

## SH 2100 ALUMINUM SINGLE HUNG WINDOW

THIS PRODUCT HAS BEEN DESIGNED AND TESTED TO COMPLY WITH THE REQUIREMENTS OF THE FLORIDA BUILDING CODE 7TH EDITION (2020) INCLUDING HIGH VELOCITY HURRICANE ZONE (HVHZ).

WINDOWS RATED FOR LARGE AND SMALL MISSILE IMPACT AND DO NOT REQUIRE SHUTTERS.

GLASS CAPACITY BASED ON ASTM E1300-09 (3 SEC. GUSTS)

ULTIMATE DESIGN LOAD OBTAINED FROM ASCE 7-16, MULTIPLY BY 0.6 SHALL BE LESS THAN OR EQUAL TO DESIGN LOAD IN THIS DOCUMENT.

A LOAD DURATION INCREASE IS USED IN DESIGN OF ANCHORS INTO WOOD ONLY.

WOOD BUCKS BY OTHERS, MUST BE ANCHORED PROPERLY TO TRANSFER LOADS TO THE STRUCTURE

ANCHORS SHALL BE LISTED, SPACED AS SHOWN IN DETAILS, ANCHORS EMBEDMENT TO BASE MATERIAL SHALL BE BEYOND WALL DRESSING OR STUCCO.

ANCHORING OR LOADING CONDITIONS NOT SHOWN IN THESE DETAILS ARE NOT PART OF THIS APPROVAL.

### MATERIAL:

ALL ALUMINUM EXTRUSION TO BE 6063 T6 ALLOY

### SEALANT:

- ALL FRAME PERIMETER CAULKING USING DOWSIL 995
- JOINT AND SEAM TO BE SEALED WITH DOWSIL 995

MATERIALS INCLUDING BUT NOT LIMITED TO STEEL/METAL SCREWS, THAT COME INTO CONTACT WITH OTHER DISSIMILAR MATERIALS SHALL MEET THE REQUIREMENTS OF THE FLORIDA BUILDING CODE 7TH EDITION (2020).

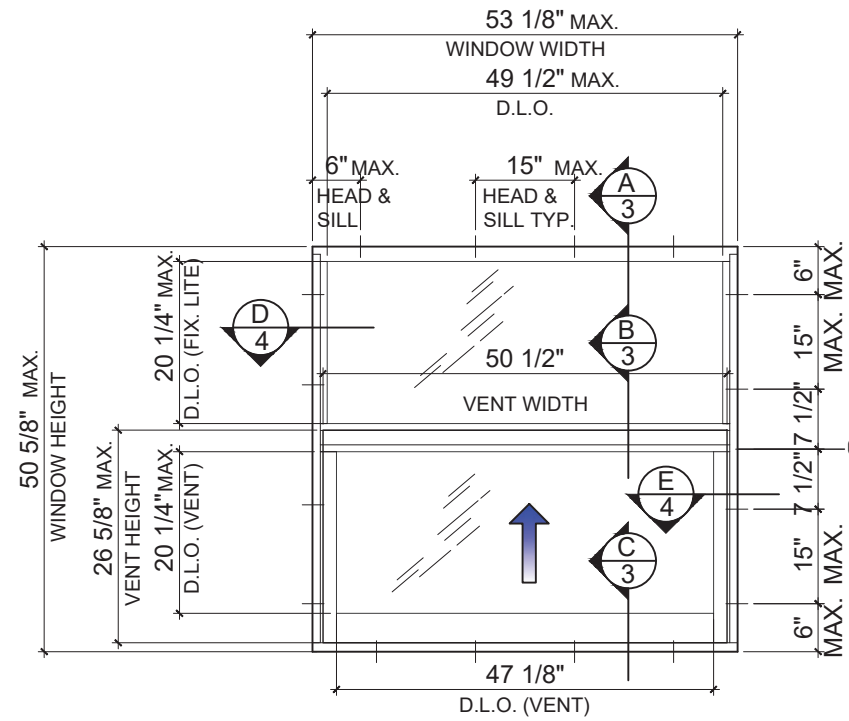

TYPICAL ELEVATION (WITHOUT JAMB ANCHORS)

**SINGLE HUNG WINDOW WITHOUT JAMB ANCHORS**  
FOR WINDOW SIZE 53 1/8" X 50 5/8" OR SMALLER WITHOUT JAMB ANCHOR MAX. DESIGN LOAD ±70 PSF.

ADDITIONAL ANCHORS FOR MULLION ARE REQUIRED SEE SEPARATE MULLION APPROVAL.

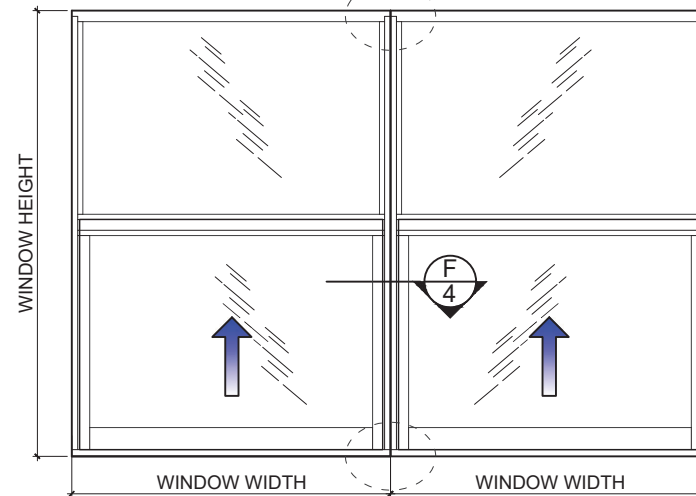

APPROVAL APPLIES TO SINGLE UNITS OR SIDE BY SIDE COMBINATIONS OF S.H./S.H. OR SINGLE HUNG WINDOW WITH OTHER WINDOW TYPES IN MODULES OF TWO OR MORE WINDOWS USING FLORIDA APPROVED MULLIONS IN BETWEEN. LOWER DESIGN PRESSURE FROM WINDOWS OR MULLION APPROVAL WILL APPLY TO ENTIRE SYSTEM.

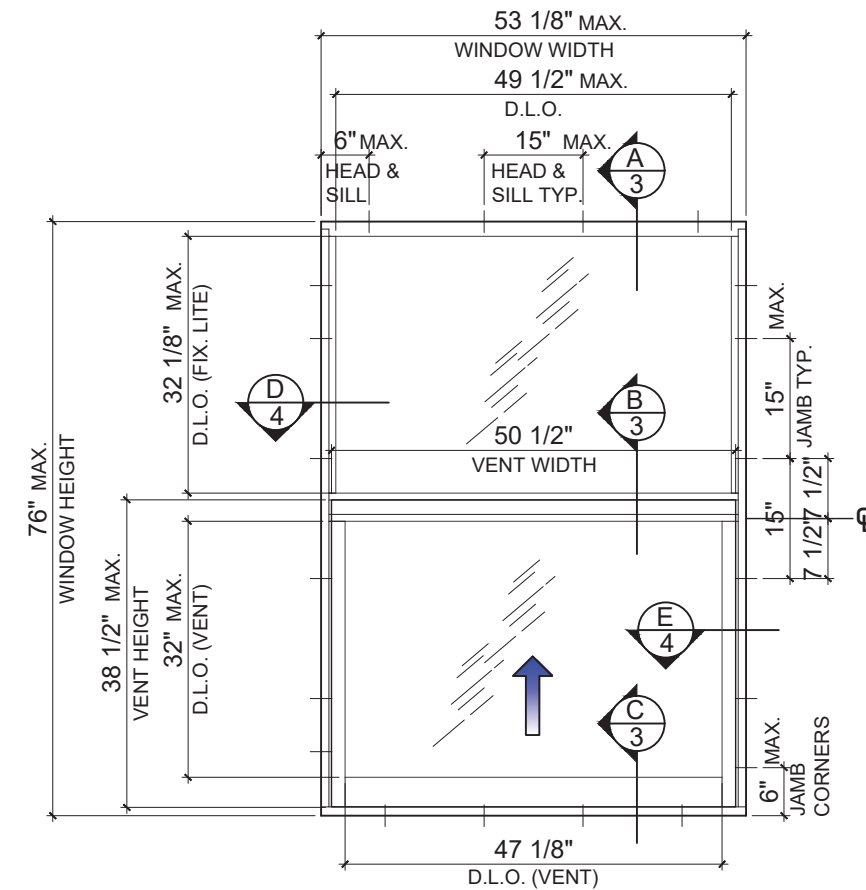

TYPICAL ELEVATION (WITH JAMB ANCHORS)

### SINGLE HUNG WINDOW WITH JAMB ANCHORS

FOR DESIGN LOAD SEE CHART ON SHEET 2 OF 5.

#### LIMITATIONS OF USE

- THIS PRODUCT EVALUATION DOCUMENT (P.E.D.) PREPARED BY THIS ENGINEER IS GENERIC AND DOES NOT PROVIDE INFORMATION FOR A SITE SPECIFIC PROJECT, I.E. WHERE THE SITE CONDITIONS DEVIATE FROM THE P.E.D.
- CONTRACTOR TO BE RESPONSIBLE FOR THE SELECTION, PURCHASE AND INSTALLATION OF THIS PRODUCT BASED ON THIS PRODUCT EVALUATION PROVIDED HE/SHE DOES NOT DEVIATE FROM THE CONDITIONS DETAILED ON THIS DOCUMENT.
- THIS PRODUCT EVALUATION DOCUMENT WILL BE CONSIDERED INVALID IF ALTERED BY ANY MEANS.
- SITE SPECIFIC PROJECTS SHALL BE PREPARED BY A FLORIDA REGISTERED ENGINEER OR ARCHITECT WHICH WILL BECOME THE ENGINEER OF RECORD (E.O.R.) FOR THE PROJECT AND WHO WILL BE RESPONSIBLE FOR THE PROPER USE OF THE P.E.D.
- THIS P.E.D. SHALL BEAR THE DATE AND ORIGINAL SEAL AND SIGNATURE OF THE PROFESSIONAL ENGINEER OF RECORD THAT PREPARED IT.

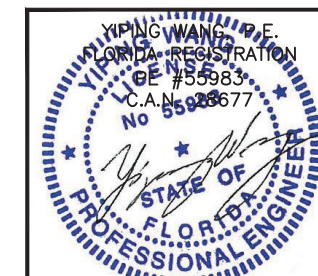

December 30th, 2020

NO.	DATE	DESCRIPTION
1.	12.14.20	PBC 2020

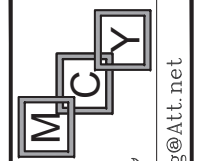

**MCY ENGINEERING, INC.**  
GLAZING CONSULTANTS

12781 MIRAMAR PKWY. STE. 301  
MIRAMAR, FL. 33027 P: 305.271.0117  
www.MCYEngineering.com MCY.Engineering@Att.net

SERIES SH2100 ALUMINUM SINGLE HUNG WINDOW - LMI & SMI

**EMC WINDOWS AND DOORS, LLC.**

455 E. 10TH AVE.  
HIALEAH, FL. 33010  
P: (305) 283 - 6280 EMCWindowsDoors@gmail.com

FL #17597

DATE	03-06-15
SCALE	AS NOTED
DRAWN	A.R.
PROJECT	15-025

DRAWING NO.  
AD15-15

1 OF 5

# SINGLE HUNG WINDOW WITH JAMB ANCHORS

DESIGN LOAD CAPACITY - PSF

WINDOW DIMS.		GLASS TYPE "A"		GLASS TYPE "B"	
HEIGHT (H)	WIDTH (W)	EXT. (+)	INT. (-)	EXT. (+)	INT. (-)
26" *(2)	19 1/8"	90.00	100.00	90.00	100.00
	26 1/2"	90.00	100.00	90.00	100.00
	37"	90.00	100.00	90.00	100.00
	53 1/8"	90.00	100.00	90.00	100.00
38-3/8" *(4)	19 1/8"	90.00	100.00	90.00	100.00
	26 1/2"	90.00	100.00	90.00	100.00
	37"	90.00	100.00	90.00	100.00
	53 1/8"	90.00	100.00	90.00	100.00
50-5/8" *(4)	19 1/8"	90.00	100.00	90.00	100.00
	26 1/2"	90.00	100.00	90.00	100.00
	37"	90.00	100.00	90.00	100.00
	53 1/8"	90.00	100.00	90.00	100.00
63" *(5)	19 1/8"	90.00	100.00	90.00	100.00
	26 1/2"	90.00	100.00	90.00	100.00
	37"	90.00	100.00	90.00	100.00
	53 1/8"	70.00	90.00	70.00	90.00
76" *(6)	19 1/8"	90.00	100.00	90.00	100.00
	26 1/2"	90.00	100.00	90.00	100.00
	37"	70.00	90.00	70.00	90.00
	53 1/8"	70.00	80.60	70.00	83.00

\* ( ) NUMBER OF ANCHORS PER JAMB

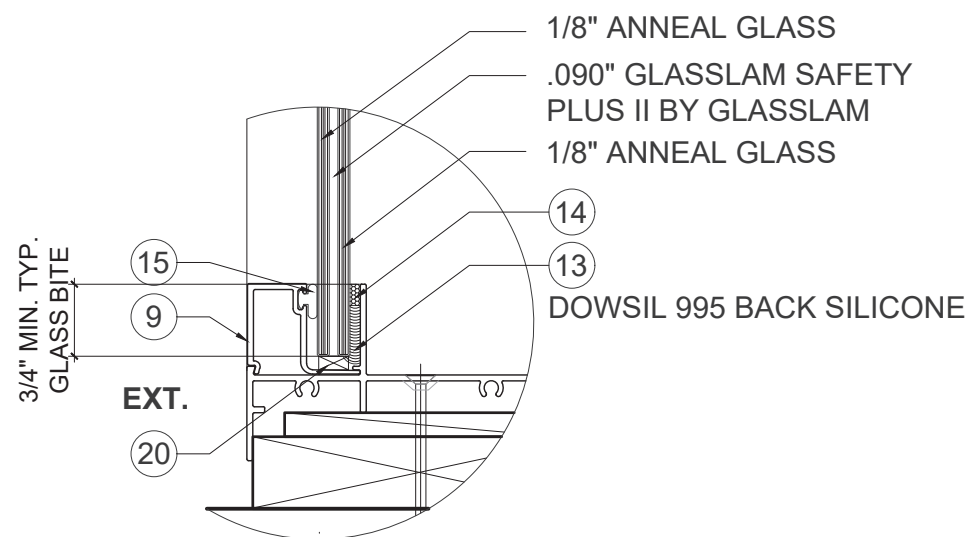

**GLASS TYPE "A"**  
5/16" OVERALL LAMINATED GLASS

CRL GRAY EDGETECH SUPER SPACER - GLASS SPACER-SILICONE FOAM BY C.R. LAURENCE CO., INC.

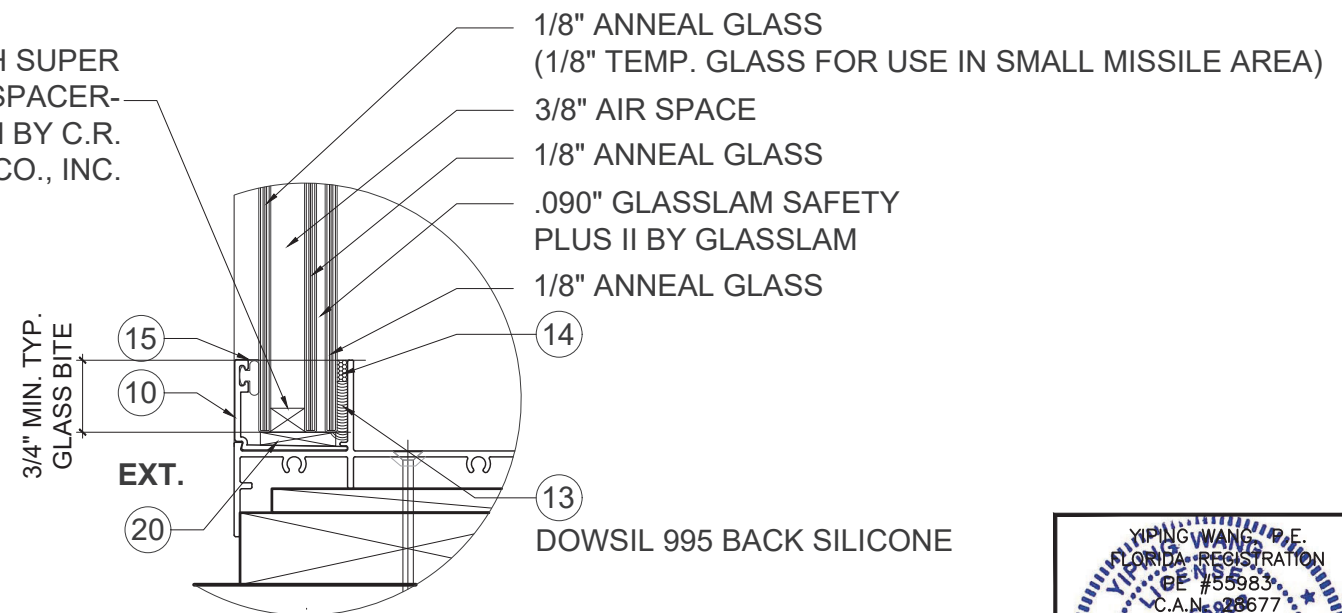

**GLASS TYPE "B"**  
13/16" OVERALL INSULATED LAMINATED GLASS

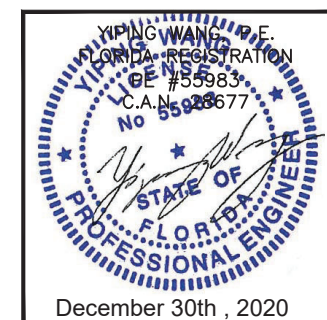

REVISIONS	
NO.	DESCRIPTION
1.	12.14.20 FBC 2020

**MCY ENGINEERING, INC.**  
GLAZING CONSULTANTS

12781 MIRAMAR PKWY. STE. 301  
MIRAMAR, FL. 33027 P: 305.271.0117  
www.MCYEngineering.com MCY.Engineering@Att.net

SERIES SH2100 ALUMINUM SINGLE HUNG WINDOW - LMI & SMI

**EMC WINDOWS AND DOORS, LLC.**  
455 E. 10TH AVE.  
HIALEAH, FL. 33010  
P: (305) 283 - 6280 EMCWindowsDoors@gmail.com

FL #17597

DATE	03-06-15
SCALE	AS NOTED
DRAWN	A.R.
PROJECT	15-025

DRAWING NO.  
AD15-15

2 OF 5

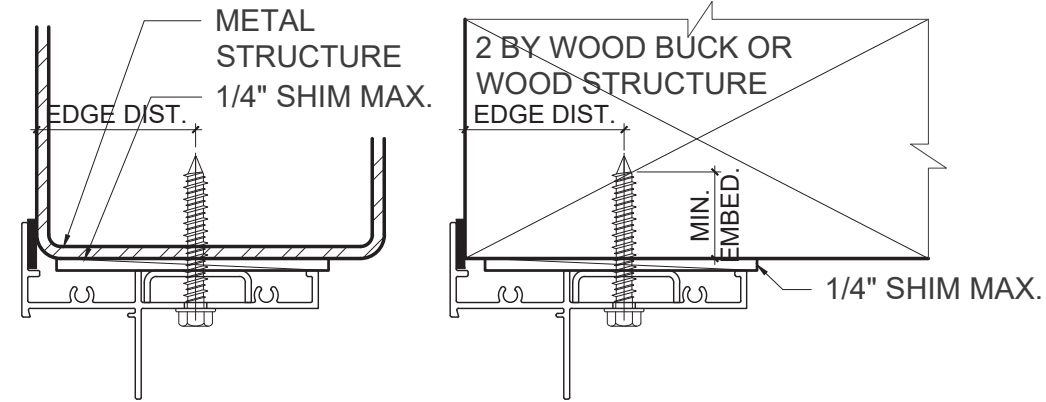
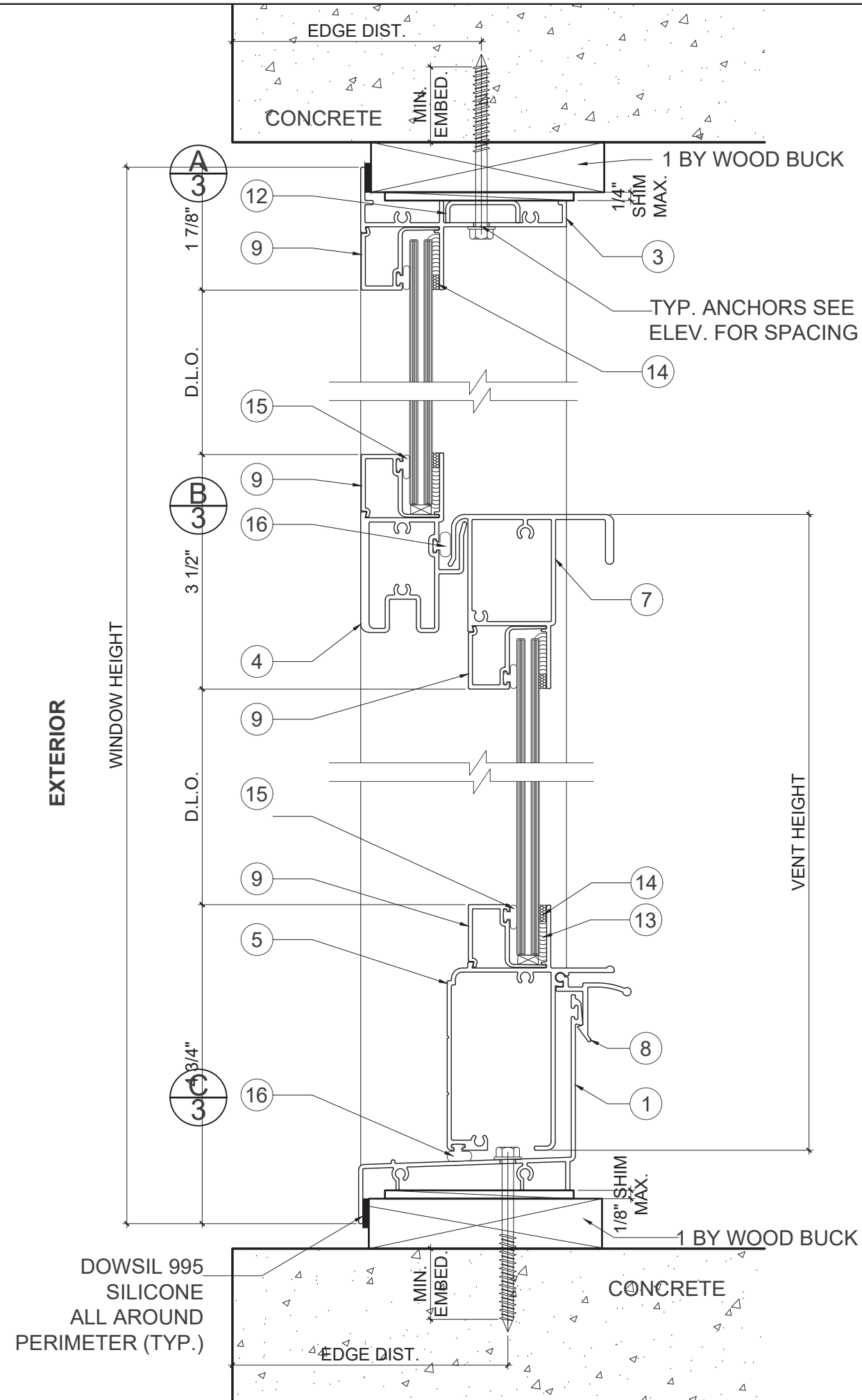

TYPICAL ANCHORS: SEE ELEV. FOR SPACING

TYPE 'A' - **1/4" ULTRACONS BY 'ELCO'** (Fu = 177 KSI, Fy = 155 KSI)

- INTO 2BY WOOD BUCKS OR WOOD STRUCTURE  
1-1/2" MIN. PENETRATION INTO WOOD
- THRU 1BY BUCKS INTO CONC. OR MASONRY  
1-1/4" MIN. EMBED INTO CONC. OR MASONRY
- DIRECTLY INTO CONC. OR MASONRY  
1-1/4" MIN. EMBED INTO CONC. OR MASONRY

TYPE 'B' - **1/4" TEKS OR SELFDRILLING SCREWS (GRADE 5 CRS)**

INTO METAL STRUCTURES

TYPE 'C' - **#14 SMS OR SELF DRILLING SCREWS (GRADE 2 CRS)**

- INTO FLORIDA STATE APPROVED MULLIONS

- STEEL : 16 GA THK MIN (Fy = 36KSI MIN.)
- ALUMINUM: 1/8" THK. MIN. (6063-T5 MIN.)  
(STEEL IN CONTACT WITH ALUMINUM TO BE PLATED OR PAINTED)

**MASONRY**

- ASTM C90 GROUT FILLED CONCRETE BLOCK
- ASTM C90 HOLLOW CONCRETE BLOCK

**CONCRETE**

- fc= 3,000 PSI MIN.

**ANCHOR EDGE DISTANCES**

- INTO CONCRETE AND MASONRY = 2-1/2" MIN.
- INTO WOOD STRUCTURE = 1" MIN.
- INTO METAL STRUCTURE = 3/4" MIN.

ALL ANCHOR OPTIONS CAN APPLY TO HEAD, SILL AND JAMB ANCHORS.

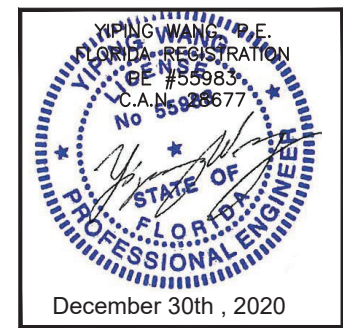

REVISIONS	
NO.	DATE
1.	12.14.20
	FBC 2020

**MCY**

**MCY ENGINEERING, INC.**  
GLAZING CONSULTANTS

12781 MIRAMAR PKWY. STE. 301  
MIRAMAR, FL. 33027  
P: 305.271.0117  
www.MCYEngineering.com MCY.Engineering@Att.net

SERIES SH2100 ALUMINUM SINGLE HUNG WINDOW - LMI & SMI

**EMC WINDOWS AND DOORS, LLC.**  
455 E. 10TH AVE.  
HIALEAH, FL. 33010  
P: (305) 283 - 6280 EMCWindowsDoors@gmail.com

FL #17597
DATE 03-06-15
SCALE AS NOTED
DRAWN A.R.
PROJECT 15-025
DRAWING NO. AD15-15
3 OF 5

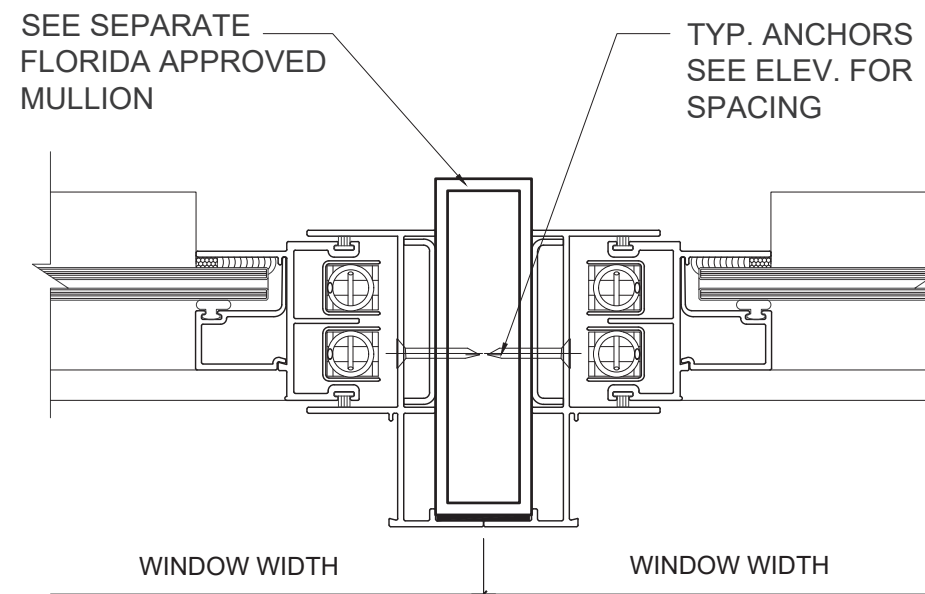
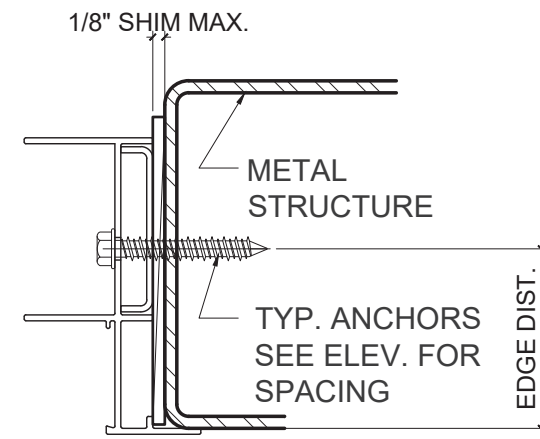
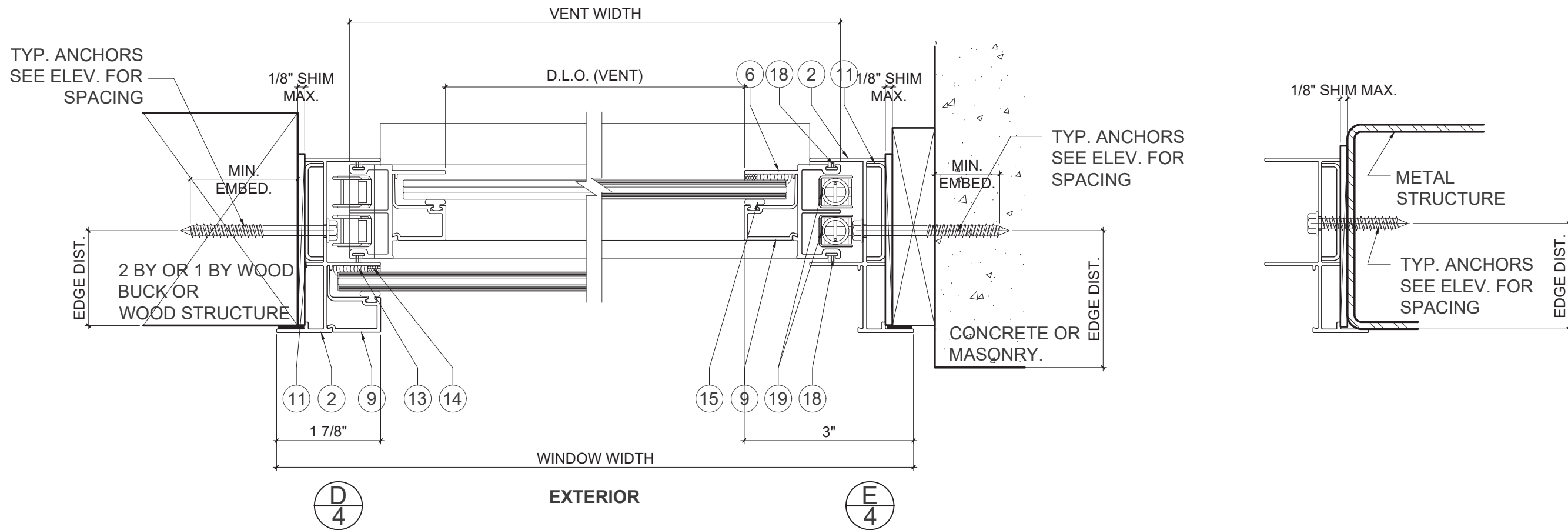

**BILL OF MATERIALS**

ITEM #	QTY.	PROFILE	DESCRIPTION	MATERIAL	MANUFACTURER/REMARKS
1	2	E101	FRAME SILL, PC WHITE	ALUM. 6063-T6	EMC WINDOWS AND DOORS, LLC.
2	2	E102	FRAME JAMB, PCWHITE	ALUM. 6063-T6	EMC WINDOWS AND DOORS, LLC.
3	2	E103	FRAME HEAD, PCWHITE	ALUM. 6063-T6	EMC WINDOWS AND DOORS, LLC.
4	2	E104	FRAME INTERLOCK, PCWHITE	ALUM. 6063-T6	EMC WINDOWS AND DOORS, LLC.
5	2	E105	VENT SILL, PCWHITE	ALUM. 6063-T6	EMC WINDOWS AND DOORS, LLC.
6	2	E106	VENT JAMB, PCWHITE	ALUM. 6063-T6	EMC WINDOWS AND DOORS, LLC.
7	2	E107	VENT TOP, PCWHITE	ALUM. 6063-T6	EMC WINDOWS AND DOORS, LLC.
8	2	E108	LOCK EXTRUSION, PCWHITE	ALUM. 6063-T6	EMC WINDOWS AND DOORS, LLC.
9	8	E110	GLAZING CHANNEL, PC WHITE	ALUM. 6063-T6	EMC WINDOWS AND DOORS, LLC.
10	8	E121	ALUM. INSULATED GLAZING CHANNEL	ALUM. 6063-T6	EMC WINDOWS AND DOORS, LLC.
11	AS REQD.	E127	ANCHOR CLIP 16 GA	ALUM. 6063-T6	EMC WINDOWS AND DOORS, LLC.
12	AS REQD.	E128	ANCHOR CLIP 16 GA	ALUM. 6063-T6	EMC WINDOWS AND DOORS, LLC.
13	AS REQD.	SEAL01-1	DOWSIL 995 BACK SILICONE	SILICONE	DOWSIL
14	AS REQD.	W0019	.125 X .25 GLAZNG TAPE, 2 SIDED	TAPE	FRANK LOWED
15	AS REQD.	V0021	E202 VINYL BULB, GLAZING STOP	VINYL	FENESTRATION GLASS PRODUCTS
16	AS REQD.	V0020	E708 VINYL BULB, FRAME	VINYL	FENESTRATION GLASS PRODUCTS
17	AS REQD.	#8 X 1	FRAME ASSEMBLY SCREWS	STEEL	SPH SHEET METAL SCREW
18	AS REQD.	Q23	WOOL PILE FRAME	WOOL	ULTRAFAB
19	AS REQD.	BL100	100 SERIES BALANCE	METAL	BSI
20	AS REQD.	-	SETTING BLOCK	EPDM +/- 65	-

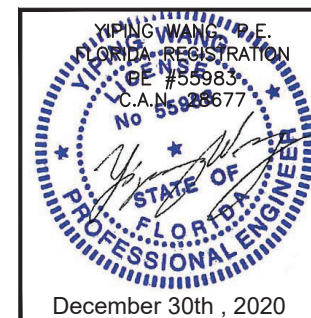

REVISIONS	NO.	DATE	DESCRIPTION
	1.	12.14.20	FBC 2020

**MCY ENGINEERING, INC.**  
 GLAZING CONSULTANTS  
 12781 MIRAMAR PKWY. STE. 301  
 MIRAMAR, FL. 33027  
 P: 305.271.0117  
 www.MCYEngineering.com  
 MCY.Engineering@Att.net

SERIES SH2100 ALUMINUM SINGLE HUNG WINDOW - LMI & SMI  
**EMC WINDOWS AND DOORS, LLC.**  
 455 E. 10TH AVE.  
 HIALEAH, FL. 33010  
 P: (305) 283 - 6280 EMCWindowsDoors@gmail.com

FL #17597
DATE 03-06-15
SCALE AS NOTED
DRAWN A.R.
PROJECT 15-025
DRAWING NO. AD15-15
4 OF 5

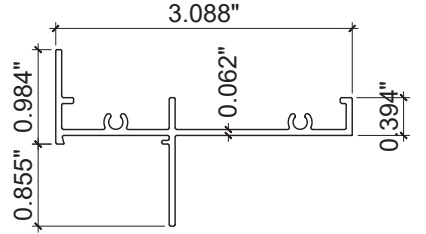
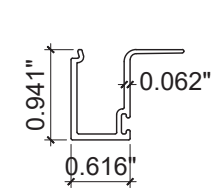
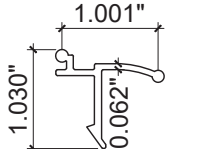
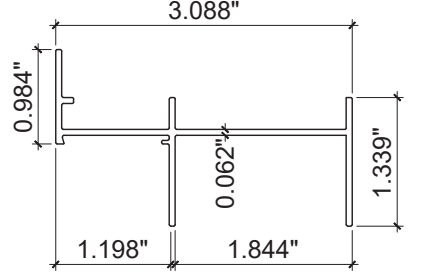
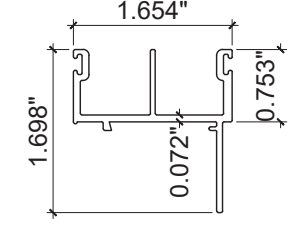
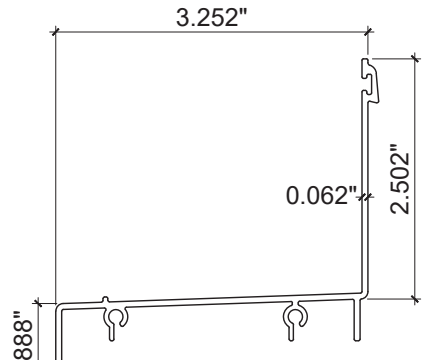
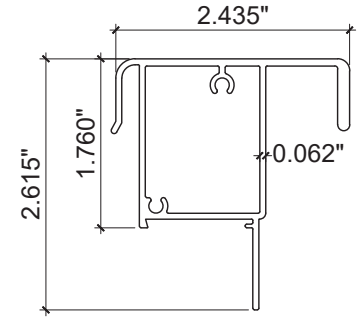
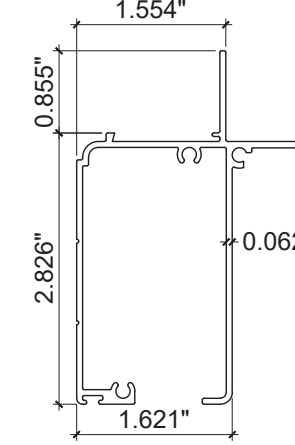
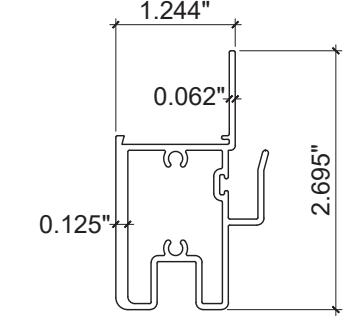
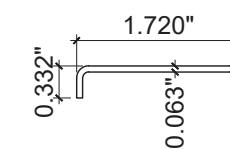
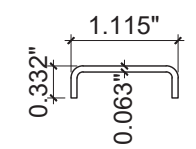
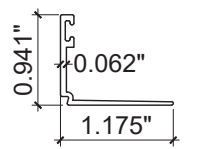
 <p>3 E103 FRAME HEAD</p>	 <p>9 E110 GLAZING CHANNEL</p>	 <p>8 E103 LOCK EXTRUSION</p>
 <p>2 E102 FRAME JAMB</p>	 <p>6 E106 VENT JAMB</p>	
 <p>1 E101 FRAME SILL</p>	 <p>7 E107 VENT TOP</p>	
 <p>5 E105 VENT SILL</p>	 <p>4 E104 FRAME INTERLOCK</p>	
 <p>11 E127 ANCHOR CLIP</p>	 <p>12 E128 ANCHOR CLIP</p>	 <p>10 E121 GLAZING CHANNEL</p>

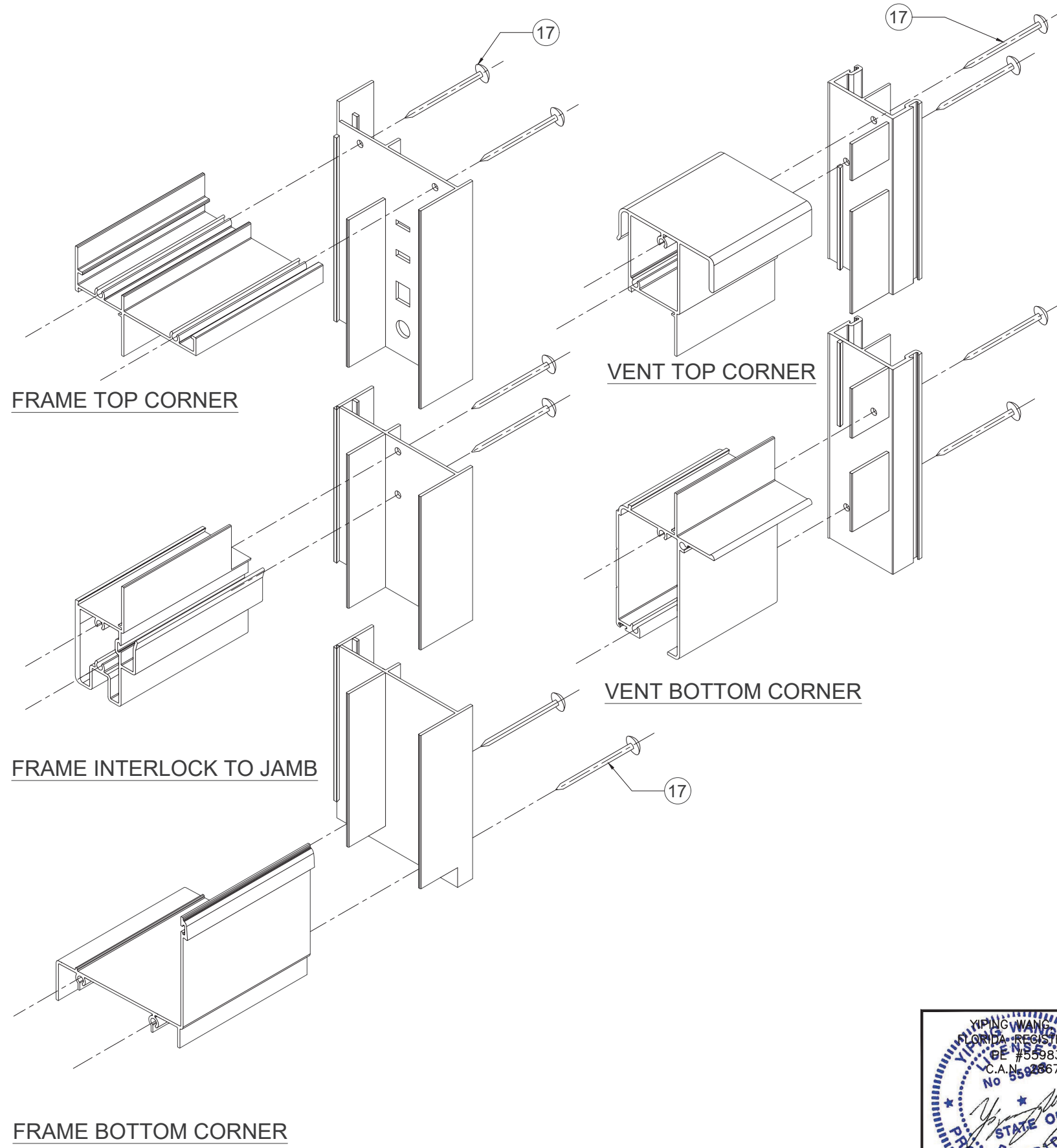

REVISIONS	
NO.	DATE
1.	12.14.20
	FBC 2020

**MCY ENGINEERING, INC.**  
GLAZING CONSULTANTS

**EMC WINDOWS AND DOORS, LLC.**  
12781 MIRAMAR PKWY. STE. 301  
MIRAMAR, FL. 33027  
P: 305.271.0117  
www.MCYEngineering.com MCY.Engineering@Att.net

SERIES SH2100 ALUMINUM SINGLE HUNG WINDOW - LMI & SMI

**EMC WINDOWS AND DOORS, LLC.**  
455 E. 10TH AVE.  
HIALEAH, FL. 33010  
P: (305) 283 - 6280 EMCWindowsDoors@gmail.com

FL #17597	
DATE	03-06-15
SCALE	AS NOTED
DRAWN	A.R.
PROJECT	15-025
DRAWING NO. AD15-15	
5 OF 5	

