

PIT 3 EXTENSION

EXISTING CONDITIONS
CROSS-SECTION PLAN

SHEET 7 OF 9



APPLICANT
PORT COLBORNE QUARRIES INC.

222 MARTINDALE ROAD, P.O. BOX 1116
ST. CATHERINES, ON, L2R 7A3

COPYRIGHT
This drawing has been prepared solely for the intended use. This any reproduction or distribution for any purpose other than authorized by IBI Group is prohibited. Written consent must be obtained from IBI Group in advance. The IBI Group and IBI Group Inc. shall be held liable for any variations from the dimensions and conditions shown on this drawing. Stop drawings shall be submitted by IBI Group for general concurrence before proceeding with fabrication.

IBI Group Professional Services (Canada) Inc.
is a member of the IBI Group of companies.

KEY MAP - N.T.S.

Part of Lots 17, 18 & 19 Concession 2 and R.P. 20R-16702 Part of Road Allowance between Lot 18 & 19 Concession 2, in former Township of Humberstone, the City of Port Colborne, Region of Niagara.

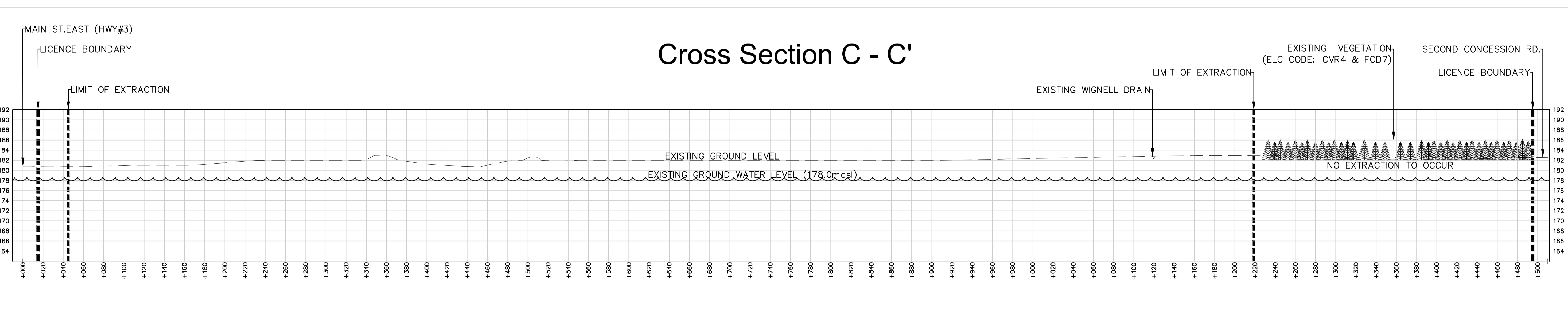
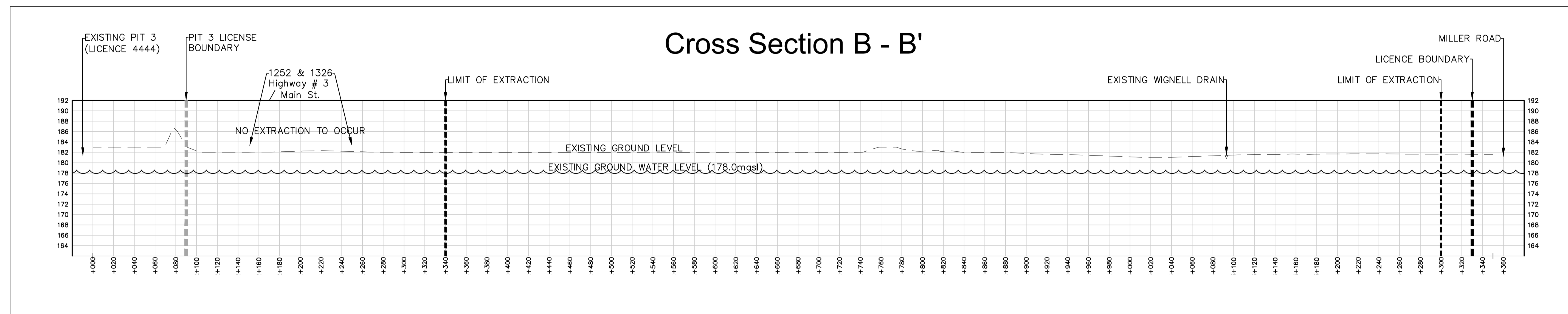
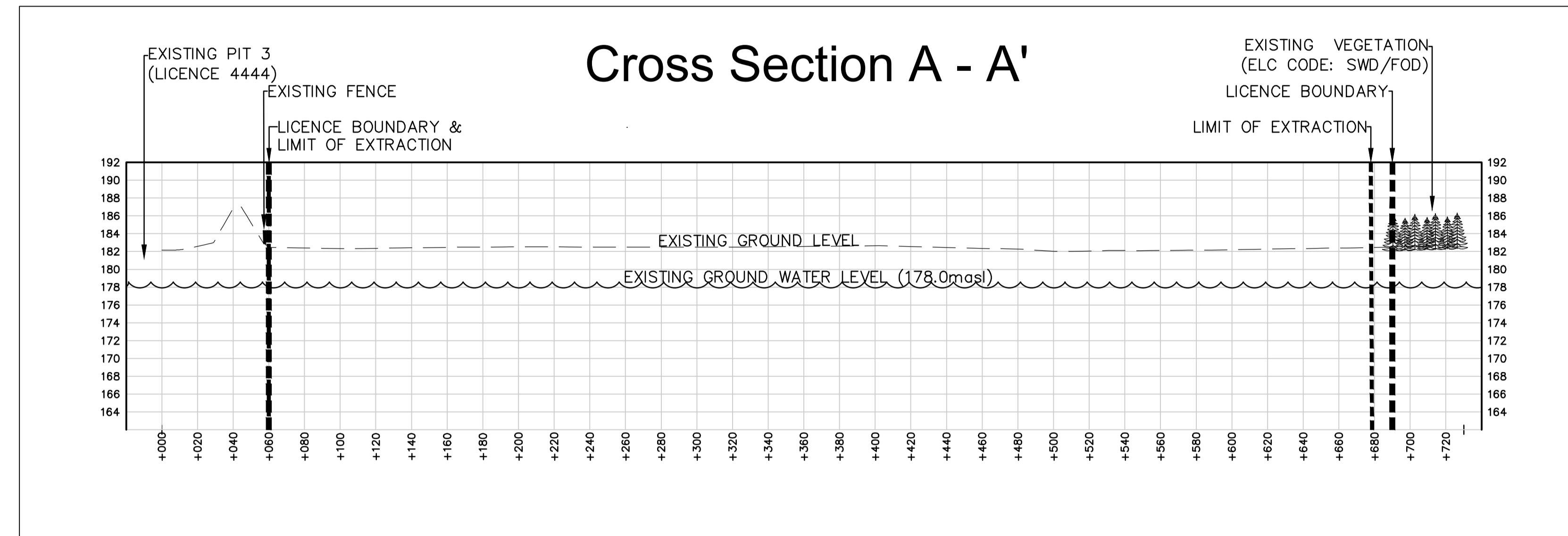

LEGEND

- LICENCE BOUNDARY
- LIMIT OF EXTRACTION
- EXISTING GROUND LEVEL
- EXISTING GROUND WATER LEVEL (178.0 m.a.s.l.)

VERTICAL SCALE
1 : 400

HORIZONTAL SCALE
1 : 2,000

| NO. | DATE | BY | DESCRIPTION |
|--|-------------|--|--|
| SITE PLAN AMENDMENTS | | | |
| 1 | 2021.02.04 | AS PER MNR PRELIMINARY REVIEW COMMENTS | AS PER MNR PRELIMINARY REVIEW COMMENTS |
| REVISIONS PRIOR TO APPROVAL | | | |
| SITE DATA | | | |
| AREA TO BE LICENSED | ±106.29 ha | | |
| AREA TO BE EXTRACTED | ± 71.12 ha | | |
| EX. DISTURBED AREA | Nil | | |
| TOTAL LAND PARCEL | ± 106.29 ha | | |
| THESE SITE PLANS HAVE BEEN PREPARED UNDER THE AGGREGATE RESOURCES ACT FOR A CLASS LICENSE, CATEGORY 2. THEY HAVE BEEN PREPARED BY THE UNDERSIGNED BY THE AUTHORITY OF MINISTERIAL APPROVAL AS SPECIFIED IN THE AREA SECTION 6 (4). | | | |
| DATE: Jun 15, 2021 | | | |

IBI GROUP
Suite 101 - 410 Albert Street
Waterloo ON N2L 3V3 Canada
Tel: 519 885 2255
ibigroup.com

PORT COLBORNE QUARRIES INC.

PIT 3 EXTENSION

SCALE: VERTICAL: 1 : 400
HORIZONTAL: 1 : 2,000

PROJECT NO:
115774

DRAWN BY:
D.R.S.

CHECKED BY:
D.R.S.

PROJECT MGR:
D.R.S.

APPROVED BY:
D.R.S.

SHEET TITLE
**EXISTING CONDITIONS
CROSS-SECTIONS**

SHEET NUMBER
7 of 9

ISSUE

File Location: J:\15774_Pit3Extension\3-Drawings\Sheet\3-DRAWING\Sheet\7-EXISTING CONDITIONS CROSS-SECTIONS.dwg, Last Saved: February 16, 2021 10:27:38 AM by Emma Tilley