

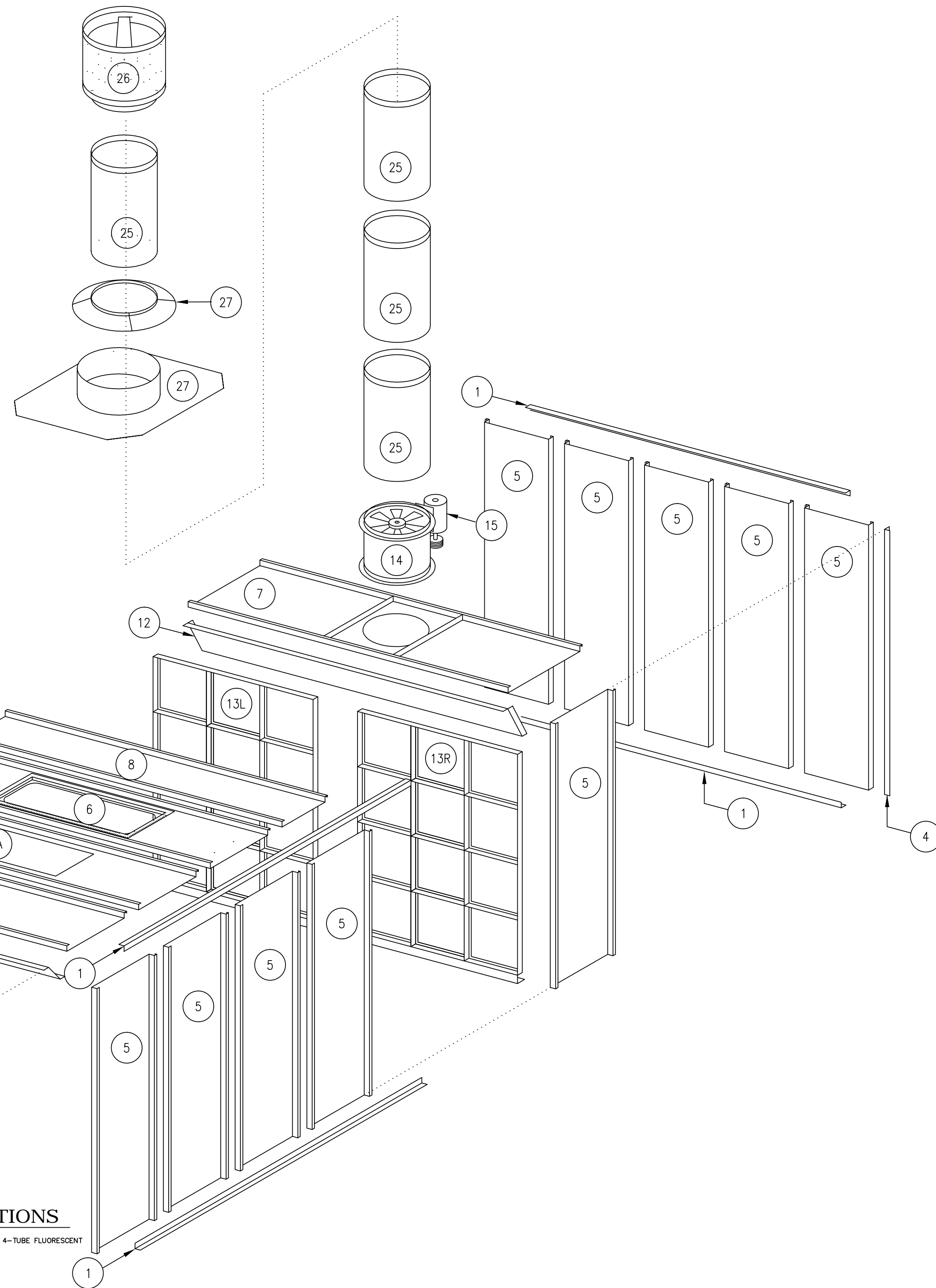

**Intertek**

53993  
 SPRAY APPLICATIONS  
 USING FLAMMABLE  
 AND COMBUSTIBLE  
 MATERIALS  
 CONFORMS TO NFPA STD.33

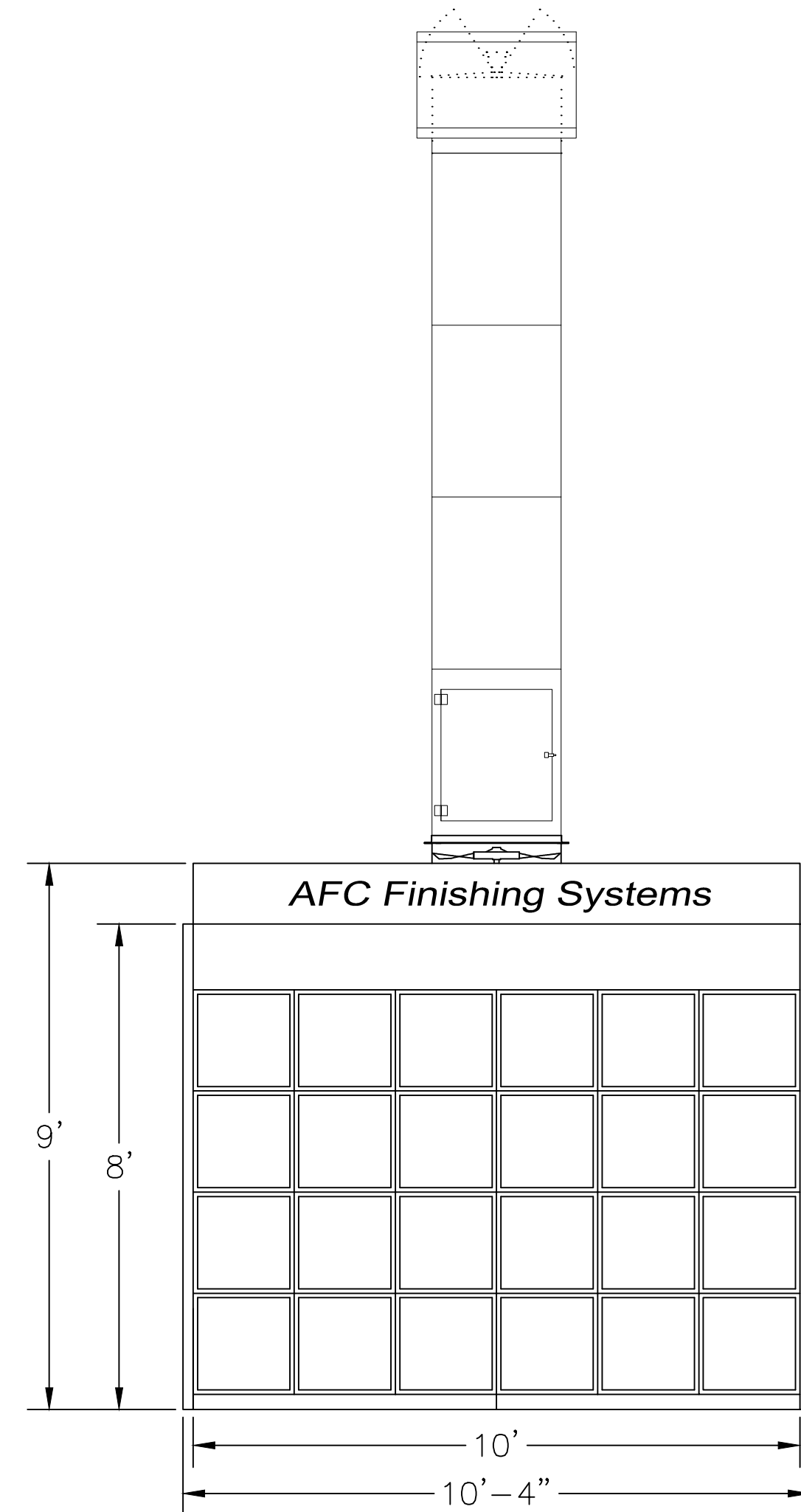
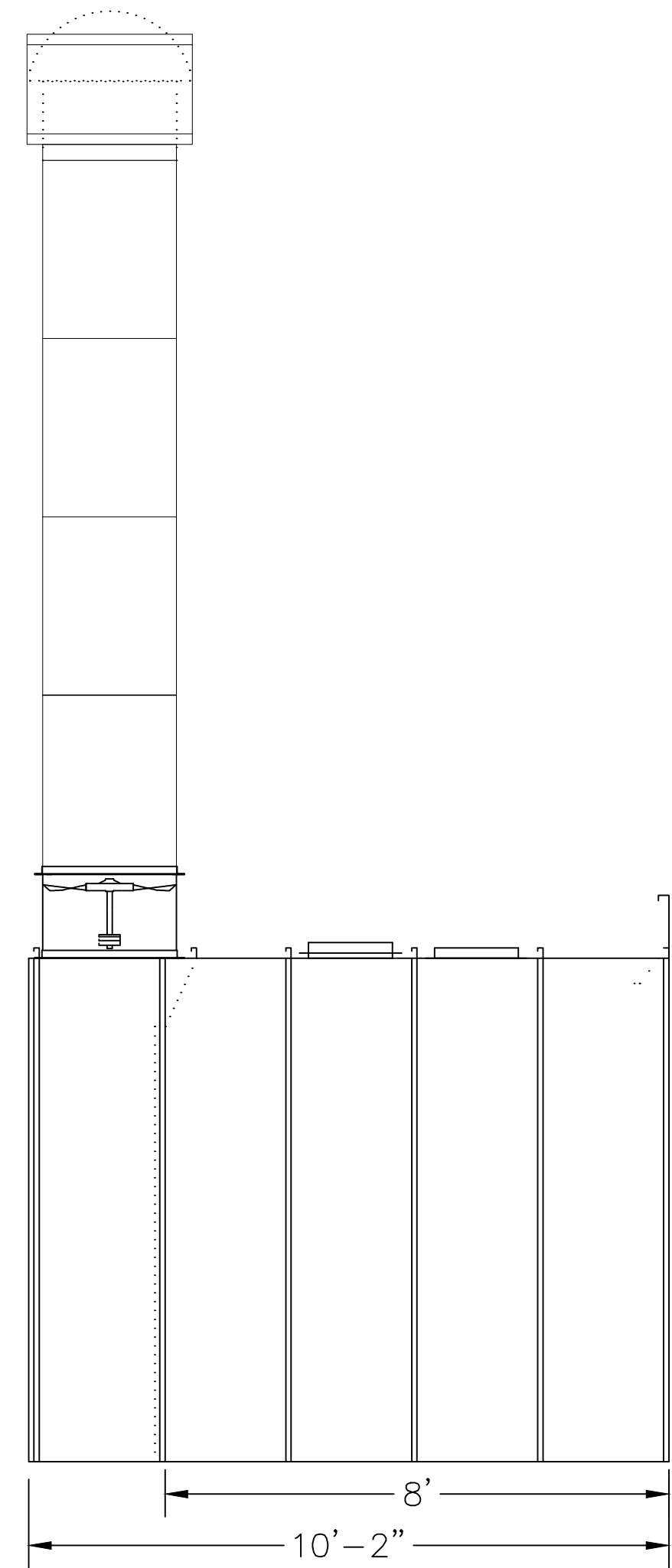

**OPEN FACE INDUSTRIAL SPRAY BOOTH  
 MODEL: EIBF108**

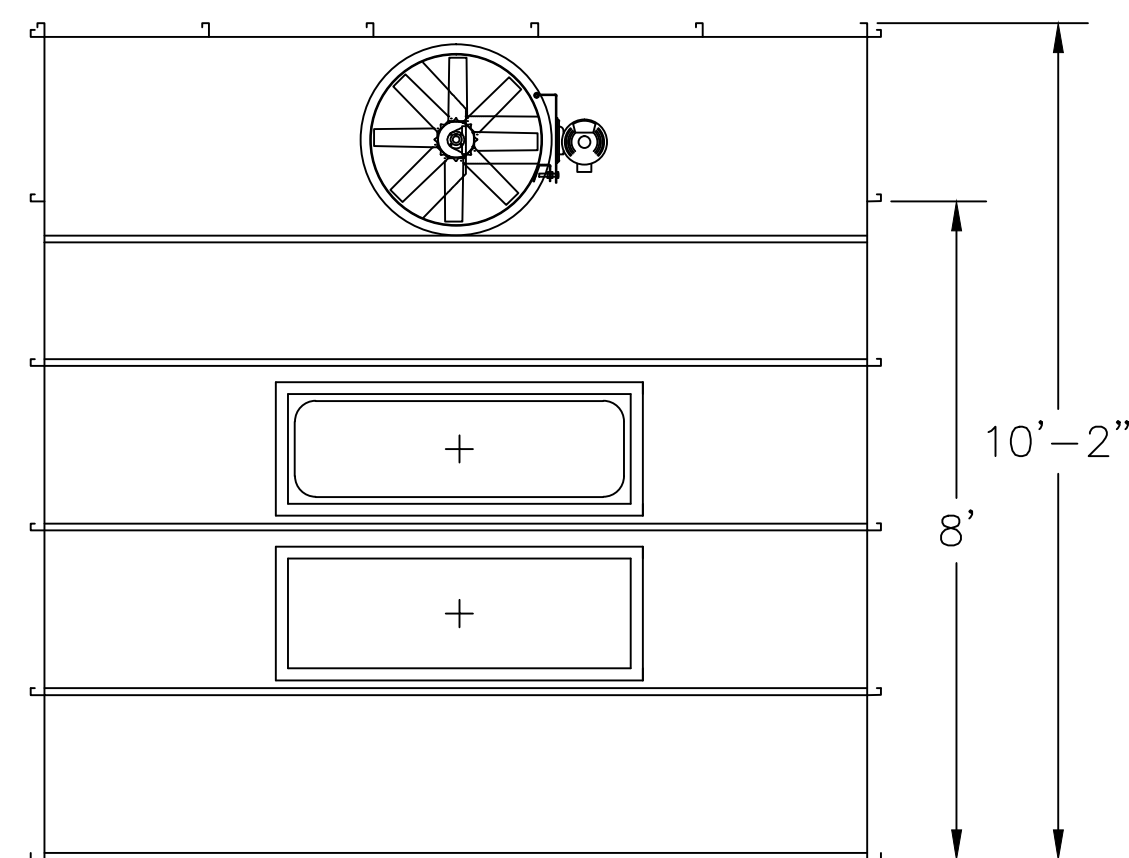

**BOOTH SPECIFICATIONS**

- MODEL= EIBF108 FLOOR FILTER BOOTH, OPEN FACE-ETL LISTED
- LENGTH= 10'-2" O.D. / 8'-0" I.D.
- WIDTH= 10'-2" O.D. / 10'-0" I.D.
- HEIGHT= 9'-0" O.D. / 8'-0" I.D.

**EXHAUST SPECIFICATIONS**

- EXHAUST FAN TYPE= 1-EACH 25 1/2" DIAMETER NON-SPARKING BLADE
- MOTOR TYPE= 1-3HP./3-PHASE
- VOLTAGE= 240VAC 3-PHASE 60HZ
- C.F.M. RATING= Total 8,000 @ 1/2" STATIC PRESSURE
- EXHAUST CELLS= (2) 20" x 20" x 2" FIBERGLASS ARRESTORS
- ONE MANOMETER ONE MAGNETIC AIR VALVE
- ONE MANUAL CONTROL PANEL MODEL: CP1

**CONSTRUCTION**

- "SINGLE WALL" 18 GA. G-90 GALVANIZED STEEL PANELS
- BASE AND TIE-IN ANGLE 14 GA. G-90 GALVANIZED STEEL
- SUPPORT CHANNEL 12 GA. G-90 GALVANIZED STEEL
- PANEL ASSEMBLY TYPE= 1/4" x 3/4" SELF-TAPPING SCREWS ON 10" CENTERS TYP.

**LIGHTING SPECIFICATIONS**

- TYPE = 1) OPEN 1) CLASS 1 DIVISION 2 INSIDE SERVICE 4-TUBE FLUORESCENT
- VOLTAGE= STANDARD: 120 VOLT
- QUANTITY= 2-EA. TOTAL

REV.	DESCRIPTION	DATE	BY



**AFC Finishing Systems**

250 AIRPORT PARKWAY, OROVILLE, CA 95965  
 (800) 331-7744 (530) 533-0179 (FAX)  
<http://www.afc-ca.com> email: sales@afc-ca.com

THIS DRAWING IS THE PROPERTY OF AFC FINISHING SYSTEMS AND IS NOT TO BE LOANED, COPIED OR DUPLICATED UNLESS IN DIRECT CONNECTION WITH AFC FINISHING SYSTEMS. ALL RIGHTS RESERVED. THIS DRAWING MUST BE RETURNED UPON REQUEST BY AFC FINISHING SYSTEMS.

DRAWN FOR: **TBD**

DESCRIPTION: **FLOOR FILTER BOOTH MODEL: EIBF108**

DRAWN BY: J.BARTON	CHECKED BY:	APPROVED BY:	DATE: 04/04/2019
INSTALLED BY:	FIELD CHANGED BY:	SCALE: 7/16"=1'	DRAWING NAME: EIBF108-8DP ASSEMBLY