



Trash & Recycling Locations within Haile Village Center



For special pick up of furniture and other items: Owners will be billed for and pay for their own special services; bulk pickup services are not provided by HVCOA. A roll off dumpster may be delivered to the property as needed.

Call the local GFL customer service team to arrange the pickup of bulk items: 352-377-0800.

For pickup of appliances such as stoves, washers, and dryers, call the County Waste Collection Office (352) 338-3233.

There is a fee charged by GFL for all bulk pick up items. Special collections of exterior materials will be arranged for a fee. Haile Village Center does not provide bulk drop-off locations, nor does the association pay for any bulk pickup services. Every owner (and renter) in Haile Village Center must contact GFL for pickup of their bulk items directly. GFL relays the following message: On your collection day, the bulk item(s) must be kept separate from any other trash or debris. Items that will fit in a garbage cart or yellow overflow trash bag are not considered “bulk”.



Recycling: There are currently two (2) Designated Recycle Locations within Haile Village Center.

Recycle Cans with Blue Lids - Plastics, glass, and aluminum may be placed inside any can with a blue lid within Haile Village Center. Recycling

cans located in HVCOA Designated Refuse Locations are picked up on Tuesdays.

Cardboard dumpster – There is currently only one (1) cardboard dumpster onsite. FLAT cardboard only is to be placed inside the designated cardboard dumpster.

Recycling containers provided by HVCOA are picked up on Tuesdays.



Primary HVCOA collection site for household trash: There is a side-entry dumpster in this location for household trash. This side-entry household trash dumpster and all HVCOA provided green-lid trash cans will be emptied on **Tuesdays and Fridays**.

If you own a home in Haile Village Center, your parcel may be exempted annually from the county's mandatory commercial trash rate for associations. Exemptions are requested by the association in June each year and become effective on Oct 1st; these parcels enjoy the added private benefit of additional residential services offered by GFL. Once established, residential private accounts with GFL receive special yard waste collections and private recycle bins; owners usually store these within their enclosed garage. Once approved, private bins are billed on the owner's tax roll. *Exempted parcels may also use any other HVC-provided refuse and/or recycling location, can or dumpster within Haile Village Center as they are for all.*

These private GFL contracted owners' cans are collected (trash and recycle pick up) on Mondays.

Any owner may contract with GFL privately or request their parcel to be added or removed from the annual exemption request at the next allowable renewal cycle. Such written requests must be received via certified mail/return receipt on or before 4/30 each year.

These private GFL customers must place their cans out for pickup prior to the collection day, or before the truck comes, for them to be emptied by GFL. The owner must contact GFL directly if they have any issues with their collection.

Many businesses in Haile Village also currently contract privately with GFL for private trash and recycle collection. Collection sites not listed on the Designated Refuse & Recycling Areas map require HVCOA board and/or ARB approval. The ARB form is available on this owner portal under Residents and Online Forms.

Owners and Renters with private dumpsters and/or privately used cans are responsible for the following:

a) Provide an approved trash surround if a new one is needed and/or for maintaining the existing dumpster surround or fence materials provided, constituting a type of surround; as well as providing for its replacement when requested by management, within a timeframe provided by the association.

(b) Providing signage related to refuse collection within 30 days when requested by management.

(c) Maintaining the cleanliness and/or integrity of the refuse location, which includes the concrete pad and enclosure.

(d) Providing pest control and maintaining potential infestations when requested.

(e) Privately owned dumpsters must remain closed and locked to prevent unauthorized dumping.

(f) Immediately disposing of all waste in a designated location.

(g) Providing all governing docs for HVCOA, including rules and their occasional revisions, to their renters. www.hailevillagecenter.com has

many community pages that are available to the public without a login. Landlords may consider requiring their renters to acknowledge receipt of HVCOA governing docs, rules and regulations. Renters should be encouraged to subscribe to association news alerts.

There are currently at least two Designated Recycle Centers in Haile Village Center.

Recycle Cans with Blue Lids - Plastics, glass, and aluminum.

Cardboard dumpster - Flat Cardboard only is required to be placed inside the dumpster.

1. **The current Primary Recycle Center is located behind condo building I (5141 SW 91st Way);** in the parking lot behind the Samba and Brick Road restaurants. The ONLY cardboard dumpster for HVC is located here. Cardboard must be flattened and placed in this specific dumpster. **No cardboard should be left on the ground anywhere.*

**The Board may relocate this area at any time, change the number of cans or style of containers, or budget for a desired enclosure.*

2. There is currently a recycling area behind the Volcanic Sushi restaurant (5212 SW 91st Terrace). Recycle Cans with Blue Lids (for plastics, glass, and aluminum). **All cardboard must be delivered to 5141 SW 91 Way Location described above; all cardboard must be flattened and placed in this dumpster. *No cardboard should be left on the ground anywhere.*

**The Board may add additional blue-lid recycling cans at any time, change the number of cans or style of containers, or budget for a different refuse plan entirely.*

Designated Refuse & Household Trash Locations within Haile Village Center.

https://drive.google.com/file/d/1cyvpDnN-PSpTHDqSmlo_tUBkuDvqL59B/view?usp=sharing

Any owner or renter may use any HVC provided green-lid can for household trash.

The primary HVCOA collection site for household trash is in the same location as the designated recycle center; There is a side-entry dumpster in this location for any household trash and several green-lid refuse cans.

All household trash will be collected on Tuesdays and Fridays. Recycling is picked up here on Tuesdays.

There are several additional Designated Refuse & Recycling locations throughout Haile Village Center.

PHOTOS: https://drive.google.com/file/d/1cyvpDnN-PSpTHDqSmlo_tUBkuDvqL59B/view?usp=sharing

Regardless of your home's location, any owner, renter, or invited guest may use any Designated Trash or Recycle Area identified on the Haile Village Center Refuse & Recycling Locations site map.

Proposed Rules related to Refuse & Recycling in Haile Village Center Owners Association, Inc.

1. No trash or cardboard should be placed on the ground at any time.

2. All items for disposal must be placed inside a container.

Do not leave items you wish to dispose of *near a can* because it may not fit inside. Find an appropriate type of can that is not full; there are several cans and dumpsters in Haile Village Center to choose from. Owners may have to drive to a nearby Designated Refuse & Recycling location or dispose of the items at a location outside of HVCOA.

3. All cans must remain where they were placed and as indicated on the site map and included the corresponding photos. Do not relocate any HVCOA trash or recycle can somewhere that is more convenient for you or your business. If your business requires a special can, to be placed in a special location, contact GFL and sign a contract for private trash collection services. Request a GFL Service here: <https://gflenv.com/request-service/>

4. Collection sites not listed on the Designated Refuse & Recycling Areas map require HVCOA board and/or ARB approval. The ARB form is available on the hailevillagecenter.com owner portal under Residents and Online Forms.

5. All issues with GFL should be directed to GFL. To contact your customer support team, visit gflenv.com/support and enter your address to send a message to your local branch.

FAQ: <https://gflenv.com/frequently-asked-questions/>

6. Owners and Renters with private dumpsters and/or privately used cans are responsible for the following:

a) Provide an approved trash surround if a new one is needed and/or for maintaining the existing dumpster surround or fence materials provided, constituting a type of surround; as well as providing for its replacement when requested by management, within a timeframe provided by the association.

(b) Providing signage related to refuse collection within 30 days when requested by management.

(c) Maintaining the cleanliness and/or integrity of the refuse location, which includes the concrete pad and enclosure.

(d) Providing pest control and maintaining potential infestations when requested.

(e) Privately owned dumpsters must remain closed and locked to prevent unauthorized dumping.

(f) Immediately disposing of all waste in a designated location.

(g) Providing all governing docs for HVCOA, including rules and their occasional revisions, to their renters. www.hailevillagecenter.com has many community pages that are available to the public without a login. Landlords may consider requiring their renters to acknowledge receipt of HVCOA governing docs, rules and regulations. Renters should be encouraged to subscribe to association news alerts.



MESSAGE FROM



Placing your trash for curbside pickup

Correct placement of your container for curbside trash, recycling and organic waste collection is easy, but it's also important to ensure your services are handled properly and safely. **We don't want to miss your collection, but we can't pick up your trash if it isn't by the curb when our truck gets there on your service day.**

This guide on container placement will ensure you're prepared:

Place your trash can and recycling bin **at the curb with the wheels facing your house and the lid opening into the street.**

Keep your garbage cans **four feet apart** and **at least four feet or more from any obstacles such as mailboxes, cars, lamp posts, or power lines.**

Keep your container at the curb until the end of the day if it hasn't been collected. Sometimes the timing of our arrival changes, and we don't want to miss you if we come later than expected.

It's generally best to put your container out **the night before your collection day.** That way even if we're early, you won't miss your pick-up.

If you follow these guidelines, you shouldn't have any problems with your collection. On rare occasions something can go wrong, so if you have any issues with your service such as a missed collection, please contact your local branch to report it. GFL trucks are equipped with GPS tracking systems so when you call, they can check the vehicle's time and location to confirm a missed collection, and route a relief vehicle to handle it.

Request a GFL Service here: <https://gflenv.com/request-service/>

Haile Village Center Owners Association, Inc. Designated GFL Refuse & Recycling Areas Map

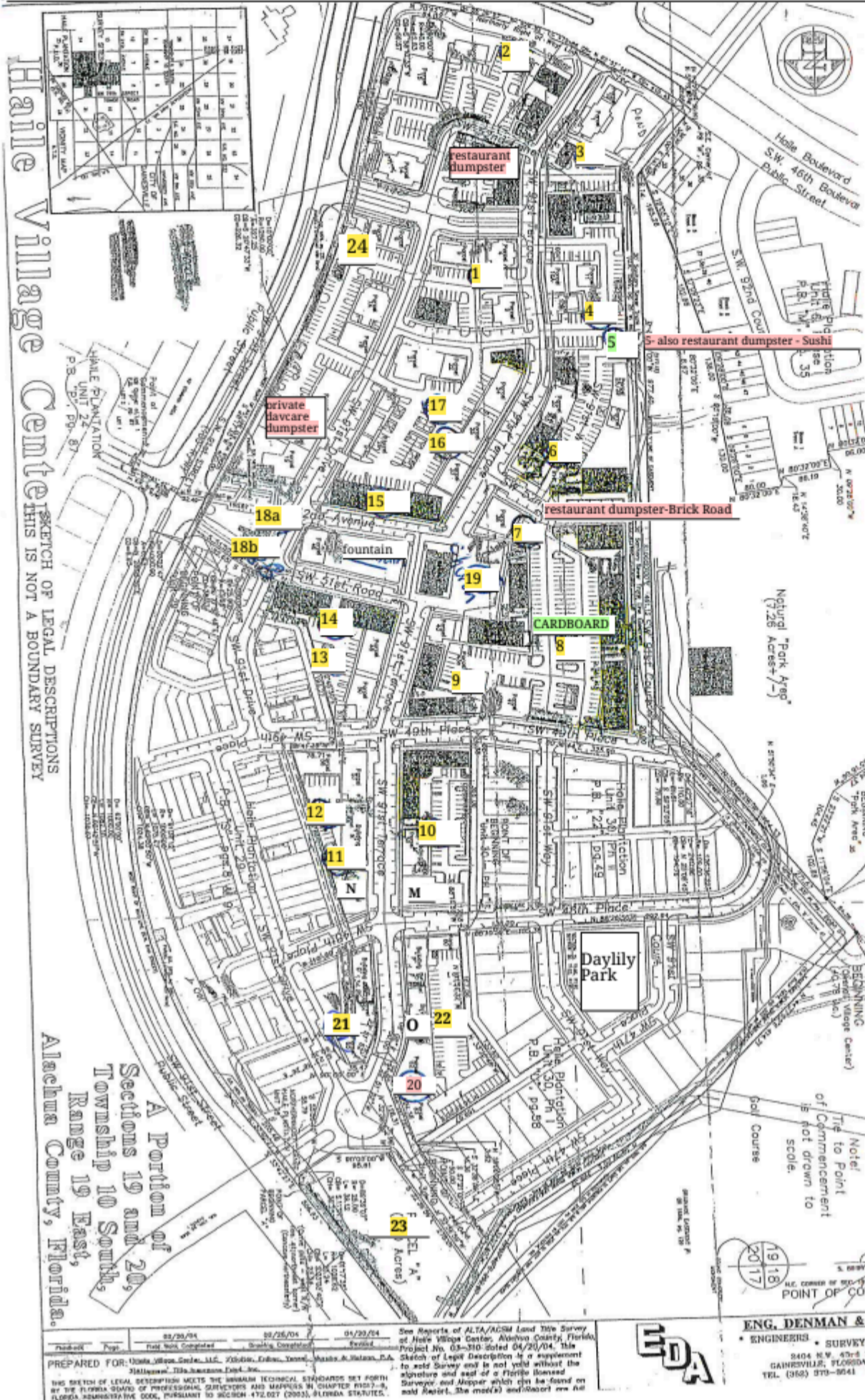

- 1 - 4 Green
- 2 - 6 Green
- 3 - 6 Green
- 4 - 4 Green
- 5 - 1 Blue
- 6 - 3 Green
- 7 - 5 Green
- 8 - 4 Green
- 2 Blue
- 18-Yard Green
- 16-Yard Cardboard Only
- 9 - 4 Green
- 10 - 4 Green
- 11 - 3 Green
- 12 - 4 Green
- 13 - 4 Green
- 14 - 6 Green
- 15 - 3 Green
- 16 - 2 Green
- 2 Blue
- 17 - 6 Green
- 18a - 1 Green
- 18b - 1 Green
- 19 - 4 Green
- 20 - 4 Green
- 1 Blue
- 1 Red (Medical Waste)
- 21 - 1 Green
- 22 - 4 Green
- 23 - 1 8-Yard Green, 2 Green
- 24 - 5 Green

#8 on the Map is the primary recycle center in HVC.

This is the location of the only cardboard dumpster within Haile Village.

Recycle Cans with Blue Lids=Plastics, glass, and aluminum.

Cardboard dumpster= Flat Cardboard only inside container.

The Primary Recycle Area is also a Primary HVCOA collection site for household trash collection: there is a side-entry dumpster in this location for any household trash.

** For special pick up of furniture and other items: Call the local customer service team: 352-377-0800. Owners will be billed for and pay for their own special services; it is not paid for by HVCOA.

** For pickup of appliances such as stoves, washers, and dryers, call the County Waste Collection Office (352) 338-3233.

adopted 7.9.25