

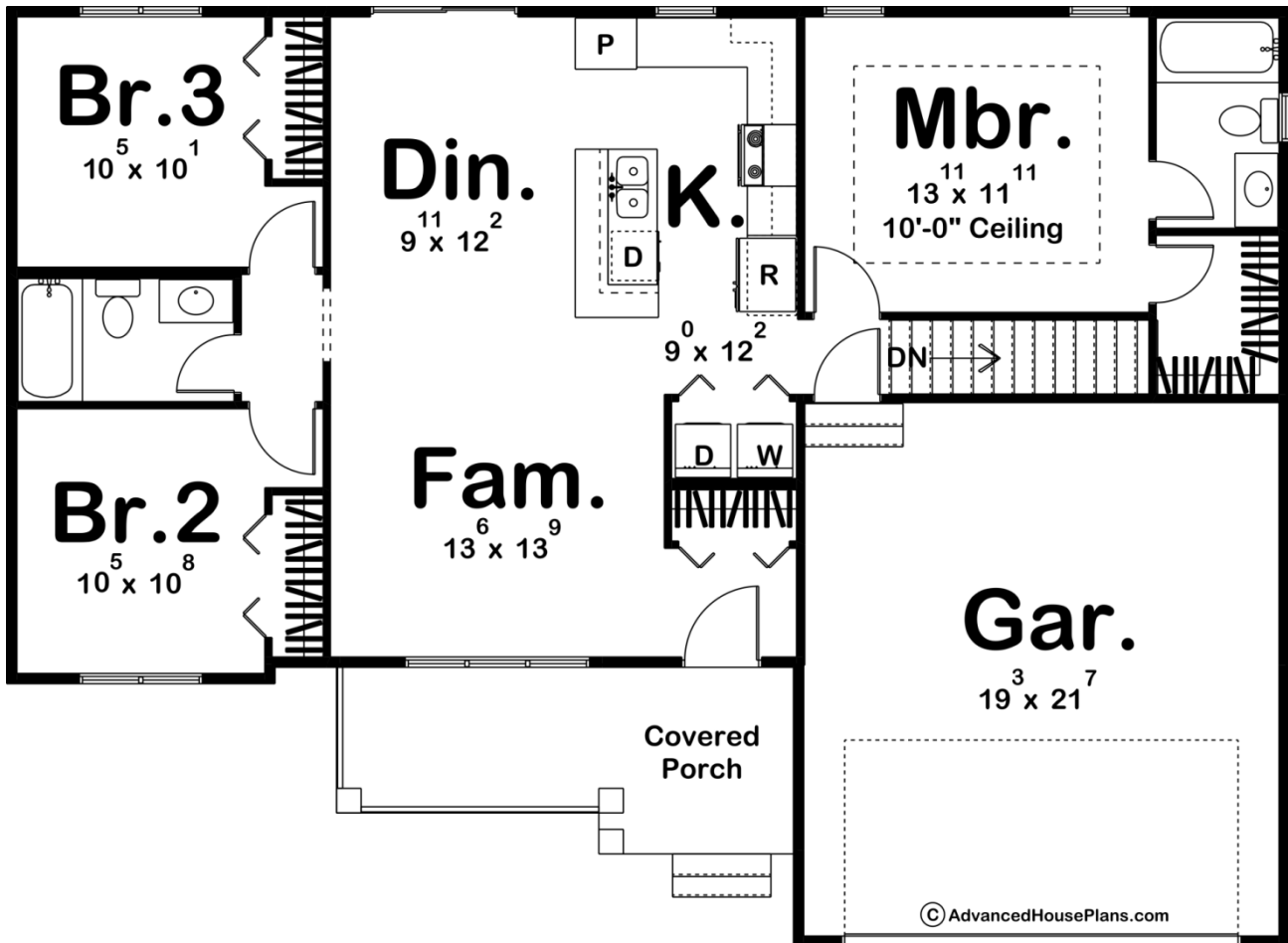

**29411 - Daniels Data Sheet**

1185 SQ FT	3 BEDS	2 BATHS	2 BAYS	52' 0" WIDE	38' 0" DEEP
---------------	-----------	------------	-----------	----------------	----------------



**Construction Specs**

Layout

Bedrooms

Bathrooms	2
Garage Bays	2

### Square Footage

Main Level	1185 Sq. Ft.
Garage	436 Sq. Ft.
Total Finished Area	1185 Sq. Ft.

### Exterior Dimensions

Width	52' 0"
Depth	38' 0"
Ridge Height <i>Calculated from main floor line</i>	21'

### Default Construction Stats

*Stats are unique to the individual plan.*

Foundation Type	Basement
Exterior Wall Construction	2x4
Roof Pitches	6/12
Foundation Wall Height	9'
Main Wall Height	9'

## Plan Description

A Modern Farmhouse facade, the Daniels is a handsome 1 story house plan with a great floor plan to match! The covered porch is an inviting approach to this house plan with detailed wood columns and board and batten siding. This 3 bedroom home has an open great room perfect for entertaining. The master suite also has a roomy walk-in closet not found in homes this size. The footprint will fit most lot sizes and the curb appeal will welcome you home. As always any Advanced House Plans home plan can be customized to fit your needs with our alteration department. Whether you need to add another garage stall, change the front elevation, stretch the home larger or just make the home plan more affordable for your budget we can do that and more for you at Ahp.