

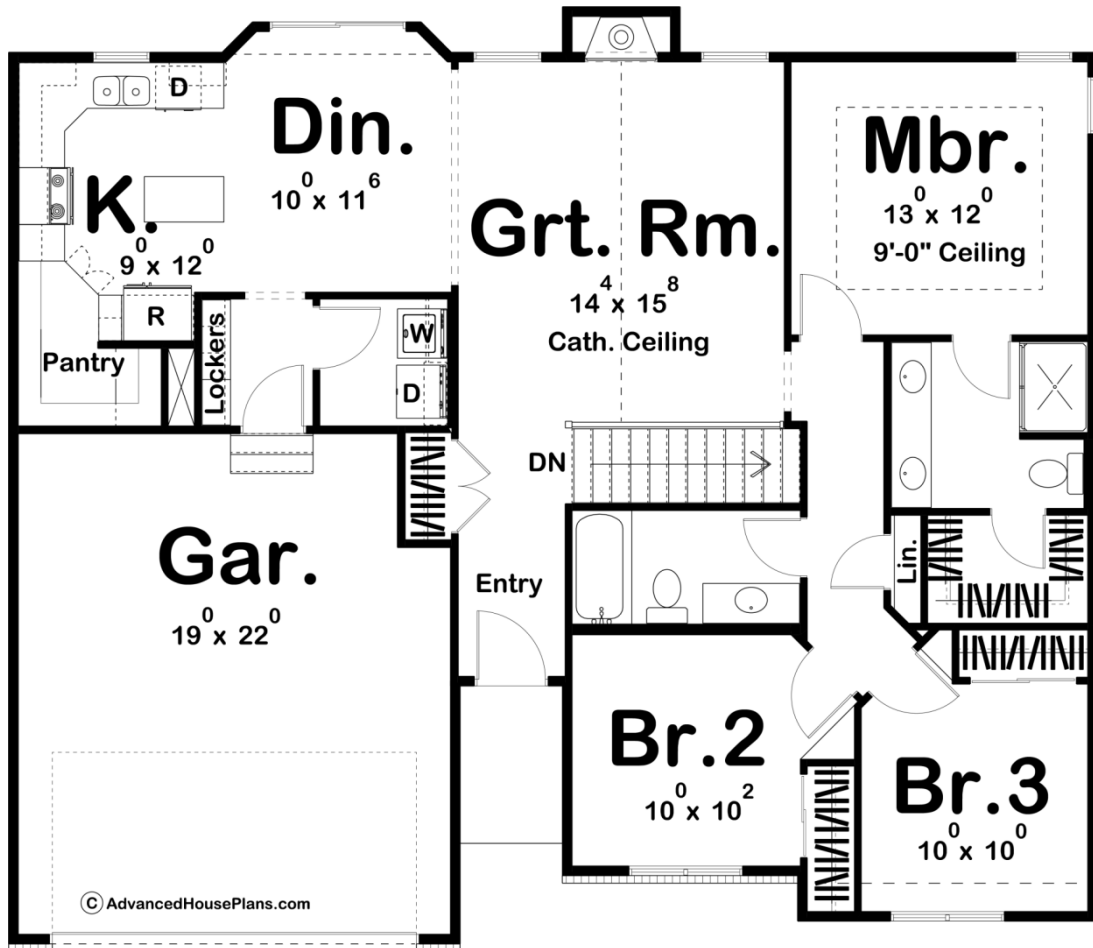

29059 - Springhill Data Sheet

1343 SQ FT	3 BEDS	2 BATHS	2 BAYS	47' 8" WIDE	41' 0" DEEP
---------------	-----------	------------	-----------	----------------	----------------



Construction Specs

Layout

Bedrooms

Bathrooms	2
Garage Bays	2

Square Footage

Main Level	1343 Sq. Ft.
Garage	423 Sq. Ft.
Total Finished Area	1343 Sq. Ft.

Exterior Dimensions

Width	47' 8"
Depth	41' 0"
Ridge Height <i>Calculated from main floor line</i>	22'

Default Construction Stats

Stats are unique to the individual plan.

Foundation Type	Basement
Exterior Wall Construction	2x4
Roof Pitches	8/12
Foundation Wall Height	9'
Main Wall Height	9'

Plan Description

The Springhill plan makes great use of its small space to create a fantastic simple house. As you walk through the entryway you will see a large great room with a soaring cathedral ceiling. The great room is warmed by a fireplace and lets in a lot of natural light with windows to the back yard. The dining room flows into a beautiful kitchen with an island and a walk in pantry. On the right side of the home you will find a wonderful master suite complete with his/her vanities, a walk in shower and a walk in closet. Bedrooms 2 and 3 share a centrally located hall bathroom. The house is also accessible from the 2 car garage through a simple and practical mudroom with lockers. This house is sure to impress at its small 1343 sq. ft. footprint. As always any Advanced House Plans home plan can be customized to fit your needs with our alteration department. Whether you need to add another garage stall, change the front elevation, stretch the home larger or just make the home plan more affordable for your budget we can do that and more for you at Ahp.