

WE'VE GOT YOU  
**COVERED!**



# **MAXSTEEL**

**BUILDINGS**

**MAXSTEELBUILDINGS.COM**



Instagram.com/MaxSteelBuildingsLLC | Facebook.com/MaxSteelBuildings





# STANDARD & PREMIUM COLOR OPTIONS★

20-Year limited warranty on rust through of the metal panels (assuming normal user care and maintenance).

ALAMO WHITE\*

LIGHT STONE

TAN

TAUPE

BROWN

BURNISHED SLATE

PEWTER GRAY\*

CHARCOAL

BLACK\*

BURGUNDY

RUSTIC RED

SILVER

OCEAN BLUE

HUNTER GREEN

\*Colors not available in 26 gauge metal.

# PREMIUM ONLY COLOR OPTIONS★

Includes color matching screws and an upgrade to a 40-year limited warranty on rust through of the metal panels (assuming normal user care and maintenance).

BRILLIANT WHITE

ASH GRAY

BRITE RED

GALLERY BLUE

FERN GREEN

★ Colors may vary from those displayed in brochure. Color samples available upon request. MaxSteel Buildings is not responsible for colors not matching brochure.

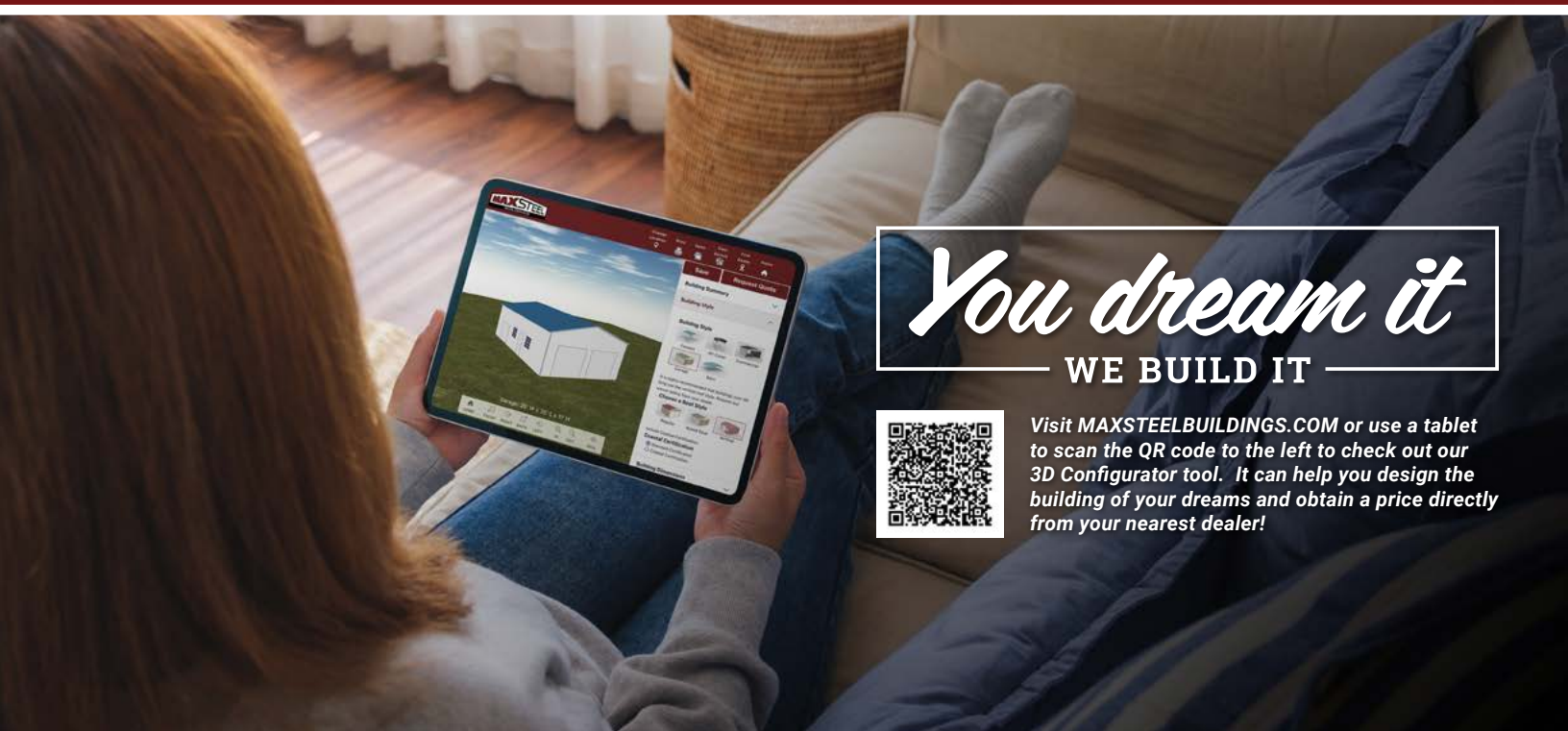

*You dream it*  
— WE BUILD IT —



Visit [MAXSTEELBUILDINGS.COM](https://www.maxsteelbuildings.com) or use a tablet to scan the QR code to the left to check out our 3D Configurator tool. It can help you design the building of your dreams and obtain a price directly from your nearest dealer!

# ROOF STYLES

## REGULAR

**GOOD**

A Regular roof style on your carport or metal building can provide the protection you need for your vehicles or equipment at an affordable price and in a variety of sizes. Rather than the roof extending out to form an eave on the sides, the ends of each truss are curved downward, which provides additional height without the cost of purchasing taller posts. Because the metal panels run gable-to-gable, they are curved around the frame at the corners, providing additional coverage from the weather.

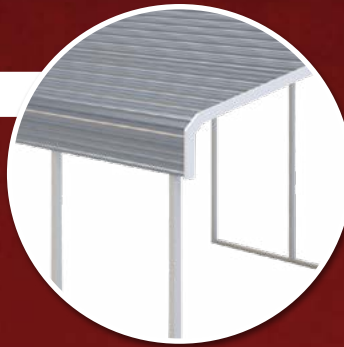

## BOXED EAVE

**BETTER**

Boxed Eave (or "A-frame") roof styles create a more traditional and attractive roof line for your carport or metal structure with only a modest increase in price. Like the Regular style, the metal panels run perpendicular to the roof slope, so they're better for warmer and drier climates that don't require maximum drainage due to harsh weather. Metal Buildings with a Boxed Eave roof also provide 4-6" of overhang on the sides that are finished with boxed trim.

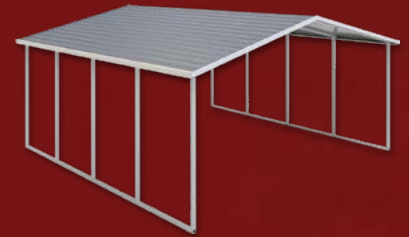

## VERTICAL

**BEST**

A Vertical roof style has the BEST long-term value and is ideal for protecting vehicles and equipment from weather elements. Along with having an attractive and traditional roof line with an eave, the metal panels and ribs run parallel to the slope, creating more efficient drainage and preventing snow load or debris build-up. Steel hat channel is utilized under the metal panels and adds strength to the structure. Vertical style roofs have 4-6" of overhang and are finished with boxed trim on all sides. Vertical Roof design is the best investment to extend the life of your carport roof.

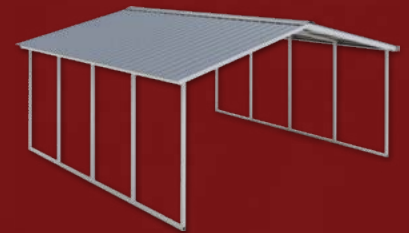

# DESIGN YOUR DREAM BUILDING

## YOU CAN START SIMPLE

Choose a carport or RV cover size that will work as the center structure for your dream building. Choose enough side height to allow for lean-to sides with a 2/12 roof pitch.

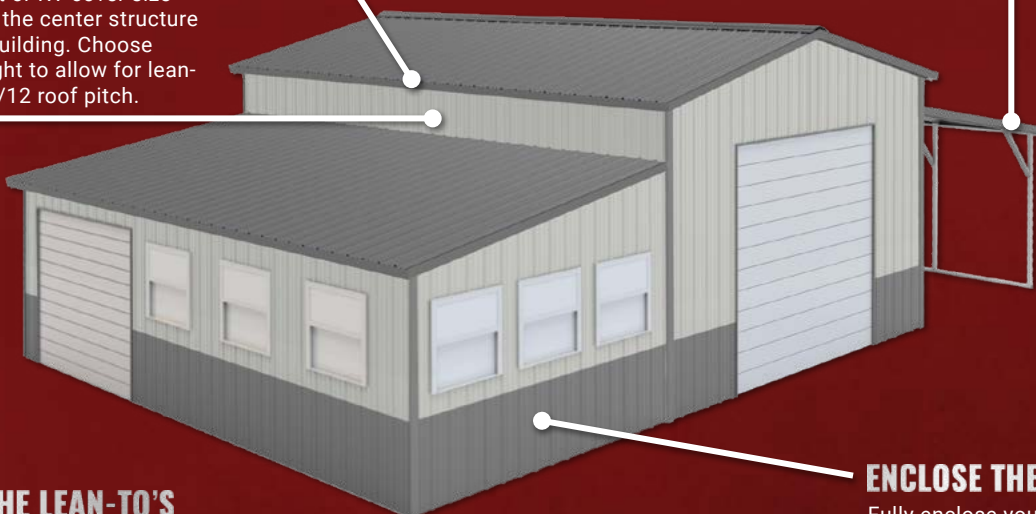

## ADD LEAN-TO'S

Add a lean-to on one or both sides to expand the square footage of your metal building. A lean-to is a great way to increase your covered space for equipment that you don't want to keep in the enclosed area.

## ENCLOSE THE LEAN-TO'S

Enclose the lean-to or both to fully convert your metal garage into the large steel building you've always wanted. At each stage, installation and delivery are free.

## ENCLOSE THE SIDES & ENDS

Fully enclose your MaxSteel Carport to make it a metal garage. Choose from a variety of colors, garage doors, walk-in doors, windows, wainscoting and more.

# CARPORTS

## INCLUDES:

- Frame & roof only

## STANDARD SPECIFICATIONS:

- From 12' to 60' wide
- From 20' to any length
- From 6' to 16' side height
- 14-gauge steel framing
- 29-gauge metal roof panels
- Full bracing (1 per post) on 8' and taller or 22' and wider sizes (unless gabled or closed ends)
- Certification is automatic if installed on ground, concrete or asphalt



Welded Trusses Standard On 24' - 30' wide

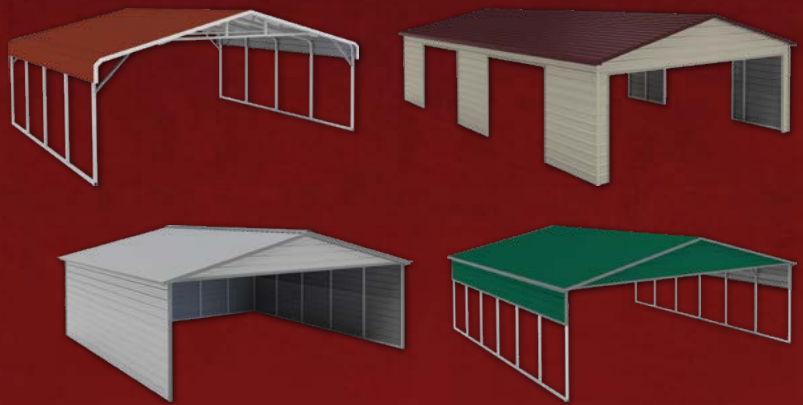

## CARPORT MATERIAL UPGRADES & OPTIONS

12-gauge steel framing | 26-gauge metal panels | Gables | J-Trim  
Premium colors (extended warranty) | Color-matching screws

# CARPORTS WITH STORAGE

## STANDARD SPECIFICATIONS:

- Certification is automatic if installed on ground, concrete or asphalt
- From 6' to 16' side height
- 14-gauge steel framing
- 29-gauge metal roof panels
- Full bracing (1 per post) on 8' and taller or 22' and wider sizes (unless gabled or closed ends)



## CARPORTS WITH STORAGE MATERIAL UPGRADES & OPTIONS

12-gauge steel framing | 26-gauge metal panels | Gables | J-Trim  
Premium colors (extended warranty) | Color-matching screws

# RV COVERS

## STANDARD SPECIFICATIONS:

- From 12' to 30' wide
- From 30' to any length
- From 12' to 16' side height
- 14-gauge steel framing
- 29-gauge metal roof panels
- Full Bracing (1 per post) unless gabled or closed ends
- Certification is automatic if installed on ground, concrete or asphalt

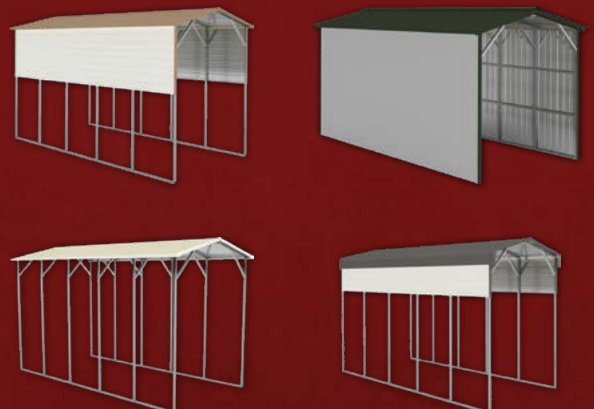

## RV COVER MATERIAL UPGRADES & OPTIONS

Front Gable | 2 Panels On Each Side | Taller Side Height | Extended Gable In Back | Premium Metal & Color Matching Screws  
12-gauge steel framing | 26-gauge metal panels | Premium colors (extended warranty) | Color-matching screws | Gables | J-Trim



# GARAGES

## STANDARD SPECIFICATIONS:

- From 12' to 60' wide
- From 20' to any length
- Minimum 8' side height for Regular roof, Minimum 9' side height for Boxed Eave and Vertical roof
- 14-gauge steel framing
- 29-gauge metal roof panels
- Certification is automatic if installed on ground, concrete or asphalt

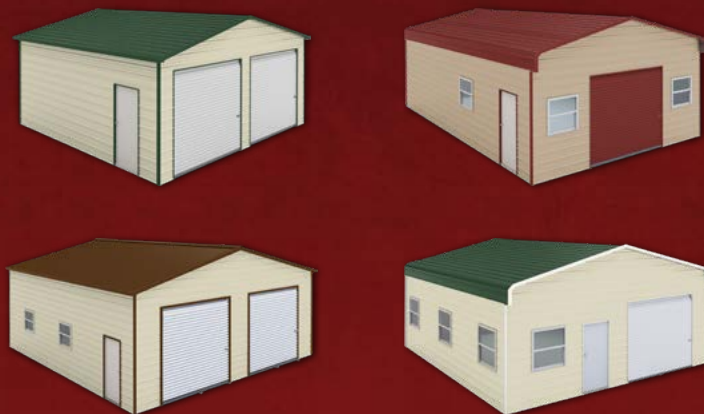

## GARAGE MATERIAL UPGRADES & OPTIONS

12-gauge steel framing | 26-gauge metal panels | Variety of garage door sizes  
Windows and Walk-in Doors | Premium colors (extended warranty) | Color-matching screws

# BARNS

## STANDARD SPECIFICATIONS:

- From 36' to 58' wide
- From 20' to any length
- Center Structure side heights from 9' to 16'
- Lean-to side heights from 6' to 13'
- 14-gauge steel framing
- 29-gauge metal roof panels
- Full bracing (1 per post) on center structure
- Full bracing on lean-to sides if 8' or taller (unless gabled or closed ends)
- Gables
- Horizontal panel orientation only
- Certification is automatic if installed on ground, concrete or asphalt

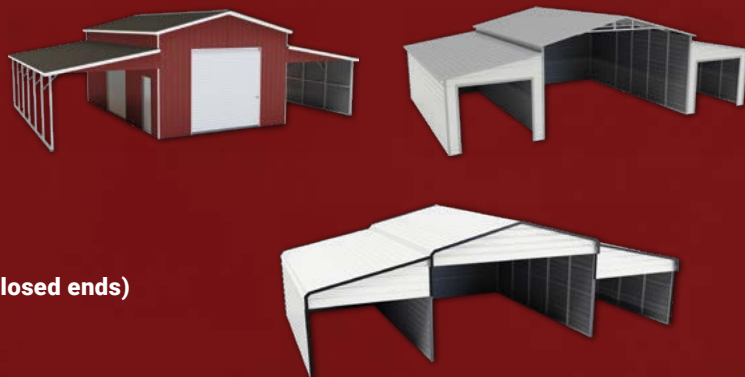

## BARN MATERIAL UPGRADES & OPTIONS

12-gauge steel framing | 26-gauge metal panels | Enclosed sides and/or ends | Garage doors, walk-in doors, windows and frame-outs  
Premium colors (extended warranty) | Color-matching screws | J-Trim

# COMMERCIAL

## STANDARD SPECIFICATIONS:

- From 31' to 40' wide single span
- From 20' to any length
- From 8' to 16' side height
- 14-gauge steel framing
- 29-gauge metal roof panels
- Engineer stamped drawings (generic, e-mailed upon request)
- Full Bracing (1 per post) unless gabled or closed ends
- Concrete anchors (building must be installed on a concrete pad)
- Engineer Certified

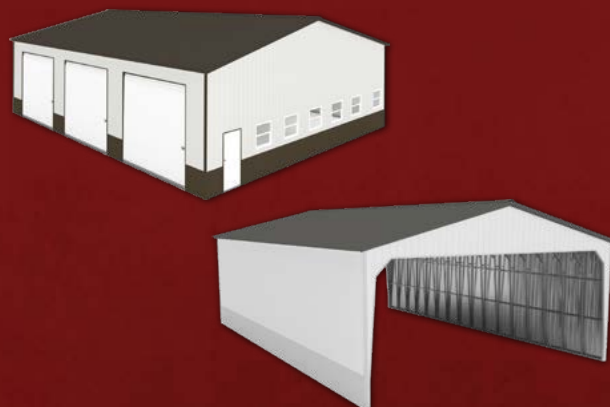

## COMMERCIAL MATERIAL UPGRADES & OPTIONS

12-gauge steel framing | 26-gauge metal panels | Gables | J-Trim  
Coastal Certification (for coastal areas only) | Premium colors (extended warranty) | Color-matching screws

# GREENHOUSES

## STANDARD SPECIFICATIONS:

- One walk-in door
- Standard carport framing
- 9' side height
- MR 9 Clear Panels on the roof, sides, and ends
- Aluminum shutter with cord
- Air exhaust fan with cord
- Variable fan speed control with cord
- Thermostat with cord
- Metal trim and metal wainscot  
(Available in your choice of colors)
- 18" shelving inside on both sides with hardware cloth
- Standard sizes: 8'x10', 10'x15' and 12'x20'

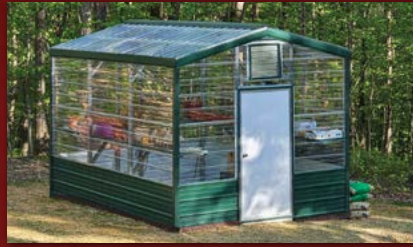

# INDUSTRIAL

## STANDARD SPECIFICATIONS:

- From 41' to 60' wide single span
- From 20' to any length
- From 8' to 16' side height
- 14-gauge steel framing
- 29-gauge metal roof panels
- Engineer stamped drawings (generic, e-mailed upon request)
- Full Bracing (1 per post) unless gabled or closed ends
- Concrete anchors (building must be installed on a concrete pad)
- Engineer Certified

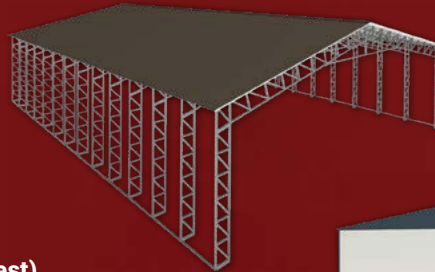

## INDUSTRIAL MATERIAL UPGRADES & OPTIONS

12-gauge steel framing | 26-gauge metal panels | Premium colors (extended warranty) | Color-matching screws | Gables  
J-Trim | Insulation | Coastal Certification (for coastal areas only) | Automatic Garage Door Openers

# COLD FORMED

- Shorter Lead Times
- Quicker Installation
- Reduced Onsite Fabrication
- 20-25% Less Concrete
- No Pre-Set Anchor Bolts



Cold-formed steel can be easily shaped and customized to fit various architectural designs and construction needs. This versatility makes it a popular choice for a wide range of building types, including residential, commercial, industrial, and institutional structures. Not to mention, because cold-formed steel is typically fabricated in a controlled factory environment, it tends to maintain a high level of consistency and quality.



# OPTIONS & ADD ONS



**Astro Armor Insulation**



**Double Bubble Insulation**



**Dripstop Condensation Barrier**



**Garage Door**

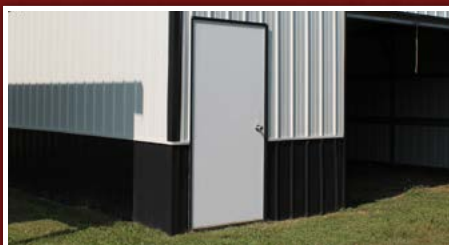

**36"x80" Walk-in Door**



**3'x3' Window**



**Horizontal Wall Panels**



**Horizontal Wainscoting**



**Additional Bows**



**Vertical Wall Panels**

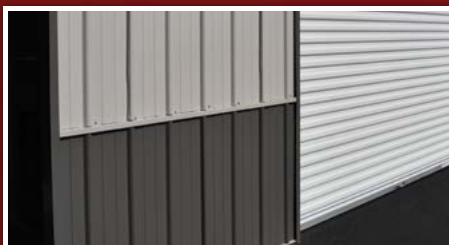

**Vertical Wainscoting**



**Additional Trusses**



**EasyRoller™ Garage Door Opener**



**Gable**

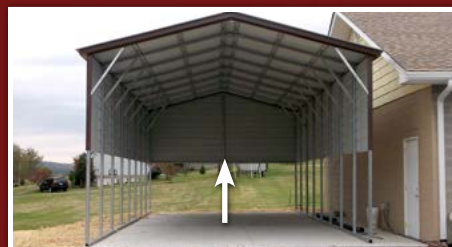

**Extended Gable**

## EXTRAS

**Screws** (Galvanized & Color Matching)

**Premium 40 Year Metal Panels**

**Horizontal Wall Panels**

**Vertical Wall Panels**

**Horizontal Wainscoting**

**Vertical Wainscoting**

**Additional Bows** (Includes two 6' legs) (Up to 16' tall maximum)

**Additional Trusses**

**Gables**

**Extended Gables**

**Connect End to End** (32' - 40' wide)

## INSULATION & CONDENSATION BARRIER

**Astro Armor Insulation**

**Double Bubble Insulation**

**Dripstop Condensation Barrier**

## DOORS & WINDOWS

**Window - 3' x 3'**

**Walk-in Door - 36" x 80"** (Opens Outward)

**Garage Door** (Multiple Sizes Available)

**EasyRoller™ Garage Door Opener**

**Frameouts** (Windows, Walk-in Door & Garage Door)

# FACTS, DISCLAIMERS, MISCELLANEOUS

- MaxSteel Buildings is not responsible for leaks under base rails.
- Interior walls extend up to but not around overhead trusses. Certain styles will have a visible gap up to 2.5" at top between trusses.
- Price includes basic labor. See your local authorized dealer for details.
- Buildings up to 12' tall require 2' level and clear working space around the perimeter of building. Buildings 13' or taller require 4' level and clear working space around perimeter of building.

## LAND/CONCRETE MUST BE LEVEL

- Concrete must be level and square, corner to corner.
- Return trip fees will be applied if building cannot be installed.
- See dealer for possible labor charges.

## CERTIFIED BUILDINGS

Certified buildings offer premier design and the highest quality. We provide certified carports, garages & barns. Generic Engineer stamped drawings are available upon request. Certification may vary depending on county or state regulations.

## WARRANTY

- **90 DAY WORKMANSHIP WARRANTY** on all buildings, effective day of installation.
- **20 YEAR LIMITED WARRANTY** on rust through of metal panels and steel tubing assuming normal user care and maintenance.

## UPGRADE TO PREMIUM 40 YEAR METAL

- **40 YEAR LIMITED WARRANTY** on rust through of metal panels and 20 year limited warranty on rust through of steel tubing assuming normal user care and maintenance.

## LIFTS ARE REQUIRED FOR:

- A building that is 26' or wider AND 13' or taller or
- A building that is 15' or 16' tall or
- A building that is 32' and wider or
- A building with side headers AND is 13' or taller.
- **Material lifts** are required for garage doors 12' x 12' and 12' x 14'.
- The customer is responsible for providing the lift and must have it onsite upon the installer's arrival. All lifts must be approved by MaxSteel Buildings, LLC. For questions regarding lifts, please call (615) 956-7272.



- > Soft credit pull until offer accepted
- > Commercial and residential locations acceptable
- > Flexible terms & quick access
- > Not necessary to own or reside on property
- > No prepayment or cancellation fees
- > Simple application process
- > Turns large projects into affordable monthly payments
- > No impact on credit to see if customers qualify
- > Terms may vary with lender

- > 90 Days Same As Cash
- > 36, 48, 60 or 72 Month Payment Options
- > Low Security Deposit
- > Low monthly payments
- > Maximum Rent to Own Price is \$25,000

Our buildings are made of the finest materials and superior quality. From order to install, our skilled dealers focus on providing customers with excellent service and products. Our customers deserve the best and we strive to ensure every project meets that level of satisfaction.