

PROJECT
WORLD BIRDING CENTER
ESTERO LLANO GRANDE STATE PARK
ROOF REPLACEMENT

PROJECT NO: MR10071

DATE: MAY 5, 2020

INDEX OF DRAWINGS

SHEET NO.	DESCRIPTION
-	COVER SHEET
A0	ABBREVIATIONS, NOTES AND SUBMITTALS
A1	ROOF PLAN & PHOTOS
A2	ROOF DETAILS
S1	STRUCTURAL PLAN, SECTION AND DETAILS

BUILDING CODE SUMMARY

- A. INTERNATIONAL CODE COUNCIL ADOPTIONS*
 - 1. BUILDING CODE INTERNATIONAL BUILDING CODE 2015
 - 2. STRUCTURAL CODE INTERNATIONAL BUILDING CODE 2015
 - 3. PLUMBING CODE INTERNATIONAL PLUMBING CODE 2015
 - 4. MECHANICAL CODE INTERNATIONAL MECHANICAL CODE 2015
 - 5. GAS CODE INTERNATIONAL FUEL GAS CODE 2015
 - 6. RESIDENTIAL CODE INTERNATIONAL RESIDENTIAL CODE 2015
 - 7. EXISTING BUILDINGS INTERNATIONAL EXISTING BUILDINGS CODE 2015
- * International Fire Code omitted in lieu of TPWD's implementation of National Fire Protection Association codes. International Energy Conservation Code 2015 omitted in lieu of Energy Standard for Buildings, ASHRAE/IESNA Standard 90.1 (2013).
- B. NATIONAL FIRE PROTECTION ASSOCIATION
 - 1. ELECTRIC CODE NATIONAL ELECTRICAL CODE NFPA-70 2017
 - 2. FIRE CODE NFPA - 1 2015
 - 3. LIFE SAFETY CODE NFPA - 101 2015
- C. STATE ENERGY CONSERVATION OFFICE (SECO)/TEXAS COMPTROLLERS OFFICE
 - 1. ENERGY CODES FOR STATE BUILDINGS - See Energy Conservation Design Standards: Texas Administrative Code, Title 34, Part 1, Ch.19, Subchapter C
 - a. COMPLIANCE WITH THE ENERGY CONSERVATION DESIGN STANDARD OF THE AMERICAN SOCIETY OF HEATING, REFRIGERATION AND AIR CONDITIONING ENGINEERS (ASHRAE) /ILLUMINATING ENGINEERING SOCIETY OF NORTH AMERICA (IESNA), ENERGY STANDARD FOR BUILDINGS, ASHRAE/IESNA STANDARD 90.1 (2013)
 - See SECO website for State Funded Buildings, New Construction and Major Renovation Requirements and SECO Compliance Certification Forms
 - 2. WATER CONSERVATION STANDARDS FOR STATE BUILDINGS - Energy Conservation Design Standards: Texas Administrative Code, Title 34, Part 1, Ch.19, Subchapter c
 - a. COMPLIANCE WITH THE WATER CONSERVATION DESIGN STANDARDS FOR STATE BUILDINGS AND INSTITUTIONS OF HIGHER EDUCATION FACILITIES, STATE ENERGY CONSERVATION OFFICE (SECO), 2016
 - See SECO website for Texas Water Conservation Design Standards, Requirements and SECO Compliance Certification / Reporting Form
- D. ACCESSIBILITY CODES
 - 1. US DEPT. OF JUSTICE, 2010 ADA STANDARDS FOR ACCESSIBLE DESIGN
 - 2. ARCHITECTURAL BARRIERS ACT ACCESSIBILITY GUIDELINES; OUTDOOR DEVELOPED AREAS, NOVEMBER 25, 2013
 - 3. 2012 TEXAS ACCESSIBILITY STANDARDS, ELIMINATION OF ARCHITECTURAL BARRIERS, TEXAS GOVERNMENT CODE, CHAPTER 469
- E. PLAYGROUND SAFETY CODE
 - 1. ASTM F1487-17, STANDARD CONSUMER SAFETY PERFORMANCE SPECIFICATIONS FOR PLAYGROUND EQUIPMENT FOR PUBLIC USE
 - 2. ASTM F2223-15, STANDARD GUIDE FOR ASTM STANDARDS ON PLAYGROUND SURFACING

SCOPE OF WORK

CONTRACTOR SHALL FURNISH ALL LABOR, EQUIPMENT, TOOLS, MATERIALS, AND INCIDENTALS NECESSARY TO REMOVE THE EXISTING ROOF TO EXISTING TRUSSES, INSTALL NEW ROOF, AND MAKE STRUCTURAL REPAIRS AT THE BUNKHOUSE BUILDING AT ESTERO LLANO GRANDE STATE PARK.

RELEASED FOR SOLICITATION

Tony Bettis 5/6/2020
 PROJECT MANAGER, INFRASTRUCTURE DIVISION DATE

DESIGN BRANCH MANAGER, INFRASTRUCTURE DIVISION DATE

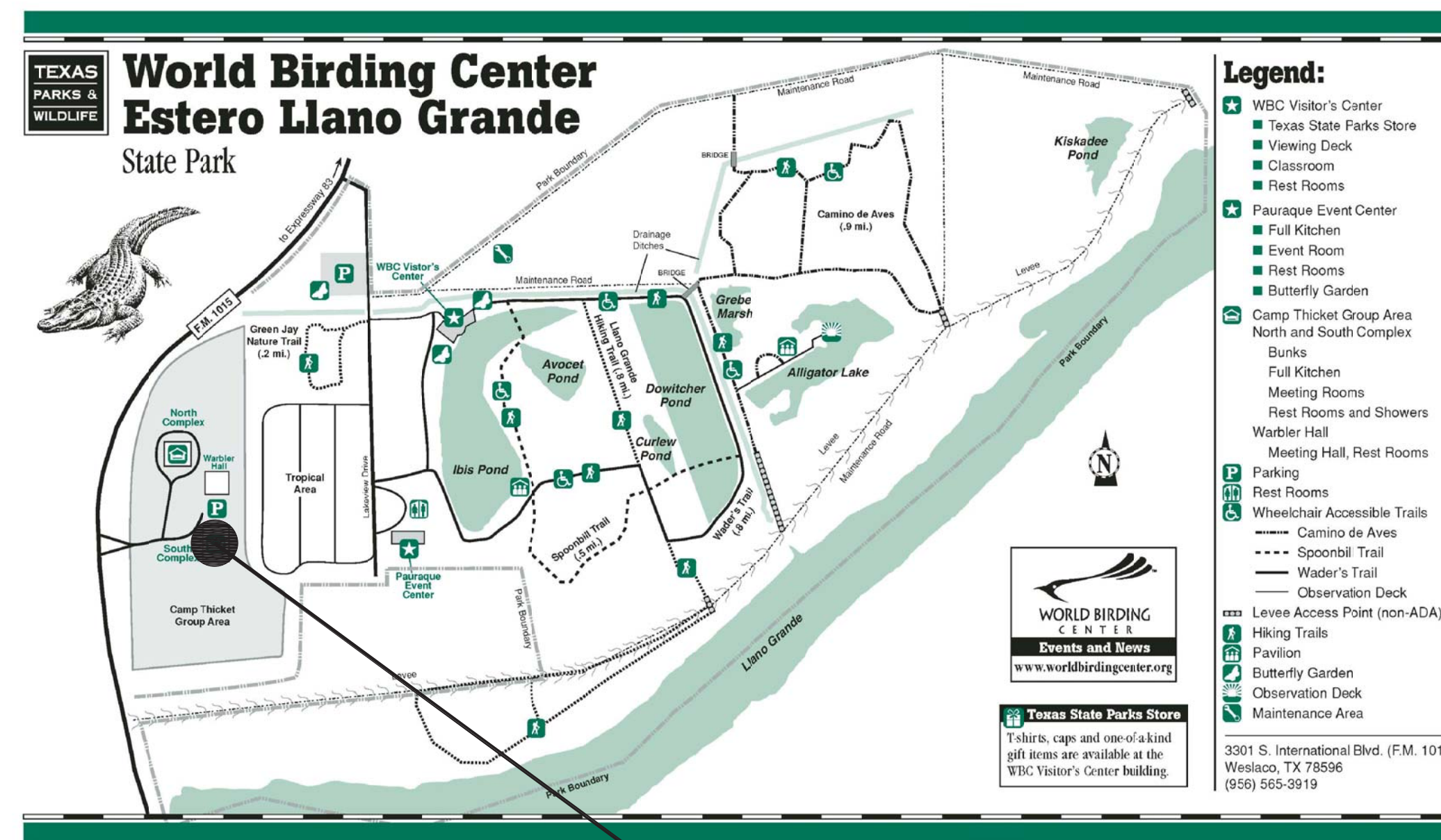
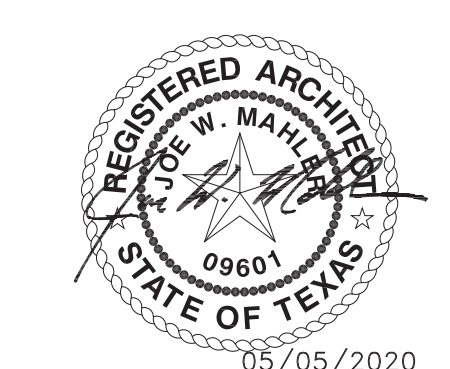

PROJECT SITE

SITE LOCATION MAP
 NOT TO SCALE

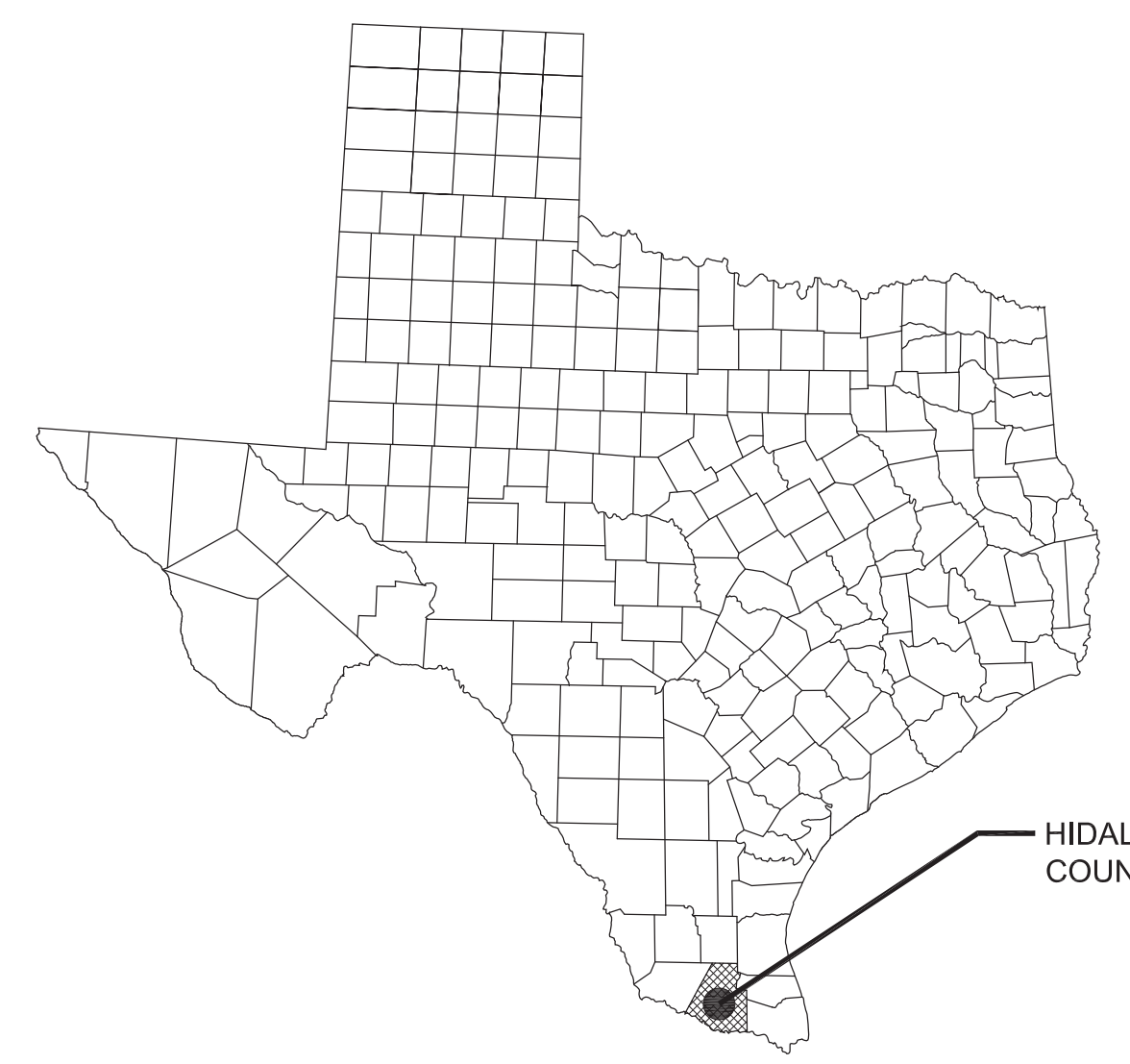
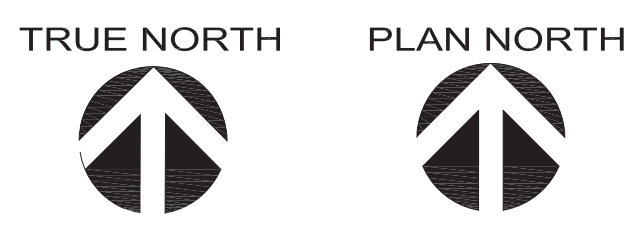

COUNTY LOCATION MAP
 NOT TO SCALE

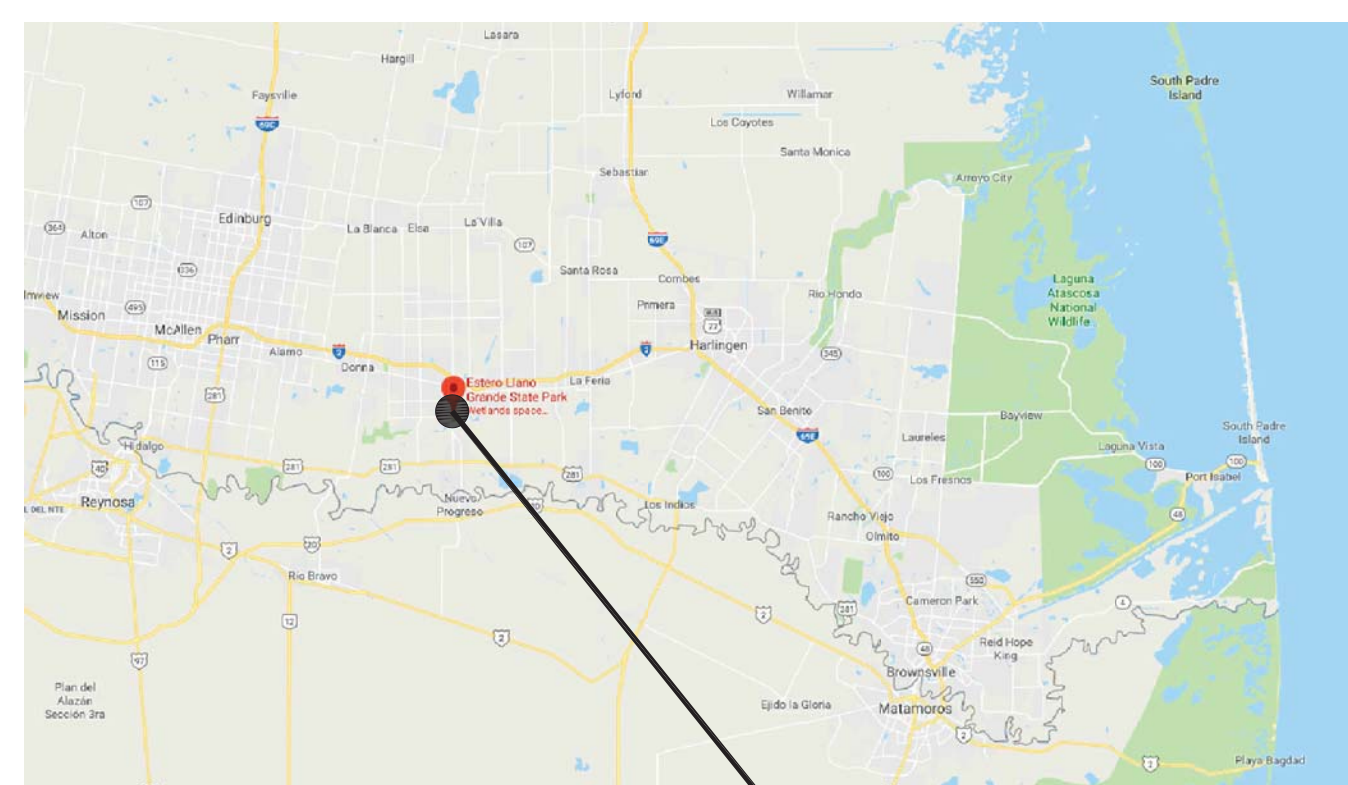

PROJECT SITE

VICINITY MAP
 NOT TO SCALE



TPWD TEAM

PROJECT MANAGER Tony Bettis Texas Parks & Wildlife 512-389-8382 512-389-4790 tony.bettis@tpwd.texas.gov	DESIGN MANAGER Quana Childs Texas Parks & Wildlife 512-389-8710 512-389-4790 quana.childs@tpwd.texas.gov	INSPECTOR TBD Texas Parks & Wildlife	PARK SUPERINTENDENT Javier de Leon Texas Parks and Wildlife 956-656-3919 javier.deleon@tpwd.texas.gov
CONTRACT MANAGER JoAnn Hernandez Texas Parks & Wildlife 512-389-4347 512-389-4790 joann.hernandez@tpwd.texas.gov	CONSTRUCTION MANAGER Williams Ramos Texas Parks & Wildlife 512-627-4179 william.ramos@tpwd.texas.gov		

DESIGN TEAM

ARCHITECT Raluca Zamfir PDG Architects 713-629-6100 713-629-6123 (fax) rzamfir@pdgarchitects.com
--



TEXAS PARKS AND WILDLIFE
INFRASTRUCTURE DIVISION

4200 SMITH SCHOOL ROAD · AUSTIN, TEXAS 78744-3292

ABBREVIATIONS

ACOST	ACOUSTICAL	LAM	LAMINATE
AFF	ABOVE FINISHED FLOOR	LAV	LAVATORY
ADD	ADDITION	LB	POUND
ADJ	ADJUSTABLE	LBL	LABEL
A/C	AIR CONDITIONING	LWT	LIGHTWEIGHT
ALT	ALTERNATE		
ALUM	ALUMINUM	MACH	MACHINE
APPROX	APPROXIMATE	MAINT	MAINTENANCE
APPVD	APPROVED	MATL	MATERIAL
ARCH	ARCHITECT	MAX	MAXIMUM
AVE	AVENUE	MBR	MEMBER
		MC	MEDICINE CABINET
BD	BOARD	MECH	MECHANICAL
BETW	BETWEEN	MEP	MECHAN/ELECT/PLMB
BLDG	BUILDING	MFR	MANUFACTURER
BLKG	BLOCKING	MGR	MANAGER
BM	BEAM OR BENCH MARK	MIN	MINIMUM
BOT	BOTTOM	MISC	MISCELLANEOUS
BRZ	BRONZE	MK	MARK
BSMT	BASEMENT	MLDG	MOULDING
		MO	MASONRY OPENING
		MSRY	MASONRY
C TO C	CENTER TO CENTER	MTD	MOUNTED
CAB	CABINET	MTL	METAL
CER	CERAMIC	MUL	MULLION
CJ	CONSTRUCTION JOINT/ CONTROL JOINT	MW	MICROWAVE
CL	CENTER LINE		
CLG	CEILING	NIC	NOT IN CONTRACT
CLR	CLEAR	NO	NUMBER
CLOS	CLOSET	NOM	NOMINAL
CMU	CONCRETE MASONRY UNIT	NTS	NOT TO SCALE
		OA	OVERALL
CO	CLEANOUT	OC	ON CENTER
COL	COLUMN	OD	OUTSIDE DIAMETER
CONC	CONCRETE	OH	OPPOSITE HAND
CONSTR	CONSTRUCTION	OPNG	OPENING
CONT	CONTINUOUS	OPP	OPPOSITE
CONTD	CONTINUED	ORIG	ORIGINAL
CONTR	CONTRACTOR	OVHD	OVERHEAD
CONTR	CONTRACTING	OZ	OUNCE
COOR	OFFICER'S REPRESENTATIVE		
CTR	CENTER	PART	PARTIAL
CW	COLD WATER	PART BD	PARTICLE BOARD
		PL	PROPERTY LINE
DBL	DOUBLE	PLAM	PLASTIC LAMINATE
DET	DETAIL	PLMB	PLUMBING
DF	DRINKING FOUNTAIN	PLYWD	PLYWOOD
DIA	DIAMETER	PREFAB	PREFABRICATED
DIAG	DIAGONAL	PR	PAIR
DIM	DIMENSION	PROP	PROPERTY
DIV	DIVISION	PSI	POUNDS PER SQ IN
DEMO	DEMOLITION	PTD	PAINTED
DN	DOWN		
DR	DOOR	RA	RETURN AIR
DS	DOWNSPOUT	RAD	RADIUS
DWG	DRAWING	RAG	RETURN AIR GRILL
DWR	DRAWER	RE	REFER
		REC	RECESSED
EA	EACH	RECEPT	RECEPTACLE
ELEV	ELEVATION	RECT	RECTANGULAR
ELEC	ELECTRICAL	RELOC	RELOCATED
ENCL	ENCLOSURE	REQD	REQUIRED
ENGR	ENGINEER	REP	REPRESENTATIVE
EQ	EQUAL	RESIL	RESILIENT
EQUIP	EQUIPMENT	REV	REVISION
ETC	AND SO FORTH	RH	RIGHT HAND
EWC	ELECTRIC WATER COOLER	RM	ROOM
		RND	ROUND
		RO	ROUGH OPENING
		RTN	RETURN
EXH	EXHAUST		
EXTG	EXISTING	SC	SOLID CORE
EXP	EXPOSED	SCHED	SCHEDULE
EXT	EXTERIOR	SECT	SECTION
FD	FLOOR DRAIN	SEQ	SEQUENCE
FE	FIRE EXTINGUISHER	SF	SQUARE FEET
FEC	FIRE EXTINGUISHER CABINET	SGL	SINGLE
FED	FEDERAL	SH	SHEET
FF	FINISHED FLOOR	SIM	SIMILAR
FV	FIELD VERIFY	SPEC	SPECIFICATION
		SQ	SQUARE
FHC	FIRE HOSE CABINET	SS	STAINLESS STEEL
FL	FLOW LINE	STD	STANDARD
FLR	FLOOR	STL	STEEL
FRPF	FIREPROOF	STOR	STORAGE
FR	FRAME	STRUCT	STRUCTURAL
FTG	FOOTING	SURF	SURFACE
FURR	FURRING	SUSP	SUSPENDED
FW	FIRE WALL		
FXTR	FIXTURE	TECH	TECHNICAL
		TELE	TELEPHONE
GA	GAUGE	THK	THICK (NESS)
GALV	GALVANIZED	THRU	THROUGH
GEN	GENERAL	TYP	TYPICAL
GFE	GOVERNMENT FURNISHED EQUIPMENT		
GFM	GOVERNMENT FURNISHED MATERIAL	UNFIN	UNFINISHED
		UNO	UNLESS NOTED OTHERWISE
GL	GLASS		
GOVT	GOVERNMENT	VENT	VENTILATE
GRL	GRILLE	VERT	VERTICAL
GYP	GYP SUM	VCT	VINYL COMPOSITION TILE
GYP BD	GYP SUM BOARD	VET	VINYL ENHANCED TILE
GC	GENERAL CONTRACTOR	VOL	VOLUME
		VVC	VINYL WALLCOVERING
HDWR	HARDWARE	WD	WOOD
HM	HOLLOW METAL	WH	WATER HEATER
HORIZ	HORIZONTAL	WHSE	WAREHOUSE
HT	HEIGHT	WP	WATERPROOF
HTR	HEATER	W	WITH
HWD	HARDWOOD	W/O	WITHOUT
HVAC	HEATING, VENTILATING, AND AIR CONDITIONING	WT	WEIGHT
HW	HOT WATER		
HHW	HOT WATER HEATER	YD	YARD
ID	INSIDE DIAMETER		
INSUL	INSULATION		
INTR	INTERIOR		
JAN	JANITOR		
JT	JOINT		

DRAWING SYMBOL LEGEND

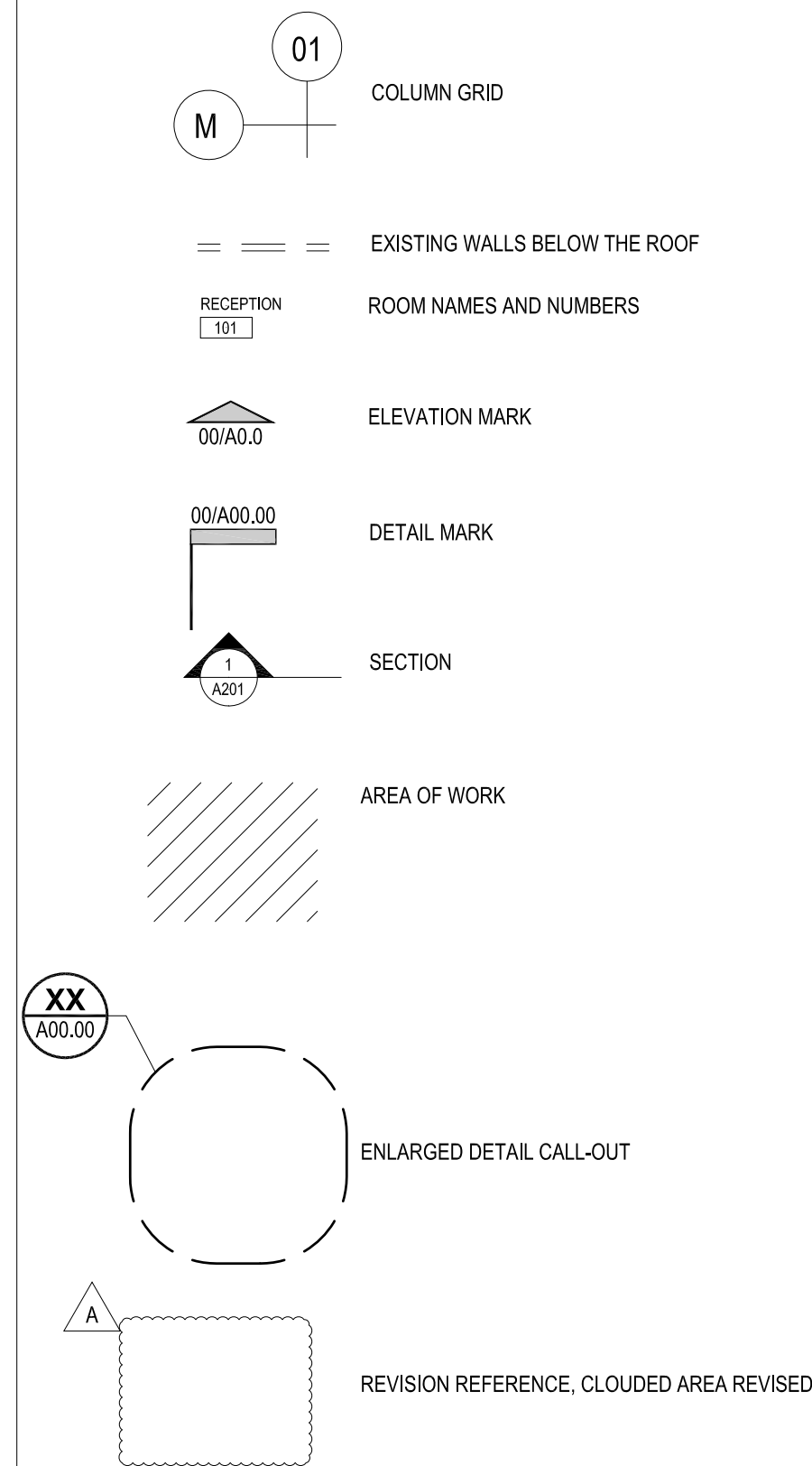

GENERAL DEMOLITION NOTES

1. ANY ITEM WHICH IS DESIGNATED TO REMAIN AND IS LOST OR DAMAGED DURING CONSTRUCTION SHALL BE REPLACED BY THE CONTRACTOR AT NO ADDITIONAL COST TO THE OWNER.
2. PROMPTLY REPAIR ADJACENT SURFACES DAMAGED BY DEMOLITION OPERATIONS.
3. REMOVE DEMOLISHED MATERIALS AND DEBRIS FROM THE SITE IN A MANNER APPROVED BY THE PROJECT MANAGER. TRANSPORT AND LEGALLY DISPOSE OFF MATERIALS AT AN APPROVED OFF SITE LOCATION.
4. UPON COMPLETION OF DEMOLITION WORK, REMOVE TOOLS, EQUIPMENT AND MATERIALS FROM SITE. REMOVE PROTECTIONS AND LEAVE SITE CLEAN.
5. REFER TO SPECIFICATIONS FOR ADDITIONAL REQUIREMENTS.

EXISTING MATERIALS NOTES

MAINTENANCE BUILDING

1. EXISTING ROOF IS EXPOSED FASTENER METAL PANEL ON WOOD PURLINS.
2. EXISTING FLASHING MATERIAL IS GALVANIZED METAL.
3. EXISTING EXTERIOR WALL CLADDING IS METAL WALL PANELS, WOOD SIDING AND EXPOSED CMU.
4. EXISTING ROOF INSULATION IS BATT INSULATION.

EXISTING CONDITIONS

1. CONTRACTOR SHALL VERIFY ALL EXISTING DIMENSIONS, ELEVATIONS, SLOPES, AREAS, AND CONDITIONS. DIMENSIONS AND AREAS SHOWN ON THE DRAWINGS ARE APPROXIMATE.
2. DRAWINGS IN THIS SET ARE NOT TO BE CONSIDERED MEASURED DRAWINGS OF AS-CONSTRUCTED CONDITIONS.
3. FIELD MEASUREMENTS WILL BE REQUIRED TO COMPLETE THE WORK. THE CONTRACTOR SHALL OBTAIN ALL FIELD MEASUREMENTS AS NECESSARY TO FABRICATE ITEMS OF WORK AND TO COMPLETE THE WORK DEPICTED IN THE CONSTRUCTION DOCUMENTS.
4. IF CONDITIONS ARE ENCOUNTERED WHICH DIFFER FROM CONDITIONS SHOWN OR SPECIFIED IN THE CONSTRUCTION DOCUMENTS, TO INCLUDE BUT NOT BE LIMITED TO DETERIORATED MATERIALS, OR DIFFERENT CONCEALED MATERIALS, CONTRACTOR SHALL NOTIFY THE OWNER'S REPRESENTATIVE FOR CLARIFICATION AND SHALL NOT PROCEED WITH ADDITIONAL WORK WITHOUT WRITTEN AUTHORIZATION.

PROPOSED MATERIALS NOTES

MAINTENANCE BUILDING

1. NEW ROOFING MATERIAL SHALL BE STANDING SEAM METAL PANEL.
2. NEW RAKE, EAVE FLASHING SHALL BE PRE-FINISHED STEEL. COLOR TO MATCH ROOFING PANEL.
3. NEW GUTTERS AND DOWNSPOUTS MATERIAL AND COLOR TO MATCH ROOFING PANEL.
4. NEW ROOFING TO BE BE CAPABLE OF RESISTING WIND SPEED OF Vultm 130 mph (RISK CATEGORY II, Exposure C) PER ASCE/ SEI 7-10.
5. REFER TO SPECIFICATIONS FOR ADDITIONAL INFORMATION.

SUBMITTALS TABLE

REQUIRED SUBMITTALS PRIOR TO INSTALLATION

MATERIAL/ PRODUCT	MANUF'S PRODUCT INFO	INSTALLATION INSTRUCTIONS	SAFETY DATA SHEETS	SAMPLE	LEGIBLE PHOTO OF THE MATERIAL	SHOP DRAWINGS AND/OR MFG'S DETAILS	MANUF'S SAMPLE WARRANTY	OTHER /NOTES
STRUCTURAL STANDING SEAM MTL PANEL	●	●	●	●		●	●	SAMPLES TO PARK FOR APPROVAL
CLIPS FOR MTL PANEL ROOF	●	●				●		
FASTENERS FOR METAL PANELS	●	●				●		
FLASHING	●	●				●		
BATT INSULATION	●	●						
ROUGH CARPENTRY-LUMBER	●							
FASTENERS FOR CARPENTRY	●	●						
CAULKS	●	●						
ADHESIVES	●	●						
METAL FRAMING ANCHORS, EACH TYPE	●	●						
FASTENERS FOR METAL FRAMING ANCHORS	●	●						
CEILING TILE	●			●				

- NOTES:
1. SUBMIT WITH SIGNED TPWD SUBMITTAL COVERSHEET.
 2. SUBMIT EITHER INDIVIDUAL SUBMITTALS PER EACH ITEM, OR A COMBINED SUBMITTAL PER EACH LINE ITEM.
 3. A SUBMITTAL IS REQUIRED PER EACH ITEM NOTED. IF CONTRACTOR HAS DIFFICULTY OBTAINING INFORMATION FOR AN ITEM, PLEASE NOTIFY ARCHITECT.

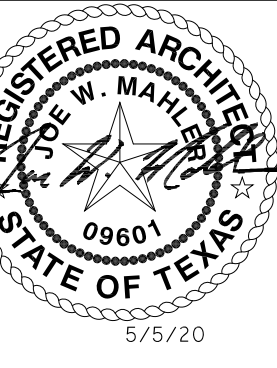

WORLD BIRDING CENTER
ESTERO LLANO GRANDE STATE PARK
ROOF REPLACEMENT
PROJECT NUMBER: MR10071

DATE: 5-5-2020
 DESIGN BY: RZ
 DRAWN BY: RZ
 REVIEW BY: JWB
 REVISED:
 REVISED:
 REVISED:

SHEET TITLE
ABBREVIATIONS,
NOTES &
SUBMITTALS

SHEET NUMBER
A0

SEE CLEARER PHOTOS
IN BID DOCUMENTS



E ROOF VIEW AT EXISTING VENT THROUGH ROOF



D ROOF VIEW AT SLOPE TRANSITION FLASHING



C WEST VIEW OF BUNKHOUSE



B EAST VIEW OF BUNKHOUSE



A SOUTH VIEW OF BUNKHOUSE

SCALE:
N.T.S.

BUNKHOUSE PHOTOS 03

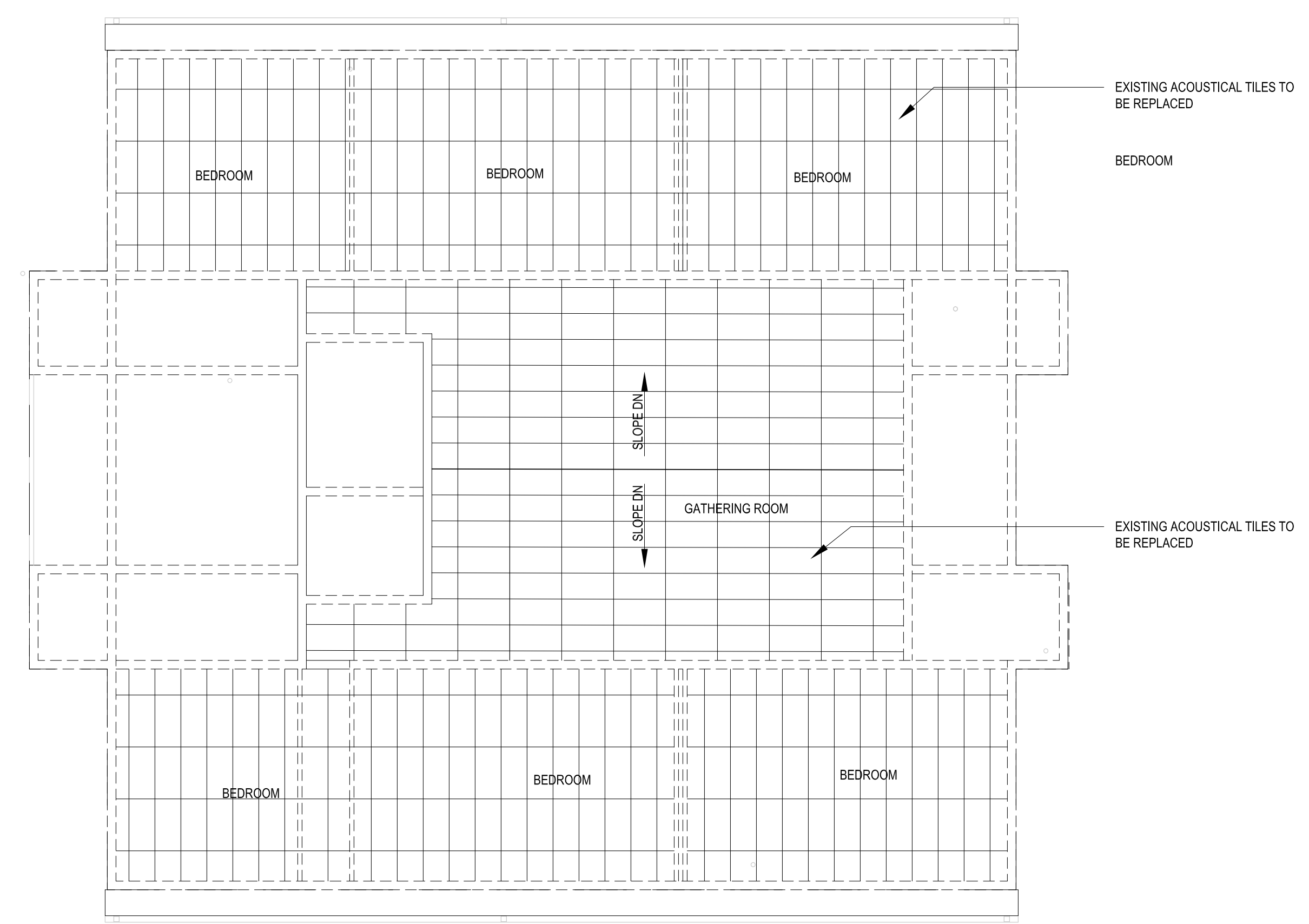

- SCOPE OF WORK:
1. REMOVE AND REPLACE EXISTING ACOUSTICAL CEILING TILES IN THE BEDROOMS AND GATHERING ROOM.
 2. EXISTING CEILING GRID TO REMAIN. REPAIR OR REPLACE SECTIONS OF GRID DAMAGED DURING CONSTRUCTION ACTIVITIES.
 3. REPLACE EXISTING INSULATION LAYING IN TOP OF EXISTING CEILING TILES.

0 SCALE: 8'-0"
1/8" = 1'-0"

BUNKHOUSE REFLECTED CEILING PLAN 02

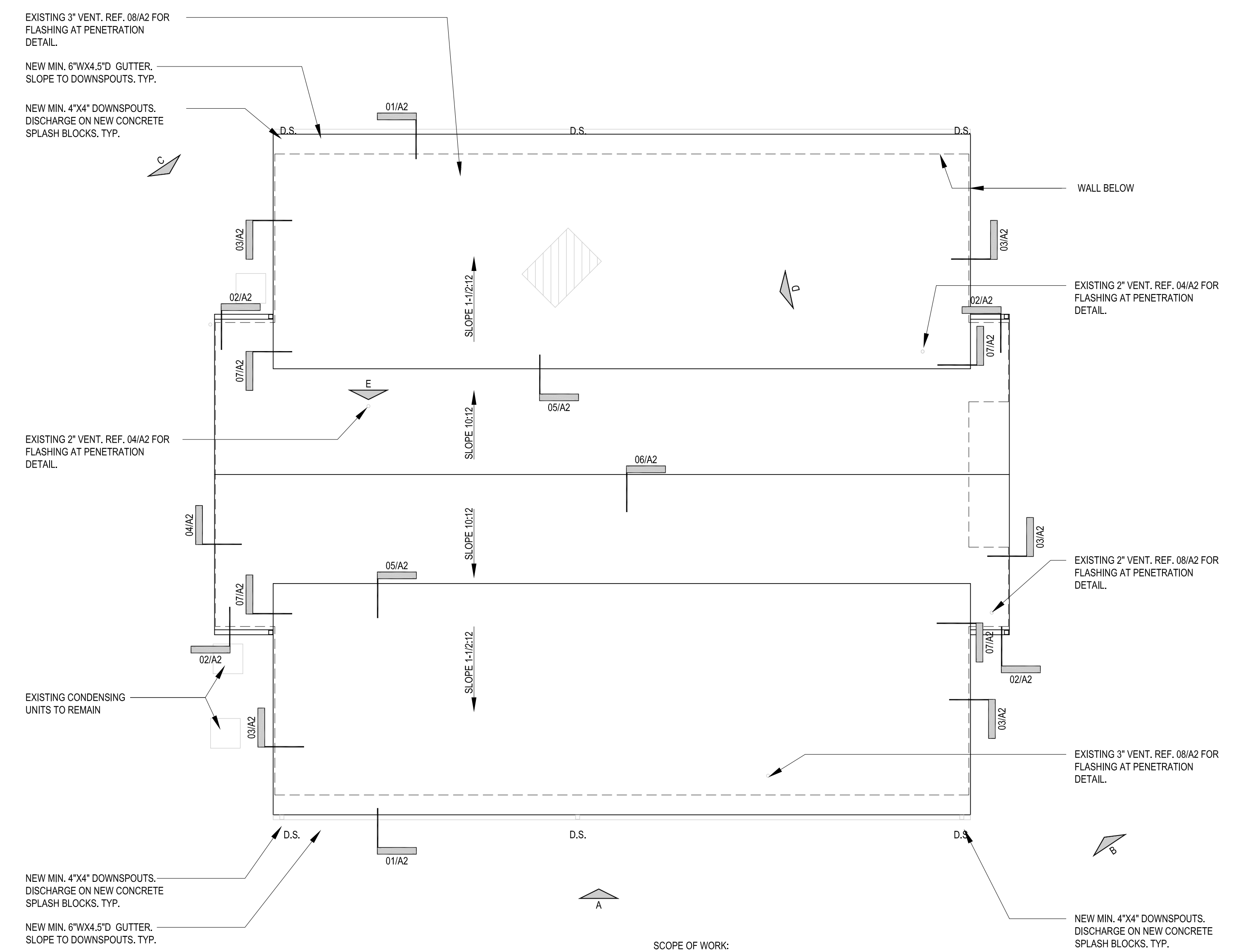

- EXISTING 3" VENT. REF. 08/A2 FOR FLASHING AT PENETRATION DETAIL.
- NEW MIN. 6"WX4.5"D GUTTER. SLOPE TO DOWNSPOUTS. TYP.
- NEW MIN. 4"x4" DOWNSPOUTS. DISCHARGE ON NEW CONCRETE SPLASH BLOCKS. TYP.
- EXISTING 2" VENT. REF. 04/A2 FOR FLASHING AT PENETRATION DETAIL.
- EXISTING 2" VENT. REF. 04/A2 FOR FLASHING AT PENETRATION DETAIL.
- EXISTING CONDENSING UNITS TO REMAIN
- EXISTING 2" VENT. REF. 08/A2 FOR FLASHING AT PENETRATION DETAIL.
- EXISTING 3" VENT. REF. 08/A2 FOR FLASHING AT PENETRATION DETAIL.
- NEW MIN. 4"x4" DOWNSPOUTS. DISCHARGE ON NEW CONCRETE SPLASH BLOCKS. TYP.
- NEW MIN. 6"WX4.5"D GUTTER. SLOPE TO DOWNSPOUTS. TYP.

APPROXIMATE ROOF AREAS (SQFT.)	
ROOF NAME	PLAN AREA
METAL PANEL	5,208

- SCOPE OF WORK:
1. MAKE STRUCTURAL REPAIRS OF THE ROOF SUPPORT SYSTEM. REF. S1.
 2. REMOVE AND DISCARD EXISTING ROOF PANELS.
 3. INSTALL NEW STANDING SEAM METAL PANEL COMPLETE WITH ALL TRIM AND FLASHING INDICATED.

0 SCALE: 8'-0"
1/8" = 1'-0"

BUNKHOUSE ROOF PLAN 01

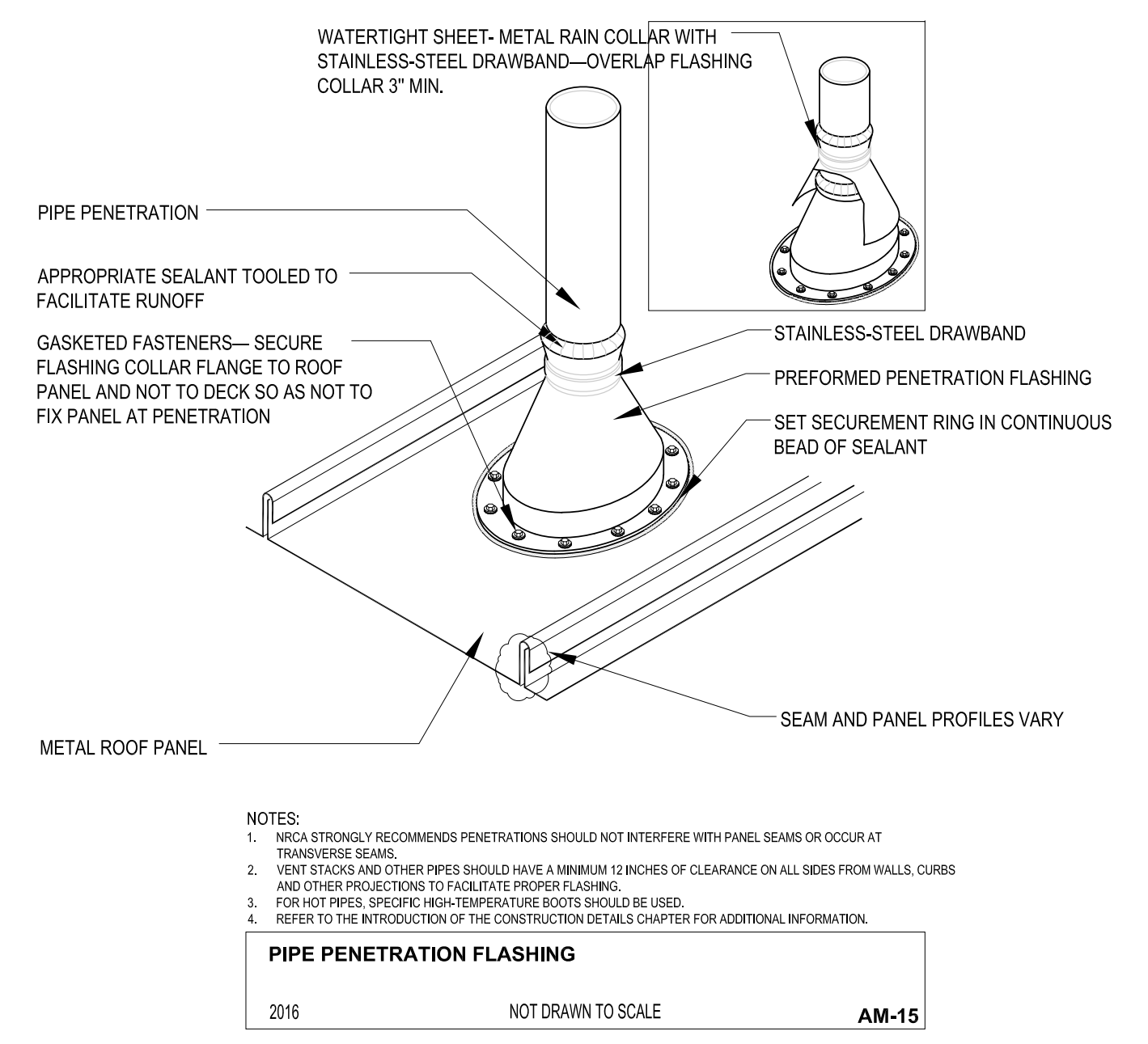

SCALE: N.T.S. PENETRATION DETAIL 08

NOTES:
1. DETAILS ARE FROM NATIONAL ROOFING CONTRACTOR'S ASSOCIATION U.N.O.
2. FOLLOW INSTALLATION DETAILS AND GUIDELINES FROM ROOFING PRODUCT MANUFACTURER.
3. IF DETAILS DO NOT EXIST FOR A PARTICULAR SITUATION, CONTACT ARCHITECT BEFORE PROCEEDING.

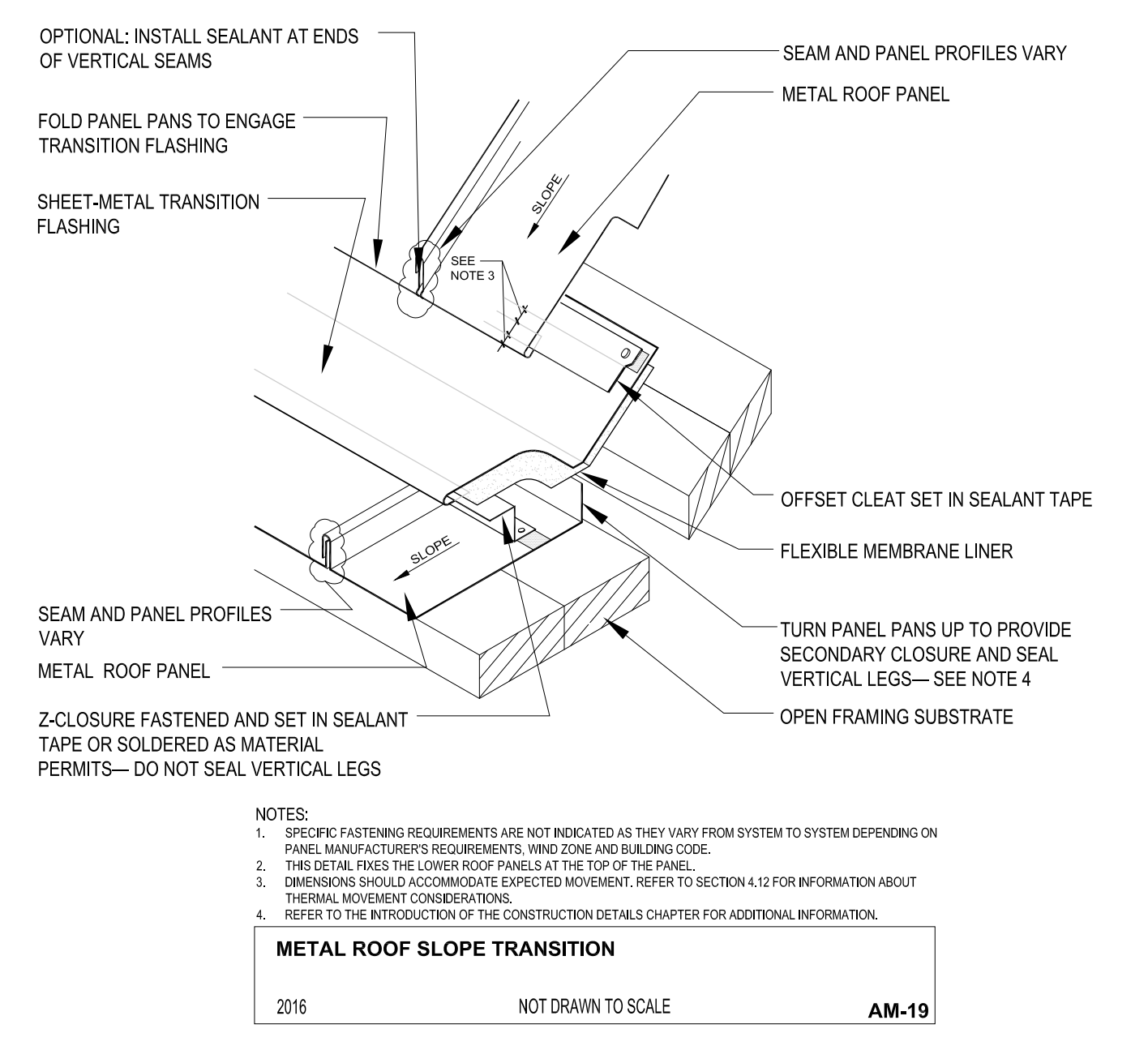

SCALE: N.T.S. SLOPE TRANSITION DETAIL 05

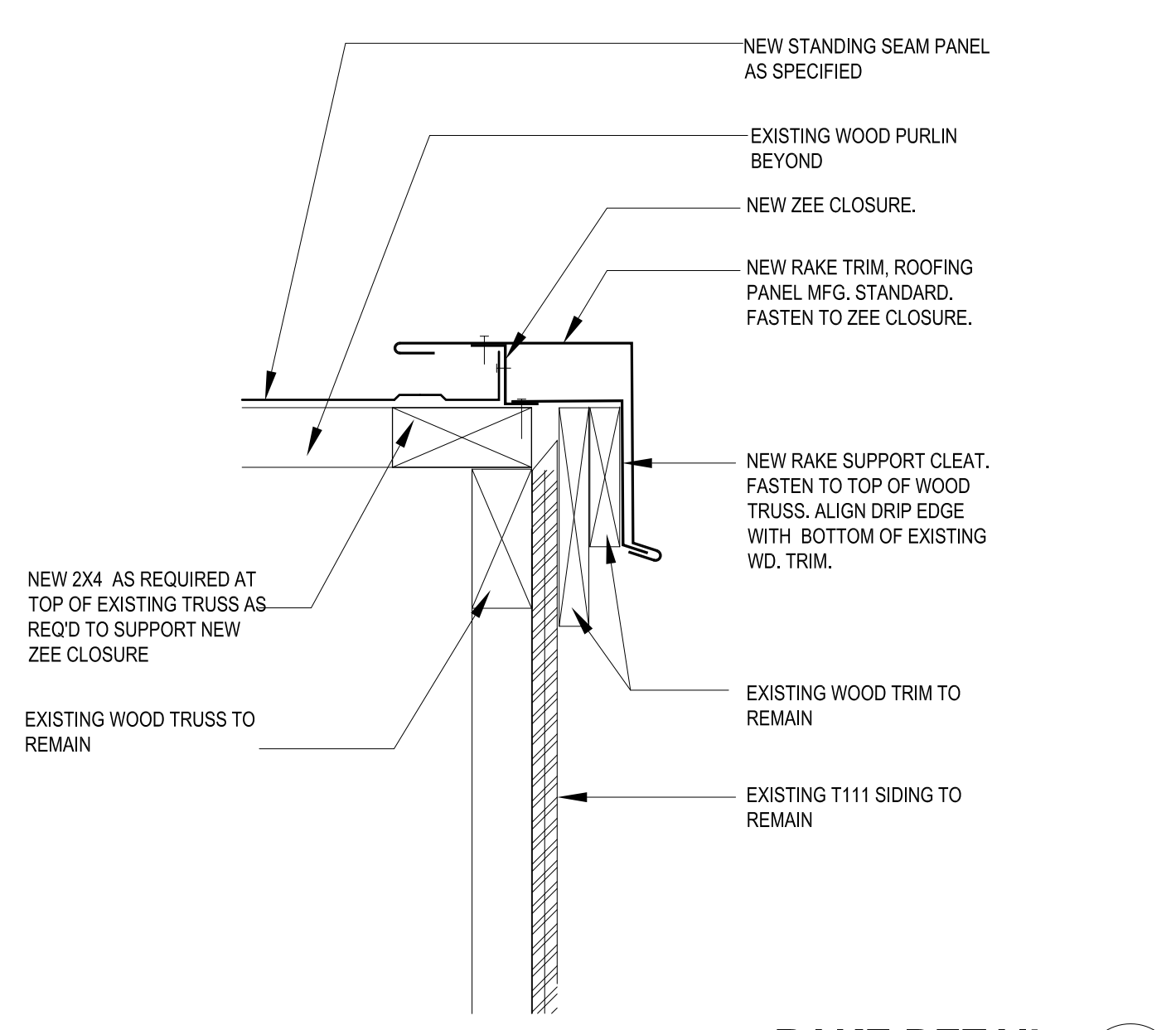

SCALE: 4" = 1'-0" RAKE DETAIL AT T-111 SIDING 04

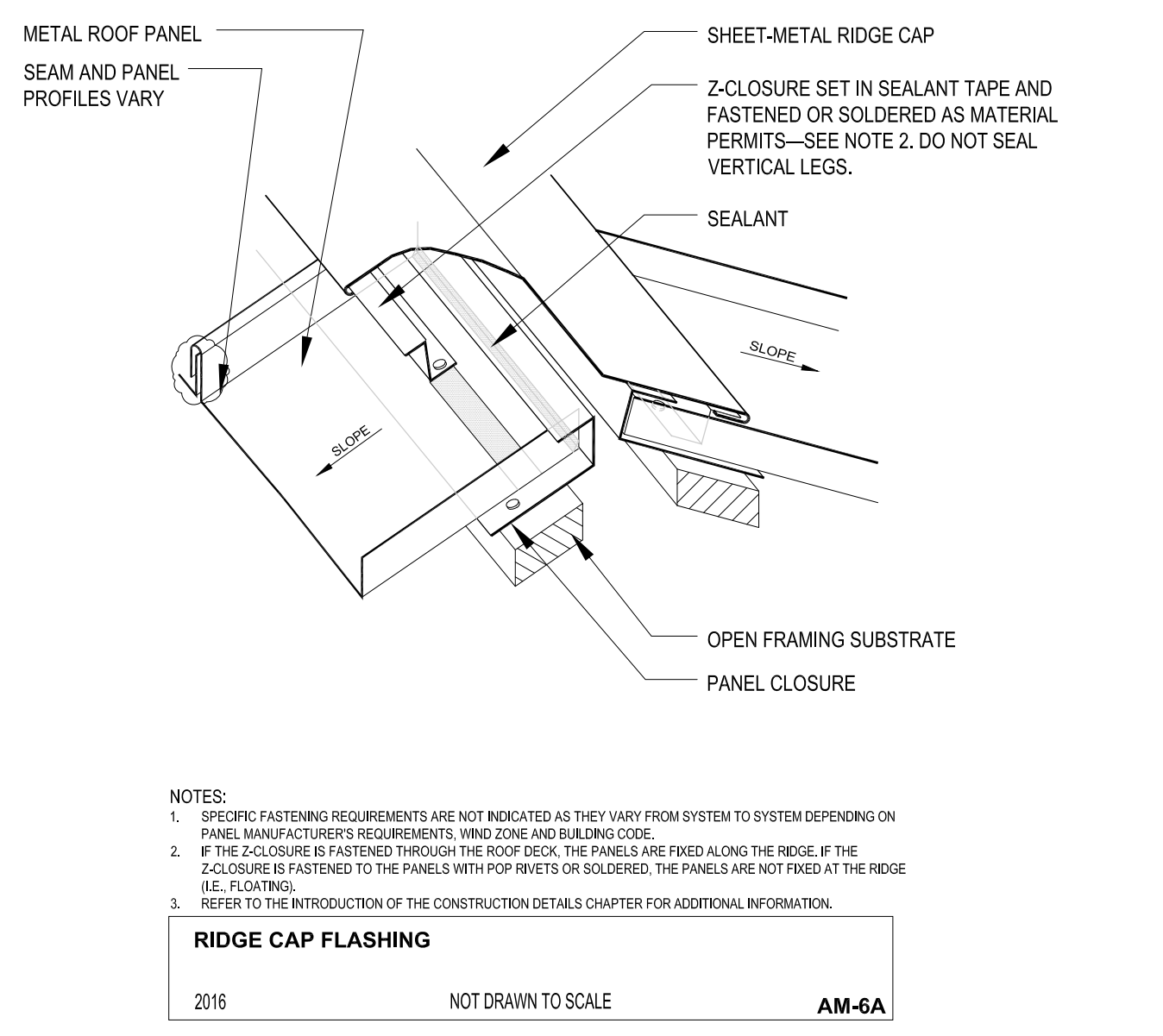

SCALE: N.T.S. RIDGE DETAIL 06

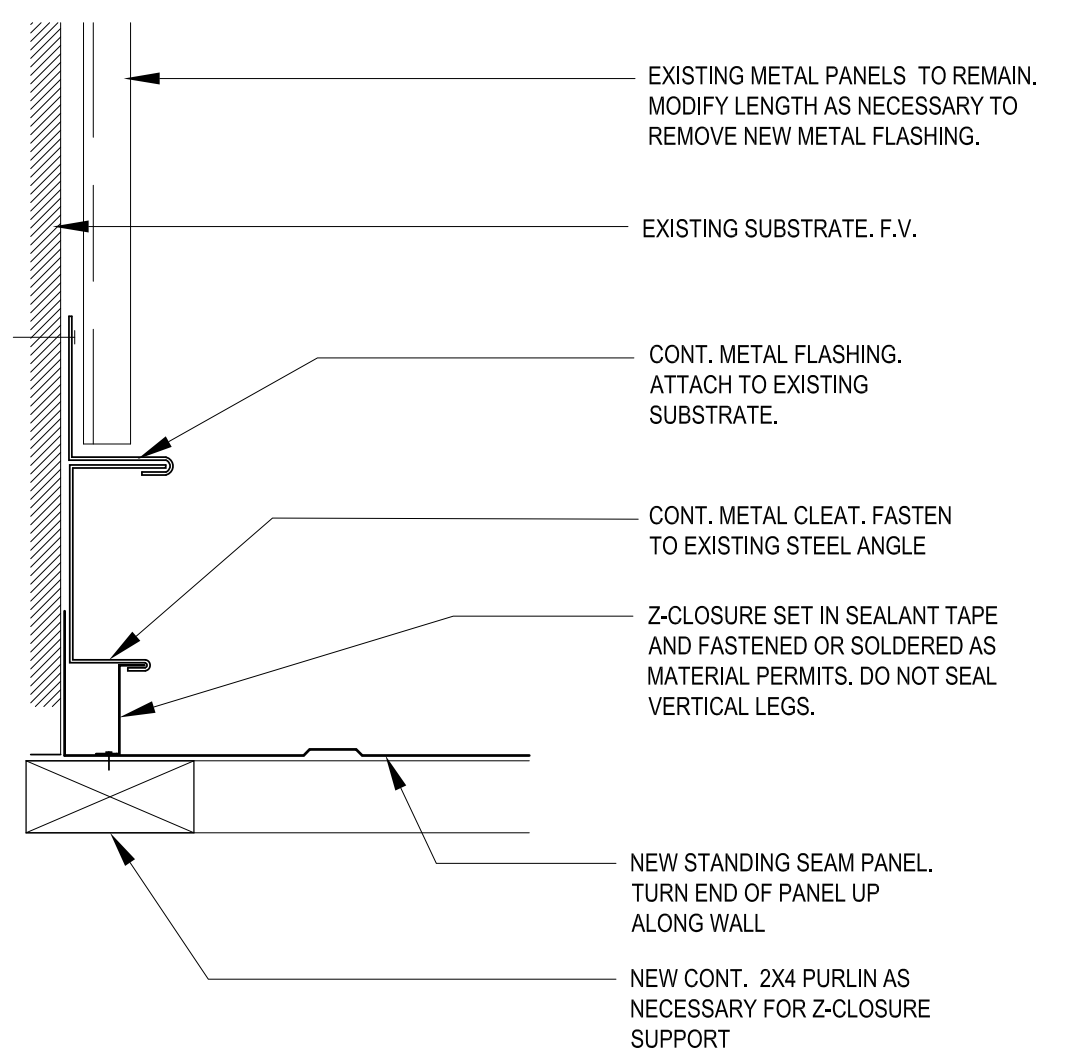

SCALE: 4" = 1'-0" SIDEWALL FLASHING DETAIL 07

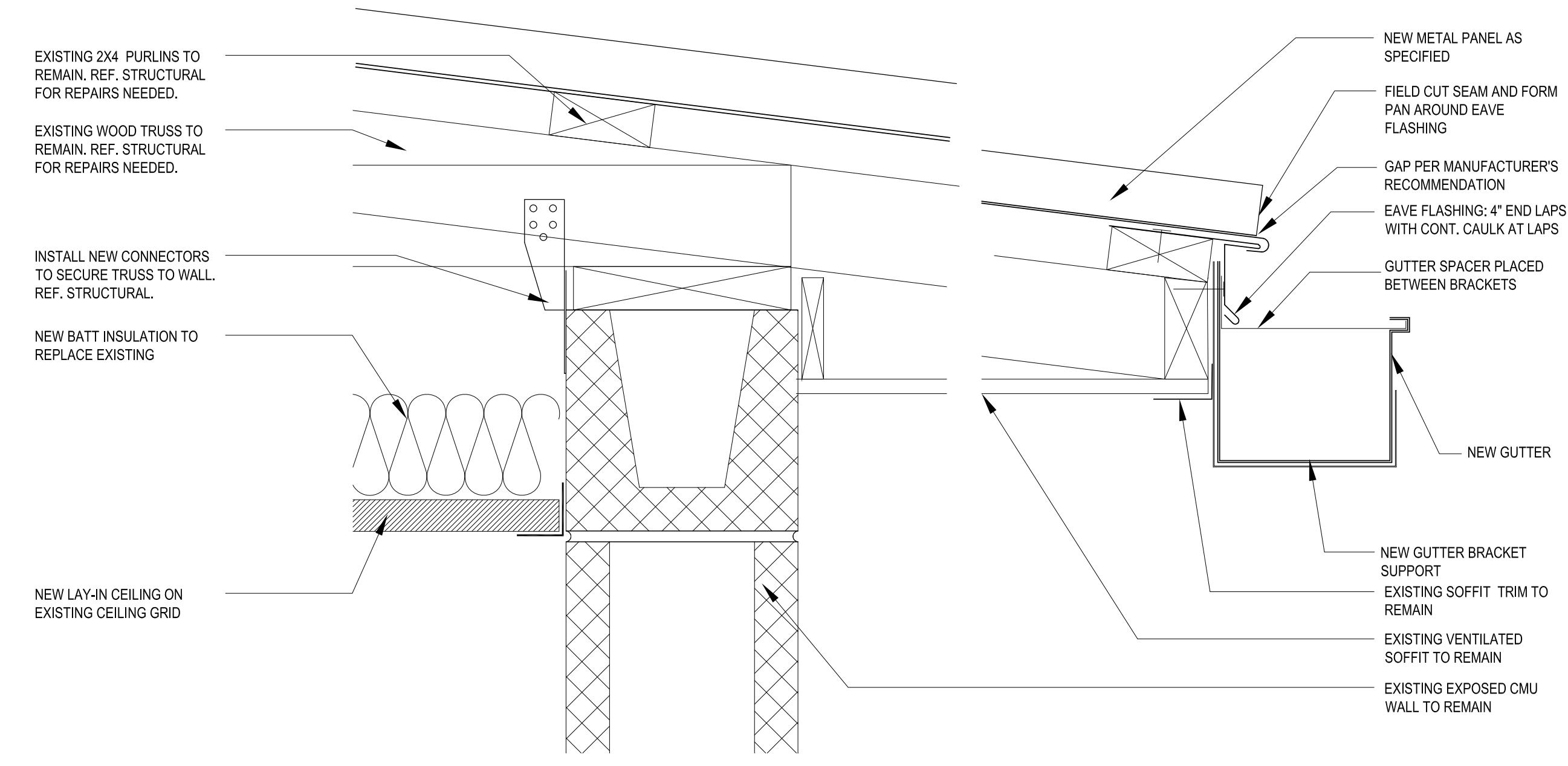

SCALE: 4" = 1'-0" GUTTER AT OVERHANG DETAIL 01

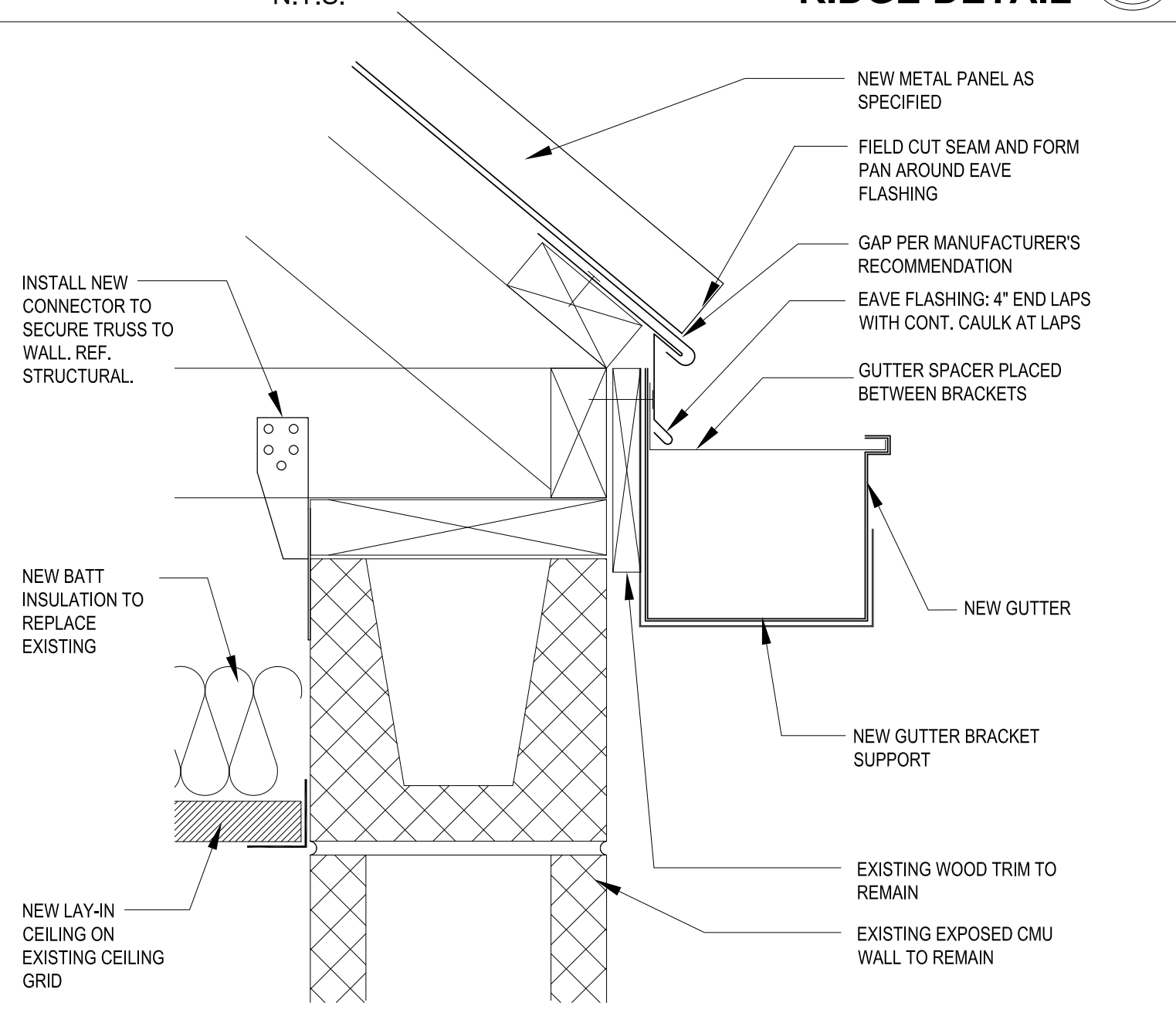

SCALE: 4" = 1'-0" EAVE WITH GUTTER DETAIL 02

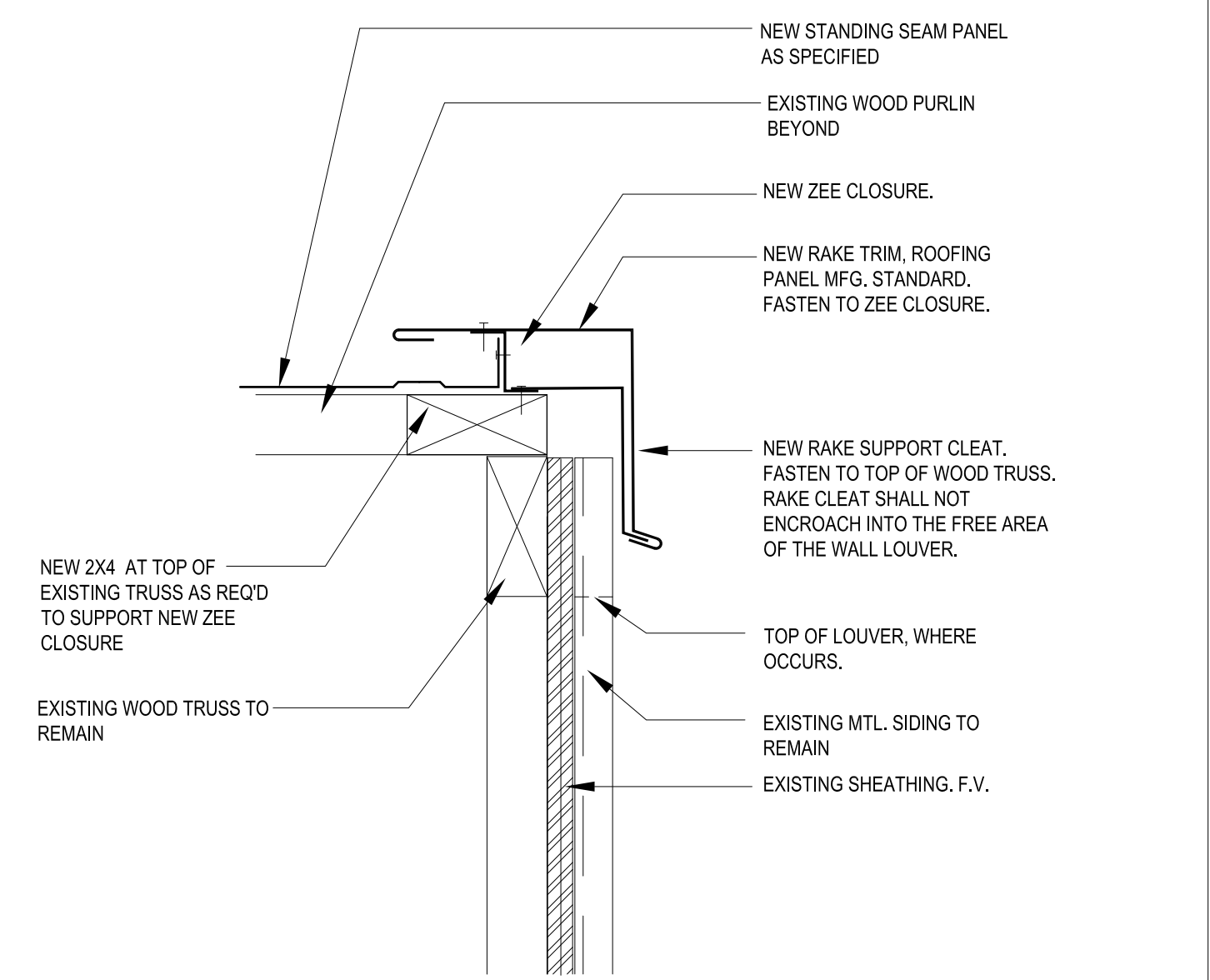

SCALE: 4" = 1'-0" RAKE DETAIL @ METAL SIDING 03



KEYNOTES

- ① REPLACE DAMAGED EXISTING SLEEPER AT ROOF TRANSITION, SEE 3/S1.0
- ② REPAIR WATER DAMAGED TRUSS TOP CHORD, SEE DETAIL 3 / S1.0
- ③ ATTACH EXISTING TRUSSES TO CMU WALL, SEE DETAIL 4/ S1.0
- ④ ATTACH EXISTING TRUSSES TO CMU WALL, SEE DETAIL 3/ S1.0
- ⑤ SIMPSON HGAM10KTA AT END WALL RIM JOISTS, SEE 3 AND 4 S1.0

GENERAL NOTES:

1. THE GENERAL CONTRACTOR SHALL FIELD VERIFY ALL EXISTING DIMENSIONS AND NOTIFY ENGINEER OF DISCREPANCIES PRIOR TO BIDDING AND CONSTRUCTION.
2. DO NOT SCALE DRAWINGS.
3. IN THE EVENT OF A CONFLICT, THE MOST SEVERE AS GOVERNED BY THE DESIGN TEAM SHALL GOVERN.
4. DESIGN CODE: INTERNATIONAL BUILDING CODE, 2012 EDITION.
5. WIND DESIGN CRITERIA - Vult = 130 MPH, EXPOSURE C, RISK CATEGORY = II
6. BASIS OF DESIGN FOR WOOD TO MASONRY CONNECTORS IS SIMPSON STRONG TIE.

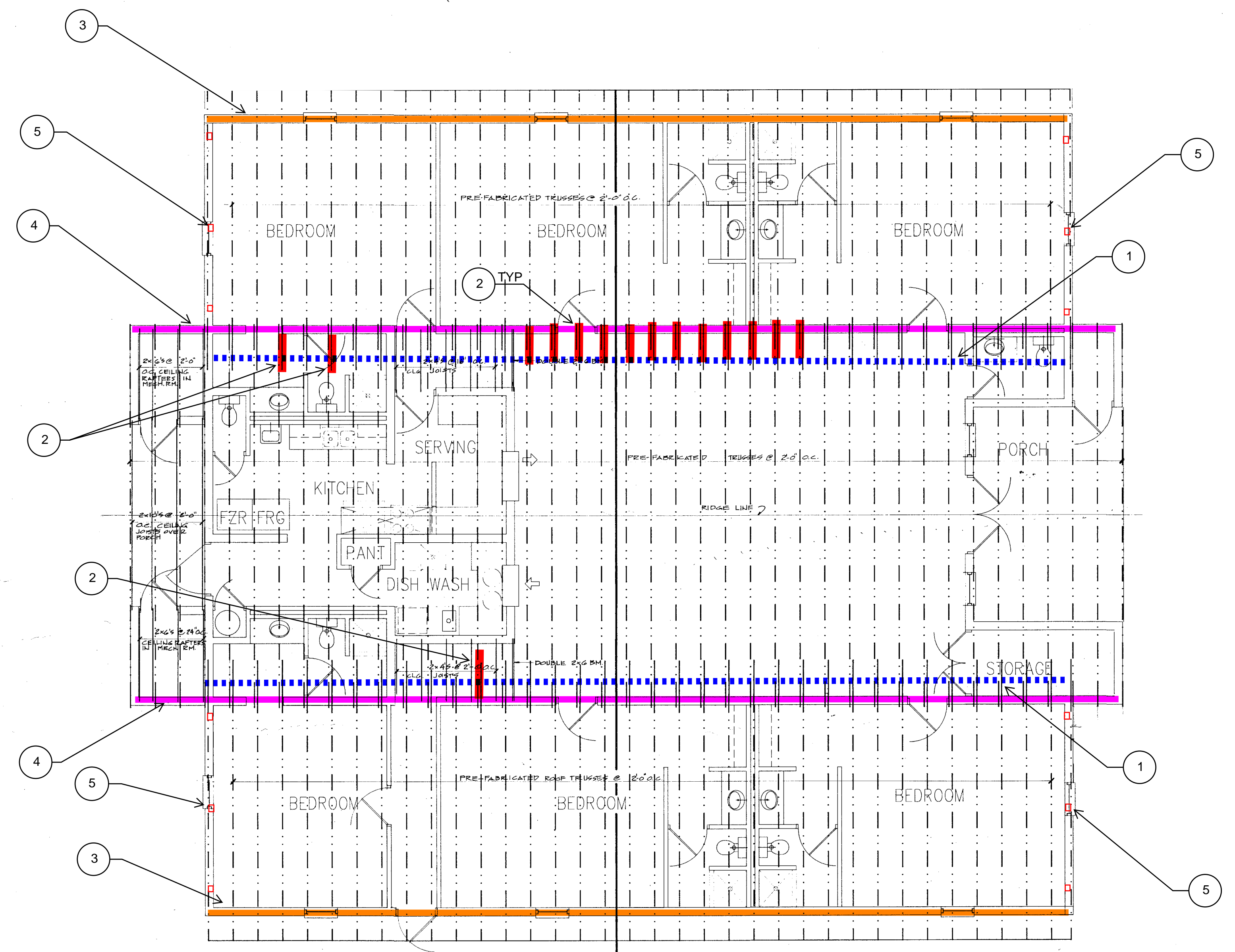

1 EXISTING ROOF FRAMING PLAN DRAWING

NOTE TO GC:
 1. DRAWING ABOVE IS FROM EXISTING DRAWING SET AND MAY DIFFER FROM AS-BUILT CONDITION. DRAWING IS INTENDED TO CONVEY APPROXIMATE ROOF TRUSS FRAMING LAYOUT.
 2. DURING CONSTRUCTION, IF ADDITIONAL AREAS OF ROT ARE FOUND, REPAIR PER KEYNOTES ABOVE.

REMOVE AND REPLACE WATER DAMAGED SLEEPER FULL LENGTH OF BUILDING WITH 2X4 #2 SYP SLEEPER, SEE PLAN FOR LOCATIONS. ATTACH TO TOP CHORD W/ (2) - 10d RING SHANK NAILS

2X4 #2 SYP SCABBED ONTO SIDE OF EXISTING WATER DAMAGED TRUSS TOP CHORD, SEE PLAN FOR LOCATIONS. ATTACH TO TOP CHORD W/ (3) - 10d RING SHANK NAILS EACH END

REPLACE SECTIONS OF EXISTING 2x WOOD PLATE THAT ARE ROTTED

AT EACH END WALL RIM TRUSS, PROVIDE SIMPSON HGAM10KTA W/ (4) 1/4" X 1 1/2" SDS SCREWS TO TRUSS AND (4) 1/4" X 2 3/4" TITEN 2 TO CMU WITHIN 2' OF TRUSS ENDS AND 10' OC MAX (810 LB CAPACITY)

SIMPSON H10S W/ (8) 0.131x1 1/2" CONNX TO TRUSS AND (2) 3/8" X 4" TITEN HD TO CMU (910 LB CAPACITY). OMIT AT END WALL RIM TRUSS

SIMPSON H16S W/ (2) 0.148x1 1/2" CONNX TO TRUSS AND (6) 1/4" X 2 1/4" TITEN 2 TO CMU (1370 LBS CAPACITY)

3 DETAIL AT INTERIOR LOAD BEARING WALL

SIMPSON H16S W/ (2) 0.148x1 1/2" CONNX TO TRUSS AND (6) 1/4" X 2 1/4" TITEN 2 TO CMU (1370 LBS CAPACITY)

AT EACH END WALL RIM TRUSS, PROVIDE SIMPSON HGAM10KTA W/ (4) 1/4" X 1 1/2" SDS SCREWS TO TRUSS AND (4) 1/4" X 2 3/4" TITEN 2 TO CMU WITHIN 2' OF TRUSS ENDS AND 10' OC MAX (810 LB CAPACITY)

4 DETAIL AT EXTERIOR LOAD BEARING WALL

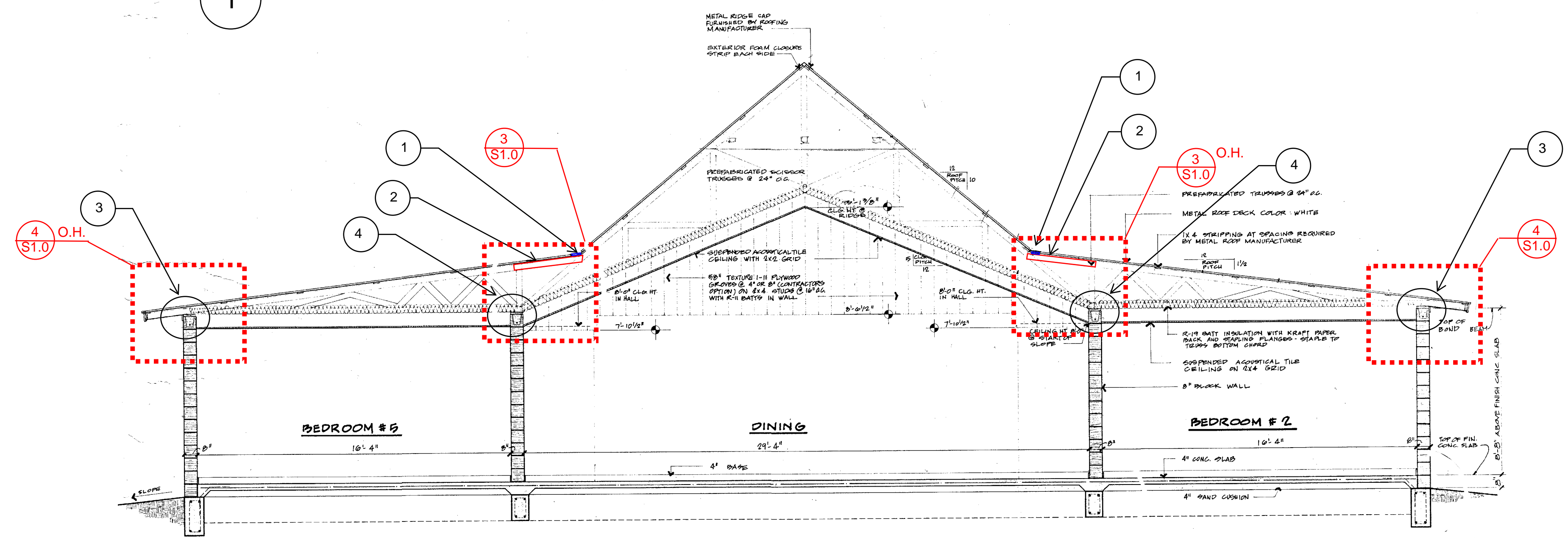

2 EXISTING BUILDING SECTION DRAWING