

Extract from deeds relating to the English Oilfields operation.

1918  
June

Receipts

Balance in hand  
From J. Candlerish for  
damage to grass in carting  
shale dug from Nar. Valley  
drain & boring on Common.  
33 1/2 owners rates at 10/-  
33 1/2 occupiers rates at 5/-  
rent of Green  
Mr. Dickersons gate.  
Mr. Leakes gate  
interest on money in  
Bank in account of N. U.  
rate.

Deficit.

£	s	d
	11	2
2	10	0
1	6	15
8	7	6
	10	0
	2	6
	1	0
1	5	6
<u>3</u>	<u>0</u>	<u>2</u>
	1	15
<u>3</u>	<u>1</u>	<u>8</u>
	15	6
<u>31</u>	<u>18</u>	<u>2</u>

1918  
April 4  
" 15  
May  
12  
20  
"  
June  
July  
August  
June  
Oct 11  
" 12  
"  
Dec  
19  
1919  
Jan  
March

Deficit £1-15-6  
W. Skifford  
10 April 1919

FROM WEST WICHEN  
COMMON BOOK  
1893 - 1946.  
S.L.C. 3/25.

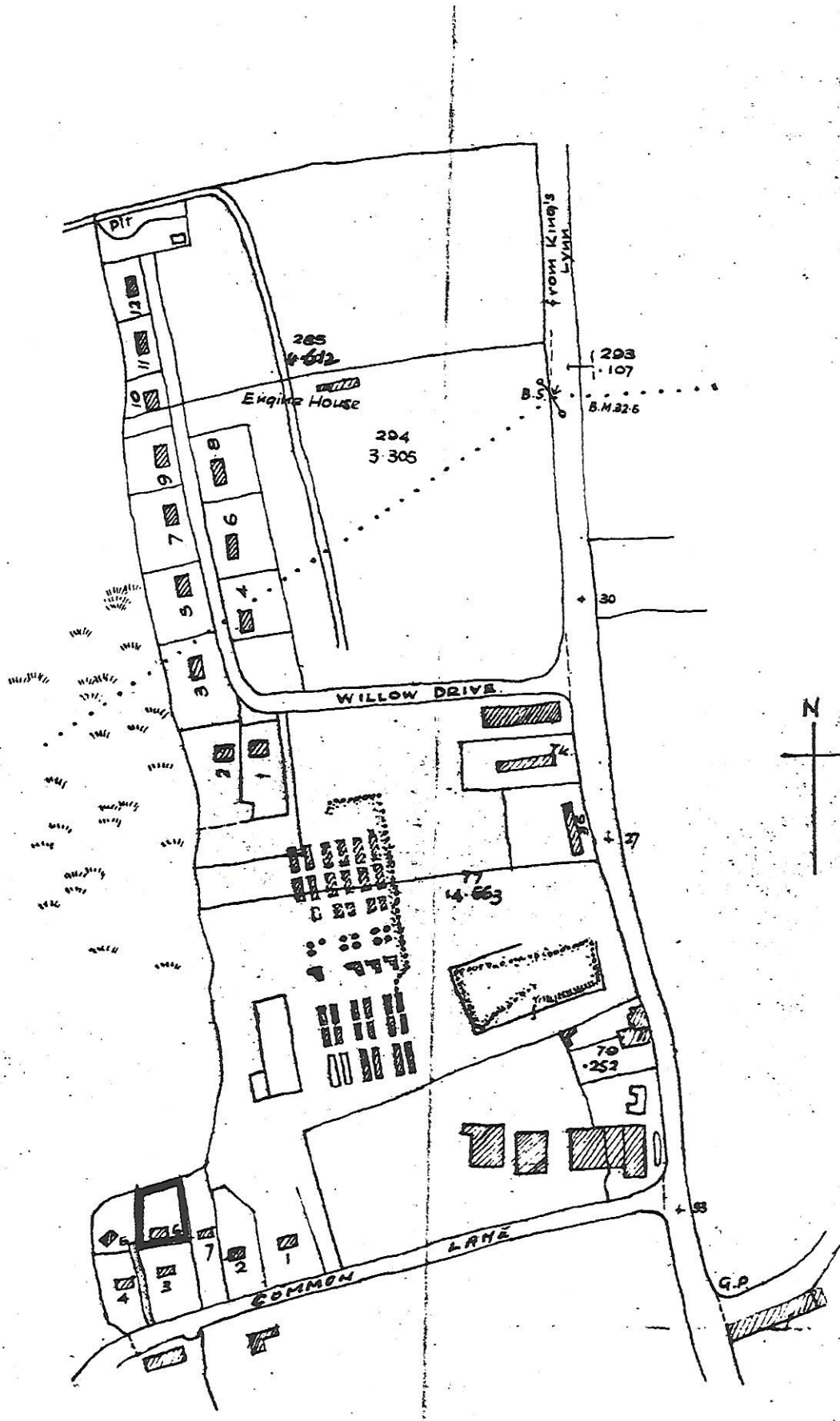

Extract from deeds relating to the English Oilfields operation.

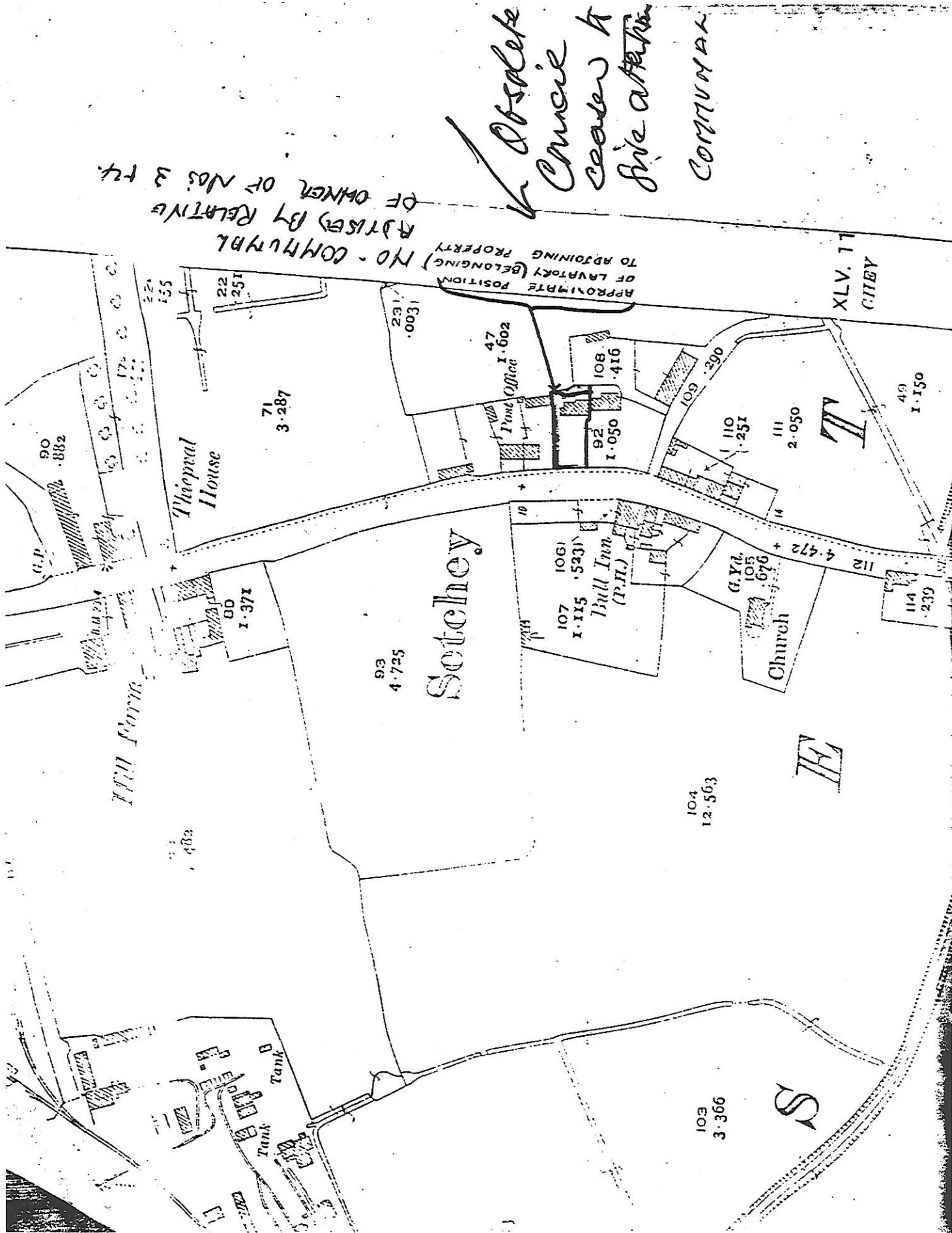

APPROXIMATE POSITION OF LAVERKY (BELONGING TO ADJOINING PROPERTY) NO - COMPLAINTS (ADVISED BY RELATIVE OF OWNER OF Nos 3 & 14)

Obsolete  
Change  
ceases to  
five a  
COMMON

Extract from deeds relating to the English Oilfields operation.

[DERIVED FROM 1928 25" & 1958 6" O.S. MAPS]

### Hand drawn plan of the Oilfields rail complex.

SCALE: 1/4 MILE

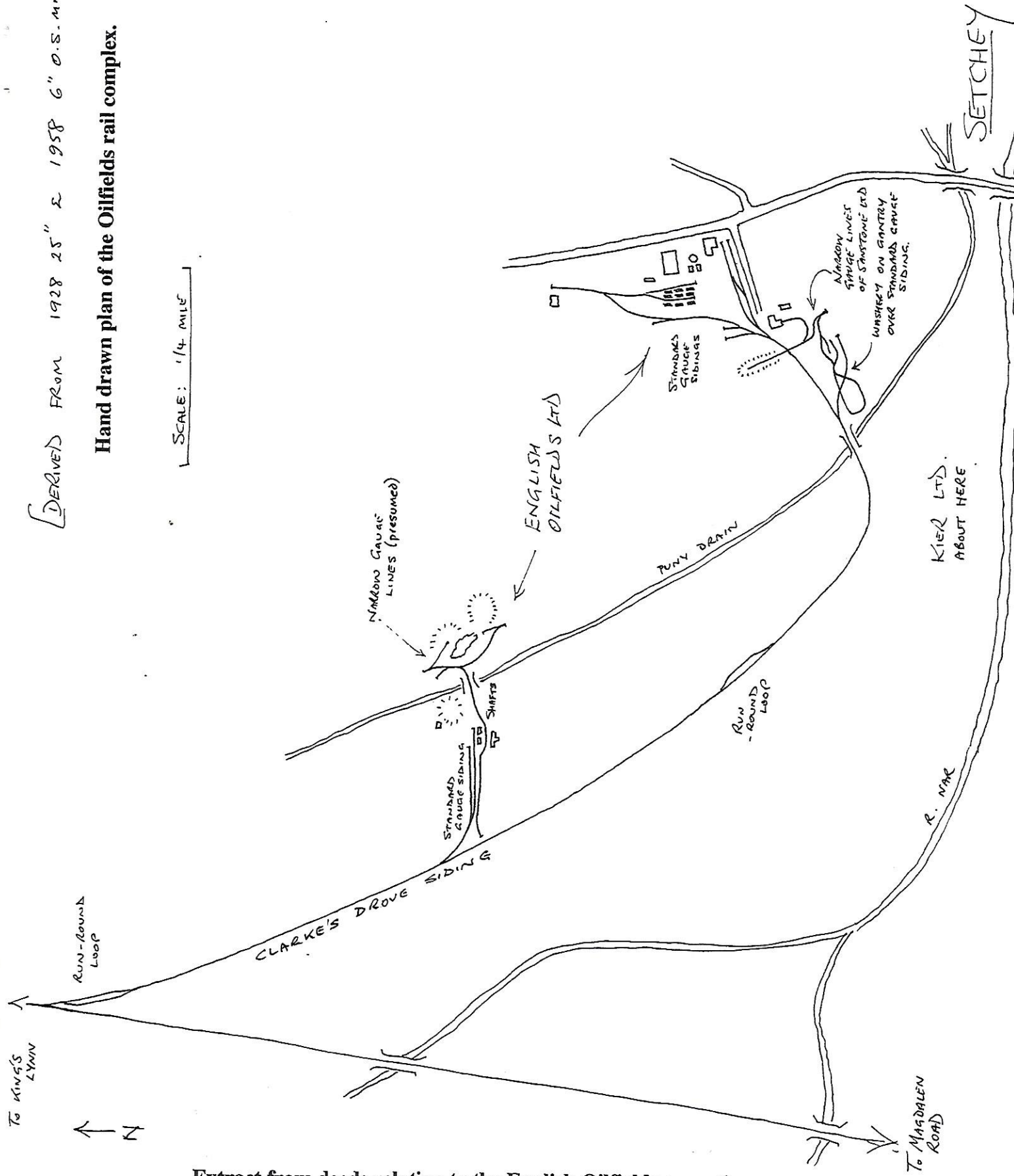

Extract from deeds relating to the English Oilfields operation.