



# OVER AND UNDER ACROSS OKLAHOMA

Volume 19 Issue 2

Dedicated to the preservation, promotion and education of the art of basketry.

March 2019

## PRESIDENT'S NOTES

Spring is here and I'm so glad the cold weather is over for this year. Be sure to contact Mary Lee if you want to make the lovely bird house project. This newsletter is dedicated to all things spring and birdhouses as you will see on the following pages.

It's a big year for me. I retire the end of June and look forward to doing some things to move the guild forward. One of my ideas is to get demos started again at the National Historical Society and other museums around the state. School Days, Frontier Days and 89 Days are good times to introduce school students to basket weaving. If you are interested in participating in demos please let me know. I would also like to see people who can go into schools and demo basket weaving or help students in a class weave baskets.

Another thing I hope to start is having people to my home to weave at least once a month. I live in Bethany, OK so if you are interested in joining some fellow weavers let me know. These will start out weaving your own project or completing those unfinished baskets. These times will be during the day on weekdays. I will have room for 10-12 people and hope to do this on the same day each month.

We will have information coming up about volunteering for projects with the National Cowboy & Western Heritage Museum. There is a calendar on page 7 with these dates and all the dates for the coming year. Easter is coming. There is a project on page 5 that you can share with your grandkids or neighbors. There is an interesting article on pages 8 and 9 that goes along with our birdhouse project. On page 6 learn how to make a holder for your water bottle for when you go on a walk in the coming months. You can make one for each member of your family because it can be hooked on your belt loop.

Pages 10 and 11 are full of pictures of your fellow weavers who were at the last guild meeting and the Beginner Class.

See you at the birdhouse project guild meeting.

Janet Newman

BWGOK meetings are held at the National Cowboy and Western Heritage Museum located near I-44 and NE 63rd Street in Oklahoma City. The meetings are held on the 3rd Saturday of the even months. Meetings generally start at 10am with weaving a project then the business meeting coincides with lunch at 12 noon. Everyone brings a covered dish to share at lunch. If you did not order a project kit come anyway and bring whatever you want to weave on. Bring finished projects to show and tell. We are usually done between 2-3.

## Guild Project for April 20, 2019

Nesting birds are rewarding to watch. About 30 bird species in each region of the country are so-called nesters, which means that most of them will also use a birdhouse. Bluebirds, purple



martins, house wrens, chickadees, tree swallows, and house sparrows are the most common occupants. Birds and their songs entertain us each spring and to welcome our spring yard birds, this month's Oklahoma Basket Weavers' Guild's project is a bird house for your garden.

This primitive birdhouse, with its double roof and fringed shingles looks like a log cabin in which Abraham Lincoln could have lived. The roof is cleverly designed and might give you ideas for other weaving projects. The birdhouse measures 8" x 6" and is 9" tall. The cost will be \$15. which can be paid at the meeting. Please e-mail or call Mary Lee by Apr. 13<sup>th</sup> if you choose to weave this birdhouse project and want a kit. Contact Mary at [Leefam77@cox.net](mailto:Leefam77@cox.net) or 405-329-6253 (leave a message if there is no answer.) Only enough kits will be made for those who order one. You are welcome to order an extra kit at \$15 each.

### BWGOK Officers - Elected and Volunteer Positions

President: Janet Newman

Vice President: Mary Lee & the Norman Weavers

Secretary: Fran Cates

Treasurer: Marcia Balleweg

Membership: Janet Newman

Librarian: Marcia Balleweg

Newsletter: Janet Newman, Newsletter submissions can be sent to: [dnjn3227@sbcglobal.net](mailto:dnjn3227@sbcglobal.net)

## BasketWeavers Guild of Oklahoma Minutes

National Cowboy and Western Heritage Museum

Oklahoma City, Oklahoma

February 16, 2018

At 11:47 the meeting was called to order. Marcia Balleweg made the motion to approve the minutes from the October 2018 meeting and JoAnn Miller seconded the motion.

Marcia Balleweg gave the Treasurer's report.

### Treasurer's Report

BWGOK Treasurer's Report as of January 31, 2019

Balance as of December 31, 2018	\$8761.11
---------------------------------	-----------

#### Expenses

SecureCare Self Storage	\$61.20
-------------------------	---------

Check re-order	\$17.85
----------------	---------

Total Expenses	\$79.05
----------------	---------

#### Deposits

Dues	\$30.00
------	---------

Glenn Walker reimbursement scholarship	\$45.00
--	---------

Total Deposits	\$75.00
----------------	---------

Balance as of January 31, 2019	\$8757.06
--------------------------------	-----------

### Old Business:

#### \* Weavers' Weekend:

Marcia reported that proposals have been submitted, but she expects there will be more to come. Janet Newman is doing donations for the weekend and will put the catalog together.

#### \* Membership: There are 114 paid members

#### \* Beginners Class: The date is March 16. Seven members volunteered to help with the class. Marcia said she had 18-20 signed up to take the class.

#### \* Projects:

- \* April 20: Bird House

- \* June 15: Dream Catcher Ornament

- \* August 17: Positive Tomorrows Basket

- \* September: State Fair Demo

- \* October 19: Bring Positive Tomorrows baskets back filled with kitchen items

Project to be determined

- \* November 1-3 Oklahoma Weavers Weekend, Edmond

- \* December: Christmas Party

### New Business:

#### \* Workshops at the National Cowboy and Western Heritage Museum: These volunteer slots allow the guild to have our meeting room for free.

- \* May 25-26 Chuck Wagon Festival at the Museum, help kids weave mats

- \* July 27: Volunteers will be needed to help teach a museum class. Time is from 9-5

- \* November 16: Volunteers will be needed to help teach a museum class. Time is from 9-5

#### \* Weavers Weekend is moving to Edmond for the November 1-3, 2019 retreat. It will be at the Hilton Garden Inn & Conference Center. The cost will be \$109 per night. Breakfast will be provided in a private room.

#### \* Marcia will apply for a grant that is being offered by Edmond for first time conference users. We will be able to use the grant for anything we wish. This will help us cut our costs for the retreat.

**Meeting Adjourned: 12:27**

# BasketWeavers Having Birthdays

March and April

## Happy Birthday to all of you!!

Jackie	Thomas	3/2
Joyce	Zimmer	3/3
Mary	Lee	3/4
Rena	Vickery	3/7
Rachel	Bess	3/12
Sue	Ausneus	4/1
Peggiann	Combs	4/7
Marcia	Balleweg	4/9
Cricket	Rose	4/15
Jimmie	McKinzie	4/22
Wahleah	Walker	4/23



These pictures are all taken from Pinterest.com.  
They show different ideas for birdhouses.





# WEAVERS WEEKEND UPDATE

## NEW LOCATION & NEW DATE

Remember to reserve November 1, 2 and 3, 2019 for this year's Weavers Weekend which will be in Edmond, Oklahoma at the Edmond Conference Center.

Classes have been chosen and the class schedule is being worked out. The catalog is in its early stages and will be ready sometime around the end of May or first part of June.

Plan now for roommates. It will be so much easier to have rooms in the same location as the retreat.

This will be our 20th retreat and we are planning some exciting things for it.



## 2019 Guild Calendar

April 20: Bird House basket

May 25-26: Chuck Wagon Festival at the Museum, Need volunteers to help kids weave, 10-4.

June 15: Dream Catcher Ornament

July 27: Volunteers needed to help with Museum class, 9-5

August 15: Deadline to enter baskets in the state fair

August 17: Positive Tomorrows Basket

September: Demo at the State Fair, date to be determined

October 19: Bring Positive Tomorrows back filled with kitchen items  
Project to be determined

November 1-3: Oklahoma Weavers Weekend, Edmond

November 16: Volunteers needed to help with Museum class, 9-5

December 21: Christmas Party, project will be an angel



# WOVEN BASKET EASTER CRAFT

- easypeasyandfun.com -

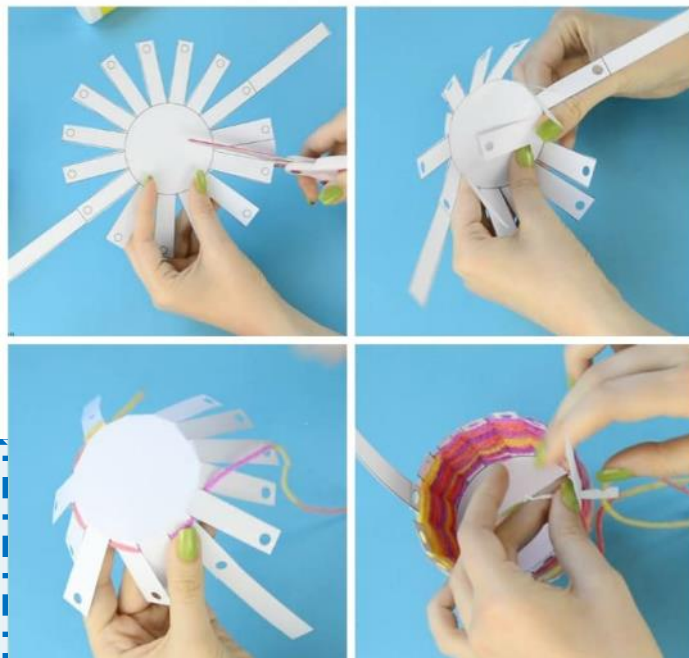

## Make Easter Baskets for the Coming Holiday

Do you need a simple basket craft to do with kids? Start teaching those little grandkids to have a love for basket weaving and crafts. This little Easter basket is made with supplies you probably have at home. Heavier cardstock or lightweight cardboard work well. Then use any color yarn you have on hand. Scissors and a hole punch are all you need. The website at the bottom of the page has a template like the one to the right and there is even a video on how to make the basket. Complete instructions are on the website.

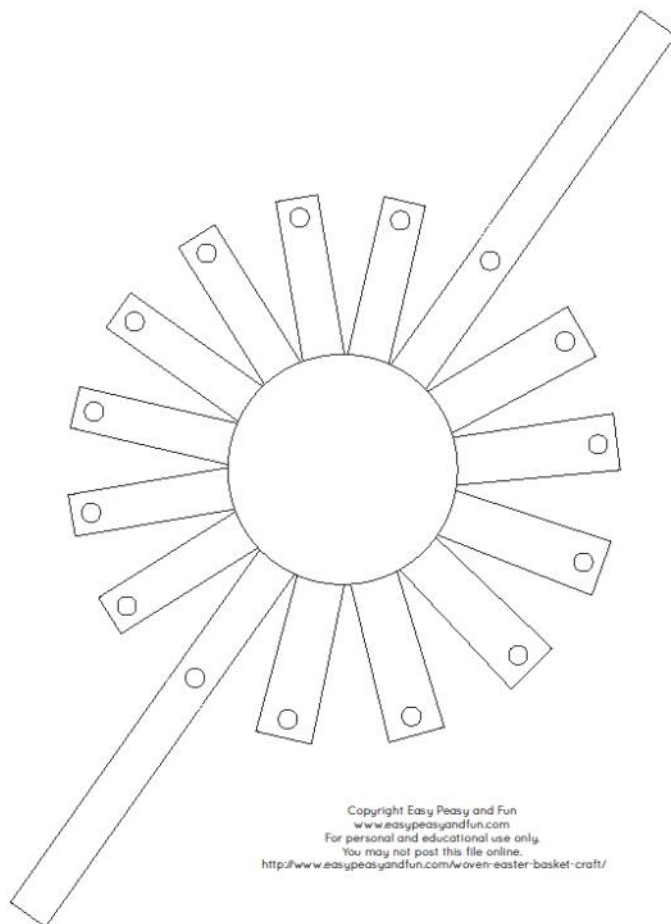

Copyright Easy Peasy and Fun  
www.easypeasyandfun.com  
For personal and educational use only.  
You may not post this file online.  
<http://www.easypeasyandfun.com/woven-easter-basket-craft/>



Overlapping the loops



Path the bight takes through the cat's eye.



Flipping the knot



Final configuration

## Weave A Bottle Sling Knot

A bottle sling is a knot that can be used to create a handle for a container with a slippery narrow neck such as a water bottle. The bottle knot is classed as a binding knot because it is able to perform a function for which most other binding knots are not suited. The bottle slings specific form allows it to grip a cylinder that has a flare or collar. The space at the center of the knot is dropped over the top of the bottle. Firmly pull on all four ends to tighten the knot over a bottle. This knot was used in ancient Greece to apply traction to arms and legs.

You can find videos on YouTube that show how to tie this knot.

Information taken from:

[https://en.wikipedia.org/wiki/Bottle\\_sling](https://en.wikipedia.org/wiki/Bottle_sling) and <https://www.instructables.com/id/Carry-any-Bottle-with-a-JUG-KNOT-Handle/>







It's Spring and time to be outdoors with nature. What better way to use your basketry skills than making bird feeders and birdhouses for our feathery bird friends. Colorful Crafts website shows how to make these items out of willow. Even if you don't have willow you could make them out of #3 and #5 round reed. If you use round reed I think I would stain the reed to make it last longer in Oklahoma's weather. Check out the websites down below for complete instructions. The birdhouse uses a technique called pairing that is new to me. It uses 2



weavers like twining but twists them between each set of spokes. The base is made then new spokes are added for the sides. The sides are woven in a 3-rod wale.

The bird feeders would be fun to make and are easy too. Make several to put in small trees or shrubs. Your feathered friends will love you for it. This is also a great craft for kids.



<http://colorful-crafts.com/bird-feeder-diy-willow-weaving/>

<http://colorful-crafts.com/willow-weaving-birdhouse/>







The February project was weaving pencil holders. Thank you Pauline Asbury for allowing us to use your pattern and to Mary, Nancy and Susan for helping to put the kits together and teaching the class. As you can see each pencil holder came out different. No two were alike. It was a fun project and we had several first time weavers. The business meeting was lively and informative and lunch was great as usual.







Our Beginner Class on March 16th was a huge success. We had 24 new weavers sign up for the class and 8 guild members who showed up to help the weavers. Each person left with a finished napkin basket. We had about 8 people who joined the guild from this class. It was interesting to see that people came from all over the state. There were several from Michigan. They were here visiting someone who was a new weaver. Lunch was sandwiches, salads and desserts. It was great. We gather names and email address from interested people at our State Fair Demo and the Chuck Wagon Festival at the museum. We also get a lot of people from word of mouth. If you know of anyone interested in weaving tell them we will do this class again in March of 2020.

## Basket Bird Nests

Taken from the book, *Earth Basketry* by Osma Gallinger Tod

Pages 149-155.

"The little bird sits at his door in the sun,  
A-tilt like a blossom among the leaves,  
And lets his illumined being o'er-run  
With the deluge of summer it receives." Lowell

Before making a basket bird nest one must know the habits of the birds to occupy it. The basket must be wide enough to accommodate their tail feathers and deep enough to suit their fancy, for birds have preferences. Most important of all is the size of the opening, for birds seem to want to be able just to squeeze through the hole: wrens, chickadees, purple martins, blue-birds and great crested flycatchers. A larger hole might admit enemies. Others, like robins, barn swallows and song sparrows, do not confine themselves in houses but prefer open nests or shelters. The entrance hole should face south and the house tip forward so rain will not enter the hole.

To help the bird-nest builder in making a successful home for his particular bird friends, the following guide is copied from *Farmers' Bulletin*, No. 1456, *Holmes For Birds*, issued by the U.S. Dept. Of Agriculture.

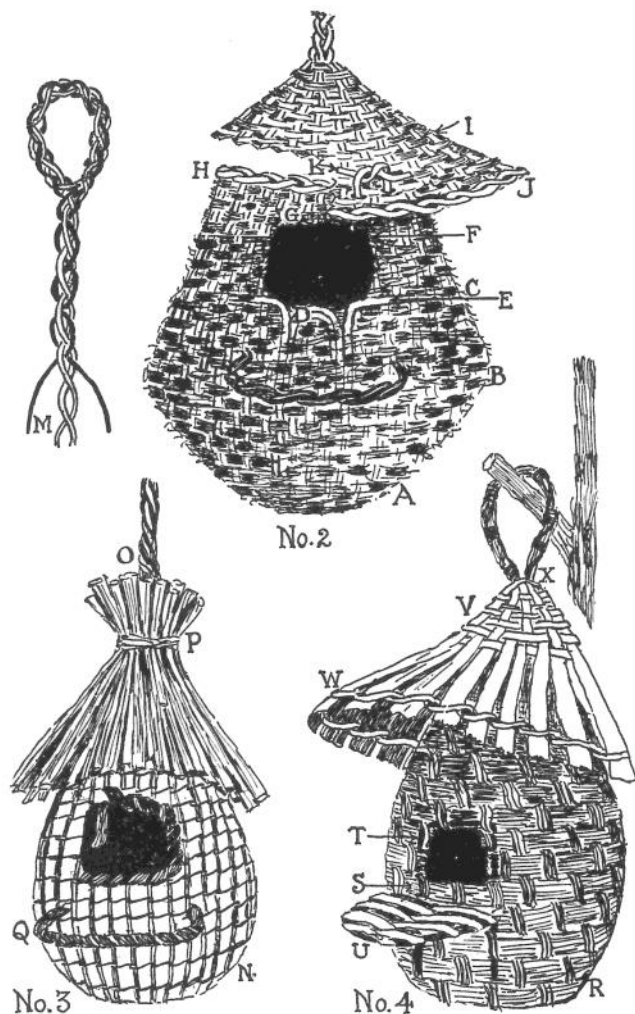

FIGURE 73—Above, DIAGRAM FOR BIRD HOUSE OF UNPEELED VINES.  
Below, left, SMALL BIRD NEST OF SPLINTS AND RUSHES. Below, right,  
TREE SWALLOW'S NEST OF SPLINTS AND GRASSES

### DIMENSIONS FOR BIRD NESTS

SPECIES	Flare of cavity Inches	Depth of cavity Inches	Entrance above floor Inches	Diameter of entrance Inches	Height above ground Feet
Bluebirds	5 X 5	8	6	1 1/2	5-10
Robin	6 X 8	8	(1)	(2)	6-13
Chickadees	4 X 4	8-10	6-8	1 1/8	6-15
Titmice	4 X 4	8-10	6-8	1 1/4	6-15
Nuthatches	4 X 4	8-10	6-8	1 1/4	12-20
House wren	4 X 4	6-8	1-6	1	6-10
Carolina wren	4 X 4	6-8	1-6	1 1/8	6-10
Tree swallow	5 X 5	6	1-5	1 1/2	10-15
Barn swallow	6 X 6	6	(1)	(2)	8-12
Purple martin	6 X 6	6	1	2 1/2	15-20
Song sparrow	6 X 6	6	(2)	(3)	1-3
House finch	6 X 6	6	4	2	8-12
Phoebe	6 X 6	6	(1)	(2)	8-12
Crested flycatcher	6 X 6	6-10	6-8	2	8-20
Flicker	7 X 7	16-18	14-16	2 1/2	6-20
Red-headed woodpecker	6 X 6	12-15	9-12	2	12-20
Downy woodpecker	4 X 4	8-10	6-8	1 1/4	6-20
Hairy woodpecker	6 X 6	12-15	9-12	1 1/2	12-20

<sup>1</sup> One or more sides open.

<sup>2</sup> All sides open.

"Where shall man wander and where shall he dwell,  
Beautiful Birds, that ye com not aw well?  
Ye have nests on the mountain all rugged and stark, Ye  
have nests in the forest all tangled and dare:  
Ye build and ye brood 'neath the cottager's eaves,  
And ye sleep on the sod 'mid the bonnie green Leaves."

William H. Thomson



## Corn & Husk Birdhouse

Below are the directions are the corn and husk birdhouse. This straw colored birdhouse is made of narrow cane or splint weavers over round spokes, with a tufted water-shed of corn husks. The dimensions are for the bluebird. The basket is woven as follows.

### CANE AND CORN HUSK BIRDHOUSE—FIGURE 72, No. 1

This straw colored birdhouse, photo in Figure 71, is made of narrow cane or splint weavers over round spokes, with a tufted water-shed of corn husks. The dimensions are for a bluebird.

**Base and Sides**—Start at A with sixteen spokes 2 feet long, size No. 3. Weave Indian Center, Figure 4, with a single strand over pairs of spokes up to B, 3 inches from start, diameter at B, 5 or 6 inches. At this point insert a pair of spokes at each pair but one, shaded spokes, C. Separate groups of four into pairs, as at D, weave once around twenty-five pairs with No. 3 in Triple Coil. Weave in-and-out 3 inches up to opening, E. **Opening**—Cut off one or two pairs 1 inch above weaving, F, turn down into weaving; weave back and forth at each side, G, taking extra turns around spokes at edges. When opening is 1½ inches high insert pairs, H, to replace cut-out spokes; weave 1 inch above opening, cut out one spoke of each pair, join adjacent single spokes in new pairs, I. Weave 1 inch to top; bind spokes with wire, J. Wrap edges of opening, as at K. **Perch**—Make perch, L, ½ inch below opening, of a No. 6 rod, 12 inches long, whittled at ends, inserted into weaving at each side, L, and wrapped with crosses. **Bridge**—Make roof-extension N, for birds to land on, of a single No. 3 strand. Fasten end ¾ inch above opening, carry it around basket; insert it under spokes every 2 inches, M, forming loops, N, extending 1 inch out from basket. Loop around basket a second time, inserting at points O, midway between points M. Go around a third time, twisting strand around outer edge only, P, and a fourth time twisting along grooves of last round, arrows, Q. **Handle**—Insert two pieces of No. 3 reed through wire at top of house, R, carry upward 1½ feet, make loop S, carry down to start of wire. Coil cane upward around handle in one direction, downward in opposite direction, forming crosses, T.

**Watershed**—Tie corn husks U, 7 or 8 inches long, in a clump around wire-bound top, as at V; bind with wire.

A square birdhouse of flat weavers is shown at X, with square plaited base at W. Make a slanting perch by bending unused spokes at opening down into the shape shown at X and weaving under and over them with cane.

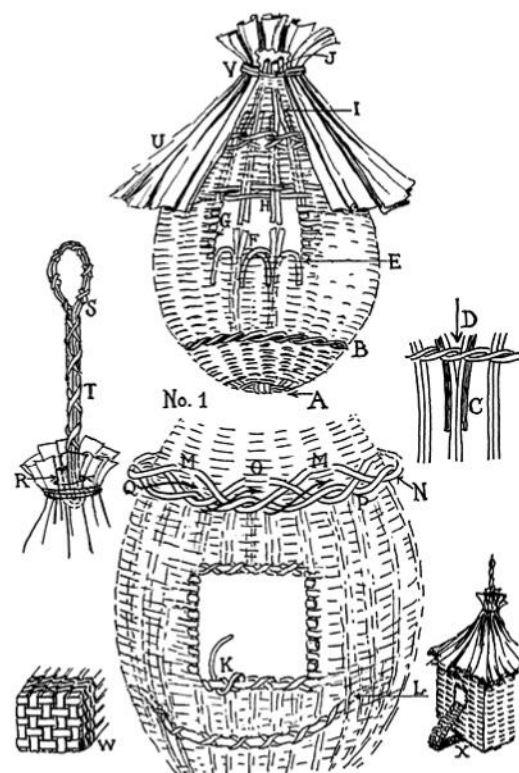
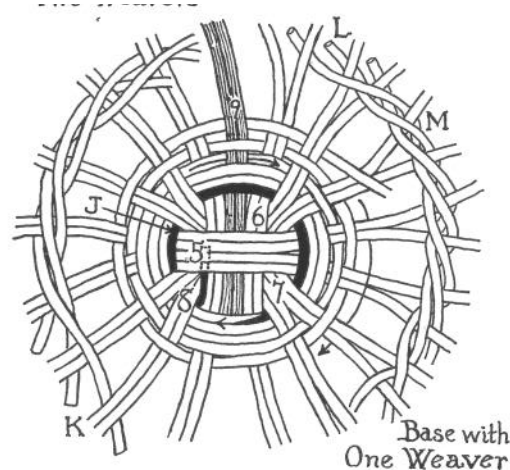

FIGURE 72—DIAGRAMS OF CANE AND CORN HUSK HOUSE FOR BLUEBIRDS

## Birdhouse of Unpeeled Vines

No. 2 on the opposite page is a woodsy looking birdhouse. Both the spokes and weavers are of unpeeled honeysuckle or other flexible vines. Spokes are #4 or #5 and weavers are #3.

Shaggy knobs along the stems give a rustic beauty to the basket. The roof is detachable so as to clean the house out between seasons.

Birdhouse #3 on the opposite page is woven with splints and rushes. It uses narrow splints of oak or ash with rushes or grasses of a light color to match and tufted watershed of corn-husks make the top. Another combination for this nest is cedar bark strips of brown for spokes, rushes or raffia for rows of pairing and green yucca leaves for the water-shed and trimmings.

The 4th nest on the opposite page is a coiled house of sewed grasses or corn husks with a sloping roof of splints. This house is the right size for the tree swallow or the violet-green swallow. Almost any kind of material may be used for the foundation coil; rushes, grasses, flexible vines, etc. The sewing strand may be of raffia or flexible vines. The perch is made of a bent twig inserted into the coiling and interlaced with a well-soaked splint fastened into a "U". Have fun weaving for your feathered friends.

