

Two 11,900 Sq. Ft. Buildings Available Cordova Industrial Park

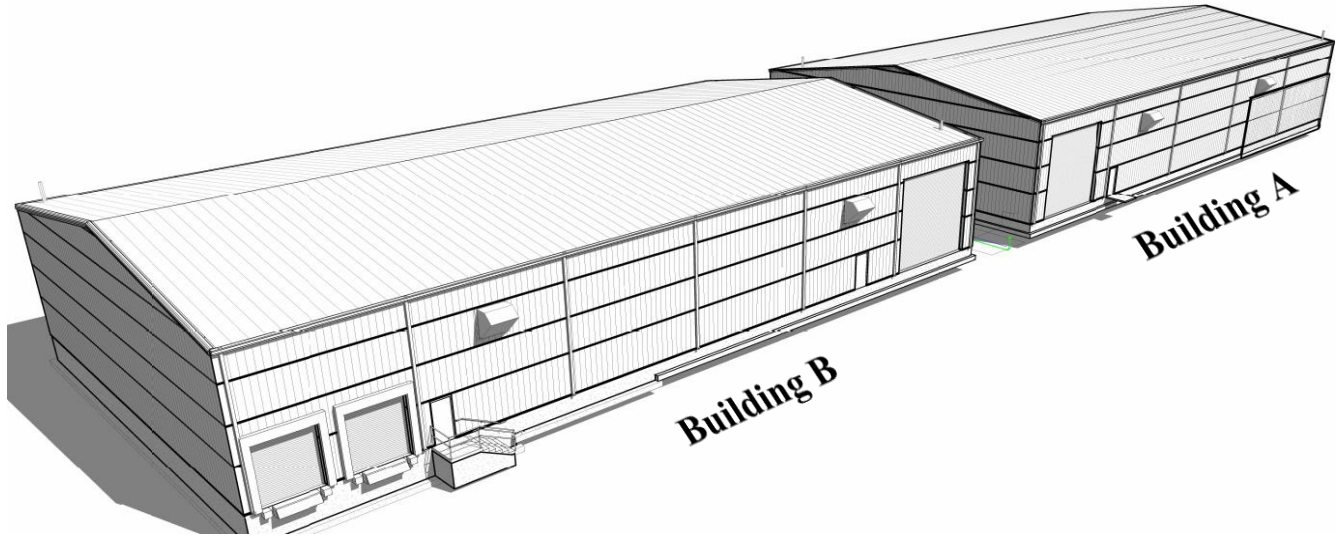

9140 Cordova Industrial Dr.
Building A & B

Available Fourth Quarter 2026

Property Features:

Total Sq. Ft:	23,800 Sq. Ft.
Building A:	11,900 Sq. Ft.
Office Area:	Build-to-Suit
Grade Level Door:	2 (20' x 22')
Building B:	11,900 Sq. Ft.
Office Area:	Build-to-Suit
Grade Level Door:	2 (20' x 22')
Outside storage:	Available
Ceiling Clear:	24' – 26'
- Can add additional doors	
- LED Lighting with motion sensors	
- Fully Fenced and Secured	

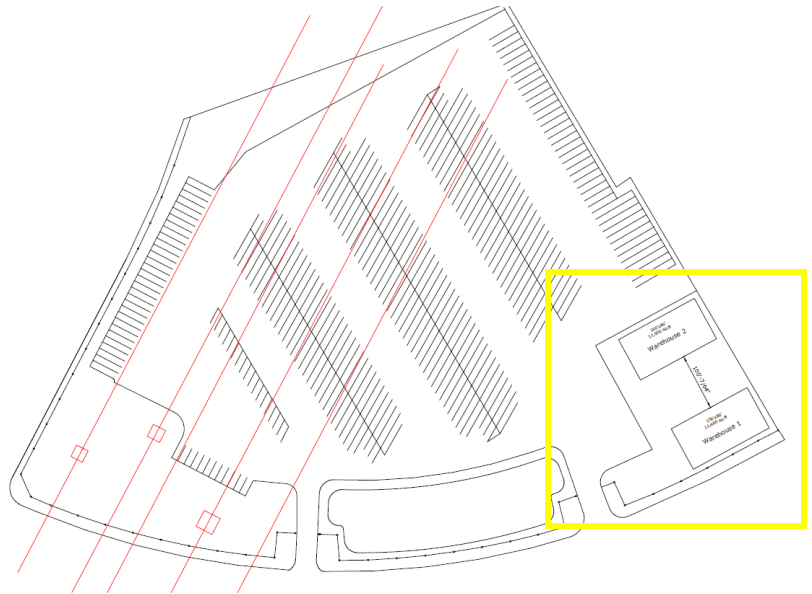

Memphis Commercial & Industrial

Exclusive Agent

3885 S. Perkins Rd Suite 12
Memphis, TN 38118
Phone 901-375-4300
Fax 901-375-9689

Ed Larkin: Ed@memphisci.com
Cell: (901)-351-3961
Stefan Feick: Stefan@memphisci.com
Cell: (901)-415-9812

LOCATION MAP

