

# 24th Annual Midwest Esri Utility User Group Conference



**April 2-4, 2025**  
**Mayo Clinic Health System Event Center**  
1 Civic Center Plaza - Mankato, MN 56001



- Hosted By -



Digital Agenda



## Hotel Information

A block of rooms has been reserved at: Hilton Garden Inn

Address: 20 Civic Center Plaza,  
Mankato, MN 56001

Phone: (507) 344-1111

**Rooms must be reserved by Wednesday March 5th to receive the group rate of \$149.** After 3/5/2025 any rooms reserved will be subject to availability, their Best Available Rate, and the Group Rate will not be honored.

Mention **Midwest Esri Utility Users Group (MWEUUG)** conference when making your reservation

## General Conference Information

We will be utilizing the Banquet Hall West for the main presentation location, the Ellerbe Room and Banquet Hall East will be used for breakout presentations and the Vendor Hall will be located in the thoroughfare between the Banquet Hall and Ellerbe Room throughout the MWEUUG conference.

Please direct any questions to Mike Siedschlag at [msiedschlag@grenergy.com](mailto:msiedschlag@grenergy.com) or James Huffman at [jhuffman@riverlandenergy.com](mailto:jhuffman@riverlandenergy.com)

**Wednesday, April 2, 2025**

|         |                                     |
|---------|-------------------------------------|
| Track 1 | GIS Beginners Classes               |
| Track 2 | GIS Intermediate & Advanced Classes |
|         | Sponsor Presentations               |

| 11:30 am - 4:30 pm | Registration               |
|--------------------|----------------------------|
| 12:30 pm - 1:00 pm | Davey Resource Group       |
| 1:00 pm - 1:30 pm  | Leica Geosystems           |
| 1:30 pm - 2:00 pm  | Power System Engineering   |
| 2:00 pm - 2:30pm   | Fenux Labs                 |
| 2:30 pm - 3:00 pm  | Frontier Precision         |
| 3:00 pm - 3:15 pm  | Afternoon Break            |
| 3:15 pm - 3:45 pm  | Ayres Associates Inc       |
| 3:45 pm - 4:15 pm  | Subsite                    |
| 4:15 pm - 4:45 pm  | SSP Innovations            |
| 4:45 pm - 5:15 pm  | WSB                        |
| 5:15 pm - 8:00 pm  | Vendor Hall Evening Social |

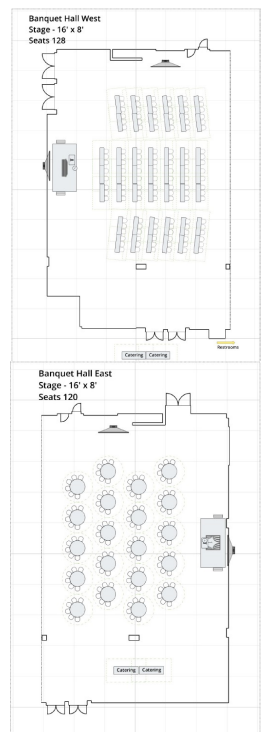
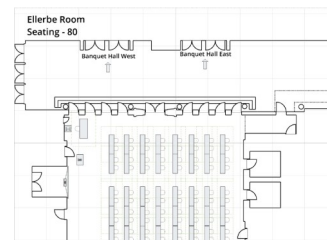

## Thursday, April 3, 2025

|                     |                                   |  |   |
|---------------------|-----------------------------------|--|---|
| 7:00 am - 8:00 am   | Exhibits Open at Breaks           | Morning Breakfast Buffet   |   |
| 8:00 am - 8:05 am   |                                   | Welcome - General Assembly   |   |
| 8:05 am - 9:00 am   |                                   | Plenary Session - Introductions  |   |
| 9:00 am - 10:00 am  |                                   | Keynote Presentation — Pat Hohl—Director, Electric Industry Solutions—Esri   |   |
| 10:00 am - 10:15 am |                                   | Morning Break  |   |
| 10:15 am - 12:00 pm |                                   | Esri Utilities overview - Keith Krall and Kyle Crawford  |   |
| 12:00 pm - 1:00 pm  |                                   | Lunch Break  |   |
| 1:00 pm - 1:30 pm   |                                   | RTK Locators & ESRI<br>Jessie Lloyd—City of Fairmont   | Performance tuning of ArcGIS Enterprise<br>Mike Siedschlag—GRE  |
| 1:30 pm - 2:00 pm   |                                   | ERMU use of ArcGIS field apps<br>Angela Hauge—ERMU   | Migrating your GN to UN<br>Kyle Crawford—Esri   |
| 2:00 pm - 2:30 pm   |                                   | 2024 Excavation Law Changes<br>Dave Hunstad—Hutchinson Utilities Commission  | Utility Network Embedded with Asset Management<br>Dhruv Thakkar— City of Oconomowoc Utilities and Tyler Caulum—WPPI |
| 2:30 pm - 2:45 pm   |                                   | Afternoon Break  |   |
| 2:45 pm - 3:15 pm   |                                   | Designing labels and pop ups with Arcade in ArcGIS Pro<br>Robert Borchert—GRE  | Experience Builder<br>Maegan Caouette—GRE   |
| 3:15 pm - 3:45 pm   |                                   | High Accuracy GNSS Construction/ Maintenance Workflows<br>Todd Copeland—MPS  | Field Survey of Joint Use Pole Attachments and NESC Clearance Violations<br>Ann Liebenow-Anttila—RPU                |
| 3:45 pm - 4:00 pm   |                                   | Afternoon Break  |   |
| 4:00 pm - 5:00 pm   |                                   | Peer to Peer session — James Huffman (moderator)<br><br>You have questions, your peers have answers!<br>Prepare your questions and get ready to learn something new! |   |
|                     | Group Dinner and Social @ Pub 500 |  |   |

## Friday, April 4, 2025

|                    |  |
|--------------------|--|
| 7:00 am - 8:00 am  | Morning Breakfast Buffet   |
| 8:00 am - 9:00 am  | MWEUUG Business Meeting / Q & A Session  |
| 9:00 am - 9:15 am  | Morning Break  |
| 9:15 am - 11:45 am | <b>Lightning Round Talks</b><br><b>UAS</b> —Discuss UAS users group, Drone imagery into Esri, etc.<br><b>Technology/Hardware</b> for field collection panel discussion<br><b>Utility Network</b> panel discussion<br><b>GIS Showcase</b> —bring your own device and show us what you’re doing with GIS |
| 11:45 am           | Adjourn  |

## Vendor Presentations – Wednesday April 3

Davey Resource Group—Anthony Landon

**Leica Geosystems—Joe Webb**

**Leica Zeno GIS Collectors: Precision and Efficiency for Utility Workflows**

*Leica Zeno GIS Collectors deliver high-accuracy GNSS solutions (sub-meter to 1 cm) with seamless integration into Esri Field Maps and Survey123 on iOS and Android devices. Designed for ease of use and reliable performance, they empower utility professionals to efficiently map assets, inspect infrastructure, assist in utility locating, and manage field data with confidence. Real-time data collection and precise positioning help reduce excavation risks, support compliance with regulatory standards, and enhance operational efficiency.*

**Power System Engineering, Inc—Logan Suhr & Ryan Wendt**

**Empowering Asset Management with AI and ArcGIS: Building a Transformer Lifecycle System**

*This presentation outlines the development of a transformer lifecycle tracking system using ArcGIS Experience Builder, supported by AI tools like ChatGPT to accelerate design and development. The project involved creating a geospatially-enabled SQL database to manage transformer assets, maintenance records, financials, and movement history. This presentation offers a practical look at how AI can enhance GIS workflows while underscoring the importance of GIS-specific tooling and expertise.*

**Fenux Labs—Gregg Noland**

**UN Migrations—Lessons Learned**

*After several Utility Network migrations, we have compiled a list of common issues found and how our proprietary migration process addresses them.*

**Frontier Precision—Dan Braun & David Siddle**

**High Accuracy GNSS Data Collection: Dialing in your Data's Coordinate System and Configuring Mean Sea Level Elevations**

*Field mobility has never been easier to integrate into your workflow through apps such as ESRI Field Maps or Survey123. Discover the options available when using ESRI's ArcGIS platforms to manage your team's field spatial data collection. This session will introduce you to the primary ways you can utilize ESRI's ArcGIS platform to digitally transform mobile staff's field initiatives. Learn how to integrate high accuracy GNSS workflows into your GIS data collection and how to be aware of coordinate system and HAE vs MSL elevation blunders.*

**Ayers Associates Inc—Nik Anderson**

**Infrastructure design and management utilizing geospatial technology**

*Learn how remote sensing and other geospatial tools are being utilized in the upper Midwest. From pre-design to maintenance, your projects can benefit from a geospatial approach as compared to conventional methods. Follow along while Nik educates on existing resources, expanding technology, and project design to help design and manage your utility infrastructure.*

**Subsite**

**SSP Innovations**

**Navigating the Esri Utility Network: Simplifying Your Migration**

*Are you new to the Esri Utility Network, the next generation of modern network management, and wondering what it's all about? This webinar will help you grasp the fundamentals and walk you through the key steps involved in migrating from your current GIS to the Esri Utility Network. We'll explain what the Esri Utility Network is, why it's important for modern utilities of all sizes, and how you can transition to it without getting bogged down by time-consuming processes or overwhelming costs. We will also cover:*

- An overview of the Utility Network migration process and its essential components.
- Strategies to reduce migration time and focus on high-impact actions.
- Tools and techniques to effectively manage your utility's data in the new environment.
- Insights into what to expect post-migration and how to optimize your workflows.
- Whether you're just learning about the Utility Network or starting to plan your migration, this webinar will give you a clear, easy-to-understand roadmap for moving forward.

**WSB—Alex Johnson**

**Harnessing ArcGIS Notebooks, ArcGIS Data Pipelines, and Custom Feeds for Utility Data Integration**

*Discover how utilities can bring in near real-time data and large datasets into ArcGIS to improve operations and decision-making. This session will demonstrate how ArcGIS Notebooks, ArcGIS Data Pipelines, and custom data feeds (such as weather and sensor data) can work together to streamline workflows. You'll learn how to automate repetitive tasks, display up-to-date information on ArcGIS maps, and enhance processes like outage management and maintenance planning.*



## General Session Presentations – Thursday April 4

### Plenary

Mike Siedschlag

*In this group discussion we will focus on you and how you are or plan to use GIS, discuss challenges you face and what you're Utilities future GIS plans are. How are you using GIS currently? What challenges are you encountering? What projects are you working on? What do you want to implement but need assistance with? What is your GIS plan or initiatives for next year, five years and ten years?*

## Keynote Presentations

Pat Hohl—Director, Electric Industry Solutions—Esri

## Beginner Breakout Sessions

### RTK Locators & ESRI

Jessie Lloyd—City of Fairmont

*Keeping up with changes in the field can be challenging and time consuming. Now with new laws in Minnesota it's even more important to get our utilities accurately mapped in a timely manner. Thankfully, technology can help with some of field work involved with keeping our maps up to date. Locators, a tool we use every day, can be equipped with high precision GPS equipment to quickly map new and old utilities. This presentation will hopefully provide some information on a few important areas. First, what locator is the best one for you. Second, what sort of other equipment you might need. Third, how to get the information from the locator to your environment. Lastly how to make the information from your equipment work in your environment.*

### ERMU use of ArcGIS field apps

Angela Hauge—ERMU

*Data accuracy is the most important thing in our world of utilities. Safety, planning, efficiency and increasing reliability of services all rely on GIS data. Leaders are beginning to see the value and necessity in the GIS realm and the data to make decisions was wanted last week. Come join in on this presentation to see some of the fundamentals in field apps for all types of end-users. Offer up ideas on what you've encountered and what helps the everyday workflow with utilizing apps and thinking through some bumps in the road of data capture, so peers can be aware for their mapping goals.*

### 2024 Excavation Law Changes

Dave Hunstad—Hutchinson Utilities Commission

*2024 Minnesota One Call Law Changes: The Minnesota state statute 216D one call law is getting updated, here is what you need to know.*

### Designing labels and pop ups with Arcade in ArcGIS Pro

Robert Borchert—GRE

*Maplex Label Engine dramatically changed the way we worked with labels. It allowed for Python, VB Script, Jscript, and HTML markups. As wonderful as it was you often had to set up numerous labeling classes to accommodate for differences in color, font, variables, and sometimes definition queries and multiple instances of the same Feature Class.*

*Now with ArcGIS Pro we have the opportunity to create simple to complex labeling schemes that will run faster in your online environment and can easily be modified. ArcGIS Pro has added the use of Arcade Script.*

*Arcade Script can be used for simple to complex scripting and expressions for labels and Popups. It can be used to create expressions.*

*This presentation will focus on some basic Arcade scripts for creating labels and will touch on the use of Arcade in popups.*

### High Accuracy GNSS Construction/Maintenance Workflows

Todd Copeland—Moorhead Public Service

*In the presentation we will review the construction process from proposed design projects, to in-construction, and final as-builts utilizing Trimble R2 and Trimble Catalyst DA2 receivers with Esri Field Maps on iPads.*



## Intermediate and Advanced Breakout Sessions

### **Performance tuning of ArcGIS Enterprise**

Mike Siedschlag—GRE

*If you are utilizing ArcGIS Enterprise for your organization, are you getting the best performance out of the software? In this presentation we will explore ways to tune and configure services, resource scaling and performance, and monitoring your enterprise with ArcGIS Monitor.*

### **Migrating your GN to UN**

Kyle Crawford—Esri

### **Utility Network Embedded with Asset Management**

Dhruv Thakkar—City of Oconomowoc Utilities and Tyler Caulum—WPPI

*Due to the technology improvement in recent years, electric utilities are having questions about design tools and asset management. Although the ESRI Utility Network provides valuable electric infrastructure visualization through its extensive mapping capabilities, asset management is also needed for the engineering operations as well. In our presentation, we will show you how ESRI electric utility network can work with an asset management effectively. This presentation will also help other organizations to think about their electric drawings (one line/three line) and how it can be imported into engineering analysis software such as Milosft (Windmil).*

### **Experience Builder**

Maegan Caouette—GRE

*Experience Builder is a great way to create, manage and deploy web applications. Great for both ArcGIS users who are constructing the experiences as well as the end-users engaging with the applications.*

### **Field Survey of Joint Use Pole Attachments and NESC Clearance Violations**

Ann Liebenow-Anttila—RPU

*After Rochester Public Utilities updated their standard joint use attachment contract, one attacher balked at signing. As part of the negotiation to get them to sign the new document, RPU committed to conducting a Joint Use Pole Attachment Survey, the cost of which would be proportionally shared with all pole attachers. This first ever for RPU survey was conducted by a contractor in the last half of 2023, in conjunction with a first ever for RPU NESC Clearance Violation survey. Lessons learned will be presented.*

*"Don't repeat other peoples' mistakes. Make your own!" Ann's father*



## General Session Presentations – Friday April 5

### Business Meeting

MWEUUG Committee

*We look to the users to provide direction for next year's conference. What should we change or better improve upon? What are your likes and dislikes about the conference. What topics do you want to hear presented on? We will also show you the ArcGIS Ideas page and how we can be an influence on the direction of Esri's development team. Announce next year's venue and host utility.*

### Utility Presentations

#### UAS Lightning Round Talks

Jeff Grussing

*Discuss UAS users group, Drone imagery into Esri and other topics*

Technology/Hardware for field collection panel discussion

Utility Network panel discussion

GIS showcase—bring your own device and show us what you are doing with GIS

*Field Maps*

*Survey123*

*Experience Builder/Dashboards*

*Web maps/apps*

*Quick Capture*

*Workforce*

## Conference Survey

Use this link <https://arcg.is/1WfCfn> or the QR Code Below to access the conference survey.

