

24th Annual Midwest Esri Utility User Group Conference



April 2-4, 2025
Mayo Clinic Health System Event Center
 1 Civic Center Plaza - Mankato, MN 56001



- Hosted By -



Preliminary Agenda

Hotel Information

A block of rooms has been reserved at: Hilton Garden Inn

Address: 20 Civic Center Plaza,
Mankato, MN 56001

Phone: (507) 344-1111

Rooms must be reserved by Wednesday March 5th to receive the group rate of \$149. After 3/5/2025 any rooms reserved will be subject to availability, their Best Available Rate, and the Group Rate will not be honored.

Mention **Midwest ESRI Utility Users Group (MWEUUG)** conference when making your reservation

General Conference Information

We will be utilizing the Banquet Hall West for the main presentation location, the Ellerbe Room and Banquet Hall East will be used for breakout presentations and the Vendor Hall will be located in the thoroughfare between the Banquet Hall and Ellerbe Room throughout the MWEUUG conference.

Please direct any questions to Mike Siedschlag at msiedschlag@greenergy.com or James Huffman at jhuffman@riverlandenergy.com

Wednesday, April 2, 2025

Track 1	GIS Beginners Classes
Track 2	GIS Intermediate & Advanced Classes
	Sponsor Presentations

11:30 am - 4:30 pm	Registration
12:00 pm - 12:30 pm	Davey Resource Group
12:30 pm - 1:00 pm	Leica Geosystems
1:00 pm - 1:30 pm	Power System Engineering
1:30 pm - 2:00 pm	Fenix Labs
2:00 pm - 2:30pm	Frontier Precision
2:30 pm - 2:45 pm	Afternoon Break
2:45 pm - 3:15 pm	Star Energy Services
3:15 pm - 3:45 pm	Ayres Associates Inc
3:45 pm - 4:15 pm	OpenPoint
4:15 pm - 4:45 pm	TBD
4:45 pm - 5:15 pm	TBD
5:30 pm - 8:00 pm	Vendor Hall Evening Social

MAYO CLINIC HEALTH SYSTEM EVENT CENTER

- Main Staff Offices
- Box Office
- Secondary Box Office
- Arena
- Meeting Spaces
- Loading Docks
- Dressing/Green Rooms
- Restrooms
- Stairs
- Elevators

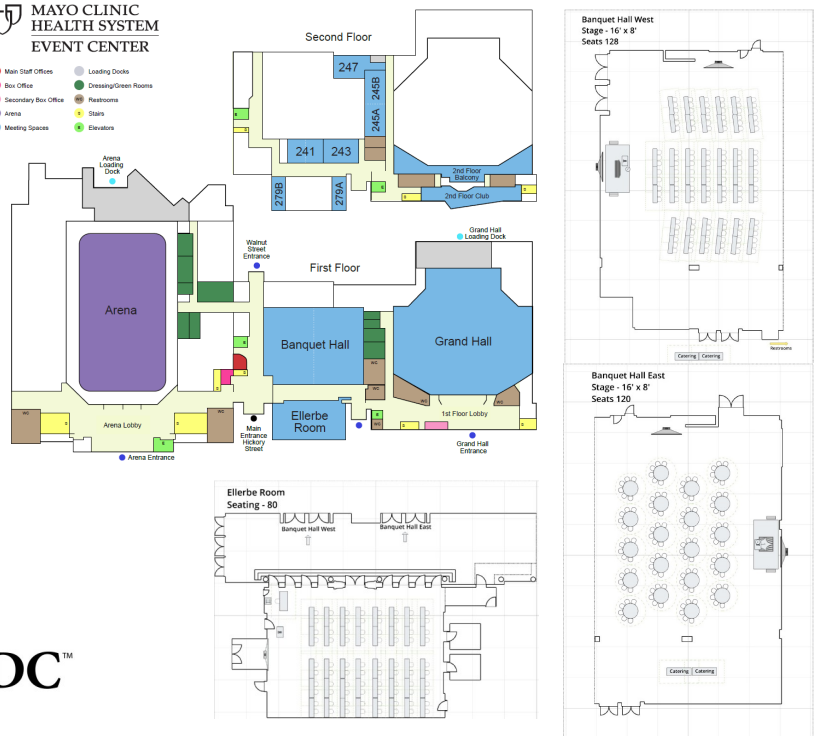

Thursday, April 3, 2025

8:00 am - 8:05 am	Welcome - General Assembly	
8:05 am - 9:00 am	Plenary Session - Introductions	
9:00 am - 10:00 am	Keynote Presentation – Pat Hohl—Director, Electric Industry Solutions—Esri	
10:00 am - 10:15 am	Morning Break	
10:15 am - 12:00 pm	Esri Utilities overview - Keith Krall and Tom DeWitte	
12:00 pm - 1:00 pm	Lunch Break	
1:00 pm - 1:30 pm	Locator & GPS - lessons learned Jessie Lloyd—City of Fairmont	Performance tuning of ArcGIS Enterprise Mike Siedschlag—GRE
1:30 pm - 2:00 pm	ERMU use of ArcGIS field apps Angela Hauge—ERMU	Migrating your GN to UN Tom DeWitte—Esri
2:00 pm - 2:30 pm	Esri UN is a 4-letter word Steve Hanson—Detroit Lakes	Electric UN, Windmill and Asset Management Dhruv Thakkar— City of Oconomowoc Utilities and Tyler Caulum—WPPI
2:30 pm - 2:45 pm	Afternoon Break	
2:45 pm - 3:15 pm	Designing labels and pop ups with Arcade in ArcGIS Pro Robert Borchert—GRE	Experience Builder Maegan Caouette—GRE
3:15 pm - 3:45 pm	Workflows for construction/repair Todd Copeland—MPS	Field Survey of Joint Use Pole Attachments and NESC Clearance Violations Ann Liebenow-Anttila—RPU
3:45 pm - 4:00 pm	Afternoon Break	
4:00 pm - 5:00 pm	Peer to Peer session – James Huffman (moderator) You have questions, your peers have answers! Prepare your questions and get ready to learn something new!	
Group Dinner and Social		

Exhibits Open at Breaks

Friday, April 4, 2025

8:00 am - 9:00 am	MWEUUG Business Meeting / Q & A Session
9:00 am - 9:15 am	Morning Break
9:15 am - 11:45 am	UAS Lightning Round Talks <ul style="list-style-type: none"> Discuss UAS users group, Drone imagery into Esri, etc. Technology/Hardware for field collection panel discussion Utility Network panel discussion GIS Showcase—bring your own device and show us what you’re doing with GIS
11:45 am	Adjourn