

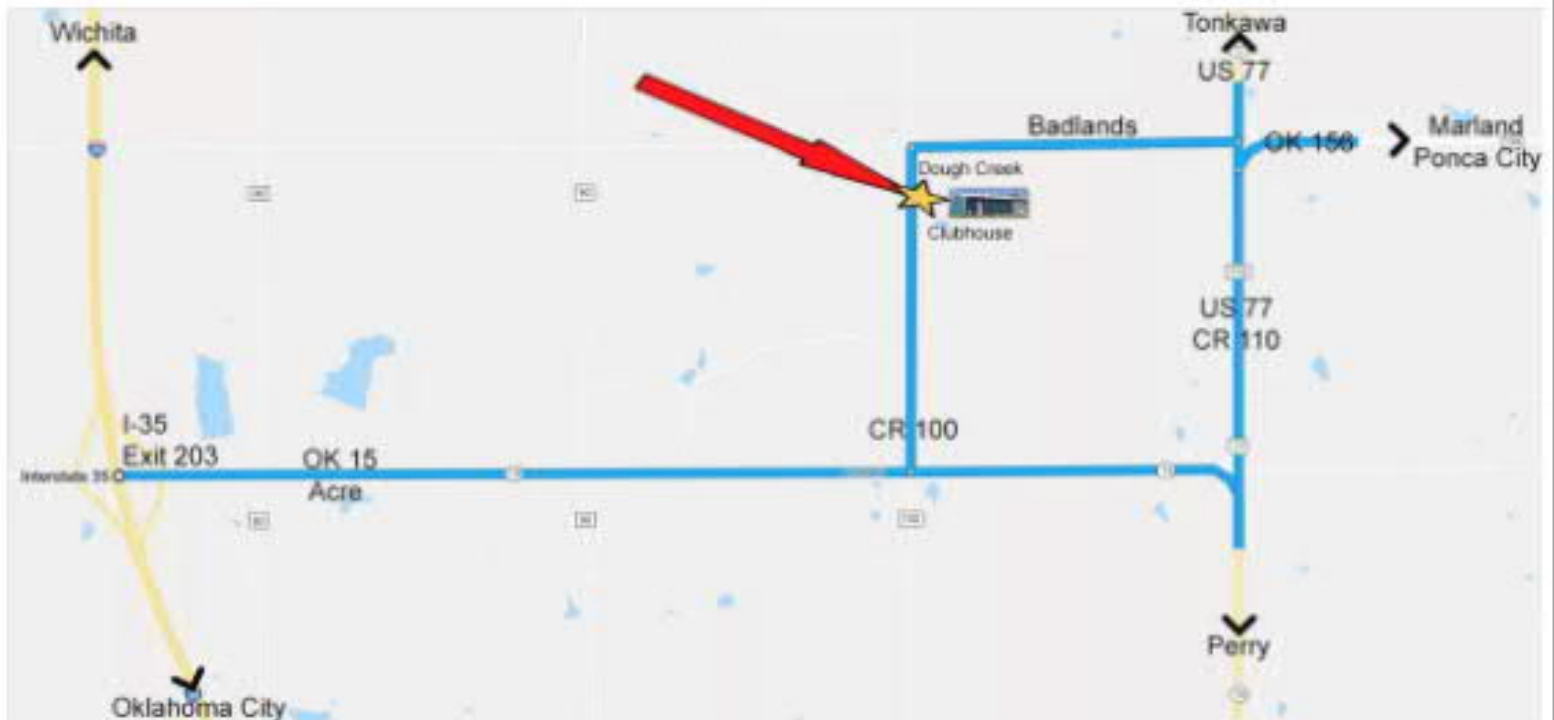

WELCOME TO THE DOUGH CREEK SHOOTING CLUB - IT'S A NICE DAY FOR SHOOTING!

DRIVING DIRECTIONS FROM:



Ponca City, Oklahoma

Drive South from Ponca City on OK-156. Proceed through Ranch Drive and Marland until you reach the end of OK-156 at US-77. Drive one mile West on "Badlands" and go South 1/4 mile and turn left into the second driveway. Note: "Badlands" is an all-weather county road. The road sign is usually missing.

Tonkawa, Oklahoma

Drive South from Tonkawa on US-177 10 miles. Turn Right on "Badlands". Drive one mile West on "Badlands" and go South 1/4 mile and turn left into the second driveway. Note: "Badlands" is an all-weather county road. The road sign is usually missing.

Perry, Oklahoma

Drive North on US-77 to the intersection of US-77/OK-156. Turn Left on "Badlands". Drive one mile West on "Badlands" and go South 1/4 mile and turn left into the second driveway. Note: "Badlands" is an all-weather county road. The road sign is usually missing.

From Other Places

From the I-35 Exit 203 (Phillips 66/Dairy Queen-Subway truck stop) proceed 2-1/2 miles (to the third intersection) East on OK-15. Turn Left (North) on CR100 (an all-weather county) road. Drive North on CR100 for 3/4 mile and turn Right (East) into the first driveway.