



VC999[®]

SERIES ROLL STOCK MACHINE

HIGH-PERFORMANCE PACKAGING MACHINE.



MADE IN THE USA



**STANDS FOR
INNOVATION!**





INTRODUCING THE NEW GENERATION OF THERMOFORMING TECHNOLOGY.



- ◆ The **i-Software** designed to navigate the HMI machine interface with ease.
- ◆ Swing-arm mounted 12.1 LED back-lit color HMI machine interface.
- ◆ IP65 stainless steel enclosure.
- ◆ Windows XPe operating system.
- ◆ Intelligent Buss terminal system with integrated diagnostics.



- ◆ The **i-Feed** servo-controlled, forming and lidding film unwinds with linear actuator for optimal unwind tension control.
- ◆ Electro-pneumatic regulated for optimal tensioning control and to minimize contamination.
- ◆ Trapeze free linear **i-Dancer** Roller System.
- ◆ Sanitary mandrel roller design.



- ◆ Stainless steel, slip-shaped **i-Panels**.
- ◆ Aesthetic robust side panel design.
- ◆ Easy machine access by tilt out or complete **i-Panel** removal.



INTERCONNECTED

The **i-Series** thermoformer runs on a reliable PLC platform. **i-Software** is design to navigate the HMI machine interface on an industrial PC with ease.

INTEGRATED

Mechanical direct-drive design, Servo-driven, advance system for high speed and accuracy. 2kW Servo motor (9.55 Nm continuous torque / 28.6 Nm maximum torque). Communications to the Servo amp is over the field bus to make the system immune to noise (a VFD version is also available.). The motion profile is fully programmed through the HMI (distance, acceleration, deceleration).

IRRESISTIBLE

The **i-Series** features a smooth, satin hand finish to exceed hygiene requirements with a high RA (root average). The design also features a corner and recess-free design for easy cleaning and sterilization.



INTELLIGENT

Comprehensive zone-specific safety design utilizes PLC-controls, less connection points, less wiring, easy to maintain and troubleshoot. Ultra high speed, Gigabit Ethernet Field Buss CC link IE field, 10 times faster communication speed. Real time protocol enables control of remote I / O field devices with essentially no transmission delay.

INNOVATIVE

The **i-Frame** has a unique corner free **i-Frame** construction, modular, flexible, highly customizable concept to accommodate current and future requirements. All stainless double stage, independent **i-Lift** construction. Lubrication free composite IGUS bearings. Tunnel guard design for discharge safety. Unique modular, dome shaped with heavy duty lifting doors for dual side access.

PACKAGING TYPES

VACUUM

SHRINK

TOP SEAL

MAP

EASY PEEL

I-SERIES RUNS FLEXIBLE, RIGID, SEMI-RIGID, & SHRINK FILMS

INDUSTRY LEADERSHIP FROM A GLOBAL TEAM.



- ◆ Easy access to each dedicated **i-Cabinet** section.
- ◆ All **i-Cabinets** feature a swing out pneumatic panel for easy maintenance.
- ◆ Specially designed **i-Closing** mechanism assure tight closing, IP65 wash down rated.
- ◆ Reduce your lifecycle costs with readily available, open source parts.



- ◆ With Sanitation in mind, unique open sanitary **i-Frame** architecture for the best visibility and access into the machine.
- ◆ Corner free **i-Frame** design which eliminates standing water for a true wash down machine.



- ◆ Independent forming and sealing LLP **i-Lift Stations**. (patent pending)
- ◆ Programmable **i-Lift Stations** LLP (Lift, Lock, Pressure) generates up to 15 tons of closing force via advanced intensifier technology. (patent pending)
- ◆ No die shimming needed to process thin or thick thermoforming films.
- ◆ Low maintenance, no grease lubrication required via IGUS composite bearings.

INTRODUCING THE NEW GENERATION OF THERMOFORMING TECHNOLOGY.



- ◆ Rollers are open for wash through and to accomplish the best hygienic design.
- ◆ The **i-Series** can be positioned up to 200 mm above the floor.



- ◆ Most cables are running outside the **i-Frame** for easy access and troubleshooting.
- ◆ Cross machine wiring, stainless cable organizer allows easy access and wash through to avoid contamination.



- ◆ The **i-Series** is designed to be transported in sections for ease of shipment and on-site installation.
- ◆ The **i-Series** offers unprecedented post installation expandability to adjust machine specifications and capabilities as production demands change.



INCLUSIVE

Machine documentation specifically configured to each machine, easily accessible online, on CD or in a manual format.

IDEAL

The **i-Series** combines industry-leading technology to achieve superior safety and sanitation levels. The support team is responsive and globally accessible. The low maintenance design makes the machine even more affordable.

INTERNET

The Internet and USB connections utilize VPN, video communication, and remote-program loading to communicate directly with VC999 service engineers.



INCREDIBLE

The new **i-Series** thermoformer from VC999 comes with an industry leading, comprehensive 2-year / 2 million cycle warranty. Designed with maintenance in mind, the machine offers great accessibility.

INTERNATIONAL

Built to exceed the highest global safety, hygiene and sanitation standards. Designed on a multi-lingual platform. Power requirements match any standard electrical system.

INFORMATION

A comprehensive MIS (management information system) monitors production, alarm data acquisition and data storage features via PC or cellular device. The VC999 Industrial LAN Router allows for remote internet access. The router detects the IP address automatically. International training available on-site or at our Switzerland and US manufacturing centers. Easy access to service manuals online, on CD or in print. Real-time assembly QA documentation, maintenance logs and service history available online throughout the life of the **i-Series** machine.

IDEAS THAT DRIVE MAINTENANCE & SERVICE SOLUTIONS.



- ◆ VFD tension controlled automatic powered trim wind up wheels.
- ◆ Operated via interface and information stored for each product.
- ◆ Operator-friendly, tilt out wheel design.
- ◆ Quick-release side plates for quick trim removal .



- ◆ Sanitary chain and rail design utilizes heavy-duty industrial chain with 360 degree cleaning to reduce chain stretch and eliminate potential contamination.
- ◆ Chain tensioning system is easily accessible, and located at the end of the machine.



- ◆ Maintenance friendly vacuum valves are easily accessible.
- ◆ Service areas designed for quick and easy access to reduce maintenance time and costs.



- ◆ Form and seal **i-Safety** covers are made out of stainless 300 series, dome shaped design and made for toolless removal.
- ◆ The **i-Series** discharge area includes an innovative tunnel guard and interlocking **i-Safety** covers.



- ◆ All tooling is manufactured with high-precision Five Axis CNC equipment.
- ◆ These advanced capabilities allow even the most complex tooling requirements to be made from single block aluminium.



- ◆ All **i-Cabinet** surfaces and virtually all other areas inside and outside the machine are designed with a 3-5 degree slope to aid in runoff and keep the machine cleaner.



INVESTMENT

Designed with lifecycle costs in mind. The **i-Series** is more economical due to an open source parts concept, lower utility costs, fewer moving parts and a lower part consumption rate.

INDUSTRIAL

Seal die and form die tops are machined from solid blocks of aluminum. The heavy-duty 5/8" pitch chain is robust, sturdy, and designed for a tough environment.

INDIVIDUAL

The modular design of the **i-Series** can be customized to fit your needs, then easily modified for production changes and future growth.



Machine Length: 6000
Discharge: 900 mm Min. *
Forming/Loading: 2040 mm Max.

- Sealing station can be moved to increase discharge length by 300 mm increments and reduce loading length by 300 mm based on application requirements.

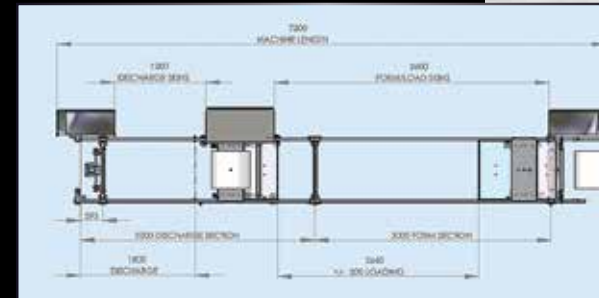

Machine Length: 7200
Discharge: 1500 mm Min. *
Forming/Loading: 2640 mm Max.

- Sealing station can be moved to increase discharge length by 300 mm increments and reduce loading length by 300 mm based on application requirements.

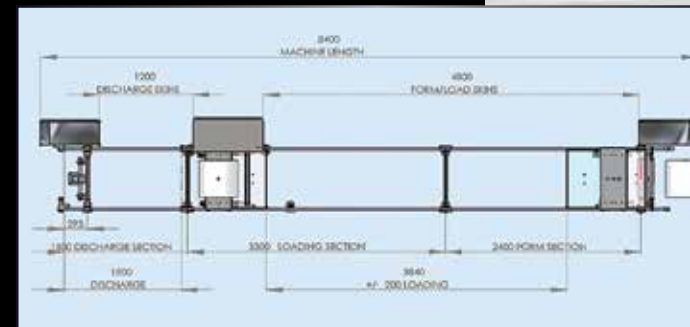

Machine Length: 8400
Discharge: 1500 mm Min. *
Forming/Loading: 3840 mm Max.

- Sealing station can be moved to increase discharge length by 300 mm increments and reduce loading length by 300 mm based on application requirements.

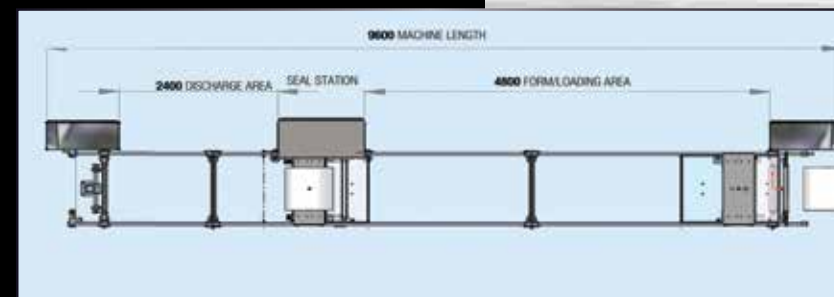

Machine Length: 9600
Discharge: 2400 mm Min. *
Forming/Loading: 4800 mm Max.

- Sealing station can be moved to increase discharge length by 300 mm increments and reduce loading length by 300 mm based on application requirements.

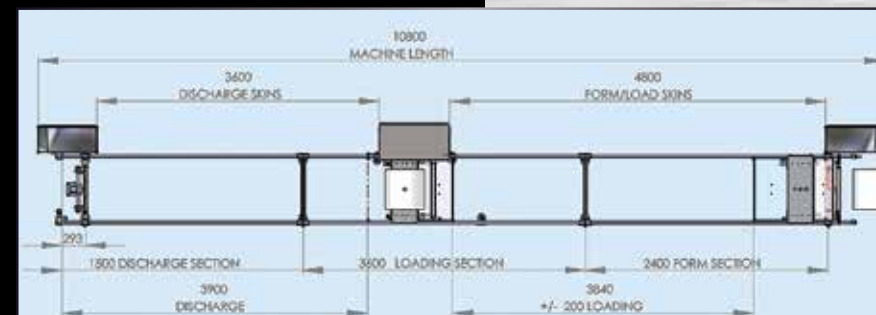

Machine Length: 10800
Discharge: 2400 mm Min. *
Forming/Loading: 4800 mm Max.

- Sealing station can be moved to increase discharge length by 300 mm increments and reduce loading length by 300 mm based on application requirements.

SPECIFICATIONS

Standard Machine Web Widths:

285 mm 320 mm 355 mm 420 mm 459 mm 520 mm
 560 mm 620 mm 660 mm 720 mm 760 mm 820 mm

Machine Widths:

i285/320 1155 mm **i**355/420 1255 mm **i**459/520 1355 mm
i560/620 1455 mm **i**660/720 1555 mm **i**760/820 1655 mm

Custom Machine Web Width:

Increments of 5 mm from 320 to 720 mm

Standard Machine Lengths: 6000 / 7200 / 8400 / 9600 / 10800 mm
 (length can be extended in increments of 1200 mm to max 19200 mm)

Machine Height: 1850 – 2050 mm

Index Length Maximum: 1200 mm

Forming Draw Depth: 50 / 100 / 135 / 185 / 225 mm

Standard Unwind: Roll Diameter 500 mm / Max. weight 95 kg

Jumbo Unwind: Roll Diameter 1000 mm

Electrical Connection:

220V/3/60hz / 220V/3/50hz / 400V/3/60hz
 400V/3/50hz / 460V/3/60hz

Compressed Air: Minimum 7 bar

Cooling Water: Usage depends on machine configuration.

**UNITED STATES: VC999 PACKAGING SYSTEMS****SALES@VC999.COM**

KANSAS CITY, MO - 419 E. 11th Avenue, North Kansas City, MO 64116
CLEVELAND, OH - VC999 Materials - 33442 Liberty Parkway, North Ridgeville, OH 44039
EDGERTON, WI - VC999 Materials - 43 HWY 51 N, Edgerton, WI 53534
SANTA CLARITA, CA - VC999 Materials - PO Box 801776, Santa Clarita, CA 91380

PHONE: +1 816-472-8999, FAX +1 816-472-1999**CANADA: VC999 CANADA LTD.****SALES.CANADA@VC999.COM**

MONTREAL, QC - 153 Sylvestre, Saint-Germain-de-Grantham, Quebec, J0C 1K0
TORONTO, ON - 2150 Winston Park Drive, Unit 7, Oakville, Ontario, L6H 5V1

TEL +1 819-395-4555, FAX +1 819-395-6444**MEXICO: VC999 PACKAGING SYSTEMS AMERICAS****SALES.MEXICO@VC999.COM**

MONTERREY - Río Escondido 862, Industrial La Silla, 67190 Guadalupe, N.L. Tel/Fax +52 81 8361 5349
MEXICO CITY - Evolution Park, Bodega 9 Calle Arbolitos S/N Barrio Texcacoa, Tepotzotlán, Estado de México C.P. 54605

TEL +52 (55) 58767784**CENTRAL & SOUTH AMERICA: VC999 PACKAGING SYSTEMS AMERICAS****SALES.AMERICAS@VC999.COM****TEL +49 162 24 34 627****COLOMBIA: VC999 PACKAGING SYSTEM COLOMBIA S.A.S.****SALES.COLOMBIA@VC999.COM**

BOGOTA - Parque empresarial Portos sabana 80, Bodega 18, Km 2,5 Autopista Medellin, Cota, Cundinamarca, Colombia

TEL +57 (1) 8966546 OR +57 (1) 8966798,**SWITZERLAND: VC999 VERPACKUNGSSYSTEME AG****INFO@VC999.CH**

HERISAU - Melonenstrasse 2, CH-9100 Herisau

TEL +41 71 35 35 900, FAX +41 71 35 35 901**GERMANY: VC999 VERPACKUNGSSYSTEME GMBH****INFO@VC999.DE**

ENGEN - Industriestrasse 10, D-78234 Engen
Tel +49 7733 948 999, Fax +49 7733 948 998

AUSTRALIA: BAUMANN ENGINEERIG PTY.LTD.**SALES@BAUMAN-INDUSTRIES.COM**

SYDNEY - 8 Powys CTT Castle Hill NSW 2154
Tel: + 61 (02) 720 521 70

**PACKAGING** plus⁺**VC999** materials