



Complete Rebuild Kit for all Power-Pole® Models (Excluding the 8' and 10' Blade Edition)

Hardware:

- A. Qty. (2) 3/8" x 3.5" Bolts
- B. Qty. (6) 5/16" x 3.5" Bolts
- C. Qty. (1) 1/4" x 3.5" Bolts
- D. Qty. (2) 1/4" x 2" Bolts
- E. Qty.(4) 3/8" Bushings (stern bracket)
- F. Qty. (8) 3/8" Bushings (u-channel)
- G. Qty. (4) 3/8" Bushings (small outer)
- H. Qty. (4) 3/8" Washers
- I. Qty. (2) 3/8" Lock Nuts (thin)
- J. Qty. (16) 5/16" Bushings (u-channel & stern bracket)
- K. Qty. (12) 5/16" Bushings (small outer)
- L. Qty. (12) 5/16" Washers
- M. Qty. (6) 5/16" Lock Nuts (thin)
- N. Qty. (2) Large Ram Spacers
- O. Qty. (2) Tubing Teflon
- P. Qty. (1) 1/4" Lock Nut (thin)
- Q. Qty. (6) 1/4" Bushing (small white)
- R. Qty. (2) 1/4" Bushing (short white)
- S. Qty. (1) 1/4" Bushing (long white)
- T. Qty. (6) 1/4" Washers
- U. Qty. (2) 1/4" Lock Nut (tall)
- V. Qty. (2) Small Ram Spacers

Installation Tools:

- 7/16", 1/2" and 9/16" Wrench with Socket & Ratchet depending on model
- Drill with 3/8" steel drill bit
- Pliers
- Small Rubber Mallet Hammer
- Torque Wrench

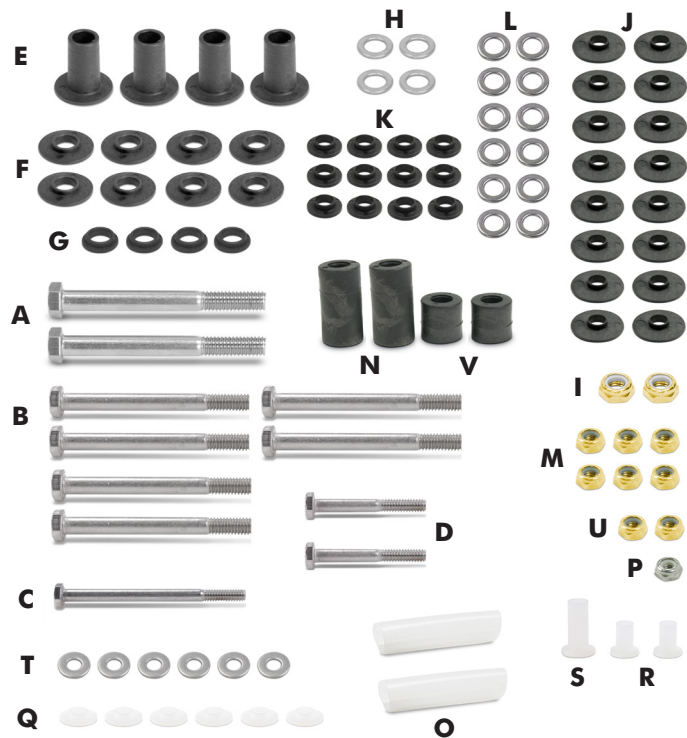

Follow Sections 1-6 specific to your Power-Pole make and model.

Hardware

Shown Actual Size

3/8" x 3.5" Bolt

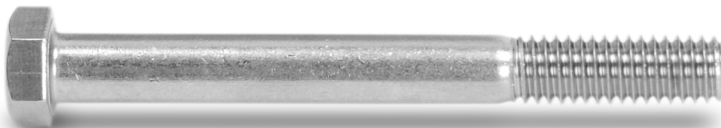

5/16" x 3.5" Bolt



1/4" x 3.5" Bolt



1/4" x 2" Bolt



3/8" Washer



3/8" Nylon Lock Nut



5/16" Washer



5/16" Nylon Lock Nut



1/4" Lock Nut



3/8" Bushing (stern bracket)



3/8" Bushing (u-channel)



3/8" Bushing (small outer)



Tubing Teflon



1/4" Bushing (small white)



1/4" Bushing (short white)



1/4" Bushing (long white)



1/4" Washer



1/4" Nylon Lock Nut



Large Ram-spacer



Small Ram-spacer



5/16" Bushing (u-channel & stern bracket)



5/16" Bushing (small outer)

Section 1

Knuckle Bolt Set 5/16" (Upper or Lower)

Compatible with the following:

All Power-Pole models excluding Blade Series 8' & 10'

NOTE: If existing Power-Pole knuckle has 1/4" bolt you will need to drill it out with 3/8" steel drill bit.

Installation Instructions:

Step 1 Lower the Power-Pole down to the ground so that the Power-Pole Everflex™ spike is touching the ground.

Warning: Be careful not to touch the spike with bare hands because the spike may become fibrous after sun exposure and use.

Step 2 Remove old bolt and bushings with installation tools.

Step 3 Insert large black bushings (J) with small flange facing the hole of the u-channel **Fig. 1** section 1.1 and knuckle joint section 1.2

Step 4 Place washer (L) onto bolt (B) followed by placing the flat side of bushing (K) against washer (L).

Step 5 Install knuckle in-between u-channel **Fig. 1** with flat side of bushings (J) touching and aligning the hole.

Step 6 Insert the bolt (B) through the u-channel and knuckle joint.

Step 7 Put bushing (K) onto bolt (B) with small flange facing toward the u-channel hole.

Step 8 Place a washer (L) onto bolt end (B) and thread nut (M) on and tighten flush with end of bolt with no threads showing **Fig. 1A**

Figure 1

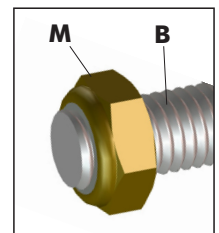
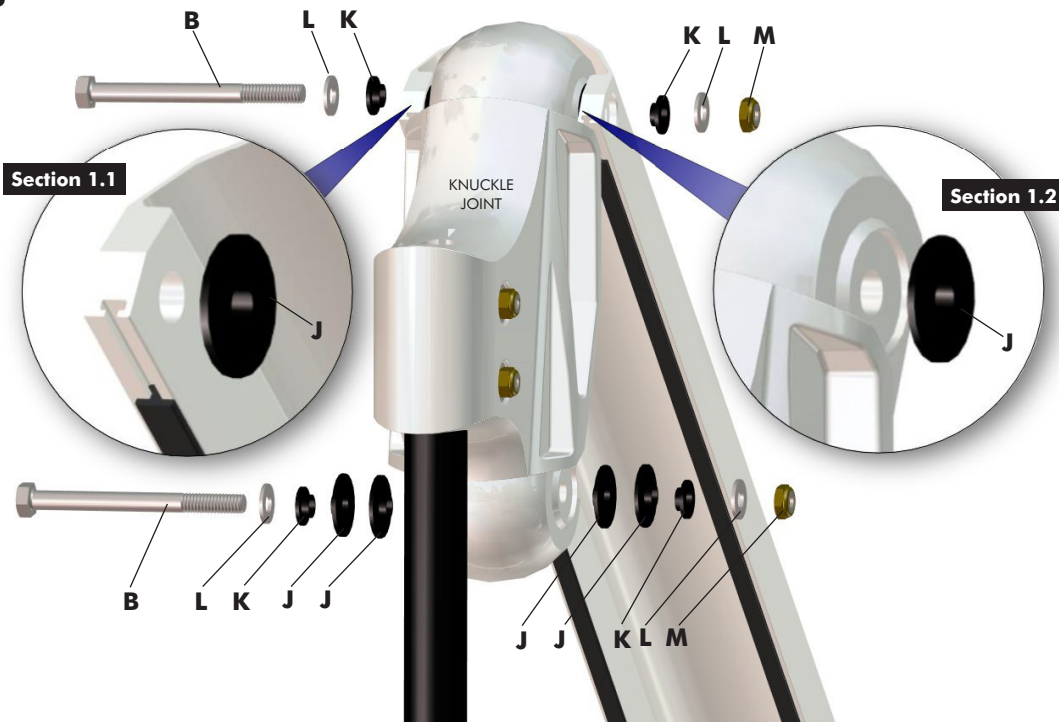

Figure 1A

Section 2

Cylinder Bolt Set for 5/16"

Compatible with the following:

All Power-Pole models excluding Blade Series 8' & 10'

Installation Instructions:

Step 1 Lower the Power-Pole down to the ground so that the Power-Pole Everflex™ spike is touching the ground.

Warning: Be careful not to touch the spike with bare hands because the spike may become fibrous after sun exposure and use.

Step 2 Remove old bolt and bushings with installation tools.

Step 3 Place washer (L) onto bolt (B) followed by placing the flat side of bushing (K) against washer (L).

Step 4 Insert bolt (B) through u-channel and large ram spacer (N) **NOTE: Large ram spacer should be on the same side as the 90 degree fitting on cylinder.**

Step 5 Push remaining bolt (B) on through hydraulic cylinder ram, small bushing ram spacer (V) and u-channel.

Step 6 Put bushing (K) onto bolt (B) with small flange facing in toward the u-channel hole.

Step 7 Place a washer (L) onto bolt end (B) and thread nut (M) on and tighten flush with end of bolt with no threads showing **Fig. 2A**

Figure 2

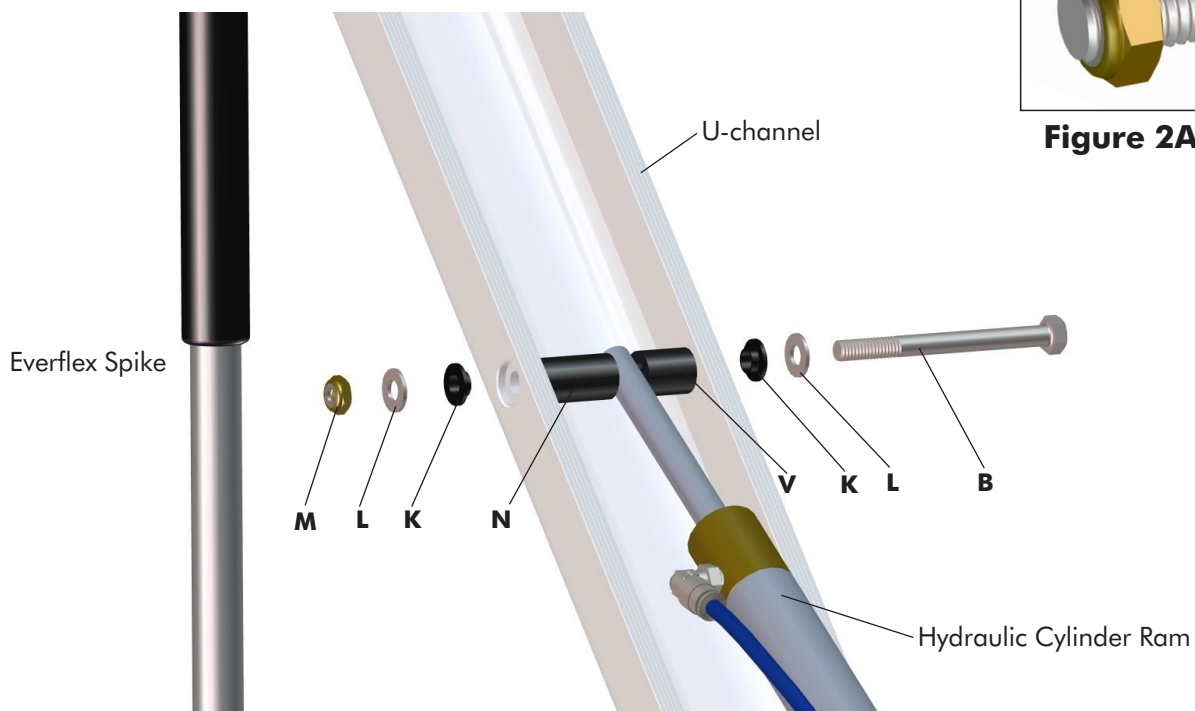

Figure 2A

Section 3

Stern Bracket Bolt Set 1/4" (Upper bolt only)

NOTE: For Lower 5/16" Bolt - Refer to instructions in (Section 4)

Compatible with the following:

- Power-Pole 6' 2008 & Earlier
- Power-Pole Sportsman Series 6' 2010 & Earlier

Installation Instructions:

Step 1 Lower the Power-Pole down to the ground so that the Power-Pole Everflex™ spike is touching the ground.

Warning: Be careful not to touch the spike with bare hands because the spike may become fibrous after sun exposure and use.

Step 2 Remove old 1/4" bolt, bushings and remove hydraulic cylinder from stern bracket only. Note: you do not need to disconnect hydraulic lines from hydraulic cylinder.

Step 3 Remove old bushing (R) from bottom of cylinder and replace with new bushing (R) **Fig. 1**.

Step 4 Insert bushings (R) and (S) into the stern brackets **Fig. 2** and **Fig. 4**.

Step 5 Insert bushings (Q) into the insides of u-channel with small flange facing towards hole. **Fig. 2** and **Fig. 4**.

Step 6 Put washer (T) onto bolt (C) followed by placing the flat side of bushing (Q) against washer (T).

Step 7 Install u-channel onto stern bracket **Fig. 3** with bushing touching and aligning each hole.

Step 8 Insert the bolt (C) through the u-channel, stern bracket, and hydraulic cylinder.

Step 9 Put small bushing (Q) onto bolt (C) with small flange facing in toward the u-channel hole.

Step 10 Place a washer (T) onto bolt end (C) and thread nut (P) on and tighten snug using standard hand tools.

Figure 1

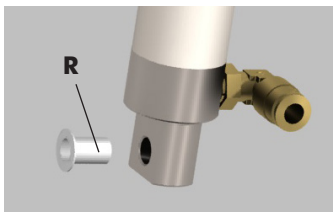

Figure 2

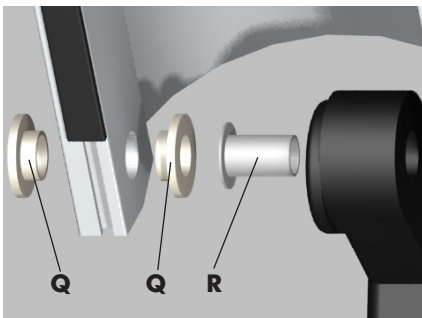

Figure 3

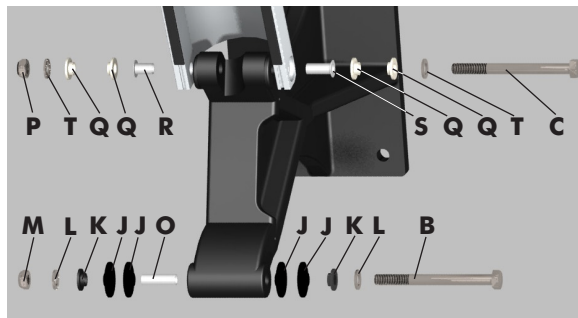
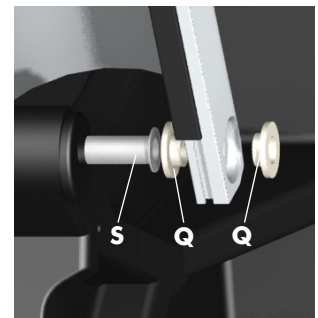

Figure 4



For lower 5/16" bolt refer to section 4

Section 4

Stern Bolt Set 5/16" (Upper or Lower)

Compatible with the following:

- Power-Pole XL 8' 2008 & Earlier
- Power-Pole Pro Series 6' , 8' 2009 & Earlier
- Power-Pole Sportsman Series 8' 2009 thru 2011
- Power-Pole Sportsman Series 6' 2009 & 2010 – *NOTE: Lower Stern Bracket Bolt Only*

Installation Instructions:

- Step 1** Lower the Power-Pole down to the ground so that the Power-Pole Everflex™ spike is touching the ground.
Warning: Be careful not to touch the spike with bare hands because the spike may become fibrous after sun exposure and use.
- Step 2** Remove old bolt, bushings and nut with installation tools.
- Step 3** Drill out old tubing stern bracket Teflon with 3/8" steel drill bit and replace with the new Teflon (O).
- Step 4** Insert bushings (J) into both sides of stern bracket holes with small flange facing in towards holes.
- Step 5** Insert bushings (J) into the insides of u-channel with small flange facing in towards hole of u-channel.
- Step 6** Install the u-channel on the stern bracket with flat sides of bushings (D) touching and aligning the hole.
- Step 7** Place washer (L) onto bolt (B) followed by placing the flat side of bushing (K) against washer (L).
- Step 8** Insert the bolt (B) through the u-channel and stern bracket.
- Step 9** Put bushing (K) onto bolt (B) with small flange facing in toward the u-channel hole.
- Step 10** Place a washer (L) onto bolt end (B) and thread nut (M) on and tighten snug using standard hand tools.

Figure 4

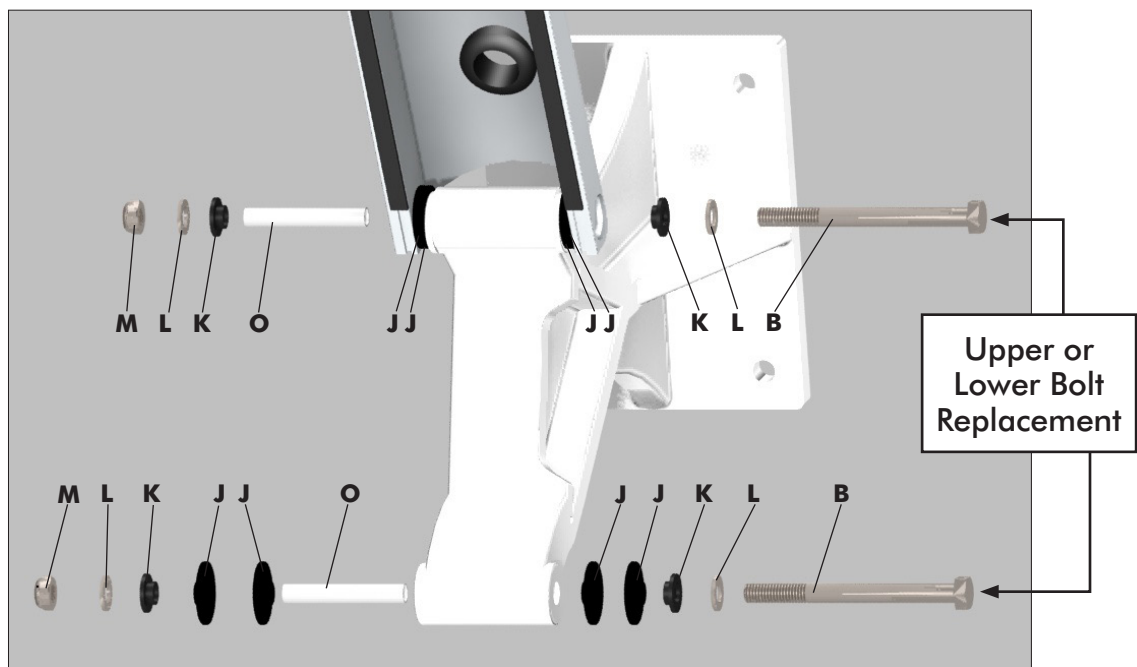

Section 5

Bolt Set Stern Bracket 3/8" (Upper or Lower)

Compatible with the following:

- Power-Pole Pro Series 6' or 8' 2010 & 2011
- Power-Pole Signature Series 4', 6', 8' 2010 & 2011
- Power-Pole Pro II Series 6', & 8' 2012 & Later
- Power-Pole Signature Series 4', 6' 2012 & Later
- Power-Pole Sportsman II Series 8' 2012 & Later

Installation Instructions:

- Step 1** Lower the Power-Pole down to the ground so that the Power-Pole Everflex™ spike is touching the ground.
Warning: Be careful not to touch the spike with bare hands because the spike may become fibrous after sun exposure and use.
- Step 2** Remove old bolt, bushings and nut with installation tools.
- Step 3** Insert both bushings (E) into the stern bracket holes with smaller side facing inward toward holes **Fig. 5** section 5.2
NOTICE: If Sportsman II Series 8' use (F) instead of (E).
- Step 4** Insert both bushings (F) into the insides of u-channel with small flange facing in towards hole of u-channel **Fig. 5** section 5.1
- Step 5** Place washer (H) onto bolt (A) followed by placing the flat side of bushing (G) against washer (H).
- Step 6** Install U-channel on stern bracket **Fig. 5** with flat sides of bushings (E) and (F) touching and aligning the hole.
- Step 7** Insert bolt (A) through the u-channel and stern bracket.
- Step 8** Put bushing (G) onto bolt (A) with small flange facing in toward the u-channel hole.
- Step 9** Place a washer (H) onto bolt end (A) and thread nut (I) on and tighten snug using standard hand tools.

Figure 5

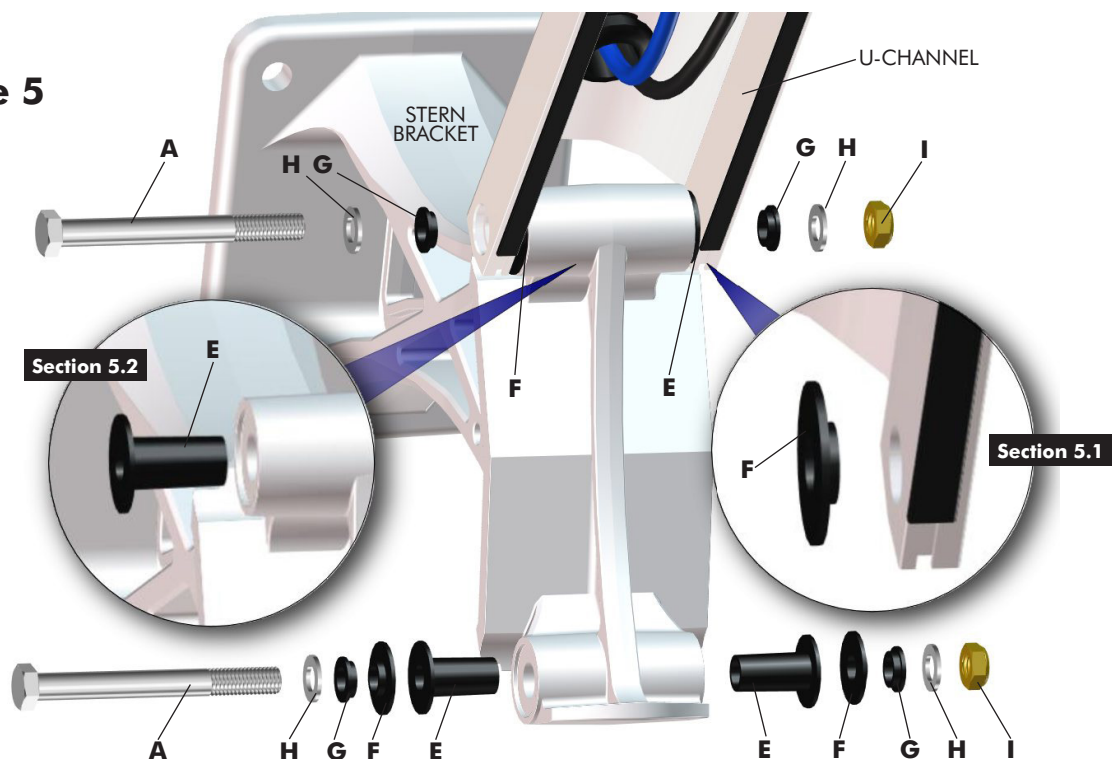

Section 6

Bolt Set for Spike (Replacement)

NOTE: Everflex™ Spike NOT included with rebuild kit.

To order visit an authorized dealer or call Product Support at 813-689-9932 opt 2 for a replacement if needed.

Compatible with the following:

All Power-Pole models excluding Blade Series 8' & 10'

Installation Instructions:

Step 1 Insert Everflex™ spike up into knuckle joint with grooves aligning the holes **Fig. 6** Section 6.1

Step 2 Place washer (T) onto each bolt (D).

Step 3 Insert bolts (D) through knuckle joint and Everflex™ spike. **NOTE: May require a small rubber mallet hammer to hammer bolt (D) on through knuckle joint and Everflex™ spike.**

Step 4 Insert white bushing (Q) onto each bolt (D) with small flange facing inward towards knuckle joint.

Step 5 Place washer (T) onto each bolt (D) followed by threading lock nut (U) on and tighten snug using standard hand tools.

Figure 6

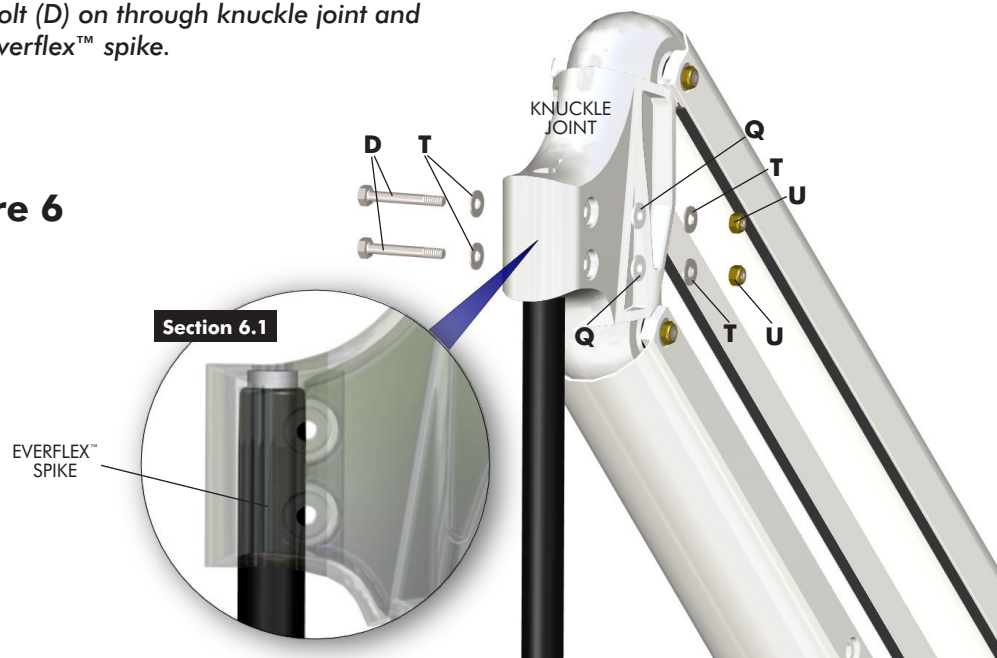

For Technical Support Call 813-689-9932 opt 2



Swift. Silent. Secure.

Product Quality Assurance

JL Marine Systems, Inc. assures that this product is made with the finest quality materials and is free from manufacturer defects. Please inspect this product prior to installation. If defects are apparent, please contact JL Marine Systems, Inc. Warranty Department at 813-689-9932 immediately. Please read all instructions carefully for proper product installation. JL Marine Systems, Inc. is not responsible for improper installation of product.

JL Marine
SYSTEMS, INC.

9010 Palm River Road, Tampa, Florida 33619 • phone 813.689.9932 • fax 813.689.8883 • power-pole.com