



# Complete Rebuild Kit for Power-Pole® Blade Models 8' & 10'

## Compatible with the following:

- Power-Pole Blade 8'
- Power-Pole Blade 10'

## Installation Tools:

- 7/16", 1/2" and 9/16" Wrench with Socket & Ratchet
- Pliers
- Spreader Block (included)
- Protective Gloves
- Small Rubber Mallet Hammer
- 1/4" Flat Punch

## Hardware:

- A. Qty. (5) 3/8" x 2.5" Bolts – Qty. (7) for 10' Model
- B. Qty. (2) 5/16" x 2.5" Bolts
- C. Qty. (2) 1/4" x 1.75" Bolts
- D. Qty. (5) 3/8" Nylon lock nuts – Qty. (7) for 10' Model
- E. Qty. (4) 3/8" Bushings (Inner Knuckle Joint)
- F. Qty. (8) 3/8" Bushing (Middle) – Qty. (12) for 10' Model
- G. Qty. (4) 3/8" Bearings (outside stern bracket)
- H. Qty. (10) 3/8" Washers – Qty. (14) for 10' Model
- I. Qty. (2) 5/16" Nylon lock nuts
- J. Qty. (2) Ram-spacers
- K. Qty. (2) 3/8" Bushings (opposite side of ram spacers)
- L. Qty. (4) 5/16" Washers
- M. Qty. (2) 5/16" Bushings (outside cylinder mount)
- N. Qty. (2) 1/4" Nylon lock nuts
- O. Qty. (4) 1/4" Washers
- P. Qty. (4) 1/4" White bushings
- Q. Qty. (1) Spreader block
- R. Qty. (4) 3/8" Bushings (Inner Stern Bracket)
- S. Qty. (6) 3/8" Bushings (outer) Qty. (10) 3/8" Bushings (outer) for 10' Model
- T. Qty. (4) 3/8" Bushings (middle stern bracket)

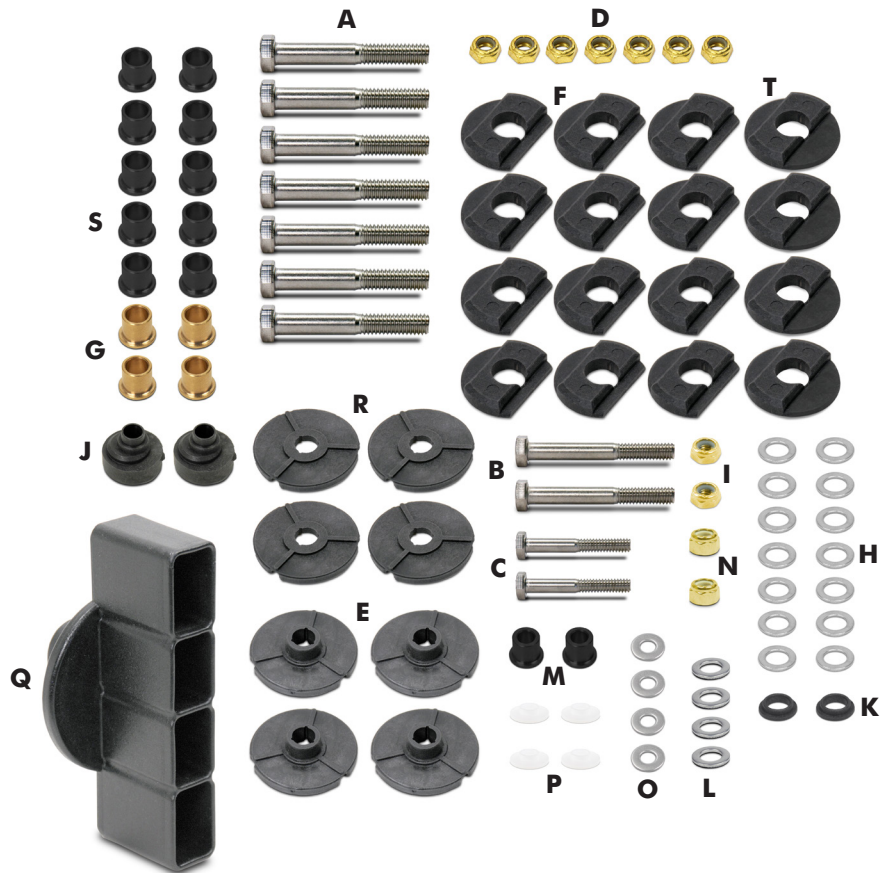

If any hardware is missing from this package please contact Tech Support immediately at 813-689-9932 opt 2

# Hardware

Shown Actual Size

3/8" x 2.5" Bolt



5/16" x 2.5" Bolt



1/4" x 1.75" Bolt



3/8" Bushing  
(Middle)



3/8" Bushing  
(Middle Stern Bracket)



3/8" Bushing  
(Inner Knuckle Joint)



3/8" Bushing  
(Inner Stern Bracket)



Spreader Block



Ram-spacer



3/8" Bushing



3/8" Bearing  
(Outside Stern  
Bracket)



3/8" Nylon Lock Nut



3/8" Washer



5/16" Nylon  
Lock Nut



3/8" Bushing (opposite  
side of Ram-spacer)



5/16" Washer



5/16" Bushing



1/4" Nylon  
Lock Nut



1/4" Washer



1/4" White Bushing

For Technical Support Call 813-689-9932 opt 2

# Section 1

## Bolt Set for Blade Knuckle (Upper or Lower)

### Installation Instructions:

**Step 1** Lower the Power-Pole down to the ground so that the Power-Pole Everflex™ spike is touching the ground.

**Warning:** Be careful not to touch the spike with bare hands because the spike may become fibrous after sun exposure and use.

**Step 2** Remove old bolt and bushings with installation tools. **NOTE:** Use the spreader block (Q) (included) to help remove the u-channel from the knuckle. (See Section 7)

**Step 3** Remove the old bushing (S) from each side of the u-channels. **NOTE:** May need to drive out old bushings (S) from the inside out with a 1/4" flat punch. (Depending on condition, the bushing (S) may not need to be removed.)

**Step 4** Insert bushing (F) into the inside holes of each u-channel with smaller side facing outward and placed into groove **Fig. 1** Section 1.2

**Step 5** Insert bushing (E) into each side of the knuckle joint **Fig. 1** Section 1.1

**Step 6** Install knuckle joint in-between u-channels with flat side of bushings (F) & (E) touching and aligning the hole **Fig. 1**

**Step 7** While holding everything into position remove the spreader block. **NOTE:** From this point all should be held together by the pressure of the u-channel.

**Step 8** Put washer (H) and bushing (S) onto bolt (A) with smaller side of bushing (S) facing the thread end of bolt (A) **Fig. 1**

**Step 9** Push or thread the bolt (A) through the u-channel and knuckle joint.

**Step 10** Now place bushing (S) onto bolt (A) with smaller side of bushing (S) facing inward towards the u-channel.

**Step 11** Finish by placing a washer (H) onto bolt end (A) and thread nut (D) on and tighten flush with the end of bolt (A) **Fig. 1A**

**Figure 1**

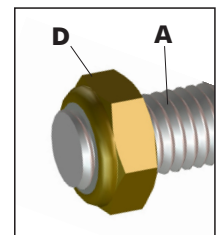
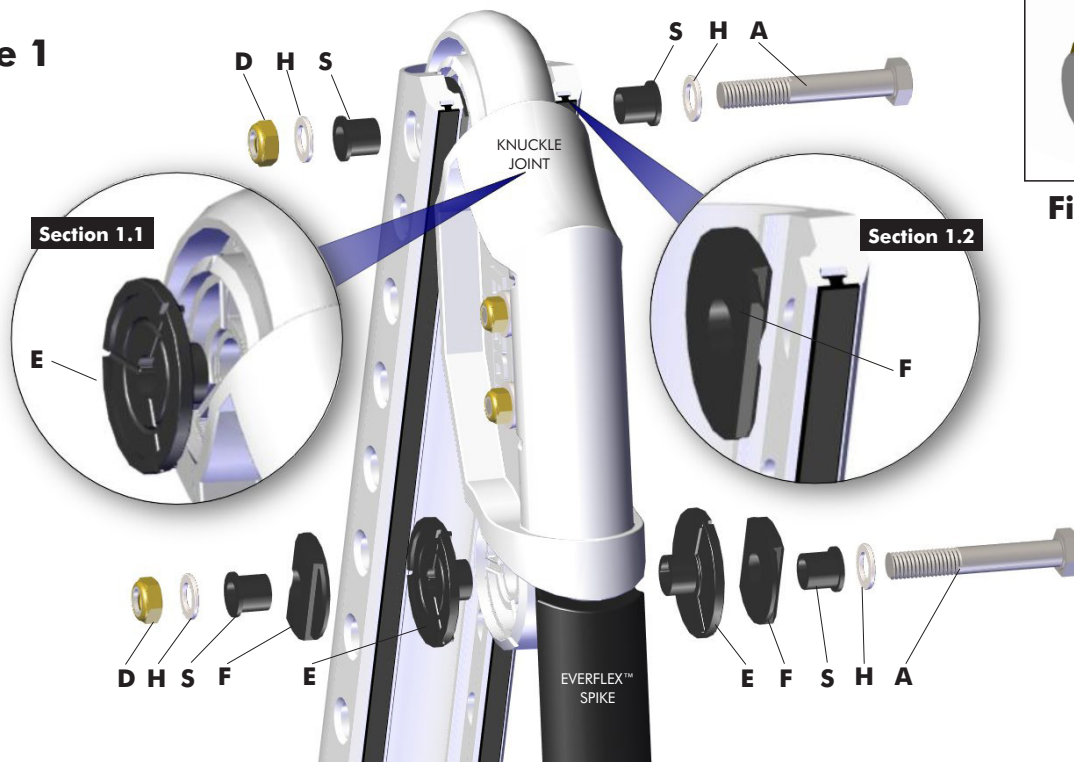

**Figure 1A**

## Section 2

### Bolt Set for Blade Stabilizer Bar (Upper or Lower)

#### Installation Instructions:

**NOTE:** The upper diagram view is for the 8' & 10' Blade Edition Stabilizer bar.

**Step 1** Lower the Power-Pole down to the ground so that the Power-Pole Everflex™ spike is touching the ground.

**Warning:** Be careful not to touch the spike with bare hands because the spike may become fibrous after sun exposure and use.

**Step 2** Remove old bolt and bushings with installation tools. **NOTE:** Use the spreader block (Q) (included) to help remove the u-channel from the stabilizer bar. (See Section 7)

**Step 3** Remove the old bushing (S) from each side of the u-channels. **NOTE:** You may need to drive out old bushings (S) from the inside out with a 1/4" flat punch. (Depending on condition, the bushing (S) may not need to be removed.)

**Step 4** Place bushing (F) into the inside holes of u-channel with smaller side facing outward and placed into the groove and aligning the hole **Fig. 2** Section 2.2

**Step 5** While holding bushings (F) in position place stabilizer bar in between **Fig. 2** Section 2.1 and remove the spreader block.

**Step 6** Put washer (H) and bushing (S) onto bolt (A) with smaller side of bushing (S) facing the thread end of bolt (A) **Fig. 2**

**Step 7** Push or thread the bolt (A) through the u-channel and stabilizer bar.

**Step 8** Now place bushing (S) onto bolt (A) with smaller side of bushing (S) facing inward to u-channel.

**Step 9** Finish by placing washer (H) onto the bolt end (A) and thread nut (D) on and tighten flush with the end of bolt (A) **Fig. 2A**

**Figure 2**

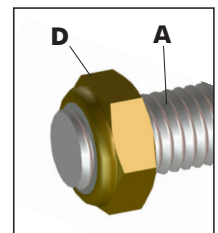
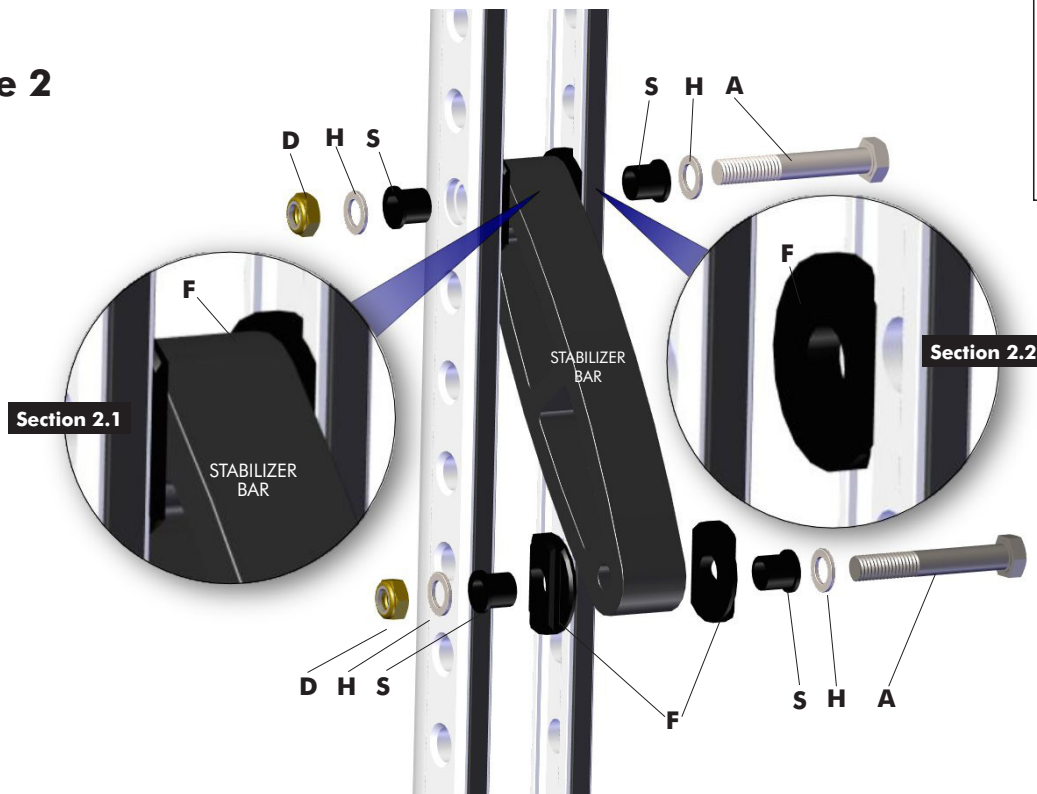

**Figure 2A**

## Section 3

### Bolt Set for Blade Cylinder / Stabilizer Bar

#### Installation Instructions:

**Step 1** Lower the Power-Pole down to the ground so that the Power-Pole Everflex™ spike is touching the ground.

**Warning:** Be careful not to touch the spike with bare hands because the spike may become fibrous after sun exposure and use.

**Step 2** Remove old bolt and bushings with installation tools. *NOTE: Use the spreader block (Q) (included) to help remove the u-channel from the hydraulic cylinder end and stabilizer bar. (See Section 7)*

**Step 3** Once the cylinder end and the stabilizer bar end are moved out of the way. *NOTE: You may need to use a 1/4" flat punch to drive out the old bushings (M) from the inside out. (Depending upon condition, the bushing (M) may not need to be removed.)*

**Step 4** Insert bushings (F) into both inside holes of u-channel with smaller side facing outward and placed into groove and aligning each hole **Fig. 3** Section 3.2

**Step 5** While holding bushings (F) into position place stabilizer bar and hydraulic cylinder ram end in between **Fig. 3** Section 3.1

*NOTICE: Cylinder fittings need to face toward boat when Power-Pole is in the closed position Fig. 3A*

**Step 6** Put washer (L) and bushing (M) onto bolt (B) with smaller side of bushing (M) facing the thread end of bolt (B) **Fig. 3**

**Step 7** Push or thread the bolt (B) through the u-channel, stabilizer bar and hydraulic cylinder.

**Step 8** Now place bushing (M) unto bolt (B) with smaller side of bushing (M) facing inward to u-channel **Fig. 3**

**Step 9** Finish by placing washer (L) onto the bolt end (B) and thread nut (I) on and tighten flush with the end of bolt (B) **Fig. 3B**

**Figure 3**

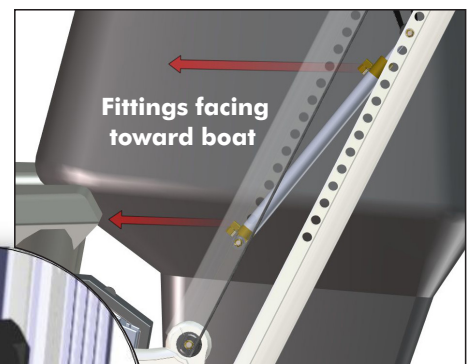
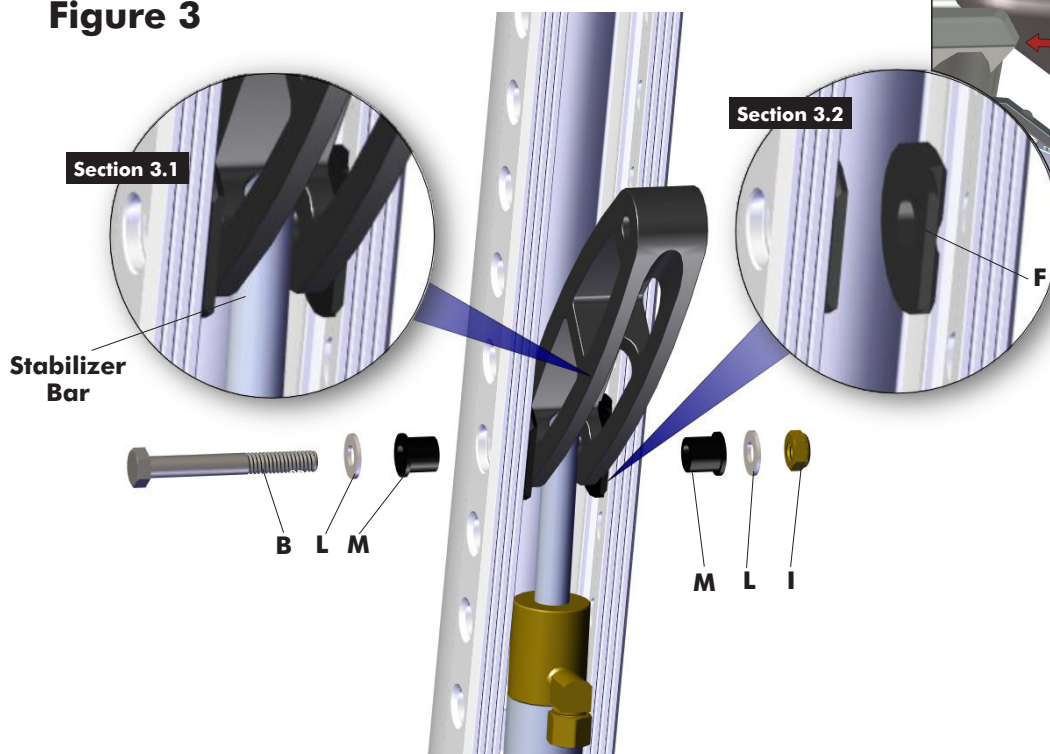

**Figure 3A**

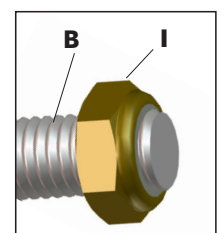

**Figure 3B**

## Section 4

### Bolt Set for Blade Cylinder End Cap

#### Installation Instructions:

**Step 1** Lower the Power-Pole down to the ground so that the Power-Pole Everflex™ spike is touching the ground.

**Warning: Be careful not to touch the spike with bare hands because the spike may become fibrous after sun exposure and use.**

**Step 2** Remove old bolt and bushings with installation tools.

**Step 3** Once the cylinder end is removed out of the way install bushings (J) into the inside u-channel holes with small flange facing outwards **Fig. 4** Section 4.1

**Step 4** While holding bushings (J) into position place the hydraulic cylinder bottom end in between **Fig. 4** Section 4.2

**NOTICE:** Cylinder fittings need to face toward boat when Power-Pole is in the closed position **Fig. 4A**

**Step 5** Place washer (L) and then bushing (K) onto bolt (B) with smaller side of bushing (K) facing the thread end of bolt (B) **Fig. 4**

**Step 6** Push or thread the bolt (B) through the u-channel and hydraulic cylinder end.

**Step 7** Now place bushing (K) unto bolt (B) with smaller side of bushing (K) facing inward towards the u-channel **Fig. 4**

**Step 8** Finish by putting washer (L) onto the bolt end (B) and then thread nut (I) on and tighten flush with the end of bolt (B) **Fig. 4B**

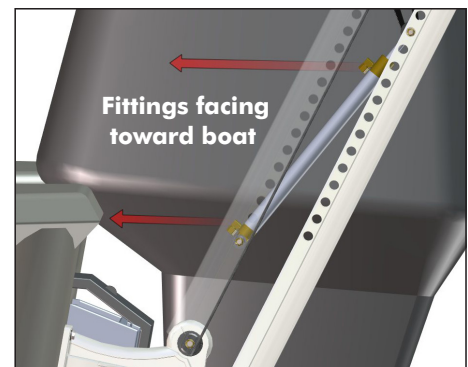

**Figure 4A**

**Figure 4**

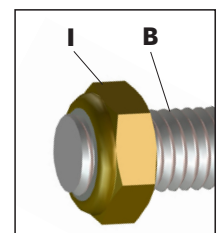
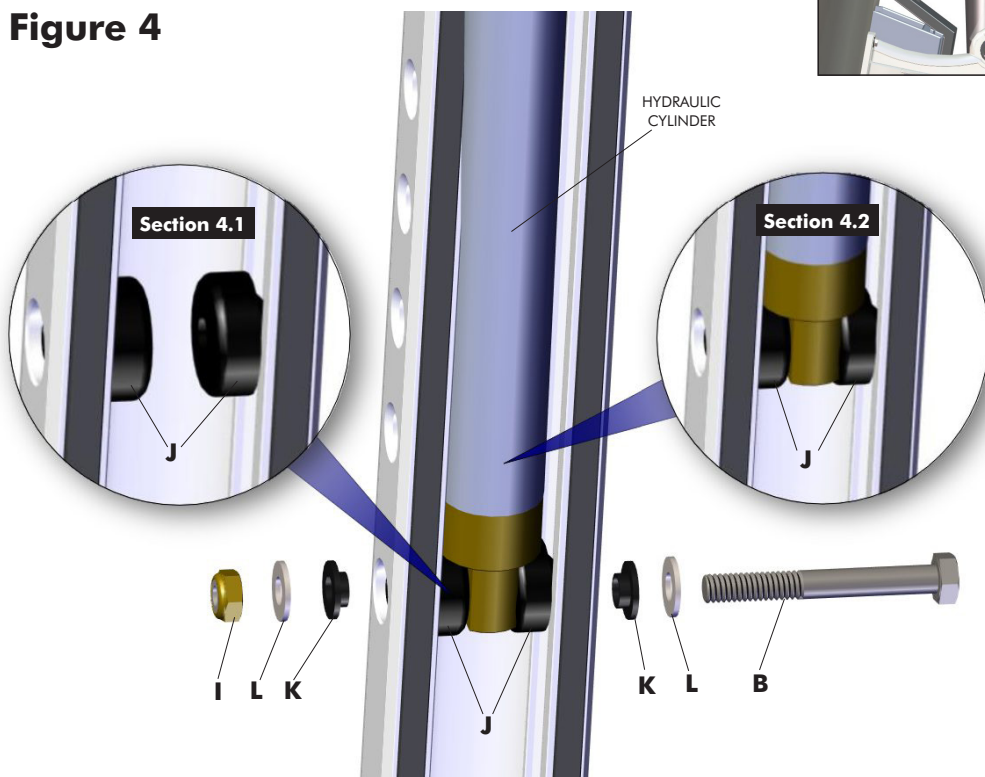

**Figure 4B**

## Section 5

### Bolt Set for Blade Stern Bracket (Upper or Lower)

#### Installation Instructions:

**Step 1** Lower the Power-Pole down to the ground so that the Power-Pole Everflex™ spike is touching the ground.

**Warning:** Be careful not to touch the spike with bare hands because the spike may become fibrous after sun exposure and use.

**Step 2** Remove old bolt and bushings with installation tools. **NOTE:** Use the spreader block (Q) (included) to help remove the u-channel from the stern bracket. (See Section 7)

**Step 3** Remove the old bearing (G) from each side of the u-channels. **NOTE:** You may need to drive out old bearings (G) from the inside out with a 1/4" flat punch. (Depending upon condition, bearing (G) may not need to be removed.)

**Step 4** Insert bushings (T) into the inside holes of u-channel with smaller side facing outward and placed into groove and aligning each hole **Fig. 5** Section 5.2

**Step 5** Insert bushings (R) into each side of the stern bracket **Fig. 5** Section 5.1

**Step 6** While holding all bushings in place install u-channel onto the stern bracket with flat side of bushings (T) & (R) touching and aligning the holes and remove spreader block. Note: From this point all should be held together by the pressure of the u-channel.

**Step 7** Put washer (H) and bearing (G) onto bolt (A) with smaller side of bearing (G) facing the thread end of bolt (A) **Fig. 5**

**Step 8** Push or thread the bolt (A) through the u-channel and stern bracket.

**Step 9** Now place bearing (G) onto bolt (A) with smaller side of bearing (G) facing inward towards the u-channel **Fig. 5**

**Step 10** Finish by placing washer (H) onto the bolt end (A) and thread nut (D) on and tighten snug using standard hand tools.

Figure 5

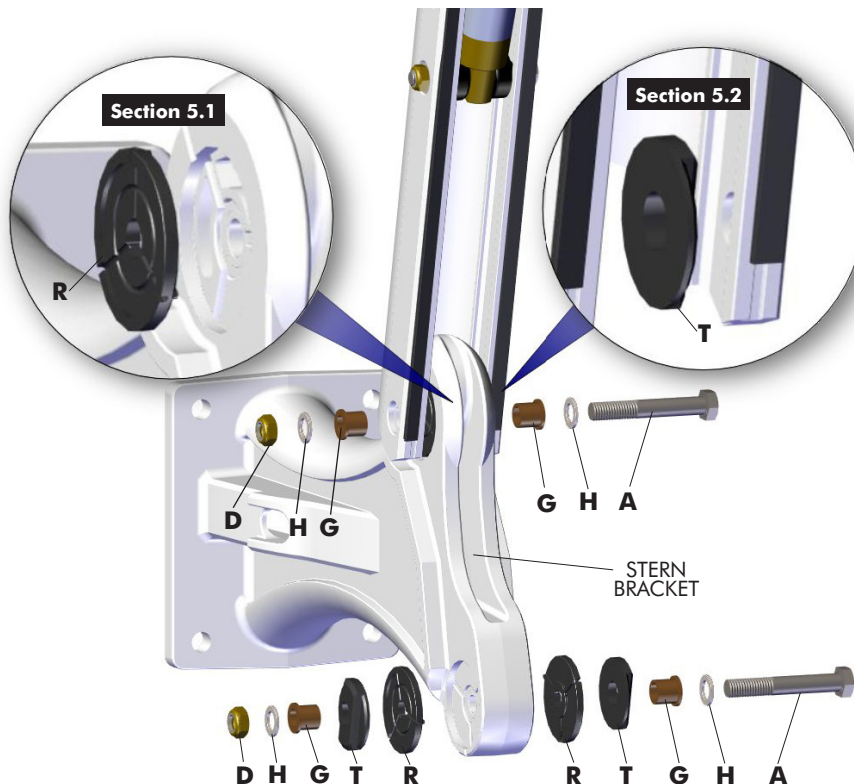

## Section 6

### Bolt Set for Blade Spike (Replacement)

**NOTE: Everflex™ Spike NOT included with rebuild kit.**

To order visit an authorized dealer or call Product Support at 813-689-9932 opt 2 for a replacement if needed.

#### Installation Instructions:

- Step 1** Insert Everflex™ spike up into knuckle joint with grooves aligning the holes **Fig. 6** Section 6.1
- Step 2** Place washer (O) and white bushing (P) onto each bolt (C) with small side of white bushing (P) facing the thread end of bolts (C).
- Step 3** Insert bolts (C) through knuckle joint and Everflex™ spike. *Note: May require a small rubber mallet hammer to hammer bolt (C) through knuckle joint and Everflex™ spike.*

*If your knuckle is non-metal, skip Step 4 and proceed to Step 5.*

- Step 4** Insert white bushing (P) onto each bolt (C) with small flange facing inward towards knuckle joint.
- Step 5** Place washer (O) onto each bolt (C) followed by threading lock nut (N) on and tighten snug using standard hand tools.

**Figure 6**

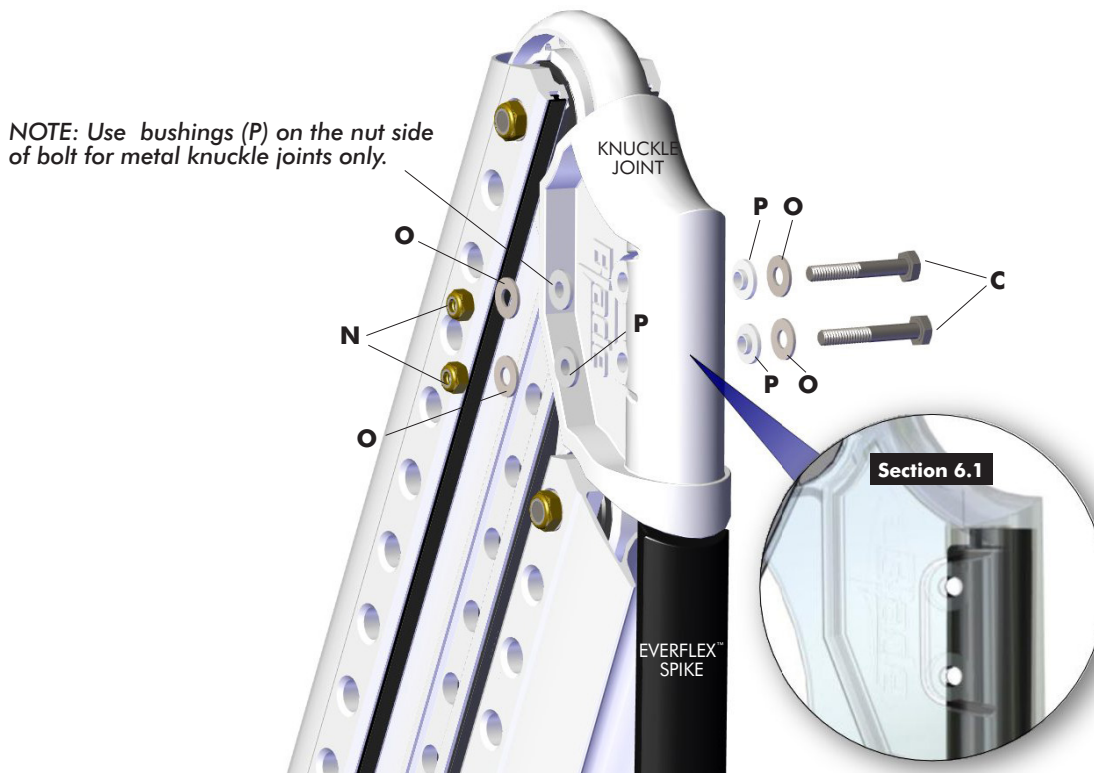



## Section 7

### Spreader Block Tool Use

#### Installation Instructions:

**Step 1** Lower the Power-Pole down to the ground so that the Power-Pole Everflex™ spike is touching the ground.

**Warning: Be careful not to touch the spike with bare hands because the spike may become fibrous after sun exposure and use.**

**Step 2** Remove the lock nut and bolt from the component being replaced.

**Step 3** Insert the smaller side of the spreader block into the u-channel a few inches below the component to be removed **Fig. 7**

**Step 4** Turn counter clock wise to spread the u-channel apart so you can easily remove components for replacement **Fig. 7**

**Step 5** Once the repair is complete simply reverse procedure and remove spreader block.

**Figure 7**

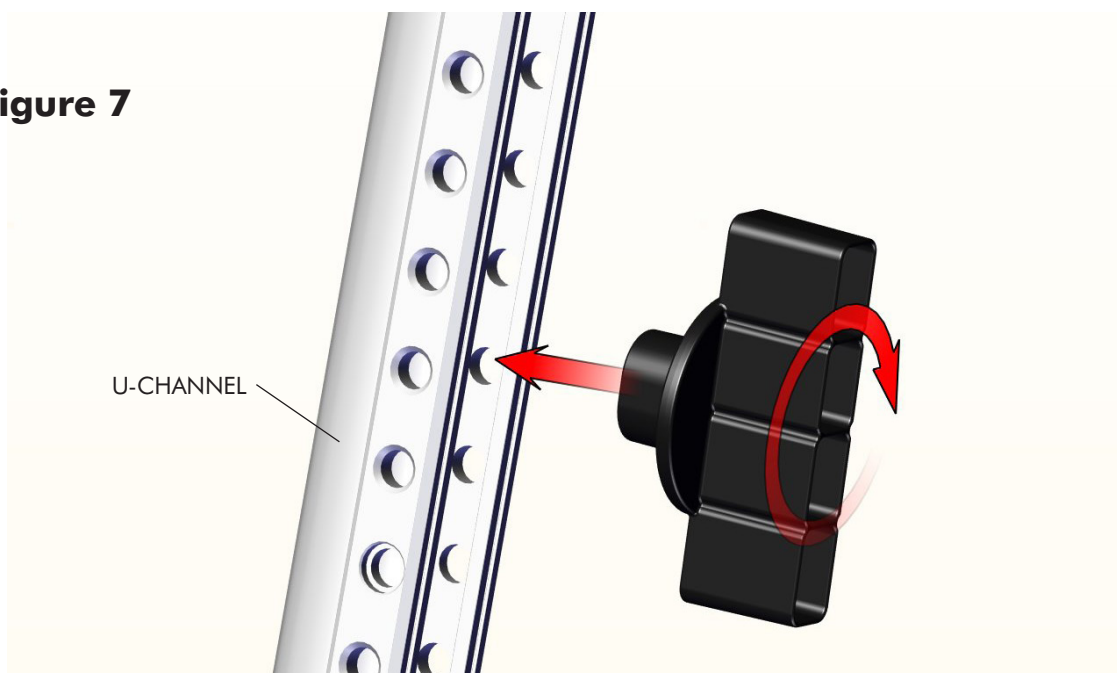

**For Technical Support Call 813-689-9932 opt 2**



**Swift. Silent. Secure.**

#### Product Quality Assurance

JL Marine Systems, Inc. assures that this product is made with the finest quality materials and is free from manufacturer defects. Please inspect this product prior to installation. If defects are apparent, please contact JL Marine Systems, Inc. Warranty Department at 813-689-9932 immediately. Please read all instructions carefully for proper product installation. JL Marine Systems, Inc. is not responsible for improper installation of product.

**JL Marine**  
SYSTEMS, INC.

9010 Palm River Road, Tampa, Florida 33619 • phone 813.689.9932 • fax 813.689.8883 • [power-pole.com](http://power-pole.com)