

## Bolt Set Stern Bracket 3/8" Upper or Lower

Compatible with the following:  
 Power-Pole Pro Series 6' or 8' 2010  
 Power-Pole Signature Series 4', 6', 8' 2010  
 For addition Compatible Power-Pole Models with  
 Stern Bracket Bolt 5/16" (Only)  
 Follow Modification Procedures Listed Below.

### Hardware

- A. Qty (1) 3/8" x 3.5" stern bracket bolt
- B. Qty (2) 3/8" washer
- C. Qty (2) Bushing small outside of u-channel
- D. Qty (2) Bushing large inside of u-channel
- E. Qty (2) Bushing large inside stern bracket
- F. Qty (1) 3/8" Thin Brass Lock Nut

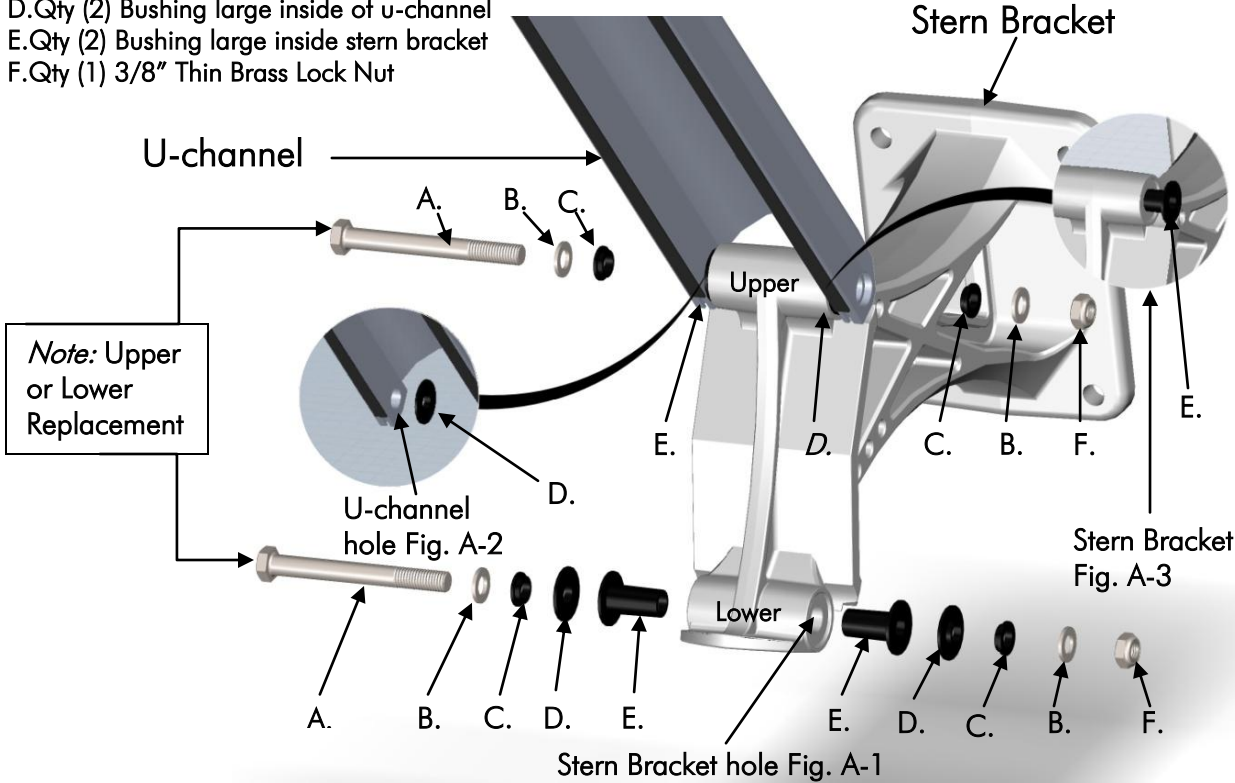
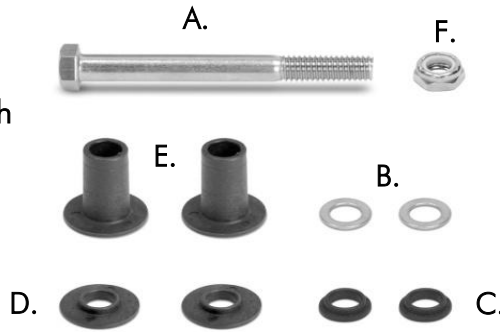

### Installation Tools

- 9/16" Socket with Ratchet
- 9/16" Wrench
- Hammer
- Pliers
- Electric Drill ( Only if Stern Bracket has a 5/16" Bolt) and needs to be drilled out.
- 1/2" & 9/16" Steel Drill Bit (Only if Stern Bracket & U-channels need to be drilled out).

### Modification Procedures:

Step -1. If your current Power-Pole has a 5/16" bolt and the Stern Bracket hole is damaged remove 5/16" bolt and all bushings and drill out the stern bracket bolt hole (only) with 9/16" steel drill bit Fig. A-1.

Step -2. Drill out both sides of U-channel (only) with a 1/2" steel drill bit Fig. A-2.

Step -3. Follow installation instructions below.

### Installation Instructions:

- Step 1 Remove old bolt, bushings and nut with installation tools listed above.
- Step 2 Insert both bushings E into stern bracket holes with smaller side facing inward toward holes Fig. A-3.
- Step 3 Insert both bushings D into the insides of U-channel with small flange facing in towards hole of U-channel Fig. A-2.
- Step 4 Put washer B onto bolt A. Next put the small black bushing C on the bolt A with flat side facing in towards washer B.
- Step 5 Install U-channel on stern bracket as in picture above with flat sides of bushings E and D touching and aligning the hole.
- Step 6 Insert dressed bolt A through the U-channel and stern bracket.
- Step 7 Place small bushing C onto bolt A with small flange facing in towards the U-channel hole followed by washer B.
- Step 8 Finish by threading nut F on and tighten to 84 inch pounds / 7 foot pounds of torque.

For technical support call 813-689-9932 opt 2.

