



Halifax Soil is a mechanically jointed, socketless system fully compliant with BS EN 877:1999 + A1:2006 Incorporating Corrigendum 2008 and certificated by BSI Kitemark (Cert No. KM 684754) and BBA (Cert No. 06/4401). These products have passed all the initial testing and rigorous on going testing to ensure the BS EN 877 is met. Independent testing is carried out on an annual basis. Our digital catalogue containing all technical, product and installation information is available at www.soilandrain.co.uk

Benefits

- Halifax Soil pipes are durable and will last the life of the building
- Cast Iron is classified as A1 and non combustible, Halifax Soil has a fire rating of A2-s1-d0 which is the best possible rating for systems complying with BS EN 877
- Low noise levels both airborne and structure borne
- Cast Iron is 100% recyclable and a sustainable material



EN877 HALIFAX SOIL



Paint Finish

The Halifax Soil system pipes are coated with a two part epoxy finish, red exterior and yellow interior, which provides improved performance when exposed to aggressive substances. The fittings are also epoxy coated in red. The pipes in this system are coated with an average of 40 microns externally and 130 microns internally.

Halifax Soil coatings have been tested successfully for resistance to attack by salt spray, waste water, hot water cycling and solution of acid at PH2 and alkalis at PH12.

SOIL PIPES & COUPLINGS	79
SOIL BENDS	80-81
SOIL BRANCHES	82-83
SOIL FITTINGS	84-85
SOIL BRACKETS & CLAMPS	86-87
SOIL CONNECTORS & TOOLS	88

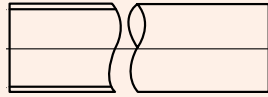

DOUBLE SPIGOT 3M PIPES

Product Code	Diameter (mm)	Nominal Weight (kg)	Price
HS2001	50	15.7	£78.18
HS3001	70	19.4	£89.58
HS4001	100	29.7	£106.33
HS6001	150	45.2	£209.32
HS8001	200	71.2	£350.37

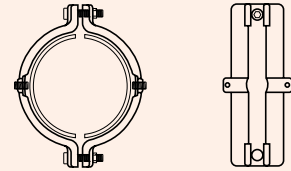

Supplied with grub screws for continuity.

DUCTILE IRON COUPLINGS WITH CONTINUITY

Product Code	Diameter (mm)	Nominal Weight (kg)	Price
HS2012	50	0.7	£11.90
HS3012	70	0.8	£12.98
HS4012	100	1.1	£17.53
HS6012	150	2.0	£35.18
HS8012	200	3.5	£79.18

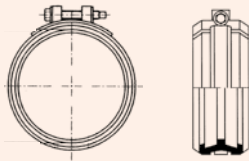

RAPID CONNECT STEEL COUPLING

Product Code	Diameter (mm)	Nominal Weight (kg)	Price
HS2002	50	0.1	£11.00
HS3002	70	0.2	£12.19
HS4002	100	0.2	£15.17
HS6002	150	0.3	£30.47
HS8002	200	0.5	£71.95

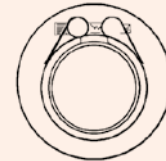

STAINLESS STEEL HIGH PERFORMANCE COUPLINGS

Product Code	Diameter (mm)	Bolt Size	Price
HS2069	50	M8	£213.41
HS3069	70	M10	£222.94
HS4069	100	M10	£225.81
HS6069	150	M12	£392.64
HS8069	200	M16	£557.65



If you don't see a product within this brochure, we have the knowledge, experience and capability to manufacture bespoke castings and fabricated products to support our comprehensive standard ranges.

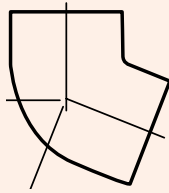

Please refer to our certificates for specific products covered.

**88° SHORT RADIUS BENDS**

Product Code	Diameter [mm]	Nominal Weight [kg]	Price
HS2003	50	0.8	£20.66
HS3003	70	1.3	£23.37
HS4003	100	2.5	£27.60
HS6003	150	5.1	£50.11
HS8003	200	9.0	£142.90

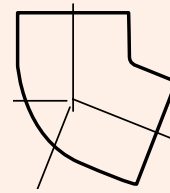
**69° SHORT RADIUS BENDS**

Product Code	Diameter [mm]	Nominal Weight [kg]	Price
HS2004	50	0.8	£20.66
HS3004	70	1.1	£23.37
HS4004	100	2.0	£27.60
HS6004	150	4.4	£50.11

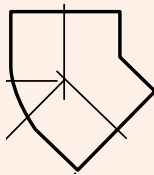
**45° SHORT RADIUS BENDS**

Product Code	Diameter [mm]	Nominal Weight [kg]	Price
HS2005	50	0.6	£20.66
HS3005	70	0.9	£23.37
HS4005	100	1.6	£27.60
HS6005	150	3.6	£50.11
HS8005	200	6.4	£142.90

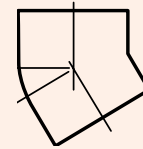
**30° SHORT RADIUS BENDS**

Product Code	Diameter [mm]	Nominal Weight [kg]	Price
HS2006	50	0.5	£20.66
HS3006	70	0.8	£23.37
HS4006	100	1.4	£27.60
HS6006	150	3.2	£50.11

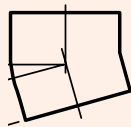
**15° SHORT RADIUS BENDS**

Product Code	Diameter [mm]	Nominal Weight [kg]	Price
HS2007	50	0.4	£20.66
HS3007	70	0.6	£23.37
HS4007	100	1.2	£27.60
HS6007	150	2.5	£50.11



TECHNICAL
SUPPORT

If you need any assistance of a technical nature,
please feel free to give us a call.



SITE
SURVEYS

If you need us to visit a site, we're happy to oblige.
We can assist with working out quantities required
or any unusual requirements.

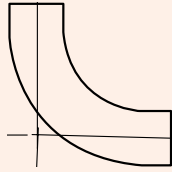

88° LONG RADIUS BENDS

Product Code	Diameter (mm)	Nominal Weight (kg)	Price
HS4008	100	5.3	£66.82
HS6008	150	10.7	£186.15



22° LONG RADIUS BENDS

Product Code	Diameter (mm)	Nominal Weight (kg)	Price
HS4009	100	2.2	£51.51

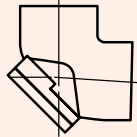

88° SHORT RADIUS BENDS WITH DOOR

Product Code	Diameter (mm)	Nominal Weight (kg)	Price
HS3010	70	2.5	£44.94
HS4010	100	3.8	£65.89

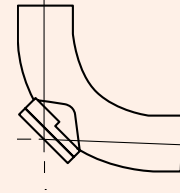

88° LONG RADIUS BENDS WITH DOOR

Product Code	Diameter (mm)	Nominal Weight (kg)	Price
HS4011	100	7.3	£85.14
HS6011	150	12.7	£214.25

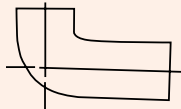

88° LONG TAIL BEND

Product Code	Diameter (mm)	Nominal Weight (kg)	Price
HS4013	100	4.0	£48.69



LONG TAIL BOSS BRANCH

Product Code	Diameter (mm)	Nominal Weight (kg)	Price
HS4059	100	TBA	£272.21



If you don't see a product within this brochure, we have the knowledge, experience and capability to manufacture bespoke castings and fabricated products to support our comprehensive standard ranges.

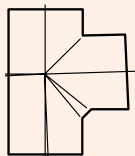

Please refer to our certificates for specific products covered.

**88° SINGLE EQUAL BRANCHES**

Product Code	Diameter (mm)	Nominal Weight (kg)	Price
HS2020	50 x 50	1.1	£33.47
HS3021	70 x 70	1.8	£35.52
HS4022	100 x 100	3.4	£44.84
HS6021	150 x 150	7.4	£107.82
HS8020	200 x 200	14.0	£287.38

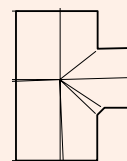
**88° SINGLE UNEQUAL BRANCHES**

Product Code	Diameter (mm)	Nominal Weight (kg)	Price
HS3020	70 x 50	1.5	£35.52
HS4020	100 x 50	2.2	£47.71
HS4021	100 x 70	2.5	£47.71
HS6020	150 x 100	5.1	£105.36

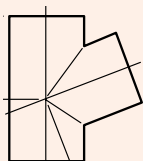
**69° SINGLE EQUAL BRANCHES**

Product Code	Diameter (mm)	Nominal Weight (kg)	Price
HS2023	50 x 50	1.1	£33.47
HS3024	70 x 70	1.8	£35.52
HS4025	100 x 100	3.4	£44.84

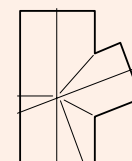
**69° SINGLE UNEQUAL BRANCHES**

Product Code	Diameter (mm)	Nominal Weight (kg)	Price
HS3023	70 x 50	1.4	£35.52
HS4023	100 x 50	2.1	£47.71
HS4024	100 x 70	2.6	£47.71
HS6023	150 x 100	4.9	£105.36

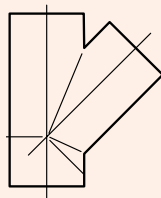
**45° SINGLE EQUAL BRANCHES**

Product Code	Diameter (mm)	Nominal Weight (kg)	Price
HS2026	50 x 50	1.3	£33.47
HS3027	70 x 70	2.2	£35.52
HS4028	100 x 100	4.3	£44.84
HS6027	150 x 150	10.2	£107.82
HS8028	200 x 200	16.8	£287.38

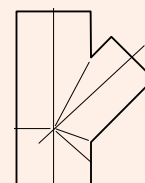
**45° SINGLE UNEQUAL BRANCHES**

Product Code	Diameter (mm)	Nominal Weight (kg)	Price
HS3026	70 x 50	1.8	£35.52
HS4026	100 x 50	2.4	£47.71
HS4027	100 x 70	3.1	£47.71
HS6028	150 x 70	4.9	£105.36
HS6026	150 x 100	5.8	£105.36
HS8026	200 x 100	9.1	£267.62
HS8027	200 x 150	13.2	£267.62



TECHNICAL
SUPPORT

If you need any assistance of a technical nature,
please feel free to give us a call.



SITE
SURVEYS

If you need us to visit a site, we're happy to oblige.
We can assist with working out quantities required
or any unusual requirements.

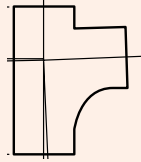

88° SINGLE RADIUS CURVE BRANCHES

Product Code	Diameter (mm)	Nominal Weight [kg]	Price
HS4030	100 x 100	4.1	£50.91
HS6030	150 x 100	6.5	£120.71
HS6033	150 x 150	11.7	£187.61

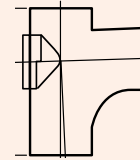

88° SINGLE RADIUS CURVE BRANCHES WITH DOOR

Product Code	Diameter (mm)	Nominal Weight [kg]	Price
HS4032	100 x 100	5.4	£84.69
HS6032	150 x 100	9.5	£182.62
HS6033	150 x 150	14.2	£187.61

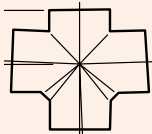

88° DOUBLE BRANCH

Product Code	Diameter (mm)	Nominal Weight [kg]	Price
HS4034	100 x 100	3.8	£64.80

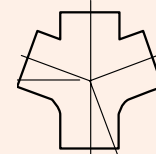

69° DOUBLE BRANCH

Product Code	Diameter (mm)	Nominal Weight [kg]	Price
HS4035	100 x 100	4.1	£64.80

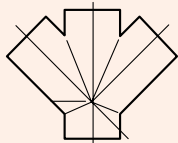

45° DOUBLE BRANCHES

Product Code	Diameter (mm)	Nominal Weight [kg]	Price
HS4036	100 x 100	5.7	£64.80
HS6036	150 x 100	6.5	£196.79
HS6037	150 x 150	11.7	£218.33
HS8036	200 x 200	21.0	£345.43

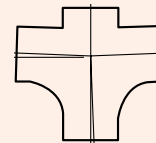

88° DOUBLE RADIUS CURVE BRANCHES

Product Code	Diameter (mm)	Nominal Weight [kg]	Price
HS4038	100 x 100	5.3	£63.63
HS6038	150 x 100	8.2	£203.51

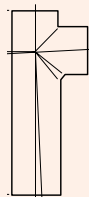

88° SINGLE LONG TAIL BRANCH

Product Code	Diameter (mm)	Nominal Weight [kg]	Price
HS4040	100 x 100	5.2	£156.50

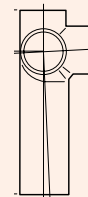

88° LONG TAIL CORNER BRANCH

Product Code	Diameter (mm)	Nominal Weight [kg]	Price
HS4041	100 x 100	7.0	£183.63

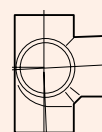

88° SHORT TAIL CORNER BRANCH

Product Code	Diameter (mm)	Nominal Weight [kg]	Price
HS4042	100 x 100	3.5	£116.78

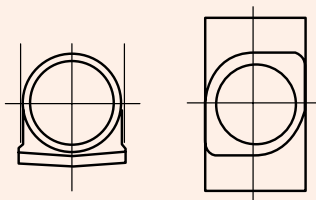
**ACCESS PIPES WITH ROUND DOOR**

Product Code	Diameter [mm]	Nominal Weight [kg]	Price
HS2043	50	1.7	£55.10
HS3043	70	2.5	£58.62
HS4043	100	4.3	£61.73
HS6043	150	7.9	£115.39

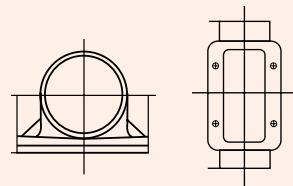
**ACCESS PIPES WITH RECTANGULAR DOOR**

Product Code	Diameter [mm]	Nominal Weight [kg]	Price
HS4049	100	7.2	£79.49
HS6049	150	13.5	£182.39
HS8049	200	22.0	£384.70

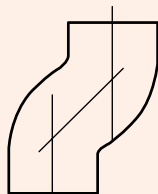
**OFFSETS 75MM PROJECTION**

Product Code	Diameter [mm]	Nominal Weight [kg]	Price
HS4044	100	2.6	£43.97

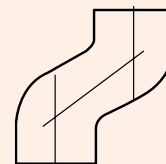
**OFFSETS 130MM PROJECTION**

Product Code	Diameter [mm]	Nominal Weight [kg]	Price
HS2045	50	1.4	£35.29
HS3045	70	2.3	£53.76
HS4045	100	3.8	£70.29

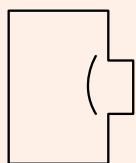
**BOSS PIPES SINGLE 2" BSPT**

Product Code	Diameter [mm]	Nominal Weight [kg]	Price
HS3053	70	1.6	£47.39
HS4053	100	2.1	£57.87
HS6053	150	3.6	£92.63

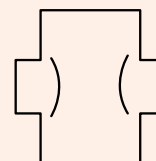
**BOSS PIPE 2 X 2" BSPT OPPOSED**

Product Code	Diameter [mm]	Nominal Weight [kg]	Price
HS4054	100	2.2	£68.05

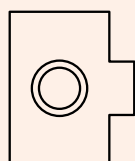
**BOSS PIPE 2 X 2" BSPT AT 90°**

Product Code	Diameter [mm]	Nominal Weight [kg]	Price
HS4055	100	2.2	£59.69

**PIPE TAPERS**

Product Code	Diameter [mm]	Nominal Weight [kg]	Price
HS3046	70 x 50	0.6	£30.39
HS4046	100 x 50	0.9	£37.70
HS4047	100 x 70	1.1	£37.70
HS6046	150 x 50	2.5	£71.71
HS6047	150 x 70	2.7	£71.71
HS6048	150 x 100	2.4	£71.71
HS8046	200 x 100	4.0	£117.23
HS8047	200 x 150	4.0	£117.23

TECHNICAL
SUPPORT

If you need any assistance of a technical nature,
please feel free to give us a call.

SITE
SURVEYS

If you need us to visit a site, we're happy to oblige.
We can assist with working out quantities required
or any unusual requirements.

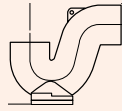

P TRAPS WITH BOTTOM DOOR

Product Code	Diameter (mm)	Nominal Weight (kg)	Price
HS2050	50	2.3	£77.96
HS3050	70	3.6	£77.96
HS4050	100	6.8	£84.14
HS6050	150	15.8	£151.10

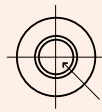

drilled & tapped
2" BSPT

BLANK ENDS DRILLED & TAPPED 2" BSPT

Product Code	Diameter (mm)	Nominal Weight (kg)	Price
HS4052	100	0.7	£23.09
HS6052	150	1.5	£28.24

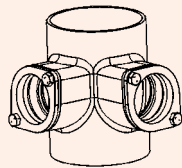

90° COMPRESSION FIT BOSS PIPE

Product Code	Diameter (mm)	Nominal Weight (kg)	Price
HS4091	100x50	3.2	£74.85

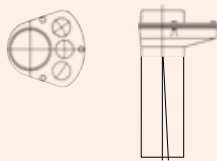

MANIFOLD CONNECTOR

Product Code	Diameter (mm)	Nominal Weight (kg)	Price
HS4058	100	3.5	£122.34

Manifold Connector fitted with 3 rubber plugs suitable for pushfit connection to 32mm/40mm diameter plastic/copper waste. Please check availability of 250mm and 300mm products.



BLANK ENDS

Product Code	Diameter (mm)	Nominal Weight (kg)	Price
HS2051	50	0.2	£8.33
HS3051	70	0.4	£8.81
HS4051	100	0.8	£10.32
HS6051	150	1.6	£14.90
HS8051	200	2.9	£64.35

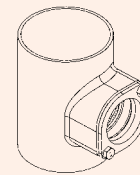

COMPRESSION FIT BOSS PIPES

Product Code	Diameter (mm)	Nominal Weight (kg)	Price
HS3090	75x50	2	£47.39
HS4090	100x50	2.5	£57.87
HS6090	150x50	4.2	£97.25

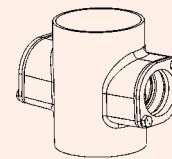

OPPOSED COMPRESSION FIT BOSS PIPES

Product Code	Diameter (mm)	Nominal Weight (kg)	Price
HS4092	100x50	3.2	£74.85



If you don't see a product within this brochure, we have the knowledge, experience and capability to manufacture bespoke castings and fabricated products to support our comprehensive standard ranges.

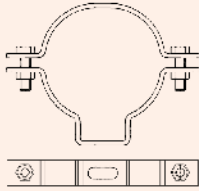

Please refer to our certificates for specific products covered.

**COATED ADJUSTABLE BRACKETS**

Product Code	Diameter [mm]	Nominal Weight [kg]	Price
HS2067	50	0.3	£11.70
HS3067	70	0.3	£11.70
HS4067	100	0.6	£13.38
HS6067	150	0.8	£24.91
HS8067	200	1.8	£92.31

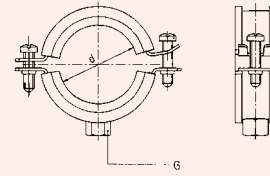
**ZINC PLATED RUBBER LINED BISMAT BRACKETS**

Product Code	Diameter [mm]	G	Price
HS2061	50	M8/M10	£4.90
HS3061	70	M10/M12	£6.66
HS4061	100	M10/M12	£9.48
HS6061	150	M10/M12	£18.51
HS8061	200	M10/M12	£27.60

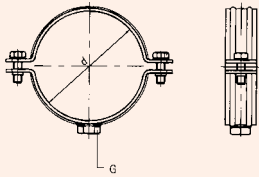
**ZINC PLATED HEAVY DUTY BOSSED BRACKETS**

Product Code	Diameter [mm]	G	Price
HS2063	50	M8/M10	£8.82
HS3063	70	M10/M12	£9.47
HS4063	100	M10/M12	£12.61
HS6063	150	M10/M12	£22.07
HS8063	200	M10/M12	£28.59

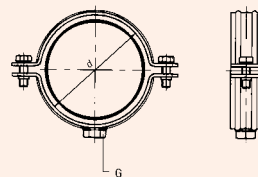
**ZINC PLATED RUBBER LINED HEAVY DUTY BOSSED BRACKETS**

Product Code	Diameter [mm]	G	Price
HS2064	50	M8/M10	£9.47
HS3064	70	M10/M12	£11.58
HS4064	100	M10/M12	£16.80
HS6064	150	M10/M12	£30.86
HS8064	200	M10/M12	£35.77

Please check availability of 250mm and 300mm products.

The Coated Adjustable Bracket may require a Wall Plate see 71. Threaded Bar not supplied.



TECHNICAL
SUPPORT

If you need any assistance of a technical nature,
please feel free to give us a call.



SITE
SURVEYS

If you need us to visit a site, we're happy to oblige.
We can assist with working out quantities required
or any unusual requirements.

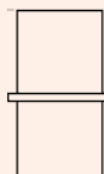

STACK SUPPORT PIPES

Product Code	Diameter (mm)	Nominal Weight (kg)	Price
HS3056	70	1.8	£45.32
HS4056	100	2.8	£50.06
HS6056	150	4.3	£79.25
HS8056	200	7.2	£116.68

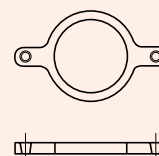

STACK SUPPORT BRACKETS WITH GASKET

Product Code	Diameter (mm)	Nominal Weight (kg)	Price
HS3057	70	1.0	£27.94
HS4057	100	1.4	£34.54
HS6057	150	1.8	£52.86
HS8057	200	2.2	£105.64

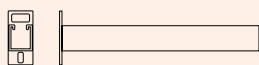

GALVANISED CANTILEVER ARMS

Product Code	Length (mm)	Strut (mm)	Price
HSD1830	300	41 x 41	£19.37
HSD1845	450	41 x 41	£25.33

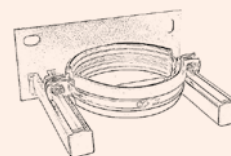

STACK SUPPORT CONSOLE WITH GUIDANCE CLAMP

Product Code	Diameter (mm)	Max Load (N)	Price
HS3070	70	3000	£84.79
HS4070	100	3000	£86.64
HS6070	150	3000	£93.99
HS8070	200	3000	£110.58

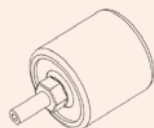

STAINLESS STEEL BRACKET DAMPNER 10MM

Product Code	Size (mm)	Nominal Weight (kg)	Price
HSD6703	M10	0.2	£57.46

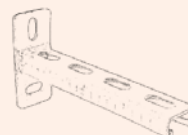

RAPID STRUT CANTILEVER ARM

Product Code	Length (mm)	Max Load (N)	Price
HSD1846	450	1881	£50.71

Please check availability of 250mm and 300mm products.



If you don't see a product within this brochure, we have the knowledge, experience and capability to manufacture bespoke castings and fabricated products to support our comprehensive standard ranges.

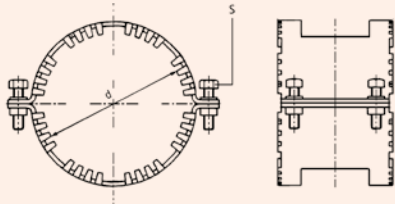

Please refer to our certificates for specific products covered.

**ZINC PLATED HALIFAX GRIPS**

Product Code	Diameter [mm]	S	Price
HS2060	50	M8 x 30	£60.80
HS3060	70	M8 x 30	£62.21
HS4060	100	M8 x 30	£66.72
HS6060	150	M10 x 30	£99.85
HS8060	200	M10 x 30	£131.10

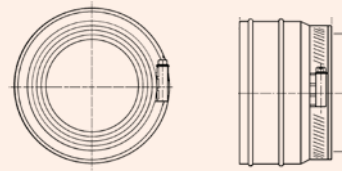
**RUBBER HALIFAX FIX CONNECTORS**

Product Code	Diameter [mm]	To Fit [mm]	Price
HS2068	50	40 - 56	£13.05
HS3068	70	56 - 75	£17.97
HS4068	100	104 - 110	£19.62

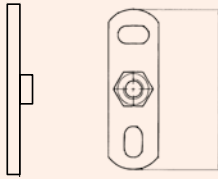
**ZINC PLATED WALL PLATE**

Product Code	Length [mm]	Bolt Size	Price
HSD6702	80	M10	£3.39

**ZINC PLATED THREAD ADAPTER**

Product Code	Male Thread	Female Thread	Price
HSD10/12	M10	M12	£3.43

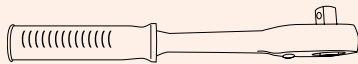
**RATCHET SPANNER**

Product Code	Drive [mm]	Price
HSD001	13.0	£88.18

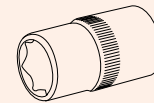
**SOCKET (FOR ACCESS DOOR BOLTS)**

Product Code	Diameter [mm]	Price
HSD002	13.0	£15.78

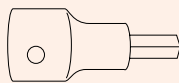
**ALLEN SOCKET ADAPTERS (FOR COUPLINGS)**

Product Code	Diameter [mm]	Price
HSD003	6.0	£21.68
HSD004	8.0	£22.31

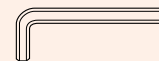
**HEX ALLEN KEY (FOR COUPLING GRUB SCREW)**

Product Code	Diameter [mm]	Price
HSD005	3.0	£0.80



TECHNICAL
SUPPORT

If you need any assistance of a technical nature,
please feel free to give us a call.



SITE
SURVEYS

If you need us to visit a site, we're happy to oblige.
We can assist with working out quantities required
or any unusual requirements.

Halifax Drain is a below ground socketless system and like Halifax Soil fully complies with BS EN 877:1999 + A1:2006 Incorporating Corrigendum 2008 and certificated by BSI Kitemark (Cert No. KM 684754) and BBA (Cert No. 06/4401). These products have passed all the initial testing and rigorous on going testing to ensure the BS EN 877 is met. Independent testing is carried out on an annual basis. Our digital catalogue containing all technical, product and installation information is available at www.soilandrain.co.uk

Benefits

- Halifax Drain pipes are strong and highly resistant to sheer loads
- Low risk of settlement damage
- Require less embedment and extra protection saving time and money
- High resistance to distortion and less likely to be damaged by vigorous rodding
- Long life expectancy (in excess of 100 years)
- Cast Iron is 100% recyclable and a sustainable material



EN877 HALIFAX DRAIN



Paint Finish

The Halifax Drain system pipes are lined internally with a two part grey epoxy finish which provides improved performance when exposed to aggressive substances. The pipes in this system are coated with an average dry film thickness of 170 microns. Pipes with an exterior coating in grey and interior coating in yellow have average dry film thicknesses of 130 microns and 170 microns respectively. Fittings are also epoxy coated in grey.

Halifax Drain coatings have been tested successfully for resistance to attack by salt spray, waste water, hot water cycling and solution of acid at PH2 and alkalis at PH12.

DRAIN PIPES & COUPLINGS, DRAIN CONNECTORS & TOOLS 90

DRAIN BENDS 91

DRAIN BRANCHES 92

DRAIN FITTINGS 93-94

DRAIN BRACKETS & CLAMPS 95

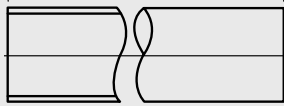

DOUBLE SPIGOT 3M PIPES

Product Code	Diameter [mm]	Nominal Weight [kg]	Price
HD4001	100	29.7	£132.95
HD6001	150	45.2	£261.66
HD8001	200	71.2	£437.95

Please check availability of 250mm and 300mm products.

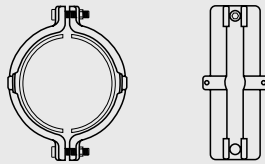

DUCTILE IRON COUPLINGS

Product Code	Diameter [mm]	Nominal Weight [kg]	Price
HD4012	100	1.1	£23.71
HD6012	150	2.0	£47.71
HD8012	200	3.5	£106.94

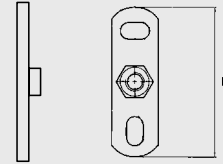

ZINC PLATED WALL PLATE

Product Code	Diameter [mm]	Nominal Weight [kg]	Price
HSD6702	80	M10	£3.39



ZINC PLATED THREAD ADAPTER

Product Code	Male Thread	Female Thread	Price
HSD10/12	M10	M12	£3.43

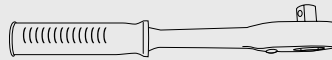

RATCHET SPANNER

Product Code	Drive [mm]	Price
HSD001	13.0	£88.18

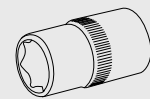

SOCKET (FOR ACCESS DOOR BOLTS)

Product Code	Diameter [mm]	Price
HSD002	13.0	£15.78

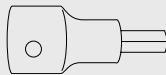

ALLEN SOCKET ADAPTERS (FOR COUPLINGS)

Product Code	Diameter [mm]	Price
HSD003	6.0	£21.68
HSD004	8.0	£22.31

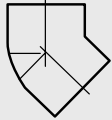

45° SHORT RADIUS BENDS

Product Code	Diameter (mm)	Nominal Weight (kg)	Price
HD4005	100	1.6	£33.12
HD6005	150	3.6	£57.64
HD8005	200	6.4	£171.52



30° SHORT RADIUS BENDS

Product Code	Diameter (mm)	Nominal Weight (kg)	Price
HD4006	100	0.8	£33.12
HD6006	150	1.1	£57.64



15° SHORT RADIUS BENDS

Product Code	Diameter (mm)	Nominal Weight (kg)	Price
HD4007	100	1.2	£33.12
HD6007	150	2.5	£57.64

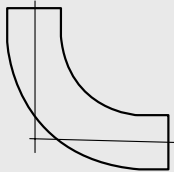

88° LONG RADIUS BENDS

Product Code	Diameter (mm)	Nominal Weight (kg)	Price
HD4008	100	5.3	£76.85
HD6008	150	10.7	£214.09



22° LONG RADIUS BENDS

Product Code	Diameter (mm)	Nominal Weight (kg)	Price
HD4009	100	2.2	£56.72

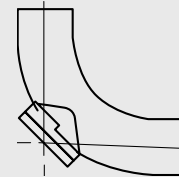

88° LONG RADIUS BENDS WITH DOOR

Product Code	Diameter (mm)	Nominal Weight (kg)	Price
HD4011	100	7.3	£97.89
HD6011	150	12.7	£235.68

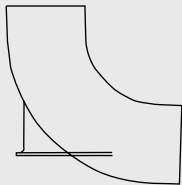

88° LONG RADIUS BENDS WITH HEEL REST

Product Code	Diameter (mm)	Nominal Weight (kg)	Price
HD4014	100	5.5	£93.63
HD6014	150	11.4	£230.17



45° MEDIUM RADIUS BENDS

Product Code	Diameter (mm)	Nominal Weight (kg)	Price
HD4015	100	3.5	£54.23
HD6015	150	6.2	£118.86

Please check availability of 250mm and 300mm products.



If you need any assistance of a technical nature, please feel free to give us a call.



SITE SURVEYS

If you need us to visit a site, we're happy to oblige. We can assist with working out quantities required or any unusual requirements.

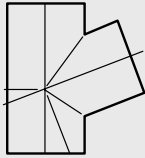

69° SINGLE EQUAL BRANCHES

Product Code	Diameter [mm]	Nominal Weight [kg]	Price
HD4025	100 x 100	3.4	£51.57

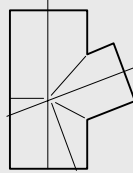

69° SINGLE UNEQUAL BRANCHES

Product Code	Diameter [mm]	Nominal Weight [kg]	Price
HD6023	150 x 100	4.9	£121.14

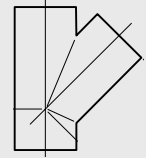

45° SINGLE EQUAL BRANCHES

Product Code	Diameter [mm]	Nominal Weight [kg]	Price
HD4028	100 x 100	4.3	£51.57
HD6027	150 x 150	10.2	£123.96
HD8028	200 x 200	16.8	£330.50

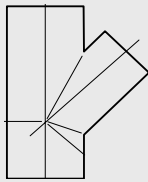

45° SINGLE UNEQUAL BRANCHES

Product Code	Diameter [mm]	Nominal Weight [kg]	Price
HD6026	150 x 100	5.8	£121.14
HD8026	200 x 100	9.1	£307.79
HD8027	200 x 150	13.2	£307.79

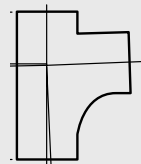

88° SINGLE RADIUS CURVE BRANCHES

Product Code	Diameter [mm]	Nominal Weight [kg]	Price
HD4030	100 x 100	4.1	£58.53
HD6030	150 x 100	6.5	£156.93
HD6031	150 x 150	11.7	£206.34

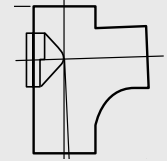

88° SINGLE RADIUS CURVE BRANCHES WITH DOOR

Product Code	Diameter [mm]	Nominal Weight [kg]	Price
HD4032	100 x 100	5.4	£101.65
HD6032	150 x 100	9.5	£200.89
HD6031	150 x 150	14.2	£206.34

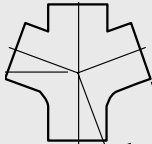

69° DOUBLE BRANCH

Product Code	Diameter [mm]	Nominal Weight [kg]	Price
HD4035	100 x 100	4.1	£74.52

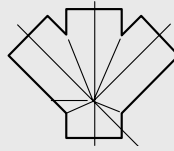

45° DOUBLE BRANCHES

Product Code	Diameter [mm]	Nominal Weight [kg]	Price
HD4036	100 x 100	5.7	£74.52
HD6036	150 x 100	6.5	£216.50
HD6037	150 x 150	11.7	£272.79
HD8036	200 x 200	21.0	£379.95

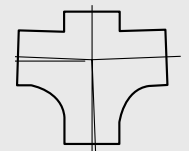

88° DOUBLE RADIUS CURVE BRANCHES

Product Code	Diameter [mm]	Nominal Weight [kg]	Price
HD4038	100 x 100	5.3	£73.17
HD6038	150 x 100	8.2	£246.81



If you don't see a product within this brochure, we have the knowledge, experience and capability to manufacture bespoke castings and fabricated products to support our comprehensive standard ranges.



Please refer to our certificates for specific products covered.

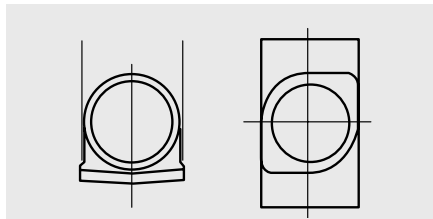

ACCESS PIPES WITH ROUND DOOR

Product Code	Diameter [mm]	Nominal Weight [kg]	Price
HD4043	100	3.4	£70.94
HD6043	150	7.9	£126.92

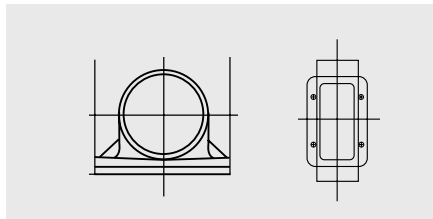

ACCESS PIPES WITH RECTANGULAR DOOR

Product Code	Diameter [mm]	Nominal Weight [kg]	Price
HD4049	100	7.2	£99.42
HD6049	150	13.5	£218.85
HD8049	200	22.0	£448.64

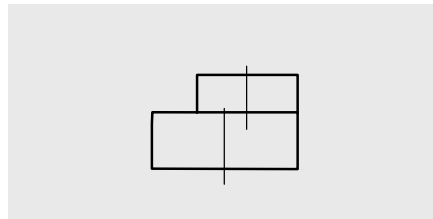

PIPE TAPERS

Product Code	Diameter [mm]	Nominal Weight [kg]	Price
HD6048	150 x 100	2.4	£78.87
HD8046	200 x 100	4.0	£134.79
HD8047	200 x 150	4.0	£134.79

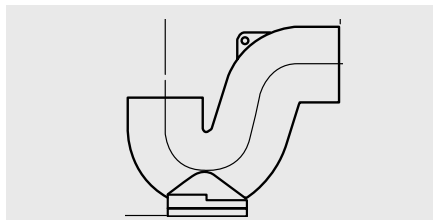

P TRAPS WITH BOTTOM DOOR

Product Code	Diameter [mm]	Nominal Weight [kg]	Price
HD4050	100	6.8	£96.79
HD6050	150	15.8	£173.76

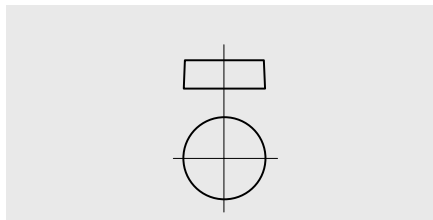

BLANK ENDS

Product Code	Diameter [mm]	Nominal Weight [kg]	Price
HD4051	100	0.8	£11.90
HD6051	150	1.6	£17.12
HD8051	200	2.9	£74.02

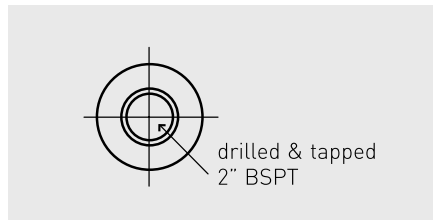

BLANK ENDS DRILLED & TAPPED 2" BSPT

Product Code	Diameter [mm]	Nominal Weight [kg]	Price
HD4052	100	0.7	£25.40
HD6052	150	1.5	£31.02

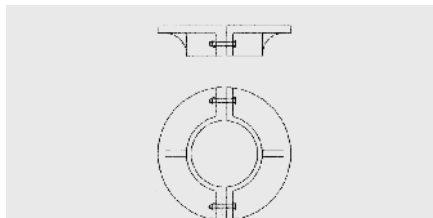

PUDDLE FLANGES

Product Code	Diameter [mm]	Nominal Weight [kg]	Price
HD4078	100	4.0	£83.08
HD6078	150	6.0	£98.96
HD8078	200	7.0	£129.40



If you need any assistance of a technical nature, please feel free to give us a call.



SITE SURVEYS

If you need us to visit a site, we're happy to oblige. We can assist with working out quantities required or any unusual requirements.

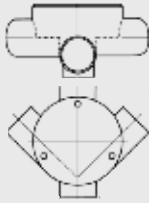

**ROUND 2 BRANCH
INSPECTION CHAMBER**

Product Code	Diameter [mm]	Nominal Weight [kg]	Price
HD4480	100 x 100	15.9	£334.41
HD6480	150 x 100	18.9	£401.28
HD6680	150 x 150	19.4	£499.34

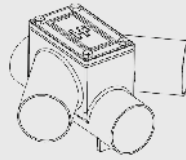

**RECTANGULAR 2 BRANCH
INSPECTION CHAMBER**

Product Code	Diameter [mm]	Nominal Weight [kg]	Price
HD4481	100 x 100	10.2	£382.61
HD6481	150 x 100	14.9	£495.50
HD6681	150 x 150	18	£620.95

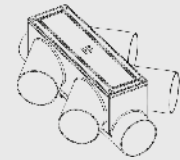

**RECTANGULAR 4 BRANCH
INSPECTION CHAMBER**

Product Code	Diameter [mm]	Nominal Weight [kg]	Price
HD4482	100 x 100	18.6	£758.93
HD6482	150 x 100	25.8	£1,009.81
HD6682	150 x 150	31.2	£1,248.15

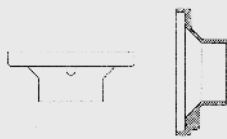

BELLMOUTH GULLY INLET

Product Code	Diameter [mm]	Nominal Weight [kg]	Price
HD4070	100	2.4	£59.95

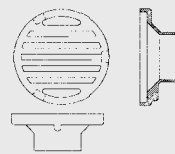

**BELLMOUTH GULLY INLET WITH
SECURED GRATING**

Product Code	Diameter [mm]	Nominal Weight [kg]	Price
HD4071	100	4.7	£80.35

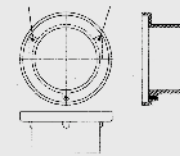

GULLY INLET

Product Code	Diameter [mm]	Nominal Weight [kg]	Price
HD6071	150	2.9	£83.21

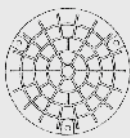

**SOLID COVER WITH
RUBBER SEAL & SCREWS**

Product Code	Diameter [mm]	Nominal Weight [kg]	Price
HD8076	200	2.2	£25.74



PLAIN GRATING

Product Code	Diameter [mm]	Nominal Weight [kg]	Price
HD8077	200	1.8	£14.47



If you don't see a product within this brochure, we have the knowledge, experience and capability to manufacture bespoke castings and fabricated products to support our comprehensive standard ranges.

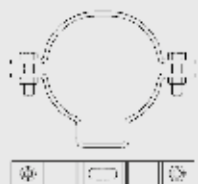

Please refer to our certificates for specific products covered.

**COATED ADJUSTABLE BRACKETS**

Product Code	Diameter [mm]	Nominal Weight [kg]	Price
HD4067	100	0.6	£14.71
HD6067	150	0.8	£27.39
HD8067	200	1.8	£101.54

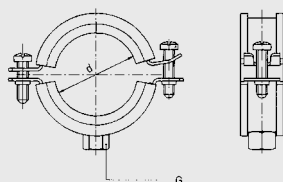
**ZINC PLATED RUBBER LINED BISMAT BRACKETS**

Product Code	Diameter [mm]	Nominal Weight [kg]	Price
HS4061	100	M8/M10	£9.48
HS6061	150	M10	£18.51
HS8061	200	M10	£27.60

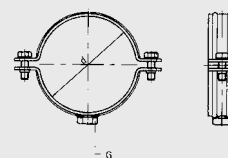
**ZINC PLATED HEAVY DUTY BOSSSED BRACKETS**

Product Code	Diameter [mm]	Nominal Weight [kg]	Price
HS4063	100	M10/M12	£12.61
HS6063	150	M10/M12	£22.07
HS8063	200	M10/M12	£28.59

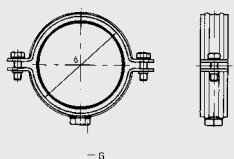
**ZINC PLATED RUBBER LINED HEAVY DUTY BOSSSED BRACKETS**

Product Code	Diameter [mm]	Nominal Weight [kg]	Price
HS4064	100	M10/M12	£16.80
HS6064	150	M10/M12	£30.86
HS8064	200	M10/M12	£35.77

Please check availability of 250mm and 300mm products.