



MAPLE MILL
CABINETY

SPEC BOOK



1 - FACE FRAME

3/4" Solid Wood

* +/- 1/16" On the Overall Width or Height

2 - END PANELS

1/2" Particle Board
Natural Maple Vinyl

3 - FLOOR & CEILING PANELS

1/2" Particle Board
Natural Maple Vinyl

4 - BACK PANEL

3/8" Particle Board
Natural Maple Vinyl

5 - SHELVES

5/8" Thick Edge-Banded
Particle Board with Laminate Finish

6 - SHELF SUPPORTS

Metal Shelf Clips

7 - DOOR & DRAWER FRONTS

3/4" x 2-1/4" Solid Wood Frames
1/4" Veneer Center Panel
3/4" Solid Wood Drawer Front

8 - HINGES

6-Way Adjustable Concealed Hinges

* Optional Soft Close Upgrade Available

9 - DRAWER GLIDES

3/4 Extension Undermount
Epoxy Coated Drawer Glides

* Optional Soft Close Upgrade Available

10 - DRAWER BOXES

1/2" Veneered Plywood
Dovetailed with a 1/4" Bottom

11 - CORNER BRACES

Plastic Corner Braces

12 - TOE KICK

4-1/2" High Particle Board



NOTE: All Cabinet Sides are 1/2" Particle Board with Natural Maple Vinyl. Upgraded Finished Sides Need to be Specified when Ordering.

BRISTOL SHAKER DOOR



Linen (Paint)



Smoke (Paint)

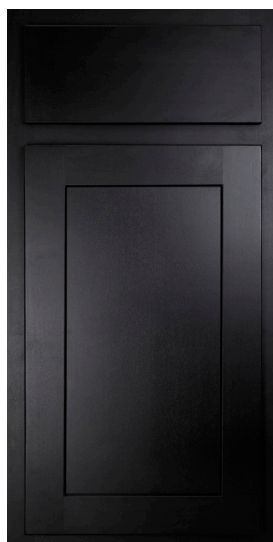

Coffee (Paint)



Graphite (Stain)



Mocha (Stain)



Cinnamon (Stain)



Natural (Clear)



Unfinished (Raw)

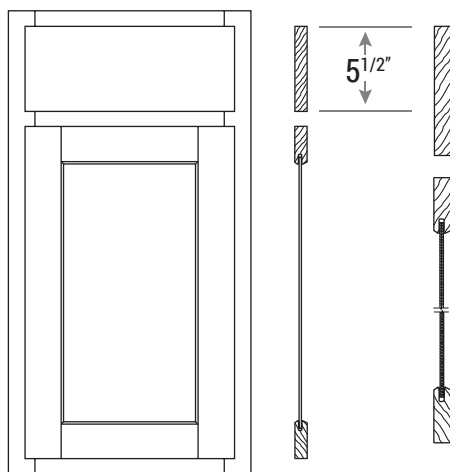

- Standard Overlay Door Style
- Solid Maple Wood Mortise and Tenon Stile and Rail
- Solid Maple Slab Drawer Front
- Veneered MDF Center Panel

Door Construction

 Indicates Solid Wood

 Indicates Veneered Plywood



CABINET NOMENCLATURE

The letter or letters represent the type of cabinet, the first set of numbers represent the width of the cabinet, and the second set of numbers represent the height of the cabinet.

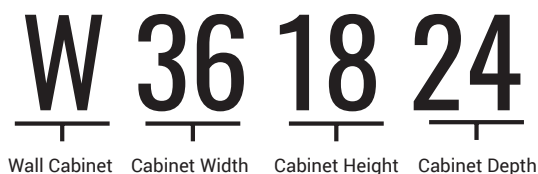
**Note**

- Wall cabinets are 12" deep, unless otherwise noted.
- Call out L or R swing for single door cabinets.

Note

- If a cabinet is more or less than 12" deep, it is represented by a third set of numbers.

Optional Upgrades

Soft Close Doors Add \$11 Per Door to List Price Finished Two Pass Plywood Veneer Side Add \$12 Per Side to List Price

Wall Bridge Double Door 12" High

- No Shelf

12" DEEP	LIST	24" DEEP	LIST
W3012	\$159	W301224	\$219
W3312	\$164	W331224	\$224
W3612	\$167	W361224	\$227

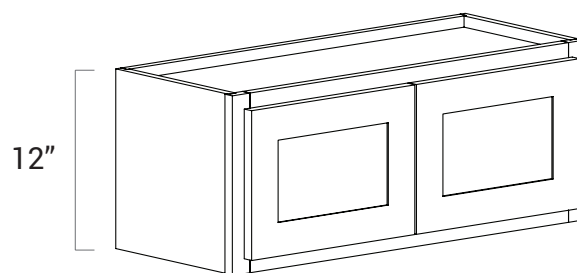

Wall Bridge Double Door 15" High

- No Shelf

12" DEEP	LIST	24" DEEP	LIST
W3015	\$174	W301524	\$234
W3315	\$188	W331524	\$248
W3615	\$192	W361524	\$252

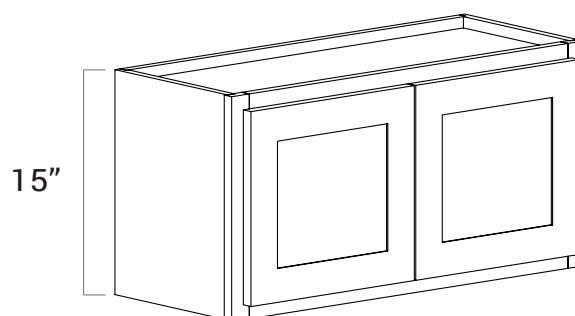

Wall Microwave 18" High

- No Doors
- 3/4" Solid Maple Shelf to Match Exterior
- 27" x 14^{1/4}" Opening

12" DEEP	LIST
WMW3018	\$200

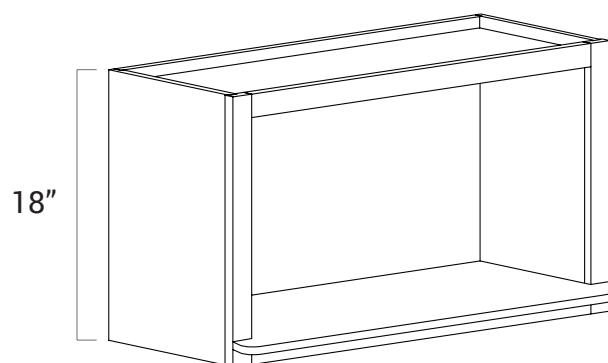

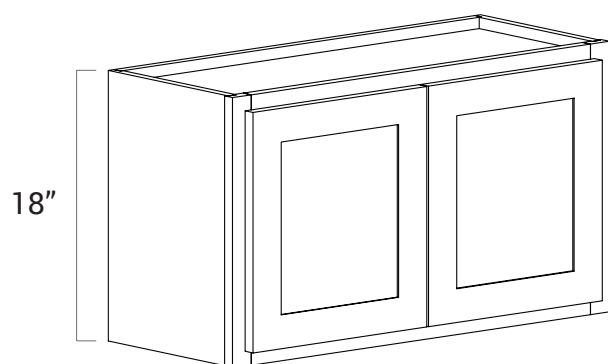

*** W4218**
 - 2" Exposed Center Stile
 - Center Stile for Extra Support

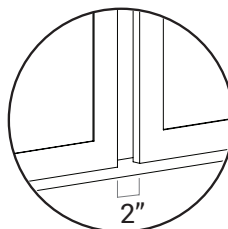

Wall Bridge Double Door 18" High

- No Shelf
- 3" Center Stile on W4218

12" DEEP	LIST	24" DEEP	LIST
W2418	\$161		
W3018	\$181	W301824	\$241
W3318	\$189	W331824	\$249
W3618	\$207	W361824	\$267
* W4218	\$227		

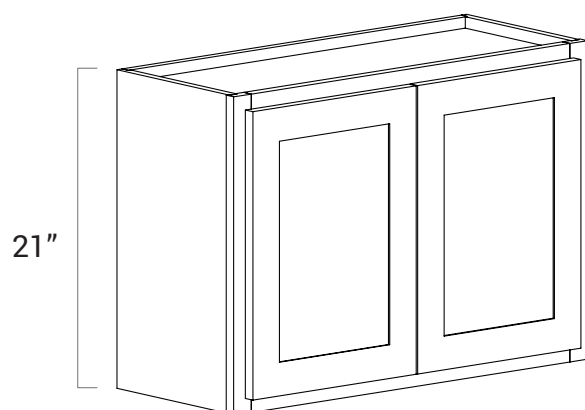

Wall Bridge Double Door 21" High

- No Shelf

12" DEEP	LIST	24" DEEP	LIST
W3021	\$188	W302124	\$248
W3321	\$196	W332124	\$256
W3621	\$214	W362124	\$274

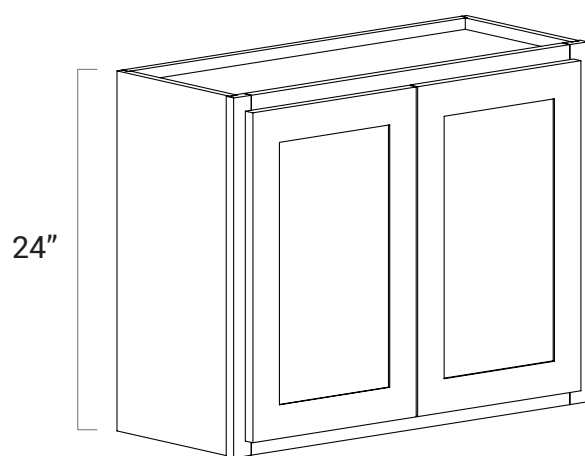

*** W4224**
 - 2" Exposed Center Stile
 - Center Stile for Extra Support

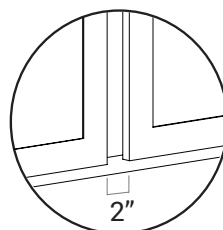

Wall Bridge Double Door 24" High

- One Adjustable Shelf
- 3" Center Stile on W4224

12" DEEP	LIST	24" DEEP	LIST
W2424	\$157		
W3024	\$181	W302424	\$241
W3324	\$196	W332424	\$256
W3624	\$213	W362424	\$273
* W3924	\$229	* W392424	\$289
* W4224	\$244		

30" WALL CABINETS

Wall Single Door 30" High

- Two Adjustable Shelves

12" DEEP	LIST
W0930	\$130
W1230	\$151
W1530	\$155
W1830	\$162
W2130	\$170

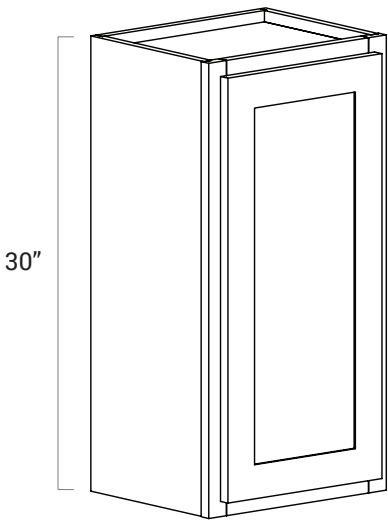

Wall Double Door 30" High

- Two Adjustable Shelves
- 39" and 42" Wide Cabinets Have a 3" Center Stile

12" DEEP	LIST
W2430	\$207
W2730	\$217
W3030	\$225
W3330	\$228
W3630	\$250
* W3930	\$254
* W4230	\$265

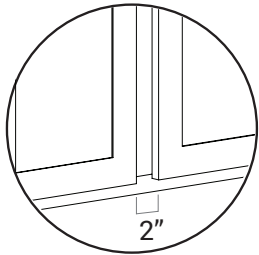
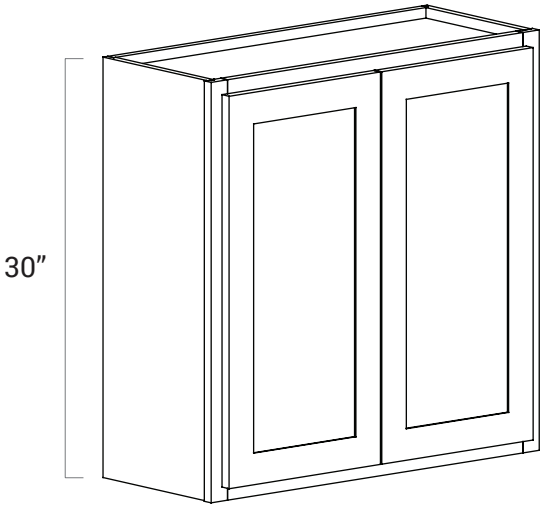

* W3930 and W4230
- 2" Exposed Center Stile
- Center Stile for Extra Support

Wall Diagonal Corner 30" High

- Two Adjustable Shelves

12" DEEP	LIST
DW2430	\$270

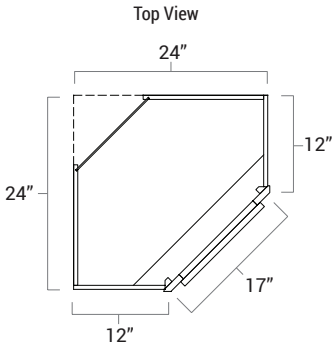
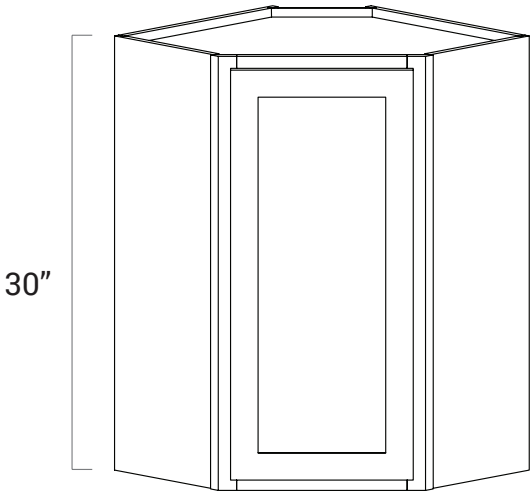

Wall Blind Corner

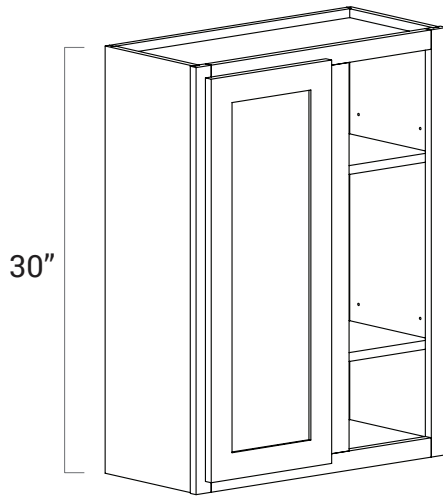

- Two Adjustable Shelves
- WC42-4530 Have Butt Doors
- Cabinet Must be Pulled From the Wall
- Cabinet Can be Flipped For Left or Right Use

Face Frame
Opening Dimensions

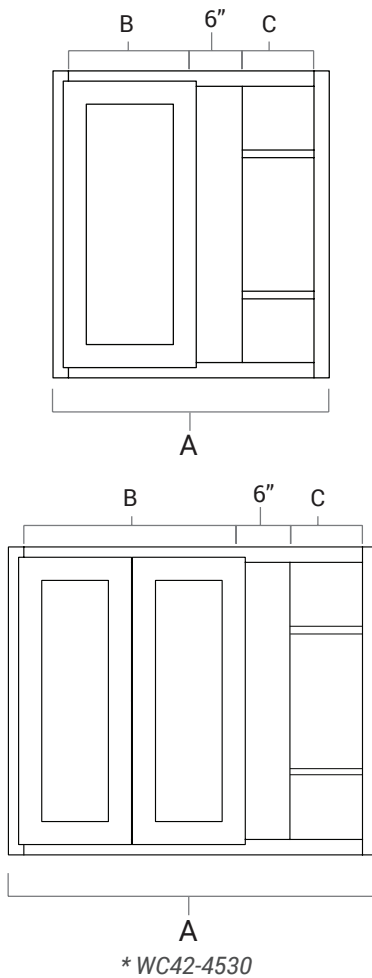

12" DEEP	LIST	A	B	C	D	
		Cabinet Width	Door Opening	Blind Opening	* Min Pull	Max Pull
WC24-2730	\$168	23"	8"	6"	24"	27"
WC36-3930	\$217	35"	20"	6"	36"	39"
* WC42-4530	\$237	41"	26"	6"	42"	45"

* Minimum Pull Dimensions Must Be Adjusted For Hardware

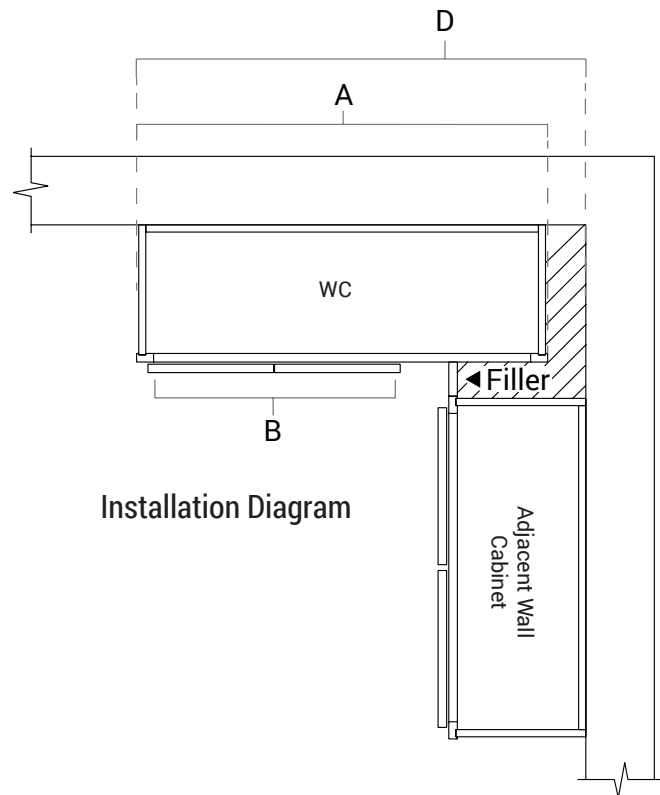

Installation Diagram

36" WALL CABINETS

Wall Single Door 36" High

- Two Adjustable Shelves

12" DEEP	LIST
W0936	\$200
W1236	\$207
W1536	\$224
W1836	\$237
W2136	\$253

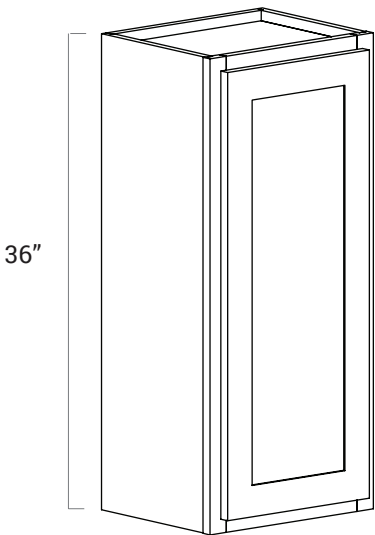

Wall Double Door 36" High

- Two Adjustable Shelves
- 39" and 42" Wide Cabinets Have a 3" Center Stile

12" DEEP	LIST
W2436	\$284
W2736	\$294
W3036	\$305
W3336	\$331
W3636	\$345
* W3936	\$353
* W4236	\$362

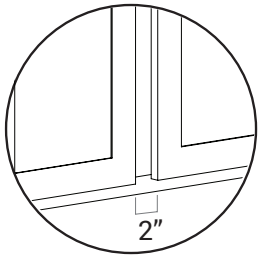
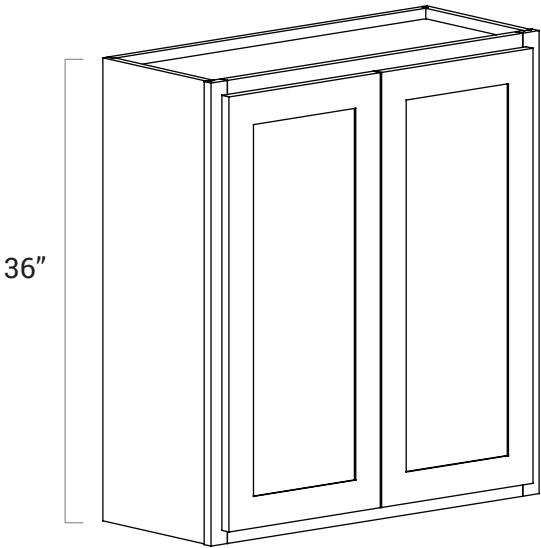

* W3936 and W4236
- 2" Exposed Center Stile
- Center Stile for Extra Support

Wall Diagonal Corner 36" High

- Two Adjustable Shelves

12" DEEP	LIST
DW2436	\$415

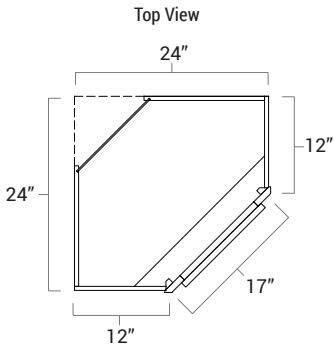
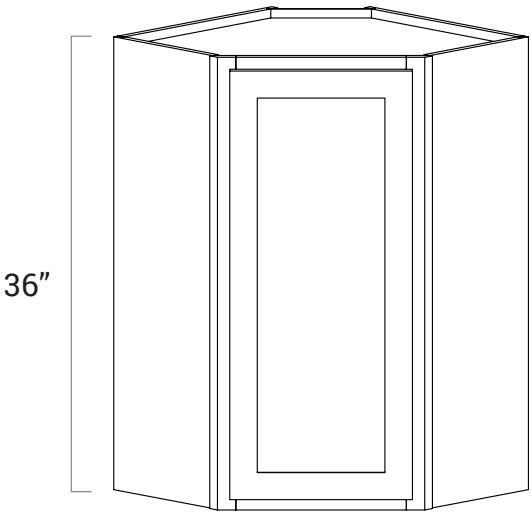

Wall Blind Corner

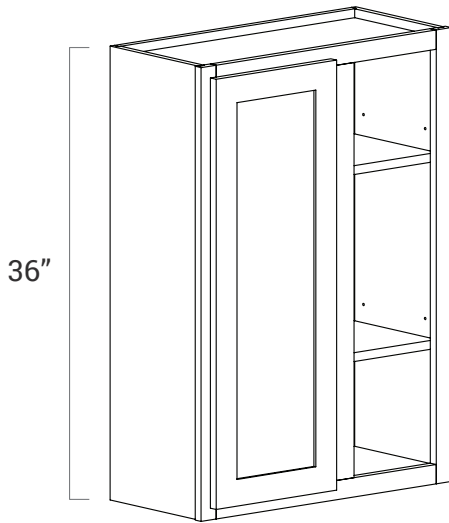

- Two Adjustable Shelves
- WC42-4536 Have Butt Doors
- Cabinet Must be Pulled From the Wall
- Cabinet Can be Flipped for Left or Right Use

Face Frame
Opening Dimensions

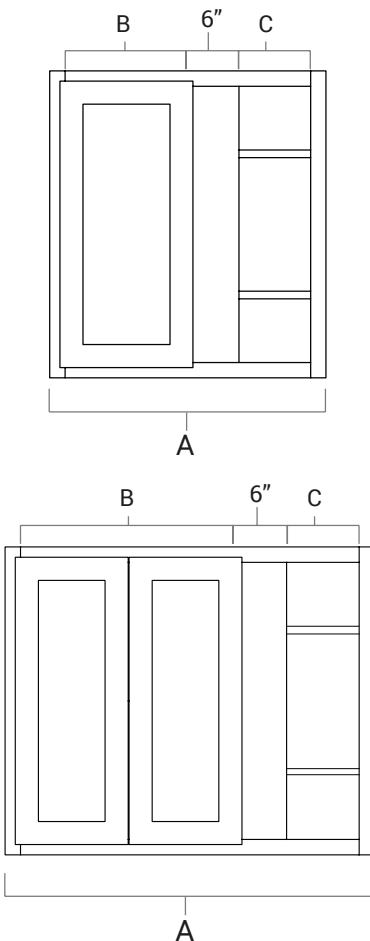

* WC42-4536

		A	B	C	D	
		Cabinet Width	Door Opening	Blind Opening	* Min Pull	Max Pull
12" DEEP	LIST					
WC24-2736	\$238	23"	8"	6"	24"	27"
WC36-3936	\$287	35"	20"	6"	36"	39"
* WC42-4536	\$307	41"	26"	6"	42"	45"

* Minimum Pull Dimensions Must Be Adjusted For Hardware

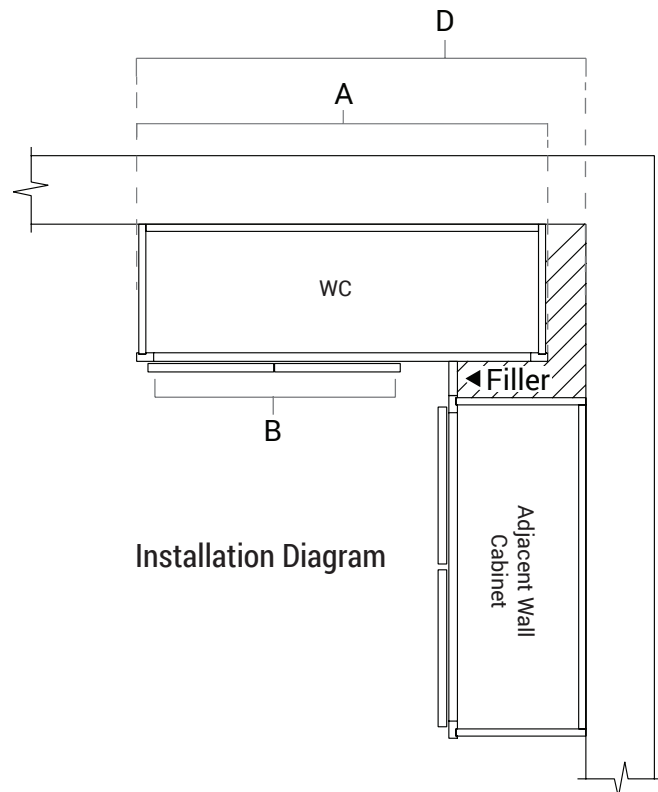

Installation Diagram

42" WALL CABINETS

Wall Single Door 42" High

- Three Adjustable Shelves

12" DEEP	LIST
W0942	\$200
W1242	\$207
W1542	\$224
W1842	\$237
W2142	\$253

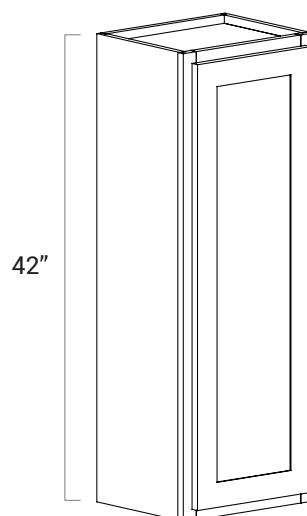

Wall Double Door 42" High

- Three Adjustable Shelves
- 39" and 42" Wide Cabinets Have a 3" Center Stile

12" DEEP	LIST
W2442	\$284
W2742	\$294
W3042	\$305
W3342	\$331
W3642	\$345
* W3942	\$353
* W4242	\$362

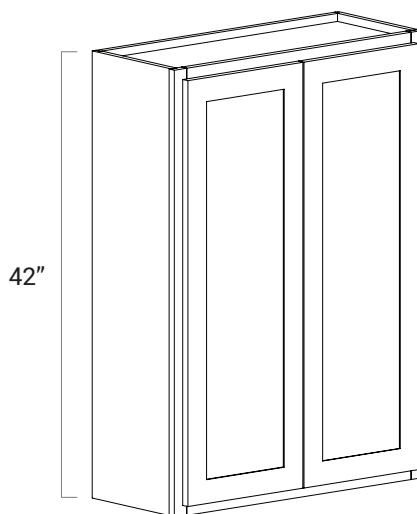

* W3942 and W4242
- 2" Exposed Center Stile
- Center Stile for Extra Support

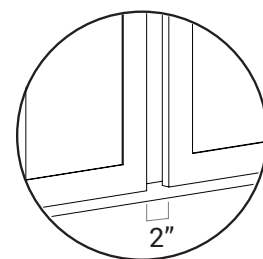

Wall Diagonal Corner 42" High

- Three Adjustable Shelves

12" DEEP	LIST
DW2442	\$415

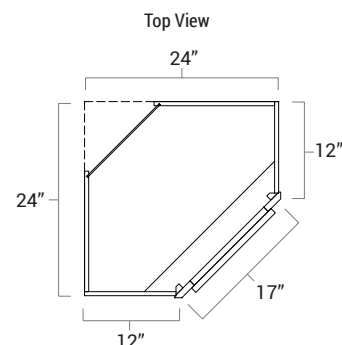
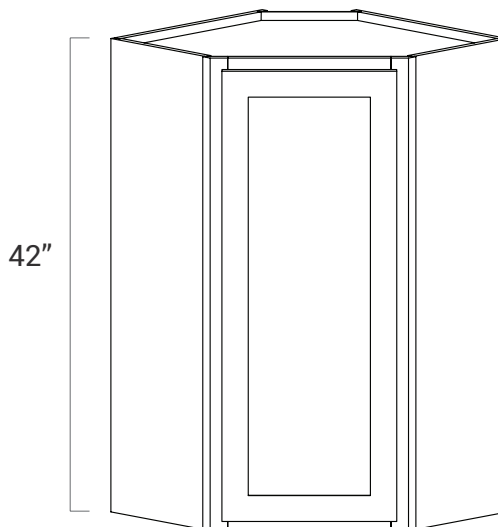

Wall Blind Corner

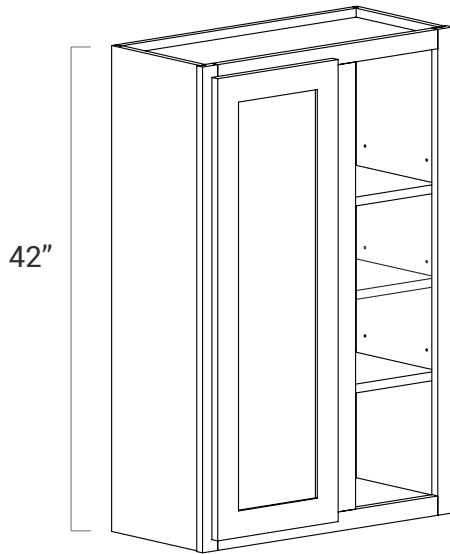

- Three Adjustable Shelves
- WC42-4542 Have Butt Doors
- Cabinet Must be Pulled From the Wall
- Cabinet Can be Flipped for Left or Right Use

Face Frame
Opening Dimensions

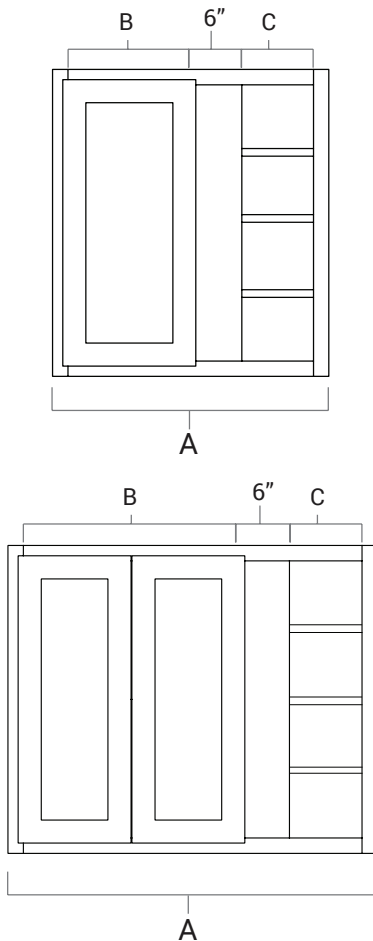

* WC42-4542

12" DEEP	LIST	A	B	C	D	
		Cabinet Width	Door Opening	Blind Opening	* Min Pull	Max Pull
WC24-2742	\$238	23"	8"	6"	24"	27"
WC36-3942	\$287	35"	20"	6"	36"	39"
* WC42-4542	\$307	41"	26"	6"	42"	45"

* Minimum Pull Dimensions Must Be Adjusted For Hardware

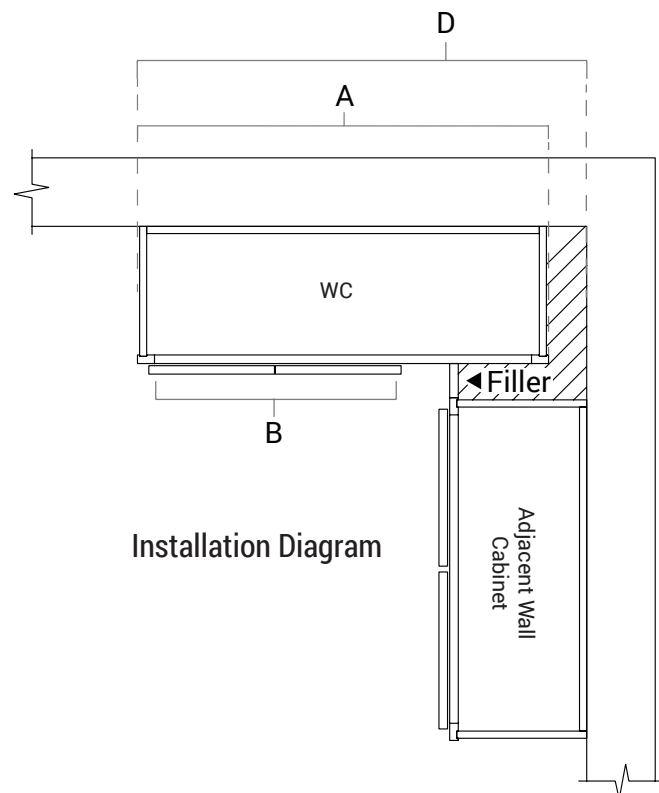

Installation Diagram

CABINET NOMENCLATURE

The letter or letters represent the type of cabinet, the first set of numbers represent the width of the cabinet.

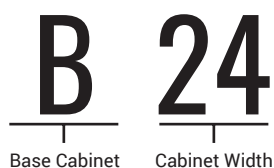
**Note**

- Base cabinets are 24" deep, unless otherwise noted.
- Vanities are 21" deep, unless otherwise noted.
- Call out L or R swing for single door cabinets.

Note

- If there is a second set of numbers they represent the depth of the cabinet, otherwise it is a standard 24" deep cabinet.

Optional Upgrades

Soft Close Doors Add \$11 Per Door to List Price Soft Close Drawer Add \$45 Per Drawer to List Price

Finished Two Pass Plywood Veneer Side Add \$12 Per Side to List Price

Base Full Height Single Door

- One Adjustable Shelf

24" DEEP	LIST	21" DEEP	LIST	18" DEEP	LIST	15" DEEP	LIST	12" DEEP	LIST
FHB09	\$161	FHB0921	\$161	FHB0918	\$161	FHB0915	\$161	FHB0912	\$161
FHB12	\$174	FHB1221	\$174	FHB1218	\$174	FHB1215	\$174	FHB1212	\$174
FHB15	\$187	FHB1521	\$187	FHB1518	\$187	FHB1515	\$187	FHB1512	\$187
FHB18	\$200	FHB1821	\$200	FHB1818	\$200	FHB1815	\$200	FHB1812	\$200
FHB21	\$213	FHB2121	\$213	FHB2118	\$213	FHB2115	\$213	FHB2112	\$213

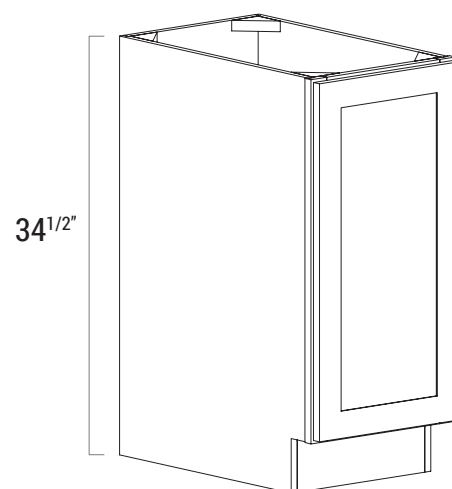

Base Full Height Double Door

- Two Adjustable Shelves
- 3" Center Stile on 39" and 42"

24" DEEP	LIST	21" DEEP	LIST	18" DEEP	LIST	15" DEEP	LIST	12" DEEP	LIST
FHB24	\$246	FHB2421	\$246	FHB2418	\$246	FHB2415	\$246	FHB2412	\$246
FHB27	\$256	FHB2721	\$256	FHB2718	\$256	FHB2715	\$256	FHB2712	\$256
FHB30	\$288	FHB3021	\$288	FHB3018	\$288	FHB3015	\$288	FHB3012	\$288
FHB33	\$301	FHB3321	\$301	FHB3318	\$301	FHB3315	\$301	FHB3312	\$301
FHB36	\$310	FHB3621	\$310	FHB3618	\$310	FHB3615	\$310	FHB3612	\$310
* FHB39	\$316	* FHB3921	\$316	* FHB3918	\$316	* FHB3915	\$316	* FHB3912	\$316
* FHB42	\$328	* FHB4221	\$328	* FHB4218	\$328	* FHB4215	\$328	* FHB4212	\$328

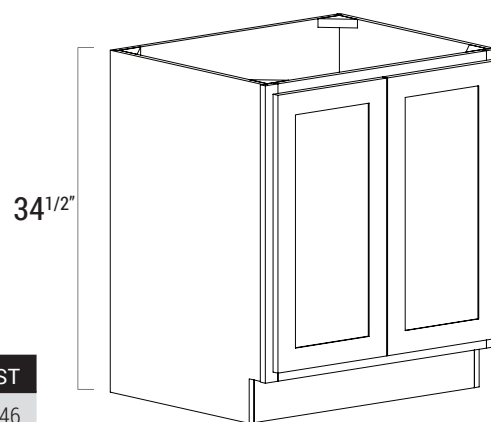

(*) - 2" Exposed Center Stile
- Center Stile for Extra Support

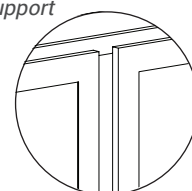

Base Full Height Single Door With Roll Out Shelves (ROS)

• One Level of ROS Includes One Adjustable Shelf

34¹/₂"

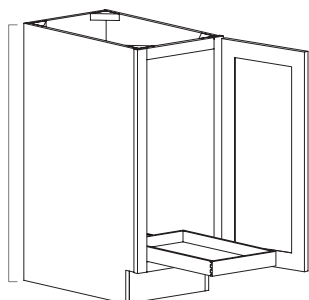

34¹/₂"

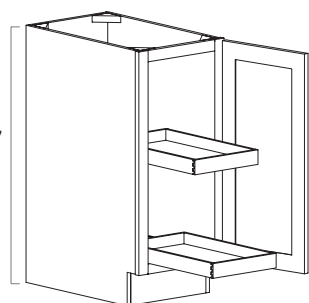

One Level of Roll Out Shelves (ROS)

24" DEEP	LIST	21" DEEP	LIST	18" DEEP	LIST
FHB12ROS	\$264	FHB1221ROS	\$264	FHB1218ROS	\$264
FHB15ROS	\$277	FHB1521ROS	\$277	FHB1518ROS	\$277
FHB18ROS	\$290	FHB1821ROS	\$290	FHB1818ROS	\$290
FHB21ROS	\$300	FHB2121ROS	\$300	FHB2118ROS	\$300

Two Levels of Roll Out Shelves (ROS2)

24" DEEP	LIST	21" DEEP	LIST	18" DEEP	LIST
FHB12ROS2	\$354	FHB1221ROS2	\$354	FHB1218ROS2	\$354
FHB15ROS2	\$367	FHB1521ROS2	\$367	FHB1518ROS2	\$367
FHB18ROS2	\$380	FHB1821ROS2	\$380	FHB1818ROS2	\$380
FHB21ROS2	\$390	FHB2121ROS2	\$390	FHB2118ROS2	\$390

Base Full Height Double Door With Roll Out Shelves (ROS)

• One Adjustable Shelf With One Level ROS
• 39" and 42" Will Have Two or Four ROS Due to the Center Stile

34¹/₂"

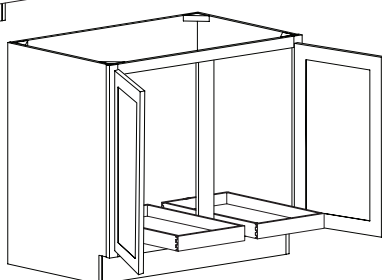
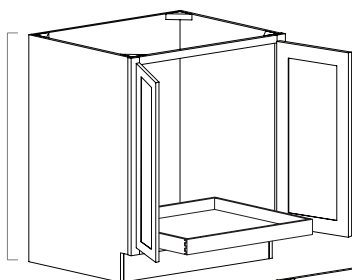

34¹/₂"

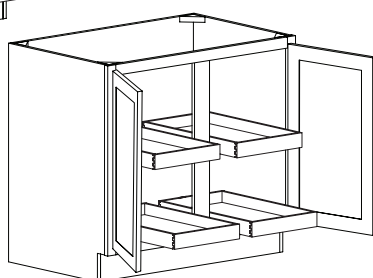
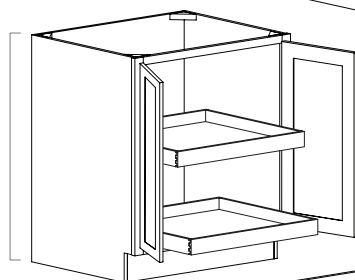

One Level of Roll Out Shelves (ROS)

24" DEEP	LIST	21" DEEP	LIST	18" DEEP	LIST
FHB24ROS	\$336	FHB2421ROS	\$336	FHB2418ROS	\$336
FHB27ROS	\$346	FHB2721ROS	\$346	FHB2718ROS	\$346
FHB30ROS	\$378	FHB3021ROS	\$378	FHB3018ROS	\$378
FHB33ROS	\$391	FHB3321ROS	\$391	FHB3318ROS	\$391
FHB36ROS	\$400	FHB3621ROS	\$400	FHB3618ROS	\$400
* FHB39ROS	\$496	* FHB3921ROS	\$496	* FHB3918ROS	\$496
* FHB42ROS	\$508	* FHB4221ROS	\$508	* FHB4218ROS	\$508

Two Levels of Roll Out Shelves (ROS2)

24" DEEP	LIST	21" DEEP	LIST	18" DEEP	LIST
FHB24ROS2	\$426	FHB2421ROS2	\$426	FHB2418ROS2	\$426
FHB27ROS2	\$436	FHB2721ROS2	\$436	FHB2718ROS2	\$436
FHB30ROS2	\$468	FHB3021ROS2	\$468	FHB3018ROS2	\$468
FHB33ROS2	\$481	FHB3321ROS2	\$481	FHB3318ROS2	\$481
FHB36ROS2	\$490	FHB3621ROS2	\$490	FHB3618ROS2	\$490
* FHB39ROS2	\$676	* FHB3921ROS2	\$676	* FHB3918ROS2	\$676
* FHB42ROS2	\$688	* FHB4221ROS2	\$688	* FHB4218ROS2	\$688

Base Single Door

- One Adjustable Shelf

24" DEEP	LIST	21" DEEP	LIST	18" DEEP	LIST
B12	\$214	B1221	\$244	B1218	\$244
B15	\$227	B1521	\$257	B1518	\$257
B18	\$240	B1821	\$270	B1818	\$270
B21	\$250	B2121	\$280	B2118	\$280

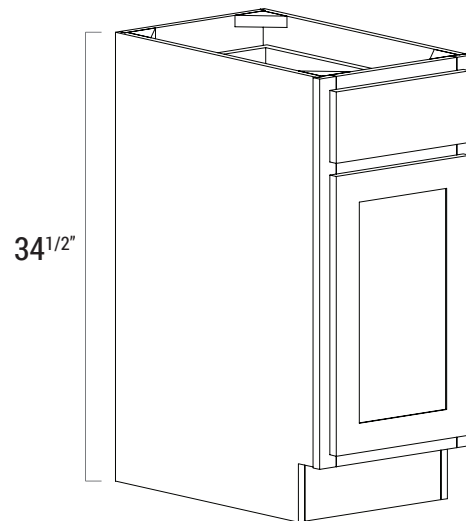

Base Double Door

- One Adjustable Shelf
- 3" Center Stile on 39", 42" and 48"
- 39", 42" and 48" Have Two Drawers

24" DEEP	LIST	21" DEEP	LIST	18" DEEP	LIST
B24	\$286	B2421	\$316	B2418	\$316
B27	\$296	B2721	\$326	B2718	\$326
B30	\$322	B3021	\$352	B3018	\$352
B33	\$341	B3321	\$371	B3318	\$371
B36	\$359	B3621	\$389	B3618	\$389
* B39	\$374	* B3921	\$404	* B3918	\$404
* B42	\$386	* B4221	\$416	* B4218	\$416
* B48	\$410	* B4821	\$440	* B4818	\$440

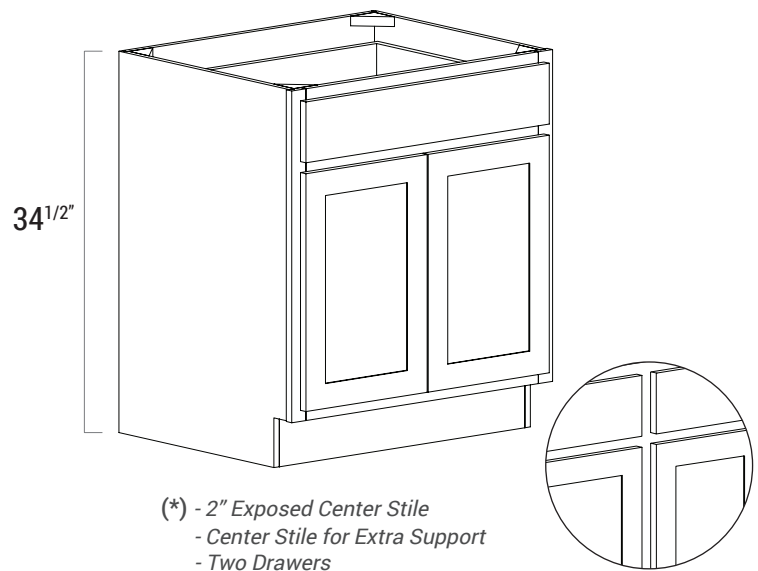

Notes:

Base Single Door With Roll Out Shelves (ROS)

- One Adjustable Shelf With One Level ROS

One Level of Roll Out Shelves (ROS)

24" DEEP	LIST	21" DEEP	LIST	18" DEEP	LIST
B12ROS	\$304	B1221ROS	\$334	B1218ROS	\$334
B15ROS	\$317	B1521ROS	\$347	B1518ROS	\$347
B18ROS	\$330	B1821ROS	\$360	B1818ROS	\$360
B21ROS	\$340	B2121ROS	\$370	B2118ROS	\$370

Two Levels of Roll Out Shelves (ROS2)

24" DEEP	LIST	21" DEEP	LIST	18" DEEP	LIST
B12ROS2	\$394	B1221ROS2	\$424	B1218ROS2	\$424
B15ROS2	\$407	B1521ROS2	\$437	B1518ROS2	\$437
B18ROS2	\$420	B1821ROS2	\$450	B1818ROS2	\$450
B21ROS2	\$430	B2121ROS2	\$460	B2118ROS2	\$460

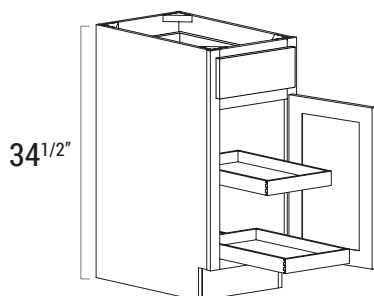
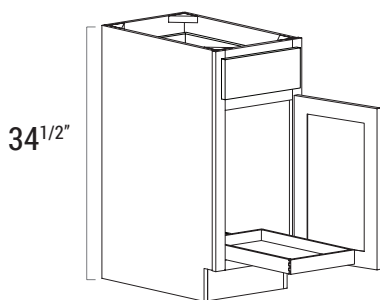

Base Double Door With Roll Out Shelves (ROS)

- One Adjustable Shelf With One Level ROS
- 39", 42" and 48" Will Have Two or Four ROS Due to the Center Stile

One Level of Roll Out Shelves (ROS)

24" DEEP	LIST	21" DEEP	LIST	18" DEEP	LIST
B24ROS	\$376	B2421ROS	\$406	B2418ROS	\$406
B27ROS	\$386	B2721ROS	\$416	B2718ROS	\$416
B30ROS	\$412	B3021ROS	\$442	B3018ROS	\$442
B33ROS	\$431	B3321ROS	\$461	B3318ROS	\$461
B36ROS	\$449	B3621ROS	\$479	B3618ROS	\$479
* B39ROS	\$554	* B3921ROS	\$584	* B3918ROS	\$584
* B42ROS	\$566	* B4221ROS	\$596	* B4218ROS	\$596
* B48ROS	\$590	* B4821ROS	\$620	* B4818ROS	\$620

Two Levels of Roll Out Shelves (ROS2)

24" DEEP	LIST	21" DEEP	LIST	18" DEEP	LIST
B24ROS2	\$466	B2421ROS2	\$496	B2418ROS2	\$496
B27ROS2	\$476	B2721ROS2	\$506	B2718ROS2	\$506
B30ROS2	\$502	B3021ROS2	\$532	B3018ROS2	\$532
B33ROS2	\$521	B3321ROS2	\$551	B3318ROS2	\$551
B36ROS2	\$539	B3621ROS2	\$569	B3618ROS2	\$569
* B39ROS2	\$734	* B3921ROS2	\$764	* B3918ROS2	\$764
* B42ROS2	\$746	* B4221ROS2	\$776	* B4218ROS2	\$776
* B48ROS2	\$770	* B4821ROS2	\$800	* B4818ROS2	\$800

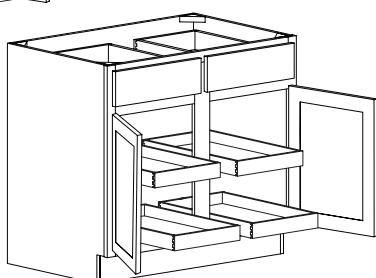
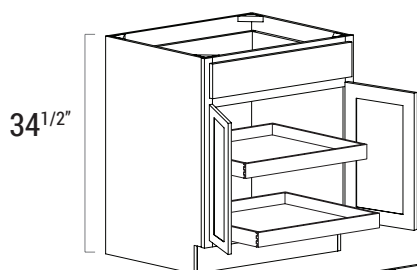
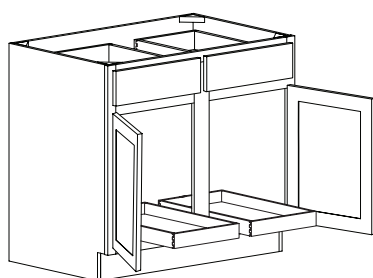
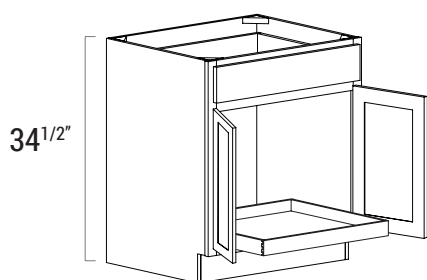

Three Drawer Base

- Top Drawer Aligns With Standard Base Cabinets
- Bottom Two Drawer Boxes are 6" High

24" DEEP	LIST	21" DEEP	LIST	18" DEEP	LIST
DB12	\$310	DB1221	\$340	DB1218	\$340
DB15	\$325	DB1521	\$355	DB1518	\$355
DB18	\$342	DB1821	\$372	DB1818	\$372
DB21	\$363	DB2121	\$393	DB2118	\$393
DB24	\$380	DB2421	\$410	DB2418	\$410
DB30	\$413	DB3021	\$443	DB3018	\$443

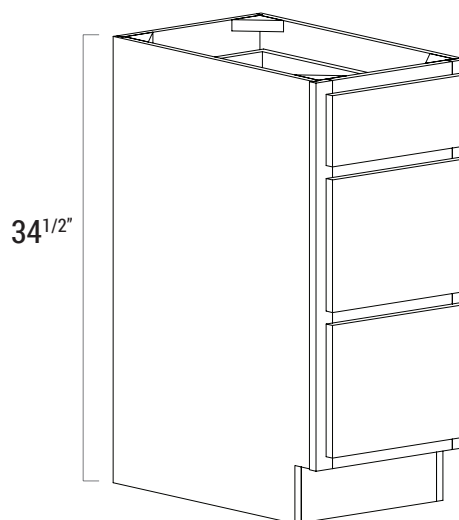

Sink Base

- False Drawer Front
- No Shelf
- 3" Center Stile on 39", 42" and 48"
- 39", 42" and 48 Have Two False Drawer Fronts

24" DEEP	LIST	21" DEEP	LIST	18" DEEP	LIST
SB24	\$255	SB2421	\$285	SB2418	\$285
SB27	\$265	SB2721	\$295	SB2718	\$295
SB30	\$290	SB3021	\$320	SB3018	\$320
SB33	\$295	SB3321	\$325	SB3318	\$325
SB36	\$325	SB3621	\$355	SB3618	\$355
* SB39	\$331	* SB3921	\$361	* SB3918	\$361
* SB42	\$343	* SB4221	\$373	* SB4218	\$373
* SB48	\$360	* SB4821	\$390	* SB4818	\$390

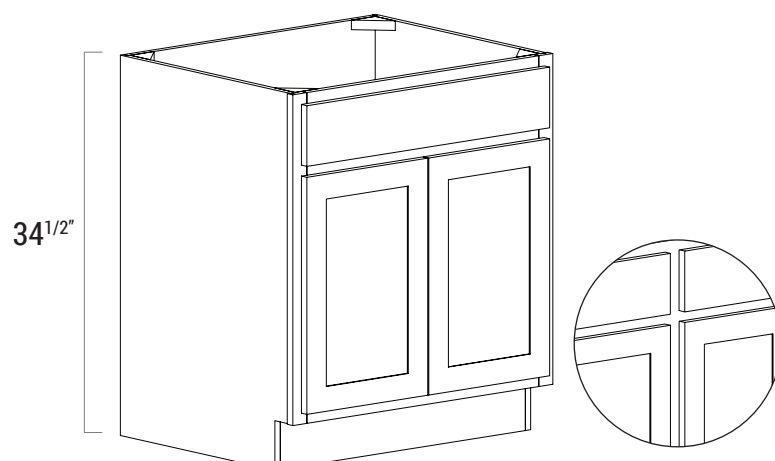

- (*) - 2" Exposed Center Stile
 - Center Stile for Extra Support
 - Two False Drawer Fronts

Farm Sink Base

- No False Drawer Front
- No Shelf
- 33" x 8 3/4" Opening
- Butt Doors

24" DEEP	LIST
FSB36	\$390

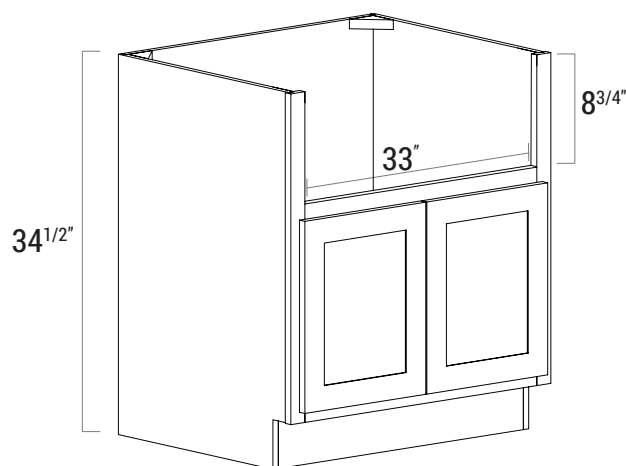

Lazy Susan Base

- Full Height, Bi-Folding Door
- Two 28" Independently Rotating Trays
- Soft Close Door Not Available
- Needs to be Pulled to 36" From the Corner
- Built Smaller to Fit Through Doors
- If Butting Up to an Appliance, a Base Skin (BSK24) is Needed to Finish the Exposed Side

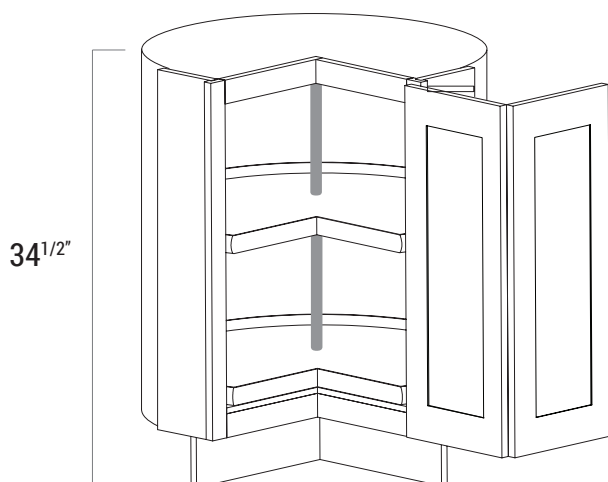

24" DEEP	LIST
LS36	\$587

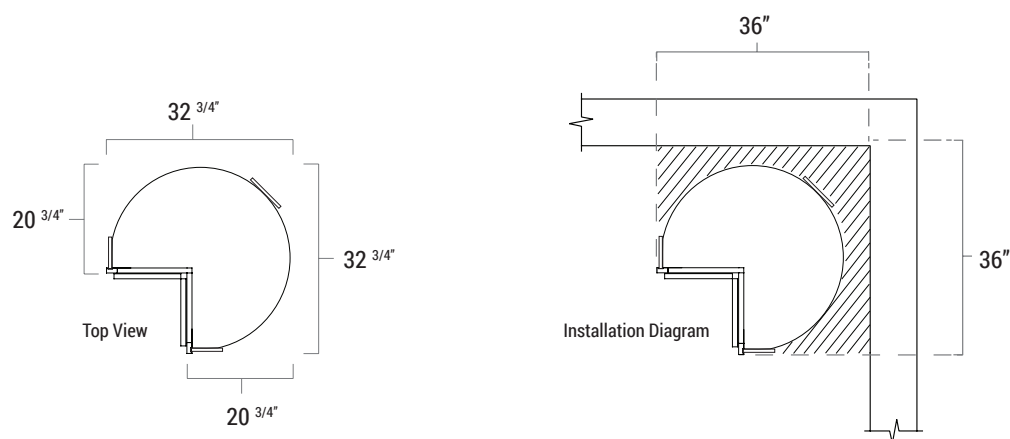

Diagonal Sink Base

- No Shelf
- False Drawer Front
- DSB42 Has Butt Doors

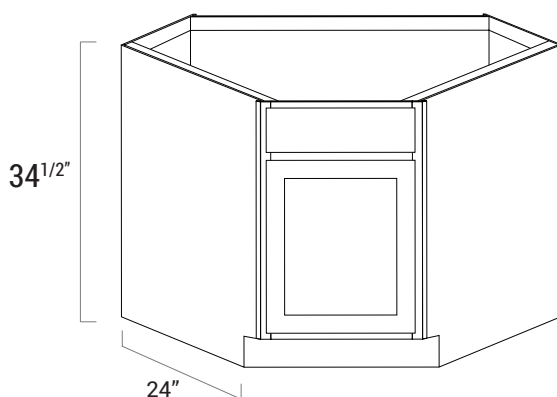

24" DEEP	LIST
DSB36	\$510
DSB42	\$560

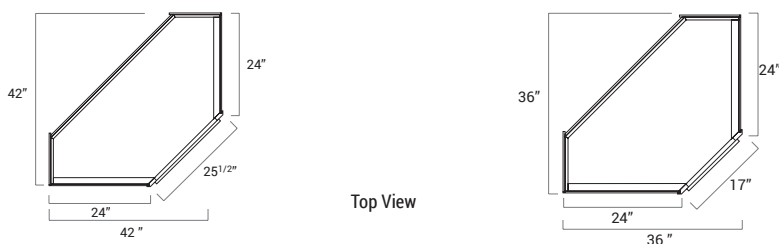

Blind Corner Base

- One Adjustable Shelf
- Cabinet Must be Pulled From the Wall
- Minimum Pull Dimensions Must be Adjusted for Hardware
- Filler Recommend But Not Included
- Specify Left or Right Blind
- Door Hinges on Center Stile

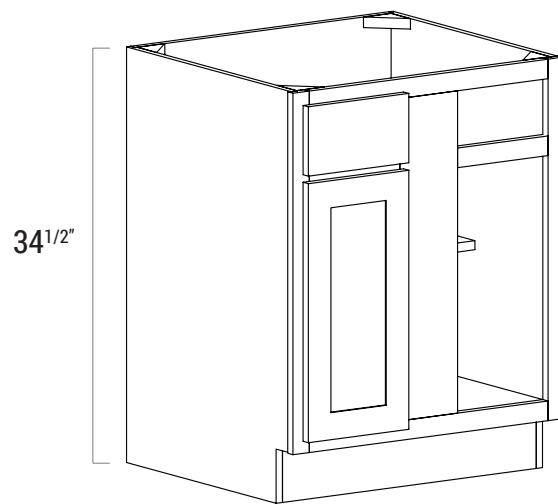

Right Blind Shown

24" DEEP	LIST
BC36-39	\$322
BC42-45	\$338
BC48-51	\$355

	A	B	C	D	
	Cabinet Width	Door Opening	Blind Opening	* Min Pull	Max Pull
24" DEEP					
BC36-39	27"	9"	9"	36"	39"
BC42-45	36"	13 1/2"	13 1/2"	42"	45"
BC48-51	48"	19 1/2"	19 1/2"	48"	51"

* Minimum Pull Dimensions Must Be Adjusted For Hardware

Face Frame
Opening Dimensions

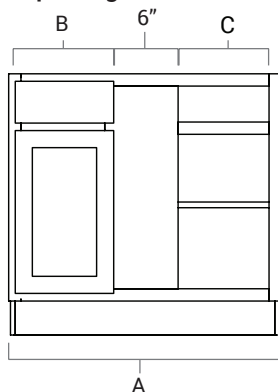

Installation Diagram

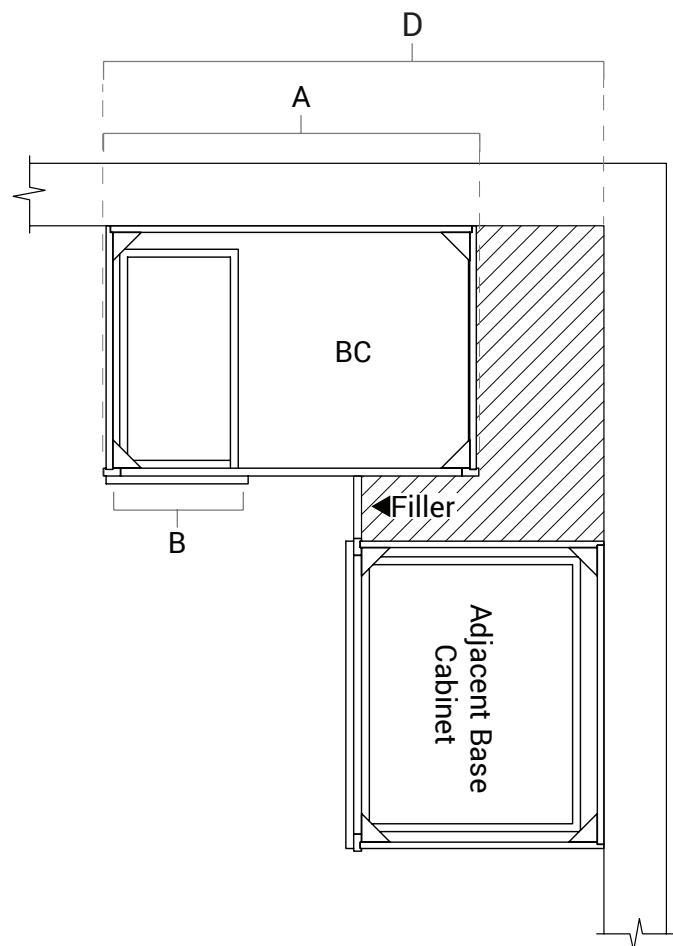

Base Waste Basket

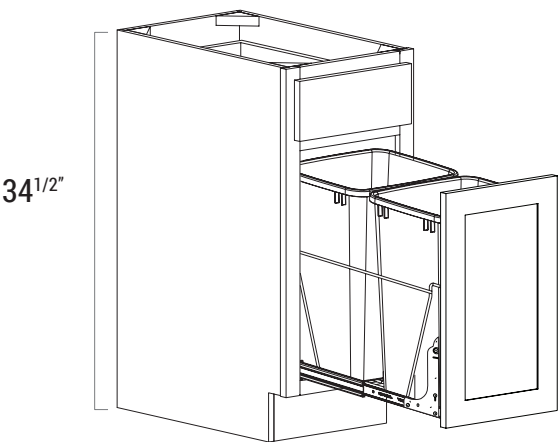

- No Shelf
- Soft Close Not Available on the Waste Basket Pull Out
- Includes (2) 35 Quart Bins

24" DEEP	LIST
BWB18	\$420

Microwave Base

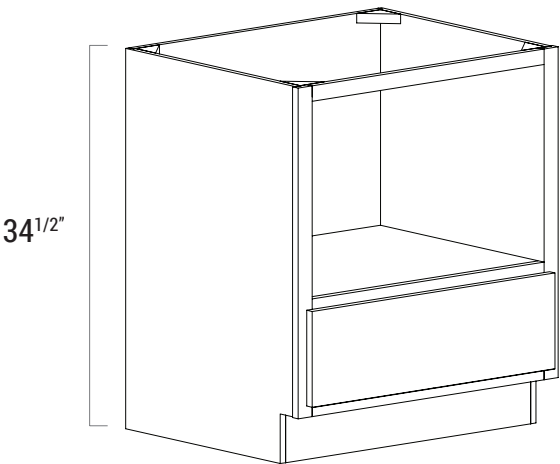

- No Shelf
- Drawer Under Microwave Cut Out
- Finished Interior to Match Exterior

24" DEEP	LIST	OPENING (W x H)
MWB24	\$350	21" x 15 ⁷ / ₈ "
MWB27	\$355	24" x 15 ⁷ / ₈ "
MWB30	\$360	27" x 15 ⁷ / ₈ "

Notes:

Utility Pantry Single Door

- Shelves Not Included
- See Page 31 for Shelf Kit

Cabinet Frame Opening

	A	B
84	27"	46 ^{1/2} "
90	33"	46 ^{1/2} "
96	39"	46 ^{1/2} "

24" DEEP	LIST	21" DEEP	LIST	18" DEEP	LIST	15" DEEP	LIST	12" DEEP	LIST
U1884	\$566	U188421	\$566	U188418	\$566	U188415	\$566	U188412	\$566
U1890	\$711	U189021	\$711	U189018	\$711	U189015	\$711	U189012	\$711
U1896	\$711	U189621	\$711	U189618	\$711	U189615	\$711	U189612	\$711

84"
90"
96"

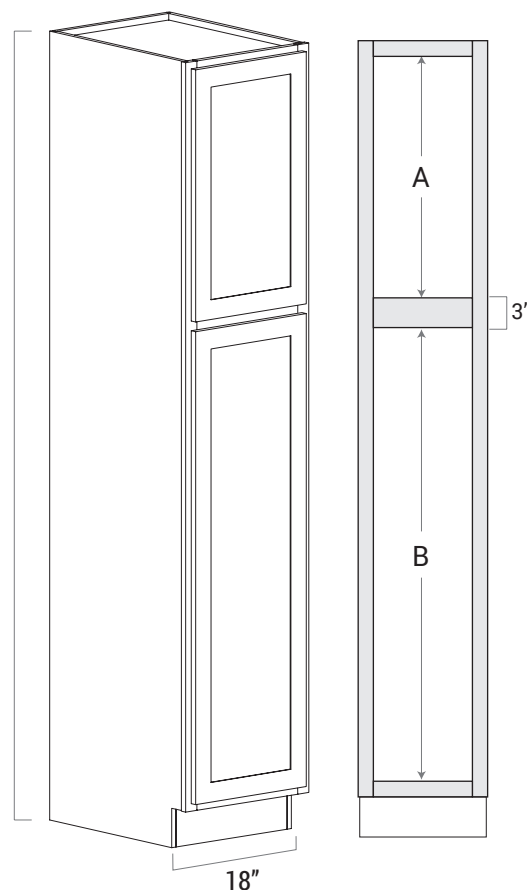

Utility Pantry Single Door With Roll Out Shelves (ROS)

- Four Roll Out Shelves in the Lower Opening
- No Shelves in the Upper Opening
- See Page 31 for Shelf Kit
- Refer to Chart for Cabinet Frame Opening Sizes

24" DEEP	LIST	21" DEEP	LIST	18" DEEP	LIST
U1884ROS4	\$900	U188421ROS4	\$900	U188418ROS4	\$900
U1890ROS4	\$1125	U189021ROS4	\$1125	U189018ROS4	\$1125
U1896ROS4	\$1125	U189621ROS4	\$1125	U189618ROS4	\$1125

84"
90"
96"

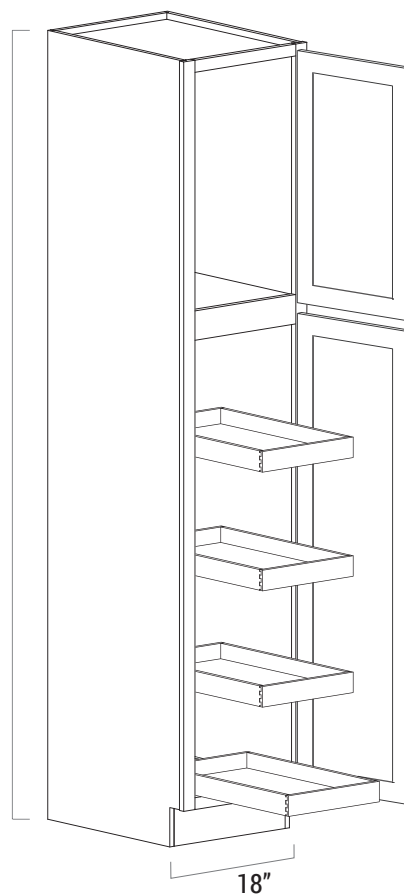

Utility Pantry Butt Doors

- Butt Doors
- Shelves Not Included
- Shelf Kits on Page 31

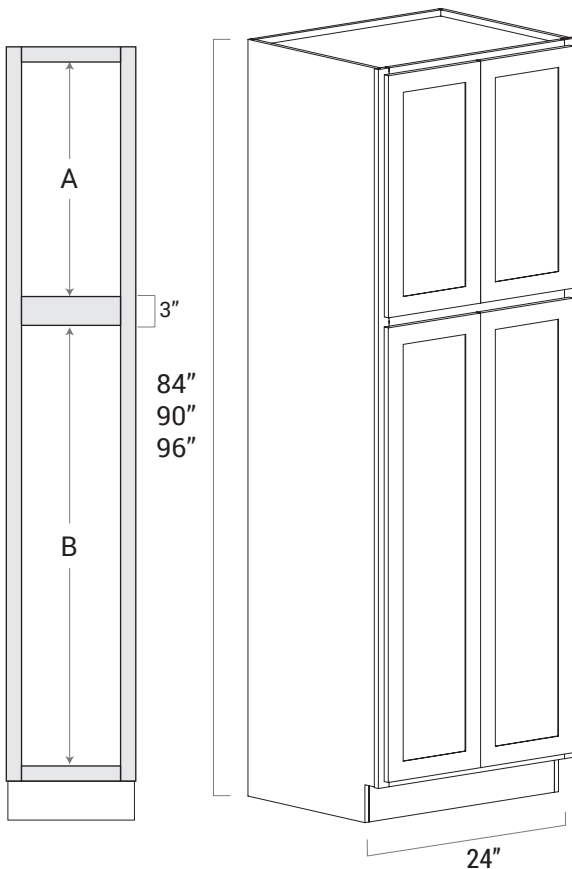

Cabinet Frame Opening

	A	B
84	27"	46 1/2"
90	33"	46 1/2"
96	39"	46 1/2"

24" DEEP	LIST	21" DEEP	LIST	18" DEEP	LIST	15" DEEP	LIST	12" DEEP	LIST
U2484	\$634	U248421	\$634	U248418	\$634	U248415	\$634	U248412	\$634
U2490	\$779	U249021	\$779	U249018	\$779	U249015	\$779	U249012	\$779
U2496	\$779	U249621	\$779	U249618	\$779	U249615	\$779	U249612	\$779

Utility Pantry Butt Doors With Roll Out Shelves (ROS)

- Four Roll Out Shelves in the Lower Opening
- No Shelves in the Upper Opening
- See Page 31 for Shelf Kit
- Refer to Chart for Cabinet Frame Opening Sizes

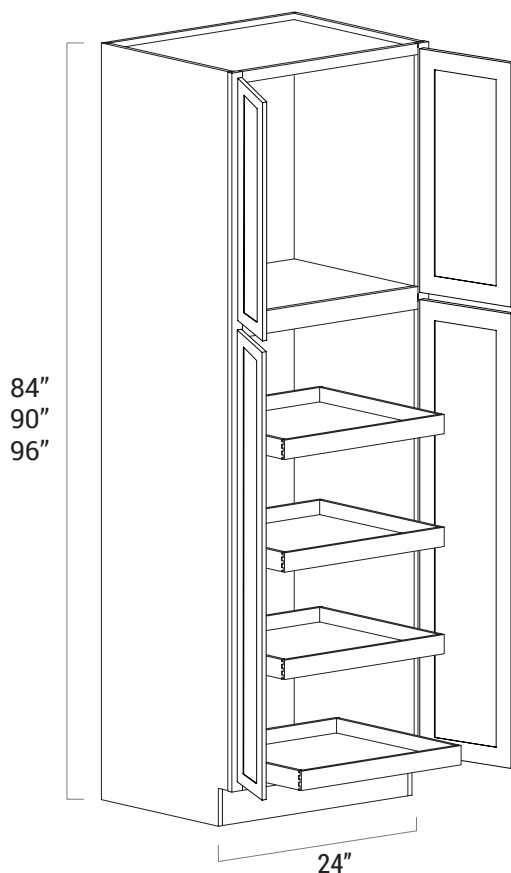

24" DEEP	LIST	21" DEEP	LIST	18" DEEP	LIST
U2484ROS4	\$1060	U248421ROS4	\$1060	U248418ROS4	\$1060
U2490ROS4	\$1205	U249021ROS4	\$1205	U249018ROS4	\$1205
U2496ROS4	\$1205	U249621ROS4	\$1205	U249618ROS4	\$1205

Vanity Sink Base

- False Drawer Front

16" DEEP	LIST
VSB1816	\$199

31 1/2"

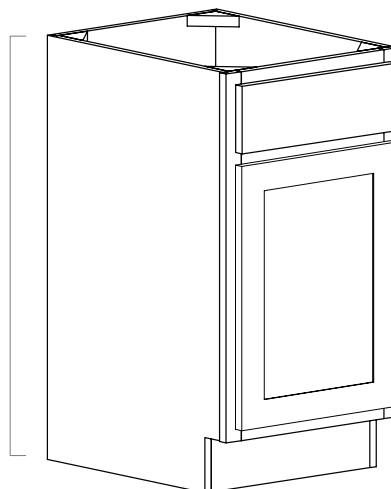

Vanity Sink Base

- False Drawer Front
- Butt Doors
- No Shelf

21" DEEP	LIST	18" DEEP	LIST
VSB24	\$229	VSB2418	\$229
VSB27	\$237	VSB2718	\$237
VSB30	\$247	VSB3018	\$247
VSB33	\$262	VSB3318	\$262
VSB36	\$277	VSB3618	\$277

31 1/2"

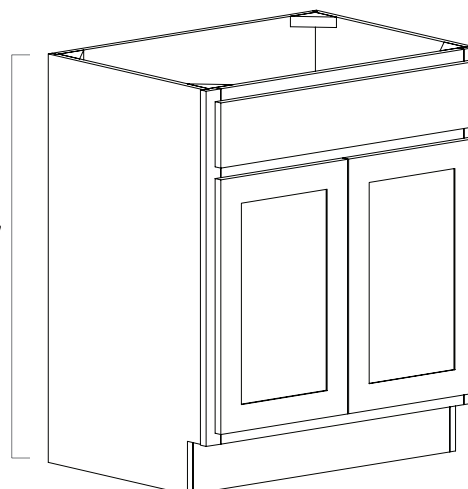

Vanity Drawer Base

- Three Drawers
- Bottom Two Drawer Boxes are 6" High

21" DEEP	LIST	18" DEEP	LIST
VDB12	\$308	VDB1218	\$338
VDB15	\$322	VDB1518	\$352
VDB18	\$348	VDB1818	\$378

31 1/2"

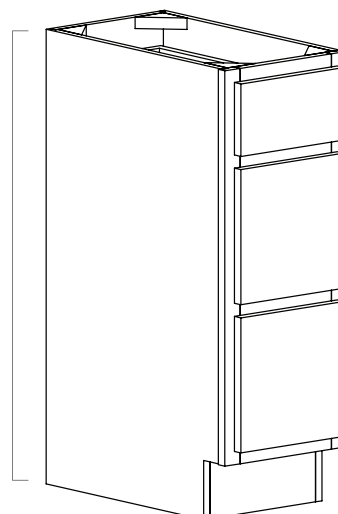

Vanity Base

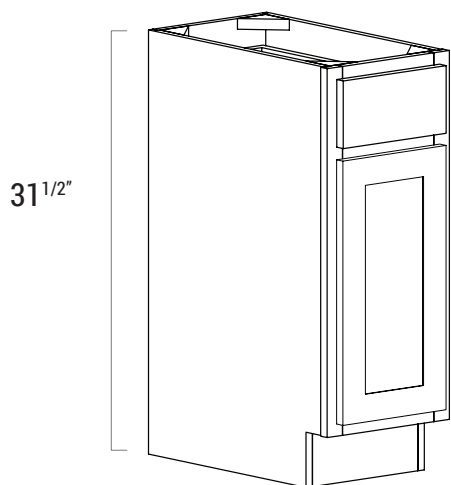

- No Shelf
- VB24, VB2418, VB30, and VB3018 Have Butt Doors

21" DEEP	LIST	18" DEEP	LIST
VB12	\$212	VB1218	\$242
VB15	\$225	VB1518	\$255
VB18	\$238	VB1818	\$268
VB24	\$264	VB2418	\$284
VB30	\$300	VB3018	\$320

Vanity Base Left or Right Drawer

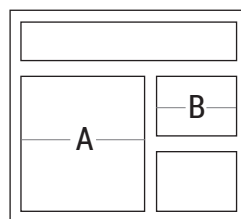
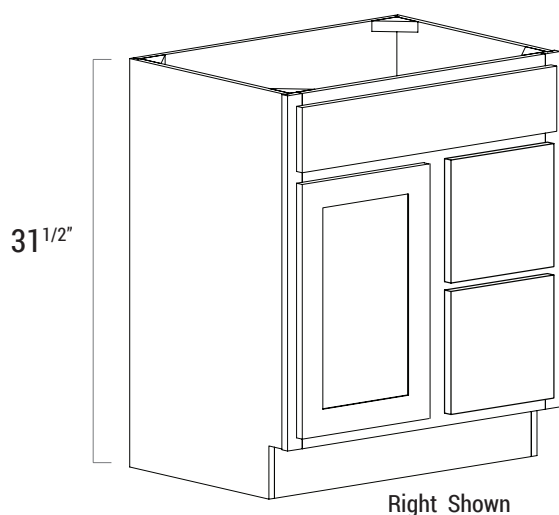

	A	B
VBL/R30	15"	10"

- No Shelf
- Top Drawer is a False Front
- Two Drawers
- L or R Indicates Drawer Side

21" DEEP	LIST	18" DEEP	LIST
VBL30	\$301	VBL3018	\$331
VBR30	\$301	VBR3018	\$331

Vanity Base Top Drawer

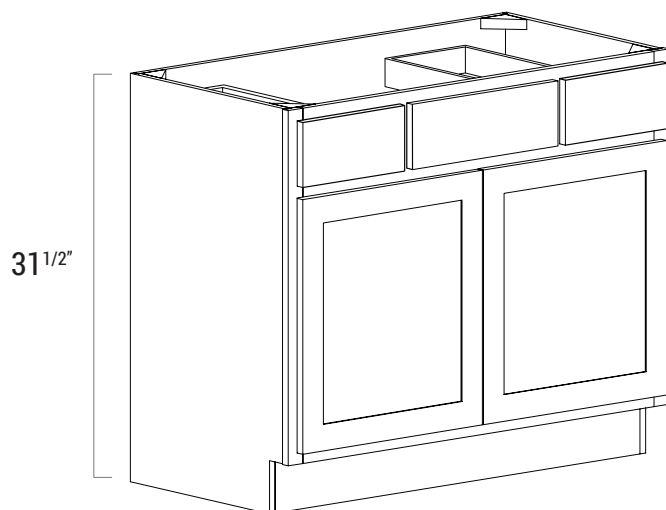

- No Shelf
- Butt Doors
- Center Drawer is a False Front
- Two Top Drawers (One on Each Side)

21" DEEP	LIST	18" DEEP	LIST
VB36	\$350	VB3618	\$364
VB42	\$360	VB4218	\$377
VB48	\$380	VB4818	\$407

Kitchen Height Vanity Sink Base

- False Drawer Front
- Butt Doors
- No Shelf

21" DEEP	LIST	18" DEEP	LIST
KVSB24	\$285	KVSB2418	\$285
KVSB30	\$320	KVSB3018	\$320
KVSB36	\$355	KVSB3618	\$355

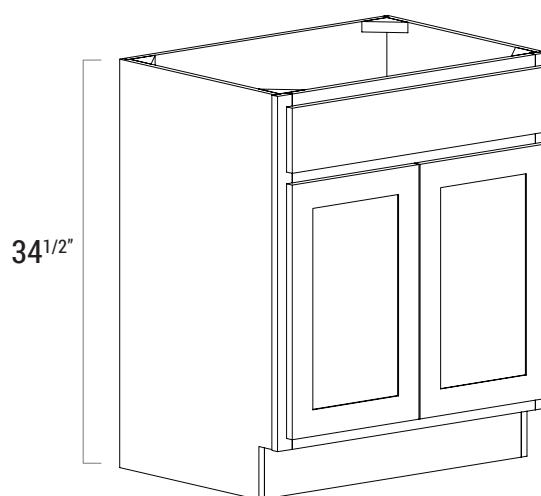

Kitchen Height Vanity Drawer Base

- Three Drawers
- Bottom Two Drawer Boxes are 6" High

21" DEEP	LIST	18" DEEP	LIST
KVDB12	\$312	KVDB1218	\$312
KVDB15	\$325	KVDB1518	\$325
KVDB18	\$338	KVDB1818	\$338

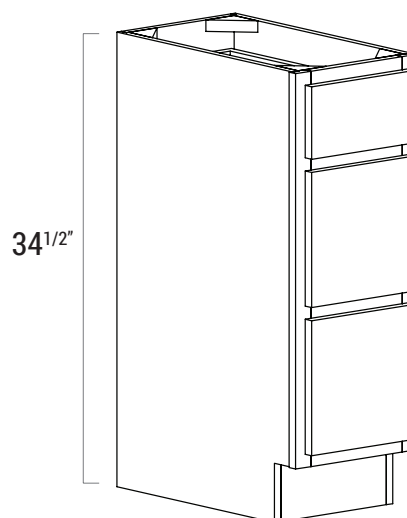

Kitchen Height Vanity Base

- No Shelf

21" DEEP	LIST	18" DEEP	LIST
KVB12	\$244	KVB1218	\$244
KVB15	\$257	KVB1518	\$257
KVB18	\$270	KVB1818	\$270

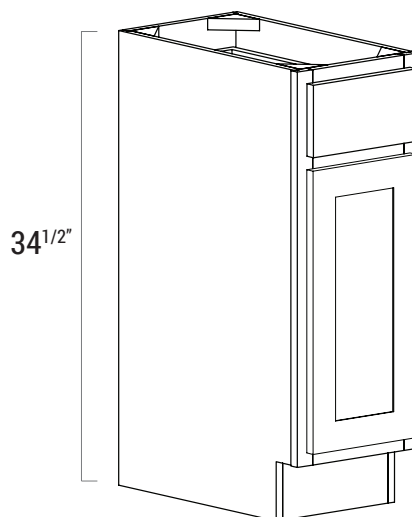

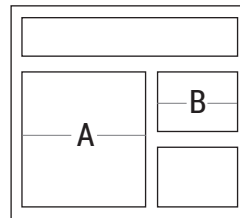
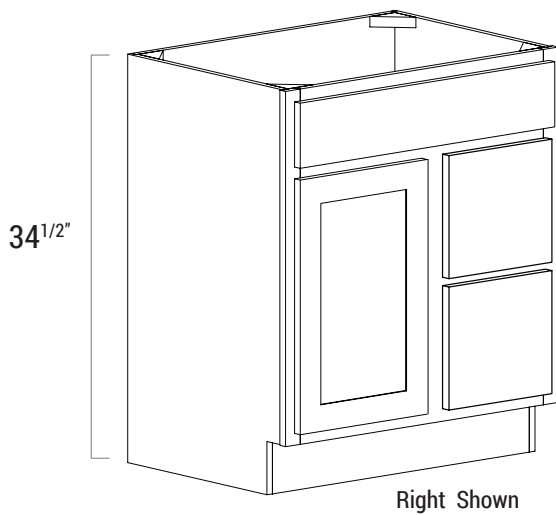

	A	B
VBL/R30	15"	10"

Kitchen Height Vanity Base Left or Right Drawer

- No Shelf
- Top Drawer is a False Front
- Two Drawers
- L or R Indicates Drawer Side

21" DEEP	LIST	18" DEEP	LIST
KVBL30	\$351	KVBL3018	\$381
KVBR30	\$351	KVBR3018	\$381

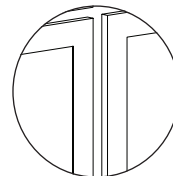
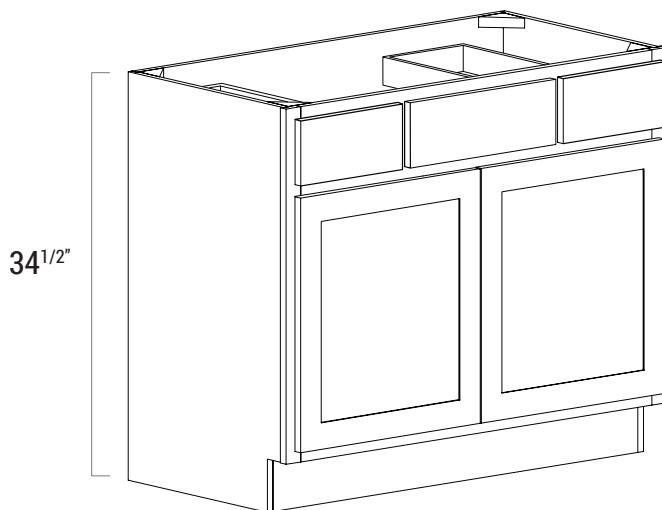

(*) - 2" Exposed Center Stile
- Center Stile for Extra Support

Kitchen Height Vanity Base Top Drawer

- No Shelf
- Center Drawer is a False Front
- Two Top Drawers (One on Each Side)
- 3" Center Stile on 42" and 48"

21" DEEP	LIST	18" DEEP	LIST
KVBT36	\$400	KVBT3618	\$420
KVBT42	\$415	KVBT4218	\$435
KVBT48	\$445	KVBT4818	\$465

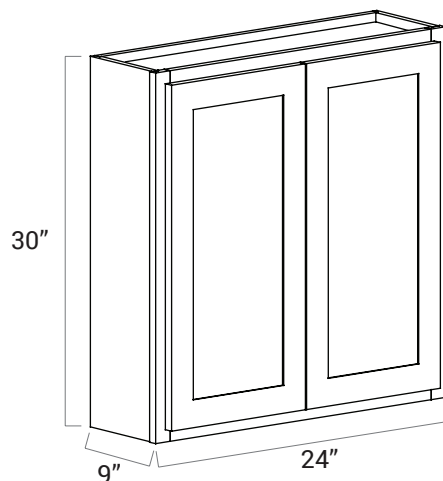

Vanity Wall

- Two Adjustable Shelves

9" DEEP	LIST
VW243009	\$210

Handicap Accessible Base

- One Adjustable Shelf
- 5¹/₂" Toe Kick
- B12HA, VB12HA, B15HA, VB15HA, B18HA and VB18HA are Single Doors

24" DEEP	LIST	21" DEEP	LIST
B12HA	\$264	VB12HA	\$292
B15HA	\$277	VB15HA	\$275
B18HA	\$290	VB18HA	\$288
B24HA	\$336		
B27HA	\$354		
B30HA	\$372		
B33HA	\$390		
B36HA	\$409		

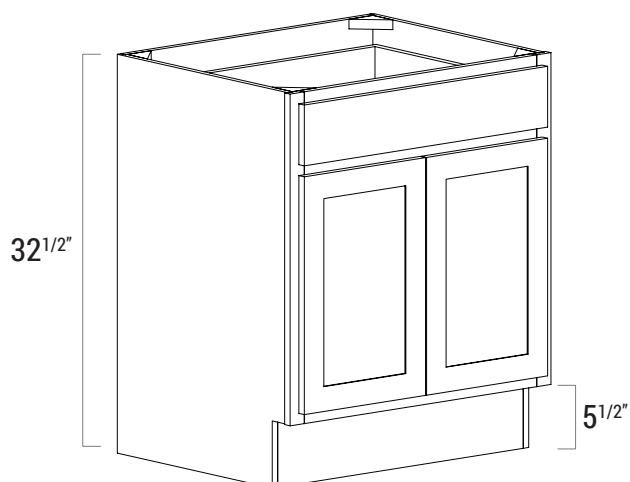

Handicap Accessible Drawer Base

- Three Drawers
- Bottom Two Drawer Boxes are 6" High
- 5¹/₂" Toe Kick

24" DEEP	LIST	21" DEEP	LIST
DB12HA	\$360	VDB12HA	\$358
DB15HA	\$375	VDB15HA	\$372
DB18HA	\$397	VDB18HA	\$398

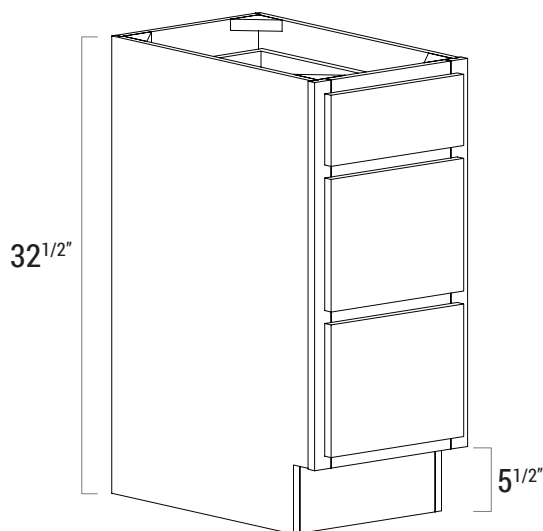

Handicap Accessible Sink Base

- False Drawer Front
- Butt Doors
- No Shelf
- 5¹/₂" Toe Kick

24" DEEP	LIST	21" DEEP	LIST
SB24HA	\$305	VSB24HA	\$279
SB27HA	\$330	VSB27HA	\$287
SB30HA	\$340	VSB30HA	\$297
SB33HA	\$350	VSB33HA	\$312
SB36HA	\$365	VSB36HA	\$327

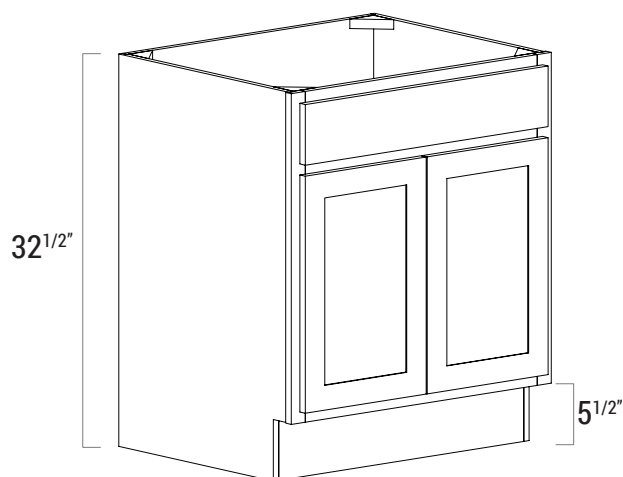

Handicap Accessible Vanity Base Top Drawer

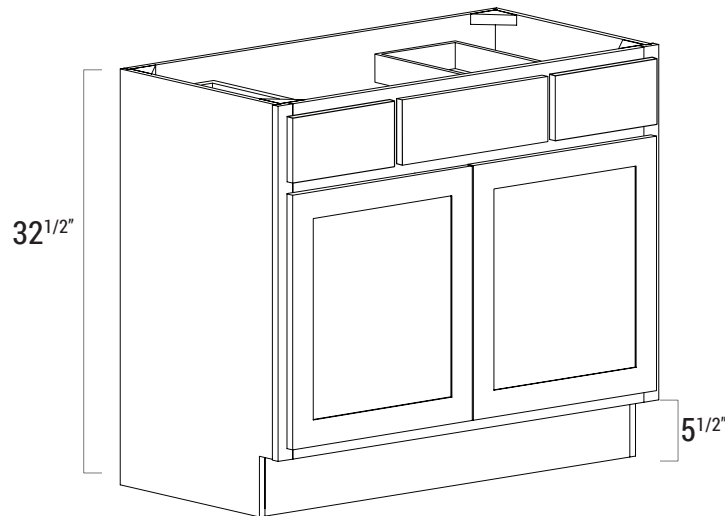

- No Shelf
- Butt Doors
- Center Drawer is a False Front
- Two Top Drawers (One on Each Side)
- 5 1/2" Toe Kick

21" DEEP	LIST
VBT36HA	\$400
VBT42HA	\$410
VBT48HA	\$430

Handicap Accessible Vanity Sink Base W/Removable Front

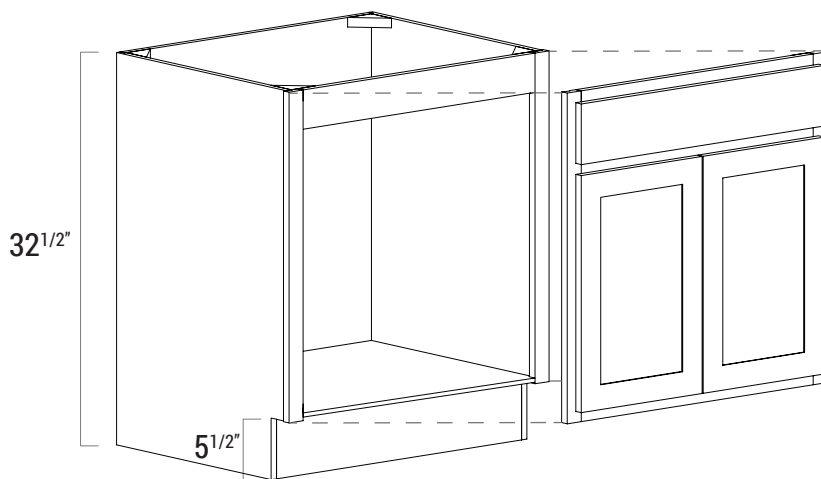

- 5 1/2" Toe Kick
- Removable Front
- Removable bottom
- Removable toe kick

21" DEEP	LIST
RFVSB30HA	\$554
RFVSB33HA	\$554
RFVSB36HA	\$554

Handicap Accessible Sink Base W/Removable Front

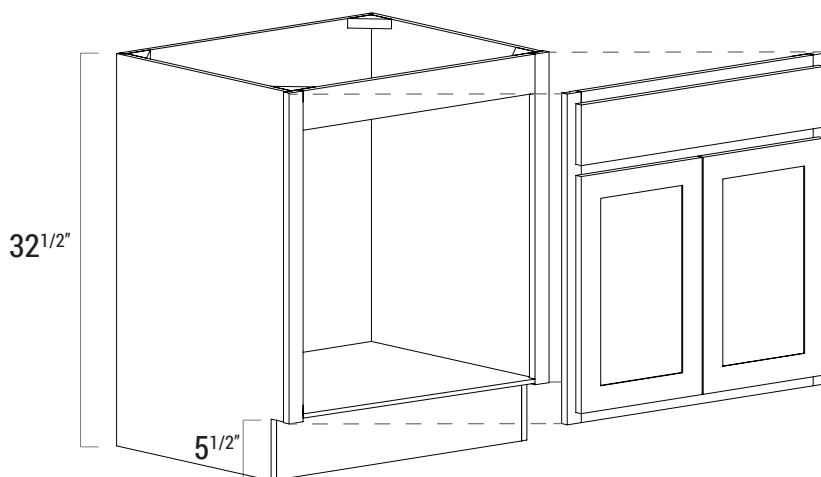

- 5 1/2" Toe Kick
- Removable Front
- Removable bottom
- Removable toe kick

24" DEEP	LIST
RFSB30HA	\$650
RFSB33HA	\$650
RFSB36HA	\$650

Dishwasher Panel

- Grain Runs Vertically
- 1/2" Veneered Plywood Panel Finished on the Exposed Side
- 3/4" Thick Solid Wood Front Stile Finished on the Front and Sides

1-1/2"	LIST	3"	LIST	6"	LIST
DWP1.5	\$76	DWP3	\$86	DWP6	\$101

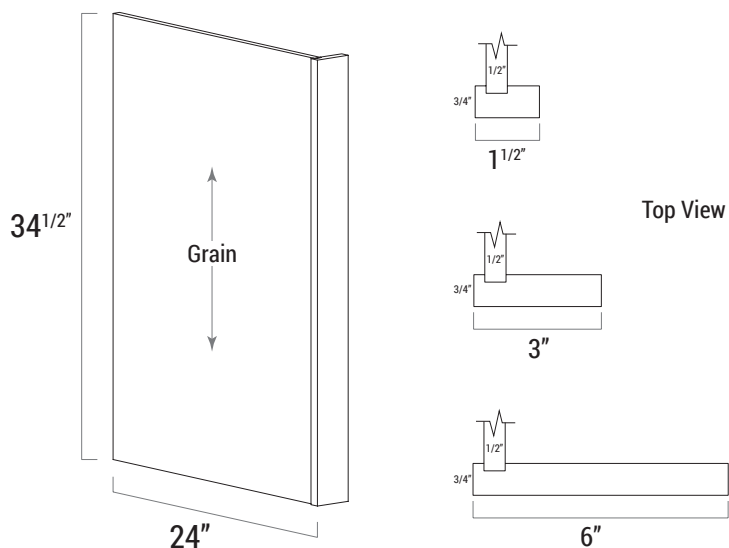

Refrigerator End Panel

- Grain Runs Vertically
- 1/2" Veneered Plywood Panel Finished on the Exposed Side
- 1 1/2" X 3/4" Thick Solid Wood Front Stile Finished on the Front and Sides

24" DEEP	LIST	30" DEEP	LIST
REP9624	\$296	REP9630	\$316

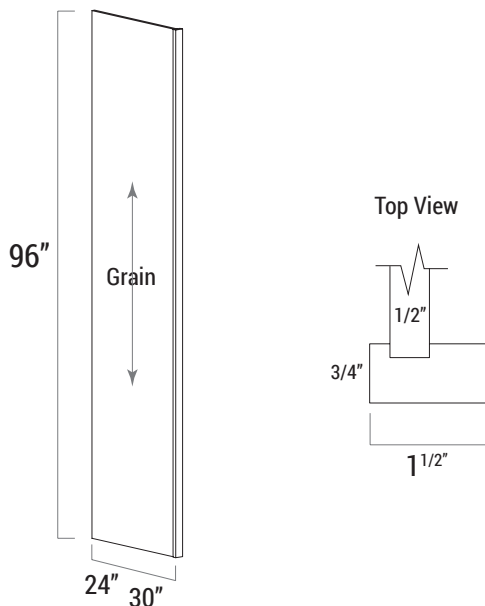

Wall End Panel

- 3/4" Thick Solid Wood Front
- Finished sides
- One Side Loose for Field Install

30" TALL	LIST	36" TALL	LIST	42" TALL	LIST
WEP1.530	\$120	WEP1.536	\$120	WEP1.542	\$120
WEP330	\$120	WEP336	\$120	WEP342	\$120

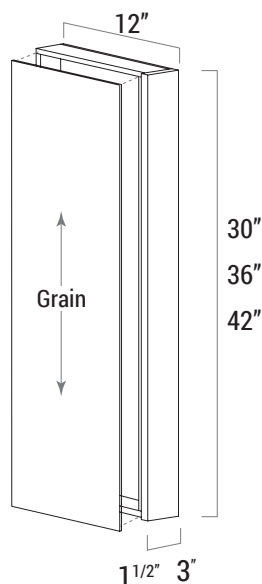

Wall Skin

- 1/4" Thick Veneered Plywood
- One Finished Side
- Field Cut to Size as Needed

12" DEEP	LIST	24" DEEP	LIST
WSK3012	\$31	WSK3024	\$47
WSK4212	\$42	WSK4224	\$62

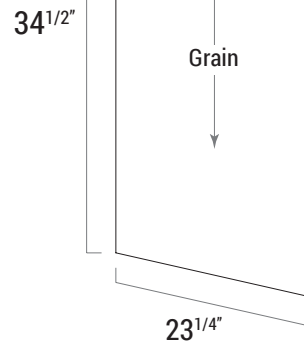
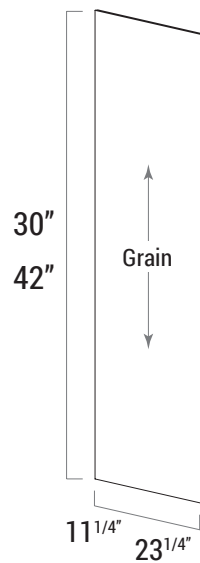

Base Skin

- 1/4" Thick Veneered Plywood
- One Finished Side
- Field Cut to Size as Needed

24" DEEP	LIST
BSK24	\$50

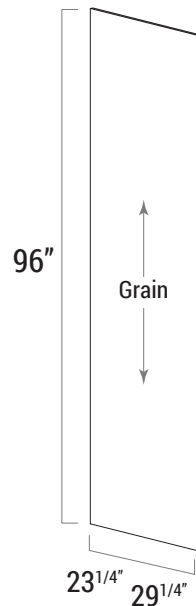

Tall Skin

- 1/4" Thick Veneered Plywood
- One Finished Side
- Field Cut to Size as Needed

24" DEEP	LIST	30" DEEP	LIST
TSK9624	\$115	TSK9630	\$210

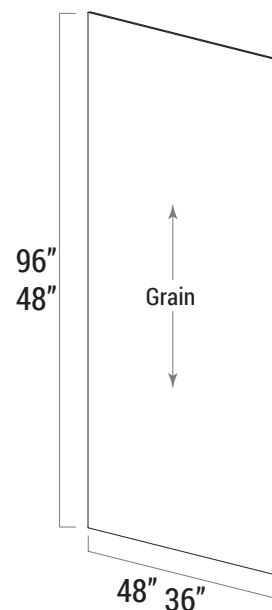

Panel

- 1/4" Thick Veneered Plywood
- One Finished Side
- Field Cut to Size as Needed

48" DEEP	LIST	96" DEEP	LIST
PAN4848	\$115	PAN4896	\$220
		PAN3696	\$220

Fillers

- 3/4" Thick Solid Wood
- Finished Front
- Field Cut to Size as Needed

30" HIGH	LIST	42" HIGH	LIST	96" HIGH	LIST
F330	\$35	F342	\$45	F396	\$90
F630	\$60	F642	\$80	F696	\$170

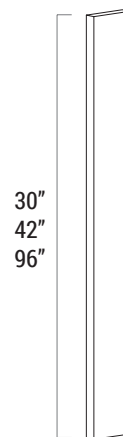
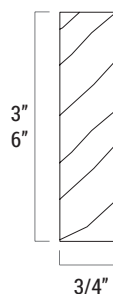

Starter Molding

- 3/4" Thick Solid Wood
- Finished Front and Long Sides
- Used to Stack Crown Molding

8' LENGTH	LIST
STM3	\$100
STM6	\$180

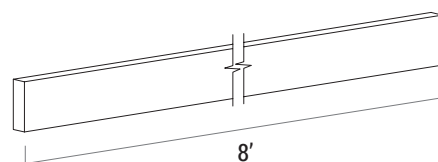
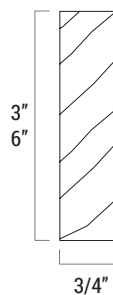

Crown Molding

- Solid Wood
- Finished Coved Side

8' LENGTH	LIST
CM	\$75

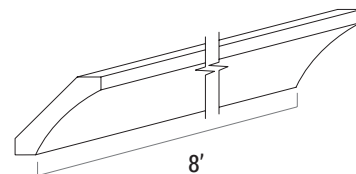
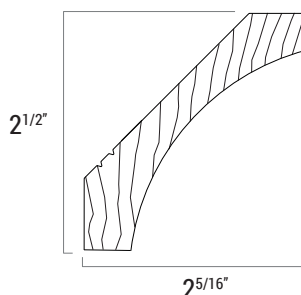

Inside Corner Molding

- Solid Wood
- Finished Coved Side

8' LENGTH	LIST
ICM	\$41

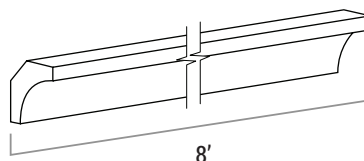
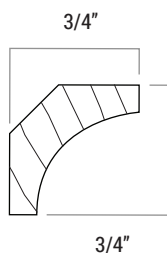

Toe Kick

- 1/4" Thick Veneered Plywood
- Finished Front
- TKMHA is 5 1/2" Tall and Used for Handicap Accessible Cabinets

8' LENGTH	LIST
TKM	\$30
TKMHA	\$30

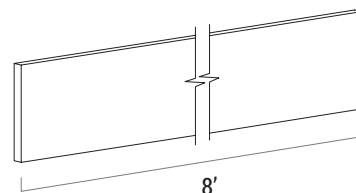
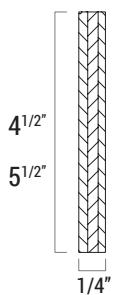

Shoe Molding

- Solid Wood

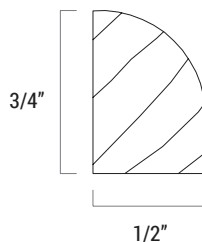
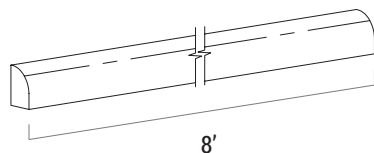

8' LENGTH	LIST
SHM	\$41

Outside Corner Molding

- Solid Wood
- Available in 135° (135OCM)

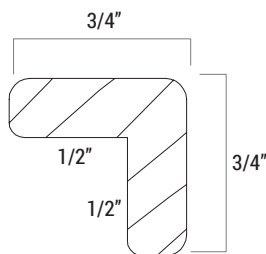
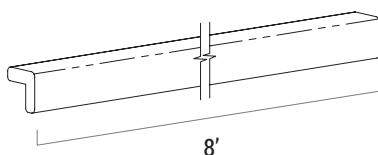

8' LENGTH	LIST
OCM	\$41
135OCM	\$41

Batten Molding

- Solid Wood

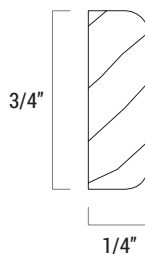
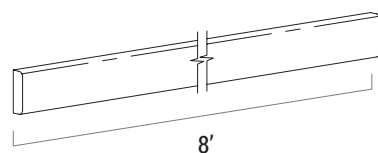

8' LENGTH	LIST
BM	\$32

Scribe Molding

- Solid Wood

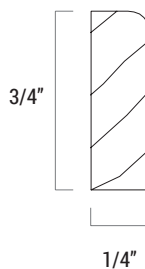
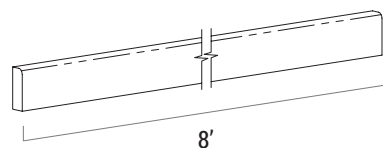

8' LENGTH	LIST
SM	\$32

Straight Valance

- 3/4" Thick Solid Wood
- Finished Front and One Long Side
- Field Cut as Needed

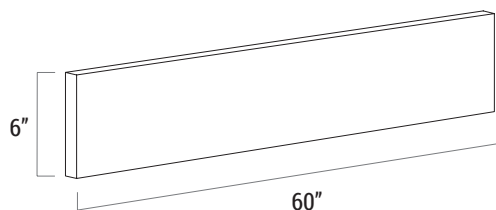

60" LENGTH	LIST
VAL60	\$160

Roll Out Shelves (ROS)

- 4" High X 5/8" Thick Veneered Plywood Boxes
- Dove Tail Joints with a 1/4" Bottom
- Full Extension Under Mount Glides Included
- 39", 42" and 48" Cabinets Have Center Stile. Order ROS Accordingly (Refer To Pages 12 & 14)
- 42" and 48" Cabinets use ROS21 and ROS24
- Soft Close Add \$45 to List Price (Each)

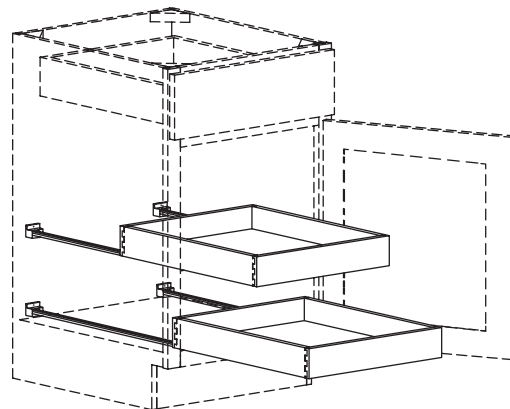

24" DEEP	LIST	21" DEEP	LIST	18" DEEP	LIST
ROS12	\$90	ROS1221	\$90	ROS1218	\$90
ROS15	\$90	ROS1521	\$90	ROS1518	\$90
ROS18	\$90	ROS1821	\$90	ROS1818	\$90
ROS21	\$90	ROS2121	\$90	ROS2118	\$90
ROS24	\$90	ROS2421	\$90	ROS2418	\$90
ROS27	\$90	ROS2721	\$90	ROS2718	\$90
ROS30	\$90	ROS3021	\$90	ROS3018	\$90
ROS33	\$90	ROS3321	\$90	ROS3318	\$90
ROS36	\$90	ROS3621	\$90	ROS3618	\$90
ROS39	\$90	ROS3921	\$90	ROS3918	\$90

Shelf Kits

- For Utility Pantry Cabinets
- Available in (2) or (4) Packs
- Shelf Clips Included
- 5/8" Edge-Banded Particle Board with Natural Maple Vinyl Color to Match Interior

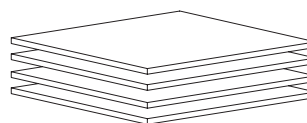
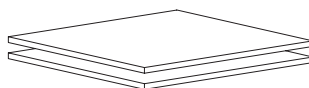

24" DEEP	LIST	21" DEEP	LIST	18" DEEP	LIST	15" DEEP	LIST	12" DEEP	LIST
SK2-1824	\$27	SK2-1821	\$27	SK2-1818	\$27	SK2-1815	\$27	SK2-1812	\$27
SK4-1824	\$54	SK4-1821	\$54	SK4-1818	\$54	SK4-1815	\$54	SK4-1812	\$54
SK2-2424	\$33	SK2-2421	\$33	SK2-2418	\$33	SK2-2415	\$33	SK2-2412	\$33
SK4-2424	\$66	SK4-2421	\$66	SK4-2418	\$66	SK4-2415	\$66	SK4-2412	\$66

Quart of Stain/Paint

- Field Application May Vary From Factory Finish
- Clear Top Coat For Stain Not Available

SKU	LIST
Quart of Stain	\$70
Quart of Paint	\$70



Touch Up Kit

- Includes Touch Up Marker and Fill Stick

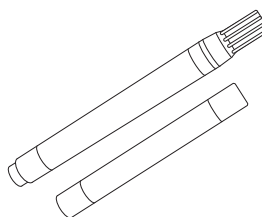

SKU	LIST
TUK	\$45

Notes:

Care and Cleaning Guide

Always test cleaners on a small, inconspicuous area before cleaning entire surface.

Cabinets

No matter how careful a person may be with cabinets, normal wear and tear from everyday use will occur. Proper cleaning and maintenance, along with touching up scratches or chips will help keep the cabinets looking new.

The cabinets have a UV cured, water-based finish for long lasting durability and beauty. This environmentally friendly process helps protect against normal everyday use, but general upkeep and maintenance are extremely important. When cleaning, only use clean, soft, lint-free cloths on the cabinets.

Cleaning:

- Wipe down cabinets with a soft, damp cloth to remove dust and other particles, and then dry immediately with a different clean, soft cloth.
- To remove buildup of grease and dirt, add a small amount of dish detergent (Dawn works best) to warm water. Dampen cloth with this solution and wipe down cabinetry. Remove all soap residue from surface with a damp cloth and then use a different soft, dry cloth to remove all dampness.
- Be sure to clean up spills immediately with a clean, soft cloth. Prolonged exposure to spills from food, water, oil or grease, along with other liquids will cause permanent damage or discoloration to the cabinet finish.

Scratches and Chips:

- It is recommended to order a touch up kit with each order. The kit will contain a touch up marker and putty stick; these are used to fix any scratches and chips in the cabinets. The touch up marker is used to hide any shallow scratches, while the putty stick is used for deeper scratches or chips.

Hardware Adjustments:

- Over time, door and drawer faces may become uneven or loose. This means the hardware will need to be adjusted or tightened. Each piece is adjustable by a set screw on the piece of hardware itself.

Things to Avoid:

- Do not wipe your cabinets with a dishcloth. They can contain soap, grease and other soil that can harm the finish on the cabinets.
- Do not use harsh chemicals, bleach, abrasive cleaners, ammonia, solvents, detergents, strong soap, furniture polish or waxes on the cabinets. The use of these products will affect the appearance and durability of the topcoat, causing the warranty to be void.
- Avoid dampness of cabinets. If water dampness is left on the cabinets, over time it will cause finish damage, later affecting the underlying wood.

Warranty Information

General Warranty Guidelines

Maple Mill Cabinetry will, at its discretion, repair or replace any product we sell where our inspection reveals a defect in workmanship or materials for a period of one year after the original purchase. In no event shall Maple Mill Cabinetry be liable for consequential, indirect or incidental damages resulting from the installation, use or failure of its products. This warranty does not cover the labor costs regarding removal, return, re-installation, subsequent damage, and is not responsible for other materials used in the installation; regardless of whether the work was performed by a contractor, service company or the consumer. This warranty is the exclusive warranty of Maple Mill Cabinetry and is in lieu of all other warranties, expressed or implied.

WHAT IS EXCLUDED:

This warranty does not cover damage arising from any of the following:

1. Accidents or abuse
2. Mishandling or misuse
3. Improper storage or installation
4. Improper maintenance or repair
5. Any product changed or modified from its original status
6. Exposure to extreme temperatures or moisture levels (including water damage)

** This warranty is not valid for products used for any purpose other than the purpose for which they were originally intended.*

Cabinets

One Year Limited Warranty on Cabinets: Maple Mill Cabinetry warrants, to original consumer purchaser, for a period of one year from the original date of purchase, that all other components of the cabinets shall be free from defects in material and workmanship under normal use.

Over time, wood species in all finishes will exhibit color changes when exposed to different types of light and environments; it is a characteristic of stained and painted wood finishes to age over time when exposed to smoke, sunlight or general household cleaning chemicals. Due to the natural variation and aging process, differences may be observed in color match when replacing doors or adding cabinets at a later date. Such color changes are to be expected and are not considered a manufacturer defect and will not be considered for warranty replacement.

Graining differences, mineral streaks, and wood color variations are expected in wood cabinets and are not classified as defects and will not be considered for warranty replacement.

Painted finishes are exceedingly different from the standard stained finish. Since normal movement is typical in wood products, certain climatic conditions can cause finish breaks, recesses, and joint and panel lines which become more visible on painted product. Consequently, in places and environments of extremely high or extremely low humidity, painted finishes are not recommended. Expansion and contraction in doors and face frames can cause visible lines at the joints. The finish will still protect the surface and the structural integrity of the joint will not be affected. An open joint line is not considered a manufacturer defect and will not be considered for warranty replacement.

Lifetime Limited Warranty on Drawer Glides and Hinges: Maple Mill Cabinetry warrants to the original consumer purchaser, that the drawer glides and hinges used in the manufacturing of the cabinets shall be free from defects in material and workmanship under normal use.

To process a warranty claim, contact the Maple Mill Cabinetry customer service department. Claims are to be submitted in writing with supporting pictures, along with a dated sales receipt as proof of purchase for a warranty claim to customerservice@maplemillcabinetry.com. If needed, inspection of the product may be requested by Maple Mill Cabinetry.

Policies and Procedures

Maple Mill Cabinetry customer support is available 8:00am – 4:00pm Monday through Friday.

- Phone: 262-346-6455
- Information and Service Email: customerservice@maplemillcabinetry.com
- Order Email: customerservice@maplemillcabinetry.com

Order Procedures:

- All orders are to be submitted via email to the order processing department at customerservice@maplemillcabinetry.com
- A purchase order number (PO#) or job name is required before any order will be acknowledged or processed.
- If there is any missing information, a customer service representative will reach out to get any needed information and then process your order. The order will be on hold until all details are received.

Order Changes, Cancellations & Returns:

- Changes to cabinet orders must be made within 48 hours of order confirmation. Once the order is in production no changes can be made.
- Returns are not accepted as cabinets are made to order.

Freight, Delivery and Handling:

- Orders placed with Maple Mill Cabinetry will be delivered tailgate only via company delivery vehicle.
LTL orders are TBD for the delivery charge.
- If a delivery is not accepted, a \$100 undeliverable load fee will be added to the invoice.

* Tailgate Delivery - Driver brings product to the back/tailgate of the truck. Customer is responsible to unload product.

- All product labels are on the front of the product in the top right corner.
- To ensure safety in transportation and storage, do not face label down or stack larger, heavier items on top.
- Do not lift boxes by the strapping. They can break or put pressure on the product, which can cause damage.
- Do not tip product onto corners to slide, move or pick up and do not set product down on corners. Everything needs to be picked up and set down flat to ensure no damage to the corners.

Payment Requirements and Process (Cash, Check or Credit Card):

- Dealers are Net 30
- **Credit and Term Policy:**
 - * A credit application must be submitted to establish payment terms with Maple Mill Cabinetry. Account terms will be Net 30 and the credit limit will be determined by credit history. Any account past due will be subject to a monthly 2% fee of the balance due and is charged monthly until the balance is paid in full. Maple Mill Cabinetry has the right to send any outstanding bills to collections if not in good standing.

Orders will not be processed or delivered if the account is not in good standing.

Backordered Items:

- Backordered items will ship freight prepaid and you will not incur added shipping charges.

Damaged, Defective or Shortage:

Customer must inspect delivered order in full and document missing or damaged items prior to contacting customer service.

All replacement orders must be submitted completely on the first request.

- If the item(s) purchased become damaged during shipping, the delivery driver will make note on the packing slip and inform the office. Customer service will reach out to you with a delivery date for the replacement product.
- All concealed (non-visible) damages need to be reported within five business days of delivery and a replacement will be shipped at no charge. If the customer does not report the damage within five business days of delivery, it is the responsibility of the customer to purchase the new item plus shipping cost.
- For replacement requests due to defects, the customer must send the original PO information and pictures, along with the requested replacement parts to customerservice@maplemillcabinetry.com
- Any product identified and verified as a shortage will be shipped at no charge. Shortage claims for missing product must be made within three business days of delivery. If the customer does not report the shortage within three business days of delivery, it will be the responsibility of the customer to purchase the new item plus shipping cost.

Customer Installation Responsibility:

- Cabinet doors and drawers are shipped without being straight and level. Doors and drawers are to be removed prior to cabinet installation and then re-installed and leveled once secured to the wall. If hardware is being used, always adjust prior to drilling. Over time, hinges on doors will need to be adjusted from cabinet use.
- All cabinets must be installed plumb, level and secured to each other. Improper installation will cause issues with cabinet performance and stability.
- Scratches, minor chips, and all nail holes are to be touched up with the touch up kit.
- Laminated countertops are made straight and may need to be scribed on site to fit during installation.

Privacy:

All contact information given to Maple Mill Cabinetry will be used for the completion of that order. We do not share this information with outside parties.

Wood Product and Finish Information

The real attraction of wood comes from the true natural qualities of wood itself which will vary in color, shades and grain. These characteristics are what make wood beautiful and distinct in color. All of our doors, drawers and face frames are made from solid maple.

Maple is a close-grained hardwood that is predominately white to creamy-white in color, with the occasional reddish-brown tones. Maple is characterized by its smooth, even grain pattern. Mineral streaks and tiny bird pecks are common and will appear darker when stained; these are not considered defects.

Expansion and Contraction

Solid wood naturally expands and contracts with normal humidity changes due to interior heating and cooling. As a result of this wood movement, slight separation may occur causing small "cracks" in the joints of doors, drawer fronts, face frames and on flat surfaces. These joint separations are unavoidable and should not be considered for warranty replacement **(The joint separations are more noticeable on painted products due to the shadow line created from the separation).**

When the cabinets are in a warm, moist environment (high humidity) the wood expands. In a dry, cooler environment (low humidity) the wood will contract. This affects the door frame, along with the door center panel as the season temperature and humidity levels change.

The contraction of the door center panel during low humidity may create the appearance of an unfinished line around the edge of the door panel. This is not considered a defect and a replacement door will not be issued. Touch up kits are available for incidentals such as this.

Finishes

Over time, wood will age, and you will see a difference in color shade. Different environment factors such as the amount of natural light, grease, smoke or cleaners will affect the aging process. These color changes are natural to wood and are not defects. Due to this natural change, any replacement doors, drawers or added cabinets may not match.



262-346-6455

www.MapleMillCabinetry.com