

ALPHA 5

THE WORLDS' SMALLEST, LIGHTEST,
FIVE-FUNCTION SUBSEA MANIPULATOR

A Revolution for Subsea
Inspection & Intervention

—▶ **ADVANCED**

0.1° Joint Accuracy
Kinematics and Self-Protection

—▶ **TOUGH**

300m Depth Rating
Field Proven

—▶ **USABLE**

Intuitive Interface
Master Arm Controlled

BLUEPRINT LAB

Be Confident.

The Alpha 5 is a tough and reliable multi-function electric manipulator for harsh environments.

With high accuracy joint positioning (0.1°) and a master/slave topside controller, the Alpha 5 is the most advanced manipulator for the portable ROV community. A must for operators in the new era of close inspection work and complex intervention.

Master Controller Enabled



MECHANICAL

Lift Capacity 2kg (Full Reach)
Weight (Air) 1360g
Weight (Water) 900g



ELECTRICAL

Voltage 18-30V
Wattage 35W Max
COMS RS232/485



ENVIRONMENTAL

Depth 300MSW
Temp -35°C to 35°C
Material AL6061



Mission Specific End-Effectors



ROV Proven

High Mobility & Compact

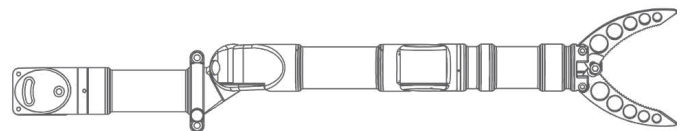
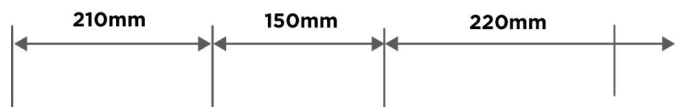
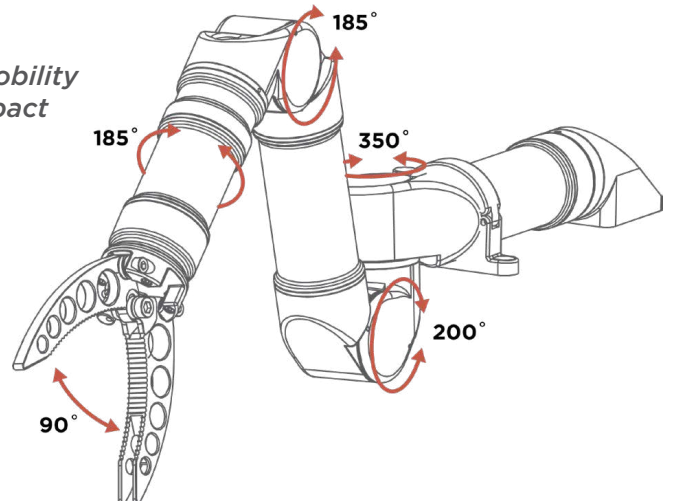

OTHER SPECS

- Max Closing Force: 600N
- Push-rod axial load rating: 100kg
- Reach: 0.4m
- Outer Diameter: 40mm
- Standard Connector: Teledyne 6 Pin IE(W)-55 Impulse Connector (whip included)
- Operator Control Options: 3D Space Mouse, Gamepad, Software GUI, Master Controller
- End-Effector Options: Quad Jaws, Pincer, Parallel Jaws, Rope Cutter

FEATURES

- Zero Oil
- Fits on very light ROV's
- Quick to integrate
- End-effector interchangeable
- Embedded controllers - no additional POD
- Adjustable grab force - pick up a sea urchin or cut a cable
- Self-protection against collision
- One-click home position
- Corrosion and scratch resistant anodized aluminium
- Highly Modular and Configurable - 3, 4 or 5 function versions available