

Make good robots for clients.

YASAKA ROBOT CATALOG 2024

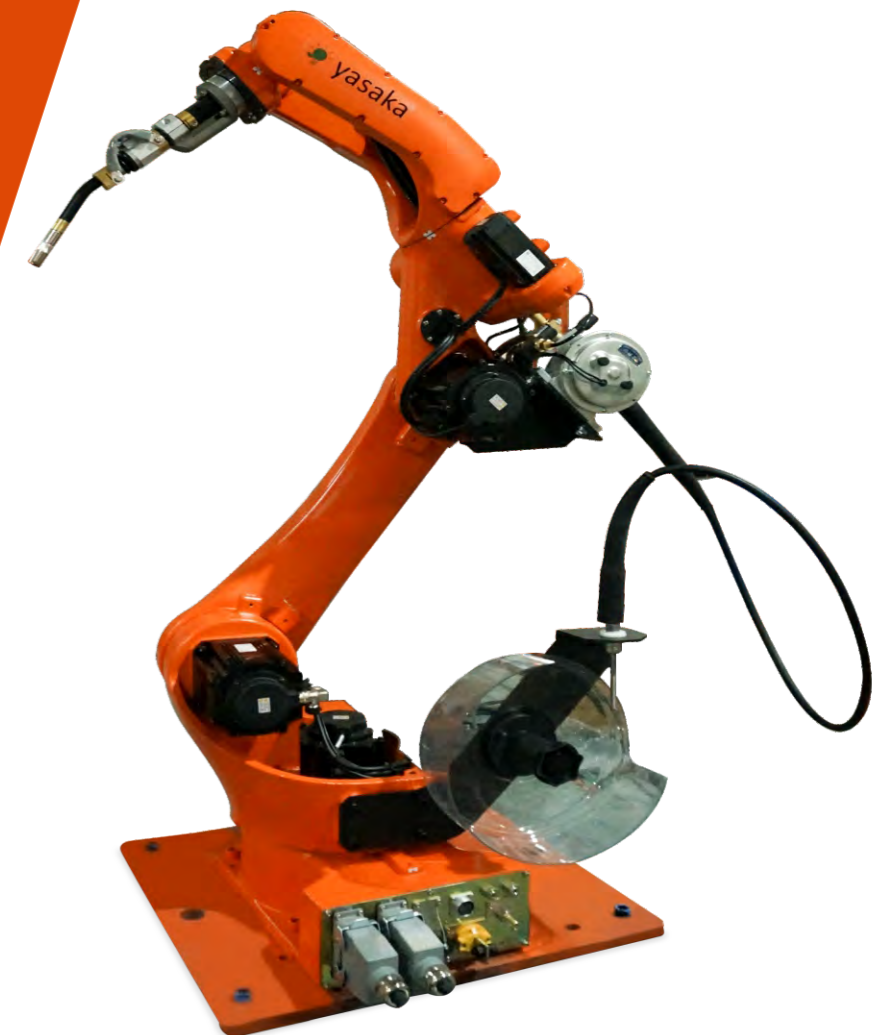

Professionals

Industrial robot control system



YASAKA Robotics is a high-tech robot manufacturer providing Automation Solutions and Support to our customers. Our products are used in industrial automation such as welding, painting, handling, palletizing and polishing.

And after years of development, our core technology has been widely used in the field of industrial robots in India. We offer professional, timely service and complete robot application solutions.

Our robot system is highly stable and matured. We are one of the earliest team who manufactures industrial robots.

Our industrial robot body and controller are developed by our company with independent intellectual property rights.

The advantages are: highly cost-effective, well-knit compact structure, flexibility, high reliability, high speed, high precision, high expandability, easy operation, easy maintenance. The motion of each joint of the robot is realized by a servo motor and a high precision and rigidity reducer with the integrated drive controller technology.



WELDING ROBOT

YS10-1440-W

Faster, more accurate and more reliable.
Suitable for all types of CO₂/MAG/MIG/TIG welding and plasma cutting.

Robot specifications

Basic data	
Model No.	YS10-1440-W
Number of axes	6
Maximum payload	10 kg
Maximum stroke	1440mm
IP class	J1, J2 - IP56; J3, J4, J5, J6- IP67
Mounting position	Floor type, wall type, ceiling type
Approx. weight	176 kg (without cabinet or welding machine)
Repeatability	±0.05 mm
Internal air duct	Φ10
Welding machines	<ul style="list-style-type: none"> • Aotai NBC-350RL (CO₂/MAG/MIG, standard) • Aotai NBC-350/500RP (CO₂/MAG/MIG, optional) • Aotai MIG-350/500/630RP (CO₂/MAG/MIG, optional) • Aotai WSM-400R/WSME-315R (TIG, optional)

Motion range	
J1 axis S	±167°
J2 axis L	+80°~-145°
J3 axis U	+145°~-75°
J4 axis R	±190°
J5 axis B	+50°~-210°
J6 axis T	±220°

Speed with rated payload	
J1 axis S	285°/s
J2 axis L	247°/s
J3 axis U	285°/s
J4 axis R	392°/s
J5 axis B	272°/s
J6 axis T	1353°/s

Electrical cabinet specifications	
Dimensions	650*495*580mm
Approx. weight	60KG
Cooling method	Natural cooling
Input power	220VAC 50/60Hz
Grounding	Industrial grounding (grounding resistance below 100Ω)
I/O terminals	<ul style="list-style-type: none"> • 16 digital inputs • 16 digital outputs • 2 analog outputs (optional)
Position control mode	EtherCAT, TCP/IP
Serial port I/F	RS485*1, RS422*1, RS232*1, CAN*1, USB*1
RAM capacity	JOB 200,000 steps, 10,000 robot commands (200MB)
Driving unit	6-axis AC servo system. External axis can be added as an option.

Operating conditions	
Use temperature	0~45°C
Storage temperature	-20~60°C
Humidity	10~90% RH, no condensing
Vibrations	Below 0.5G
Altitude	Below 1000m. (Degrade if over 1000m, max 2000m)
Other requirements	<ul style="list-style-type: none"> • With no corrosive or combustible gas • With no water, oil or drug splashing • With no electromagnetic field nearby • With no radiations nearby

▶ Working envelope (unit: mm)

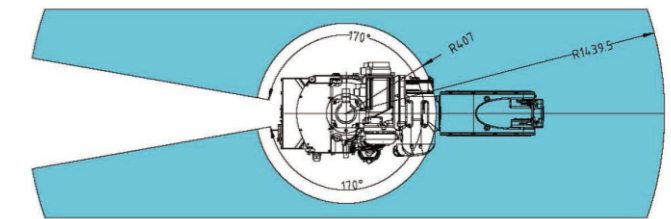
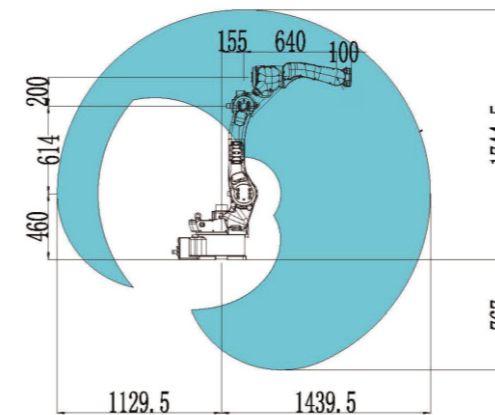

▶ Flange and base dimensions (unit: mm)

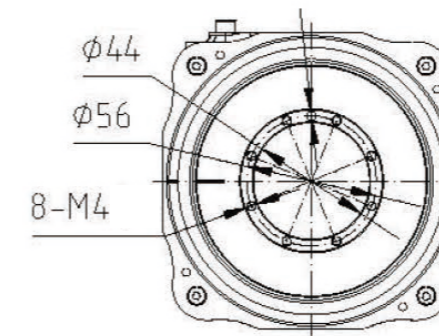

Flange

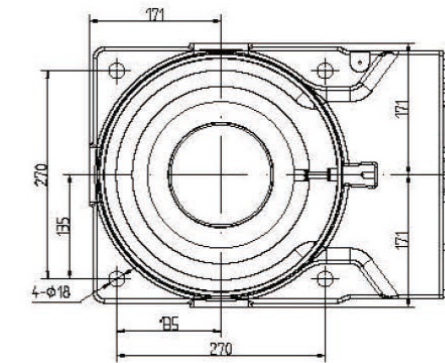

Base

▶ Payload diagram

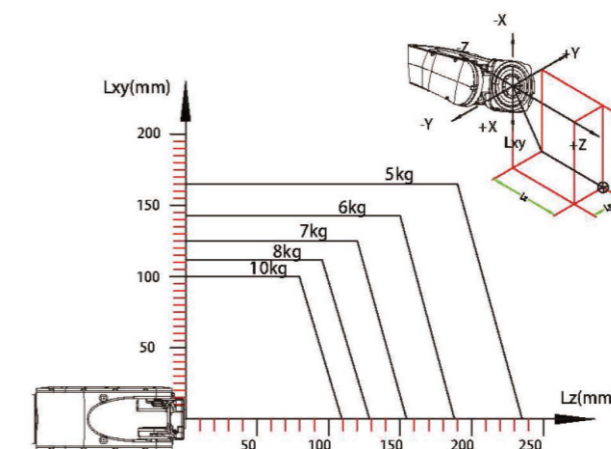

All data, drawings and specifications provided in this catalog are purely for information purposes and do not constitute a guarantee of these characteristics. The extent of goods delivered and services performed is determined by the subject matter of the specific contract. No liability accepted for errors or omissions.

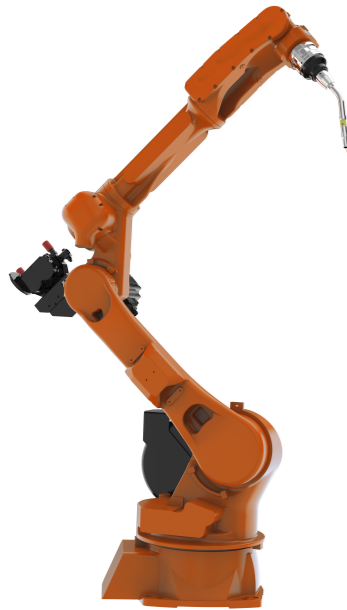

WELDING ROBOT

YS10-2000-W

Faster, more accurate and more reliable.
Suitable for all types of CO₂/MAG/MIG/TIG welding and plasma cutting.

Robot specifications

Basic data	
Model No.	YS06-2000-W
Number of axes	6
Maximum payload	10 kg
Maximum stroke	2010mm
IP class	J1, J2 - IP56; J3, J4, J5, J6 - IP67
Mounting position	Floor type, wall type, ceiling type
Approx. weight	186 kg (without cabinet or welding machine)
Repeatability	±0.05 mm
Internal air duct	Φ10
Welding machines	<ul style="list-style-type: none"> • Aotai NBC-350RL (CO₂/MAG/MIG, standard) • Aotai NBC-350/500RP (CO₂/MAG/MIG, optional) • Aotai MIG-350/500/630RP (CO₂/MAG/MIG, optional) • Aotai WSM-400R/WSME-315R (TIG, optional)
Motion range	
J1 axis S	±165°
J2 axis L	+80°~-145°
J3 axis U	+145°~-75°
J4 axis R	±190°
J5 axis B	+50°~-210°
J6 axis T	±220°
Speed with rated payload	
J1 axis S	203°/s
J2 axis L	203°/s
J3 axis U	214°/s
J4 axis R	392°/s
J5 axis B	276°/s
J6 axis T	1356°/s

Electrical cabinet specifications	
Dimensions	650*495*580mm
Approx. weight	60KG
Cooling method	Natural cooling
Input power	220VAC 50/60Hz
Grounding	Industrial grounding (grounding resistance below 100Ω)
I/O terminals	<ul style="list-style-type: none"> • 16 digital inputs • 16 digital outputs • 2 analog outputs (optional)
Position control mode	EtherCAT, TCP/IP
Serial port I/F	RS485*1, RS422*1, RS232*1, CAN*1, USB*1
RAM capacity	JOB 200,000 steps, 10,000 robot commands (200MB)
Driving unit	6-axis AC servo system. External axis can be added as an option.

Operating conditions	
Use temperature	0~45°C
Storage temperature	-20~60°C
Humidity	10~90% RH, no condensing
Vibrations	Below 0.5G
Altitude	Below 1000m. (Degrade if over 1000m, max 2000m)
Other requirements	<ul style="list-style-type: none"> • With no corrosive or combustible gas • With no water, oil or drug splashing • With no electromagnetic field nearby • With no radiations nearby

▶ Working envelope (unit: mm)

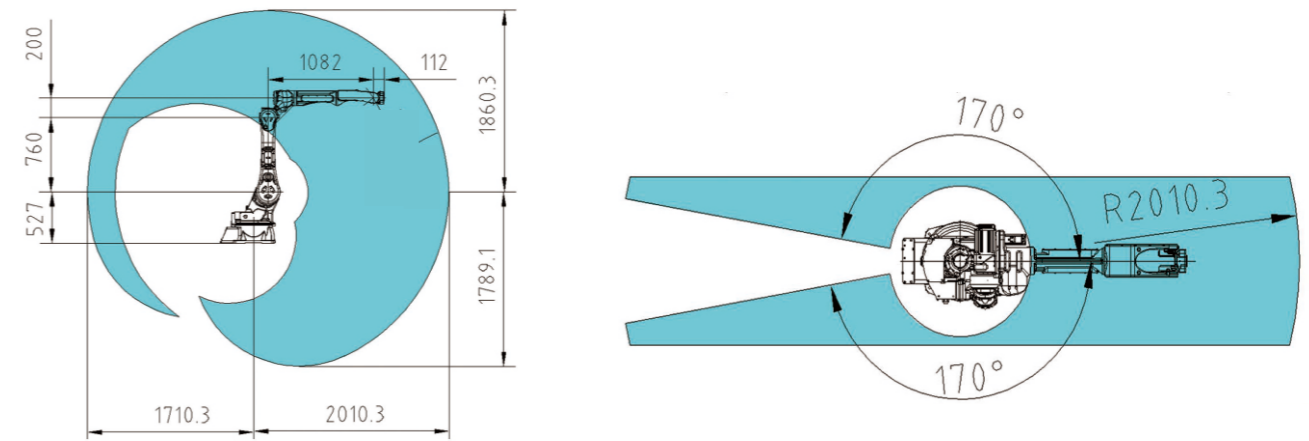

▶ Flange and base dimensions (unit: mm)

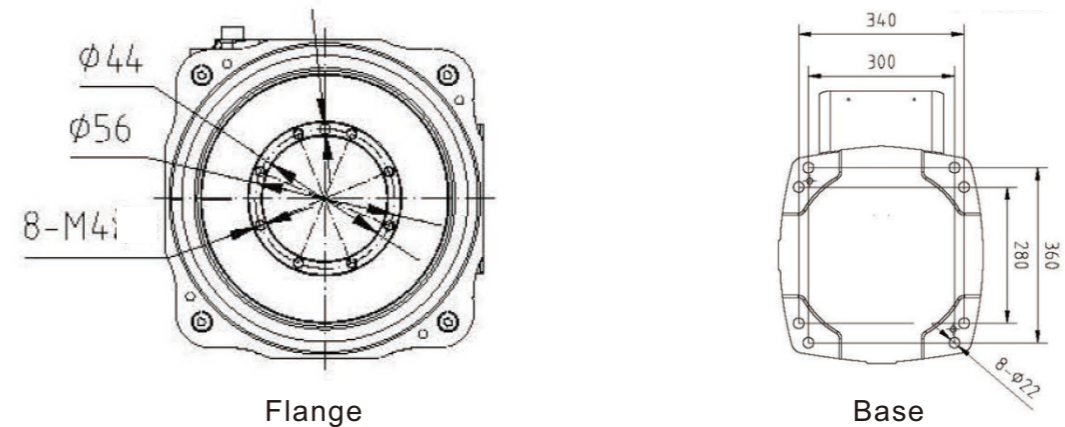

▶ Payload diagram

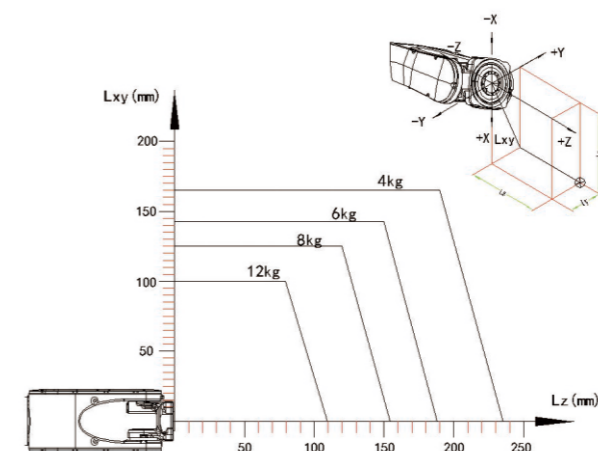

All data, drawings and specifications provided in this catalog are purely for information purposes and do not constitute a guarantee of these characteristics. The extent of goods delivered and services performed is determined by the subject matter of the specific contract. No liability accepted for errors or omissions.



6-AXIS HANDLING ROBOT

YS07-930

Enclosed design, compact and agile.
Suitable for pick-n-place, machine tending and palletizing.

Robot specifications

Basic data	
Model No.	YS07-930
Number of axes	6
Maximum payload	7 kg
Maximum stroke	930mm
IP class	J1, J2, J3, J4, J5, J6- IP67
Mounting position	Floor type, wall type, ceiling type
Approx. weight	60 kg (without cabinet)
Repeatability	±0.05 mm
Internal air duct	Φ6
Motion range	
J1 axis S	±170°
J2 axis L	±110°
J3 axis U	+70°~-90°
J4 axis R	±200°
J5 axis B	±120°
J6 axis T	±360°
Speed with rated payload	
J1 axis S	338°/s
J2 axis L	245°/s
J3 axis U	300°/s
J4 axis R	262°/s
J5 axis B	376°/s
J6 axis T	600°/s

Electrical cabinet specifications	
Dimensions	490*400*365mm
Approx. weight	40KG
Cooling method	Natural cooling
Input power	220VAC 50/60Hz
Grounding	Industrial grounding (grounding resistance below 100Ω)
I/O terminals	<ul style="list-style-type: none"> • 16 digital inputs • 16 digital outputs • 2 analog outputs (optional)
Position control mode	EtherCAT, TCP/IP
Serial port I/F	RS485*1, RS422*1, RS232*1, CAN*1, USB*1
RAM capacity	JOB 200,000 steps, 10,000 robot commands (200MB)
Driving unit	6-axis AC servo system. External axis can be added as an option.

Operating conditions	
Use temperature	0~45°C
Storage temperature	-20~60°C
Humidity	10~90% RH, no condensing
Vibrations	Below 0.5G
Altitude	Below 1000m. (Degrade if over 1000m, max 2000m)
Other requirements	<ul style="list-style-type: none"> • With no corrosive or combustible gas • With no water, oil or drug splashing • With no electromagnetic field nearby • With no radiations nearby

▶ Working envelope (unit: mm)

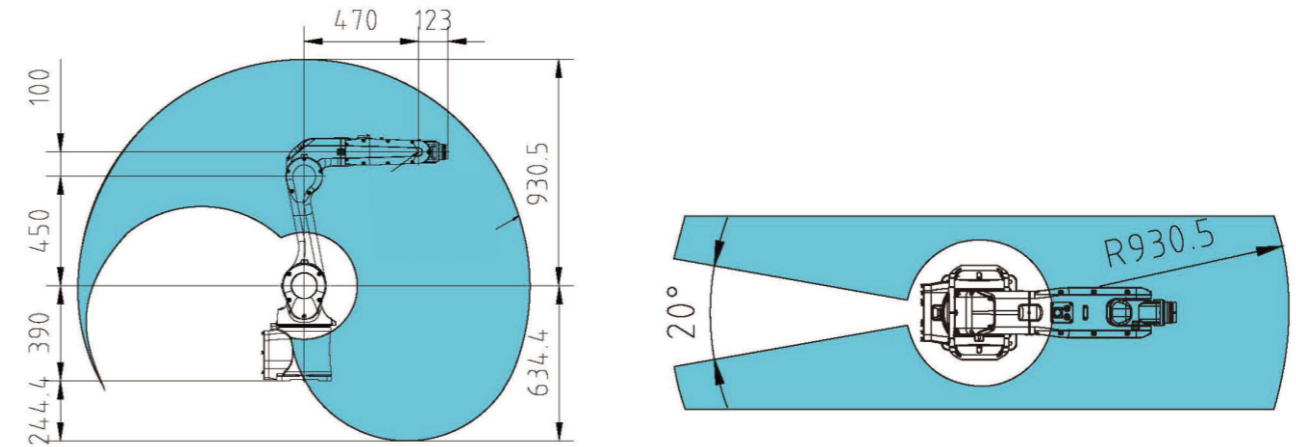

▶ Flange and base dimensions (unit: mm)

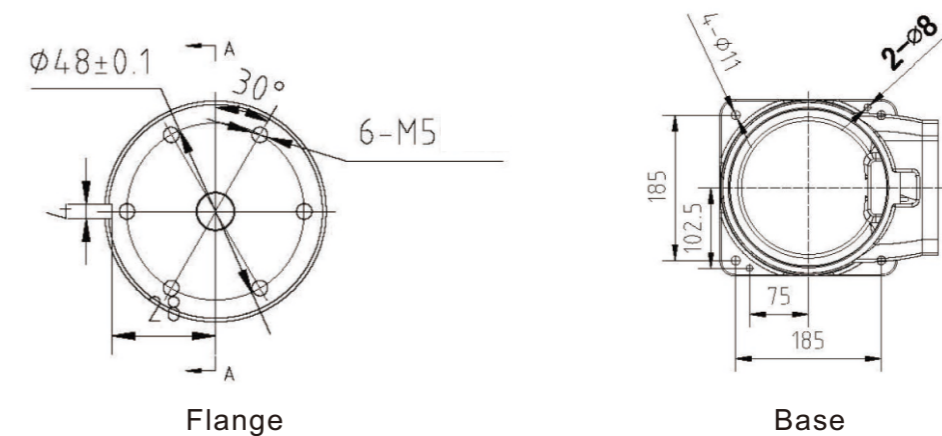

▶ Payload diagram

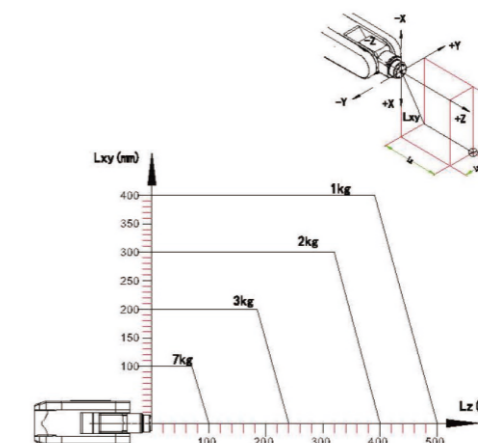

All data, drawings and specifications provided in this catalog are purely for information purposes and do not constitute a guarantee of these characteristics. The extent of goods delivered and services performed is determined by the subject matter of the specific contract. No liability accepted for errors or omissions.



6-AXIS HANDLING ROBOT

YS10-1440

Fast, accurate and reliable.
Suitable for pick-n-place, machine tending, palletizing and painting.

Robot specifications

Basic data	
Model No.	YS10-1440
Number of axes	6
Maximum payload	10 kg
Maximum stroke	1440mm
IP class	J1, J2 - IP56; J3, J4, J5, J6 - IP67
Mounting position	Floor type, wall type, ceiling type
Approx. weight	172 kg (without cabinet)
Repeatability	±0.05 mm
Internal air duct	Φ10
Motion range	
J1 axis S	±160°
J2 axis L	+80°~-145°
J3 axis U	+145°~-75°
J4 axis R	±190°
J5 axis B	+50°~-210°
J6 axis T	±360°
Speed with rated payload	
J1 axis S	199.5°/s
J2 axis L	174°/s
J3 axis U	199.5°/s
J4 axis R	392°/s
J5 axis B	272°/s
J6 axis T	480°/s

Electrical cabinet specifications	
Dimensions	650*495*580mm
Approx. weight	60KG
Cooling method	Natural cooling
Input power	220VAC 50/60Hz
Grounding	Industrial grounding (grounding resistance below 100Ω)
I/O terminals	<ul style="list-style-type: none"> • 16 digital inputs • 16 digital outputs • 2 analog outputs (optional)
Position control mode	EtherCAT, TCP/IP
Serial port I/F	RS485*1, RS422*1, RS232*1, CAN*1, USB*1
RAM capacity	JOB 200,000 steps, 10,000 robot commands (200MB)
Driving unit	6-axis AC servo system. External axis can be added as an option.

Operating conditions	
Use temperature	0~45°C
Storage temperature	-20~60°C
Humidity	10~90% RH, no condensing
Vibrations	Below 0.5G
Altitude	Below 1000m. (Degrade if over 1000m, max 2000m)
Other requirements	<ul style="list-style-type: none"> • With no corrosive or combustible gas • With no water, oil or drug splashing • With no electromagnetic field nearby • With no radiations nearby

▶ Working envelope (unit: mm)

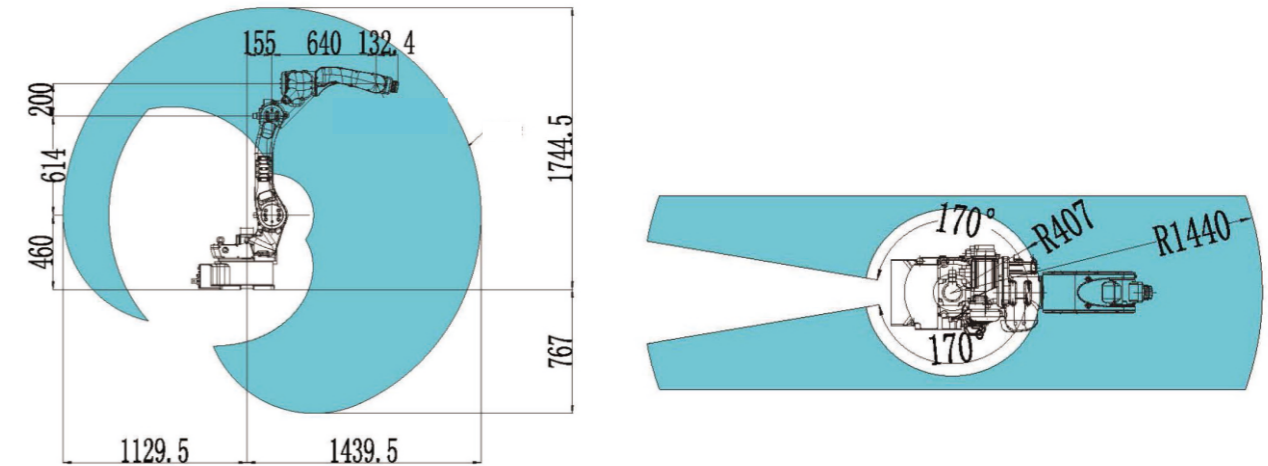

▶ Flange and base dimensions (unit: mm)

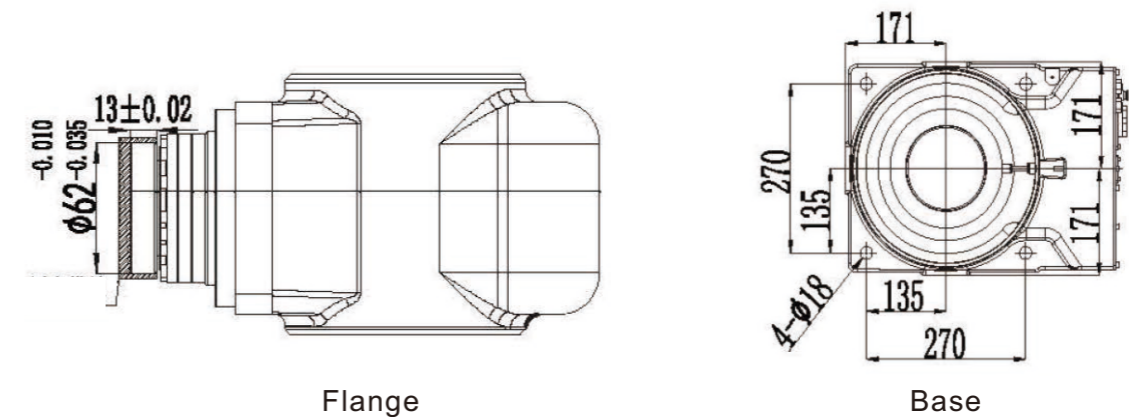

▶ Payload diagram

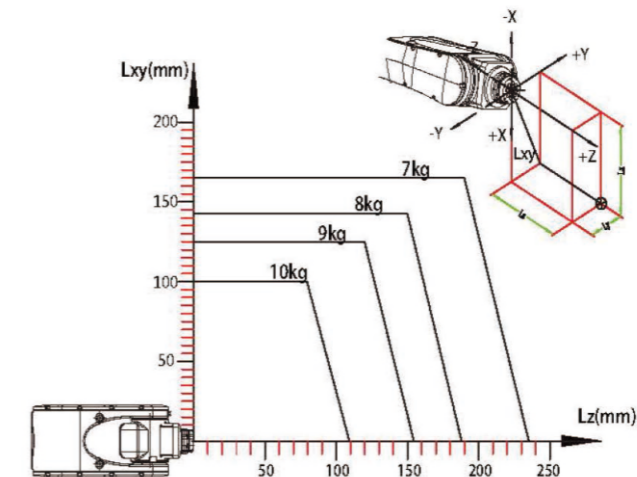

All data, drawings and specifications provided in this catalog are purely for information purposes and do not constitute a guarantee of these characteristics. The extent of goods delivered and services performed is determined by the subject matter of the specific contract. No liability accepted for errors or omissions.



6-AXIS HANDLING ROBOT

YS12-1550

Fast, accurate and reliable.
Suitable for pick-n-place, machine tending, palletizing and painting.

Robot specifications

Basic data	
Model No.	YS12-1550
Number of axes	6
Maximum payload	12 kg
Maximum stroke	1550mm
IP class	J1, J2 - IP56; J3, J4, J5, J6 - IP67
Mounting position	Floor type, wall type, ceiling type
Approx. weight	172 kg (without cabinet)
Repeatability	±0.05 mm
Internal air duct	Φ10
Motion range	
J1 axis S	±160°
J2 axis L	+80°~-145°
J3 axis U	+145°~-75°
J4 axis R	±190°
J5 axis B	+20°~-200°
J6 axis T	±360°
Speed with rated payload	
J1 axis S	257°/s
J2 axis L	223°/s
J3 axis U	257°/s
J4 axis R	272°/s
J5 axis B	275°/s
J6 axis T	540°/s

Electrical cabinet specifications	
Dimensions	650*495*580mm
Approx. weight	60KG
Cooling method	Natural cooling
Input power	220VAC 50/60Hz
Grounding	Industrial grounding (grounding resistance below 100Ω)
I/O terminals	<ul style="list-style-type: none"> • 16 digital inputs • 16 digital outputs • 2 analog outputs (optional)
Position control mode	EtherCAT, TCP/IP
Serial port I/F	RS485*1, RS422*1, RS232*1, CAN*1, USB*1
RAM capacity	JOB 200,000 steps, 10,000 robot commands (200MB)
Driving unit	6-axis AC servo system. External axis can be added as an option.

Operating conditions	
Use temperature	0~45°C
Storage temperature	-20~60°C
Humidity	10~90% RH, no condensing
Vibrations	Below 0.5G
Altitude	Below 1000m. (Degrade if over 1000m, max 2000m)
Other requirements	<ul style="list-style-type: none"> • With no corrosive or combustible gas • With no water, oil or drug splashing • With no electromagnetic field nearby • With no radiations nearby

▶ Working envelope (unit: mm)

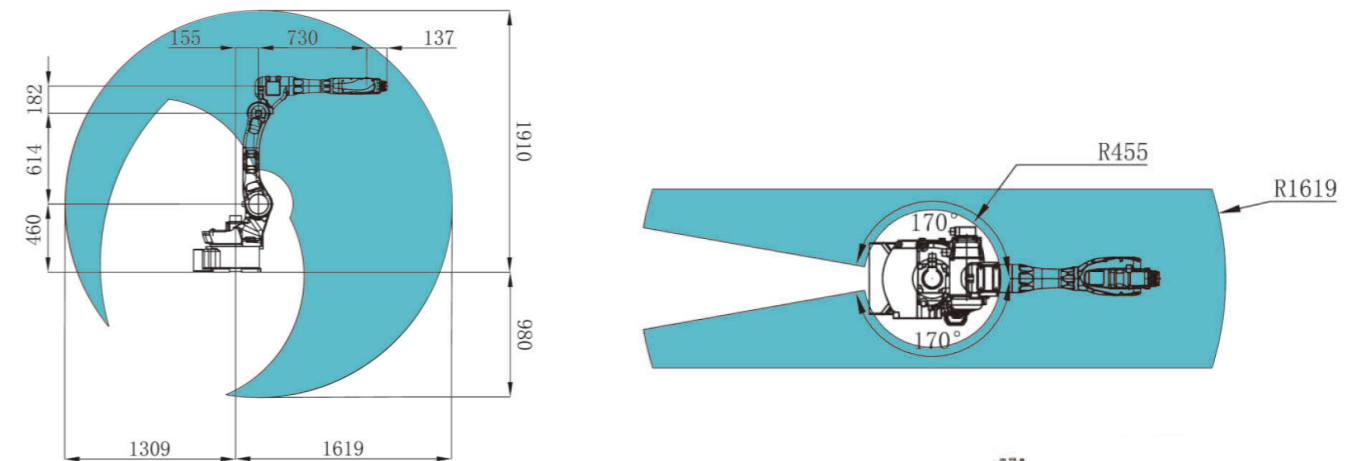

▶ Flange and base dimensions (unit: mm)

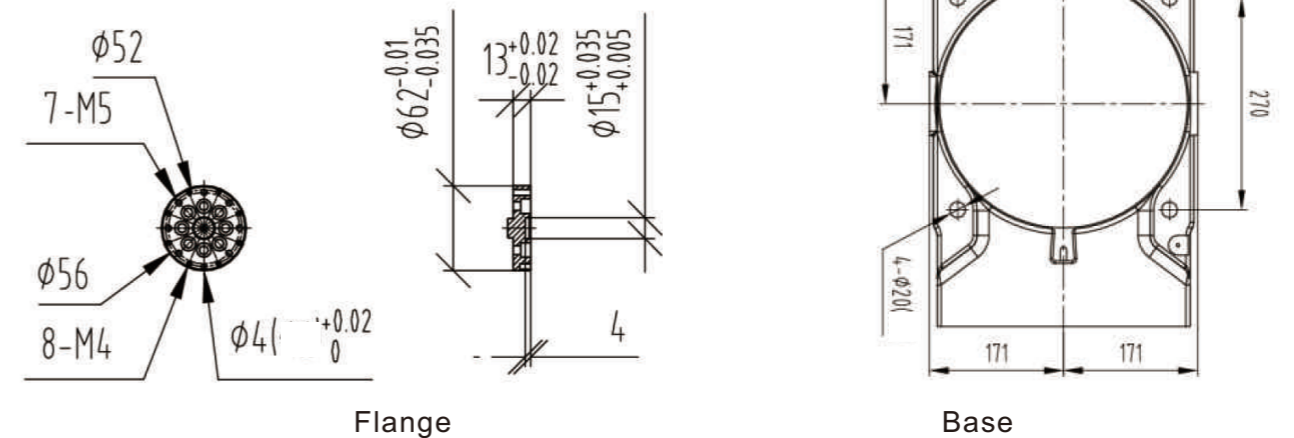

▶ Payload diagram

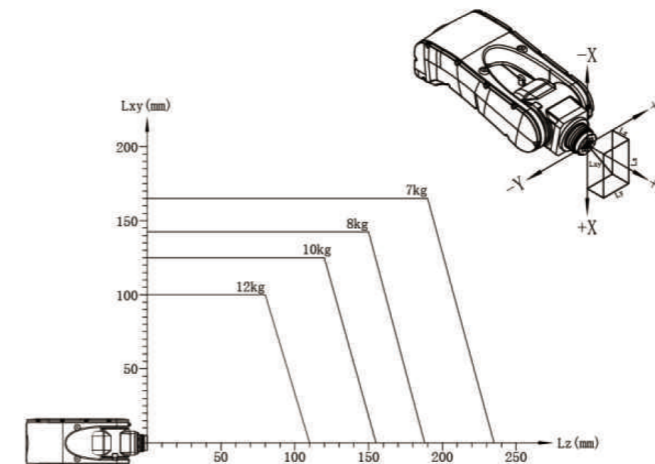

All data, drawings and specifications provided in this catalog are purely for information purposes and do not constitute a guarantee of these characteristics. The extent of goods delivered and services performed is determined by the subject matter of the specific contract. No liability accepted for errors or omissions.



6-AXIS HANDLING ROBOT

YS10-2000

Special long-stroke design.
Suitable for pick-n-place and palletizing.

Robot specifications

Basic data	
Model No.	YS10-2000
Number of axes	6
Maximum payload	10 kg
Maximum stroke	2050mm
IP class	J1, J2 - IP56; J3, J4, J5, J6 - IP67
Mounting position	Floor type, wall type, ceiling type
Approx. weight	286kg (without cabinet)
Repeatability	±0.08 mm
Internal air duct	Φ10
Motion range	
J1 axis S	±167°
J2 axis L	+92°~150°
J3 axis U	+110°~85°
J4 axis R	±150°
J5 axis B	+20°~200°
J6 axis T	±360°
Speed with rated payload	
J1 axis S	181°/s
J2 axis L	181°/s
J3 axis U	190°/s
J4 axis R	375°/s
J5 axis B	412°/s
J6 axis T	600°/s

Electrical cabinet specifications	
Dimensions	650*495*580mm
Approx. weight	80KG
Cooling method	Natural cooling
Input power	380VAC 50/60Hz
Grounding	Industrial grounding (grounding resistance below 100Ω)
I/O terminals	<ul style="list-style-type: none"> • 16 digital inputs • 16 digital outputs • 2 analog outputs (optional)
Position control mode	EtherCAT, TCP/IP
Serial port I/F	RS485*1, RS422*1, RS232*1, CAN*1, USB*1
RAM capacity	JOB 200,000 steps, 10,000 robot commands (200MB)
Driving unit	6-axis AC servo system. External axis can be added as an option.

Operating conditions	
Use temperature	0~45°C
Storage temperature	-20~60°C
Humidity	10~90% RH, no condensing
Vibrations	Below 0.5G
Altitude	Below 1000m. (Degrade if over 1000m, max 2000m)
Other requirements	<ul style="list-style-type: none"> • With no corrosive or combustible gas • With no water, oil or drug splashing • With no electromagnetic field nearby • With no radiations nearby

Working envelope (unit: mm)

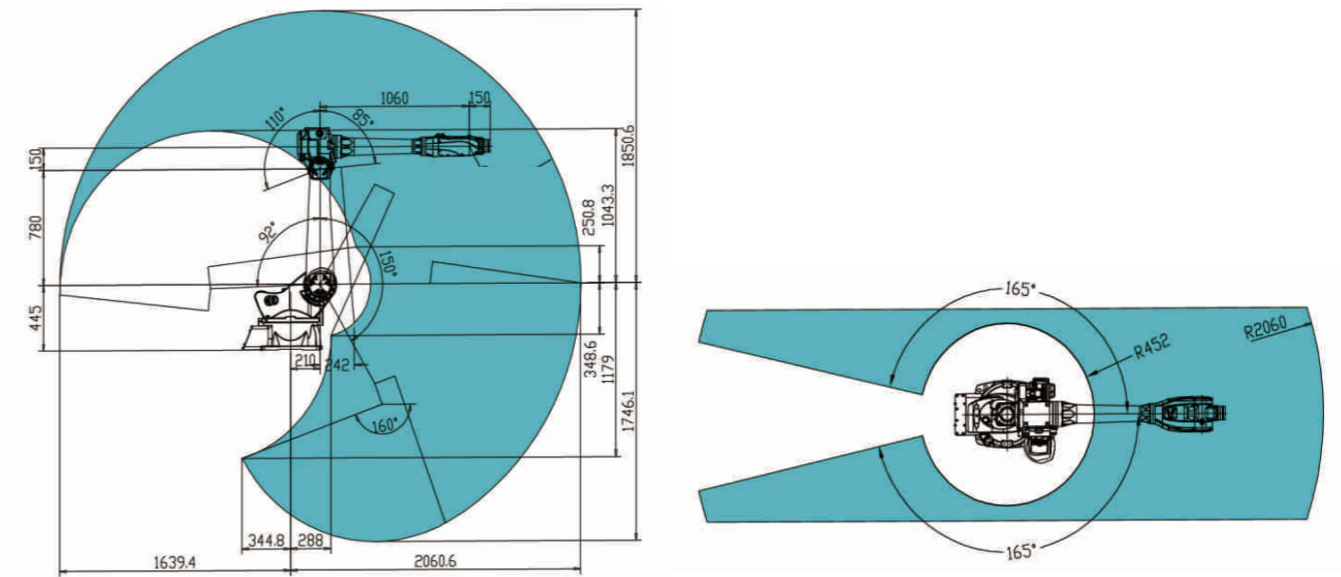

Flange and base dimensions (unit: mm)

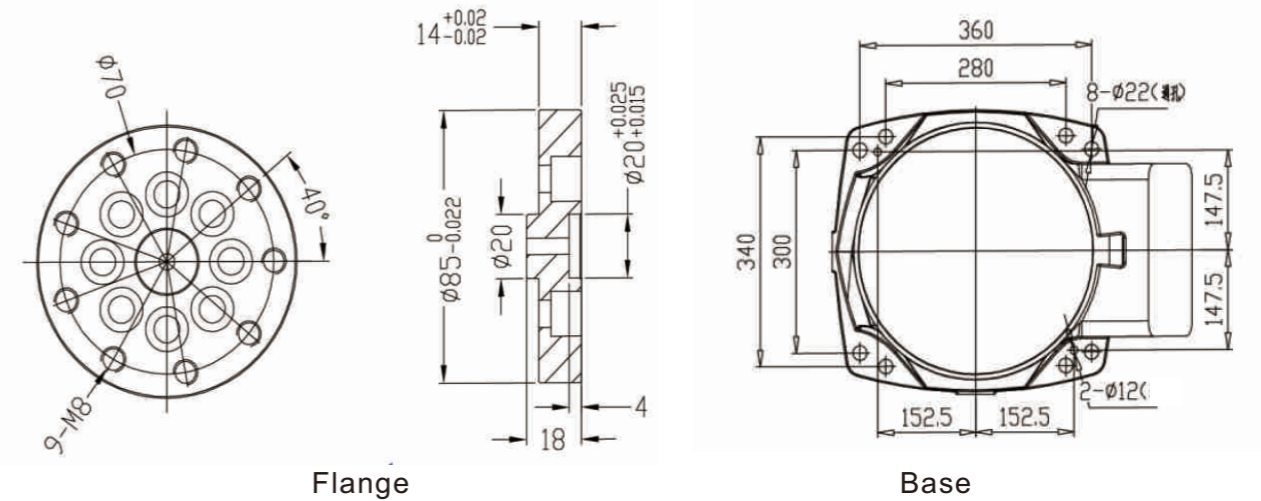

Payload diagram

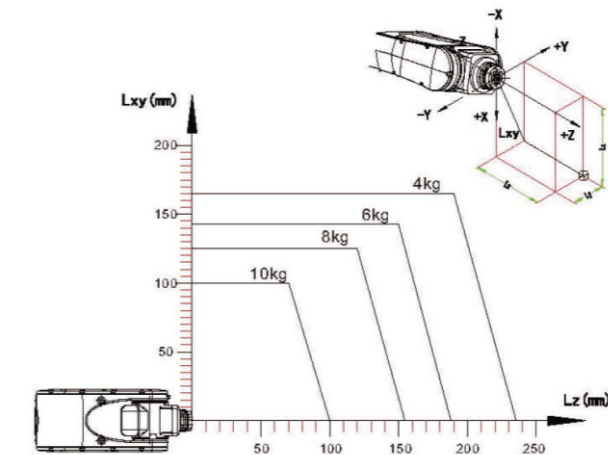

All data, drawings and specifications provided in this catalog are purely for information purposes and do not constitute a guarantee of these characteristics. The extent of goods delivered and services performed is determined by the subject matter of the specific contract. No liability accepted for errors or omissions.



6-AXIS HANDLING ROBOT

YS20-1840

Fast, accurate and reliable.
Suitable for pick-n-place, machine tending, palletizing and painting.

Robot specifications

Basic data	
Model No.	YS20-1800
Number of axes	6
Maximum payload	20 kg
Maximum stroke	1840mm
IP class	J1, J2 - IP56; J3, J4, J5, J6 - IP67
Mounting position	Floor type, wall type, ceiling type
Approx. weight	260 kg (without cabinet)
Repeatability	±0.08 mm
Internal air duct	Φ10
Motion range	
J1 axis S	±167°
J2 axis L	+92°~150°
J3 axis U	+110°~85°
J4 axis R	±150°
J5 axis B	+20°~200°
J6 axis T	±360°
Speed with rated payload	
J1 axis S	223°/s
J2 axis L	223°/s
J3 axis U	214°/s
J4 axis R	375°/s
J5 axis B	412°/s
J6 axis T	600°/s

Electrical cabinet specifications	
Dimensions	650*495*580mm
Approx. weight	80KG
Cooling method	Natural cooling
Input power	380VAC 50/60Hz
Grounding	Industrial grounding (grounding resistance below 100Ω)
I/O terminals	<ul style="list-style-type: none"> • 16 digital inputs • 16 digital outputs • 2 analog outputs (optional)
Position control mode	EtherCAT, TCP/IP
Serial port I/F	RS485*1, RS422*1, RS232*1, CAN*1, USB*1
RAM capacity	JOB 200,000 steps, 10,000 robot commands (200MB)
Driving unit	6-axis AC servo system. External axis can be added as an option.

Operating conditions	
Use temperature	0~45°C
Storage temperature	-20~60°C
Humidity	10~90% RH, no condensing
Vibrations	Below 0.5G
Altitude	Below 1000m. (Degrade if over 1000m, max 2000m)
Other requirements	<ul style="list-style-type: none"> • With no corrosive or combustible gas • With no water, oil or drug splashing • With no electromagnetic field nearby • With no radiations nearby

Working envelope (unit: mm)

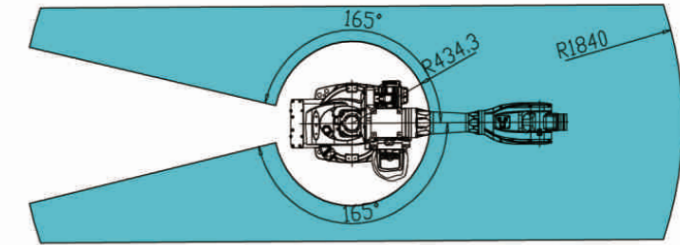
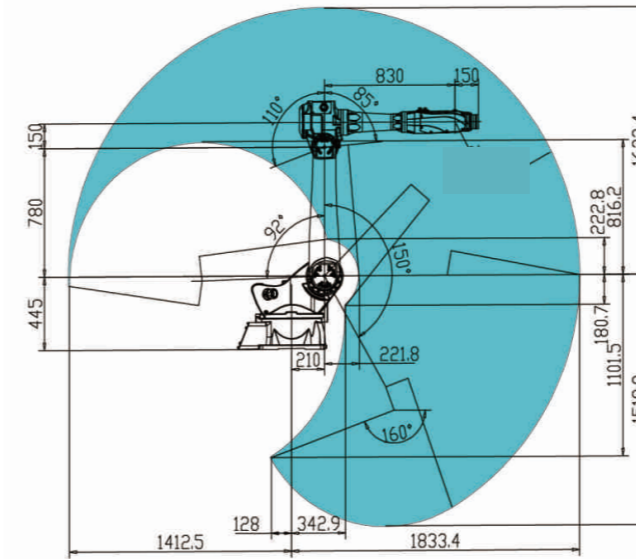

Flange and base dimensions (unit: mm)

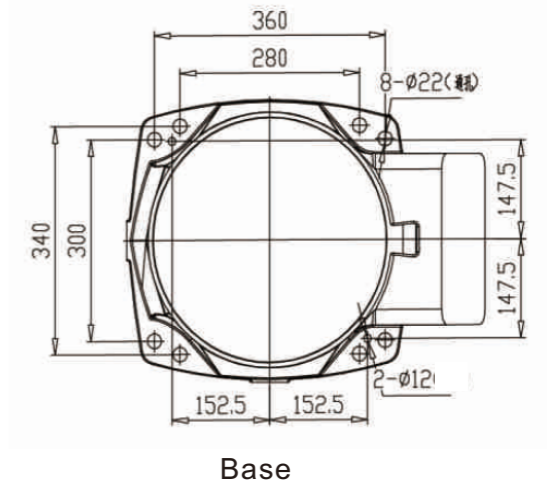
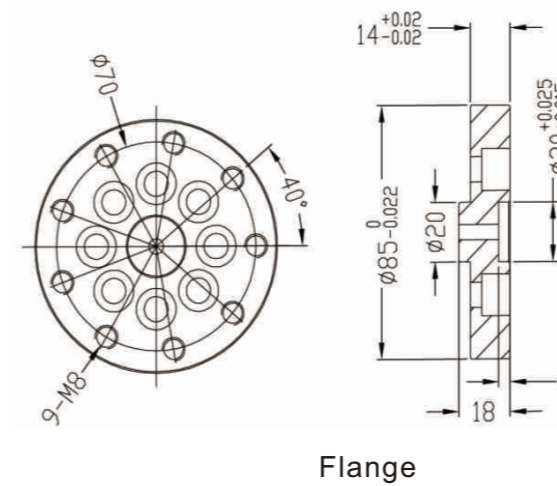

Payload diagram

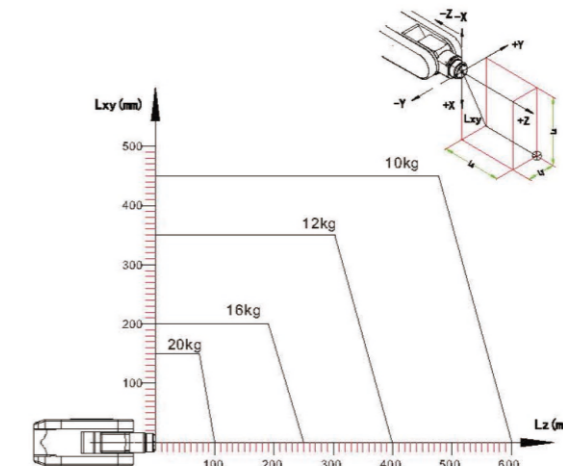

All data, drawings and specifications provided in this catalog are purely for information purposes and do not constitute a guarantee of these characteristics. The extent of goods delivered and services performed is determined by the subject matter of the specific contract. No liability accepted for errors or omissions.



6-AXIS HANDLING ROBOT

YS30-1840

Fast, accurate and reliable.
Suitable for pick-n-place, machine tending, palletizing and painting.

Robot specifications

Basic data	
Model No.	YS30-1800
Number of axes	6
Maximum payload	30 kg
Maximum stroke	1840mm
IP class	J1, J2 - IP56; J3, J4, J5, J6- IP67
Mounting position	Floor type, wall type, ceiling type
Approx. weight	260 kg (without cabinet)
Repeatability	±0.08 mm
Internal air duct	Φ10
Motion range	
J1 axis S	±167°
J2 axis L	+92°~-150°
J3 axis U	+110°~-85°
J4 axis R	±150°
J5 axis B	+20°~-200°
J6 axis T	±360°
Speed with rated payload	
J1 axis S	200°/s
J2 axis L	198°/s
J3 axis U	163°/s
J4 axis R	296°/s
J5 axis B	333°/s
J6 axis T	333°/s

Electrical cabinet specifications	
Dimensions	650*495*580mm
Approx. weight	80KG
Cooling method	Natural cooling
Input power	380VAC 50/60Hz
Grounding	Industrial grounding (grounding resistance below 100Ω)
I/O terminals	<ul style="list-style-type: none"> • 16 digital inputs • 16 digital outputs • 2 analog outputs (optional)
Position control mode	EtherCAT, TCP/IP
Serial port I/F	RS485*1, RS422*1, RS232*1, CAN*1, USB*1
RAM capacity	JOB 200,000 steps, 10,000 robot commands (200MB)
Driving unit	6-axis AC servo system. External axis can be added as an option.

Operating conditions	
Use temperature	0~45°C
Storage temperature	-20~60°C
Humidity	10~90% RH, no condensing
Vibrations	Below 0.5G
Altitude	Below 1000m. (Degrade if over 1000m, max 2000m)
Other requirements	<ul style="list-style-type: none"> • With no corrosive or combustible gas • With no water, oil or drug splashing • With no electromagnetic field nearby • With no radiations nearby

▶ Working envelope (unit: mm)

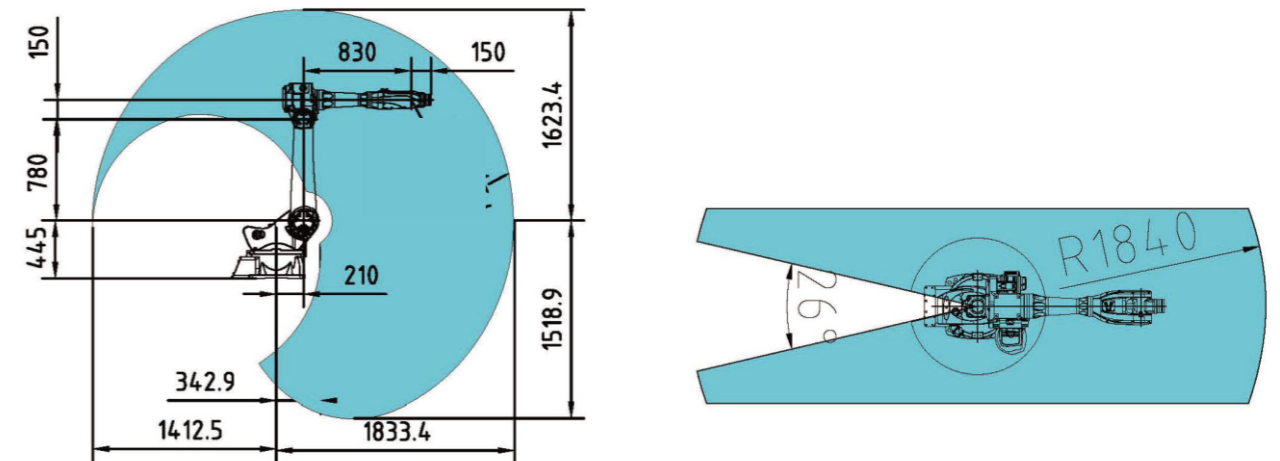

▶ Flange and base dimensions (unit: mm)

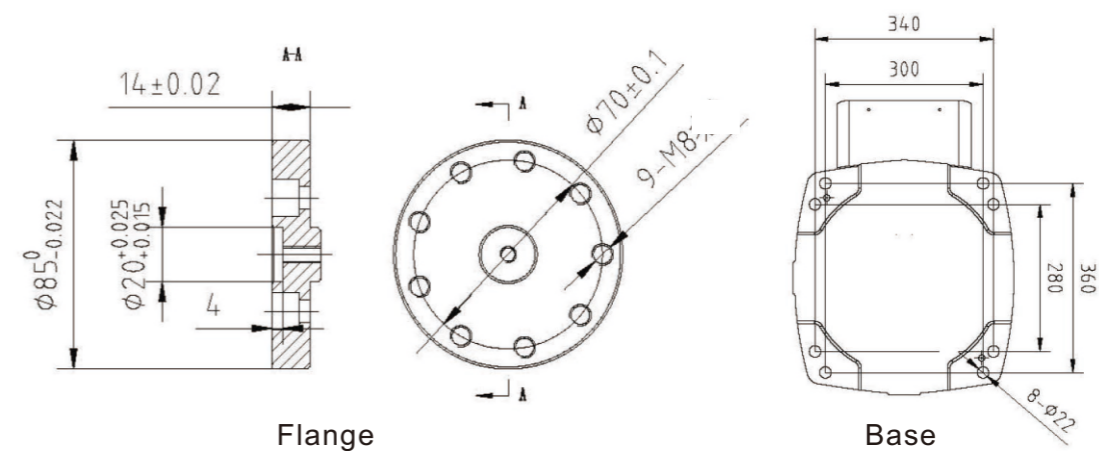

▶ Payload diagram

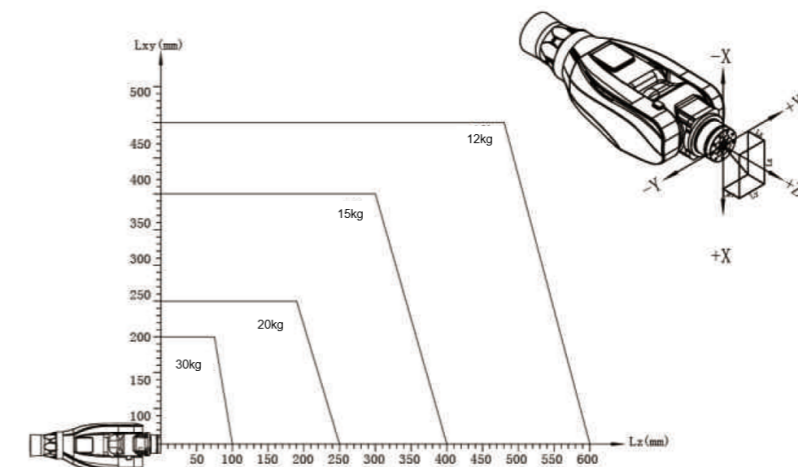

All data, drawings and specifications provided in this catalog are purely for information purposes and do not constitute a guarantee of these characteristics. The extent of goods delivered and services performed is determined by the subject matter of the specific contract. No liability accepted for errors or omissions.



6-AXIS HANDLING ROBOT

YS30-1700

Enclosed design. Heavy duty.
Suitable for pick-n-place, machine tending, palletizing, polishing and painting.

Robot specifications

Basic data	
Model No.	YS30-1700
Number of axes	6
Maximum payload	30 kg
Maximum stroke	1700mm
IP class	J1, J2 - IP56; J3, J4, J5, J6- IP67
Mounting position	Floor type, wall type, ceiling type
Approx. weight	283 kg (without cabinet)
Repeatability	±0.08 mm
Internal air duct	Φ10
Motion range	
J1 axis S	±165°
J2 axis L	+80°~150°
J3 axis U	+130°~60°
J4 axis R	±190°
J5 axis B	+20°~200°
J6 axis T	±360°
Speed with rated payload	
J1 axis S	130°/s
J2 axis L	130°/s
J3 axis U	144°/s
J4 axis R	224°/s
J5 axis B	333°/s
J6 axis T	374°/s

Electrical cabinet specifications	
Dimensions	650*495*580mm
Approx. weight	80KG
Cooling method	Natural cooling
Input power	380VAC 50/60Hz
Grounding	Industrial grounding (grounding resistance below 100Ω)
I/O terminals	<ul style="list-style-type: none"> • 16 digital inputs • 16 digital outputs • 2 analog outputs (optional)
Position control mode	EtherCAT, TCP/IP
Serial port I/F	RS485*1, RS422*1, RS232*1, CAN*1, USB*1
RAM capacity	JOB 200,000 steps, 10,000 robot commands (200MB)
Driving unit	6-axis AC servo system. External axis can be added as an option.

Operating conditions	
Use temperature	0~45°C
Storage temperature	-20~60°C
Humidity	10~90% RH, no condensing
Vibrations	Below 0.5G
Altitude	Below 1000m. (Degrade if over 1000m, max 2000m)
Other requirements	<ul style="list-style-type: none"> • With no corrosive or combustible gas • With no water, oil or drug splashing • With no electromagnetic field nearby • With no radiations nearby

▶ Working envelope (unit: mm)

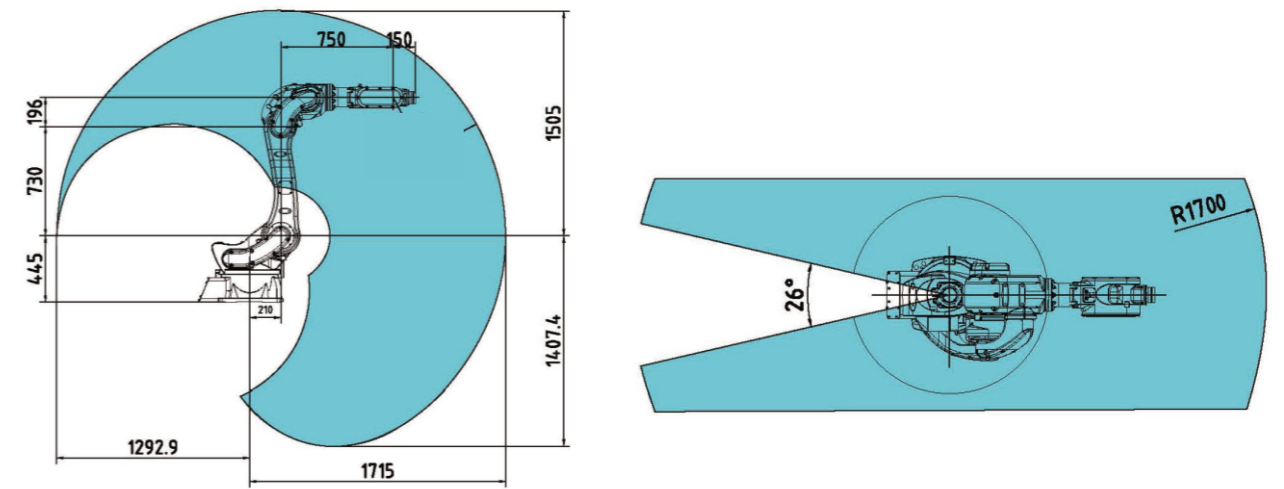

▶ Flange and base dimensions (unit: mm)

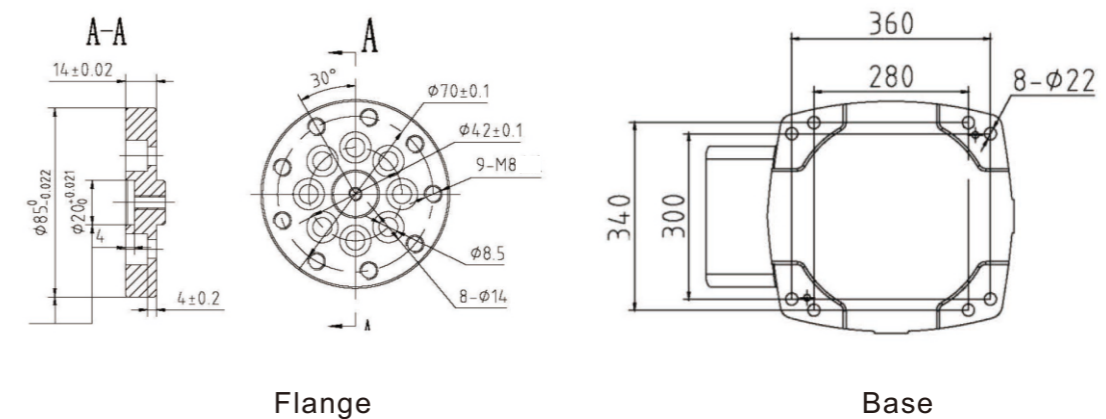

▶ Payload diagram

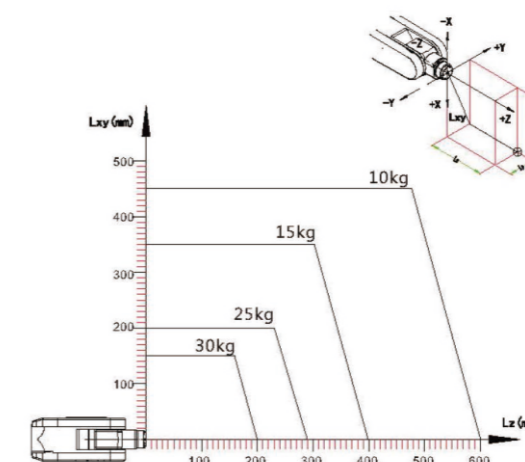

All data, drawings and specifications provided in this catalog are purely for information purposes and do not constitute a guarantee of these characteristics. The extent of goods delivered and services performed is determined by the subject matter of the specific contract. No liability accepted for errors or omissions.



6-AXIS HANDLING ROBOT

YS60-2680

Enclosed design. Heavy duty.
Suitable for pick-n-place, machine tending, palletizing, polishing and painting.

Robot specifications

Basic data	
Model No.	YS60-2680
Number of axes	6
Maximum payload	60 kg
Maximum stroke	2680mm
IP class	J1, J2 - IP56; J3, J4, J5, J6- IP67
Mounting position	Floor type, wall type
Approx. weight	655 kg (without cabinet)
Repeatability	±0.08 mm
Internal air duct	Φ8/10
Motion range	
J1 axis S	±165°
J2 axis L	+90°~-120°
J3 axis U	+140°~-70°
J4 axis R	±190°
J5 axis B	+30°~-210°
J6 axis T	±360°
Speed with rated payload	
J1 axis S	214°/s
J2 axis L	149°/s
J3 axis U	175°/s
J4 axis R	378°/s
J5 axis B	285°/s
J6 axis T	370°/s

Electrical cabinet specifications	
Dimensions	850*550*920mm
Approx. weight	170KG
Cooling method	Natural cooling
Input power	380VAC 50/60Hz
Grounding	Industrial grounding (grounding resistance below 100Ω)
I/O terminals	<ul style="list-style-type: none"> • 16 digital inputs • 16 digital outputs • 2 analog outputs (optional)
Position control mode	EtherCAT, TCP/IP
Serial port I/F	RS485*1, RS422*1, RS232*1, CAN*1, USB*1
RAM capacity	JOB 200,000 steps, 10,000 robot commands (200MB)
Driving unit	6-axis AC servo system. External axis can be added as an option.

Operating conditions	
Use temperature	0~45°C
Storage temperature	-20~60°C
Humidity	10~90% RH, no condensing
Vibrations	Below 0.5G
Altitude	Below 1000m. (Degrade if over 1000m, max 2000m)
Other requirements	<ul style="list-style-type: none"> • With no corrosive or combustible gas • With no water, oil or drug splashing • With no electromagnetic field nearby • With no radiations nearby

▶ Working envelope (unit: mm)

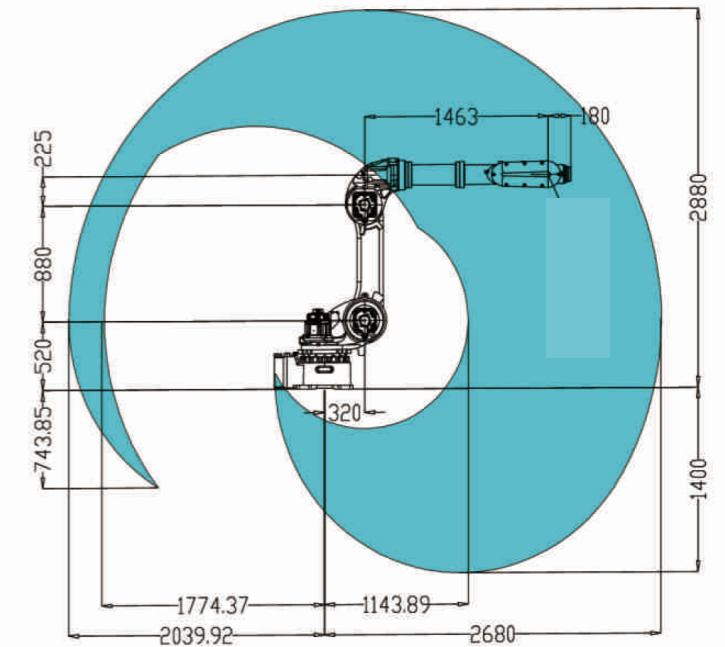

▶ Flange and base dimensions (unit: mm)

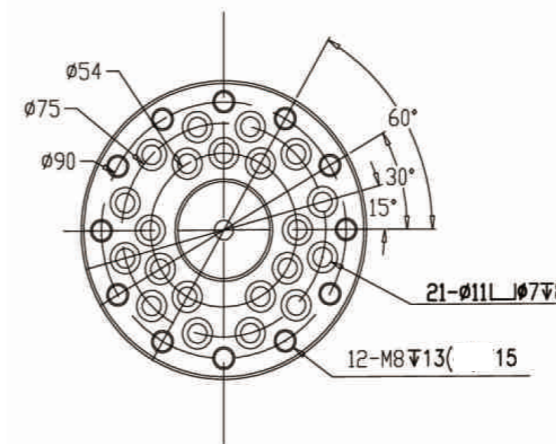

Flange

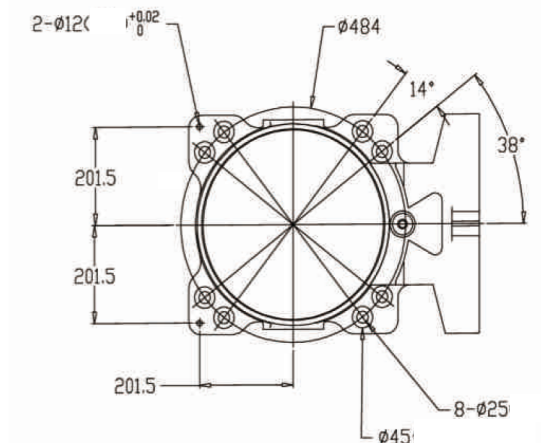

Base

▶ Payload diagram

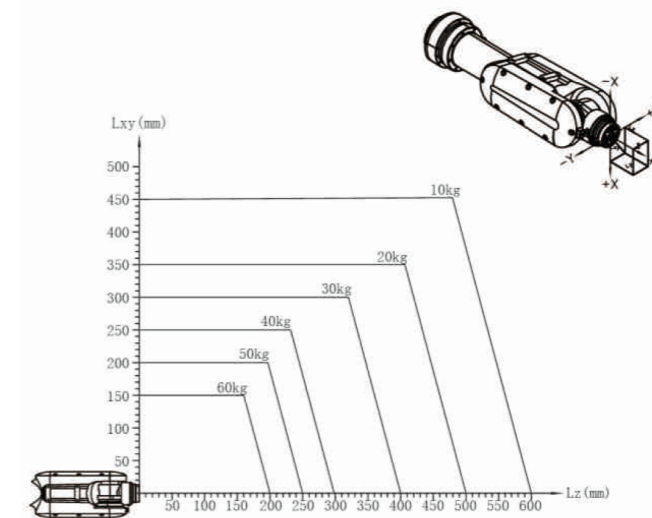

All data, drawings and specifications provided in this catalog are purely for information purposes and do not constitute a guarantee of these characteristics. The extent of goods delivered and services performed is determined by the subject matter of the specific contract. No liability accepted for errors or omissions.



6-AXIS HANDLING ROBOT

YS80-2250

Enclosed design. Heavy duty.
Suitable for pick-n-place, machine tending, palletizing, polishing and painting.

Robot specifications

Basic data	
Model No.	YS80-2250
Number of axes	6
Maximum payload	80 kg
Maximum stroke	2250mm
IP class	J1, J2 - IP56; J3, J4, J5, J6- IP67
Mounting position	Floor type, wall type
Approx. weight	678 kg (without cabinet)
Repeatability	±0.08 mm
Internal air duct	Φ8/10
Motion range	
J1 axis S	±165°
J2 axis L	+90°~-120°
J3 axis U	+140°~-70°
J4 axis R	±190°
J5 axis B	+30°~-210°
J6 axis T	±360°
Speed with rated payload	
J1 axis S	216°/s
J2 axis L	150°/s
J3 axis U	175°/s
J4 axis R	378°/s
J5 axis B	286°/s
J6 axis T	370°/s

Electrical cabinet specifications	
Dimensions	850*550*920mm
Approx. weight	170KG
Cooling method	Natural cooling
Input power	380VAC 50/60Hz
Grounding	Industrial grounding (grounding resistance below 100Ω)
I/O terminals	<ul style="list-style-type: none"> • 16 digital inputs • 16 digital outputs • 2 analog outputs (optional)
Position control mode	EtherCAT, TCP/IP
Serial port I/F	RS485*1, RS422*1, RS232*1, CAN*1, USB*1
RAM capacity	JOB 200,000 steps, 10,000 robot commands (200MB)
Driving unit	6-axis AC servo system. External axis can be added as an option.

Operating conditions	
Use temperature	0~45°C
Storage temperature	-20~60°C
Humidity	10~90% RH, no condensing
Vibrations	Below 0.5G
Altitude	Below 1000m. (Degrade if over 1000m, max 2000m)
Other requirements	<ul style="list-style-type: none"> • With no corrosive or combustible gas • With no water, oil or drug splashing • With no electromagnetic field nearby • With no radiations nearby

▶ Working envelope (unit: mm)

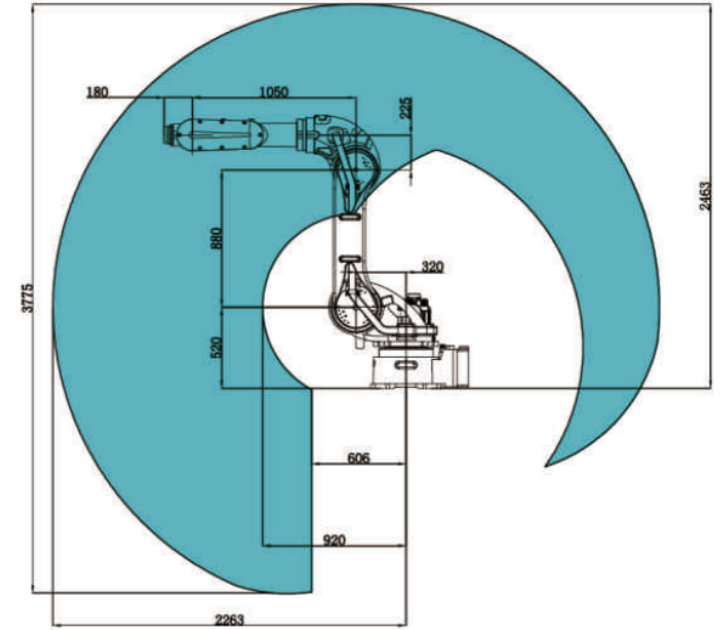

▶ Flange and base dimensions (unit: mm)

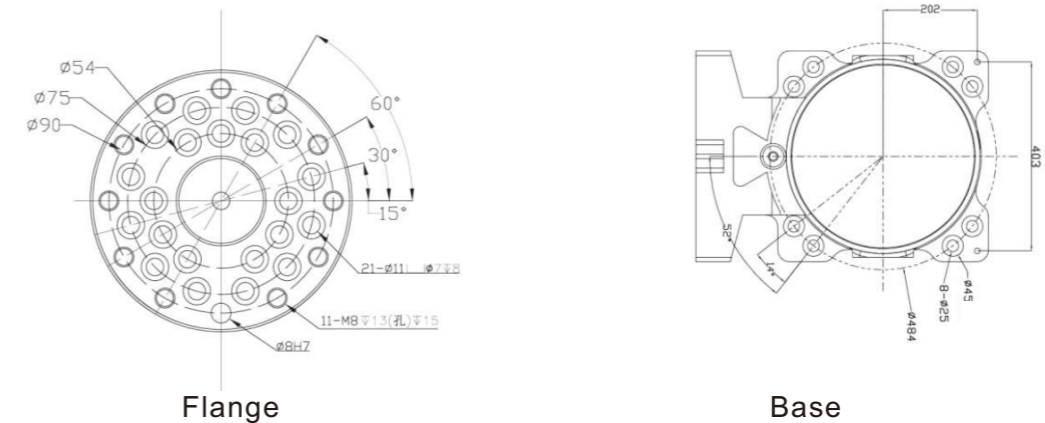

▶ Payload diagram

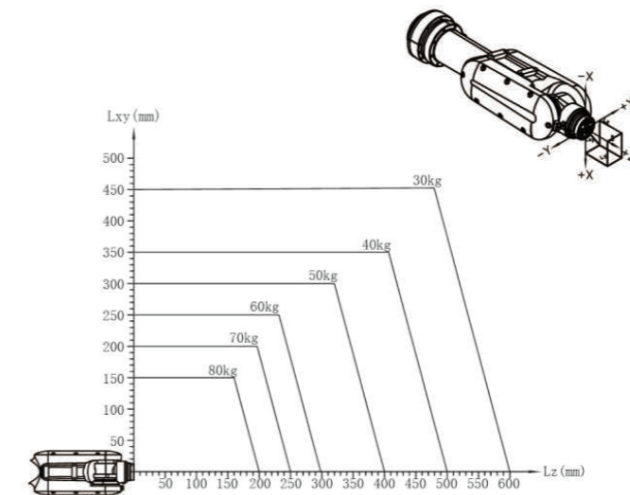

All data, drawings and specifications provided in this catalog are purely for information purposes and do not constitute a guarantee of these characteristics. The extent of goods delivered and services performed is determined by the subject matter of the specific contract. No liability accepted for errors or omissions.



6-AXIS HANDLING ROBOT

YSRT50-270

Special long-stroke design.
Suitable for pick-n-place and palletizing.

Robot specifications

Basic data	
Model No.	YSRT50-270
Number of axes	6
Maximum payload	50 kg
Maximum stroke	1700mm
IP class	J1, J2, J3, J4, J5, J6 - IP56
Mounting position	Floor type
Approx. weight	600 kg (without cabinet)
Repeatability	±0.15 mm
Internal air duct	Φ10
Motion range	
J1 axis S	±165°
J2 axis L	+80°~-90°
J3 axis U	+105°~-75°
J4 axis R	±180°
J5 axis B	+98°~-90°
J6 axis T	±360°
Speed with rated payload	
J1 axis S	127°/s
J2 axis L	70°/s
J3 axis U	74.5°/s
J4 axis R	137°/s
J5 axis B	99°/s
J6 axis T	222°/s

Electrical cabinet specifications	
Dimensions	560*500*730mm
Approx. weight	80KG
Cooling method	Natural cooling
Input power	380VAC 50/60Hz
Grounding	Industrial grounding (grounding resistance below 100Ω)
I/O terminals	<ul style="list-style-type: none"> • 16 digital inputs • 16 digital outputs • 2 analog outputs (optional)
Position control mode	EtherCAT, TCP/IP
Serial port I/F	RS485*1, RS422*1, RS232*1, CAN*1, USB*1
RAM capacity	JOB 200,000 steps, 10,000 robot commands (200MB)
Driving unit	6-axis AC servo system. External axis can be added as an option.

Operating conditions	
Use temperature	0~45°C
Storage temperature	-20~60°C
Humidity	10~90% RH, no condensing
Vibrations	Below 0.5G
Altitude	Below 1000m. (Degrade if over 1000m, max 2000m)
Other requirements	<ul style="list-style-type: none"> • With no corrosive or combustible gas • With no water, oil or drug splashing • With no electromagnetic field nearby • With no radiations nearby

▶ Working envelope (unit: mm)

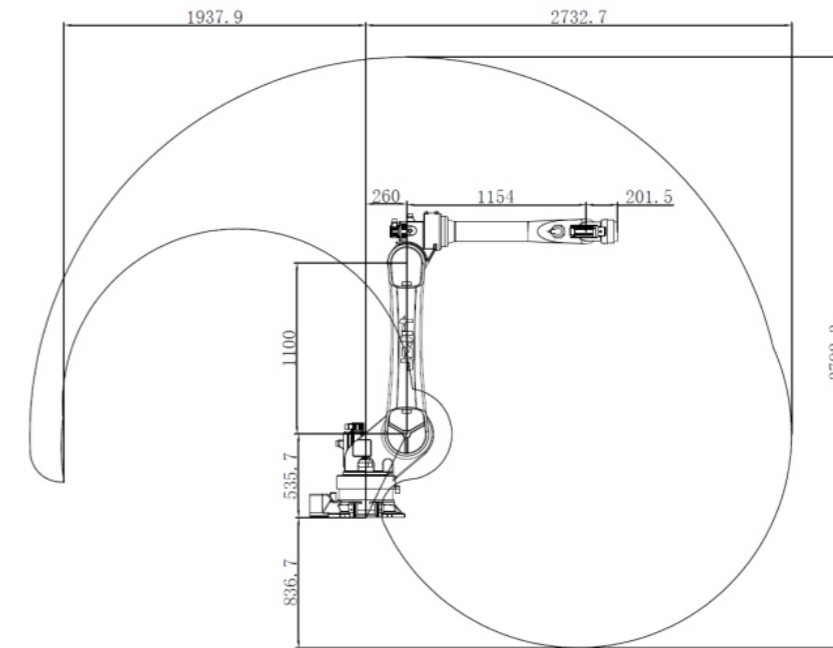

▶ Flange and base dimensions (unit: mm)

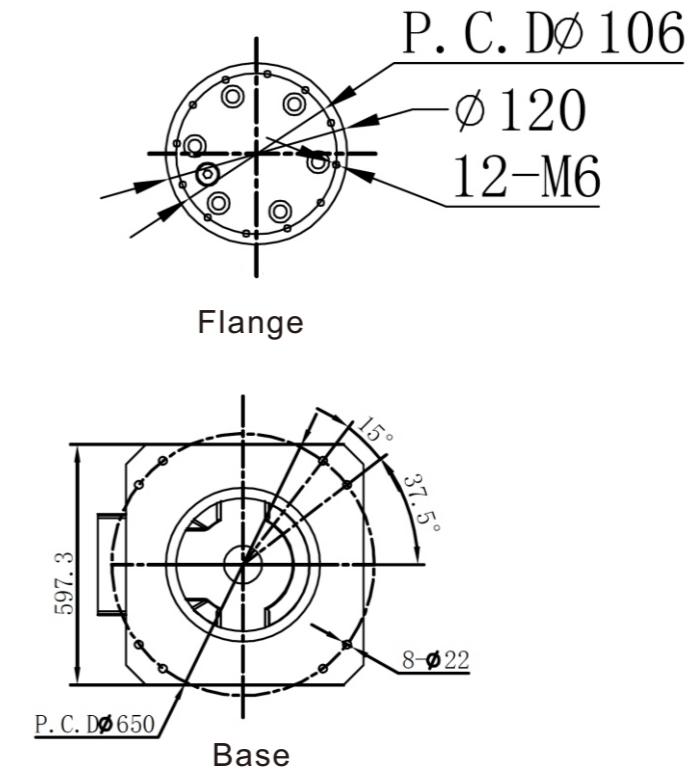

All data, drawings and specifications provided in this catalog are purely for information purposes and do not constitute a guarantee of these characteristics. The extent of goods delivered and services performed is determined by the subject matter of the specific contract. No liability accepted for errors or omissions.



6-AXIS HANDLING ROBOT

YSRT100-270

Special long-stroke design.
Suitable for pick-n-place and palletizing.

Robot specifications

Basic data	
Model No.	YSRT100-270
Number of axes	6
Maximum payload	50 kg
Maximum stroke	1700mm
IP class	J1, J2, J3, J4, J5, J6 - IP56
Mounting position	Floor type
Approx. weight	615 kg (without cabinet)
Repeatability	±0.15 mm
Internal air duct	Φ10
Motion range	
J1 axis S	±165°
J2 axis L	+80°~-90°
J3 axis U	+105°~-75°
J4 axis R	±180°
J5 axis B	+98°~-90°
J6 axis T	±360°
Speed with rated payload	
J1 axis S	127°/s
J2 axis L	70°/s
J3 axis U	74.5°/s
J4 axis R	137°/s
J5 axis B	99°/s
J6 axis T	222°/s

Electrical cabinet specifications	
Dimensions	560*500*730mm
Approx. weight	80KG
Cooling method	Natural cooling
Input power	380VAC 50/60Hz
Grounding	Industrial grounding (grounding resistance below 100Ω)
I/O terminals	<ul style="list-style-type: none"> • 16 digital inputs • 16 digital outputs • 2 analog outputs (optional)
Position control mode	EtherCAT, TCP/IP
Serial port I/F	RS485*1, RS422*1, RS232*1, CAN*1, USB*1
RAM capacity	JOB 200,000 steps, 10,000 robot commands (200MB)
Driving unit	6-axis AC servo system. External axis can be added as an option.

Operating conditions	
Use temperature	0~45°C
Storage temperature	-20~60°C
Humidity	10~90% RH, no condensing
Vibrations	Below 0.5G
Altitude	Below 1000m. (Degrade if over 1000m, max 2000m)
Other requirements	<ul style="list-style-type: none"> • With no corrosive or combustible gas • With no water, oil or drug splashing • With no electromagnetic field nearby • With no radiations nearby

▶ Working envelope (unit: mm)

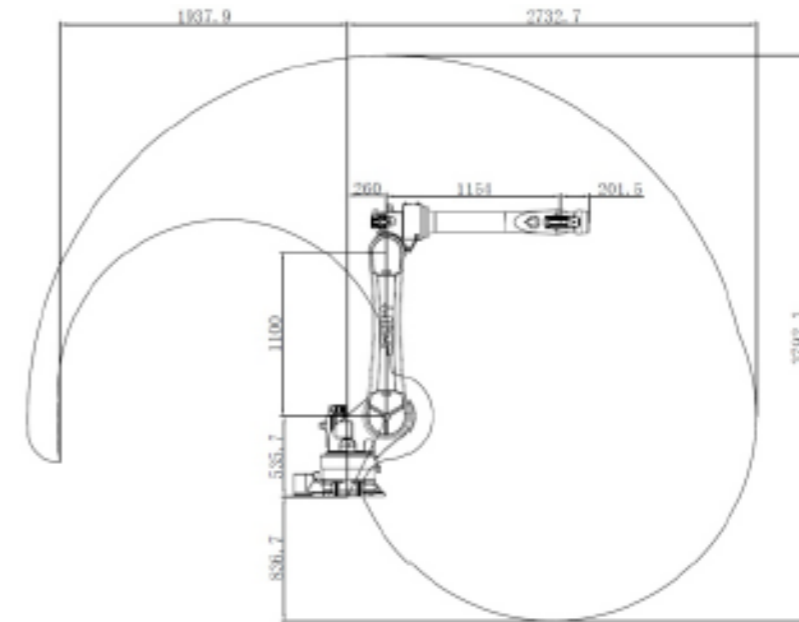

▶ Flange and base dimensions (unit: mm)

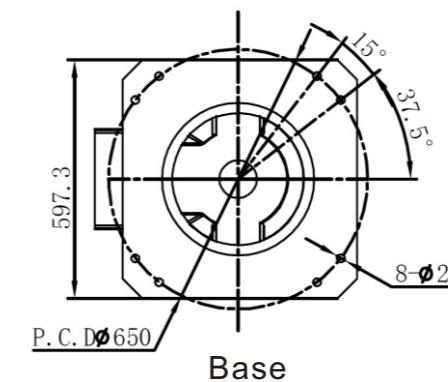
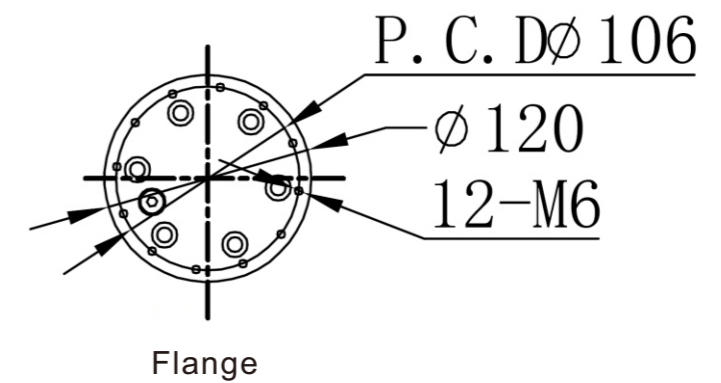

All data, drawings and specifications provided in this catalog are purely for information purposes and do not constitute a guarantee of these characteristics. The extent of goods delivered and services performed is determined by the subject matter of the specific contract. No liability accepted for errors or omissions.

6-AXIS HANDLING ROBOT

YS-F120R2230

Heavy duty, fast and accurate.
Suitable for pick-n-place, machine tending, palletizing, polishing, glue dispensing and painting.



Robot specifications

Basic data	
Model No.	YS-F120R2230
Number of axes	6
Maximum payload	120 kg
Maximum stroke	2230mm
IP class	J1, J2 - IP56; J3, J4, J5, J6- IP67
Mounting position	Floor type
Approx. weight	700 kg (without cabinet)
Repeatability	±0.06 mm
Internal air duct	Φ10
Motion range	
J1 axis S	±185°
J2 axis L	+154°~-65°
J3 axis U	+170°~-80°
J4 axis R	±360°
J5 axis B	±120°
J6 axis T	±360°
Speed with rated payload	
J1 axis S	130°/s
J2 axis L	110°/s
J3 axis U	120°/s
J4 axis R	170°/s
J5 axis B	170°/s
J6 axis T	250°/s

Electrical cabinet specifications	
Dimensions	560*500*800mm
Approx. weight	80KG
Cooling method	Natural cooling
Input power	380VAC 50/60Hz
Grounding	Industrial grounding (grounding resistance below 100Ω)
I/O terminals	<ul style="list-style-type: none"> • 16 digital inputs • 16 digital outputs • 2 analog outputs (optional)
Position control mode	EtherCAT, TCP/IP
Serial port I/F	RS485*1, RS422*1, RS232*1, CAN*1, USB*1
RAM capacity	JOB 200,000 steps, 10,000 robot commands (200MB)
Driving unit	6-axis AC servo system. External axis can be added as an option.

Operating conditions	
Use temperature	0~45°C
Storage temperature	-20~60°C
Humidity	10~90% RH, no condensing
Vibrations	Below 0.5G
Altitude	Below 1000m. (Degrade if over 1000m, max 2000m)
Other requirements	<ul style="list-style-type: none"> • With no corrosive or combustible gas • With no water, oil or drug splashing • With no electromagnetic field nearby • With no radiations nearby

▶ Working envelope (unit: mm)

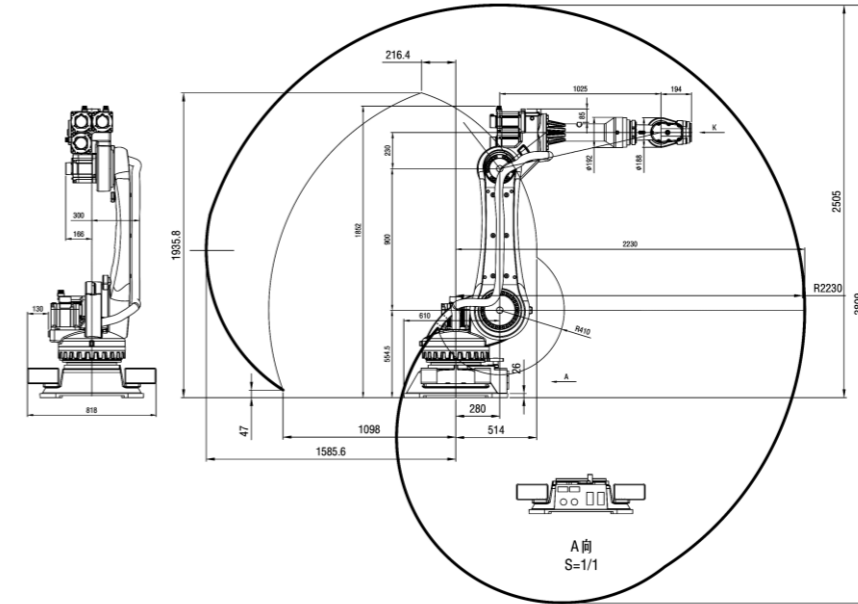

▶ Flange and base dimensions (unit: mm)

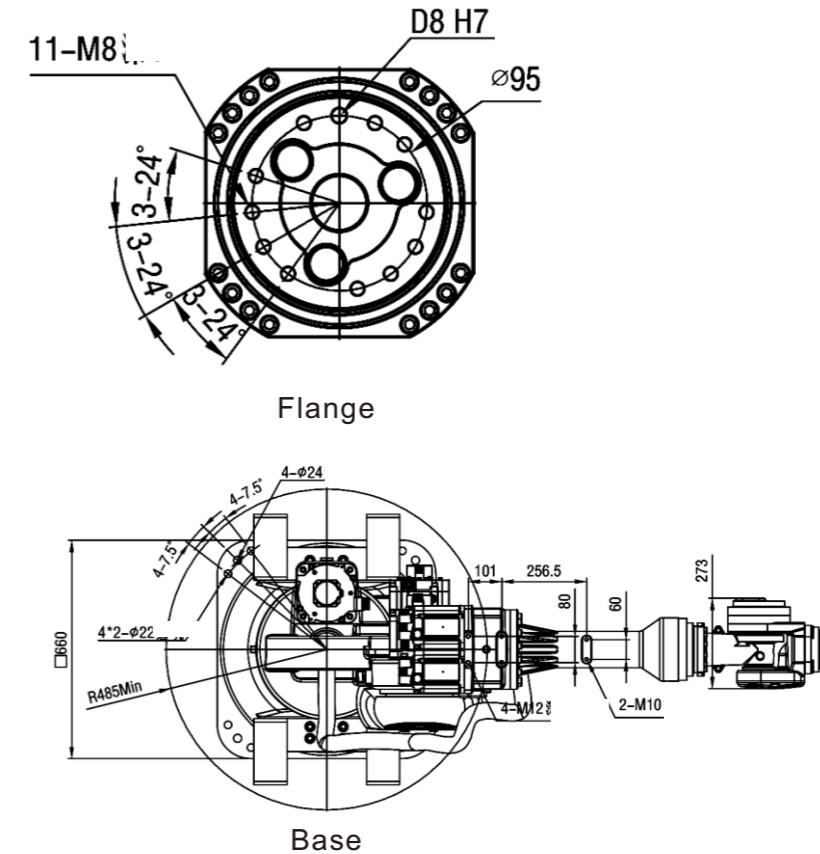

All data, drawings and specifications provided in this catalog are purely for information purposes and do not constitute a guarantee of these characteristics. The extent of goods delivered and services performed is determined by the subject matter of the specific contract. No liability accepted for errors or omissions.



6-AXIS HANDLING ROBOT YS-F210R2700

Top class heavy duty. Powerful, fast and accurate.
Suitable for pick-n-place, machine tending, palletizing,
polishing, glue dispensing and painting.

Robot specifications

Basic data	
Model No.	YS-F210R2700
Number of axes	6
Maximum payload	210 kg
Maximum stroke	2700mm
IP class	J1, J2 - IP56; J3, J4, J5, J6- IP67
Mounting position	Floor type
Approx. weight	1130 kg (without cabinet)
Repeatability	±0.06 mm
Internal air duct	Φ10
Motion range	
J1 axis S	±185°
J2 axis L	+85°~-50°
J3 axis U	+210°~-65°
J4 axis R	±350°
J5 axis B	±125°
J6 axis T	±350°
Speed with rated payload	
J1 axis S	123°/s
J2 axis L	115°/s
J3 axis U	112°/s
J4 axis R	179°/s
J5 axis B	172°/s
J6 axis T	219°/s

Electrical cabinet specifications	
Dimensions	560*500*800mm
Approx. weight	100KG
Cooling method	Natural cooling
Input power	380VAC 50/60Hz
Grounding	Industrial grounding (grounding resistance below 100Ω)
I/O terminals	<ul style="list-style-type: none"> • 16 digital inputs • 16 digital outputs • 2 analog outputs (optional)
Position control mode	EtherCAT, TCP/IP
Serial port I/F	RS485*1, RS422*1, RS232*1, CAN*1, USB*1
RAM capacity	JOB 200,000 steps, 10,000 robot commands (200MB)
Driving unit	6-axis AC servo system. External axis can be added as an option.

Operating conditions	
Use temperature	0~45°C
Storage temperature	-20~60°C
Humidity	10~90% RH, no condensing
Vibrations	Below 0.5G
Altitude	Below 1000m. (Degrade if over 1000m, max 2000m)
Other requirements	<ul style="list-style-type: none"> • With no corrosive or combustible gas • With no water, oil or drug splashing • With no electromagnetic field nearby • With no radiations nearby

▶ Working envelope (unit: mm)

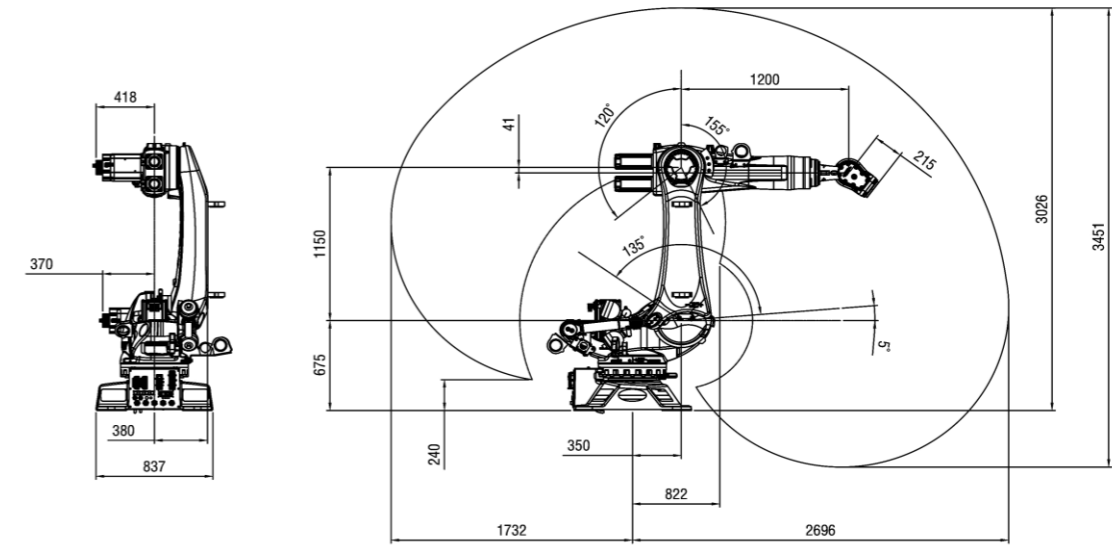

▶ Flange and base dimensions (unit: mm)

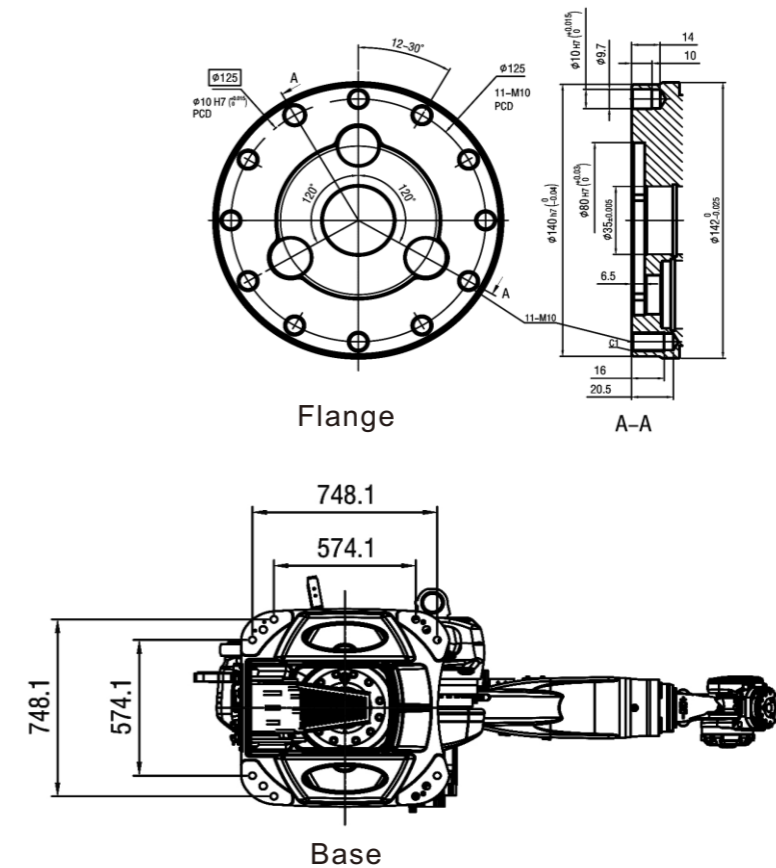

All data, drawings and specifications provided in this catalog are purely for information purposes and do not constitute a guarantee of these characteristics. The extent of goods delivered and services performed is determined by the subject matter of the specific contract. No liability accepted for errors or omissions.



4-AXIS HANDLING ROBOT

YS10B-1400

Fast, accurate and reliable.
Suitable for pick-n-place and palletizing.

Robot specifications

Basic data	
Model No.	YS10B-1400
Number of axes	4
Maximum payload	12 kg
Maximum stroke	1400mm
IP class	J1, J2 - IP56; J3, J4- IP67
Mounting position	Floor type
Approx. weight	165 kg (without cabinet)
Repeatability	±0.08 mm
Internal air duct	Φ10
Motion range	
J1 axis S	±170°
J2 axis L	+80°~-32°
J3 axis U	+20°~-90°
J4 axis R	±360°
Speed with rated payload	
J1 axis S	223°/s
J2 axis L	173°/s
J3 axis U	300°/s
J4 axis R	481°/s

Electrical cabinet specifications	
Dimensions	490*400*365mm
Approx. weight	40KG
Cooling method	Natural cooling
Input power	220VAC 50/60Hz
Grounding	Industrial grounding (grounding resistance below 100Ω)
I/O terminals	• 16 digital inputs • 16 digital outputs
Position control mode	EtherCAT, TCP/IP
Serial port I/F	RS485*1, RS422*1, RS232*1, CAN*1, USB*1
RAM capacity	JOB 200,000 steps, 10,000 robot commands (200MB)
Driving unit	6-axis AC servo system. External axis can be added as an option.

Operating conditions	
Use temperature	0~45°C
Storage temperature	-20~60°C
Humidity	10~90% RH, no condensing
Vibrations	Below 0.5G
Altitude	Below 1000m. (Degrade if over 1000m, max 2000m)
Other requirements	• With no corrosive or combustible gas • With no water, oil or drug splashing • With no electromagnetic field nearby • With no radiations nearby

▶ Working envelope (unit: mm)

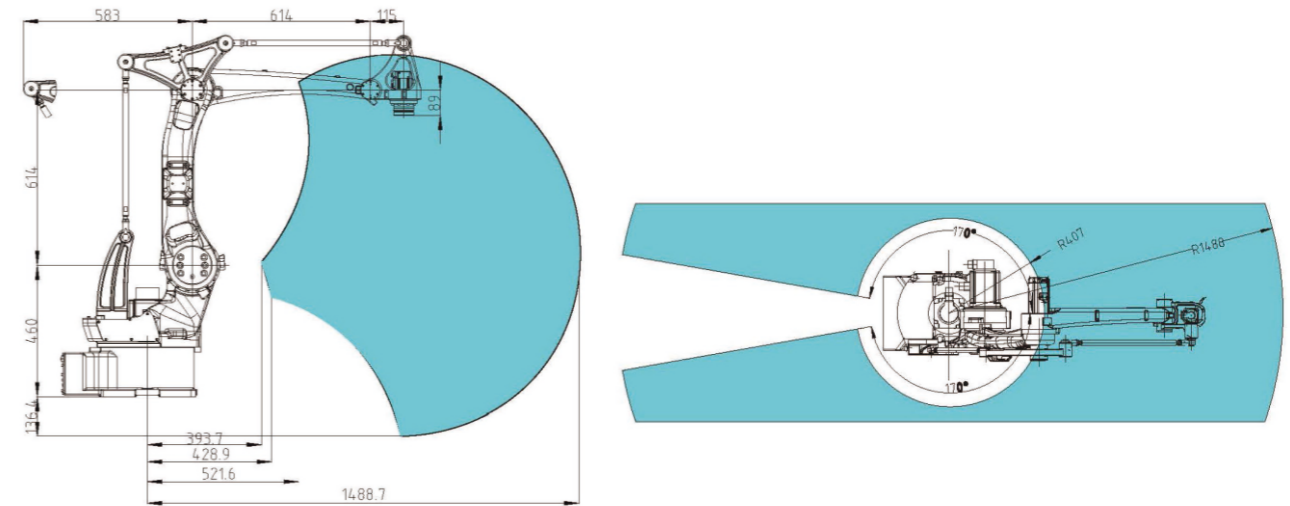

▶ Flange and base dimensions (unit: mm)

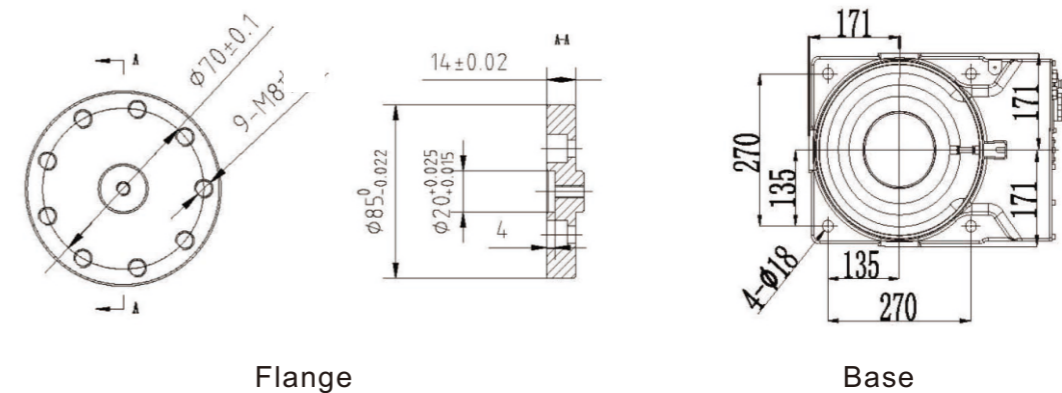

▶ Payload diagram

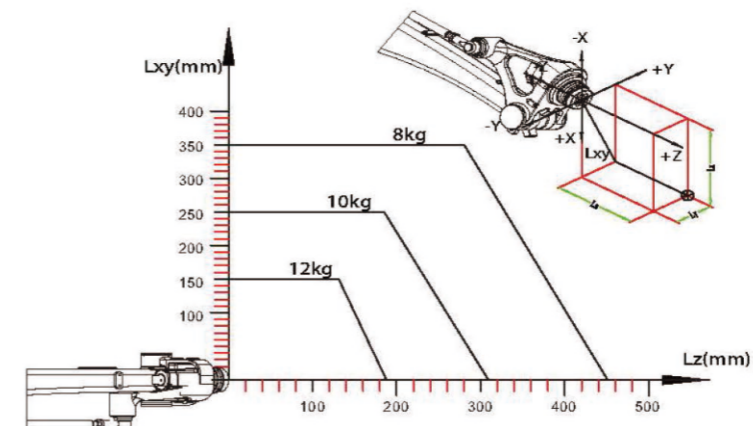

All data, drawings and specifications provided in this catalog are purely for information purposes and do not constitute a guarantee of these characteristics. The extent of goods delivered and services performed is determined by the subject matter of the specific contract. No liability accepted for errors or omissions.



4-AXIS HANDLING ROBOT

YS15B-1400

Fast, accurate and reliable.
Suitable for pick-n-place and palletizing.

Robot specifications

Basic data	
Model No.	YS15B-1800
Number of axes	4
Maximum payload	15 kg
Maximum stroke	1418mm
IP class	J1, J2 - IP56; J3, J4- IP67
Mounting position	Floor type
Approx. weight	170 kg (without cabinet)
Repeatability	±0.08 mm
Internal air duct	Φ10
Motion range	
J1 axis S	±140°
J2 axis L	+35°~-70°
J3 axis U	+75°~-70°
J4 axis R	±360°
Speed with rated payload	
J1 axis S	260°/s
J2 axis L	200°/s
J3 axis U	296°/s
J4 axis R	540°/s

Electrical cabinet specifications	
Dimensions	450*510*730mm
Approx. weight	40KG
Cooling method	Natural cooling
Input power	220VAC 50/60Hz
Grounding	Industrial grounding (grounding resistance below 100Ω)
I/O terminals	• 16 digital inputs • 16 digital outputs
Position control mode	EtherCAT, TCP/IP
Serial port I/F	RS485*1, RS422*1, RS232*1, CAN*1, USB*1
RAM capacity	JOB 200,000 steps, 10,000 robot commands (200MB)
Driving unit	6-axis AC servo system. External axis can be added as an option.

Operating conditions	
Use temperature	0~45°C
Storage temperature	-20~60°C
Humidity	10~90% RH, no condensing
Vibrations	Below 0.5G
Altitude	Below 1000m. (Degrade if over 1000m, max 2000m)
Other requirements	<ul style="list-style-type: none"> • With no corrosive or combustible gas • With no water, oil or drug splashing • With no electromagnetic field nearby • With no radiations nearby

▶ Working envelope (unit: mm)

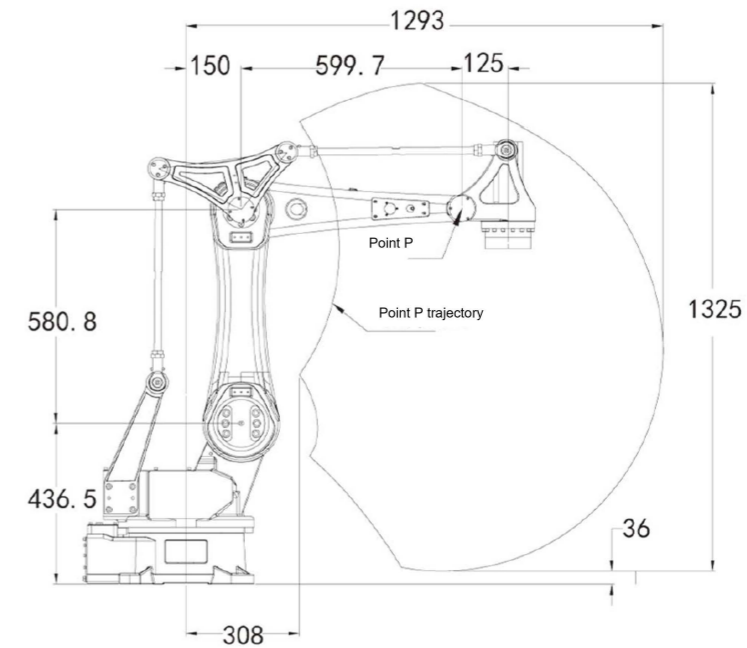

▶ Flange and base dimensions (unit: mm)

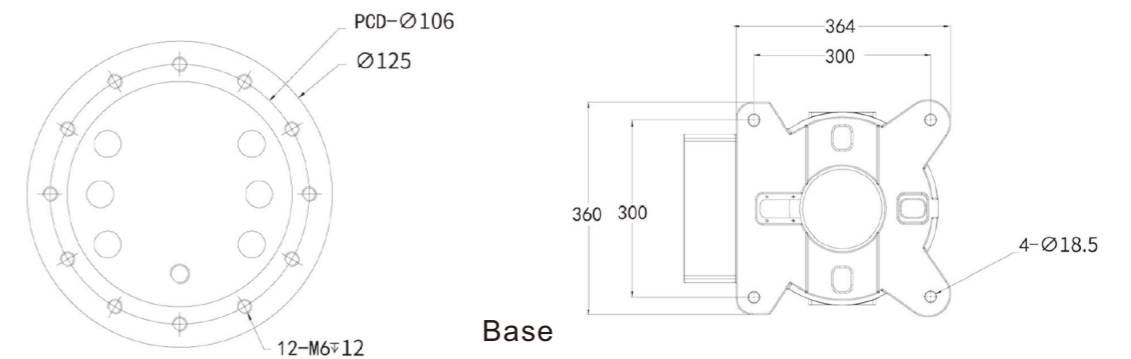

▶ Payload diagram

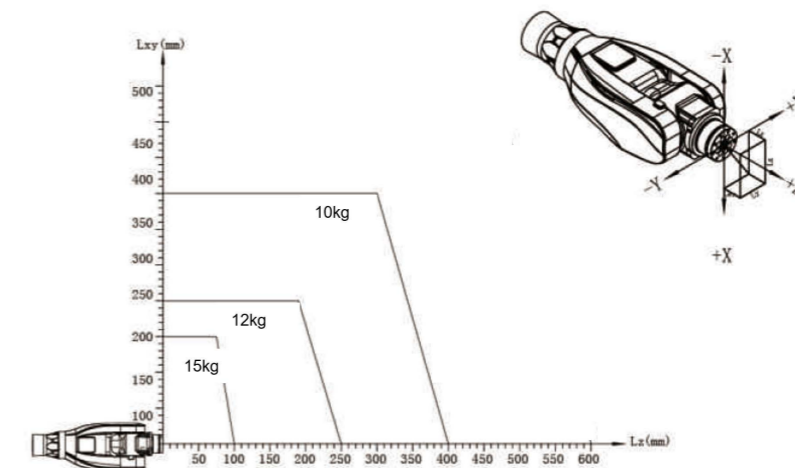

All data, drawings and specifications provided in this catalog are purely for information purposes and do not constitute a guarantee of these characteristics. The extent of goods delivered and services performed is determined by the subject matter of the specific contract. No liability accepted for errors or omissions.



4-AXIS HANDLING ROBOT

YS25B-1800

Fast, accurate and reliable.
Suitable for pick-n-place and palletizing.

Robot specifications

Basic data	
Model No.	YS25B-1800
Number of axes	4
Maximum payload	25 kg
Maximum stroke	1758mm
IP class	J1, J2 - IP56; J3, J4- IP67
Mounting position	Floor type
Approx. weight	295 kg (without cabinet)
Repeatability	±0.08 mm
Internal air duct	Φ10
Motion range	
J1 axis S	±130°
J2 axis L	+35°~-70°
J3 axis U	+75°~-70°
J4 axis R	±360°
Speed with rated payload	
J1 axis S	136°/s
J2 axis L	135°/s
J3 axis U	118°/s
J4 axis R	222°/s

Electrical cabinet specifications	
Dimensions	560*500*730mm
Approx. weight	50KG
Cooling method	Natural cooling
Input power	380VAC 50/60Hz
Grounding	Industrial grounding (grounding resistance below 100Ω)
I/O terminals	• 16 digital inputs • 16 digital outputs
Position control mode	EtherCAT, TCP/IP
Serial port I/F	RS485*1, RS422*1, RS232*1, CAN*1, USB*1
RAM capacity	JOB 200,000 steps, 10,000 robot commands (200MB)
Driving unit	6-axis AC servo system. External axis can be added as an option.

Operating conditions	
Use temperature	0~45°C
Storage temperature	-20~60°C
Humidity	10~90% RH, no condensing
Vibrations	Below 0.5G
Altitude	Below 1000m. (Degrade if over 1000m, max 2000m)
Other requirements	<ul style="list-style-type: none"> • With no corrosive or combustible gas • With no water, oil or drug splashing • With no electromagnetic field nearby • With no radiations nearby

▶ Working envelope (unit: mm)

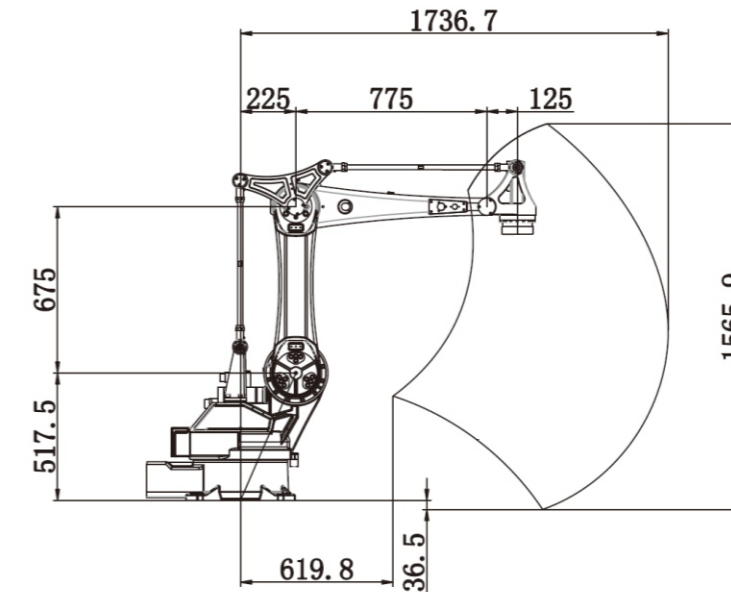

▶ Flange and base dimensions (unit: mm)

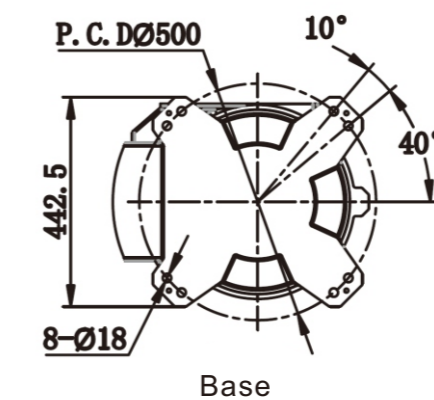
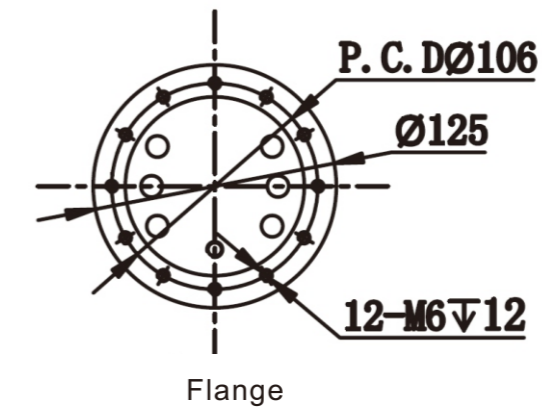

All data, drawings and specifications provided in this catalog are purely for information purposes and do not constitute a guarantee of these characteristics. The extent of goods delivered and services performed is determined by the subject matter of the specific contract. No liability accepted for errors or omissions.



4-AXIS HANDLING ROBOT

YS50B-2300

Fast, accurate and reliable.
Suitable for pick-n-place and palletizing.

Robot specifications

Basic data	
Model No.	YS50B-2300
Number of axes	4
Maximum payload	50 kg
Maximum stroke	2363mm
IP class	J1, J2 - IP56; J3, J4- IP67
Mounting position	Floor type
Approx. weight	615 kg (without cabinet)
Repeatability	±0.08 mm
Internal air duct	Φ10
Motion range	
J1 axis S	±150°
J2 axis L	+35°~-55°
J3 axis U	+60°~-50°
J4 axis R	±360°
Speed with rated payload	
J1 axis S	127°/s
J2 axis L	70°/s
J3 axis U	74.5°/s
J4 axis R	222°/s

Electrical cabinet specifications	
Dimensions	560*500*730mm
Approx. weight	55KG
Cooling method	Natural cooling
Input power	380VAC 50/60Hz
Grounding	Industrial grounding (grounding resistance below 100Ω)
I/O terminals	• 16 digital inputs • 16 digital outputs
Position control mode	EtherCAT, TCP/IP
Serial port I/F	RS485*1, RS422*1, RS232*1, CAN*1, USB*1
RAM capacity	JOB 200,000 steps, 10,000 robot commands (200MB)
Driving unit	6-axis AC servo system. External axis can be added as an option.

Operating conditions	
Use temperature	0~45°C
Storage temperature	-20~60°C
Humidity	10~90% RH, no condensing
Vibrations	Below 0.5G
Altitude	Below 1000m. (Degrade if over 1000m, max 2000m)
Other requirements	<ul style="list-style-type: none"> • With no corrosive or combustible gas • With no water, oil or drug splashing • With no electromagnetic field nearby • With no radiations nearby

▶ Working envelope (unit: mm)

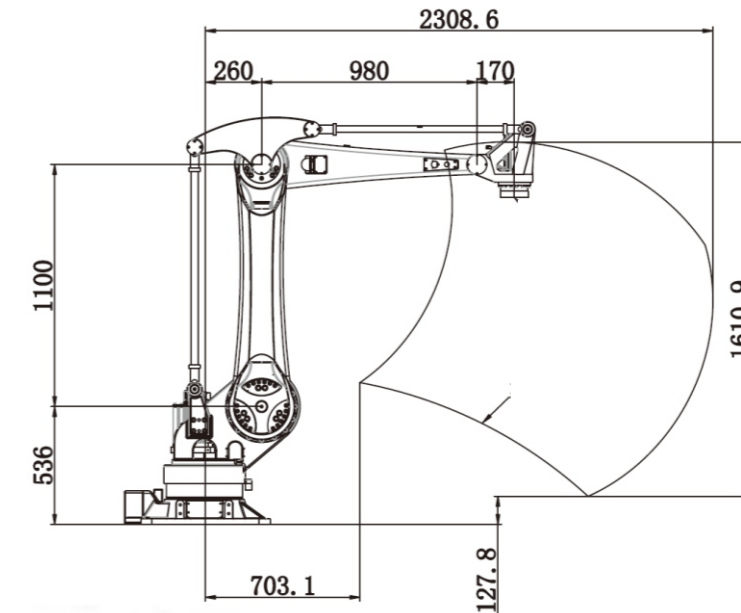

▶ Flange and base dimensions (unit: mm)

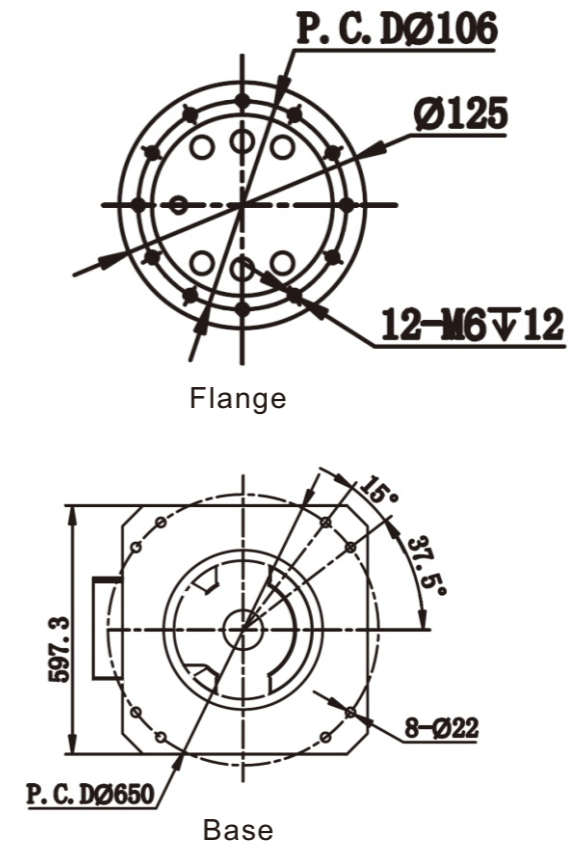

All data, drawings and specifications provided in this catalog are purely for information purposes and do not constitute a guarantee of these characteristics. The extent of goods delivered and services performed is determined by the subject matter of the specific contract. No liability accepted for errors or omissions.



4-AXIS HANDLING ROBOT

YSRT100B-230

Fast, accurate and reliable.
Suitable for pick-n-place and palletizing.

Robot specifications

Basic data	
Model No.	YSRT100B-230
Number of axes	4
Maximum payload	100 kg
Maximum stroke	2363mm
IP class	J1, J2 - IP56; J3, J4- IP67
Mounting position	Floor type
Approx. weight	630 kg (without cabinet)
Repeatability	±0.08 mm
Internal air duct	Φ10
Motion range	
J1 axis S	±150°
J2 axis L	+35°~-55°
J3 axis U	+60°~-50°
J4 axis R	±360°
Speed with rated payload	
J1 axis S	127°/s
J2 axis L	70°/s
J3 axis U	74.5°/s
J4 axis R	222°/s

Electrical cabinet specifications	
Dimensions	560*500*730mm
Approx. weight	55KG
Cooling method	Natural cooling
Input power	380VAC 50/60Hz
Grounding	Industrial grounding (grounding resistance below 100Ω)
I/O terminals	• 16 digital inputs • 16 digital outputs
Position control mode	EtherCAT, TCP/IP
Serial port I/F	RS485*1, RS422*1, RS232*1, CAN*1, USB*1
RAM capacity	JOB 200,000 steps, 10,000 robot commands (200MB)
Driving unit	6-axis AC servo system. External axis can be added as an option.

Operating conditions	
Use temperature	0~45°C
Storage temperature	-20~60°C
Humidity	10~90% RH, no condensing
Vibrations	Below 0.5G
Altitude	Below 1000m. (Degrade if over 1000m, max 2000m)
Other requirements	<ul style="list-style-type: none"> • With no corrosive or combustible gas • With no water, oil or drug splashing • With no electromagnetic field nearby • With no radiations nearby

▶ Working envelope (unit: mm)

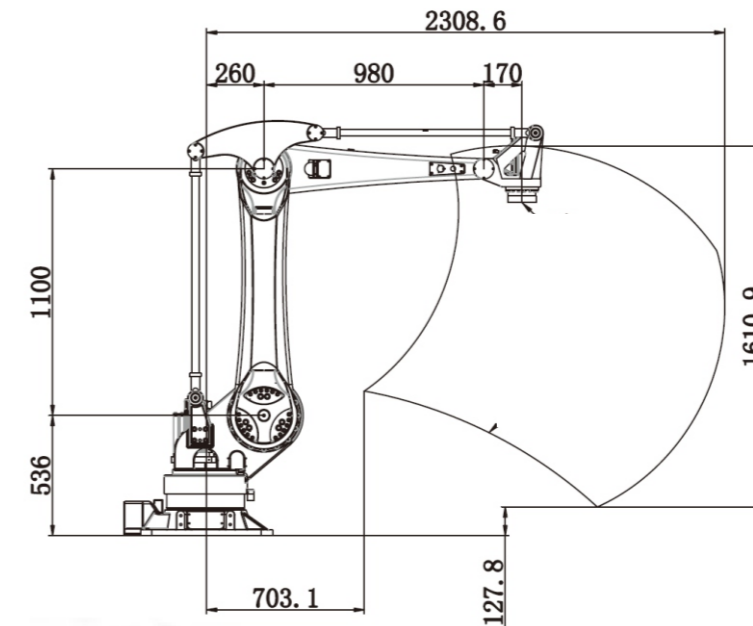

▶ Flange and base dimensions (unit: mm)

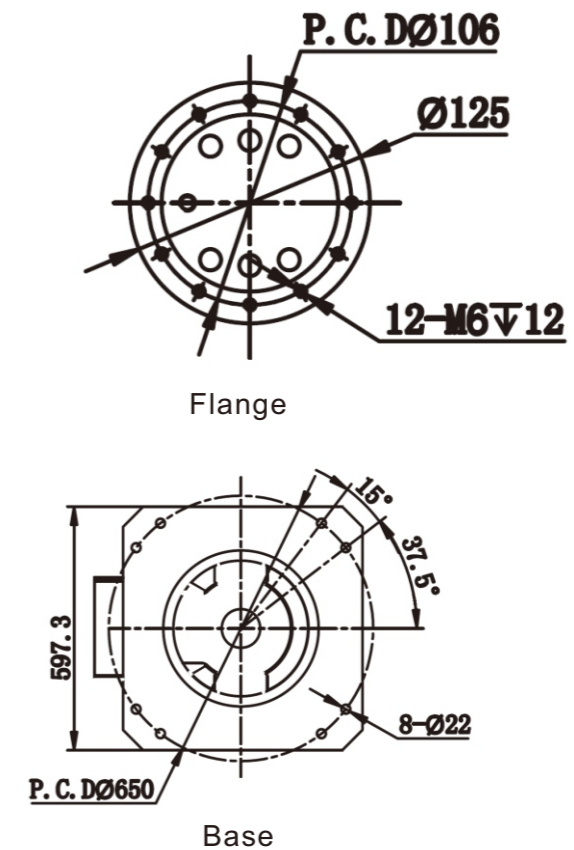

All data, drawings and specifications provided in this catalog are purely for information purposes and do not constitute a guarantee of these characteristics. The extent of goods delivered and services performed is determined by the subject matter of the specific contract. No liability accepted for errors or omissions.

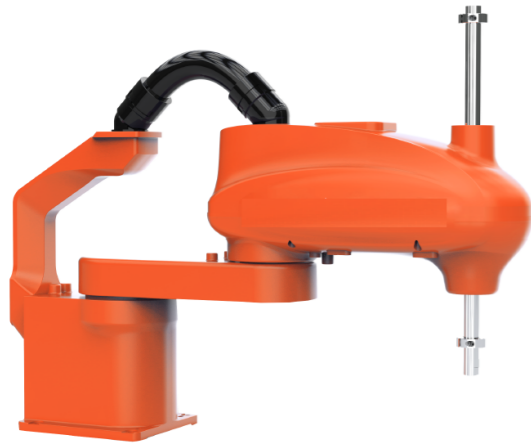

SCARA ROBOT

YS06-502S/602S/702S

Fast, accurate and reliable.
Suitable for pick-n-place of 3C industry.

Robot specifications

Basic data	
Model No.	YS06-502S/602S/702S
Number of axes	4
Maximum payload	6 kg
Maximum stroke	500/600/700mm
IP class	J1, J2 - IP56; J3, J4- IP67
Mounting position	Floor type
Approx. weight	30 kg (without cabinet)
Repeatability	±0.02 mm
Internal air duct	Φ6
Motion range	
J1 axis S	±132°
J2 axis L	±150°
J3 axis U	220mm
J4 axis R	±360°
Speed with rated payload	
J1 axis S	540°/s
J2 axis L	600°/s
J3 axis U	750°/s
J4 axis R	1717°/s

Electrical cabinet specifications	
Dimensions	490*400*365mm
Approx. weight	40KG
Cooling method	Natural cooling
Input power	220VAC 50/60Hz
Grounding	Industrial grounding (grounding resistance below 100Ω)
I/O terminals	<ul style="list-style-type: none"> • 16 digital inputs • 16 digital outputs • 2 analog outputs (optional)
Position control mode	EtherCAT, TCP/IP
Serial port I/F	RS485*1, RS422*1, RS232*1, CAN*1, USB*1
RAM capacity	JOB 200,000 steps, 10,000 robot commands (200MB)
Driving unit	6-axis AC servo system. External axis can be added as an option.

Operating conditions	
Use temperature	0~45°C
Storage temperature	-20~60°C
Humidity	10~90% RH, no condensing
Vibrations	Below 0.5G
Altitude	Below 1000m. (Degrade if over 1000m, max 2000m)
Other requirements	<ul style="list-style-type: none"> • With no corrosive or combustible gas • With no water, oil or drug splashing • With no electromagnetic field nearby • With no radiations nearby

▶ Working envelope (unit: mm)

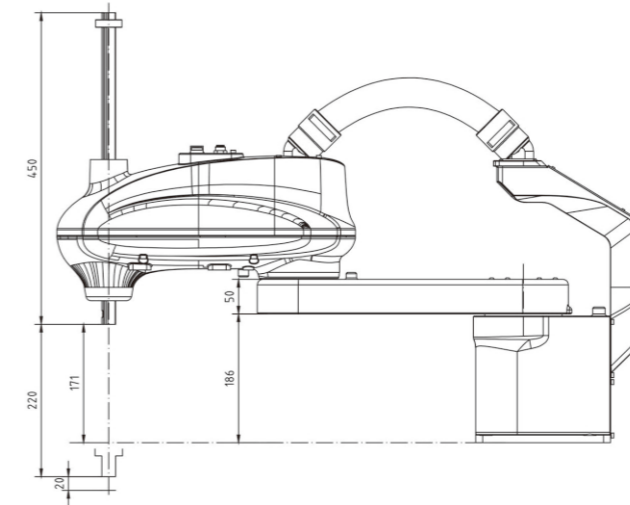

▶ Flange and base dimensions (unit: mm)

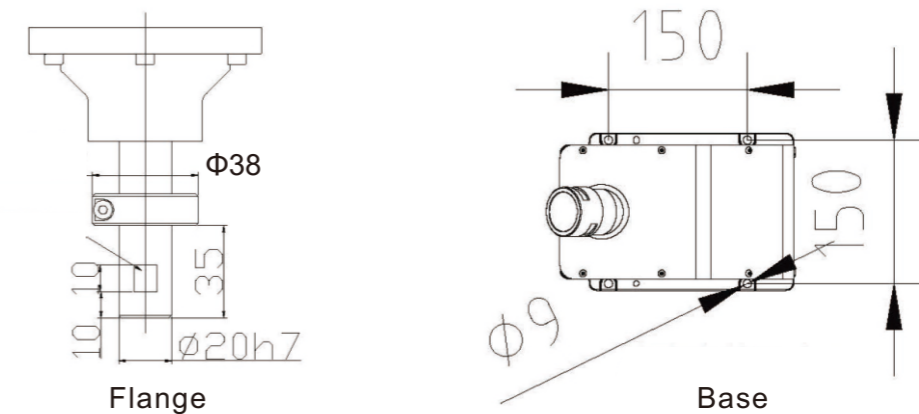

▶ Payload diagram

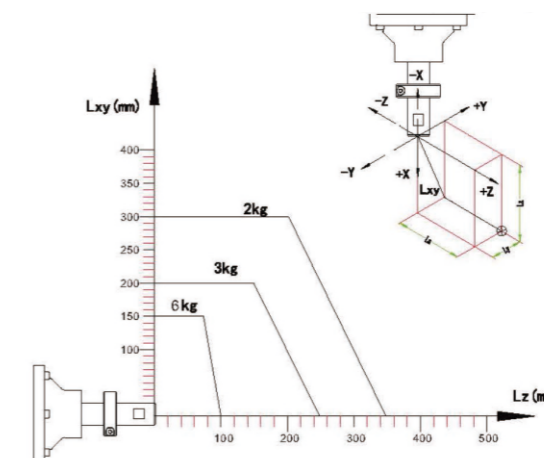

All data, drawings and specifications provided in this catalog are purely for information purposes and do not constitute a guarantee of these characteristics. The extent of goods delivered and services performed is determined by the subject matter of the specific contract. No liability accepted for errors or omissions.