

SIX IN A SQUARE

WHERE 60 DEGREES
MEETS 90 DEGREES

An easy trim down method for making
six-pointed stars that finish as a square

Use one tool from start to finish

Plays well with other quilt blocks

10 Sizes: 3"-12"



MADE IN
THE USA

Six in a Square[®] Tool Overview

The Six in a Square[®] Tool is designed to make 60 degree angled units that are sewn together without any Y seams to create a 6 pointed star in a square. The completed blocks are slightly oversized and trimmed to perfection with the same tool. It is versatile enough to make 10 different finished size blocks from 3" to 12" and comes with illustrated step by step instructions for both left and right handed quilters. The blocks can then be incorporated into one of your favorite designs, with other traditional blocks, or in one of our patterns. The possibilities are endless!

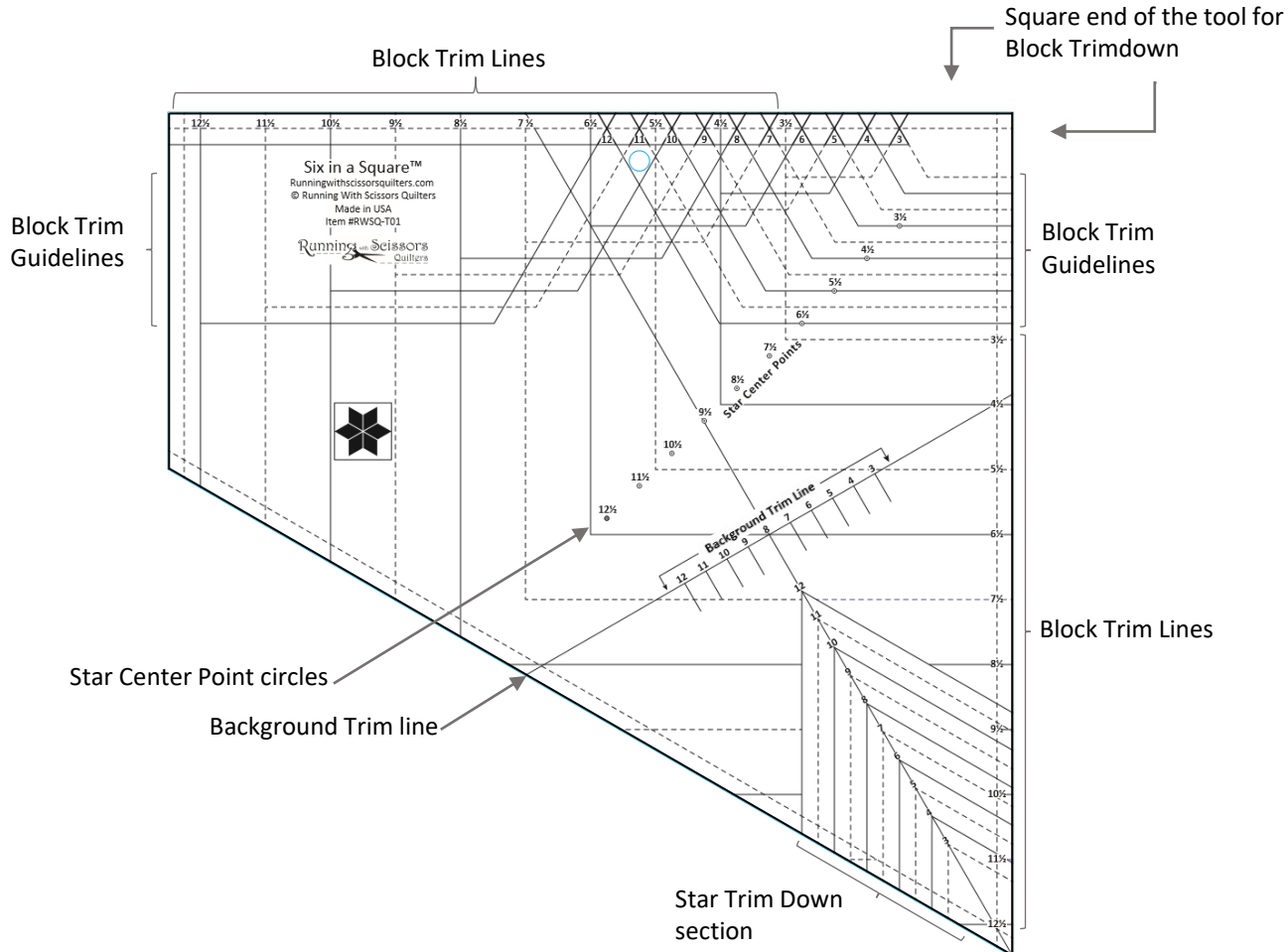

OVERVIEW

The Six in a Square[®] is made from three unit types (shown below). The finished block consists of two of each of these three units.

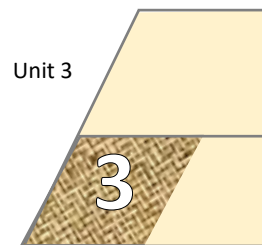
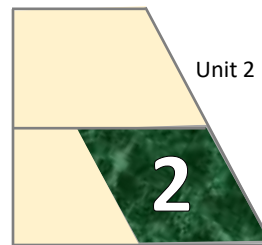
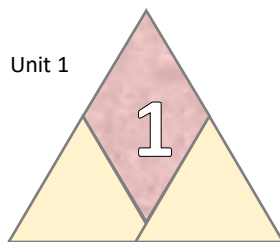
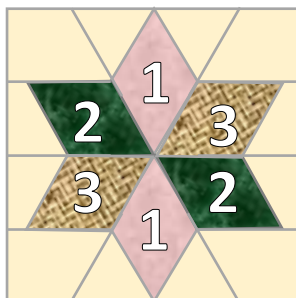

SIZING CHART

Finished Block Size	Cut Block Size	Star Point Strip Width	Number of Star Points per WOF	Background Strip Width Unit 1	Unit 1 Background Triangle Pairs per WOF	Background Strip Width Units 2 & 3	Sub-cut Background Rectangles Units 2 & 3	Unit 2 & 3 Background Rectangles per WOF
3	3½"	1½"	21	2"	17	1½"	1½" x 3½"	11
4	4½"	1¾"	20	2¼"	14	1¾"	1¾" x 4"	10
5	5½"	2"	17	2½"	14	2"	2" x 4½"	8
6	6½"	2¼"	14	2¾"	12	2¼"	2¼" x 5"	8
7	7½"	2½"	14	3"	11	2½"	2½" x 5½"	7
8	8½"	2¾"	12	3¼"	10	2¾"	2¾" x 6"	6
9	9½"	3"	11	3½"	10	3"	3" x 6½"	6
10	10½"	3¼"	10	3¾"	9	3¼"	3¼" x 7"	5
11	11½"	3½"	9	4"	8	3½"	3½" x 7½"	5
12	12½"	3¾"	9	4¼"	8	3¾"	3¾" x 8"	5

Star Points

- 1) Place a star point strip(s) on your cutting mat. Align the edge of the strip with the $\frac{1}{4}$ " line on the edge of the Six in a Square[®] tool. Cut near the edge of the strip to begin cutting star points.
- 2) Rotate the strip(s). Using a standard ruler, cut 3 pairs of star points the same width as the star point strip width as listed in the sizing chart. If making multiple colors, do this for all colors of the star points.

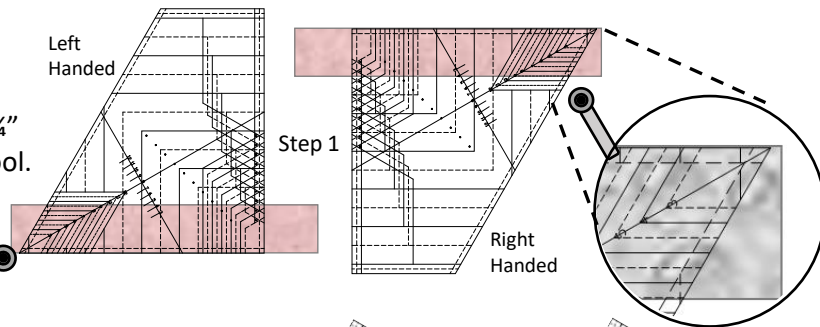

Unit 1 Background

- 3) Locate the appropriately sized background strip for Unit 1. Refer to the diagram and align the Background Trim Line with the edge of the strip. Right handers align the trim line to the top of the strip. Left handers align to the bottom of the strip. Make the first cut for the background triangle.
- 4) Rotate the Six in a Square[®] tool and realign the Background Trim Line. Align the Background Trim Line with the bottom of the background strip and the edge of the tool with the first background triangle cut made in step 3. Left handers should align the Background Trim Line with the top of the strips. Cut to complete Unit 1 background triangles.
- 5) Repeat steps 3 and 4 as needed to make the required number of background triangles for your project. Four background triangles are required per block.

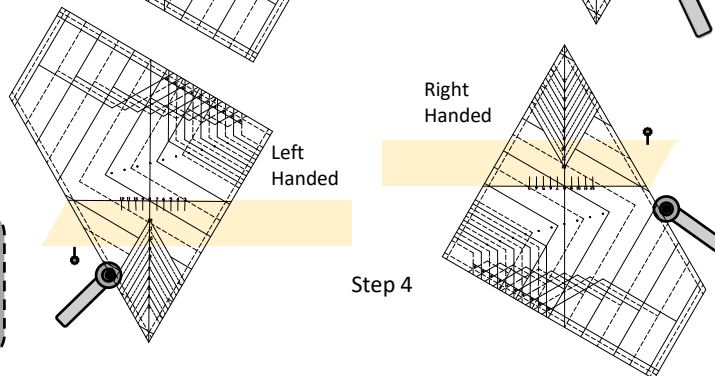
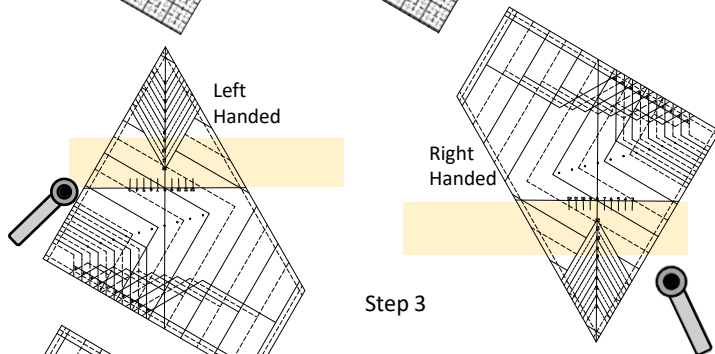
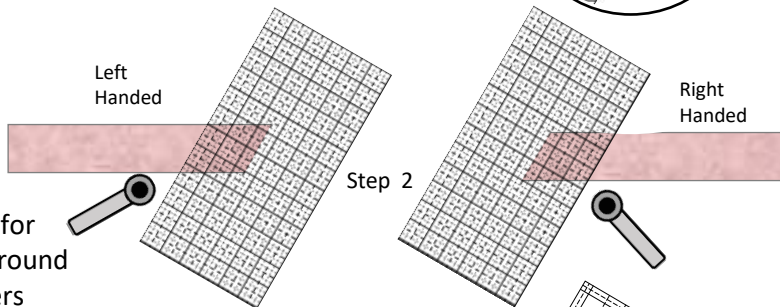

 **Mark the Straight Edge:** After each cut, mark the straight of the grain on the background triangles with a pin or marking tool.



Unit 1 Assembly

- 6) Refer to the diagram and orient a star point vertically. Align a background triangle, right sides together, with a $\frac{1}{4}$ " overhang at the left side of the star point, assuring the straight of grain is on the right side. Stitch with a $\frac{1}{4}$ " seam.
- 7) Refer to the diagram and press the seam toward the star point.
- 8) Orient the star point/background unit vertically. Place a second background triangle, right sides together, on the bottom right side of the star point. Align the background triangle with a $\frac{1}{4}$ " overhang on the right side of the star point. Stitch with a $\frac{1}{4}$ " seam.
- 9) Press the seam toward second background triangle.
- 10) Repeat steps 6 – 9 to make the second Unit 1.

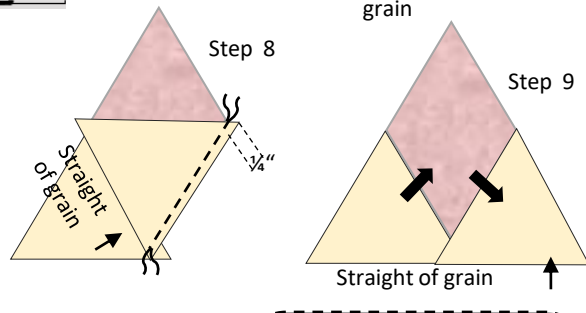
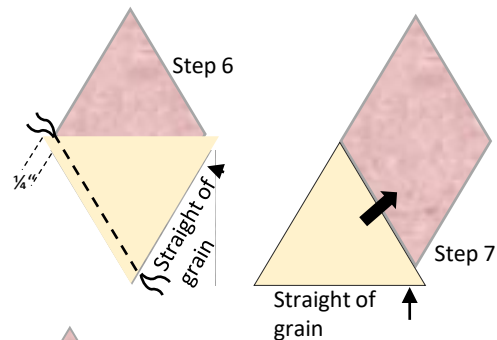
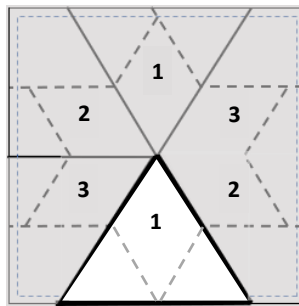

Unit 2 & 3 Background Pieces

- 11) Refer to the sizing chart and cut two (2) pairs of appropriately sized background rectangles for Units 2 & 3.
- 12) Place a pair of the rectangles right or wrong sides together. Use the Six in a Square[®] tool to cut the angle on the rectangles from Step 11 to make the background trapezoid pairs. Align the top of the rectangle with the number of the **finished** block size on the Background Trim Line. Cut along the edge of the tool creating trapezoid background pairs which will be two different sizes.

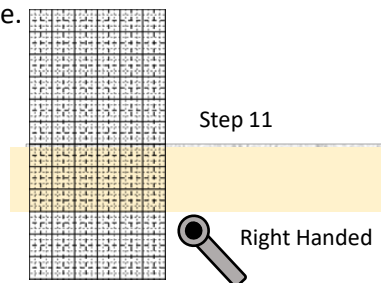

 **Press Carefully:**
Pressing unit 1 background triangles as shown in steps 7 & 9 allows all seams to nest when the block is fully assembled.

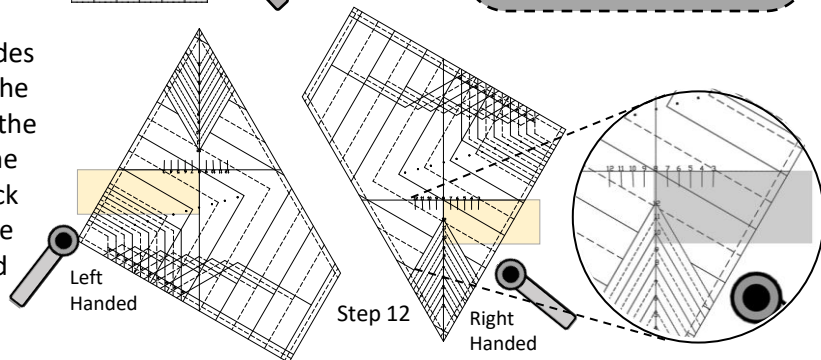

Unit 2 Assembly

- 13) Refer to the diagram and separate the trapezoid pairs with the larger on the left and the smaller on the right for each of Units 2 and Units 3.

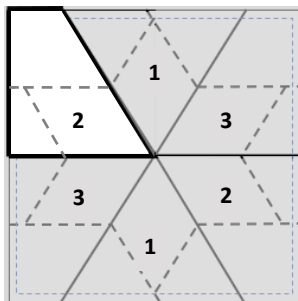

- 14) Set aside the trapezoid pairs for Unit 3. These will be used beginning with step 21.

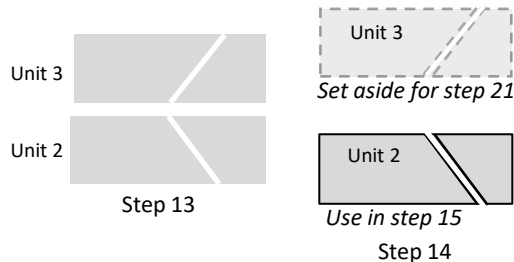

- 15) Arrange the Unit 2 trapezoid components by spinning the small trapezoid so it is positioned below the large.

- 16) Locate a star point from step 2. Orient the star point as shown placing the star point on top of the angled side of the small trapezoid, right sides together. Align the star point with the angled side of the trapezoid allowing a $\frac{1}{4}$ " offset at the top and bottom of the strip. Stitch the small trapezoid to the star point using a $\frac{1}{4}$ " seam.

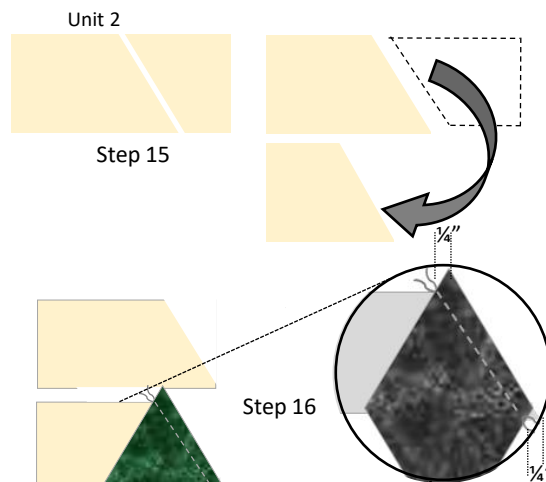

- 17) Refer to the diagram and press the seam toward the small trapezoid.
- 18) Place the large background trapezoid on top of the star point/small trapezoid combination offsetting by a $\frac{1}{4}$ " as shown, right sides together, and stitch using a $\frac{1}{4}$ " seam. **The square edges of the unit will not align and will be trimmed later.**

- 19) Press toward the star point/background unit created in step 16.

- 20) Repeat steps 15 to 19 to make the second Unit 2.

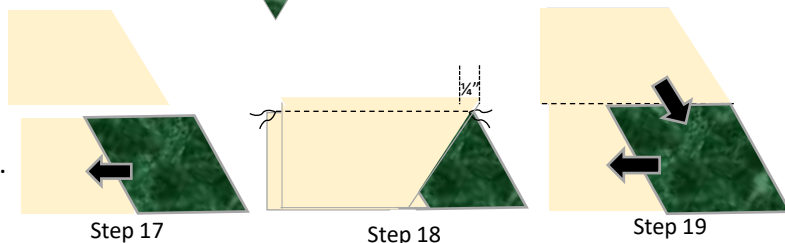

Unit 3 Assembly

- 21) Locate the Unit 3 trapezoids that were set aside in step 14. Arrange the Unit 3 trapezoids by spinning the large trapezoid above the small.

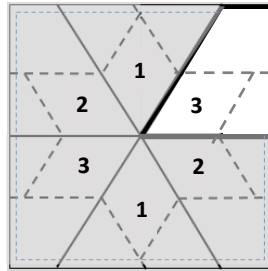

- 22) Locate a star point from step 2. Orient the star point as shown, placing the star point on top of the angled side of the small trapezoid, right sides together. Align the edge of the star point with the angled edge of the trapezoid, offsetting as in Unit 2. Stitch the small trapezoid to the star point using a $\frac{1}{4}$ " seam.

- 23) Refer to the diagram and press the seam toward the star point.

- 24) Place the large background trapezoid on top of the star point/small trapezoid combination, offsetting as in Unit 2, right sides together, and stitch using a $\frac{1}{4}$ " seam. **The square edges of the unit will not align and will be trimmed later.**

- 25) Refer to the diagram and press the seam toward the large trapezoid.

- 26) Repeat steps 21 to 25 to make the second unit 3.



- 27) Trim the star points of all units to an exact size using the Star Trim Down section of the Six in a Square[®] tool. Place the unit right side up and orient the star point as shown. Align the Star Trim Down line with the stitched seam lines for the finished block size. Trim along both sides of the tool for all 6 units.

Unit 3



Step 21

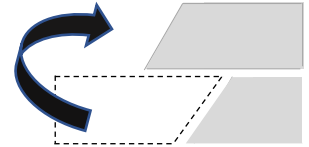

Unit 3

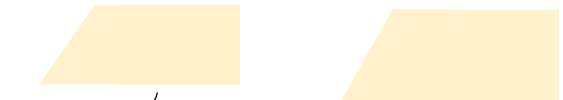

Step 22

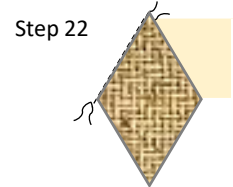

Step 23



Step 24

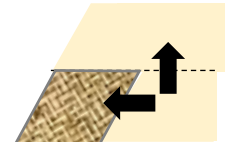

Step 25



The solid lines on the Six in a Square[®] tool indicate lines to be used for making even numbered finished sized blocks - 4", 6", 8", etc... the dashed lines will indicate lines to be used for making odd finished sized blocks - 3", 5", 7", etc...

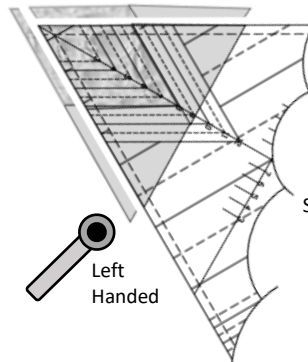

Left Handed

Step 27

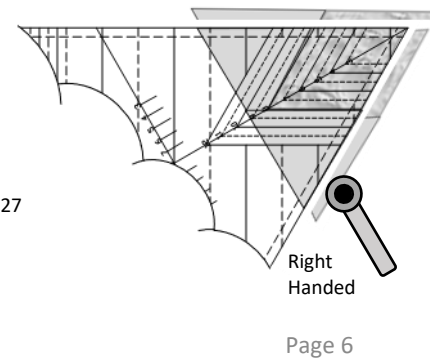

Right Handed

Star Assembly

- 28) Using the diagram to the right, position the six units as shown. The six pieced units will fit together perfectly in the center and have all seams nesting. The outside edges of the block will not align and will be trimmed In the Final Trim steps.
- 29) Units 1, 2, and 3, are stitched together to make a half star. Stich unit 1 and 2 together using a $\frac{1}{4}$ " seam. Press seams open.
- 30) Stitch unit 3 to the unit completed in Step 29 using a $\frac{1}{4}$ " seam to complete a half star. Press seams open.
- 31) Repeat steps 29 and 30 to complete the second half of the star.
- 32) Align the star point intersections and join the two half stars to make a whole star.

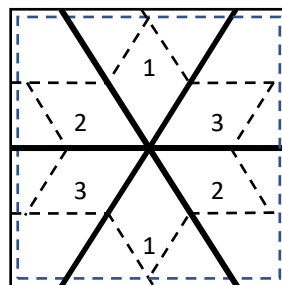

Step 28

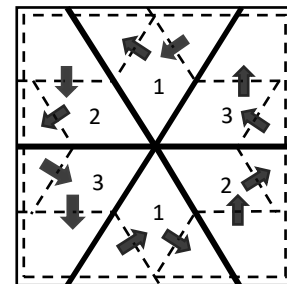

Pressing Arrows

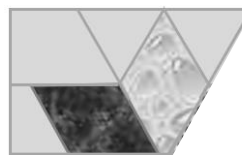

Step 29

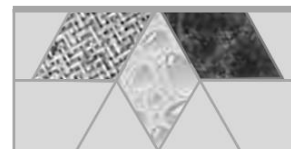
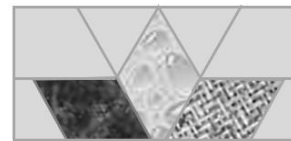

Steps 30 - 32

Final Block Trim Overview

The Six in a Square[®] tool has three groups of lines to check when trimming the final block. The lines for an 8" finished block are shown in bold on the tool image to the right.

- 1 Block Trim Lines, used to check the perimeter of the block.
- 2 Block Trim Guidelines, used to check the Unit 1 star point and Units 2 & 3 stitching lines.
- 3 Star Center Point Circles, used to locate the center of the completed block.

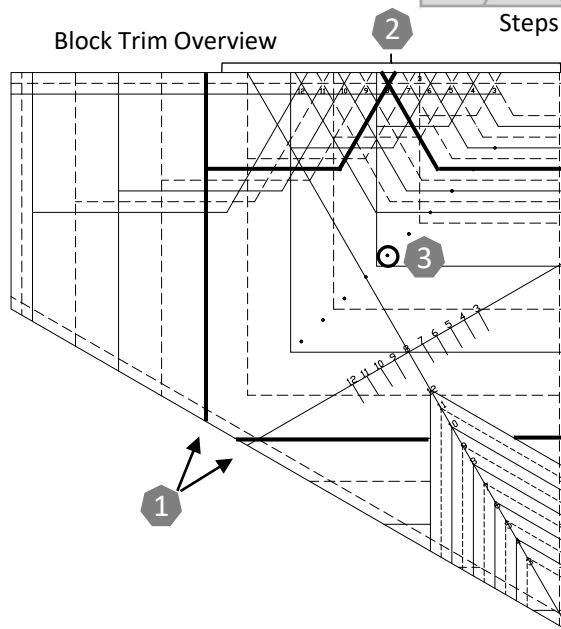

Right-handed trimming

- 33) Position the star block as shown with Unit 1 at the top. The outside edges of the block will be uneven. Left handers will position the star block with Unit 1 to the left as shown in the diagrams for Left Hand Trimming below.
- 34) Lay the Six in a Square[®] tool on top of the block, assuring the outside of the blocks fits within the Block Trim Lines.
- 35) Align the Trim Guidelines with the stitched lines of Units 2 and 3 and the Unit 1 star point with the "X" on the tool that matches your finished block size. Position the corresponding (cut size) Star Center Point circle on the tool over the center of the star block.

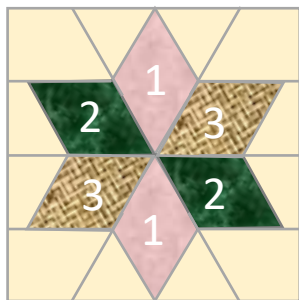

Step 33

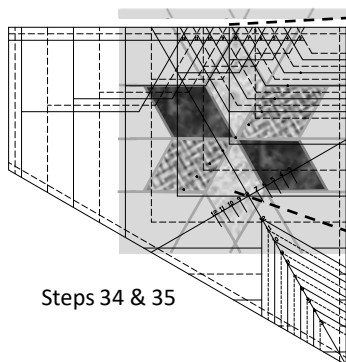

Steps 34 & 35

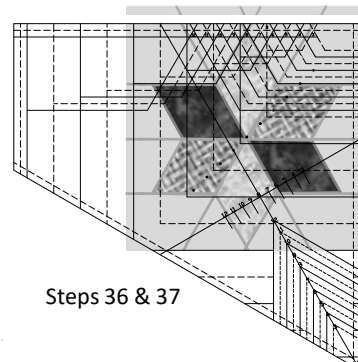
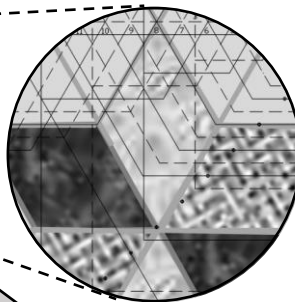

Steps 36 & 37

- 36) Rotate the block 180° and line up the Six in a Square[®] tool again. Align the trimmed edges from step 35 with the Block Trim Lines. Check that the "X", the trim guidelines and the Star Center Point circle align. Trim the two remaining sides to complete a precise square.
- 37) Trim the right and top edges as shown.

Images for Left-handed Trimming

 For Left Hand Trimming, rotate the block and tools 90° counter-clockwise. Then follow the right handed trimming instructions.

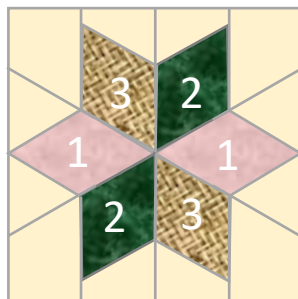

Step 33

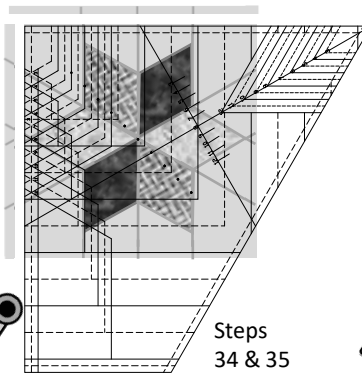

Steps
34 & 35

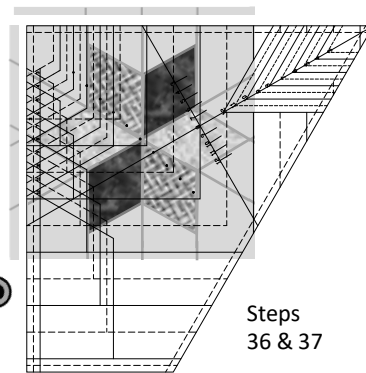

Steps
36 & 37

CROSSROADS

To make this Six in a Square sample wall hanging, construct units for eleven (11) 8" blocks. Refer to the diagram to assemble nine (9) full and four (4) half blocks.

Fabric Requirements

Star Points	¼ yard of 3 fabrics
Background	1¼ yards
Inner Border	½ yard
Outer Border / Binding	1¼ yards
Backing	3 yards

Cutting Chart

	Quantity	Cut Size
Quilt Center		
Blocks	9	8½"
Sashing	4	1½" X 28½"
Sashing	12	1½" X 8½"
Borders		
Half-blocks	4	4½" X 8½"
Inner border	4	4½" X 10½"
Inner border	4	4½" X 14½"
Outer Border	2	4½" X 36½"
Outer Border	2	4½" X 44½"

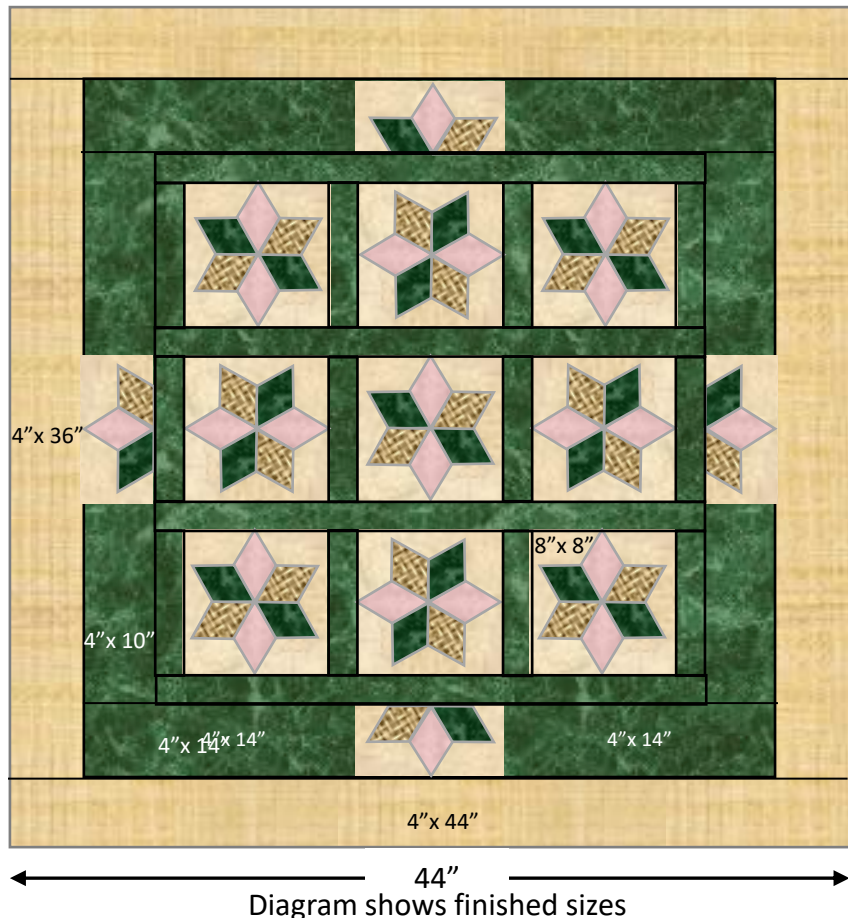

Thank you for purchasing the Six in a Square® tool.

We hope you enjoy using this tool as much as we have enjoyed creating it.

Please visit our website at RunningWithScissorsQuilters.com for our online video demonstration and view the exciting possibilities.

©2020 RunningWithScissorsQuilters.com

All rights reserved. Printed in USA