

Triple K Industries

True Tilt 5th Wheel Quick-Tach

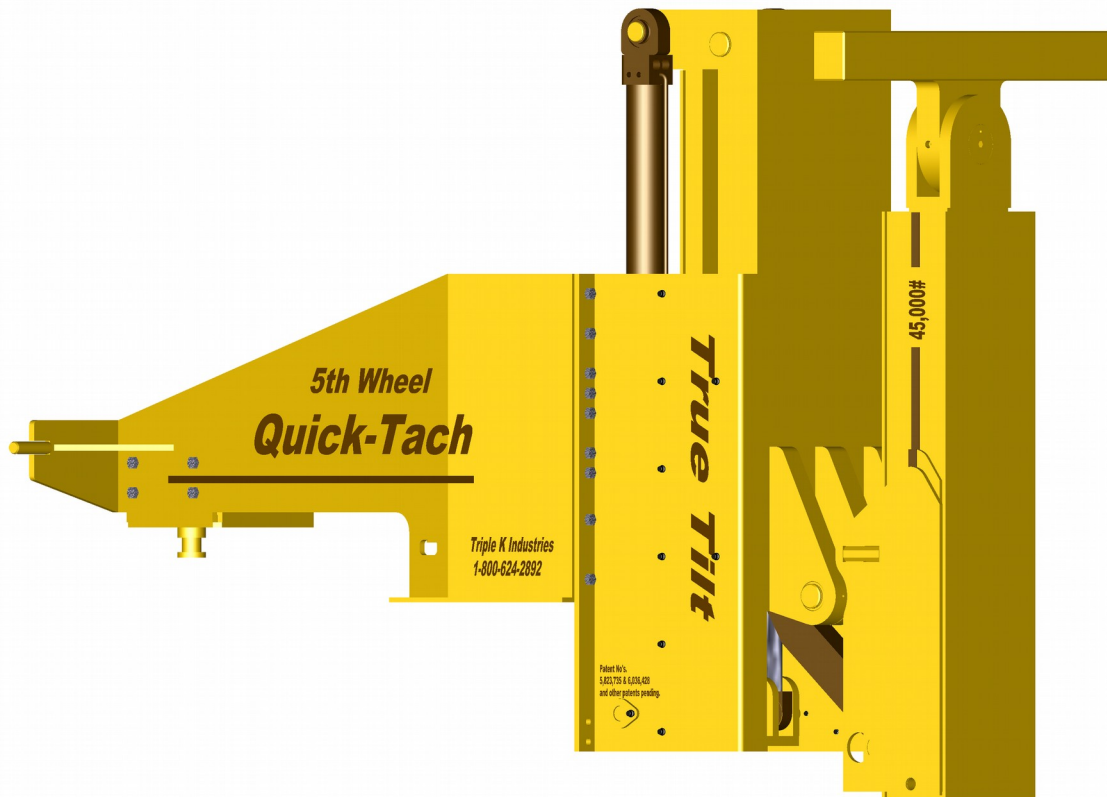

47219 W. Schweigers Circle #3
Sioux Falls, SD 57107
800-624-2892
www.triplekindustries.com

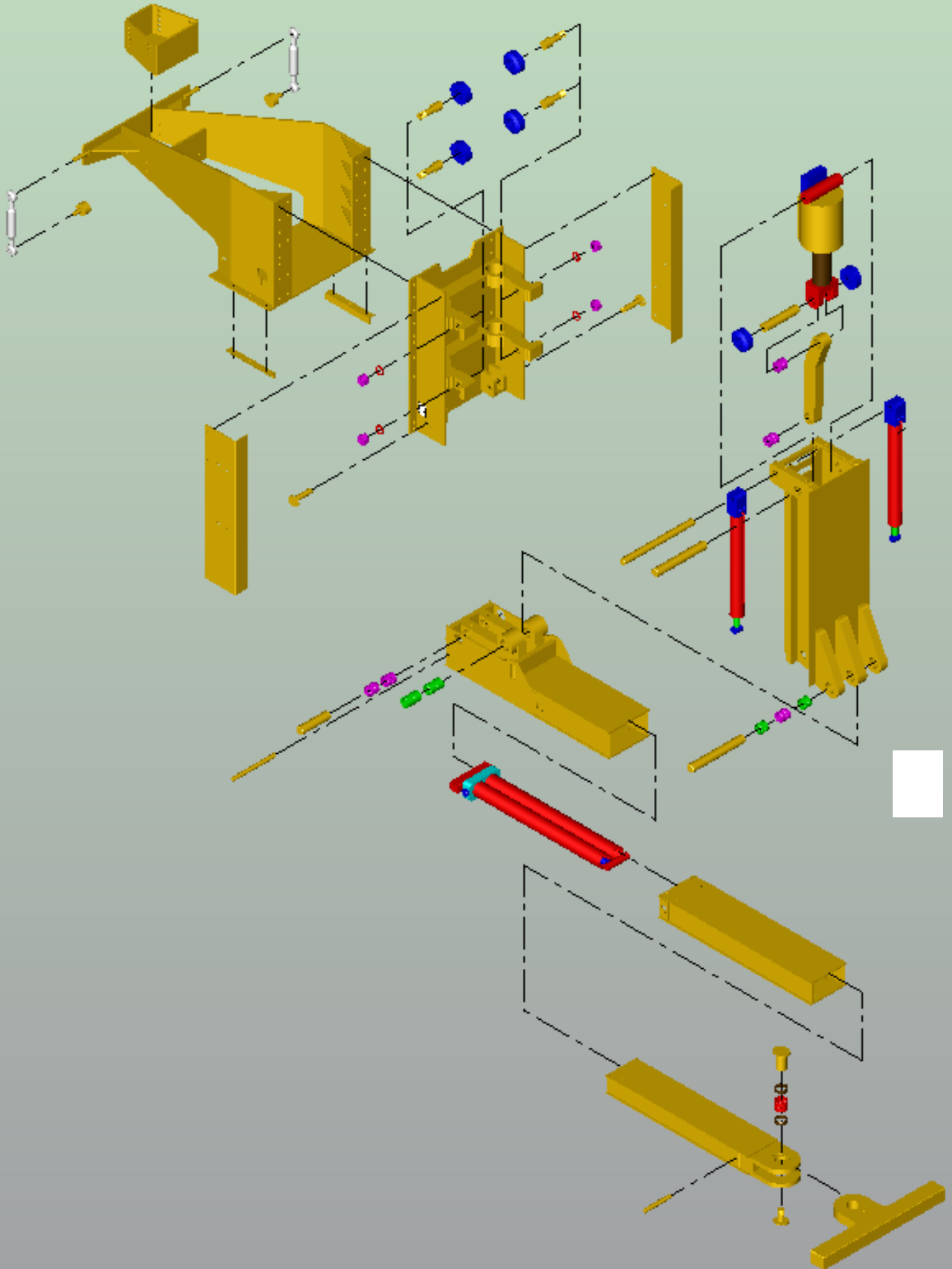

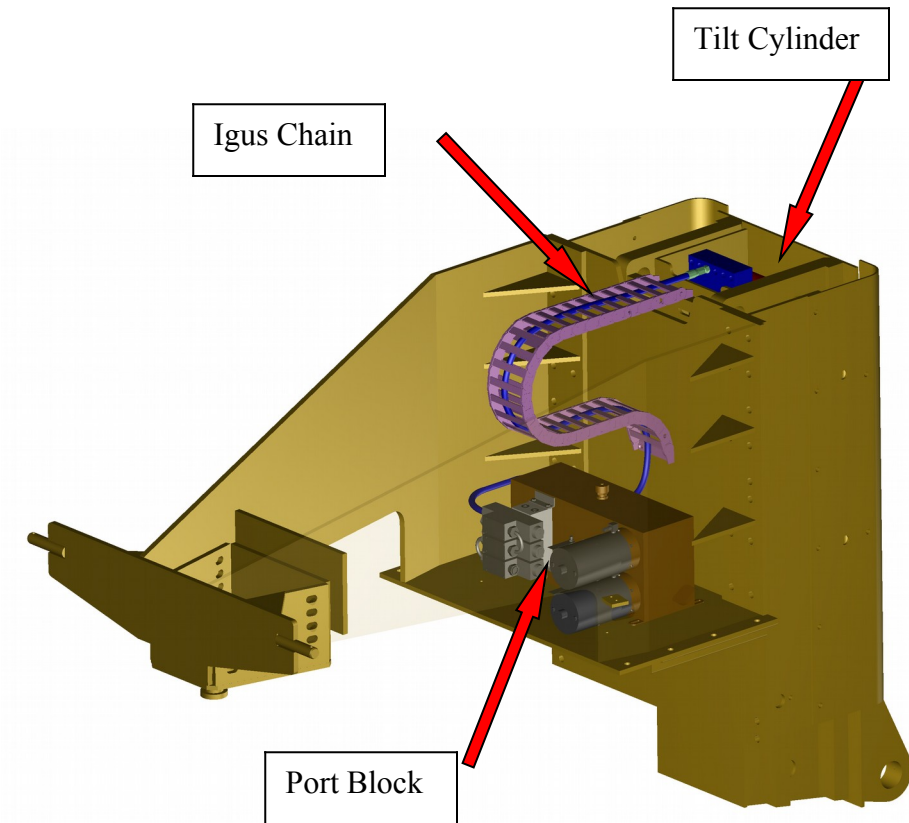

Install IGUS nylon chain as shown with 4 – 6 mm Flat Head Screws. Install 6 hydraulic hoses through the IGUS chain as shown per one.

Hint:

1. Install each end of IGUS chain. (Take off chain by prying apart with a flat screwdriver.)
2. Install one end of each hose to Tilt Cylinder.
3. Pass all 6 hoses through IGUS chain.
4. Snap chain into ends of chain.
5. Install loose end of hydraulic hoses to proper port in block

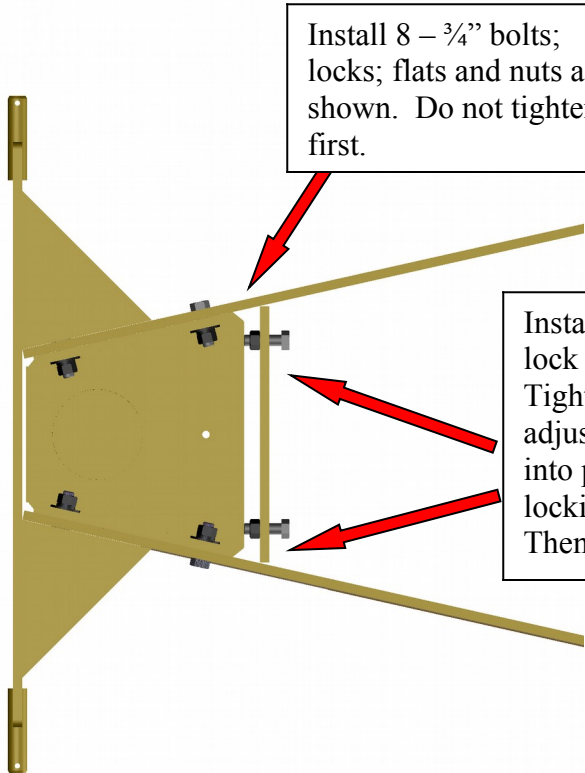

Install 8 – 3/4" bolts; locks; flats and nuts as shown. Do not tighten first.

Install 2 – 3/4" bolts; and lock nuts as shown. Tighten bolts to push adjustment box tightly into place. Tighten locking nuts. Then tighten the 8 bolts.

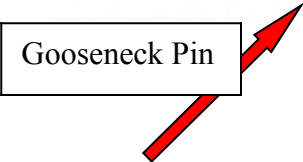

Adjust kingpin
"adjustment box"
so
gooseneck sets flat on
truck frame.

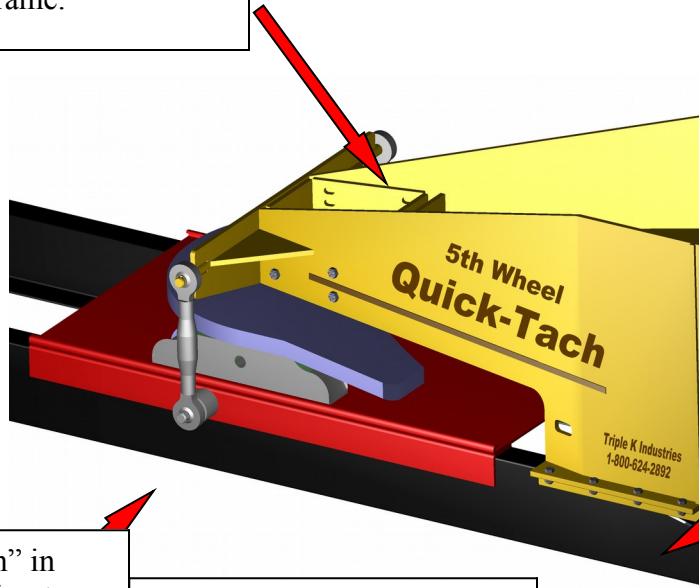

Attach "Side Angles" to
each side of gooseneck
only. Do not weld to
truck frame

Weld "bushing/pin" in
near vertical position to
top pin on gooseneck.
Weld as high as possible.

Recommend "low
hydrogen" type weld, 3/8"
bead all around bushing/pin.

Note: On some "slider
frames" it may be necessary
to grind edge of bushing/pin

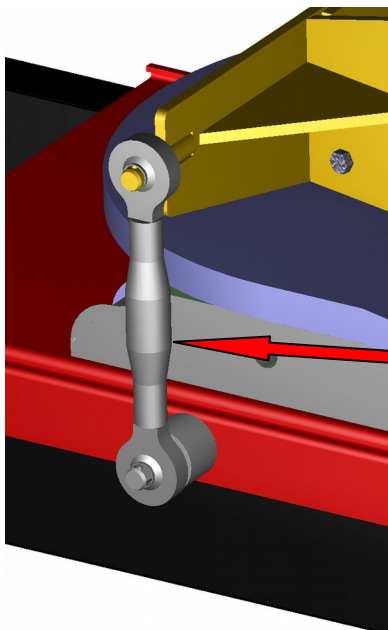

Hand tighten the turnbuckle
"link" on each side until
gooseneck "adjustment box"
is touching the 5th wheel
plate. Lock by hand
tightening the locking nut.

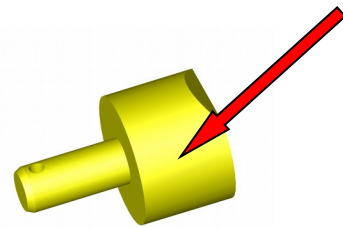

Adjust height as needed by using the hand crank.

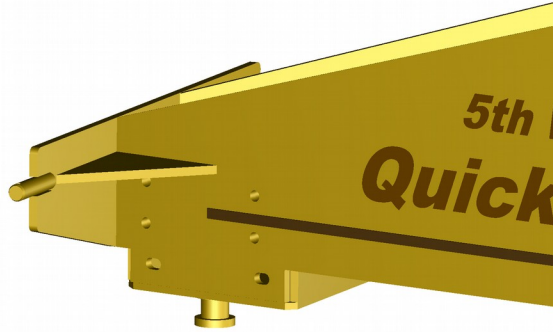

Install Jack Stands by sliding end of jack arm over gooseneck pin. Fasten by inserting lock pin through hole in jack arm and gooseneck pin.

Attach Jack with two lock pins. Jack arm can be rotated either way and use either set of holes in Jack to accommodate height.

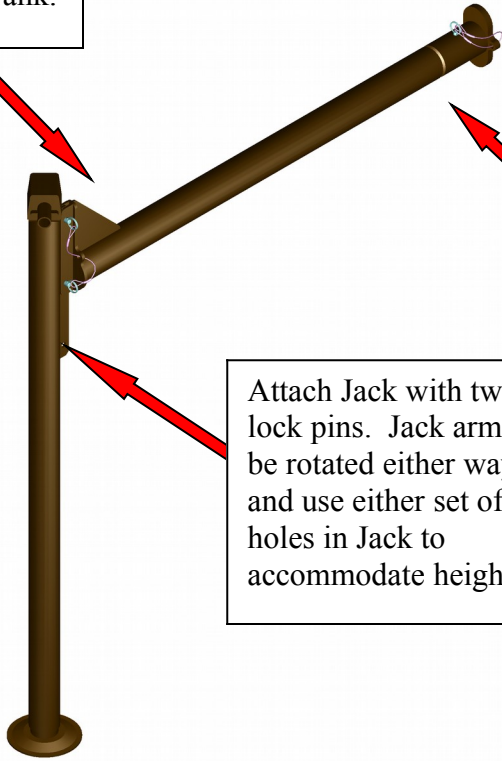

Wiring & Plumbing Diagrams for Elec/Hyd Pump and Wet Pac

Plumbing Diagram Tilt Cylinder Manifold

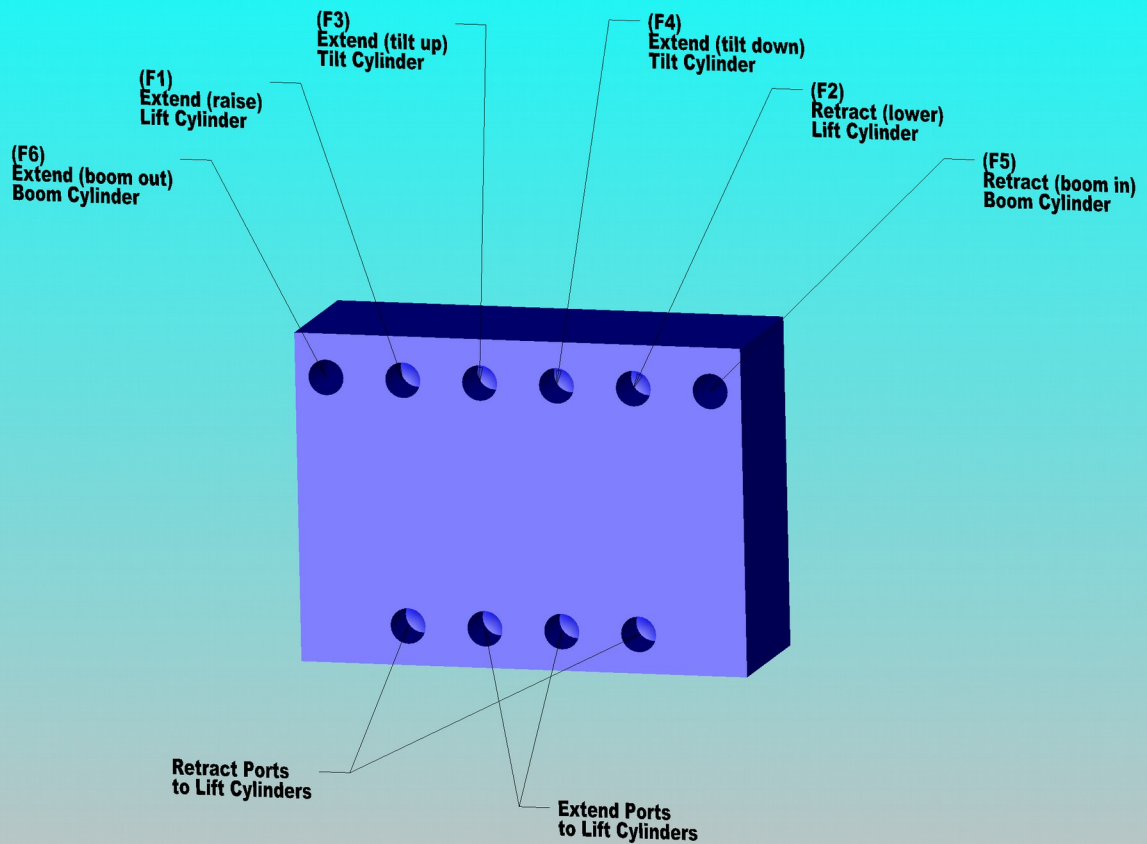

Plumbing

Elec/Hyd Pump Pac

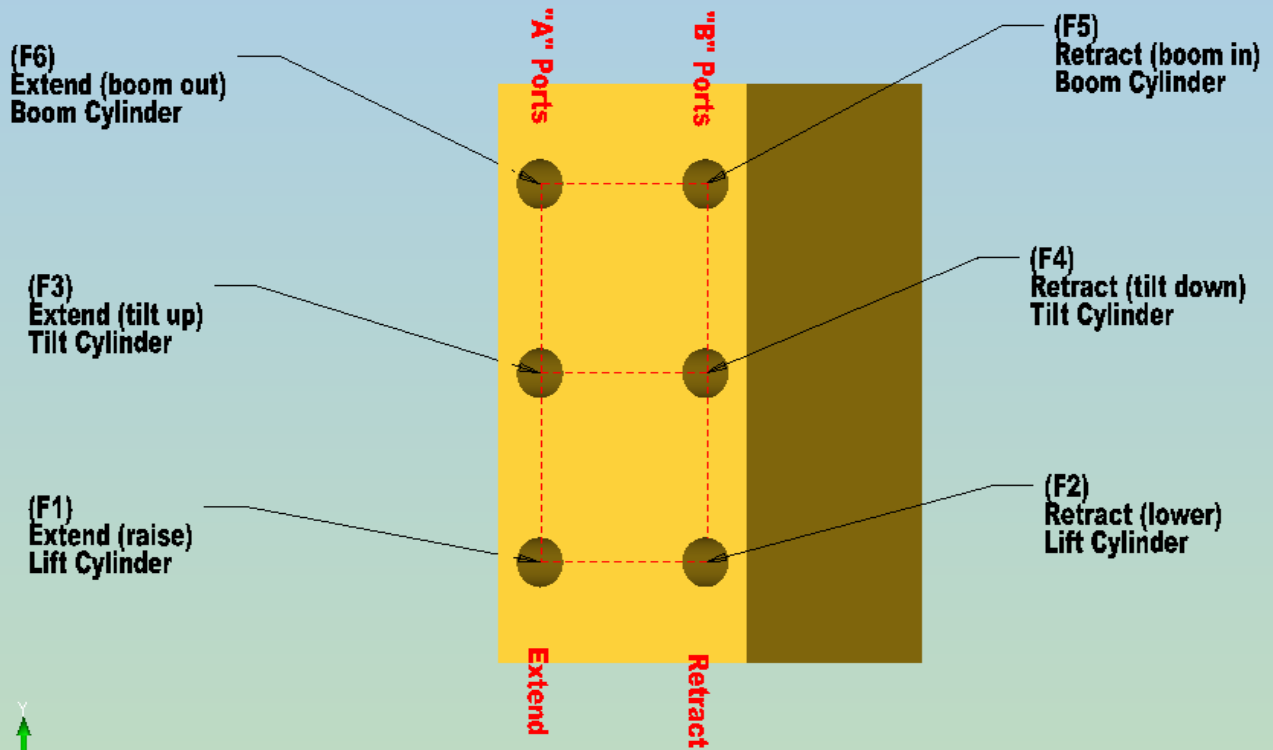

Plumbing Wet Pac (PTO Pump)

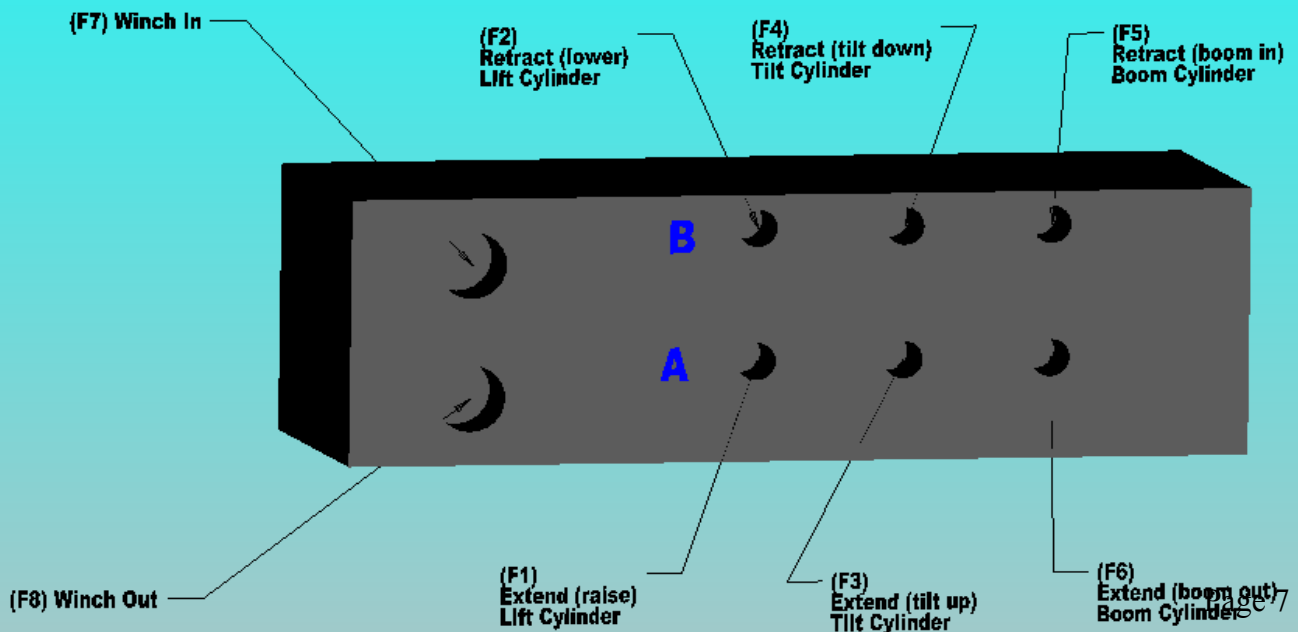

Wet Pac (PTO Pump)

Flow Control
(In- less gallons)
(Out - more gallons)

Relief Valve
(In - higher pressure)
(Out - lower pressure)

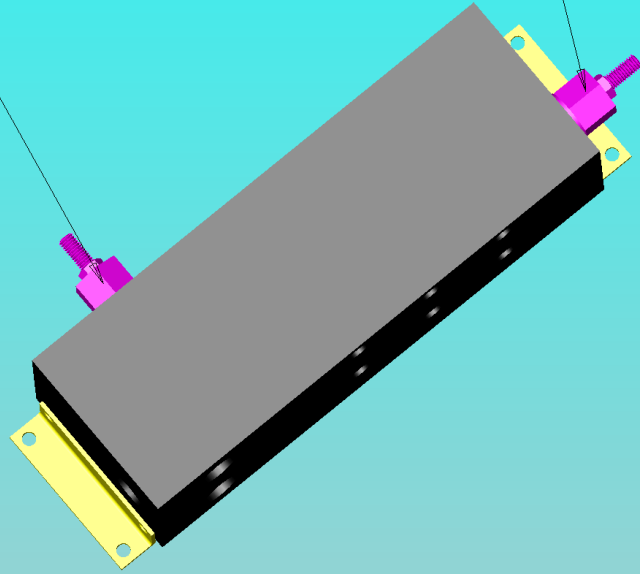

Wiring Harness Connections:

DD-MS-1: Wiring Harness With 6 Functions

DIN #1 – Main Cylinder Up/Down

DIN #2 – Tilt Cylinder Up/Down

DIN #3 – Boom Cylinder In/Out

SV Wire – Valve bypass – wired to small solenoid terminals

Fused Main Radio Power Wire – Wire to separate 15 amp circuit *

Note: On electric over hydraulic units it is important to wire the radio unit to a separate 15 amp circuit. DO NOT connect radio power to circuit supplying power to the motors on these units.

DD-MS-2: Wiring Harness With 10 Functions

DIN #1 – Main Cylinder Up/Down

DIN #2 – Tilt Cylinder Up/Down

DIN #3 – Boom Cylinder In/Out

SV Wire – Valve bypass – wired to small solenoid terminals

DIN #4 – Winch In/Out

TSII – Freespool Wire (this is 2 foot cable)

Grey Wire – Accessory power (this is 8 foot cable)

Fused Main Radio Power Wire – Wire to separate 15 amp circuit *

Lubrication:

Grease one or two pumps every two weeks under normal service:
It is not necessary to lubricate between rollers and tracks. Occasionally put a couple drops of oil where pins go through bushings.

Nylon Wear Pads can be lubricated with “Never Seize” or a dry graphite product if desired.

1 Grease Fitting:
Crossbar: Must turn to expose zerk:

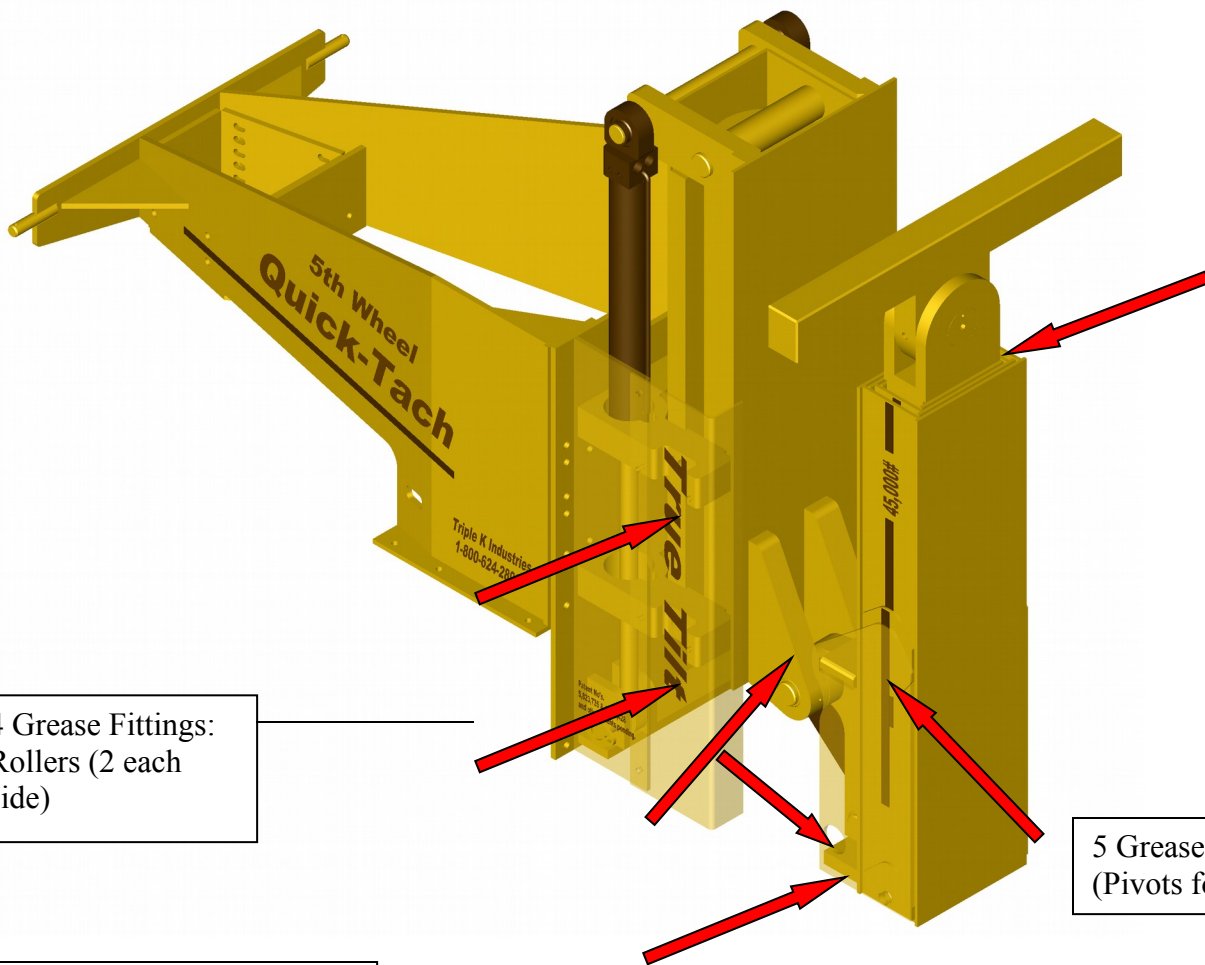

4 Grease Fittings:
Rollers (2 each side)

5 Grease Fittings:
(Pivots for Hinge Pin)

3 Grease Fittings on Tilt Cylinder Shaft:
(2 on one side 1 on other)
Must be full tilt up and vertical lift lowered to expose fittings.

2 Grease Fittings:
(Top Side of Inner Boom)

1 Grease Fitting:
(Center of Pin)

- Use Dexron Automatic Transmission Fluid in the electric/hydraulic pump. (Can cut with diesel fuel in cold temperatures – up to 1/3).
- Fill tank to within 2” from top with all cylinders retracted.
- Run cylinders in stages both ways to eliminate air from the system the first time it is used. Do not run completely to one end before cycling the opposite way. This may produce an “air lock” in the valves.
- Use the 1/0 Welding Cable that is provided to ensure sufficient voltage to unit. Be sure ground is complete. Bolt short ground cable to truck frame only (not to cross member). Clean area thoroughly before mounting (sand or grind clean). Also check to be sure the truck frame is grounded to the battery. (Sometimes the ground is left off when an engine is rebuilt).

Triple K Industries

Triple K Industries
47219 W. Schweigers Circle #3
Sioux Falls, SD 57107
800-624-2892
www.tripleindustries.com