

10635 Kerns Road, Huntersville NC 28078

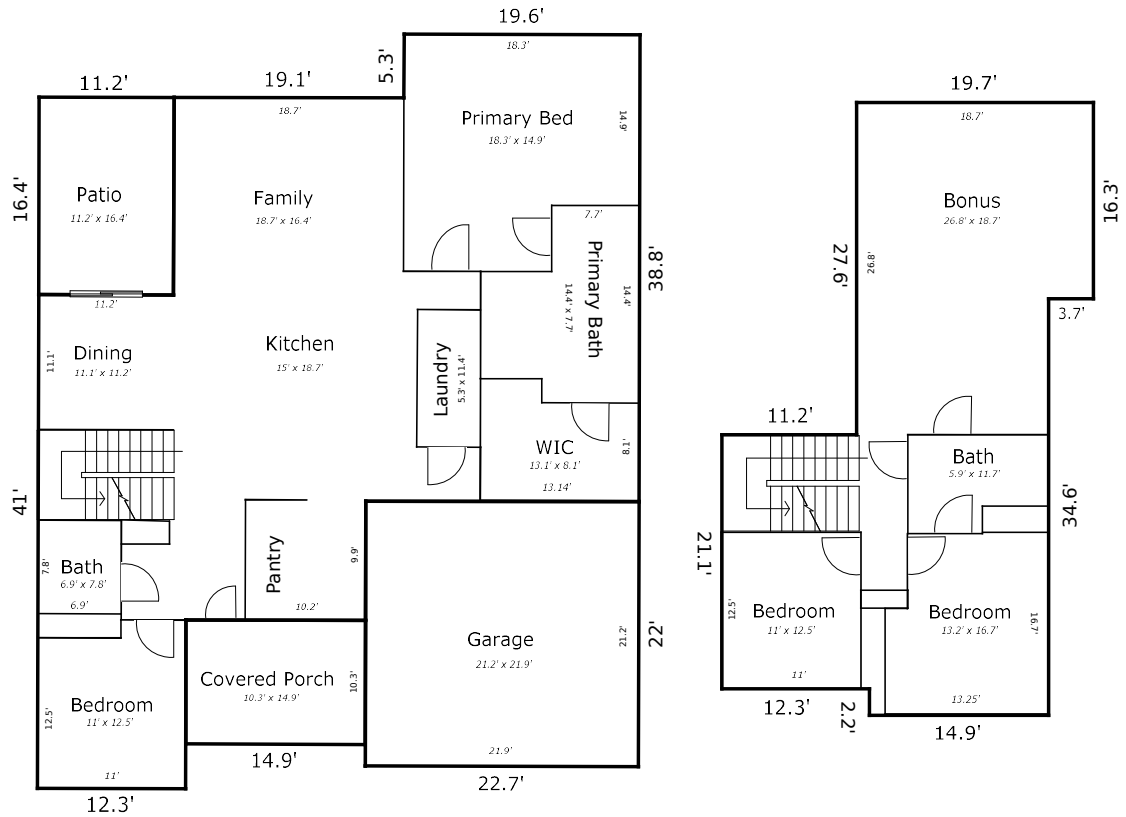

The improvements have been measured in accordance with the ANSI Z765-2021 Measuring Standard and are deemed accurate.

The measurements included are approximate based on possible limited sightlines, obstructed views and/or grading and topography.

Measurements may differ from those calculated by others based on measurement tools and rounding.

TOTAL Sketch by a la mode

Area Calculations Summary

Living Area		Calculation Details
First Floor	2033.3 Sq ft	$41 \times 11.2 = 459.2$ $38.8 \times 19.6 = 760.5$ $33.5 \times 3.1 = 103.8$ $43.4 \times 14.9 = 646.7$ $57.4 \times 1.1 = 63.1$
Second Floor	1106.2 Sq ft	$19.6 \times 16.3 = 320.3$ $16 \times 11.3 = 180.2$ $27.2 \times 21.1 = 572.9$ $2.2 \times 14.9 = 32.8$

Total Living Area (Rounded):	3140 Sq ft	
Non-living Area		
Concrete Patio	183.7 Sq ft	$16.4 \times 11.2 = 183.7$
2 Car Attached	499.4 Sq ft	$22 \times 22.7 = 499.4$
Covered Porch	153.5 Sq ft	$10.3 \times 14.9 = 153.5$