



SKU: 40-2001
40-2002

FISHING ROD HOLDER (2021+ FORD BRONCO)

KIT CONTENTS:

- One (1) or Two (2) Plastic Fishing Rod Holders
- One (1) or Two (2) Stainless Steel Brackets
- Hardware Bag consisting of
 - (2) M6 x 1mm (35mm Long) Pan Head Screws (A)
 - (4) M6 x 1mm (20mm Long) Pan Head Screws (B)
 - (2) 8-32 (1 3/8" Long) Pan Head Screws (C)
 - (4) 10-24 (3/4" Long) Pan Head Screws (D)
 - (2) M6 x 1mm Serrated Flange Locknuts (E)
 - (4) 10-24 Serrated Flange Locknuts (F)
 - (2) 1/2" x 13/16" Long Nylon Spacers (G)
 - (8) M6 Flat Washers (H)
 - (4) M6 Split Lock Washers (I)
 - (2) 8-32 (1" Long) Binding Barrels (J)

NOTE: Not all hardware will be used. There is sufficient hardware provided in the kit to allow the double holder kit (40-2002) to be split into two single kits (40-1001). This would allow you to have one single holder on each side.

(Drawing not to scale. Actual hardware may vary slightly from drawings.)

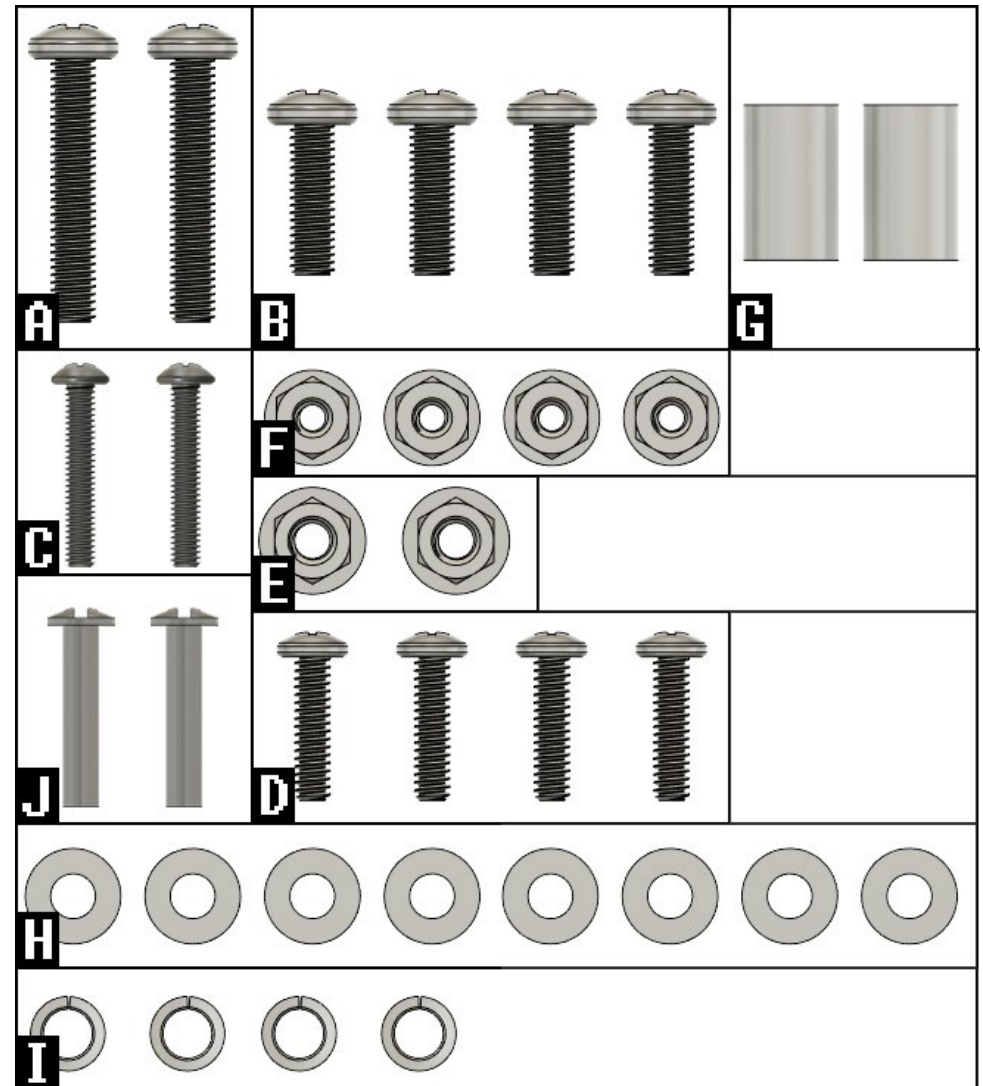

FISHING ROD HOLDER (2021+ FORD BRONCO)

1a. SINGLE ROD HOLDER

Using the provided hardware, mount the plastic fishing rod holder to the stainless steel mounting bracket. You'll use (2) 10-24 3/4" Long Pan Head Screws (D), (2) M6 Washers (H) & (2) 10-24 Flange Locknuts (F) to attach the plastic fishing rod holder to the mounting bracket. **Do not** over-tighten the screws. Tighten them just enough that the washer begins to mushroom into the plastic. Make sure the flared end of the plastic holder angles upwards. Use the following drawing on the right as an example of the correct order for the hardware.

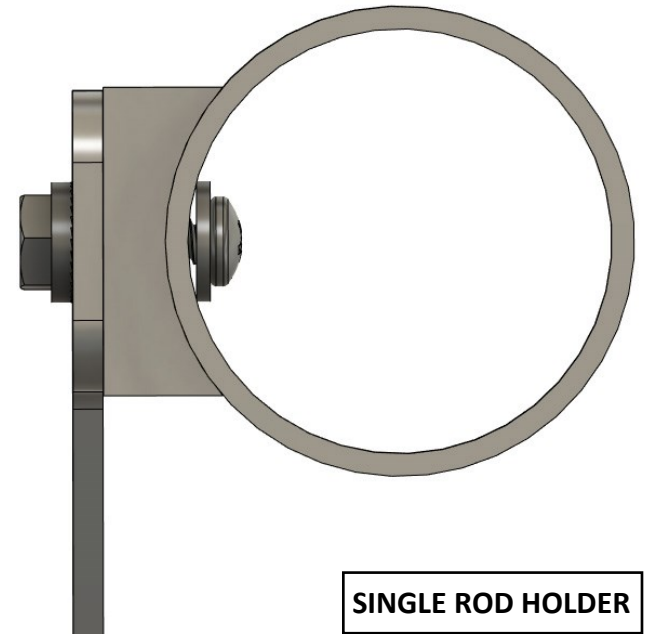

1b. DOUBLE ROD HOLDER

Using the provided hardware, mount the plastic fishing rod holders to the stainless steel mounting brackets. You'll use (2) 8-32 1" Long Pan Head Screws (C), (2) 8-32 1" Long Binding Barrels (J), (4) M6 Washers (H) & (2) Nylon Spacers (G) to attach the plastic fishing rod holder to the mounting bracket. **Do not** over-tighten the screws. Tighten them just enough that the washer begins to mushroom into the plastic. Make sure the flared end of the plastic holder angles upwards. Use the following drawing below as an example of the correct order for the hardware.

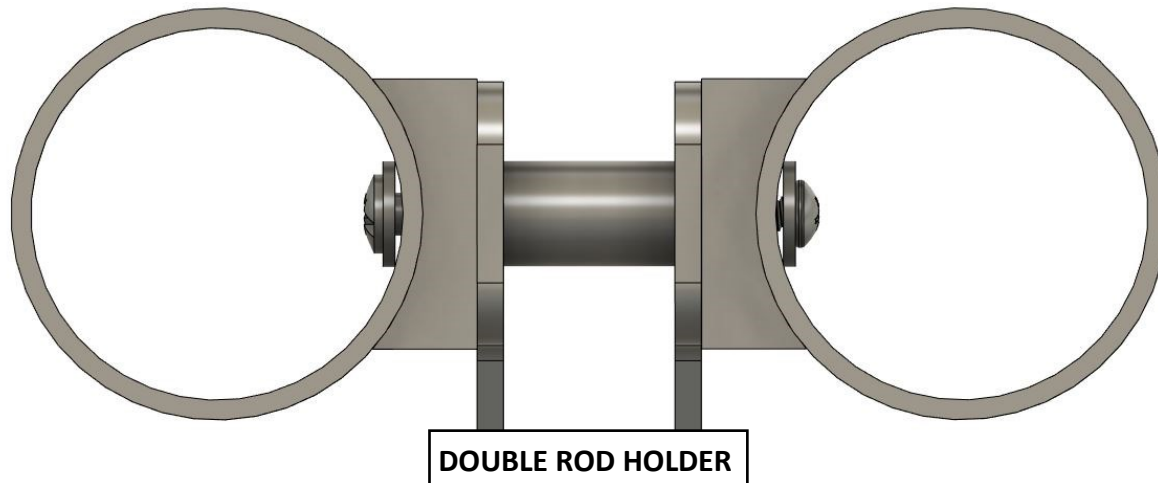

FISHING ROD HOLDER (2021+ FORD BRONCO)

2a. SINGLE ROD HOLDER

Using (2) 20mm Long M6 Pan Head Screws (B), (2) M6 Flat Washers (H) & (2) M6 Split Washers (I) attach the bracket to the vehicles trail sights. You'll need to remove the (2) male bolts on the trail sight (you will re-use the female side). Use the torx key provided in your vehicles hardware kit. Use the following drawing on the right as an example of the correct order for the hardware. The M6 Pan Head Screws (B) will screw into the factory trail sight hardware.

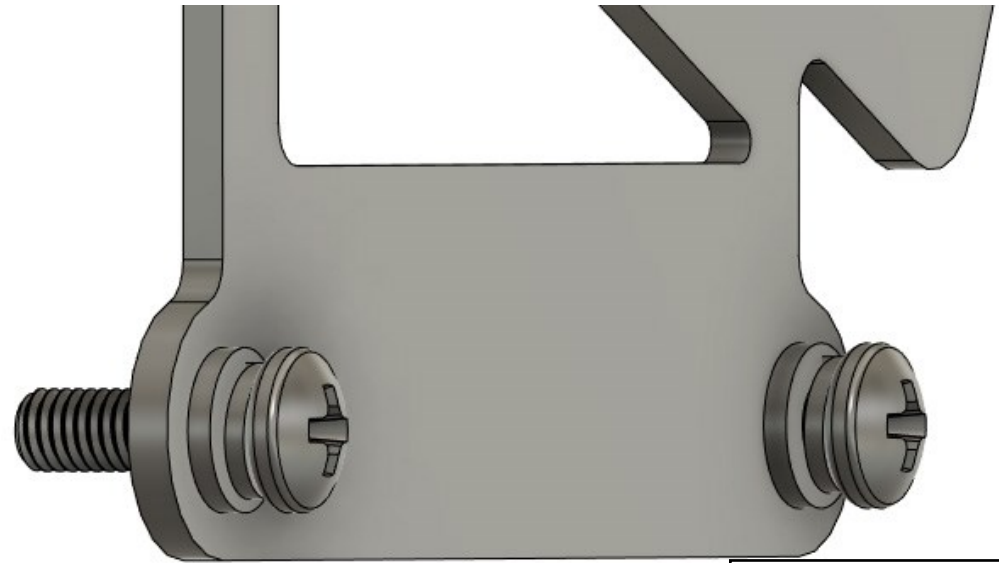

SINGLE ROD HOLDER

2b. DOUBLE ROD HOLDER

Using (2) 35mm Long M6 Pan Head Screws (A), (2) M6 Flat Washers (H) & (2) M6 Flange Locknuts (E) attach the bracket to the vehicles trail sights. You'll need to remove the existing trail sight nuts & bolts. Use the torx key provided in your vehicles hardware kit. These will not be used with the double holder but save these for future use. Use the following drawing below as an example of the correct order for the hardware.

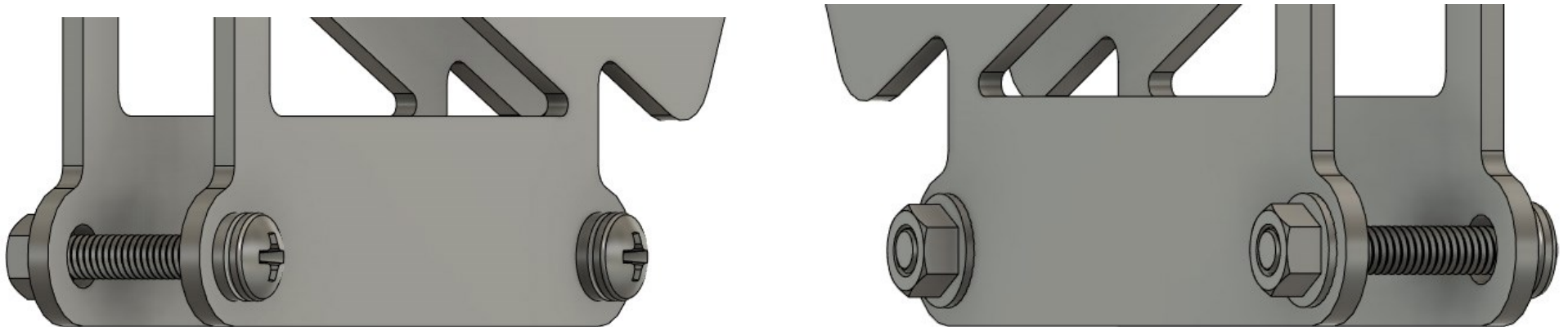

DOUBLE ROD HOLDER

FISHING ROD HOLDER (2021+ FORD BRONCO)

3. MOUNT FISHING RODS

Slide your fishing rods into the fishing rod holders. It's recommended to use a small bungee cord on each rod holder to secure the fishing rod in place. This will help prevent the rod & reel from bouncing around during transport. Please note that the installation of the double rod holder **will prohibit** access to the engine bay. It's recommended to keep basic hand tools in your vehicle should you need to quickly remove the fishing rod holders in the field.

