

FRIENDS OF BANDON PARKS & RECREATION

Newsletter

Volume 2 | Issue 3



CONNECT WITH NATURE

Message from Christine Hall



This Photo by Unknown Author is licensed under CC BY-SA

Hi Members, Supporters, and Especially our Volunteers.

We have a new look to the newsletter with the help of Maya Graphics. We take our communications to our community of supporters seriously. With your donation of time and funds, we make positive contributions to make things happen.

Bandon City Park is the focus of the March issue with many initiatives underfoot.

City parks serve, day in and day out, as the primary green spaces for the majority of Americans.

Bruce Babbit

City Park Appreciation Day Saturday April 29

Remember last year and how much FUN we had at Park Cleanup Day? Nearly 75 people showed their support of City Park. Back again with a new name is, Park Appreciation Day. Rain or shine, we even have indoor projects lined up.

Here's what's planned:

- Expand and improve the gravel pathway for the StoryWalk.
- Work with Disc Golfers to install course expansion
- General clean-up of flower beds, ivy removal, and cleaning projects
- Grounds Maintenance (if needed)
- Inside the Sprague Theater, some interior cleaning and painting projects

People don't remember each tree in a park but all of us benefit from the trees. - Yoko Ono

Our Bandon Volunteers Needed



**City Park used to be a dense urban forest.
Help Friends and the Community to plant more trees.**

FRIENDS OF BANDON PARKS & RECREATION

Newsletter

Volume 2 | Issue 3



CONNECT WITH NATURE

Future Plans for City Park? Pump Track

• *What's a Pump Track?* It's easier to show than describe. It is a track for wheeled sports where you don't pedal but "pump" your bike. A pump track is being explored by the City. Stay tuned.



This Photo by Unknown Author is licensed under CC BY-SA

Here are several examples of pump tracks. Volunteer efforts were made several years back at City Park but it needs a total revamping.

More Future Plans for City Park?

What's a Skate Park?

Again it is easier to show rather than tell. Skateboarding around the country is a very popular recreational sport.

In the past, Bandon has had a skateboard park area. Gradually, it deteriorated and was removed. There is momentum to bring back the Skate Park and build it even better. Our youth definitely will be excited by this move.



FRIENDS OF BANDON PARKS & RECREATION

Newsletter

Volume 2 | Issue 3



CONNECT WITH NATURE

More Ideas for Skate Park Layouts

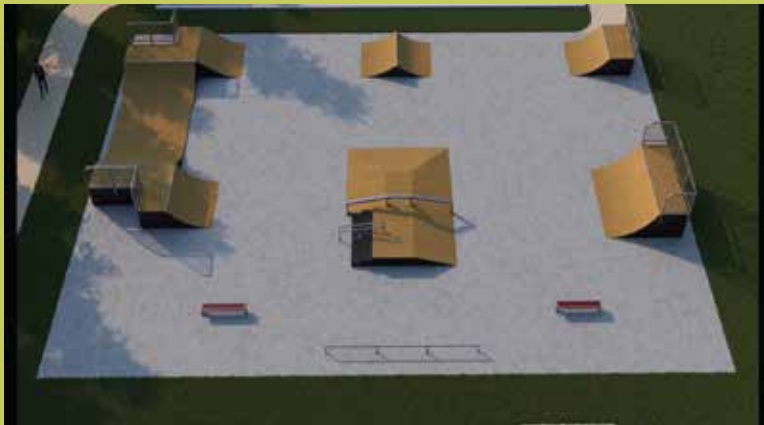

Pickleball On the Move



Storage chest proposed for more easy access to pickleball net, balls and extra paddles.

The Bandon Pickleball group tops nearly 100 members!

They are proposing a new pickleball surface for the current concrete slab area where the current basketball court is. The slab is shared by both basketball and pickleball games and will continue to be shared.

Fundraising efforts have begun to resurface the slab with a surface designed for pickleball courts. Bids are being reviewed.

Friends Donates to:

StoryWalk

\$1000 to the Bandon City Library StoryWalk project with grant funds from Coos County Cultural Coalition.

Pickleball Surface

\$300 towards their new pickleball surface in City Park. Funds received from donations and membership dues.

The current balance for Friends of Bandon Parks and Recreation is just under \$3,000.



This Photo by Unknown Author is licensed under CC BY-SA

FRIENDS OF BANDON PARKS & RECREATION

Newsletter

Volume 2 | Issue 3



CONNECT WITH NATURE

Update on Playground in City Park

- The City was successful in obtaining a \$30k grant from Oregon State Park and Rec Dept. An additional \$6k from City Funds will be a great boost to new playground equipment.
- The rubber mulch needs to be removed and plans are underway to do just that. Be patient. It is going to happen.
- The next step is to replace the rubber chips with something safe and that allows access for all. A new surface is under consideration that will do just that.



Safe Streets for Walking/Cycling

Walking and cycling are two great recreation opportunities especially with Bandon ocean views. How do we encourage walkers and cyclists to get out on the road and yet feel safe?

Many streets in rural communities lack sidewalks and safe streets. And Bandon is no different. While Beach Loop is a designated Bike Route along with Riverview Dr., these narrow streets with no shoulders can be scary.

In communities where the infrastructure can't support safe travels, they have reduced car speeds.

Slower car speeds make for safer streets. Separated infrastructure like sidewalks and bike lanes, is one of the biggest changes cities can make to city streets to increase the safety of people traveling outside of cars.



Spring is coming

ANNUAL CITY PARK SPRING CLEANUP

Park Appreciation Day

Volunteers needed

**Parks and Recreation Commission
City of Bandon**



Saturday, April 29th

10 am to 1 pm

Meet at the Gazebo to sign-in

Paint, clean, rake & mulch

**Parks and Recreation
Commission**



Bandon by the Sea

CONNECT our COMMUNITY to NATURE



South Jetty Park is four acres of undeveloped river and ocean front. The Northern border is the Coquille River and the entrance to the sea. Here you will see fishing boats, the Coast Guard, surfers, fishing on the beach, agate seekers and rock hounds.

Membership helps us preserve and enhance our parks while promoting exercise and education

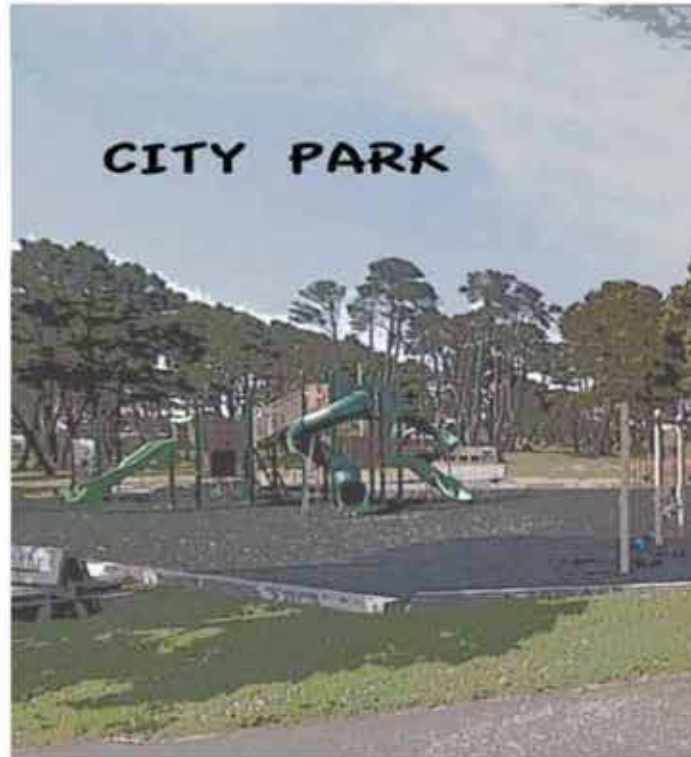

Begun in 1912, City Park was the first park in Bandon. Located on 11th Street, its 15 acres of trees are often referred to as the 'Gem of Bandon'. City Park has a walking path, dog park, playground for children, ball fields, skateboard area, and disc golf course.



info@friendsofbandonparks.org

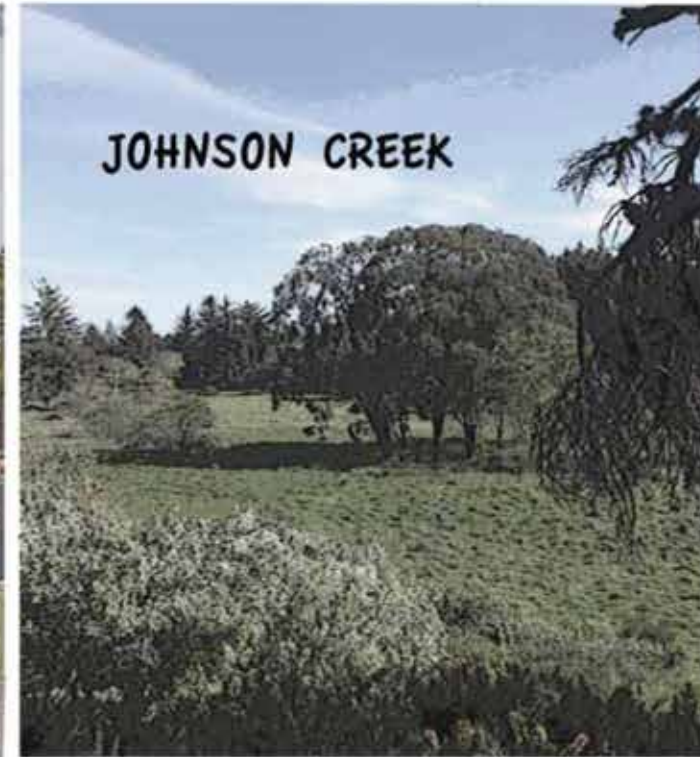

Located off Beach Loop Road is newly acquired Johnson Creek. Zoned as Natural Resource land, its 37 acres of undeveloped land promises to be a nature preserve for birds and wildlife. Johnson Creek meanders through it. Walking paths are being discussed.

Annual membership	\$25
Annual family	\$45
Student	\$5
Patron	

MEMBERSHIP APPLICATION



FRIENDS OF BANDON PARKS AND RECREATION

First name: _____

Last name: _____

Phone: _____

Email: _____

Interests and skills: _____

Annual membership \$25

Family \$45

Student \$5

Patron

Mail checks payable to:

Friends of Bandon Parks

c/o GBA

PO Box 161

Bandon, OR 97411

CONNECT our COMMUNITY to NATURE

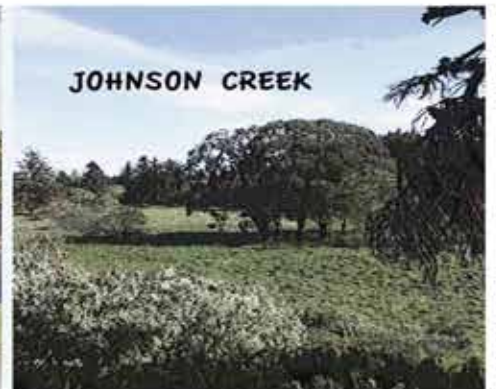
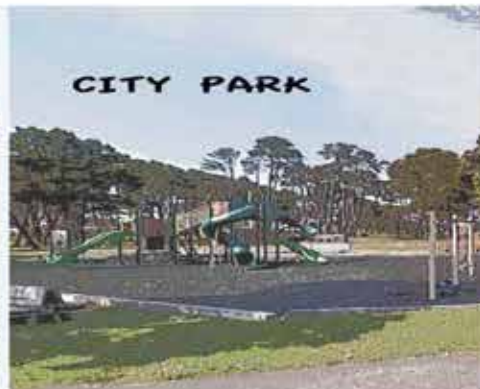

Your membership helps us share, preserve and enhance our parks while promoting education, and wellness. Thank you for your support.



What we do

- Raise funds for special park projects
- Produce fun recreational events
- Craft community volunteer activities

Funding sources

- Membership fees
- Local funds from community and business
- Grants from private and public funding
- Endowments and memorial gifts

100% of funds are used for park programs and projects. All members are volunteers

Friends is affiliated with Greater Bandon Business Association, non-profit 501c3



Member benefits

- Receive priority invitations to events
- Get involved in education and leadership opportunities
- Share in selecting project priorities
- Research funding sources and writing

Volunteer benefits

- Attend events throughout the year
- Connect with local people
- Learn about Bandon and surrounding area
- Get some exercise
- Use your own expertise and talent
- Promote our city and our parks



JOIN US

FRIENDS OF BANDON PARKS & RECREATION

*"Parks and playgrounds
are the heart of the city"*
Marty Rubin



Our mission is to encourage thriving parks for a healthy community for generations to come.



Bandon by the Sea
bandoncares.org