

LED TROFFER SERIES

INSTALLATION INSTRUCTIONS

NOTE

Please read this entire manual to fully understand and safely use this product.

Specifications are subject to change without notice.

Please visit our website the most recent user guide versions.

UNPACKING

- 1 Unpack and carefully examine the product.
- 2 Report any damage and save all packing materials if any part(s) were damaged during shipping.
- 3 Do not attempt to use this apparatus if it is damaged.

IMPORTANT SAFETY INFORMATION



CAUTION: Risk of Electric Shock

Suitable for Damp location. Access above ceiling required. Do not install insulation within 51mm(2 in) of any part of the luminaire. Suitable for suspended ceilings.

READ ALL INSTRUCTIONS BEFORE INSTALLATION

- 1 Consult a qualified electrician to ensure correct branch circuit conductor.
- 2 The product should be installed and operated by a qualified electrician or technician in accordance with relevant local codes.
- 3 Risk of electric shock. Ensure that main power source is off when wiring or soldering the sections of the product.
- 4 Before installing this fixture or doing any maintenance, make sure to turn off the power supply at the circuit breaker or fuse box.
- 5 Check to make sure that all fixture connections have been properly made and the fixture is grounded to avoid potential electrical shocks.
- 6 Do not handle energized fixture when hands are wet, when standing on wet or damp surfaces, or in water.
- 7 Designed for use in 110V~277V or 110V-347V, 50-60Hz protected circuit.

INCLUDED IN THIS BOX

- 1 LED Luminaire
- 2 Installation instruction

LED TROFFER SERIES

INSTALLATION INSTRUCTIONS

INSTALLATION INSTRUCTIONS

Step1: Bend hang buckle by 90° making it vertical to the rear cover of panel light.

Same to 4 hang buckles.(Figure 1)
J-Hook for positioning only

Step2: Turn off power, and remove the ceiling panel.

Step3:For positioning, place the troffer into the T-bar. Ensure the troffer are attached to the ceiling. (Figure2)

Step4: Open up the driver box
Trade size of conduit 22.2mm dia

Step5:

- 1 Connect AC Wires
Input L connects to the black wire of the luminaire, N connects to the white wire, the ground connects to the green wire
- 2 Connect Dimmer
Compatible with 0-10V dimmer
The driver VIOLET (D+) to the dimmer+(VIOLET), and the driver PINK (D-)to the dimmer-(PINK)

Connect the wires with terminal cap as shown in wiring diagram. (Figure3)
Incoming insulated dimming conductors shall have voltage rated at least equal to the branch voltage.

Step6: Close the driver box and screw in (Figure4)

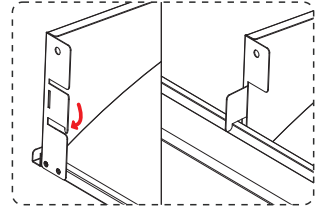

Figure1

Figure2

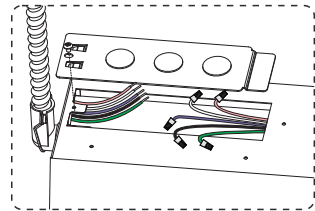

Figure3

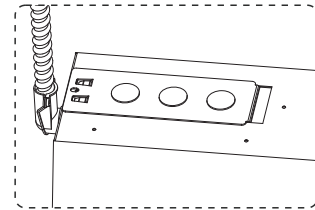

Figure4

WIRING DIAGRAM

