

# 2.3" SURFACE LED

## ARCHITECTURAL LED LUMINAIRE INDEPENDENT INSTALLATION

**⚠ RISK OF FIRE AND ELECTRICAL SHOCK. FIXTURE MUST BE INSTALLED BY A QUALIFIED ELECTRICIAN ONLY IN ACCORDANCE WITH NATIONAL, LOCAL BUILDING AND ELECTRICAL CODES. DISCONNECT POWER AT ELECTRICAL PANEL BEFORE SERVICING.**

### IMPORTANT

1. Read all instructions.
2. Install in accordance with national and local electrical code regulations.
3. This product is intended to be installed and serviced by a qualified, licensed electrician.
4. Do not install in wet locations. For dry and damp use only.
5. Turn off electrical power before installing or servicing fixture in any way.
6. To reduce the risk of fire and overheating, make sure all connections are tight.
7. Under no circumstances can the lighting fixture be covered with heat insulation gasket or similar materials.
8. The maximum connection of each input line is 40FT(1200CM) in 120AC, 80FT(2400CM) in 230AC, 100FT(3000CM) in 277AC.

### ACCESSORY



**A** Butterfly Drywall Anchor

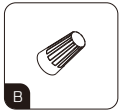

**B** Wire Nut

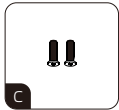

**C** Screw

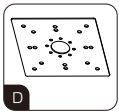

**D** Square plate  
(Optional accessory)  
Noted: Square plate Compatible for 4" octagon, 4" round, 4" square and 2x4" rectangle junction boxes.

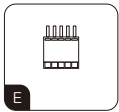

**E** Male quick connector  
(5 holes)

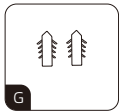

**G** Anchor



**I** Screw

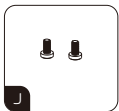

**J** Screw

### WIRING

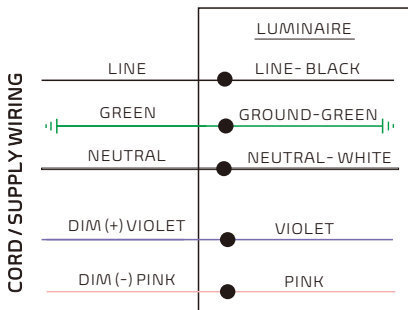

**⚠** Please isolate two dimming wires by P2 terminal individually if no need dimming; **MUST connect wires with corresponding colors as shown.**

### PRE-INSTALLATION

#### Assemble Power Cord

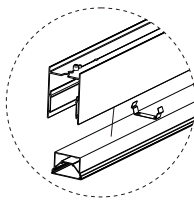

1. Take off the end cap and LED modular.

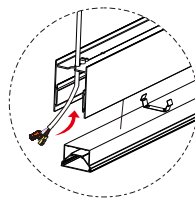

2. Thread the power cord out of the housing as shown.

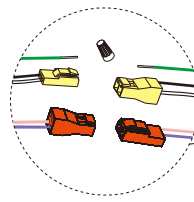

3. Wiring  
Must connect connectors with corresponding colors as shown.

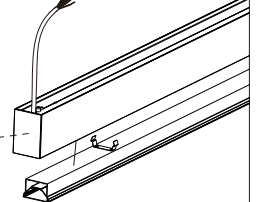

4. Remount end cap into housing.

### INDEPENDENT INSTALLATION

#### 1 Prepare mounting point in the ceiling

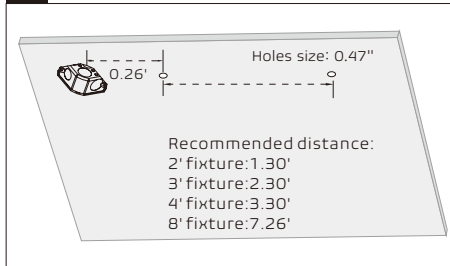

#### 2 Mount plate and wiring

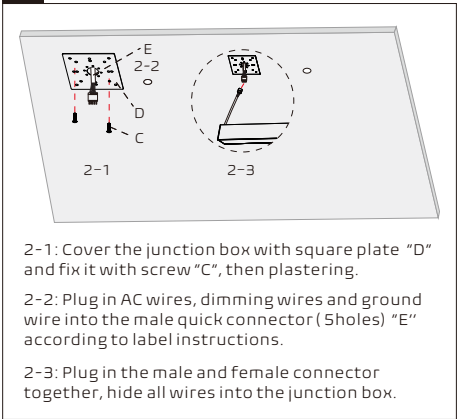

#### 3 Screw the housing in the ceiling

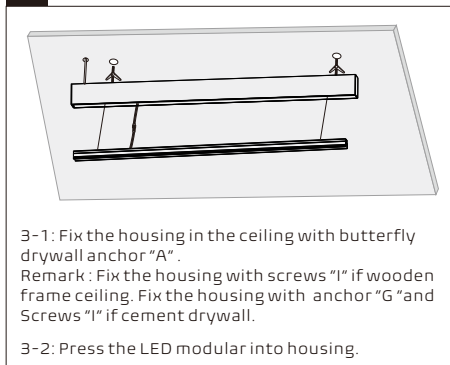

#### 4 Complete

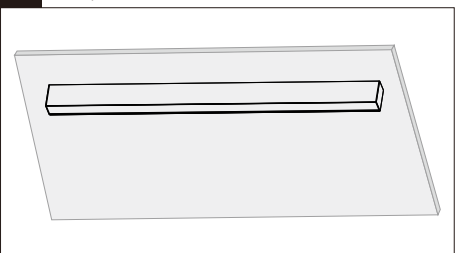

# 2.3" SURFACE LED

## ARCHITECTURAL LED LUMINAIRE MULTIPLE LUMINAIRES CONNECTION

**⚠ RISK OF FIRE AND ELECTRICAL SHOCK. FIXTURE MUST BE INSTALLED BY A QUALIFIED ELECTRICIAN ONLY IN ACCORDANCE WITH NATIONAL, LOCAL BUILDING AND ELECTRICAL CODES. DISCONNECT POWER AT ELECTRICAL PANEL BEFORE SERVICING.**

### JOINER OPTIONS

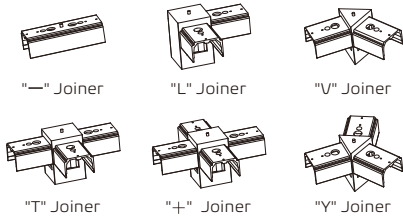

Noted: It needs 2 inputs if using joiner "T", "+ " and "Y".

### ACCESSORY



Noted: Silicone Seal is used to seal seams that may appear at both ends of luminaires when multiple connections.

### BEFORE CONNECTING

#### Disassemble Luminaires

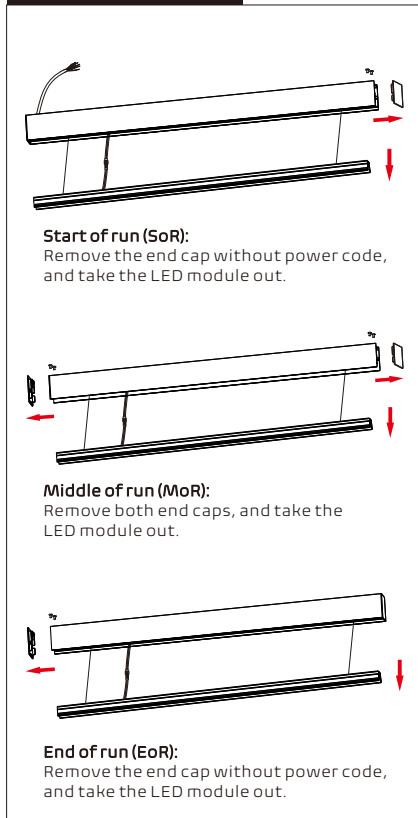

### LINE CONNECTION

Mounting Points:  
1.96' for 2FT fixture  
2.96' for 3FT fixture  
3.96' for 4FT fixture  
7.92' for 8FT fixture

2' fixture : 1.97'  
4' fixture : 3.94'  
8' fixture : 7.88'

#### 1 Prepare mounting point in the ceiling

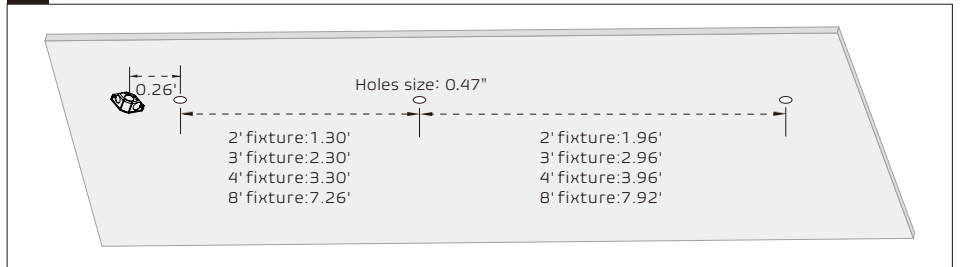

#### 2 Mount plate and wiring

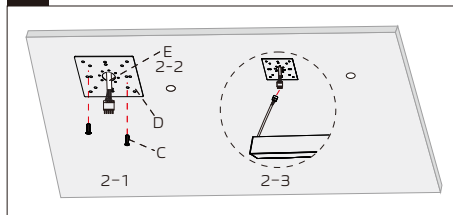

2-1: Cover the junction box with square plate "D" and fix it with screw "C", then plastering.

2-2: Plug in AC wires, dimming wires and ground wire into the male quick connector (5holes) "E" according to label instructions.

2-3: Plug in the male and female connector together, hide all wires into the junction box.

#### 3 Install the housing and joiner – SoR

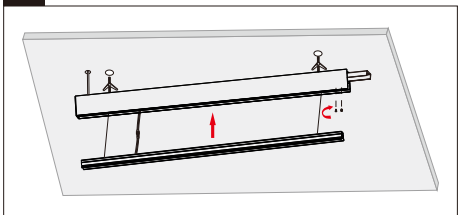

3-1: Fix the housing in the ceiling with butterfly drywall anchor "A".

Remark: Fix the housing with screws "I" if wooden frame ceiling. Fix the housing with Anchor "G" and Screws "I" if cement drywall.

3-2: Insert the joiner "—" into the SoR housing and fix it by screws.

#### 4 Repeat install and join steps-MoR to EoR

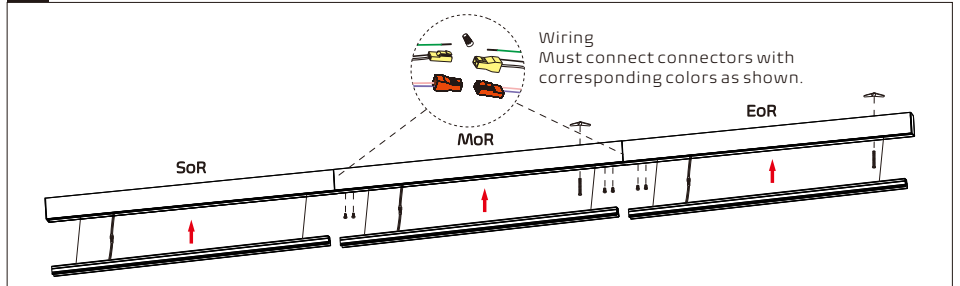

4-1: Fix the housing in the ceiling in turn.

4-2: Insert the joiner "—" into the housing and fix it by screws in turn.

4-3: Connect the quick connectors properly.

4-4: Insert all the led modules into the housing from SoR to EoR in turn.

#### 5 Complete

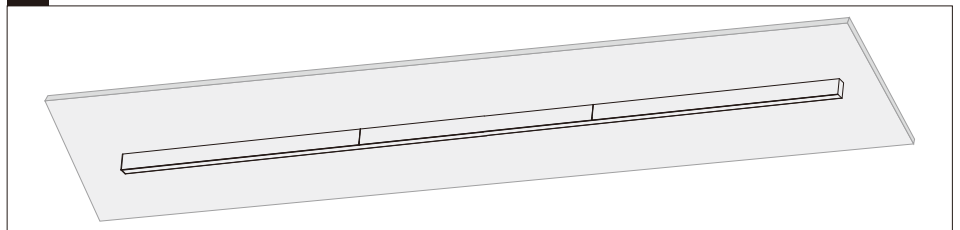

#### Optional 42' Diffuser Lens Roll

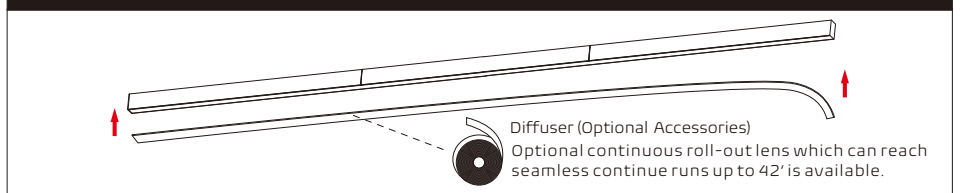

**⚠ RISK OF FIRE AND ELECTRICAL SHOCK. FIXTURE MUST BE INSTALLED BY A QUALIFIED ELECTRICIAN ONLY IN ACCORDANCE WITH NATIONAL, LOCAL BUILDING AND ELECTRICAL CODES. DISCONNECT POWER AT ELECTRICAL PANEL BEFORE SERVICING.**

### L SHAPE CONNECTION

- ▲ For "T", "+", "Y" shape or other geometric shapes, all subject to the "L" shape installation
- ▲ It needs 2 inputs if using joiner "T", "+" and "Y".

#### 1 Make hole in the ceiling

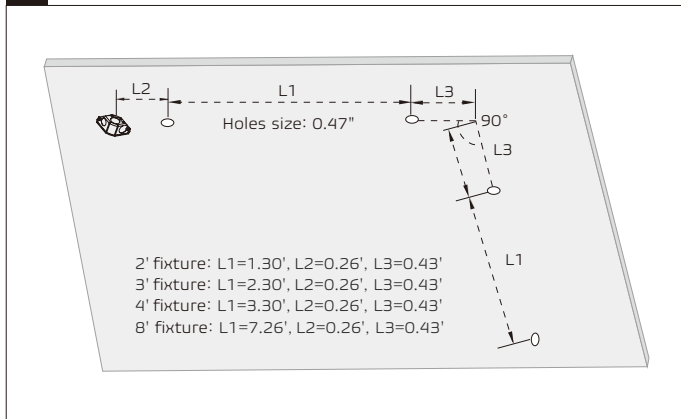

#### 2 Mount plate and wiring

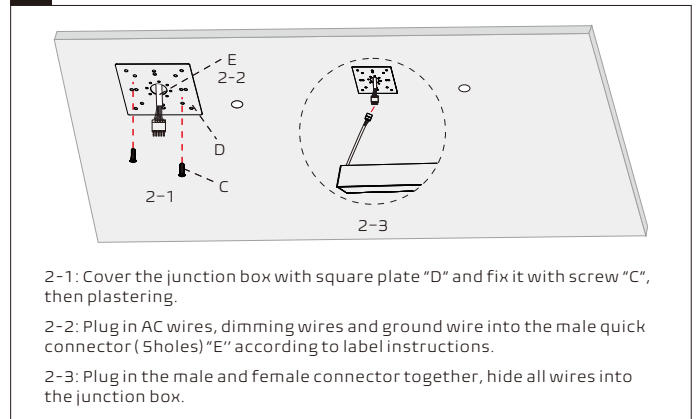

#### 3 Install the housing and joiner – SoR

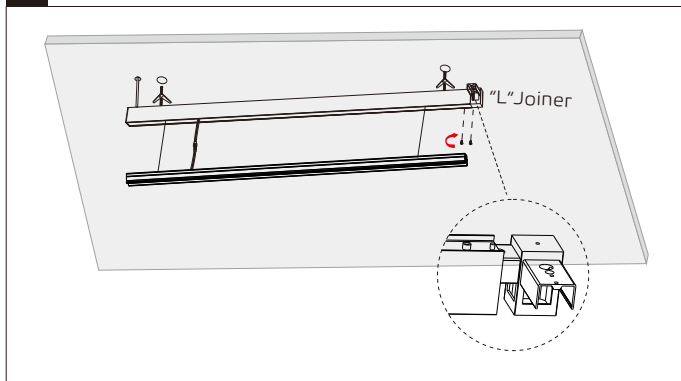

- 3-1: Fix the housing in the ceiling with butterfly drywall anchor "A"  
 Remark: Fix the housing with screws "I" if wooden frame ceiling.  
 Fix the housing with Anchor "G" and Screws "I" if cement drywall.
- 3-2: Insert the joiner "L" into the SoR housing and fix it by screws.

#### 4

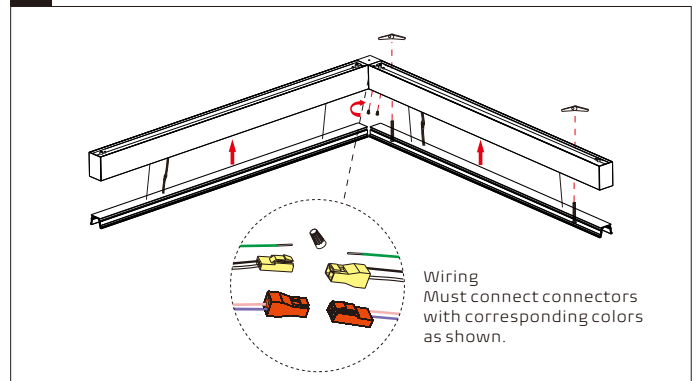

- 4-1: Fix the housing in the ceiling in turn.  
 4-2: Insert the joiner "L" into the housing and fix it by screws in turn.  
 4-3: Connect the quick connectors properly.  
 4-4: Insert all the LED modules into the housing from SoR to EoR in turn.

#### 5 Complete

