

Features

Construction

- ◆ The area light features a rugged die-cast aluminium body that uses heatsink and flow-through venting to provide optimal thermal management that both enhances LED performance and extends component's life.
- ◆ The light housing is sealed against moisture and environmental contaminants.
- ◆ 3G vibration rated compact design minimizes wind load requirements. Low EPA, allowing pole optimisation.

Electrical:

- ◆ Universal 120-347VAC or 277-480VAC input voltage
Standard with 1-10V dimmable
- ◆ Power Factor : ≥ 0.95
THD $\leq 20\%$
- ◆ 10KV Surge Protector go standard
- ◆ Light engines are available in 3000K, 4000K,
- ◆ 5000K or 5700K (70 CRI) configurations

Information

- ◆ The Energreen Technologies area light is highly cost effective and offers complete configurations.
- ◆ The area light delivers 11000lm to 48000lm lumens, which can replace 250W to 1000W HID lumens.
- ◆ The whole family includes three different sizes, Slipfitter mount, square or round pole mount arm and Yoke mount are available
- ◆ Photocell, motion sensor and external light control shield are also available.



80W/ 100W
120W/ 150W
Wattage Tunable

240W/ 260W
280W/ 310W
Wattage Tunable



Optics:

- ◆ Type III, IV, V distributions optional

Finish:

- ◆ Dark bronze is standard, black, white and grey optional

Ambient Temperature:

- ◆ -40° F (-40° C) to 113° F (45° C)

Listing:

- ◆ UL Certified to meet U.S. and Canadian standards. Suitable for wet locations. Rated for -40°C minimum temperature.
- ◆ DesignLights Consortium® (DLC) Premium qualified product and DLC qualified product.

Warranty:

- ◆ 10 years limited warranty*

Ordering Guide

EXAMPLE: EGTSBX(240/260/280/310)WHV30/40/50KT3SFDPS

Brand XALH	Product name	Wattage XXXW	Input Voltage AA	CCT XXK	Dist.Type Y	Mount Y	Finish Y	Photocontrol Y	Sensor Y
EGT	SBX	(80/100/120/150)W (240/260/280/310)W	HL=120-347V	30/40/ 50K	T3=Type III T4=Type IV T5=Type V	SF=Slipfitter Mount PA=Square and Round Pole Mount Arm TR=Triunion Mount	D=Dark Bronze	Blank=without Photocell P=with Photocell	S=with Mo on Sensor Blank=without Mo on Sensor



Mounting Information

Square & Round Pole Mount

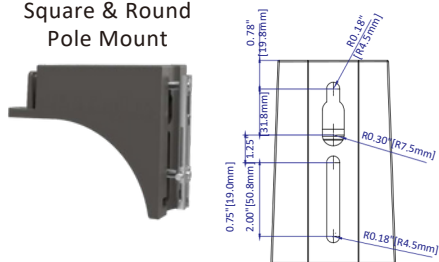

Slip Fitter Mount

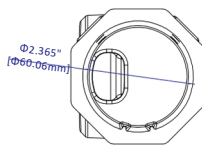

Trunnion Mount

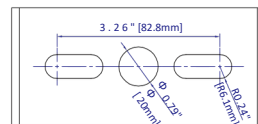

Dimensions & Weight

80W / 100W / 120W / 150W

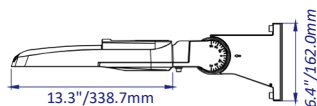
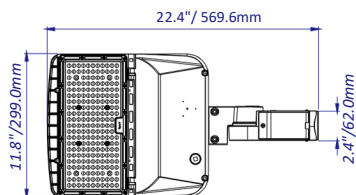

Net Weight: 9.7Lbs/4.4kgs

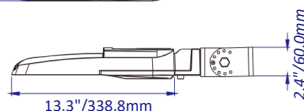
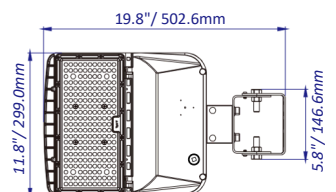

Net Weight: 9.7Lbs/4.4kgs

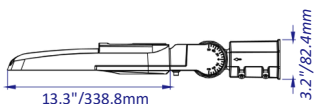
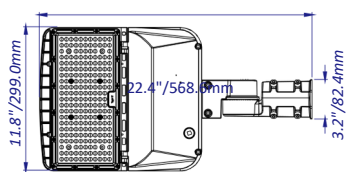

Net Weight: 10.1Lbs/4.6kgs

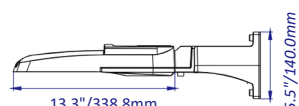
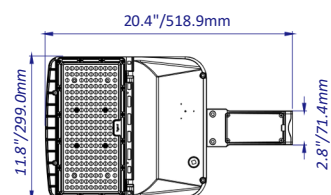

Net Weight: 11.0Lbs/5kgs

240W / 260W / 280W / 310W

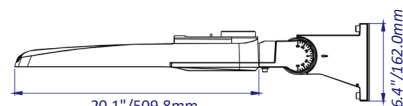
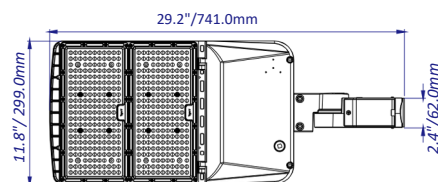

Net Weight: 13.2Lbs/6kgs

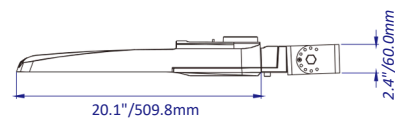
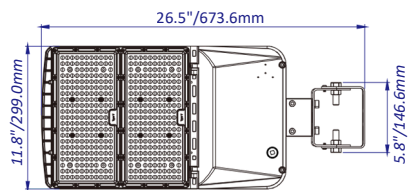

Net Weight: 13.2Lbs/6kgs

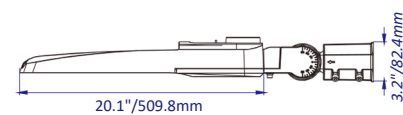
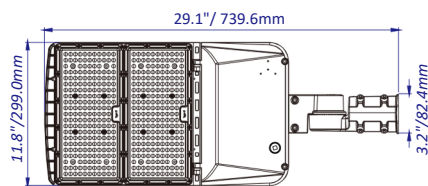

Net Weight: 13.7Lbs/6.2kgs

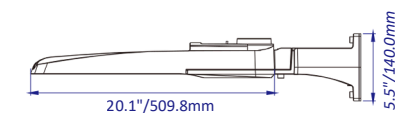
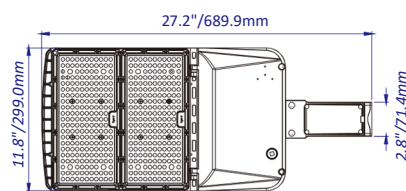

Net Weight: 14.6Lbs/6.6kgs