

## EDGE Electro-Mechanical Actuators

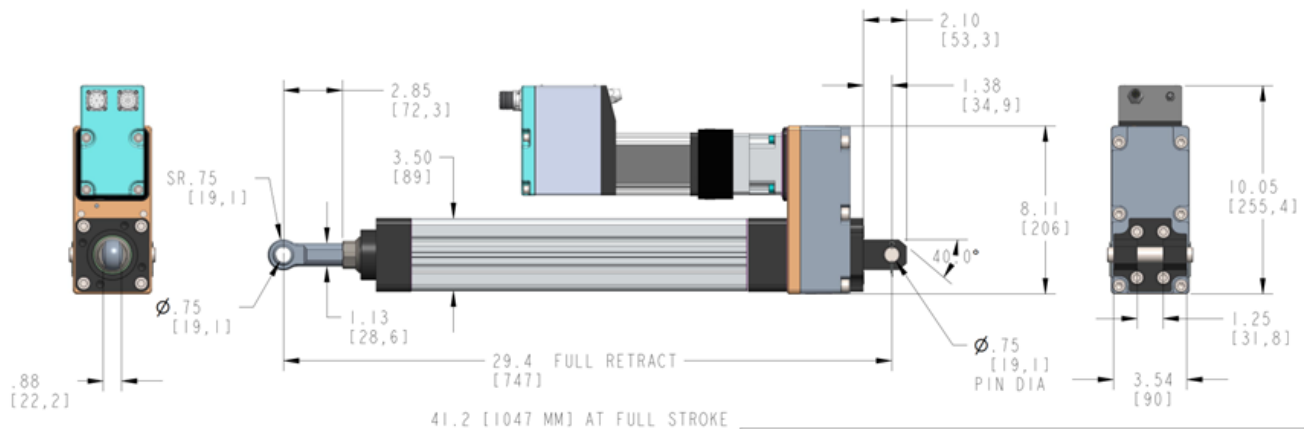
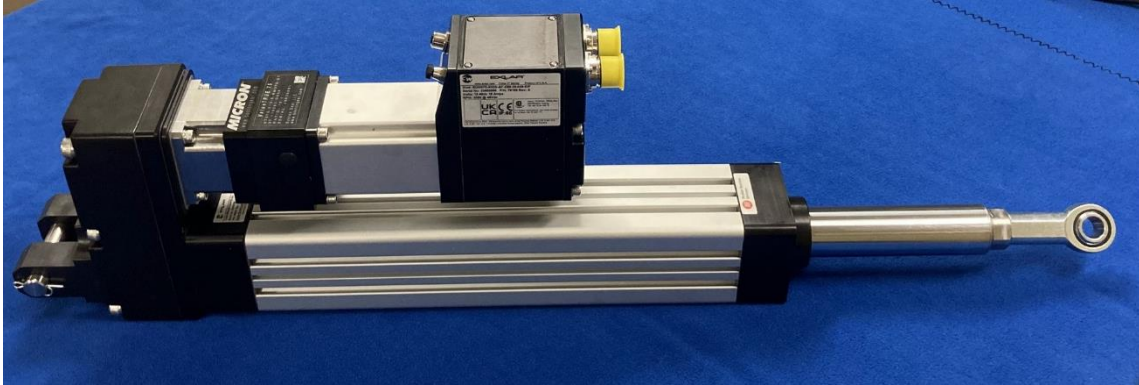

The EDGE actuators are designed for web and strip guiding.

- ✓ DC servo motor (brushless) with onboard controller.
- ✓ Roller Screw actuator.
- ✓ Thrust ranges from 1,000 to 6,500 ft-lbs. of thrust.
- ✓ Thrust range of 10,000 ft-lbs. possible with engineered order.
- ✓ Programmable strokes up to 12".
- ✓ Absolute encoder, no homing sequence required.
- ✓ Smaller foot print than traditional actuators from guiding suppliers.
- ✓ High duty cycle. Designed to outlast ball screw linear actuators in high duty environment.
- ✓ Available with holding brake.
- ✓ Multiple mounting configurations.
- ✓ The EDGE controller is required to power and control these actuators.