

State of New York
County of Chemung

TOWN OF CATLIN
1448 CHAMBERS ROAD
BEAVER DAMS, NEW YORK 14812
607-739-5598



The Town of Catlin Planning Board will hold a Public Hearing on March 25, 2019 at 7:00PM at the Catlin Town Hall for a Site Plan Review of a Cell Tower to be located on Townly Hill Road. Documents concerning the Tower can be found on the Town of Catlin website or can be viewed at the Catlin Town Hall during normal business hours (Monday, Tuesday, and Thursday 9:00AM – 1:00PM)

Thanks,

Jim

N/F
SUE A BENEDET
T.A. #26-1-16

N/F
NORTHWOODS
HUNTING, INC
T.A. #26-1-52.2

N/F
BECKY L LUCAS
T.A. #26-1-23.2

N/F
DAVID B &
JEANNI CAMPBELL
T.A. #26-1-3

N/F
DAVID B CAMPBELL &
MARGARET JEAN
T.A. #26-1-29

N/F
MICHAEL A EARL &
KATHLEEN I PAVNE
T.A. #26-1-28.3

N/F
ROBERT W KITCHEN
T.A. #19-1-50.2

PROPOSED 90' INGRESS / EGRESS
AND UTILITIES EASEMENT

PROPOSED 100' X 100' AT&T LEASE PARCEL
PROPOSED 90' INGRESS / EGRESS
AND UTILITIES EASEMENT

PROPOSED 100' X 100' AT&T LEASE PARCEL
LOT 17
BASE ELEVATION: 1889.7'

N/F
KEITH BAUER
CHRISTOPHER
AND MARIAN
T.A. #26-1-42.21

PROPOSED 90' INGRESS / EGRESS
AND UTILITIES EASEMENT

N/F
DARREL HARTMAN
T.A. #26-1-44.1

N/F
DENNIS B
CYNTHIA CLARK
T.A. #26-1-42.2

N/F
ANDREW A
HEATHER SHUPP
T.A. #26-1-42.1

APPROXIMATE LOCATION OF 90' WIDE PRELIMINE
EASEMENT FOR 27' PRELIMINE GRADIENT TO BURIED
SERVICES. THIS 90' WIDE PRELIMINE EASEMENT
INDICATES AN IN-TERRACE PRELIMINE ALIGNMENT
EASTWARD TOWARD THE EASTERN BOUNDARY OF THIS EASEMENT

N/SEG 1
TOWNLEY HILL ROAD

N/SEG 2

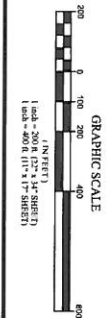
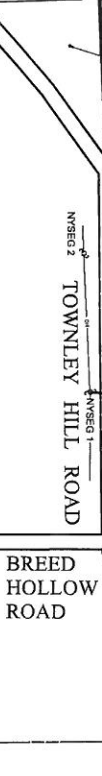

at&t
at&t MOBILITY CORP.
5841 BRIDGE STREET
EAST SYRACUSE, NY 13257

AIRSMITH
Engineering
• Civil
• Structural
• Surveying
• Landscape
• Architecture

Costich Engineering
2171a, A, 2nd
Syracuse, NY 13216

NO.	DATE	COMMENTS
0	01/18/2015	Final Plan. As per 7/28 REVIEW
1	12/12/2015	Revised Plan.
2		
3		
4		
5		
6		
7		
8		
9		
10		

PROJECT MANAGER
D.A.W.

DRAWN BY
O.L.A.

COPYRIGHT 2015
COSTICH ENGINEERING, D.P.C.
USE OF THIS PLAN UNDER THE SUPERVISION OF A REGISTERED PROFESSIONAL CIVIL ENGINEER DOES NOT IMPLY ENDORSEMENT OF ANY SERVICES OR PRODUCTS BY COSTICH ENGINEERING. THE USER OF THIS PLAN SHALL BE RESPONSIBLE FOR OBTAINING ALL NECESSARY PERMITS AND APPROVALS FROM THE APPROPRIATE AGENCIES AND FOR OBTAINING A PROFESSIONAL ENGINEER AND ARCHITECT'S SIGNATURE AND SEALS OF APPROVAL OF THIS PLAN.

POST CREEK
FA #: 14554656

TOWN OF CATTLIN
COUNTY OF CHEMUNG
STATE OF NEW YORK

OVERALL SITE PLAN

SHEET NUMBER: 6805
SHEET: C-1