

**TOWN OF CATLIN**  
**HARVESTING REGISTRATION**  
As required by  
Section II of Local Law #\_\_\_\_ of 200\_

**IT SHALL BE THE RESPONSIBILITY OF THE PROPERTY OWNER OR THE PROPERTY OWNER'S AGENT OR HARVESTER TO SECURE ALL PERMITS, WHICH MAY BE REQUIRED BY NYSDEC, NYSDOT, COUNTY DOT, TOWN OR OTHER AGENCIES OF JURISDICTION.**

1. Date of Registration: \_\_\_\_\_/\_\_\_\_/\_\_\_\_
2. Control number issued by **Code Enforcement Officer** \_\_\_\_\_
3. **Property Owner:**  
Name: \_\_\_\_\_  
Mailing Address: \_\_\_\_\_  
Telephone Number: \_\_\_\_\_
4. **Owner's Agent:**  
Name: \_\_\_\_\_  
Mailing Address: \_\_\_\_\_  
Telephone Number: \_\_\_\_\_
5. **Harvester:**  
Name: \_\_\_\_\_  
Mailing Address: \_\_\_\_\_  
Telephone Number: \_\_\_\_\_
6. **PROPERTY to be HARVESTED:**  
PROPERTY Address: \_\_\_\_\_  
Tax map Number: \_\_\_\_\_

7. **Harvesting** information:

Number of **board feet** to be **harvested**

Number of acres to be **harvested**

(If 10 or more acres are **harvested** a SEQR is required)

Will **clear cutting** occur

(If **clear cutting** will occur a SEQR is required)

8. Date of completed SEQR if required:

9. Estimated date **HARVESTING** is to commence:

10. Has Catlin Highway Superintendent been contacted:

11. Date that new **curb cut** issued:

12. State, County, and Town **roads** in the Town of Catlin to be used for transport:

13. Proof of general aggregate liability insurance submitted:

14. Proof of workmen's compensation and Disability Insurance submitted,  
if required by law:

15. "Best Management Practices During Timber Harvesting Operations"  
given to **PROPERTY** owner:

16. Estimated date **HARVESTING** is to be completed:

\_\_\_\_\_  
Property Owner's or Agent's Signature

\_\_\_\_/\_\_\_\_/\_\_\_\_  
Date

\_\_\_\_\_  
Logger's Signature

\_\_\_\_/\_\_\_\_/\_\_\_\_  
Date

\_\_\_\_\_  
Code Enforcement Officer's Signature

\_\_\_\_/\_\_\_\_/\_\_\_\_  
Date

17. Date of completion of **HARVESTING**:

\_\_\_\_/\_\_\_\_/\_\_\_\_

\_\_\_\_\_  
Code Enforcement Officer's Signature

\_\_\_\_/\_\_\_\_/\_\_\_\_  
Date

TOWN OF CATTEN  
**REVOCABLE PERMIT**  
As required by  
Section III of Local Law #\_\_\_\_ of 200\_\_

1. Date of completed **Harvesting** Registration \_\_\_\_\_/\_\_\_\_/\_\_\_\_

2. Control number form associated **Harvesting** Registration \_\_\_\_\_

3. Date that permit fee was collected \_\_\_\_\_/\_\_\_\_/\_\_\_\_

4. **Date that Erosion Control Plan** was accepted as complete \_\_\_\_\_/\_\_\_\_/\_\_\_\_

5. Amount of Security for performance required  
Attach receipt from Town Clerk \_\_\_\_\_

6. Date that this permit is issued \_\_\_\_\_/\_\_\_\_/\_\_\_\_

7. Date that this permit shall expire \_\_\_\_\_/\_\_\_\_/\_\_\_\_

\_\_\_\_\_/\_\_\_\_/\_\_\_\_  
**Code Enforcement Officer's Signature** \_\_\_\_\_ **Date** \_\_\_\_\_

8. Date that this permit is revoked \_\_\_\_\_/\_\_\_\_/\_\_\_\_

9. Reason for revocation in item 6:  
\_\_\_\_\_  
\_\_\_\_\_  
\_\_\_\_\_

10. Inspection date for compliance with **Erosion Control Plan** \_\_\_\_\_/\_\_\_\_/\_\_\_\_

11. Result of inspection \_\_\_\_\_ Satisfactory/Unsatisfactory

12. Reasons for the unsatisfactory inspection and estimated cost for the Town to  
make the indicated corrections:  
\_\_\_\_\_  
\_\_\_\_\_



**TOWN OF CATLIN**  
**SOIL EROSION AND SEDIMENTATION CONTROL PLAN**  
**FOR A TIMBER HARVESTING OPERATION**

As required by  
Section III of Local Law # \_\_\_\_\_ of 200\_\_

1) GENERAL INFORMATION

- A. Control number from registration: \_\_\_\_\_
- B. **Timber** sale area: \_\_\_\_\_ acres
- C. Person(s) responsible for construction and maintenance of earthmoving operations  
and sedimentation controls:

Name(s) \_\_\_\_\_

Address: \_\_\_\_\_

Phone number(s): \_\_\_\_\_

\_\_\_\_\_  
Signature(s) of person(s) responsible

- D. Location and parcel number(s) of **harvest** area

\_\_\_\_\_  
Telephone number(s): \_\_\_\_\_

\_\_\_\_\_  
Signature of person(s) responsible for the **harvest** and **harvesting** plan:

\_\_\_\_\_  
Signature of landowner: \_\_\_\_\_

- 2) Have you obtained a copy of "BEST MANAGEMENT PRACTICES DURING TIMBER  
HARVESTING OPERATIONS"? \_\_\_\_\_ (yes/no)  
If no, contact the Catlin Town Clerk or Chemung County Soil and Water for a copy.

- Signature of Catlin Code Enforcement Officer

2 of 5

Figure 22. Typical Map Symbols

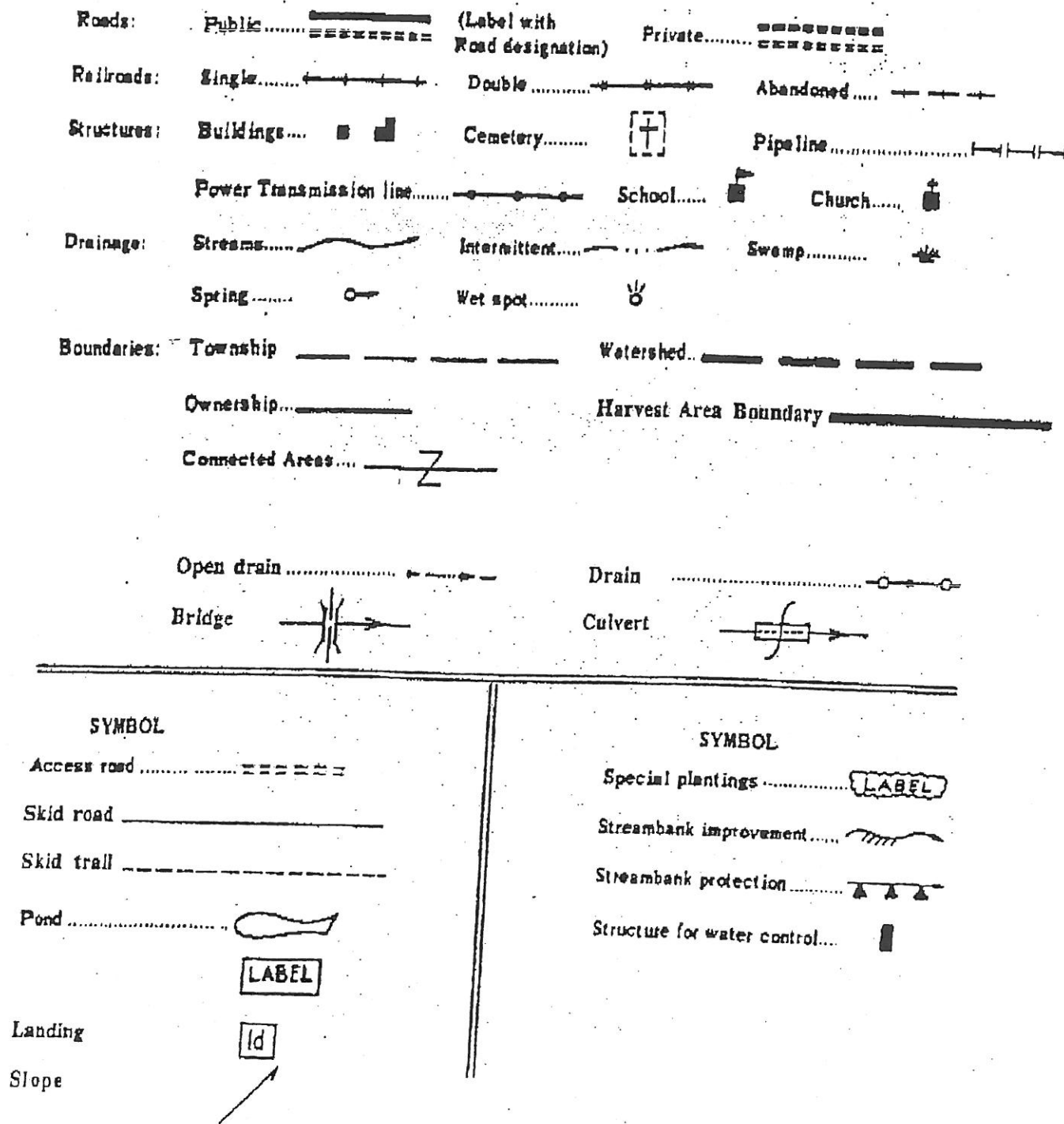



Figure 24. Alternative Map for Soil Erosion and Sedimentation Control Plan

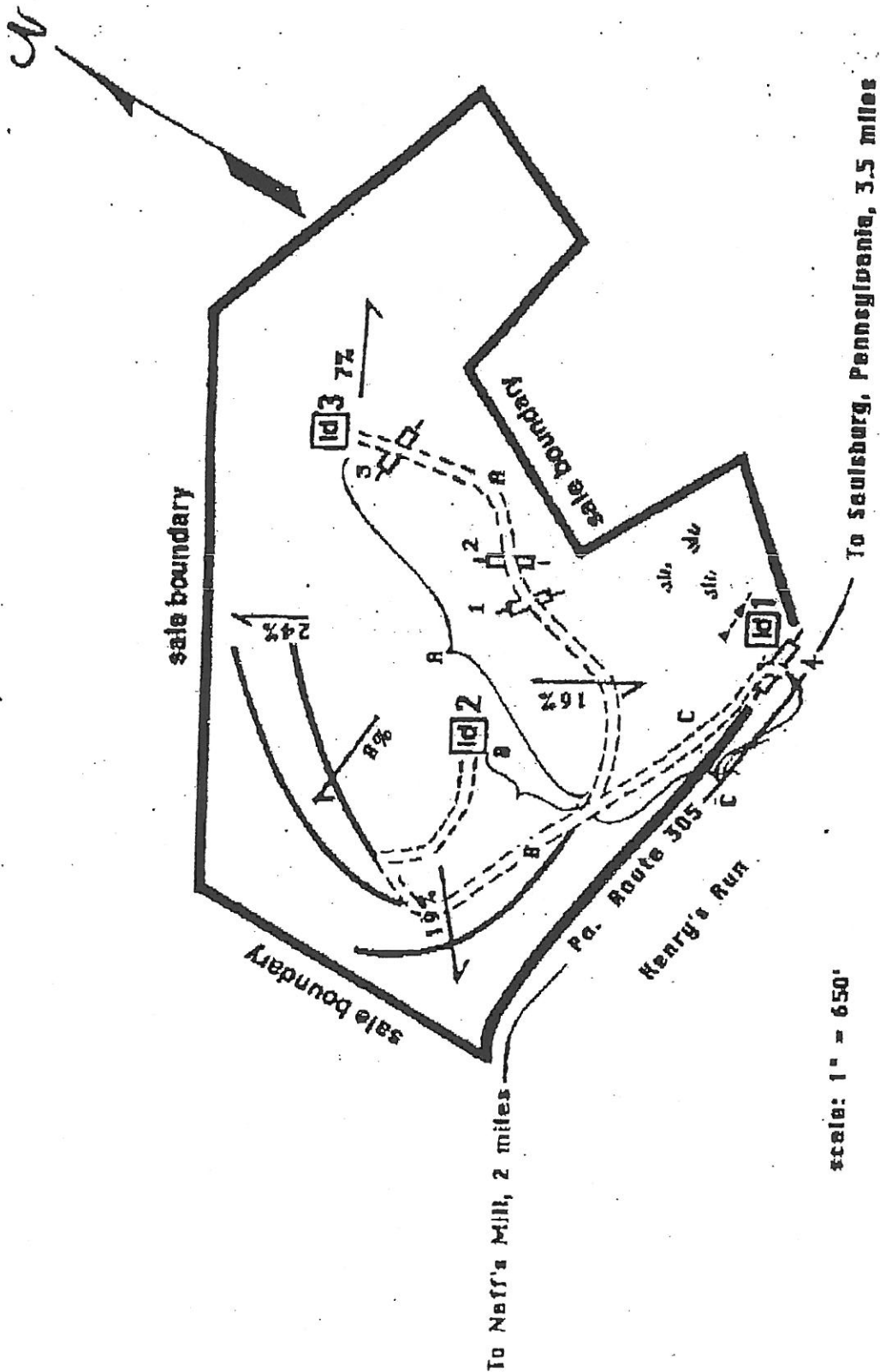

Figure 23. Map for Soil Erosion and Sedimentation Control Plan

