



ZX-Speed RC 3D Tool Setting Probe



Tool Measurement



Radio Transmission



Multidirectional



Wear-free Measuring Mechanism



Tool Breakage Detection



Tool Length Measurement



Tool Radius Measurement



Axes Compensation

3D Tool Setting Probe ZX-Speed RC

BLUM
focus on productivity



ZX-Speed RC | 3D Tool Setting Probe | Tactile tool setting system with BRC radio transmission

Wireless 3D tool setting probe for precise tool measurement

- Tool breakage detection
- Tool length measurement
- Tool radius measurement
- Axes compensation
- Perfect where line of sight between probe and receiver is blocked or intermittent

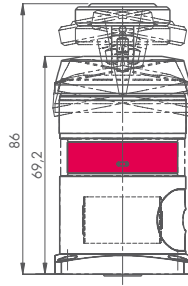

Your benefit:

- Reliable measurement with a wide range of tool types and sizes
- Superior precision due to latest measuring mechanism technology
- No subsequent damage due to tool breakage
- Fast ROI
- Easy pairing procedure between probe and receiver
- Use of up to 6 measuring systems with one receiver
- Extended battery life
- Compact and robust design

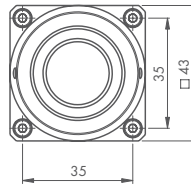

Tool length measurement



Tool radius measurement

Optoelectronic measuring mechanism

- Skip signal is generated via shading of an interior miniature light barrier
- Wear-free signal generation
- Enables higher measuring speeds and accuracy than with conventional probes

Technical data

Protection class	IP68
Approach direction	$\pm X, \pm Y, -Z$
Measuring force in XY Z	3.0 N 5.2 N
Max. deflection in XY Z	$\pm 11^\circ$ 6 mm
Repeatability	0.4 μm 2σ
Max. probing speed	2 m/min
Min. tool diameter	1 mm *
Mass	280 g
Signal transmission	Radio (BRC Technology)
Frequency band	2.4000 ... 2.4835 GHz
Transmission power Range	0 dBm 15 m
Battery (2 pieces)	Saft Lithium LS14250 (1/2 AA, 3.6 V) 1200 mAh

* Depending on geometry and material of tool. Probing force must not result in damage of tool



Sequential use of up to 6 measuring systems with one radio receiver



Optional nozzle for tool cleaning



focus on productivity

Blum worldwide Service & Support

More than 40 subsidiaries and service offices.

www.blum-novotest.com

Blum-Novotest Ltd.

Unit 15 Granary Wharf Business Park
Wetmore Road, Burton upon Trent
Staffordshire, DE14 1DU
United Kingdom
Phone: +44 1283 569691
Fax: +44 1283 563687
info@blum-novotest.co.uk

Blum-Novotest, Inc.

4144 Olympic Boulevard
Erlanger, KY 41018
USA

Phone: +1 (859) 344 6789
Fax: +1 (859) 344 6799
solutions@blum-novotest.us