

# HUNTWOOD<sup>®</sup>

## Cabinet Options



SONORA, Heartwood, Dove.  
Island: Alder, Terra.



**Without Mouldings**



**With Mouldings**

## Creative Mouldings

### Mouldings Turn a Plain Kitchen Into a Designer Kitchen.

Creative mouldings transform cabinets into furniture. Crown mouldings and wall bottom mouldings frame your entire design with a finished look that a true custom kitchen exemplifies.

**Stacked Mouldings** customize your design further by combining mouldings, fillers and/or riser mouldings (see cross sections).

See more examples of creative mouldings in our Catalog under "Accessories, Trim."

## Glass Doors



**Glass Upper**  
MDFGU



**Prairie Mullion Upper**  
MDPMW



**Prairie Mullion**  
MDPM



**X-Mullion**  
MDGMXP



**Geometric Mullion**  
MDGGMG



**Quaker Mullion**  
MDQMG



**Glass Door**  
MDFG



**Glass Mullion**  
MDGM

## 5-Piece Drawer Fronts



*Standard Slab Drawer Front*



*Optional 5-Piece Drawer Front*

### Modify Drawer Front to Raised or Recessed

MDRP

Add elegance to any kitchen by modifying from a standard slab drawer front to an optional 5-piece drawer front that matches your 5-piece door.

*NOTE: Glass is sold separately. See our Factory Glass Program.*



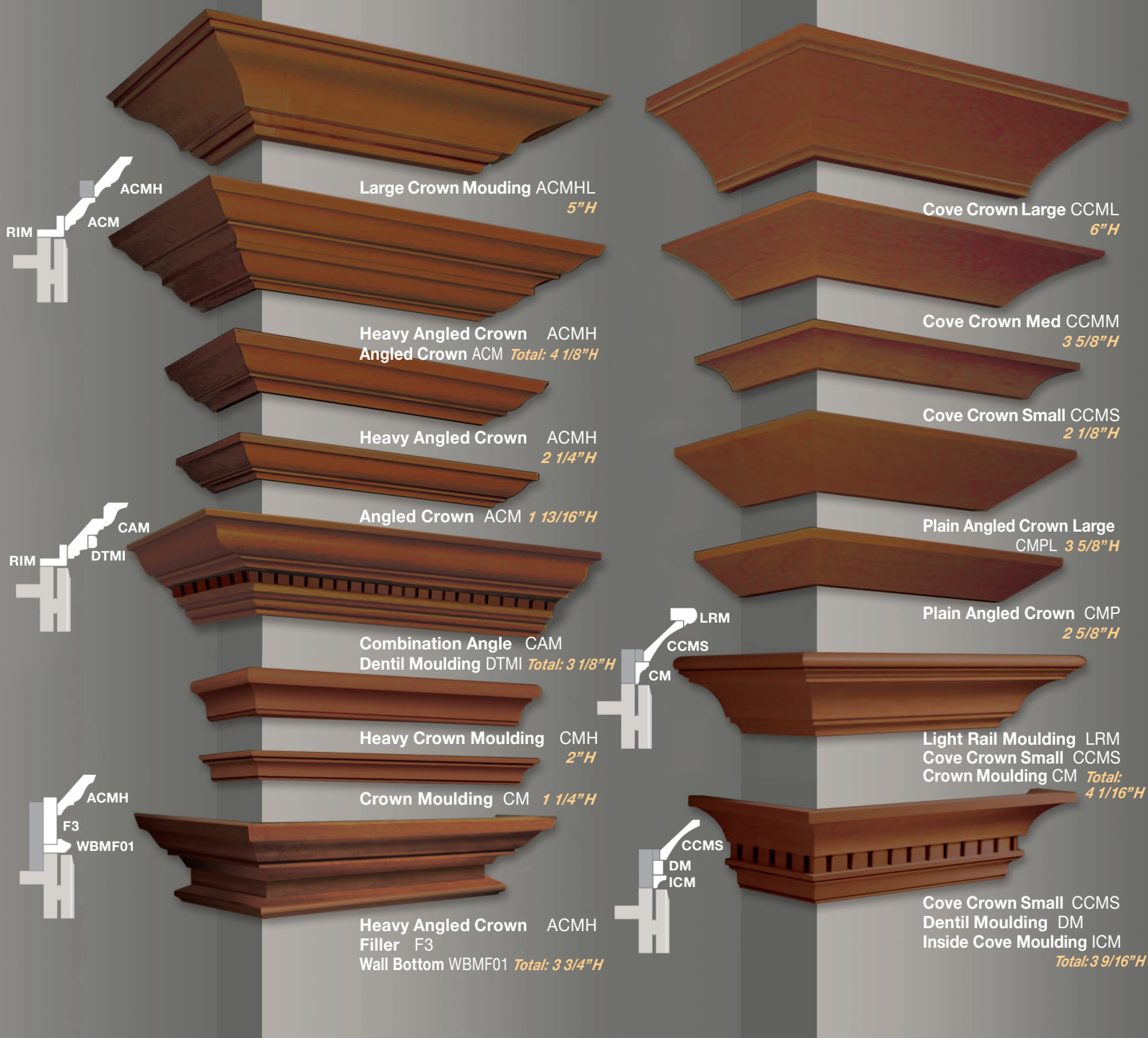

## Drawers and Drawer Guides

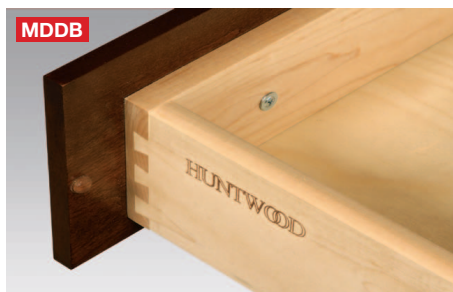

### 5/8" Solid Dovetail

Upgrade from standard dovetail to 5/8" thick solid Maple dovetail drawer, featuring Eastern Hardrock Maple & hand-finished joinery.

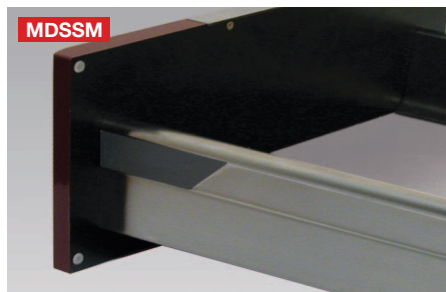

### Metro Drawer Box

Metal sides, integrated full-extension guides w/soft-close. For cabinets with Frameless construction only.



### Full-Extension Guides

Full-extension with soft-close.  
**MDXGHD** Heavy Duty w/ stabilizer bar



# Roll-Out Shelves and Pull-Out Racks



## Standard Roll-Out Shelves

3 3/4" deep roll-out shelves provide full access.



## Deep Roll-Out Shelves

6 1/4" deep roll-out shelves provide full access. Provides more secure storage for taller items.



## Base Pull-Out Spice Rack



## Wall Pull-Out Spice Rack

# Corner Cabinets



## Corner w/ Deep Wood Susans



## Square Corner w/ Susans



## Corner w/ Wood Lazy Susans



## Angled Corner w/ Poly Susans



## Corner w/ Polymer Susans



## 3-Drawer Corner Cabinet



## Waste/Recycle Bins



2-Bin Waste/Recycle



Base High Waste/Recycle



3-Bin Recycle Center



Door Mount 1+ Bin

## Tall Options



Pantry Roll-Out



Pantry Pull-Out



Vertical Divider



Pin Doors Together

## Wall Range Hoods



Wall Hood, Large



Wall Hood H



Custom Hood, Plain



Storefront Hood A



Custom Hood with Shiplap



# Wine Racks and More



Wine Cubby



Wall Qtr Wine Storage



Diagonal Wine Storage



Base High Towel Rack



Wall Lattice Wine Cabinet



Wine Rack Kit, Scalloped Wood Stemware Holder



Wall Apothecary Drawer Cabinet

# Drawer Accessories and Options



Breadboard/Cutlery



Wood Cutlery Tray



Wood Knife Block



Wood Spice Insert



Utensil Drawer Liner



Drawer Box Dividers



Kitchenware Organizer



Cabinet w/ Docking Drawer



**Breadboard & Drawers**  
Solid hardwood breadboard pulls out.



**Base Warming Drawer**  
Custom cut-out fits most warming drawers.



**Base Microwave Cabinet**  
Custom cut-out fits most base microwaves.



**Routed for Finger Pulls**  
Finger routes on drawers and doors.



# Spice Racks and Pull-Outs



**Nickel Spice Rack**  
Frosted nickel wire spice rack.



**Wood Spice Racks**  
Wood spice shelves & chrome rails.



**Pull-Out Spice Rack**  
3" to 6" pull-out for spice storage.



**Pull-Out Peg Board**  
Stainless steel panel, hooks & pegs.

# Tray Dividers



**Base Wire Divider**



**Base High Rollout Tray Divider**



**Base Roll-Out Divider**



**Wall Wood Divider**



**Wall Nickel Tray Dividers**

# Finished Backs and Ends



**Flat Flush Finish Back Panel**



**Raised or Recessed Finished Back Panel**



**Flat Flush Finished End**  
Finished end is flush with face frame.



**Decorative Finished End Panel**  
With raised or recessed panel.



**Plant-on Door**  
Finished end w/plant-on door.  
**MEPOD** Flush with front door.



# Interior Options



SPILMTL

## Loose Polystyrene Spill Mat

Small divots in the mat work to capture spilled liquids.

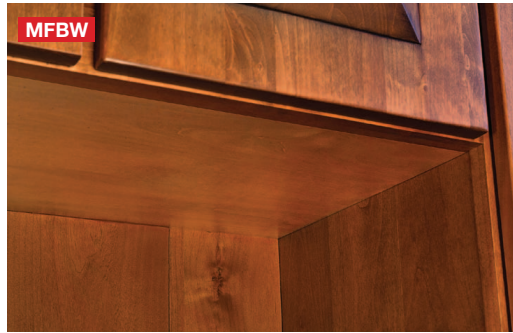

MFBW

## Finished Bottom Wall Cabinet



MFIC

## Finished Interior

Same wood & color as exterior.

# Floating Vanity



MVBSA

## Floating Vanity Modification

Modifies back for suspended application. Deletes toekick.

# Apron Sink



BFAS

## Farmers Apron Sink Cabinet

Base Farmers Apron Sink Cabinet

# Pilaster



PPBFT

## Plain Pilaster

# 1-Piece Construction



MOPCS

MFTKC

## 1-Piece Construction Flush Craftsman Toekick

# Toekicks/Feet



MFTKA

## Flush Arched Toekick



MFTKO

## Flush Double Arch w/Ogee Toekick



MRTK

## Recessed Toekick MRTKE End, MRTKB Back



MASF

## Square Foot

Applied over recessed toekick.



MATF

## Tapered Foot

Applied over recessed toekick.



MAHF

## Hampton Corner Foot

Applied over recessed toekick.



**HUNTWOOD**<sup>®</sup>

WOOD IN ITS FINEST FORM

23800 E. Appleway Avenue  
Liberty Lake, WA USA  
509.924.5858  
800.873.7350

[www.huntwood.com](http://www.huntwood.com)  
POPT NCG4K6/20



80% Waste  
Reutilization



Committed to  
Sustainable  
Resources