

Snap Track Patented Push Pin

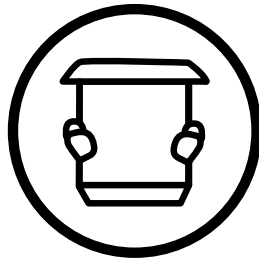

Patent Number: 6,872,039

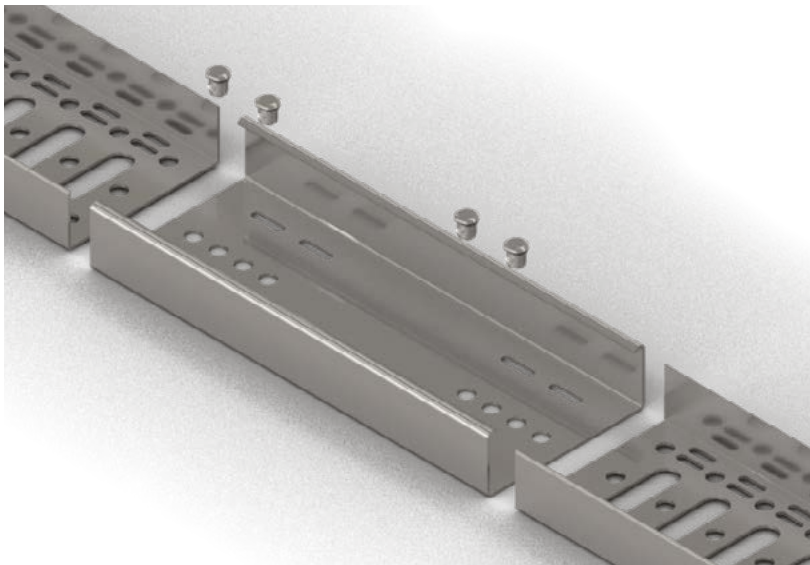

Snap Track Push Pin

The Push Pin eliminates bolts and nuts and does not require tools for assembly, thereby greatly speeding the installation of the Snap Track system.

Dual spring-loaded plungers and a tapered insertion ramp allow the pin to easily push into place. The vertical face at the rear of the plunger prevents the pin from backing out once engaged.

All Snap Track fittings and tray have been tested and UL Classified using the Patented Snap Track Push Pin



Push Pin



STSLP-9-22-T

9/16"

All Snap Track fittings are provided with the appropriate number of Push Pins. Only order P/N STSLP-9-22-T when additional pins are required.

Installation Guideline: with the 9/16" round holes on the cable tray and the splice lined up, press the Push Pins into the holes. You will hear a click when the pins are secure. Two pins are to be installed on each side of the splice. Repeat the process until all pins provided are used.

Thermal Expansion

It is important to consider thermal contraction and expansion when installing cable tray systems. The length of the straight cable tray run and the temperature differential govern the number of expansion splice plates required.

Temperature Differential		Maximum Distance	
C	(F)	M	(Feet)
14	(25)	79	(260)
28	(50)	40	(130)
42	(75)	27	(87)
56	(100)	20	(65)
70	(125)	16	(52)
83	(150)	13	(43)

* The temperature differential is the difference in the temperature between the hottest and coldest days of the year.

The cable tray should be anchored with hold-down clamps at the support nearest to its midpoint between expansion splice plates and secured by expansion guides at all other support locations. The cable tray should be permitted longitudinal movement in both directions from that fixed point.

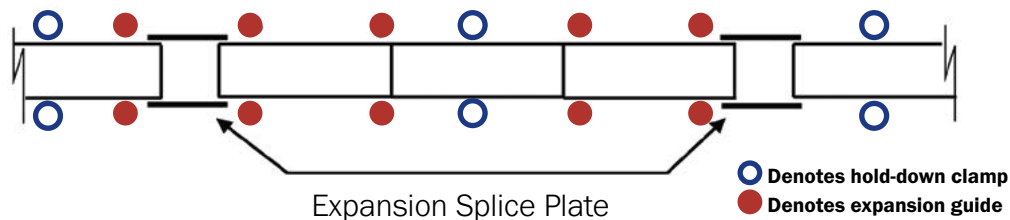

Note: All Snap Track splices are provided with four 1 1/4" X 0.312" slots and are designed for use as expansion splices. The 1 1/4" slot also eliminates the need for gap calculations based on temperature differentials. See fasteners for appropriate installation hardware. A bonding jumper is required at each expansion joint.

* See accessories page 65 for Expansion Guides & page 85 for Hold Down clamps.

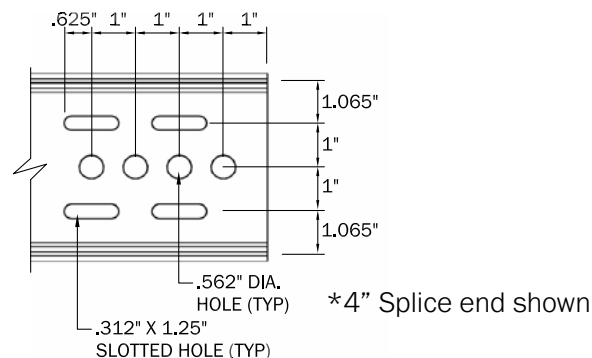

Snap Track Splices

Splice

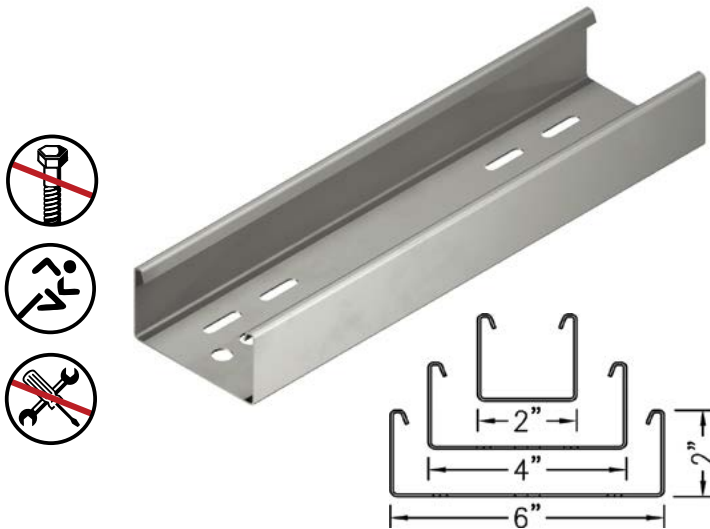

	W	D	L	
Channel Splice*				
STCS-2-2-AL	2"	2"	16"	1 LB
STCS-4-2-AL	4"	2"	16"	1 LB
STCS-6-2-AL	6"	2"	16"	2 LBS

Note:

Four push pins supplied with each fitting
 Round holes 9/16"
 Slotted holes 0.312" X 1.25"

**Splice may also be used for expansion joints.*

EJBK-SS

Expansion Splice Hardware Kit

Each kit contains:

- (6) 1/4" x 3/4" SS Phil Pan Head Bolt
- (6) 1/4" SS Nylon Insert Lock Nuts and
- (6) 1/4" SS Flat Washers

Installation Guideline:

When assembling expansion joints use hardware kit EJBK-SS. Tighten carriage bolt and nylon lock nut then back off 1/4 turn.

Bonding Jumpers should be installed with all expansion splices. See page 78.

Patented Push Pins are provided for a secure attachment.



Installation Guideline:

For maximum strength, insert pin using the first and third hole from each end.

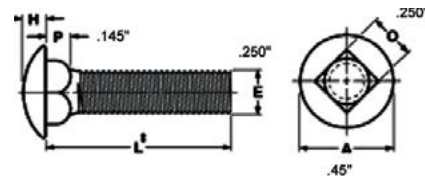
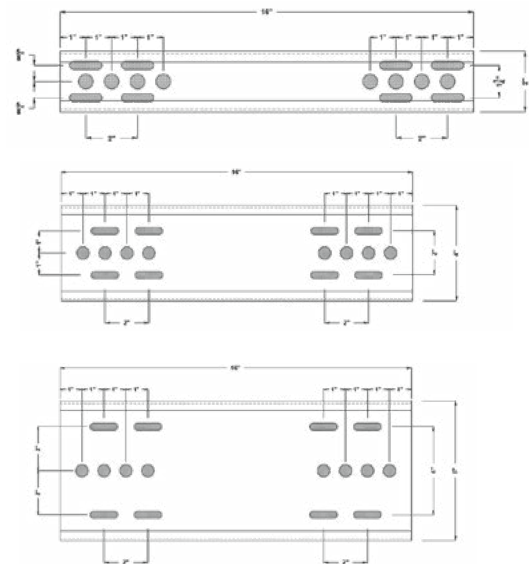

*** Note:** Use slotted holes, hardware kit EJBK-SS, and a Bonding Jumper ST0203-14-07-36-1 when expansion joints are required.



TechLine® MFG.

Snap Track Reducing and Plane Adapters



Patented Push Pins are provided for a secure attachment.



Installation Guideline:

For maximum strength insert pin using the first and third hole from each end.

Round holes 9/16"
Slotted Holes 0.312" x 1.25"

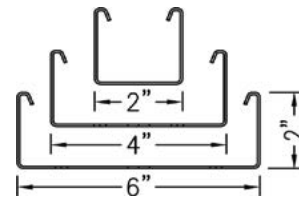

Plane Adapter Top View

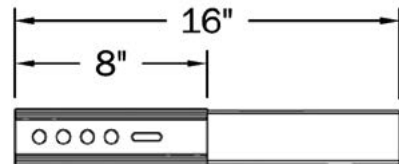

STPAS-2-2-BK

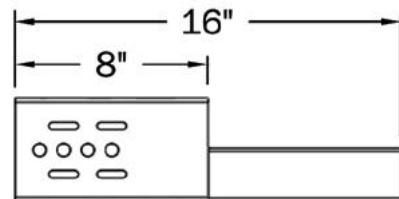

STPAS-4-2-RH

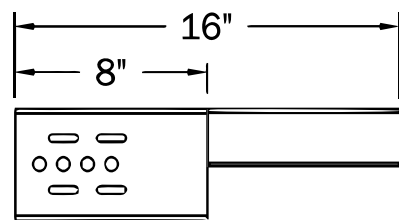

STPAS-4-2-LH

Reducing and Plane Adapters				
Reducing Adapter				
STRAS-4-2-AL-RH	4"	2"	16"	2 LBS
STRAS-6-2-AL-RH	6"	2"	16"	2 LBS
STRAS-6-4-AL-RH	6"	4"	16"	2 LBS
STRAS-4-2-AL-LH	4"	2"	16"	2 LBS
STRAS-6-2-AL-LH	6"	2"	16"	2 LBS
STRAS-6-4-AL-LH	6"	4"	16"	2 LBS
Plane Adapter				
STPAS-2-2-AL-RH	2"	2"	16"	2 LBS
STPAS-4-2-AL-RH	4"	2"	16"	2 LBS
STPAS-6-2-AL-RH	6"	2"	16"	2 LBS
STPAS-2-2-AL-LH	2"	2"	16"	2 LBS
STPAS-4-2-AL-LH	4"	2"	16"	2 LBS
STPAS-6-2-AL-LH	6"	2"	16"	2 LBS
STPAS-2-2-AL-BK	2"	2"	16"	2 LBS
STPAS-4-2-AL-BK	4"	2"	16"	2 LBS
STPAS-6-2-AL-BK	6"	2"	16"	2 LBS



Snap Track Adjustable Splices

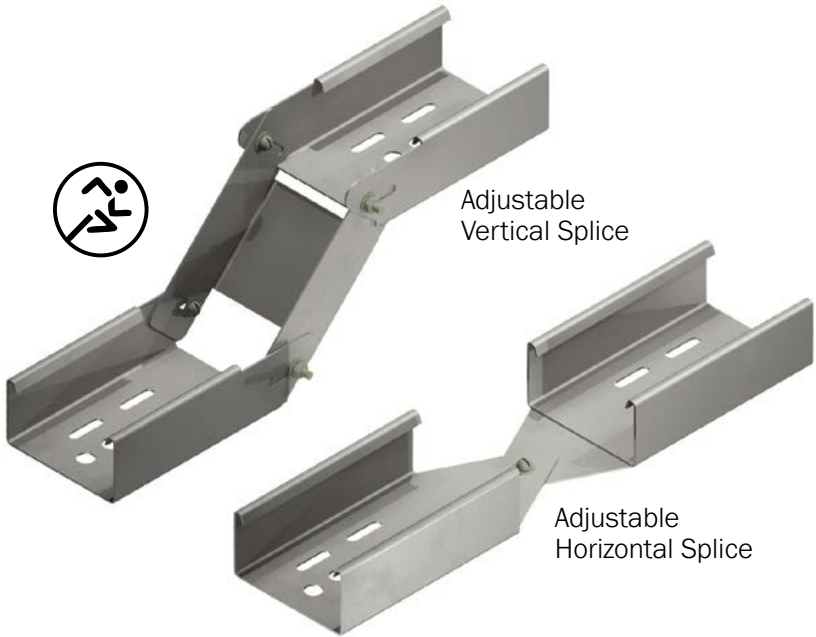

Patented Push Pins are provided for a secure attachment.



Installation Guideline:

Adjustable Splices allow for offset changes in the vertical direction or an adjustable radius in the horizontal direction.

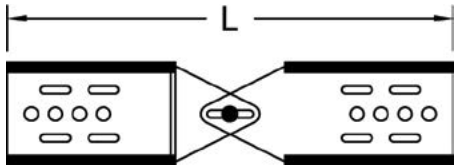
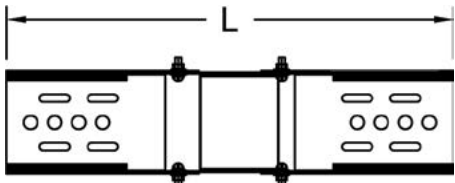
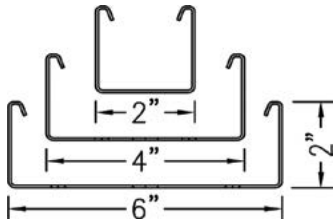

Adjustable Splices				
Adjustable Vertical Splice				
STAVS-2-2-AL	2"	2"	23"	2 LBS
STAVS-4-2-AL	4"	2"	20"	2 LBS
STAVS-6-2-AL	6"	2"	20"	2 LBS
Adjustable Horizontal Splice*				
STAHS-2-2-AL	2"	2"	20"	2 LBS
STAHS-4-2-AL	4"	2"	19.5"	2 LBS
STAHS-6-2-AL	6"	2"	19.5"	2 LBS

* Sidewall strip available for STAHS

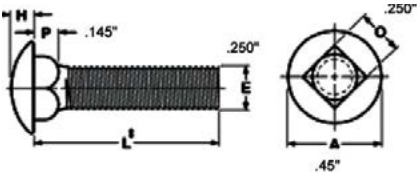

Note: Use slotted holes, hardware kit EJBK-SS, and a Bonding Jumper ST0203-14-07-36-1 when expansion joints are required.

Bonding Jumper

Note: A Bonding Jumper is recommended for electrical continuity. See accessory section for bonding jumpers.

ST0203-14-07-36-1
See page 78.



Snap Track 3" Radius Elbow



Patented Push Pins are provided for a secure attachment.



See Splice for hole detail page 43.

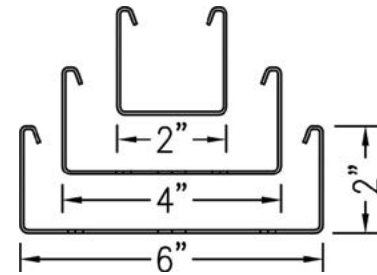

	W —	D	L /	R ⌚	Person
3" Radius Elbow					
Vertical Outside Elbow					
STVO-2-2-AL-3R	2"	2"	14"	3"	2 LBS
STVO-4-2-AL-3R	4"	2"	14"	3"	2 LBS
STVO-6-2-AL-3R	6"	2"	14"	3"	3 LBS
Vertical Inside Elbow					
STVI-2-2-AL-3R	2"	2"	14"	3"	2 LBS
STVI-4-2-AL-3R	4"	2"	14"	3"	2 LBS
STVI-6-2-AL-3R	6"	2"	14"	3"	3 LBS
Horizontal Elbow					
STHE-2-2-AL-3R	2"	2"	14"	3"	2 LBS
STHE-4-2-AL-3R	4"	2"	16"	3"	3 LBS
STHE-6-2-AL-3R	6"	2"	18"	3"	4 LBS

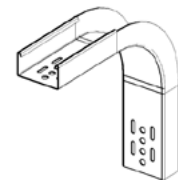
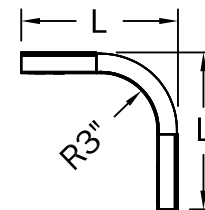

90° Vertical Outside 3" Radius

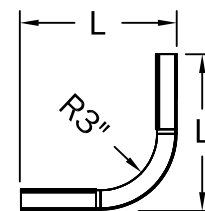

90° Vertical Inside 3" Radius

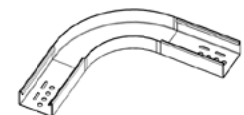
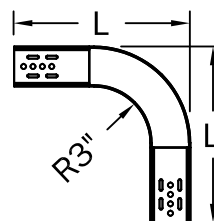

90° Horizontal 3" Radius



Snap Track 6" Radius Elbow

6" Radius Elbow



Patented Push Pins are provided for a secure attachment.



See Splice for hole detail page 43.

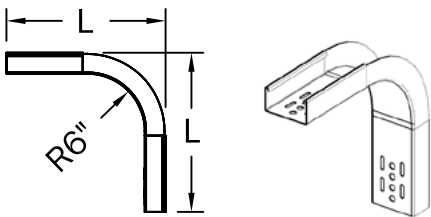
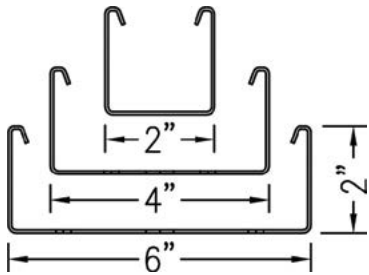

90° Vertical Outside 6" Radius

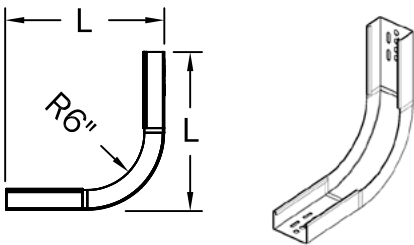

90° Vertical Inside 6" Radius

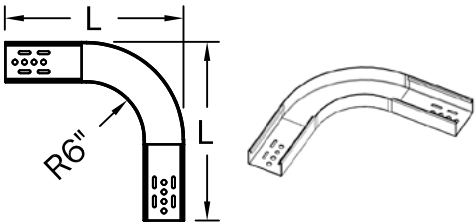

90° Horizontal 6" Radius

6" Radius Elbow

Vertical Outside Elbow

STVO-2-2-AL-6R	2"	2"	17"	6"	2 LBS
STVO-4-2-AL-6R	4"	2"	17"	6"	3 LBS
STVO-6-2-AL-6R	6"	2"	17"	6"	4 LBS

Vertical Inside Elbow

STVI-2-2-AL-6R	2"	2"	17"	6"	2 LBS
STVI-4-2-AL-6R	4"	2"	17"	6"	3 LBS
STVI-6-2-AL-6R	6"	2"	17"	6"	4 LBS

Horizontal Elbow

STHE-2-2-AL-6R	2"	2"	17"	6"	2 LBS
STHE-4-2-AL-6R	4"	2"	19"	6"	3 LBS
STHE-6-2-AL-6R	6"	2"	21"	6"	4 LBS



Snap Track 12" Radius Elbow

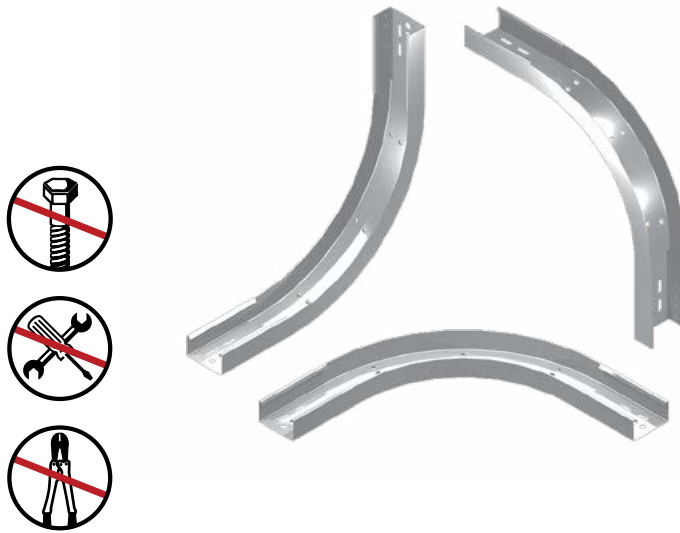

Patented Push Pins are provided for a secure attachment.



See Splice for hole detail page 43.

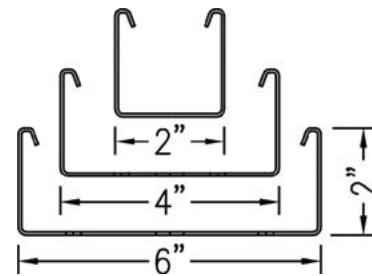

12" Radius Elbow

Vertical Outside Elbow

STVO-2-2-AL-12R	2"	2"	23"	12"	3 LBS
STVO-4-2-AL-12R	4"	2"	23"	12"	4 LBS
STVO-6-2-AL-12R	6"	2"	23"	12"	5 LBS

Vertical Inside Elbow

STVI-2-2-AL-12R	2"	2"	22.5"	12"	3 LBS
STVI-4-2-AL-12R	4"	2"	22.5"	12"	4 LBS
STVI-6-2-AL-12R	6"	2"	22.5"	12"	5 LBS

Horizontal Elbow

STHE-2-2-AL-12R	2"	2"	23"	12"	3 LBS
STHE-4-2-AL-12R	4"	2"	25"	12"	4 LBS
STHE-6-2-AL-12R	6"	2"	27"	12"	5 LBS

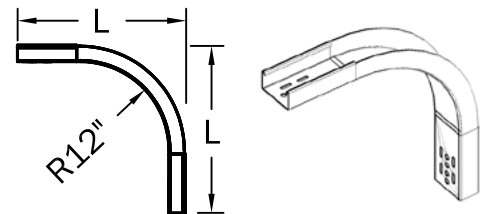

90° Vertical Outside 12" Radius

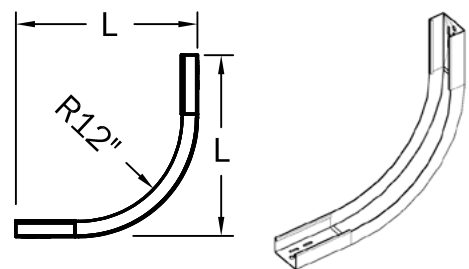

90° Vertical Inside 12" Radius

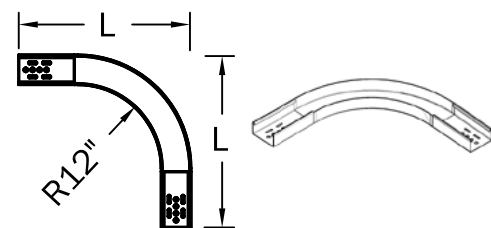

90° Horizontal 12" Radius



Snap Track 24" Radius Elbow

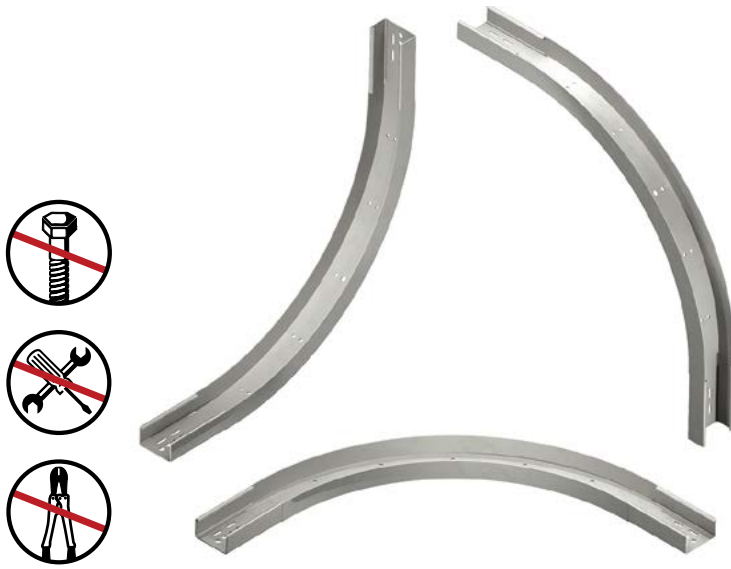

Patented Push Pins are provided for a secure attachment.



See Splice for hole detail page 43.

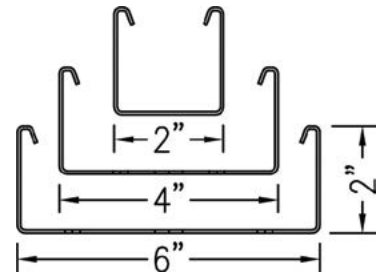

	W —	D	L /	R ⌚	Person
24" Radius Elbow					
Vertical Outside Elbow					
STVO-2-2-AL-24R	2"	2"	35"	24"	5 LBS
STVO-4-2-AL-24R	4"	2"	35"	24"	6 LBS
STVO-6-2-AL-24R	6"	2"	35"	24"	7 LBS
Vertical Inside Elbow					
STVI-2-2-AL-24R	2"	2"	35"	24"	5 LBS
STVI-4-2-AL-24R	4"	2"	35"	24"	6 LBS
STVI-6-2-AL-24R	6"	2"	35"	24"	7 LBS
Horizontal Elbow					
STHE-2-2-AL-24R	2"	2"	35"	24"	5 LBS
STHE-4-2-AL-24R	4"	2"	37"	24"	6 LBS
STHE-6-2-AL-24R	6"	2"	39"	24"	7 LBS

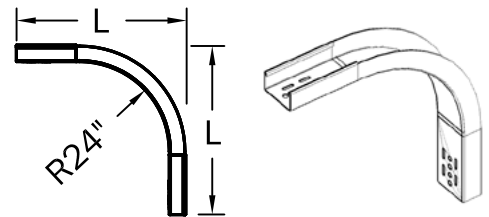

90° Vertical Outside 24" Radius

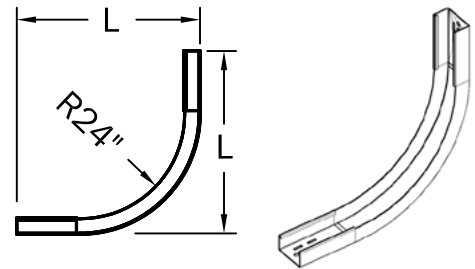

90° Vertical Inside 24" Radius

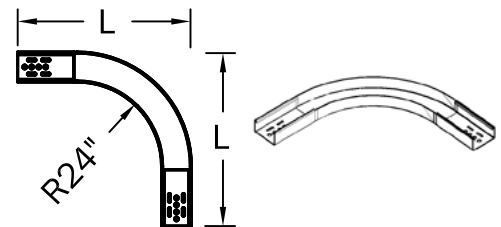

90° Horizontal 24" Radius



Snap Track 36" Radius Elbow



Patented Push Pins are provided for a secure attachment.



See Splice for hole detail page 43.

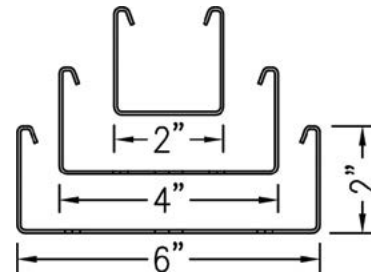

	W	D	L	R	
36" Radius Elbow					
Vertical Outside Elbow					
STVO-2-2-AL-36R	2"	2"	47"	36"	7 LBS
STVO-4-2-AL-36R	4"	2"	47"	36"	9 LBS
STVO-6-2-AL-36R	6"	2"	47"	36"	10 LBS
Vertical Inside Elbow					
STVI-2-2-AL-36R	2"	2"	47"	36"	7 LBS
STVI-4-2-AL-36R	4"	2"	47"	36"	9 LBS
STVI-6-2-AL-36R	6"	2"	47"	36"	10 LBS
Horizontal Elbow					
STHE-2-2-AL-36R	2"	2"	47"	36"	7 LBS
STHE-4-2-AL-36R	4"	2"	49"	36"	9 LBS
STHE-6-2-AL-36R	6"	2"	51"	36"	10 LBS

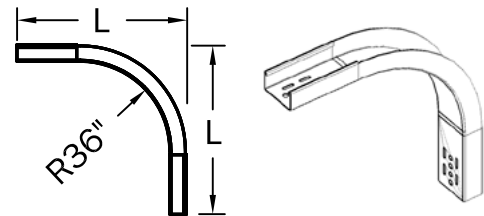

90° Vertical Outside 36" Radius

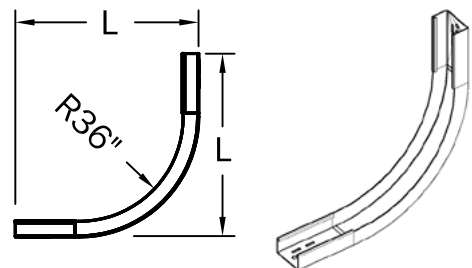

90° Vertical Inside 36" Radius

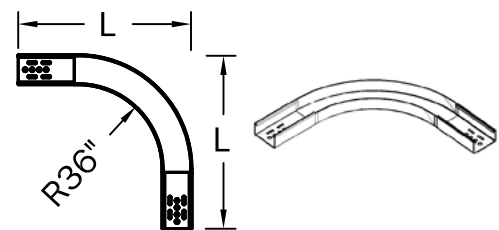

90° Horizontal 36" Radius



Snap Track 3", 6" & 12" Radius Tee

Tee



Patented Push Pins are provided for a secure attachment.



See Splice for hole detail page 43.

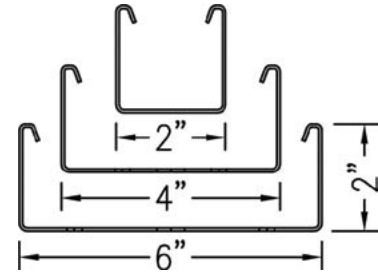

	W	D	L	A	R	
Tee						
3" Radius Tee						
STCT-2-2-AL-3R	2"	2"	24.5"	13.5"	3"	3 LBS
STCT-4-2-AL-3R	4"	2"	26.5"	15.5"	3"	4 LBS
STCT-6-2-AL-3R	6"	2"	28.5"	17.5"	3"	5 LBS
6" Radius Tee						
STCT-2-2-AL-6R	2"	2"	31"	17"	6"	4 LBS
STCT-4-2-AL-6R	4"	2"	33"	19"	6"	5 LBS
STCT-6-2-AL-6R	6"	2"	35"	21"	6"	6 LBS
12" Radius Tee						
STCT-2-2-AL-12R	2"	2"	43.5"	23"	12"	6 LBS
STCT-4-2-AL-12R	4"	2"	45.5"	25"	12"	7 LBS
STCT-6-2-AL-12R	6"	2"	47.5"	27"	12"	8 LBS

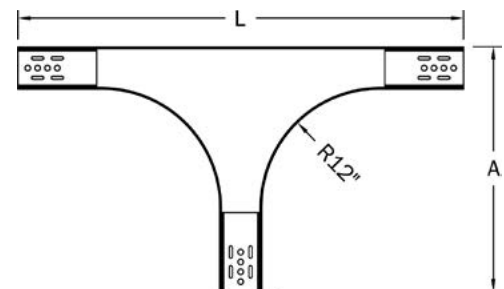
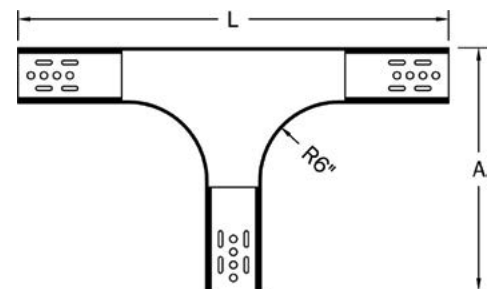
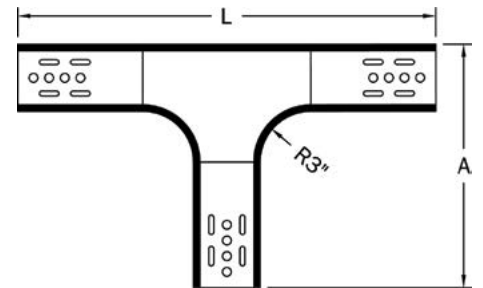

Snap Track 24" & 36" Radius Tee



Patented Push Pins are provided for a secure attachment.



See Splice for hole detail page 43.

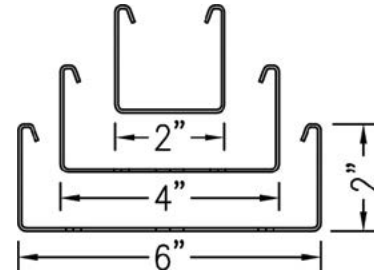

Tee						
24" Radius Tee						
STCT-2-2-AL-24R	2"	2"	67"	34"	24"	10 LBS
STCT-4-2-AL-24R	4"	2"	69"	36"	24"	13 LBS
STCT-6-2-AL-24R	6"	2"	71"	38"	24"	15 LBS
36" Radius Tee						
STCT-2-2-AL-36R	2"	2"	91"	46"	36"	17 LBS
STCT-4-2-AL-36R	4"	2"	93"	48"	36"	20 LBS
STCT-6-2-AL-36R	6"	2"	95"	50"	36"	23 LBS

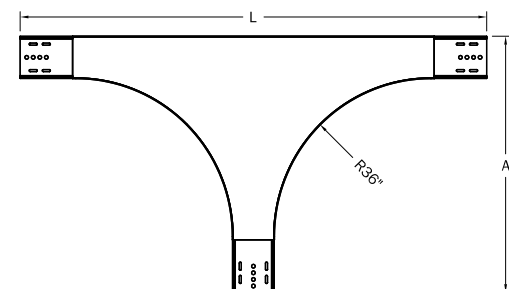
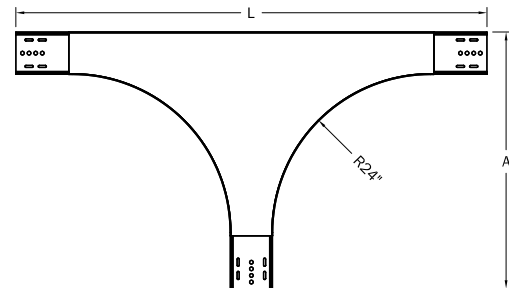

Snap Track 3", 6" & 12" Radius Cross

Cross



Patented Push Pins are provided for a secure attachment.



See Splice for hole detail page 43.

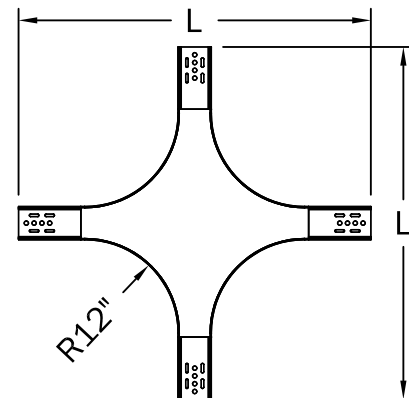
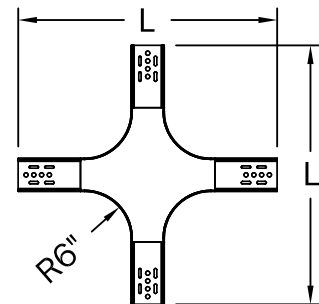
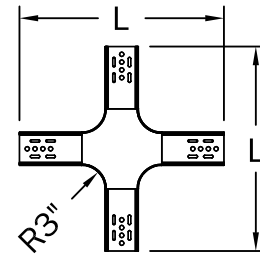
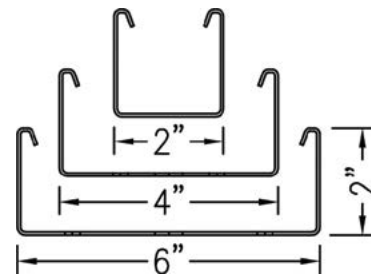

Cross					
3" Radius Cross					
STCC-2-2-AL-3R	2"	2"	24.5"	3"	4 LBS
STCC-4-2-AL-3R	4"	2"	26.5"	3"	5 LBS
STCC-6-2-AL-3R	6"	2"	28.5"	3"	6 LBS
6" Radius Cross					
STCC-2-2-AL-6R	2"	2"	31"	6"	6 LBS
STCC-4-2-AL-6R	4"	2"	33"	6"	7 LBS
STCC-6-2-AL-6R	6"	2"	35"	6"	8 LBS
12" Radius Cross					
STCC-2-2-AL-12R	2"	2"	43"	12"	9 LBS
STCC-4-2-AL-12R	4"	2"	45"	12"	10 LBS
STCC-6-2-AL-12R	6"	2"	47"	12"	12 LBS

Snap Track 24" & 36" Radius Cross



Patented Push Pins are provided for a secure attachment.



See Splice for hole detail page 43.

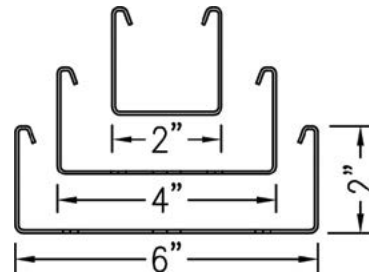

	W	D	L	R	
Cross					
24" Radius Cross					
STCC-2-2-AL-24R	2"	2"	67"	24"	19 LBS
STCC-4-2-AL-24R	4"	2"	69"	24"	23 LBS
STCC-6-2-AL-24R	6"	2"	71"	24"	26 LBS
36" Radius Cross					
STCC-2-2-AL-36R	2"	2"	91"	36"	27 LBS
STCC-4-2-AL-36R	4"	2"	93"	36"	31 LBS
STCC-6-2-AL-36R	6"	2"	95"	36"	36 LBS

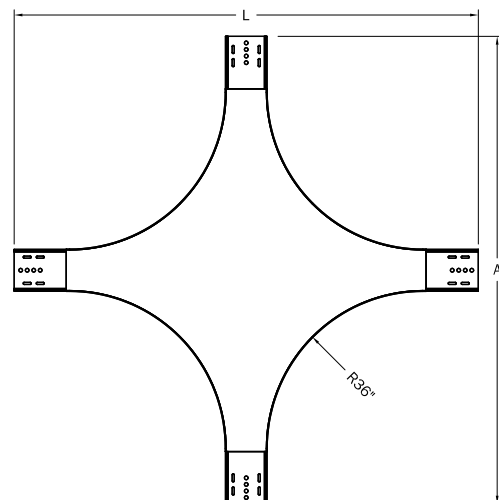
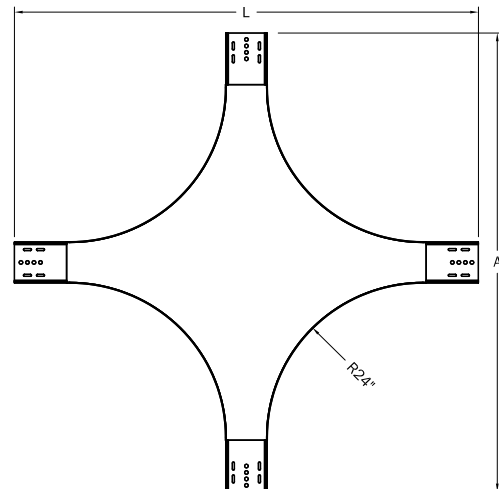

Snap Track Waterfall Exit Fittings



Waterfall Transitions		
Vertical Transitions		
STWF-2-2-AL-6R	2"	2"
STWF-4-2-AL-6R	4"	2"
STWF-6-2-AL-6R	6"	2"

6R standard or larger upon request.

Patented Push Pins are provided for a secure attachment.



See Splice for hole detail page 43.

Waterfall Exit Fittings:

Assembles onto any size **Snap Track** tray spilling over the side and transitioning into a vertical tray. Waterfalls mount directly to existing tray without alterations or tools.

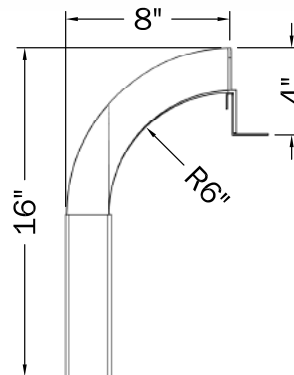
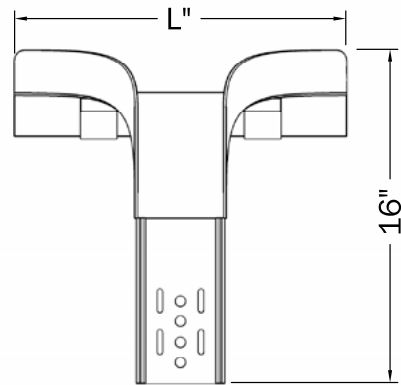

Drawing represents 6" radius



Snap Track Downspout Exit Fittings



Patented Push Pins are provided for a secure attachment.



See Splice for hole detail page 43.

Downspout Exit Fittings:

Create a 90° 2" X 2" spill out transition from the center of a horizontal or vertical run. The fittings maintain a 3" bend radius controlled throughout the transition to the downspout.

Downspout Exit

	W	D	L	
Downspout Transitions				
Vertical Transitions				
STDE-4-2-AL-*_*	4"	2"	22"	3 LBS
STDE-6-2-AL-*_*	6"	2"	22"	3.5 LBS

**Consult Factory for Larger Radius Fittings.

*3R or *6R

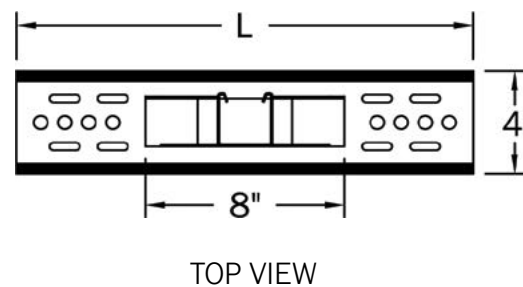
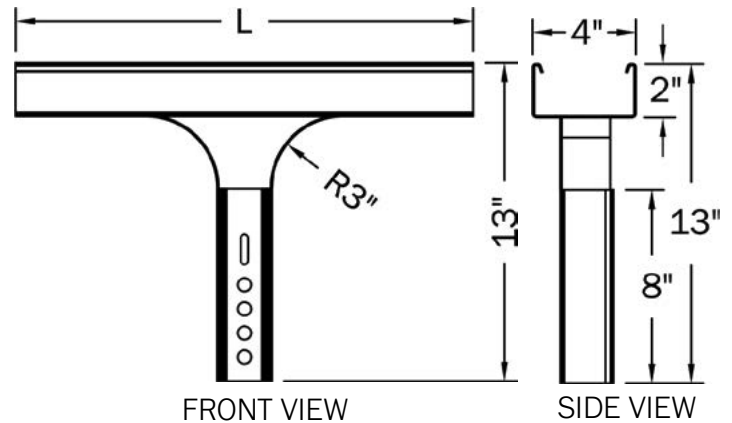

Drawing represents 3" radius



Snap Track Drop Tee Fittings

Drop Tee



Patented Push Pins are provided for a secure attachment.



Drop Tee Fitting

Example: STDT - * - * - AL - *R

Basic Part:
SnapTrack Drop Tee Fitting

Width of Run Fitting:
(2", 4" or 6")

Bottom Size of Drop Fitting:
(2", 4" or 6")

Material Finish: Aluminum

Radius of Drop:
(6" or 12")

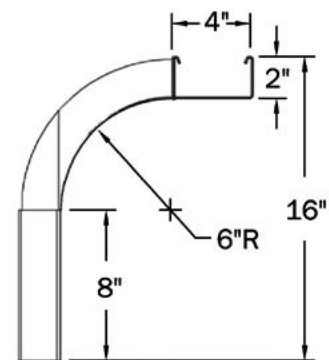
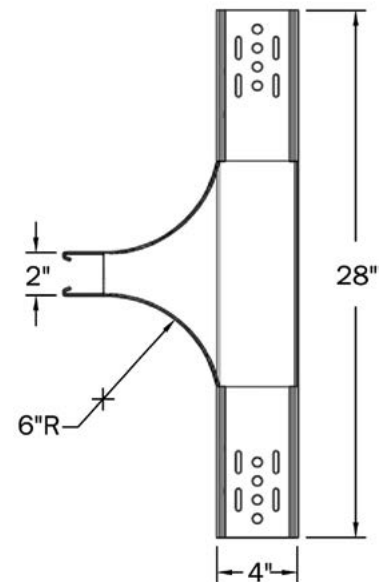
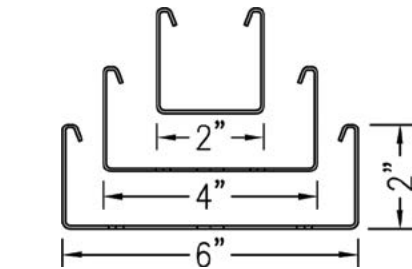

SIDE VIEW

Drawing represents 6" radius



Snap Track Conduit Outlet Fittings



Conduit Outlet Sections:

Patented Push Pins are provided for a secure attachment.



Allows for a direct conduit connection to any size **Snap Track** tray. 3/4" and 1" conduit knockouts are located on each side rail to provide for up to four conduit entries.

Conduit Outlet Section				
STCOS-2-2-AL	2"	2"	16"	1 LB
STCOS-4-2-AL	4"	2"	16"	2 LBS
STCOS-6-2-AL	6"	2"	16"	3 LBS

Note: Knock-outs provide for the attachment of conduit to the cable tray. If a UL Listed connector is not used the fitting will provide only a mechanical connection, not an electrical connection. In order to make an electrical connection, a bonding jumper must first be run from the conduit to the cable tray.



Conduit Knockout Grommet(s)
See page 73.

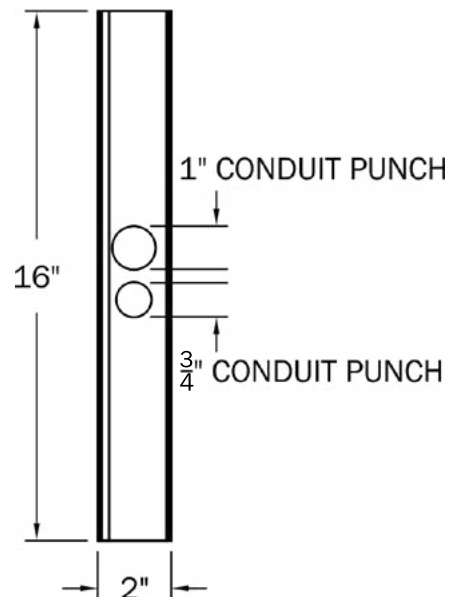

NOTES:

[illegible]

TechLine[®]
MFG.

SNAP TRACK Accessories

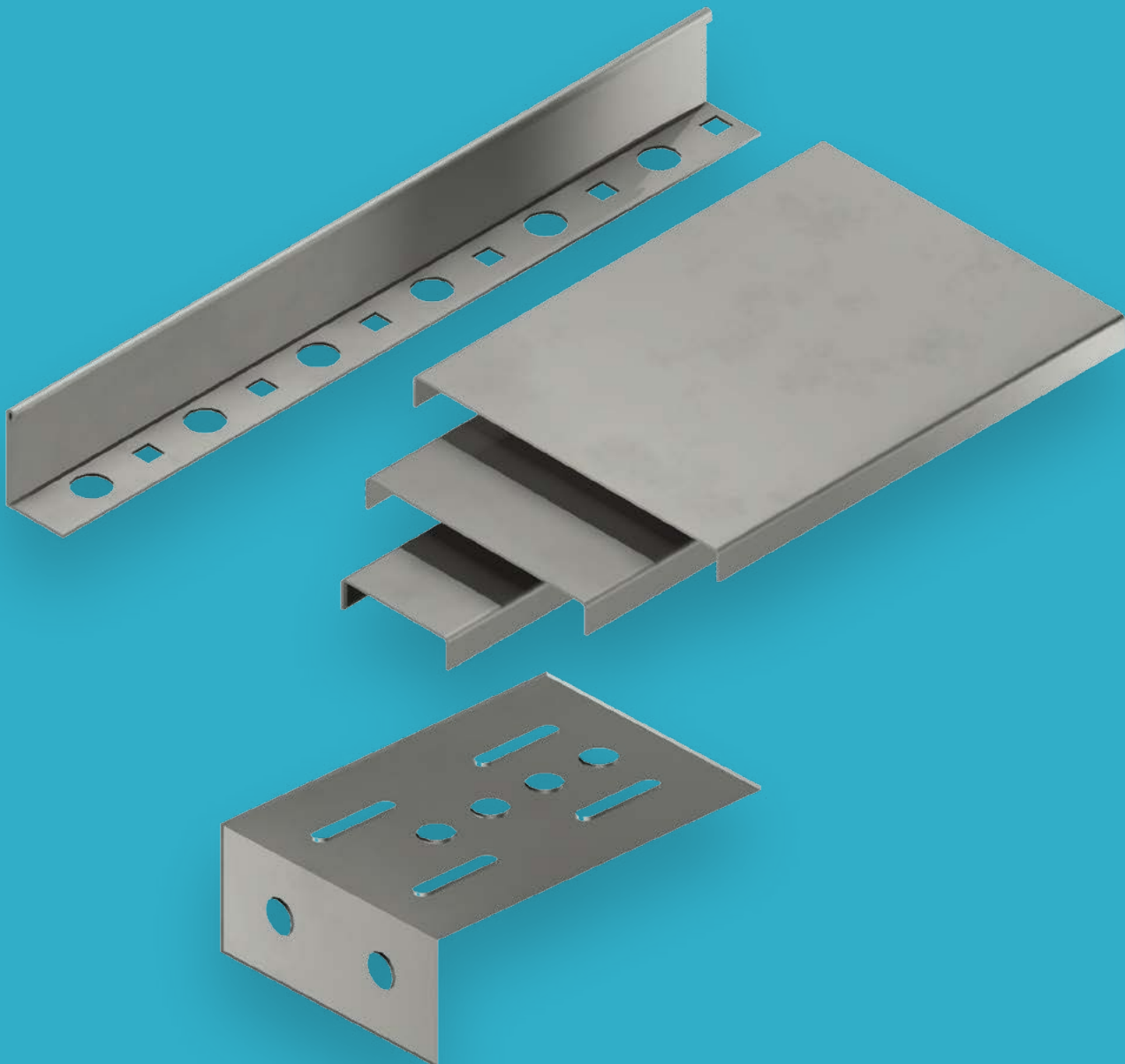

Snap Track Covers

May be used for additional **cable protection**.



Snap Track Covers are designed to fit both **Snap Track** Tray and Splices

Fabricated from 0.032" 21 Gauge Aluminum

Covers				
STCV-2-AL	2.30"	0.5"	10'	2 LBS
STCV-4-AL	4.30"	0.5"	10'	4 LBS
STCV-6-AL	6.30"	0.5"	10'	6 LBS

Note: To order Snap Track Fittings with covers add suffix CVF to the selected fitting part number.

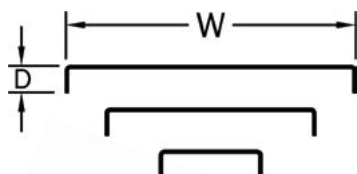

Fitting Cover - Covers are available for all standard **Snap Track** Fittings. Fitting covers are secured with Ready use Band-It straps, or stainless steel S.T. cover clamps Page 63.

Snap Track Covers

- Provide maximum cable protection
- Reduce electromagnetic interference (EMI) effects
- Eliminate dust and dirt build-up on cable
- Secure easily to **Snap Track** Tray with "Ready-Use" Band-It Straps or **Snap Track** cover clamps.

Ready Use Band-it Straps



Part Number: STL21099

Material: 201SS

Width: 0.25"

Length: 34"

Thickness: 0.030"

Maximum Single Wrap Diameter: 8"

Buckle: Pre-Assembled Ear-Lokt



Snap Track Cover Clamps

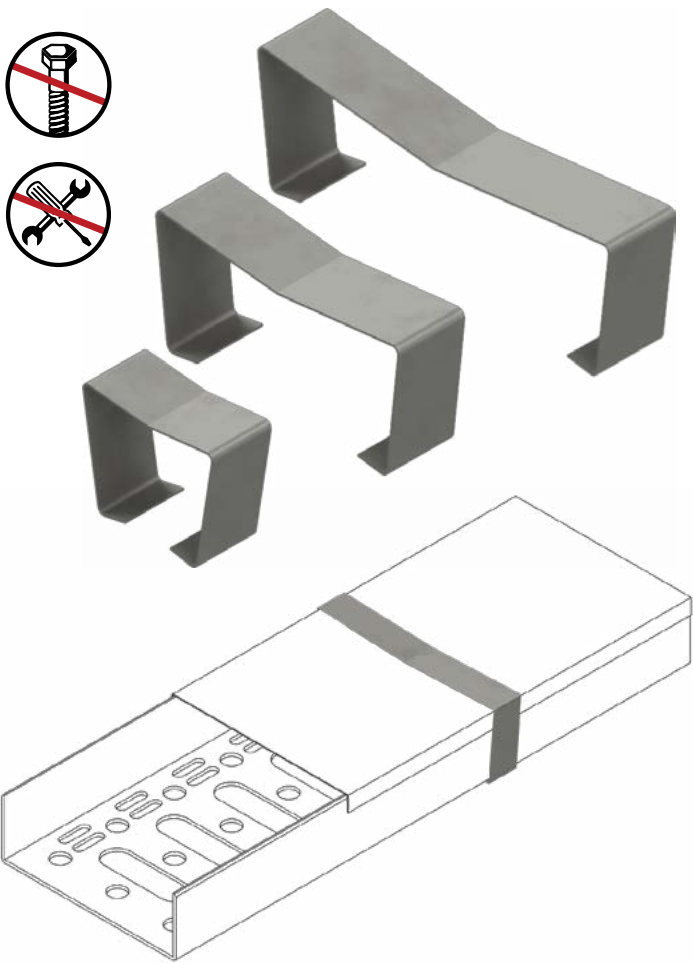

Snap Track Cover Clamps are used to secure the **Snap Track Cover** to the tray.

- Assembled to **Snap Track** Tray and Cover without tools.
- Provides a better alternate method to secure the cover.
- Eliminates the need to cut straps and replace when opening the cover.

Manufactured in 304SS finish only.

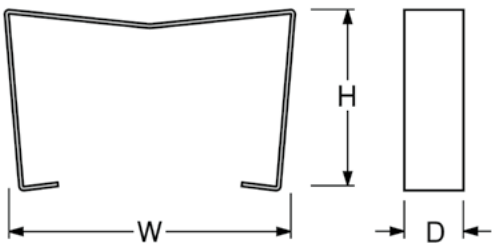

	W —	H	D /
Cover Clamps			
STCVC-2-2-*	2"	2"	1.25"
STCVC-4-2-*	4"	2"	1.25"
STCVC-6-2-*	6"	2"	1.25"

“*” - Suffix use “C” for channel cover clamp and “F” for fitting cover clamp.

Cover Clamps

Snap Track End Plates



Two Patented Push Pins are provided for a secure attachment.



Snap Track End Plates are used for dead-end closure and indicates the termination of a cable tray run.

- Assembled to **Snap Track** tray with patented Push Pin.
- Designed with 1/2" and 1" conduit knockouts.



Conduit Knockout Grommet(s)
See page 73.

	W —	D	L /	T _f
Snap Track Blind End				
STBE-2-2-AL	2"	2"	4.75"	.100
STBE-4-2-AL	4"	2"	4.75"	.100
STBE-6-2-AL	6"	2"	4.75"	.100

Installation Guideline:

Align both 9/16" round holes prior to making the final tray cut on a dead-end run.

Note: Knock-outs provide for the attachment of conduit to the cable tray. If a UL listed fitting is not used it will provide only a mechanical connection, not an electrical connection. In order to make an electrical connection without a UL listed fitting, an equipment grounding conductor must first be run from the conduit to the cable tray.

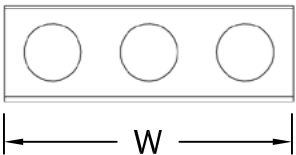
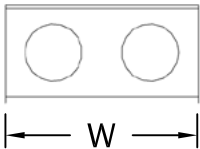
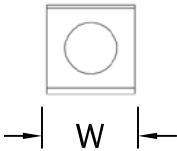
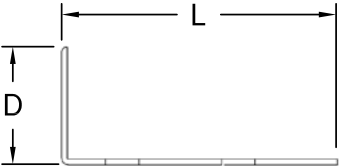

Snap Track Expansion Guides

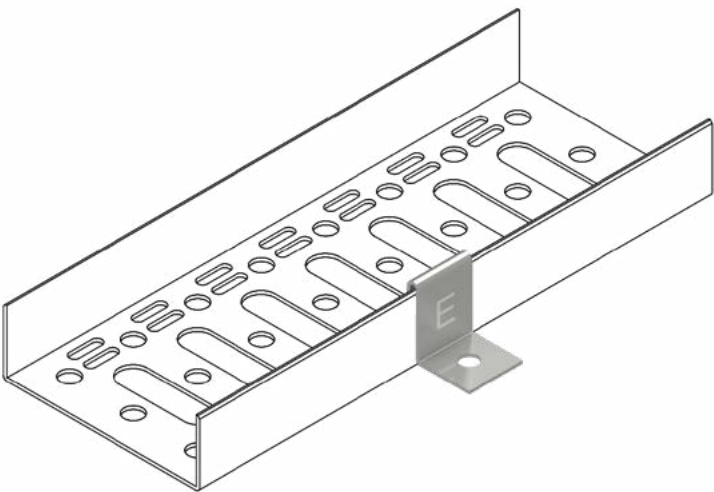

	W —	D	L /
Snap Track Thermal Expansion Guides			
STEG-2-AL	1.75"	2.125"	1.75"

Installation Guideline:

The cable tray should be anchored at the support nearest to its midpoint between expansion splices and secured by expansion guides at all other support locations. The cable tray should be permitted longitudinal movement in both directions from that fixed point – NEMA BI-50016-2024 (Current Issue).

Standard **Snap Track** Splices may be used as expansion plates when secured to the tray with ¼" carriage bolts and nylon insert nuts, hardware kit EJBK-SS. See page 44.

Do not strap tray or fitting covers within 3 feet of expansion guides.

Snap Track Expansion Guides

Installation Guideline:

Thermal expansion guides are recommended per NEMA BI-50016-2024 to provide longitudinal movement from a fixed point. Refer to page 43 for further information regarding thermal expansion.

When installing **Snap Track** Expansion Guides, two guides should be used and attached to each side rail.

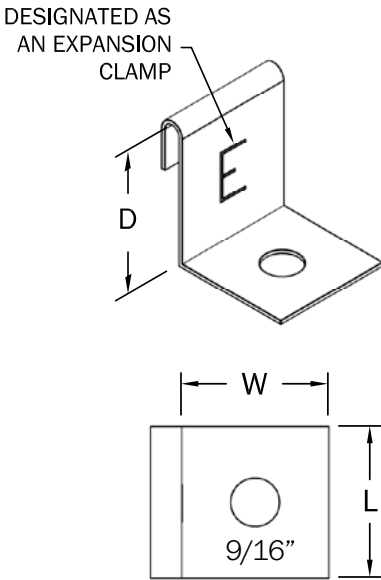

Snap Track Ladder Tray Transition Bracket

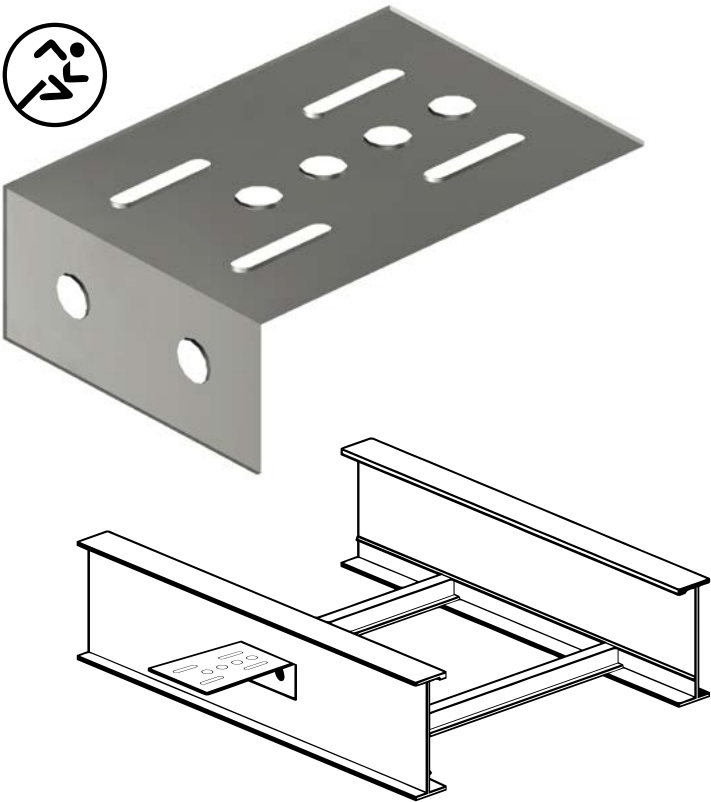

Snap Track Ladder Tray Transitions adapt ladder tray to **Snap Track** Cable Tray

Two Patented Push Pins are provided for a secure attachment.

Installation Guideline:
Bolt Transition Bracket a minimum of 2.5" below the bottom lip of the ladder tray side rail top flange. Either horizontal or perpendicular Snap Track cable tray runs can then be attached with 2 Push Pins.

	W —	L	T _f
Ladder Tray Transitions			
STLTT-2-AL	2"	6"	0.100
STLTT-4-AL	4"	6"	0.100
STLTT-6-AL	6"	6"	0.100

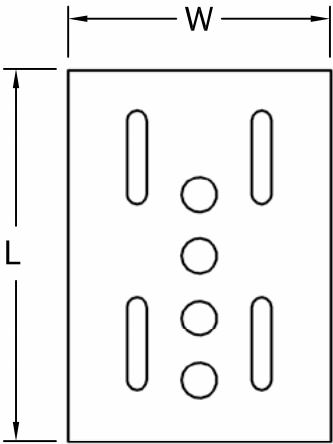

TOP VIEW

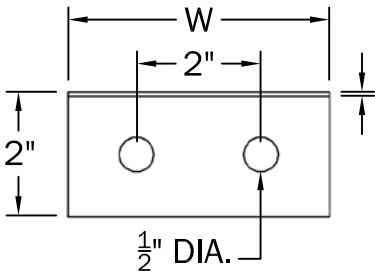

END VIEW

Snap Track Ladder Tray Transition

Snap Track has a wide variety of options to exit ladder style tray systems. Our brackets allow the user to install to the top, bottom or side of the tray. Snap Track can run perpendicular or parallel to the ladder tray.

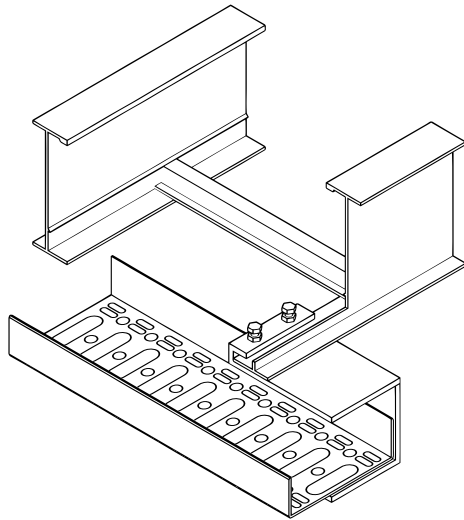
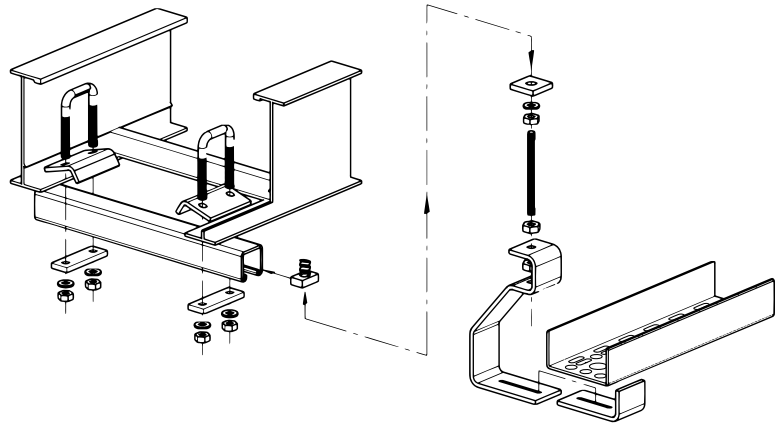

Part#: STULTTBKT-AL

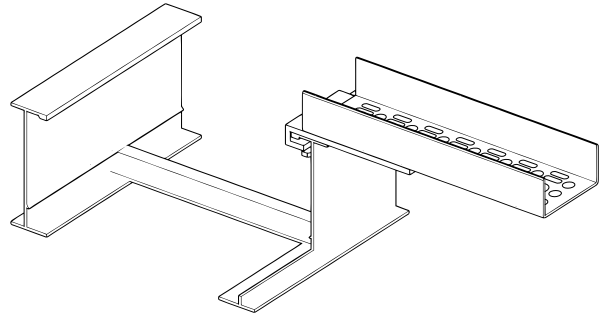

Part#: STOLTTBKT-AL

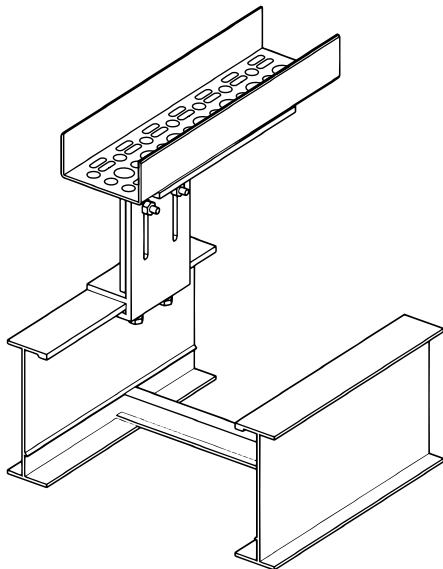

PARALLEL ORIENTATION

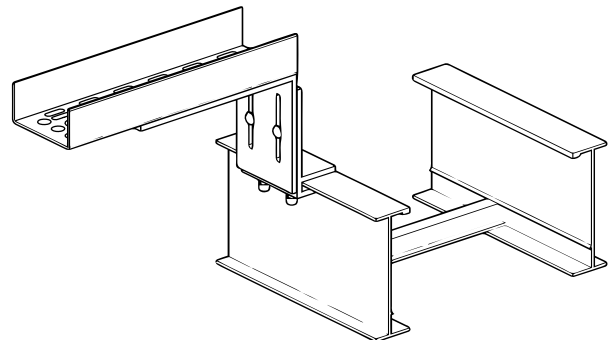

PERPENDICULAR ORIENTATION

Part#: STOLTTBKT-AL-ADJ-PER/PAR

Snap Track Conduit Bracket



Snap Track Conduit Brackets allow for an easy transition from cable tray to conduit. The two Hold Down Clamps slide over the inside wall of the tray and are secured by two patented push pins. The cable can exit either from the top or bottom of the tray. Conduit is secured utilizing traditional strut clamps.**

	W —	L
Conduit Bracket Adapter		
STCB-AL	3 1/4"	6"
STCB-AL-12	3 1/4"	12"

****Strut pieces are 1 5/8" x 1 5/8" solid, back to back with two hold down clamps.**

Snap Track Conduit Bracket attaches to **Snap Track** Cable Tray to allow exiting of the tray via conduit. The conduit can be secured to the bracket by strut clamps.



Two Patented Push Pins are provided for a secure attachment.

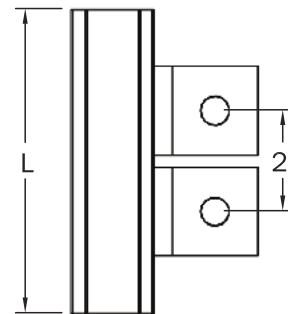

TOP VIEW

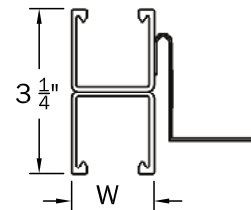

SIDE VIEW

Snap Track Bulkhead Connector



Snap Track Bulkhead Connector connects **Snap Track** to a wiring panel or equipment. A channel sized opening is in the baseplate of the connector. This allows for transitioning into **Snap Track** from an enclosed location.

 Two Patented Push Pins are provided for a secure attachment.

Bulkhead Connector				
STBH-2-AL	2"	8"	.125"	3.0 LBS
STBH-4-AL	4"	8"	.125"	3.2 LBS
STBH-6-AL	6"	8"	.125"	3.4 LBS

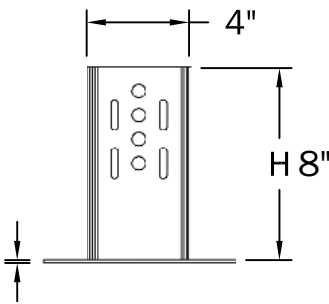
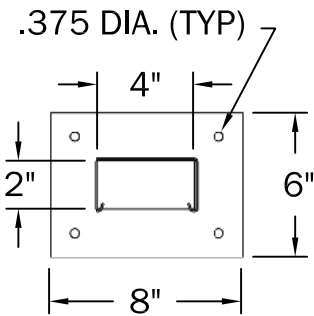

STBH-4-AL Shown

Snap Track End of Tray Drop Out

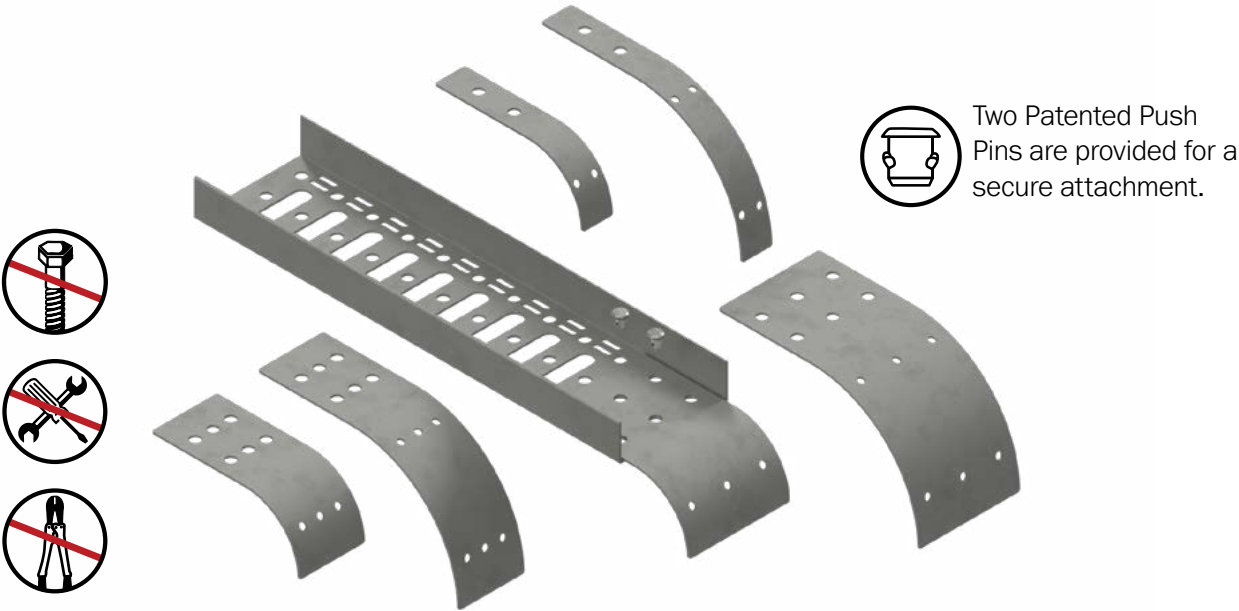

Snap Track End of Tray Drop Outs are designed to allow cables to freely spill out the end of the tray while providing the proper bend radius protection.

Drop Out				
3" Radius Drop Out				
STD0-2-AL-3R	2"	3"	.5 LBS	0.100
STD0-4-AL-3R	4"	3"	.75 LBS	0.100
STD0-6-AL-3R	6"	3"	1 LBS	0.100
6" Radius Drop Out				
STD0-2-AL-6R	2"	6"	.5 LBS	0.100
STD0-4-AL-6R	4"	6"	.75LBS	0.100
STD0-6-AL-6R	6"	6"	1 LBS	0.100

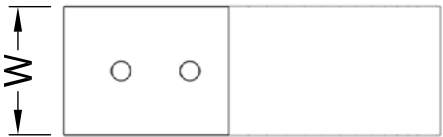

TOP VIEW

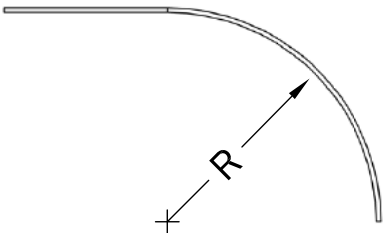

SIDE VIEW



Snap Track Edge Protector & Instrument Support Kit

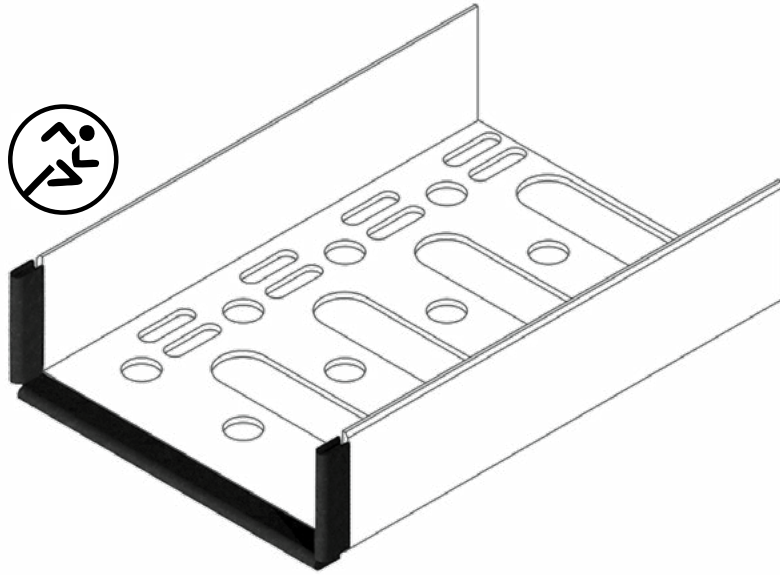

Snap Track Edge Protector is a flexible PVC trim that enables the user to continue a run without the use of a conduit connection or STBE blind end. Protects cables from any edges after field fabrication.

- Color: Black
- Available in minimum of 250 ft. rolls.

Part#: 100B3TPRFRX1/8

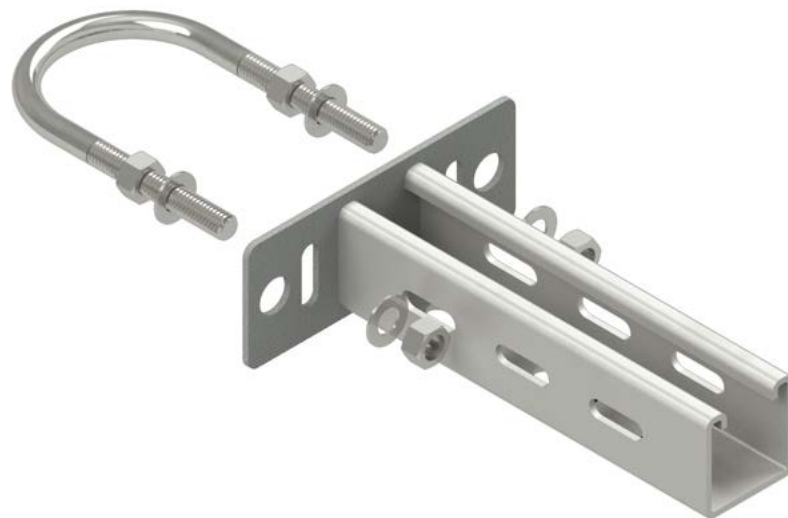

Snap Track Instrument Support Kit **Part#: STUSB-GV-KIT**

The **Snap Track** STUSB-GV-KIT connects to a 2" nominal bore pipe instrument stand or other structure with a U-bolt. This allows the connecting of **Snap Track Cable Tray** in either a vertical or horizontal plane. The kit contains (1) STUSB-GV strut bracket, (1) 5/16" X 2" U-bolt w/ nut & washer, (1) 3/8" spring nut, (1) 3/8" x 1" hex bolt.

Additional fasteners required for vertical mount. All kit items are zinc plated.

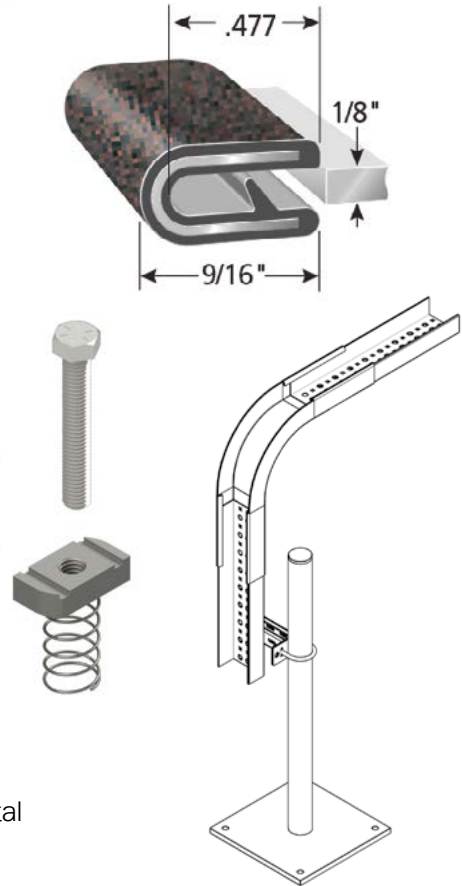

Snap Track Wire Spool and Bracket



Snap Track Wire Spools were designed to eliminate “pig tails,” which commonly occur at the instrument connection, in a connectivity solution.

- Mounts directly to standard 2” instrument stands or can be adapted to the instrument conduit connection with STWSB6-AL mounting bracket.
- 4” spool diameter to accommodate the minimum bend radius of control cables.
- Minimizes potential of cable damage.

Manufactured from 12 Gauge Aluminum

Installation Guideline:

Order with STWSB-6-AL bracket to mount wire spools directly to surface mounted transmitters, or with a U-bolt directly to stand.

Eliminate “Pig Tails”

Pre-ordered cable lengths and “slack” requirements commonly result in unprotected and unsightly “pigtails”.



Snap Track Wire Spools			
STWS-4-AL	4"	12"	5 LBS

STWSB6-AL

Wire Spool Mounting Bracket

Optional mounting bracket for surface mount applications. Use STWSB6-AL to mount **Snap Track** wire spools directly to the 1/2” instrument conduit connection.

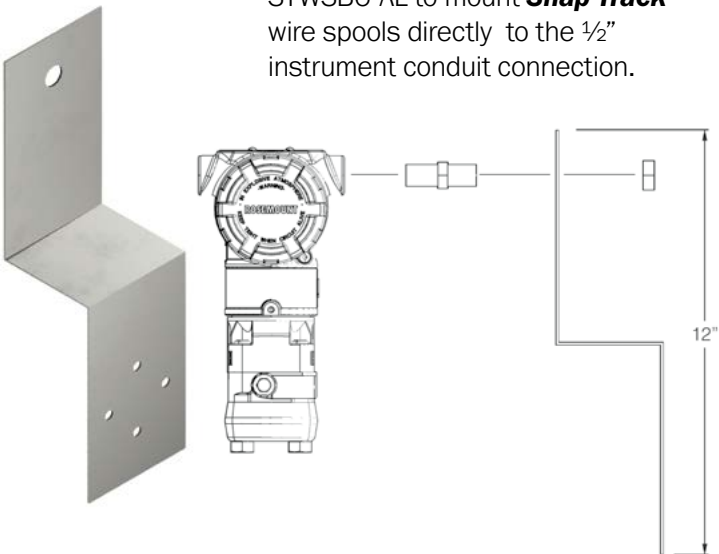

Snap Track Dividers and Grommets

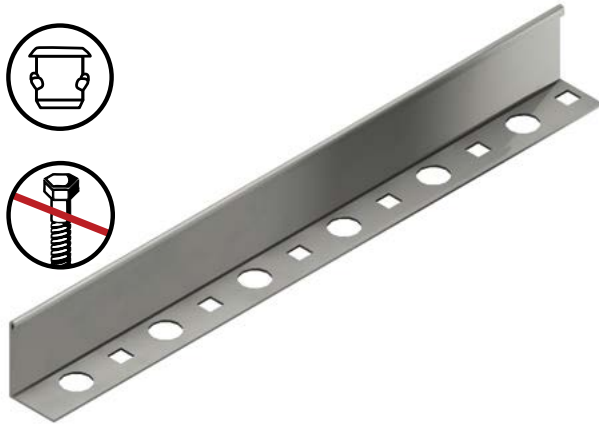

W — D | L /

Snap Track Tray Dividers

STDS-1-1.5-AL	1"	1.5"	6'	1 LB
---------------	----	------	----	------

Installation Guideline:

Whenever possible, power cables and data cables should be run in separate trays to prevent electromagnetic interference (EMI). When this is not possible, dividers should be installed to provide an EMI barrier.

EMI is the disruption of operation of an electronic device when it is in the vicinity of an electromagnetic field (EM field) in the radio frequency (RF) spectrum that is caused by another electronic device.

Patented Push Pins are provided for a secure attachment.

Snap Track Dividers are used to separate power and data cables within **Snap Track** Tray.

- Assembled to **Snap Track** Tray with Patented Push Pin
- Field fabricated with tin snips for changes in radius or level
- Rolled edge for maximum cable protection

Problems with EMI can be minimized by ensuring that all electronic equipment is operated with a good electrical ground system. In addition, cords and cables connecting the peripherals in an electronic or computer system should, if possible, be shielded to keep unwanted RF energy from entering or leaving. Common sources of EMI include power cables, radios, motors, lighting, and mobile phones.

Grommets	Size
STG-890	1/2"
STG-1370	1"



Snap Track Conduit Knockout Grommets

Max. Panel Thickness: 0.125"
Circular Punch Hole: for 1/2" & 1"
Conduit. Color: Black

Installation Guideline:

For maximum cable protection, install **Snap Track** Grommets wherever conduit knockouts are used without conduit fittings. Not for center hole dropouts.

Snap Track Center Hole Grommet

Rubber grommets are available for center holes in **Snap Track Channel Tray**.



Part Number	Description
STG-B90-2/4	Rubber Grommet Fits 2" and 4" Snap Track, 1/2" inside diameter

Snap Track Isolator Pad

TechLine Mfg.'s new Isolator Pad fits between strut supports and **Snap Track** Aluminum Cable Tray, reducing dissimilar metal corrosion and protecting vital components. Isolator pads are available for all sizes of **Snap Track**, 2", 4" and 6", with each pad extending two inches on either side of the tray to allow for **Snap Track** Hold Down Clamps (page 85). Isolator Pads are made from UV-resistant rubber-coated aluminum.

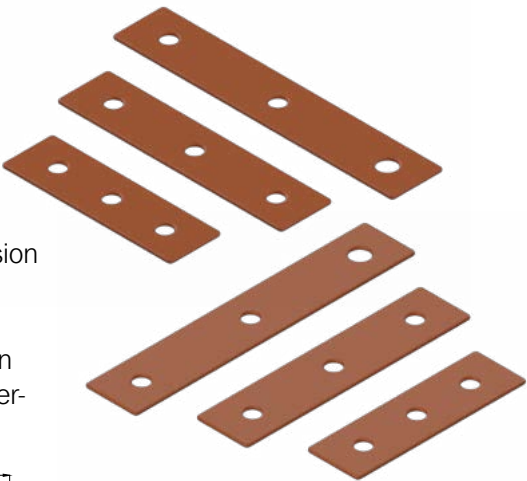

Part Number
STIP-2-AL-ORG
STIP-4-AL-ORG
STIP-6-AL-ORG

