

COMPANY PROFILE

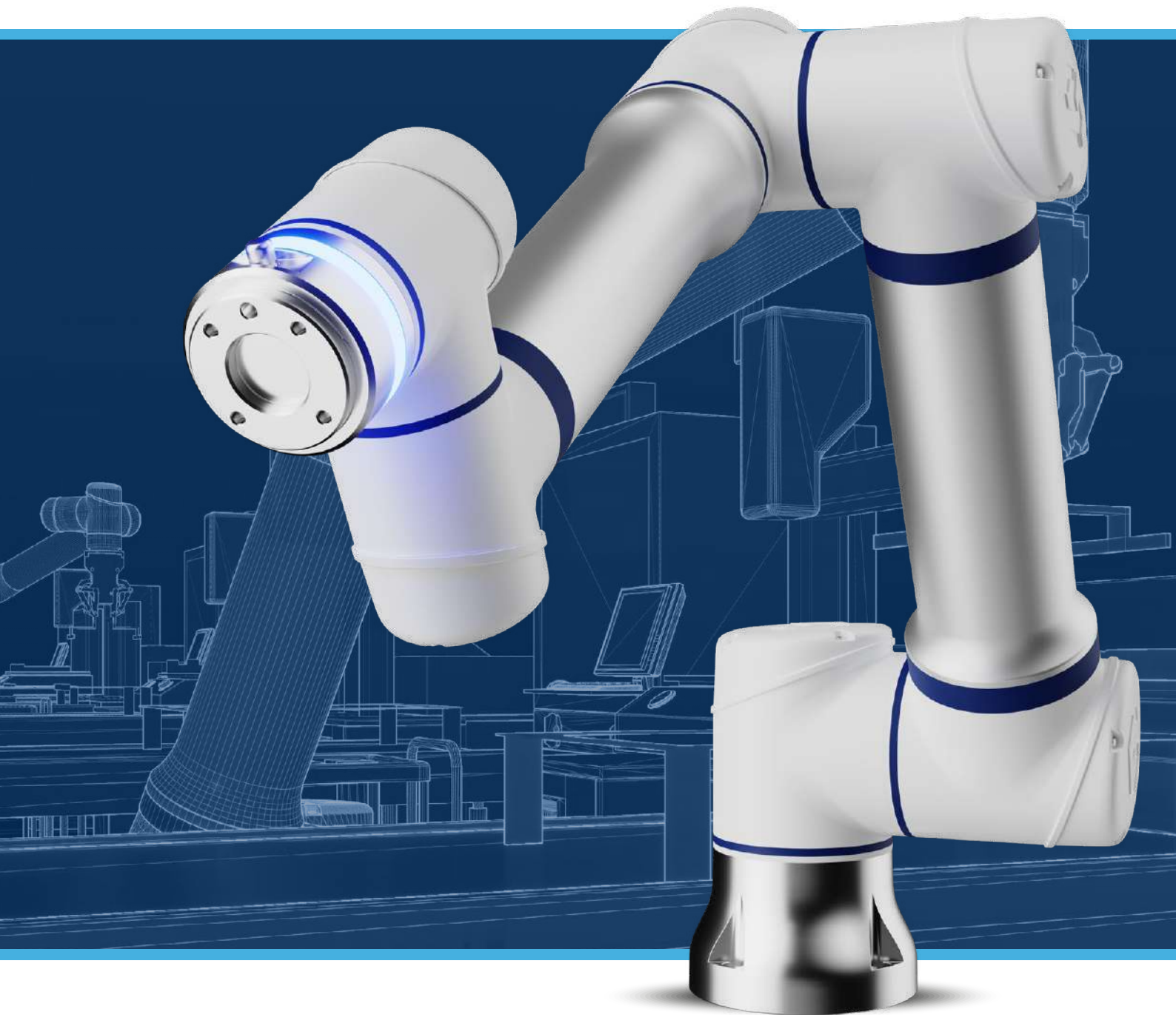

Robotic Arm

Payload	3kg	
Radius	624mm	
Accuracy	±0.02mm	
Axis	6	
Joints rotation	J1-J6	±360°
	J1-J2	190°/s
Joints speed	J3	190°/s
	J4-J6	260°/s
Typical TCP Speed	1.5 m/s	
IP rating	IP54	
Temperature range	-10~50°C	
Relative humidity	5%~95% (non-condensing)	
Noise reduction	<70db	
Typical power usage	185w	
Mounting	Any angle	
Tool I/O connector	12 pin	
Tool I/O ports	2 DI, 2 DO; 1 AI, 1 AO	
Tool I/O power supply	24V / 2A	
Tool I/O communication	RS485, Modbus RTU	
Footprint	Ø 128 mm	
Weight	13kg	
Material	Aluminum, steel, plastic, rubber	
Cable length	5.5m*	
Certifications	ISO 10218; RoHS-1; UL, CE, CR, KCs	
Programming	LUA-script, free-drag/offline programming	

* Optional cable lengths of 1.5m, 3m and 8m are available.



Elite Robots' entry-level cobot stands out for its accuracy, light weight, and small footprint. Install it anywhere effortlessly, mounted on a table or integrated into a line, and let it perform your assembly, handling and other tasks.

Standard controller

Type	AC / DC
I/O ports	16 x DI, 20 x DO, 2 x AI, 4 x AO
I/O power supply	24V/2A
Communication	RS485/RS232, Ethernet TCP/IP, UDP, Modbus TCP/RTU, Ethernet/IP slave, Profinet slave, CCLink slave (optional)
Size	505mm x 246mm x 447mm
IP Rating	IP44
Weight	15kg
Power source	90-264VAC, 50-60Hz / 19-72VDC
Temperature range	0~50°C
Relative humidity	5%~95% (non-condensing)
Material	Aluminum, Steel



Standard AC/DC controller with 16 DI / 16 DO. Ethernet/IP / Profinet slave with Modbus TCP/RTU interface

Mini controller

Type	DC
I/O ports	8 x DI, 8 x DO
I/O power supply	24V/2A
Communication	RS485, Ethernet TCP/IP, UDP, Modbus TCP/RTU, Ethernet/IP slave, Profinet slave, CCLink slave (optional)
Size	205mm x 135mm x 40mm
IP Rating	IP40
Weight	1.2kg
Power source	45-55VDC
Temperature range	0~50°C
Relative humidity	5%~95% (non-condensing)
Material	Aluminum

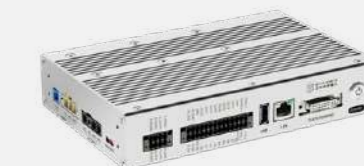

Optional OEM "Mini" DC controller for integrators, OEM partners and users who want to create their own custom design.

Teach Pendant ERP300

Size	290mm x 225mm x 118mm
Screen size	8"
Resolution	800 x 600 pixels
IP rating	IP54
Weight	1.2kg
Cable length	5.5 m
Temperature range	0~50°C
Relative humidity	5%~95% (non-condensing)
Material	Aluminium, plastic, rubber
Input method	Resistive touch-screen, 3-mode enable key



Industrial teach-pendant with 3-modes enable key for safe and convenient on-site operations. 8" touch-screen.

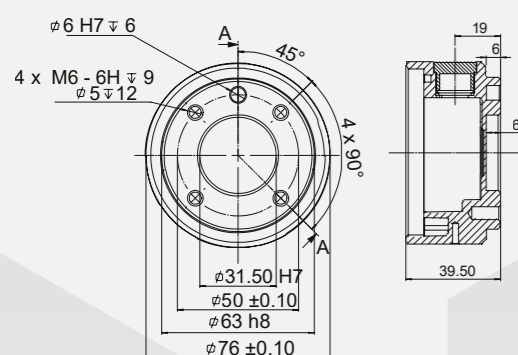
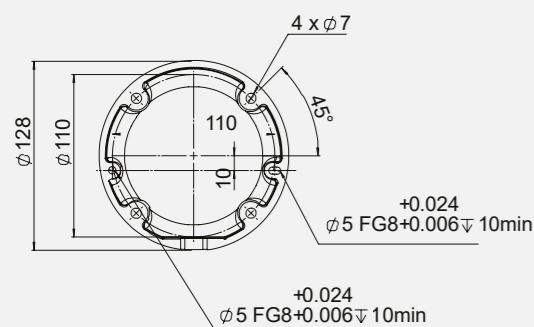
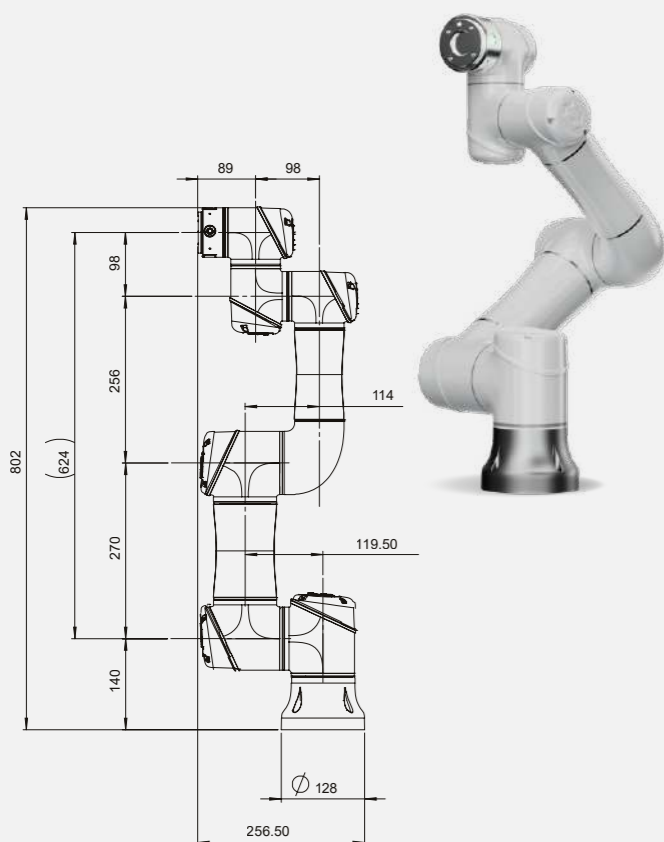

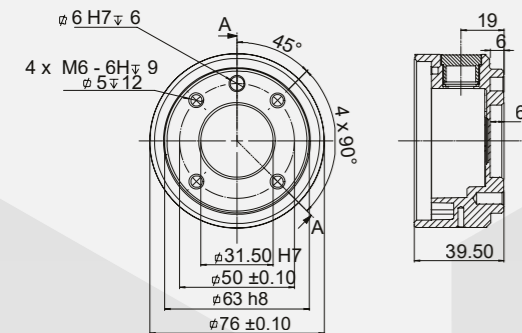
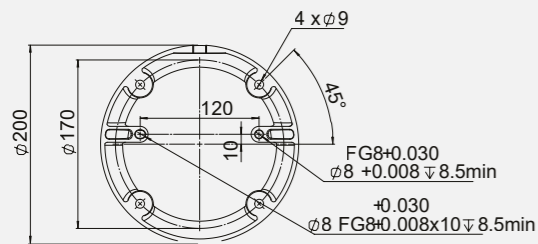
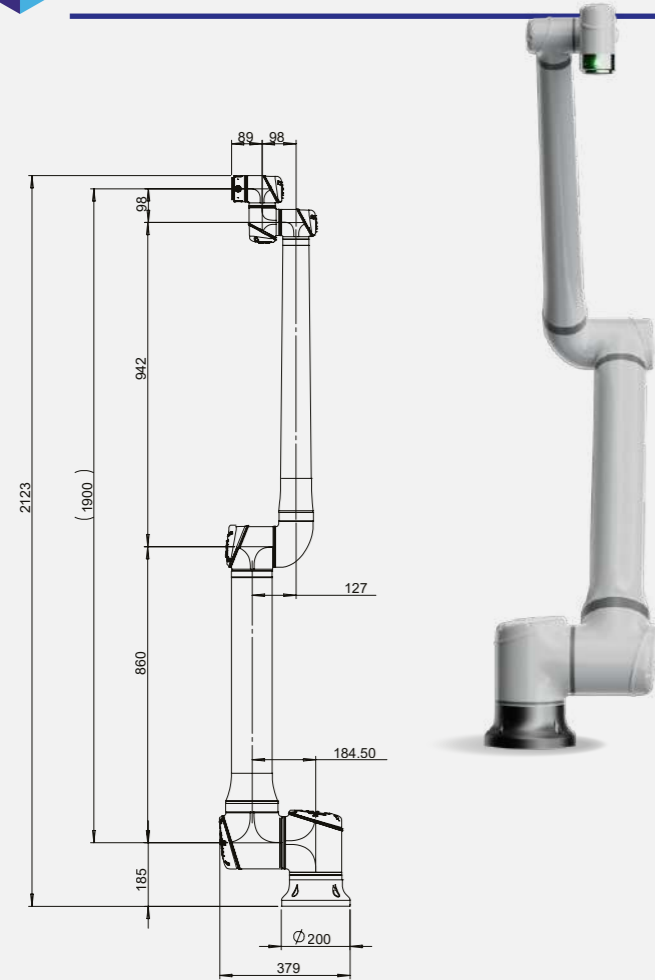

Robotic Arm

Payload	4kg	
Radius	1900mm	
Accuracy	±0.1mm	
Axis	6	
Joints rotation	J1-J6	±360°
	J1-J2	120°/s
Joints speed	J3	150°/s
	J4-J6	260°/s
Typical TCP Speed	1.5 m/s	
IP rating	IP54	
Temperature range	-10~50°C	
Relative humidity	5%~95% (non-condensing)	
Noise reduction	<70db	
Typical power usage	350w	
Mounting	Any angle	
Tool I/O connector	12 pin	
Tool I/O ports	2 DI, 2 DO; 1 AI, 1 AO	
Tool I/O power supply	24V / 2A	
Tool I/O communication	RS485, Modbus RTU	
Footprint	Ø 200 mm	
Weight	33.5kg	
Material	Aluminum, steel, plastic, rubber	
Cable length	5.5m*	
Certifications	ISO 10218; RoHS-1; UL, CE, CR, KCs	
Programming	LUA-script, free-drag/offline programming	

* Optional cable lengths of 1.5m, 3m and 8m are available.



With a leading radius of 1900cm, EC64 is the cobot with the longest reach in the entire Elite Robots range and perfect for effortlessly performing 2D and 3D inspection and measurement tasks of large components.

Standard controller

Type	AC / DC
I/O ports	16 x DI, 20 x DO, 2 x AI, 4 x AO
I/O power supply	24V/2A
Communication	RS485/RS232, Ethernet TCP/IP, UDP, Modbus TCP/RTU, Ethernet/IP slave, Profinet slave, CCLink slave (optional)
Size	505mm x 246mm x 447mm
IP Rating	IP44
Weight	17kg
Power source	90-264VAC, 50-60Hz / 19-72VDC
Temperature range	0~50°C
Relative humidity	5%~95% (non-condensing)
Material	Aluminum, Steel



Standard AC/DC controller with 16 DI / 16 DO. Ethernet/IP / Profinet slave with Modbus TCP/RTU interface

Mini controller

Type	DC
I/O ports	8 x DI, 8 x DO
I/O power supply	24V/2A
Communication	RS485, Ethernet TCP/IP, UDP, Modbus TCP/RTU, Ethernet/IP slave, Profinet slave, CCLink slave (optional)
Size	205mm x 135mm x 40mm
IP Rating	IP40
Weight	1.2kg
Power source	45-55VDC
Temperature range	0~50°C
Relative humidity	5%~95% (non-condensing)
Material	Aluminum



Optional OEM "Mini" DC controller for integrators, OEM partners and users who want to create their own custom design.

Teach Pendant ERP300

Size	290mm x 225mm x 118mm
Screen size	8"
Resolution	800 x 600 pixels
IP rating	IP54
Weight	1.2kg
Cable length	5.5 m
Temperature range	0~50°C
Relative humidity	5%~95% (non-condensing)
Material	Aluminium, plastic, rubber
Input method	Resistive touch-screen, 3-mode enable key



Industrial teach-pendant with 3-modes enable key for safe and convenient on-site operations. 8" touch-screen.

Robotic Arm

Payload	6kg	
Radius	914mm	
Accuracy	±0.03mm	
Axis	6	
Joints rotation	J1-J6	±360°
	J1-J2	150°/s
Joints speed	J3	190°/s
	J4-J6	260°/s
Typical TCP Speed	1.5 m/s	
IP rating	IP54	
Temperature range	-10~50°C	
Relative humidity	5%~95% (non-condensing)	
Noise reduction	<70db	
Typical power usage	250w	
Mounting	Any angle	
Tool I/O connector	12 pin	
Tool I/O ports	2 DI, 2 DO; 1 AI, 1 AO	
Tool I/O power supply	24V / 2A	
Tool I/O communication	RS485, Modbus RTU	
Footprint	Ø 150 mm	
Weight	17.5kg	
Material	Aluminum, steel, plastic, rubber	
Cable length	5.5m*	
Certifications	ISO 10218; RoHS-1; UL, CE, CR, KCs	
Programming	LUA-script, free-drag/offline programming	

* Optional cable lengths of 1.5m, 3m and 8m are available.



EC66 is the robot from which Elite Robots began its journey into collaborative robotics. Since its release, it has been integrated with a wide range of applications, from picking and placing components to handling vials for laboratories and pharmaceutical companies.

Standard controller

Type	AC / DC
I/O ports	16 x DI, 20 x DO, 2 x AI, 4 x AO
I/O power supply	24V/2A
Communication	RS485/RS232, Ethernet TCP/IP, UDP, Modbus TCP/RTU, Ethernet/IP slave, Profinet slave, CCLink slave (optional)
Size	505mm x 246mm x 447mm
IP Rating	IP44
Weight	15kg
Power source	90-264VAC, 50-60Hz / 19-72VDC
Temperature range	0~50°C
Relative humidity	5%~95% (non-condensing)
Material	Aluminum, Steel



Standard AC/DC controller with 16 DI / 16 DO. Ethernet/IP / Profinet slave with Modbus TCP/RTU interface

Mini controller

Type	DC
I/O ports	8 x DI, 8 x DO
I/O power supply	24V/2A
Communication	RS485, Ethernet TCP/IP, UDP, Modbus TCP/RTU, Ethernet/IP slave, Profinet slave, CCLink slave (optional)
Size	205mm x 135mm x 40mm
IP Rating	IP40
Weight	1.2kg
Power source	45-55VDC
Temperature range	0~50°C
Relative humidity	5%~95% (non-condensing)
Material	Aluminum



Optional OEM "Mini" DC controller for integrators, OEM partners and users who want to create their own custom design.

Teach Pendant ERP300

Size	290mm x 225mm x 118mm
Screen size	8"
Resolution	800 x 600 pixels
IP rating	IP54
Weight	1.2kg
Cable length	5.5 m
Temperature range	0~50°C
Relative humidity	5%~95% (non-condensing)
Material	Aluminium, plastic, rubber
Input method	Resistive touch-screen, 3-mode enable key



Industrial teach-pendant with 3-modes enable key for safe and convenient on-site operations. 8" touch-screen.

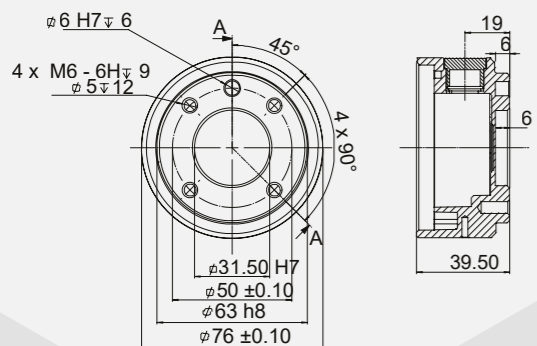
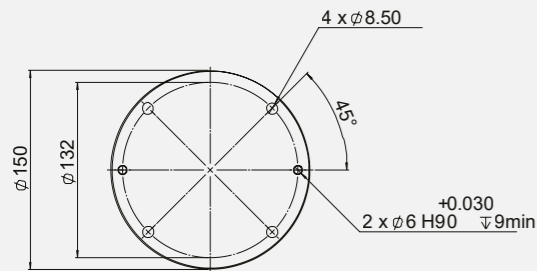
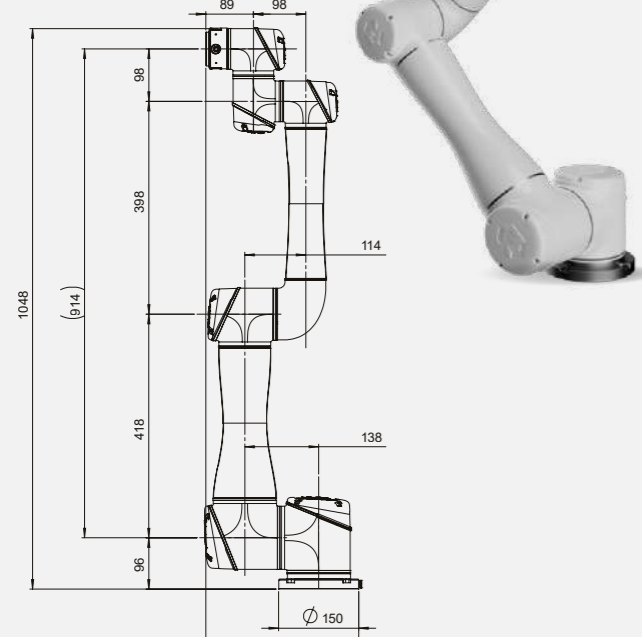

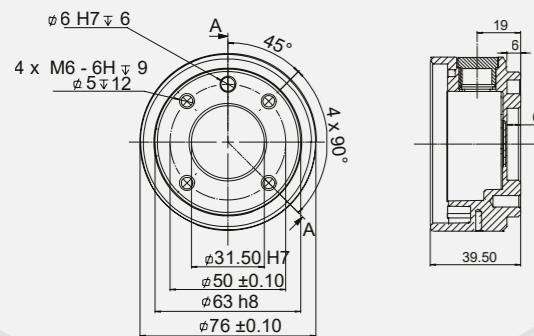
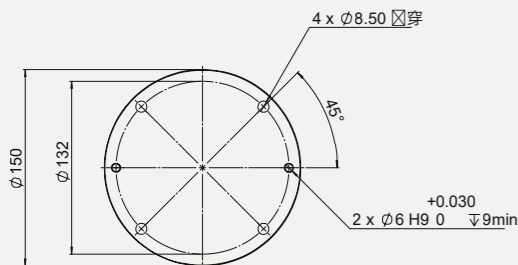
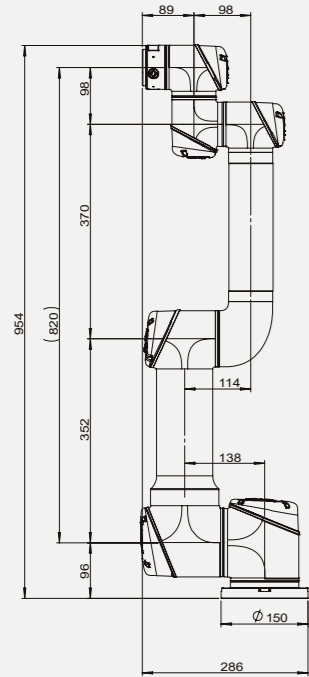

Robotic Arm

Payload	8kg	
Radius	820mm	
Accuracy	±0.03mm	
Axis	6	
Joints rotation	J1-J6	±360°
	J1-J2	150°/s
Joints speed	J3	190°/s
	J4-J6	260°/s
Typical TCP Speed	1.5 m/s	
IP rating	IP54	
Temperature range	-10~50°C	
Relative humidity	5%~95% (non-condensing)	
Noise reduction	<70db	
Typical power usage	250w	
Mounting	Any angle	
Tool I/O connector	12 pin	
Tool I/O ports	2 DI, 2 DO; 1 AI, 1 AO	
Tool I/O power supply	24V / 2A	
Tool I/O communication	RS485, Modbus RTU	
Footprint	Ø 150 mm	
Weight	17kg	
Material	Aluminum, steel, plastic, rubber	
Cable length	5.5m*	
Certifications	ISO 10218; RoHS-1; UL, CE, CR, KCs	
Programming	LUA-script, free-drag/offline programming	

* Optional cable lengths of 1.5m, 3m and 8m are available.



This handy yet powerful cobot features a unique architecture that gives it enough forces for performing multiple assembly and processing tasks. Its compact design and small footprint make it perfect for effortless integration into any production line.

Standard controller

Type	AC / DC
I/O ports	16 x DI, 20 x DO, 2 x AI, 4 x AO
I/O power supply	24V/2A
Communication	RS485/RS232, Ethernet TCP/IP, UDP, Modbus TCP/RTU, Ethernet/IP slave, Profinet slave, CCLink slave (optional)
Size	505mm x 246mm x 447mm
IP Rating	IP44
Weight	15kg
Power source	90-264VAC, 50-60Hz / 19-72VDC
Temperature range	0~50°C
Relative humidity	5%~95% (non-condensing)
Material	Aluminum, Steel



Standard AC/DC controller with 16 DI / 16 DO. Ethernet/IP / Profinet slave with Modbus TCP/RTU interface

Mini controller

Type	DC
I/O ports	8 x DI, 8 x DO
I/O power supply	24V/2A
Communication	RS485, Ethernet TCP/IP, UDP, Modbus TCP/RTU, Ethernet/IP slave, Profinet slave, CCLink slave (optional)
Size	205mm x 135mm x 40mm
IP Rating	IP40
Weight	1.2kg
Power source	45-55VDC
Temperature range	0~50°C
Relative humidity	5%~95% (non-condensing)
Material	Aluminum



Optional OEM "Mini" DC controller for integrators, OEM partners and users who want to create their own custom design.

Teach Pendant ERP300

Size	290mm x 225mm x 118mm
Screen size	8"
Resolution	800 x 600 pixels
IP rating	IP54
Weight	1.2kg
Cable length	5.5 m
Temperature range	0~50°C
Relative humidity	5%~95% (non-condensing)
Material	Aluminium, plastic, rubber
Input method	Resistive touch-screen, 3-mode enable key



Industrial teach-pendant with 3-modes enable key for safe and convenient on-site operations. 8" touch-screen.



Robotic Arm

Payload	12kg	
Radius	1304mm	
Accuracy	±0.05mm	
Axis	6	
Joints rotation	J1-J6	±360°
	J1-J2	120°/s
Joints speed	J3	150°/s
	J4-J6	210°/s
Typical TCP Speed	1.5 m/s	
IP rating	IP54	
Temperature range	-10~50°C	
Relative humidity	5%~95% (non-condensing)	
Noise reduction	<70db	
Typical power usage	435w	
Mounting	Any angle	
Tool I/O connector	12 pin	
Tool I/O ports	2 DI, 2 DO; 1 AI, 1 AO	
Tool I/O power supply	24V / 2A	
Tool I/O communication	RS485, Modbus RTU	
Footprint	Ø 200 mm	
Weight	33.5kg	
Material	Aluminum, steel, plastic, rubber	
Cable length	5.5m*	
Certifications	ISO 10218; RoHS-1; UL, CE, CR, KCs	
Programming	LUA-script, free-drag/offline programming	

* Optional cable lengths of 1.5m, 3m and 8m are available.

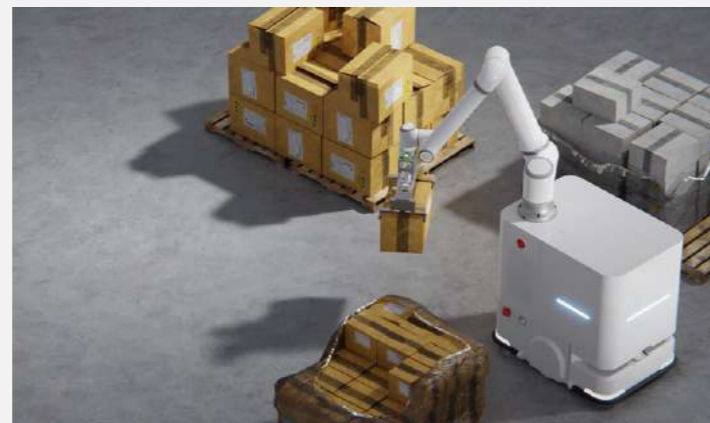

Elite Robots' most popular cobot keeps supporting users globally in automating a wide range of tasks. Lightweight, with sufficient reach and payload and slim in design, this cost-effective cobot can be mounted in any existing production line, speeding up this and your returns.

Standard controller

Type	AC / DC
I/O ports	16 x DI, 20 x DO, 2 x AI, 4 x AO
I/O power supply	24V/2A
Communication	RS485/RS232, Ethernet TCP/IP, UDP, Modbus TCP/RTU, Ethernet/IP slave, Profinet slave, CCLink slave (optional)
Size	505mm x 246mm x 447mm
IP Rating	IP44
Weight	17kg
Power source	90-264VAC, 50-60Hz / 19-72VDC
Temperature range	0~50°C
Relative humidity	5%~95% (non-condensing)
Material	Aluminum, Steel



Standard AC/DC controller with 16 DI / 16 DO. Ethernet/IP / Profinet slave with Modbus TCP/RTU interface

Mini controller

Type	DC
I/O ports	8 x DI, 8 x DO
I/O power supply	24V/2A
Communication	RS485, Ethernet TCP/IP, UDP, Modbus TCP/RTU, Ethernet/IP slave, Profinet slave, CCLink slave (optional)
Size	205mm x 135mm x 40mm
IP Rating	IP40
Weight	1.2kg
Power source	45-55VDC
Temperature range	0~50°C
Relative humidity	5%~95% (non-condensing)
Material	Aluminum

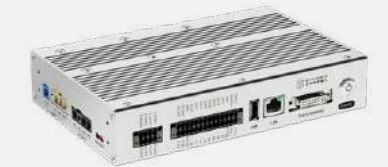

Optional OEM "Mini" DC controller for integrators, OEM partners and users who want to create their own custom design.

Teach Pendant ERP300

Size	290mm x 225mm x 118mm
Screen size	8"
Resolution	800 x 600 pixels
IP rating	IP54
Weight	1.2kg
Cable length	5.5 m
Temperature range	0~50°C
Relative humidity	5%~95% (non-condensing)
Material	Aluminium, plastic, rubber
Input method	Resistive touch-screen, 3-mode enable key



Industrial teach-pendant with 3-modes enable key for safe and convenient on-site operations. 8" touch-screen.

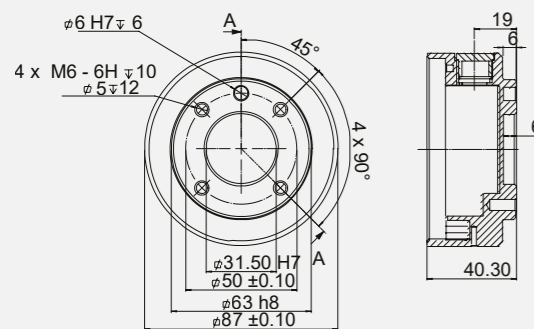
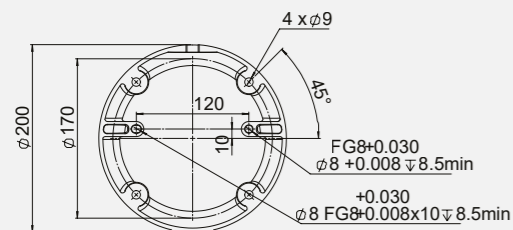
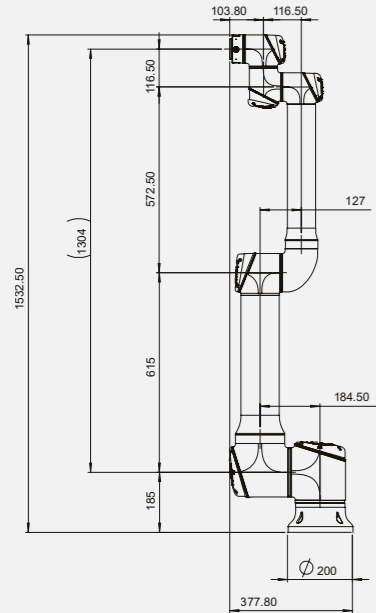

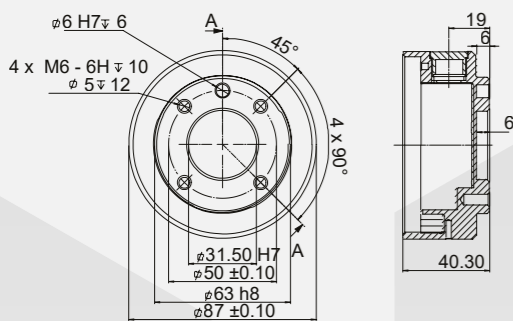
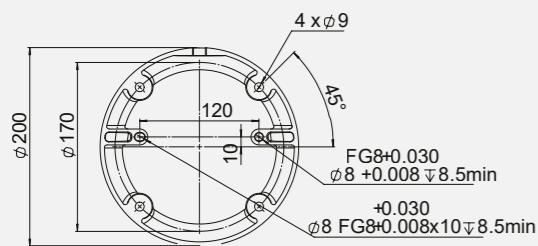
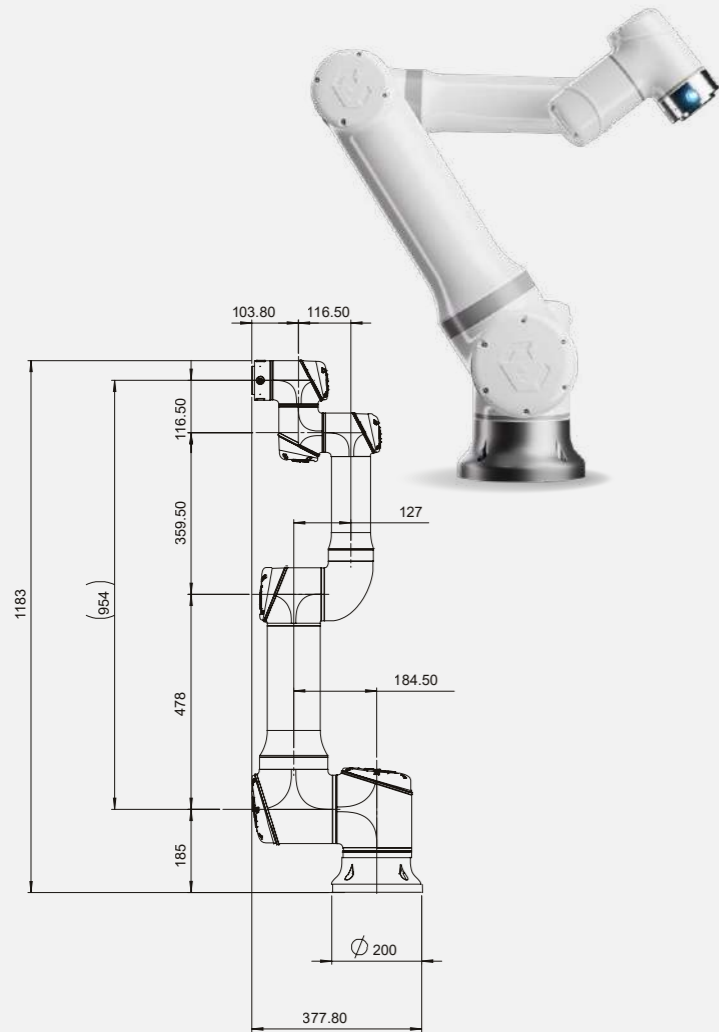

Robotic Arm

Payload	16kg	
Radius	954mm	
Accuracy	±0.03mm	
Axis	6	
Joints rotation	J1-J6	±360°
	J1-J2	120°/s
Joints speed	J3	150°/s
	J4-J6	210°/s
Typical TCP Speed	1.5 m/s	
IP rating	IP54	
Temperature range	-10~50°C	
Relative humidity	5%~95% (non-condensing)	
Noise reduction	<70db	
Typical power usage	435w	
Mounting	Any angle	
Tool I/O connector	12 pin	
Tool I/O ports	2 DI, 2 DO; 1 AI, 1 AO	
Tool I/O power supply	24V / 2A	
Tool I/O communication	RS485, Modbus RTU	
Footprint	Ø 200 mm	
Weight	32.5kg	
Material	Aluminum, steel, plastic, rubber	
Cable length	5.5m*	
Certifications	ISO 10218; RoHS-1; UL, CE, CR, KCs	
Programming	LUA-script, free-drag/offline programming	

* Optional cable lengths of 1.5m, 3m and 8m are available.



Standard controller

Type	AC / DC
I/O ports	16 x DI, 20 x DO, 2 x AI, 4 x AO
I/O power supply	24V/2A
Communication	RS485/RS232, Ethernet TCP/IP, UDP, Modbus TCP/RTU, Ethernet/IP slave, Profinet slave, CCLink slave (optional)
Size	505mm x 246mm x 447mm
IP Rating	IP44
Weight	17kg
Power source	90-264VAC, 50-60Hz / 19-72VDC
Temperature range	0~50°C
Relative humidity	5%~95% (non-condensing)
Material	Aluminum, Steel



Standard AC/DC controller with 16 DI / 16 DO. Ethernet/IP / Profinet slave with Modbus TCP/RTU interface

Mini controller

Type	DC
I/O ports	8 x DI, 8 x DO
I/O power supply	24V/2A
Communication	RS485, Ethernet TCP/IP, UDP, Modbus TCP/RTU, Ethernet/IP slave, Profinet slave, CCLink slave (optional)
Size	205mm x 135mm x 40mm
IP Rating	IP40
Weight	1.2kg
Power source	45-55VDC
Temperature range	0~50°C
Relative humidity	5%~95% (non-condensing)
Material	Aluminum

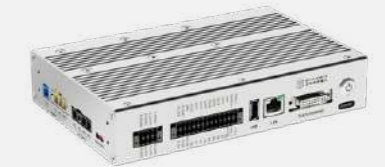

Optional OEM "Mini" DC controller for integrators, OEM partners and users who want to create their own custom design.

Teach Pendant ERP300

Size	290mm x 225mm x 118mm
Screen size	8"
Resolution	800 x 600 pixels
IP rating	IP54
Weight	1.2kg
Cable length	5.5 m
Temperature range	0~50°C
Relative humidity	5%~95% (non-condensing)
Material	Aluminium, plastic, rubber
Input method	Resistive touch-screen, 3-mode enable key



Industrial teach-pendant with 3-modes enable key for safe and convenient on-site operations. 8" touch-screen.



3 kg



624 mm



±0.02 mm

CS63

CS SERIES

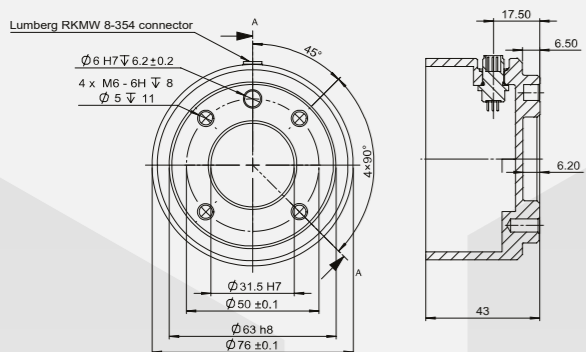
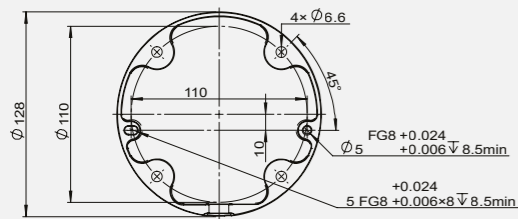
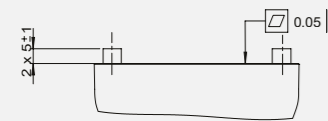
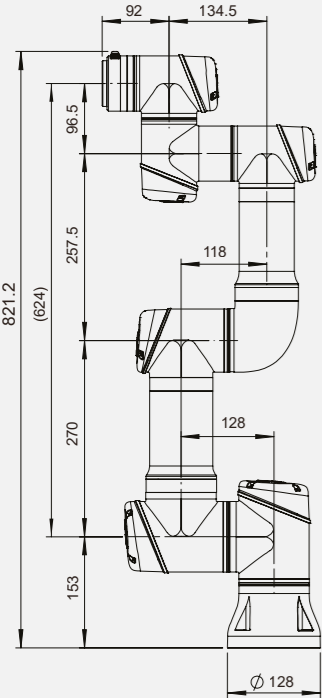
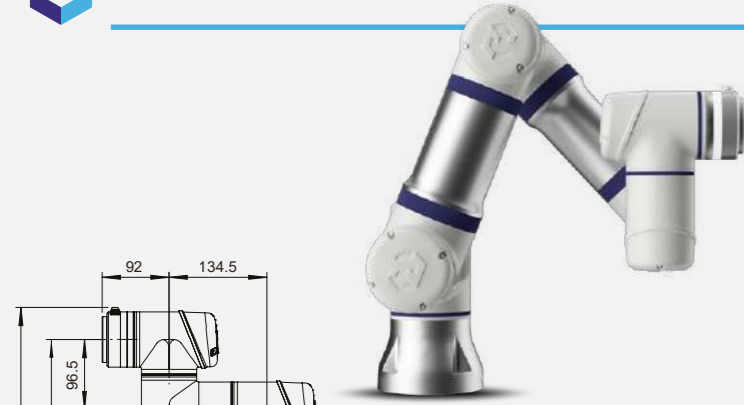

Robotic Arm

Payload	3kg	
Radius	624mm	
Accuracy	±0.02mm	
Axis	6	
Joints rotation	J1-J6	±360°
	J1-J2	180°/s
Joints speed	J3	230°/s
	J4-J6	230°/s
Typical TCP Speed	1.5 m/s	
IP rating	IP65 (optional IP68)	
Temperature range	-10~50°C	
Relative humidity	<90% (non-condensing)	
Noise reduction	<70db	
Typical power usage	185w	
Mounting	Any angle	
Tool I/O connector	M8, 8pin	
Tool I/O ports	4 config. DI / DO; 1 AI, 1 AO	
Tool I/O power supply	0 / 12V / 24V; 3A / 2A / 1A	
Tool I/O communication	RS485, Modbus RTU	
Footprint	Ø 128 mm	
Weight	15 kg	
Material	Aluminum, steel, plastic, rubber	
Cable length	5.5m*	
Certifications	ISO 13849, ISO 10218, ISO/TS 15066, ISO 14644 cleanroom class 5, RoHS; SEMI-S2; UL, CE, KCs	
Programming	Python-script, graphical proprietary user interface, free-drag/offline programming	

* Optional cable lengths of 1.5m, 3m and 10m and additional extensions up to 10m are available.



Small in size but great in applications, Elite Robots' little big cobot brings accuracy and flexibility to your line, by meticulously performing precise and meticulous tasks. Optimal for table-top and soft-grip applications, ideal for research & education.

Standard controller

Type	AC
I/O ports	24 DI, 24 DO (8 safety config. DI/DO); 2 AI, 2 AO; 4 High-Speed DI
I/O power supply	24V/3A (internal), 6A (external)
Communication	RS485, Ethernet TCP/IP, Modbus TCP/RTU, Ethernet/IP slave, Profinet slave
Size	505mm x 257mm 462mm
IP Rating	IP44
Weight	14kg
Power source	100~240 VAC, 50~60 Hz
Temperature range	0~50°C
Relative humidity	5%~95% (non-condensing)
Material	Aluminum, Steel



The standard controller integrates a holder to optionally attach the TP

OEM controller

Type	DC / AC
I/O ports	24 DI, 24 DO (8 safety config. DI/DO); 2 AI, 2 AO; 4 High-Speed DI
I/O power supply	24V/3A (internal), 6A (external)
Communication	RS485, Ethernet TCP/IP, Modbus TCP/RTU, Ethernet/IP slave, Profinet slave
Size	495mm x 200mm x 227mm
IP Rating	IP40
Weight	5kg
Power source	19~72VDC / 100~240VAC, 50~60Hz
Temperature range	0~50°C
Relative humidity	5%~95% (non-condensing)
Material	Aluminum, Steel



The optional OEM controller is suitable for integrators, OEM partners and users who want to create their own custom design.

Teach Pendant

	ERP400	ERP400S
Size	301mm x 232mm x 54mm	301mm x 232mm x 105mm
Screen size	12.1"	
Resolution	1280 x 800 pixels	
IP rating	IP54	
Weight	1.7 kg	1.6 kg
Cable length	5.5 m	
Temperature range	0~50°C	
Relative humidity	5%~95% (non-condensing)	
Material	Aluminum, plastic, rubber	
Input method	Capacitive full touch-screen	Capacitive full touch-screen, 3-mode enable key, jogging-keys, function keys



The CS teach pendant contains Elite Robots proprietary software. The optional ERP400S version integrates jogging and function keys and a 3-mode enable key for enhanced safety.



6 kg



914 mm



±0.03 mm

CS66

CS SERIES

Robotic Arm

Payload	6kg	
Radius	914mm	
Accuracy	±0.03mm	
Axis	6	
Joints rotation	J1-J6	±360°
	J1-J2	150°/s
	J3	180°/s
Joints speed	J4-J6	230°/s
Typical TCP Speed	1.5 m/s	
IP rating	IP65 (optional IP68)	
Temperature range	-10~50°C	
Relative humidity	<90% (non-condensing)	
Noise reduction	<70db	
Typical power usage	250w	
Mounting	Any angle	
Tool I/O connector	M8, 8pin	
Tool I/O ports	4 config. DI / DO; 1 AI, 1 AO	
Tool I/O power supply	0 / 12V / 24V; 3A / 2A / 1A	
Tool I/O communication	RS485, Modbus RTU	
Footprint	Ø 150 mm	
Weight	20 kg	
Material	Aluminum, steel, plastic, rubber	
Cable length	5.5m*	
Certifications	ISO 13849, ISO 10218, ISO/TS 15066, ISO 14644 cleanroom class 5, RoHS; SEMI-S2; UL, CE, KCs	
Programming	Python-script, graphical proprietary user interface, free-drag/offline programming	

* Optional cable lengths of 1.5m, 3m and 10m and additional extensions up to 10m are available.



Ideal for applications that require a small-sized cobot with sufficient reach and payload, the CS66 cobot is the must-have choice to smoothly automate your light-mid weight pick and place, assembly, dispensing tasks and more.

Standard controller

Type	AC
I/O ports	24 DI, 24 DO (8 safety config. DI/DO); 2 AI, 2 AO; 4 High-Speed DI
I/O power supply	24V/3A (internal), 6A (external)
Communication	RS485, Ethernet TCP/IP, Modbus TCP/RTU, Ethernet/IP slave, Profinet slave
Size	505mm x 257mm 462mm
IP Rating	IP44
Weight	14kg
Power source	100~240 VAC, 50~60 Hz
Temperature range	0~50°C
Relative humidity	5%~95% (non-condensing)
Material	Aluminum, Steel



The standard controller integrates a holder to optionally attach the TP

OEM controller

Type	DC / AC
I/O ports	24 DI, 24 DO (8 safety config. DI/DO); 2 AI, 2 AO; 4 High-Speed DI
I/O power supply	24V/3A (internal), 6A (external)
Communication	RS485, Ethernet TCP/IP, Modbus TCP/RTU, Ethernet/IP slave, Profinet slave
Size	495mm x 200mm x 227mm
IP Rating	IP40
Weight	5kg
Power source	19~72VDC / 100~240VAC, 50~60Hz
Temperature range	0~50°C
Relative humidity	5%~95% (non-condensing)
Material	Aluminum, Steel



The optional OEM controller is suitable for integrators, OEM partners and users who want to create their own custom design.

Teach Pendant

	ERP400	ERP400S
Size	301mm x 232mm x 54mm	301mm x 232mm x 105mm
Screen size	12.1"	
Resolution	1280 x 800 pixels	
IP rating	IP54	
Weight	1.7 kg	1.6 kg
Cable length	5.5 m	
Temperature range	0~50°C	
Relative humidity	5%~95% (non-condensing)	
Material	Aluminum, plastic, rubber	
Input method	Capacitive full touch-screen	Capacitive full touch-screen, 3-mode enable key, jogging-keys, function keys



The CS teach pendant contains Elite Robots proprietary software. The optional ERP400S version integrates jogging and function keys and a 3-mode enable key for enhanced safety.

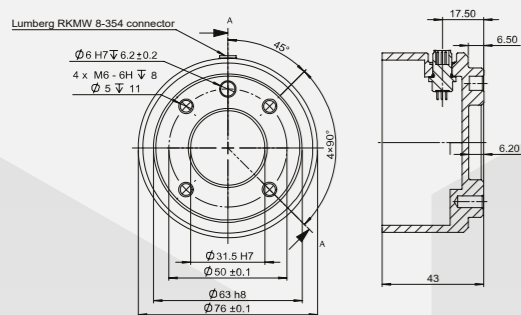
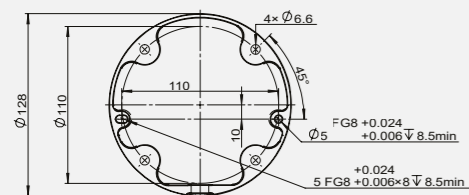
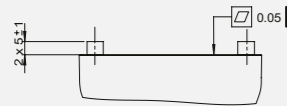
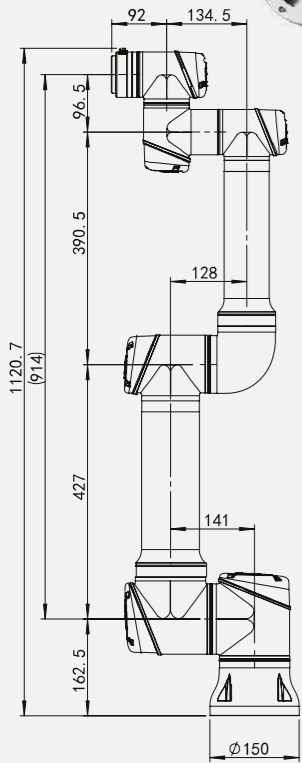
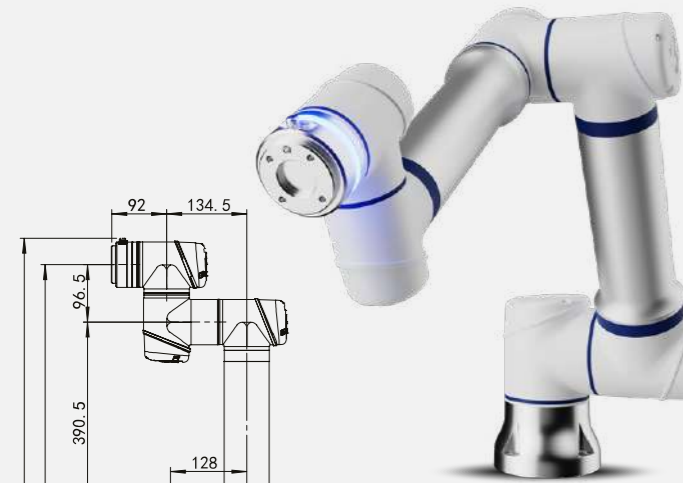



12 kg



1304 mm



±0.05 mm

CS612

CS SERIES

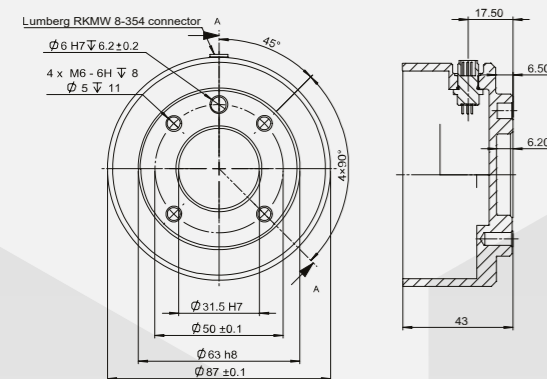
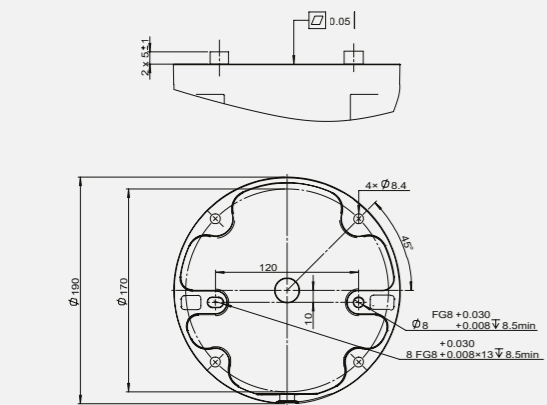
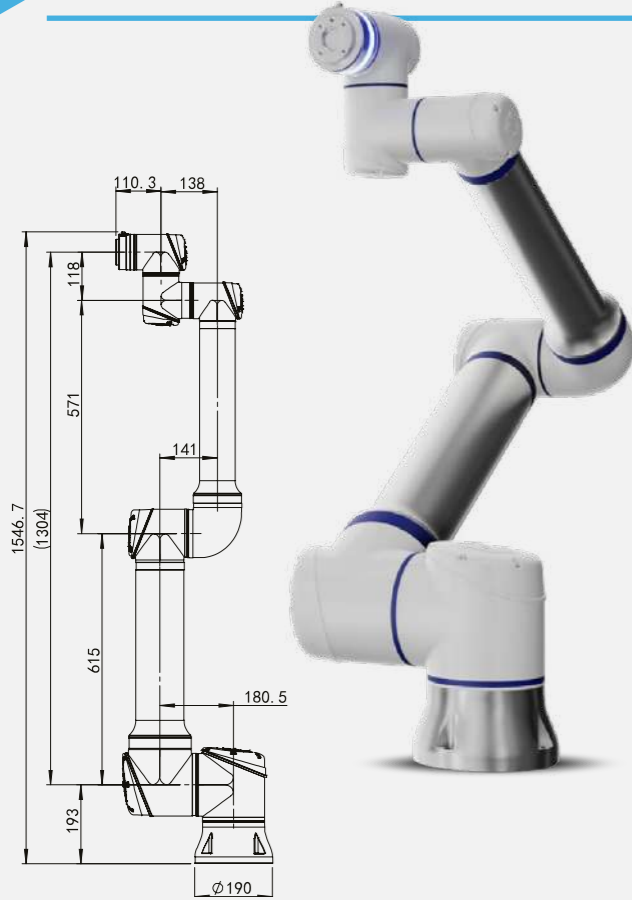

Robotic Arm

Payload	12kg	
Radius	1304mm	
Accuracy	±0.05mm	
Axis	6	
Joints rotation	J1-J6	±360°
	J1-J2	120°/s
	J3	150°/s
Joints speed	J4-J6	180°/s
Typical TCP Speed	1.5 m/s	
IP rating	IP65 (optional IP68)	
Temperature range	-10~50°C	
Relative humidity	<90% (non-condensing)	
Noise reduction	<70db	
Typical power usage	435w	
Mounting	Any angle	
Tool I/O connector	M8, 8pin	
Tool I/O ports	4 config. DI / DO; 1 AI, 1 AO	
Tool I/O power supply	0 / 12V / 24V; 3A / 2A / 1A	
Tool I/O communication	RS485, Modbus RTU	
Footprint	Ø 190 mm	
Weight	34 kg	
Material	Aluminum, steel, plastic, rubber	
Cable length	5.5m*	
Certifications	ISO 13849, ISO 10218, ISO/TS 15066, ISO 14644 cleanroom class 5, RoHS; SEMI-S2; UL, CE, KCs	
Programming	Python-script, graphical proprietary user interface, free-drag/offline programming	

* Optional cable lengths of 1.5m, 3m and 10m and additional extensions up to 10m are available.



Featuring both a long reach and a high payload, CS612 strikes the perfect balance between flexibility and power, and opens the door to an infinite range of applications, including machine tending, welding and mobility solutions with AGVs.

Standard controller

Type	AC
I/O ports	24 DI, 24 DO (8 safety config. DI/DO); 2 AI, 2 AO; 4 High-Speed DI
I/O power supply	24V/3A (internal), 6A (external)
Communication	RS485, Ethernet TCP/IP, Modbus TCP/RTU, Ethernet/IP slave, Profinet slave
Size	505mm x 257mm 462mm
IP Rating	IP44
Weight	14kg
Power source	100~240 VAC, 50~60 Hz
Temperature range	0~50°C
Relative humidity	5%~95% (non-condensing)
Material	Aluminum, Steel



The standard controller integrates a holder to optionally attach the TP

OEM controller

Type	DC / AC
I/O ports	24 DI, 24 DO (8 safety config. DI/DO); 2 AI, 2 AO; 4 High-Speed DI
I/O power supply	24V/3A (internal), 6A (external)
Communication	RS485, Ethernet TCP/IP, Modbus TCP/RTU, Ethernet/IP slave, Profinet slave
Size	495mm x 200mm x 227mm
IP Rating	IP40
Weight	5kg
Power source	19~72VDC / 100~240VAC, 50~60Hz
Temperature range	0~50°C
Relative humidity	5%~95% (non-condensing)
Material	Aluminum, Steel



The optional OEM controller is suitable for integrators, OEM partners and users who want to create their own custom design.

Teach Pendant

	ERP400	ERP400S
Size	301mm x 232mm x 54mm	301mm x 232mm x 105mm
Screen size	12.1"	
Resolution	1280 x 800 pixels	
IP rating	IP54	
Weight	1.7 kg	1.6 kg
Cable length	5.5 m	
Temperature range	0~50°C	
Relative humidity	5%~95% (non-condensing)	
Material	Aluminum, plastic, rubber	
Input method	Capacitive full touch-screen	Capacitive full touch-screen, 3-mode enable key, jogging-keys, function keys



The CS teach pendant contains Elite Robots proprietary software. The optional ERP400S version integrates jogging and function keys and a 3-mode enable key for enhanced safety.

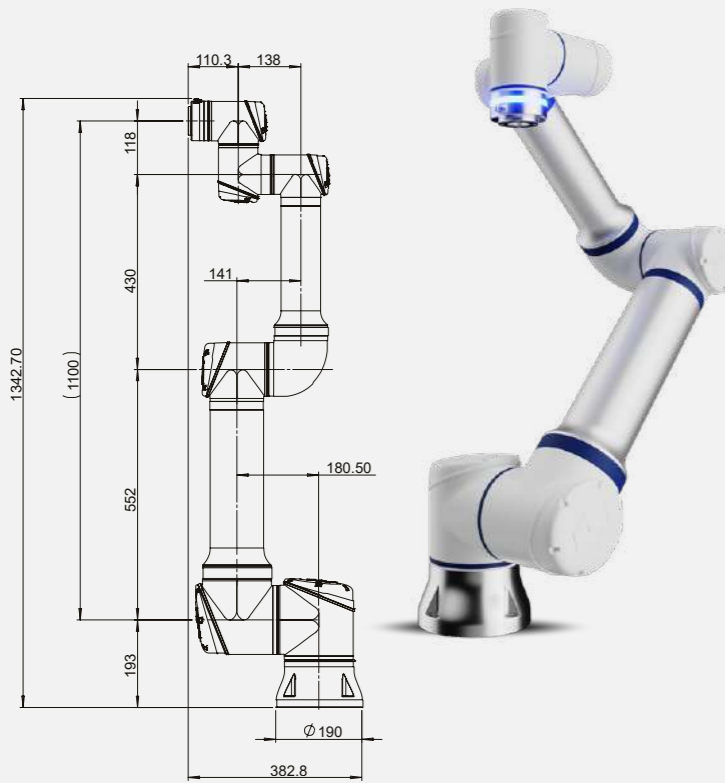

Robotic Arm

Payload	16kg	
Radius	1100mm	
Accuracy	±0.05mm	
Axis	6	
Joints rotation	J1-J6	±360°
	J1-J2	120°/s
	J3	150°/s
Joints speed	J4-J6	180°/s
Typical TCP Speed	1.5 m/s	
IP rating	IP65 (optional IP68)	
Temperature range	-10~50°C	
Relative humidity	<90% (non-condensing)	
Noise reduction	<70db	
Typical power usage	435w	
Mounting	Any angle	
Tool I/O connector	M8, 8pin	
Tool I/O ports	4 config. DI / DO; 1 AI, 1 AO	
Tool I/O power supply	0 / 12V / 24V; 3A / 2A / 1A	
Tool I/O communication	RS485, Modbus RTU	
Footprint	Ø 190 mm	
Weight	33 kg	
Material	Aluminum, steel, plastic, rubber	
Cable length	5.5m*	
Certifications	ISO 13849, ISO 10218, ISO/TS 15066, ISO 14644 cleanroom class 5, RoHS; SEMI-S2; UL, CE, KCs	
Programming	Python-script, graphical proprietary user interface, free-drag/offline programming	

* Optional cable lengths of 1.5m, 3m and 10m and additional extensions up to 10m are available.

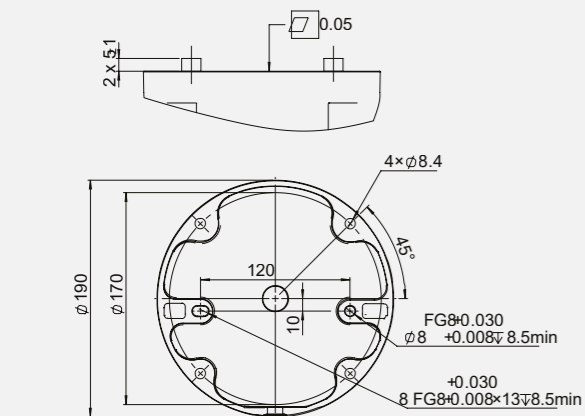

Lumberg RKMW 8-354 connector

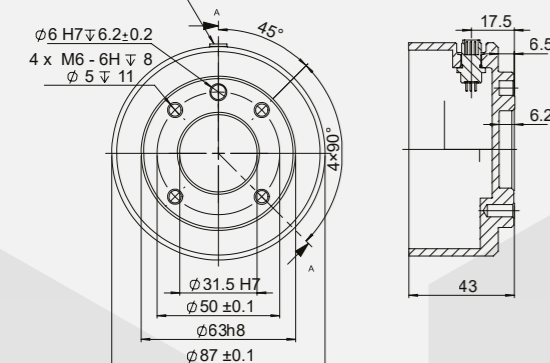

Standard controller

Type	AC
I/O ports	24 DI, 24 DO (8 safety config. DI/DO); 2 AI, 2 AO; 4 High-Speed DI
I/O power supply	24V/3A (internal), 6A (external)
Communication	RS485, Ethernet TCP/IP, Modbus TCP/RTU, Ethernet/IP slave, Profinet slave
Size	505mm x 257mm 462mm
IP Rating	IP44
Weight	14kg
Power source	100~240 VAC, 50~60 Hz
Temperature range	0~50°C
Relative humidity	5%~95% (non-condensing)
Material	Aluminum, Steel



The standard controller integrates a holder to optionally attach the TP

OEM controller

Type	DC / AC
I/O ports	24 DI, 24 DO (8 safety config. DI/DO); 2 AI, 2 AO; 4 High-Speed DI
I/O power supply	24V/3A (internal), 6A (external)
Communication	RS485, Ethernet TCP/IP, Modbus TCP/RTU, Ethernet/IP slave, Profinet slave
Size	495mm x 200mm x 227mm
IP Rating	IP40
Weight	5kg
Power source	19~72VDC / 100~240VAC, 50~60Hz
Temperature range	0~50°C
Relative humidity	5%~95% (non-condensing)
Material	Aluminum, Steel



The optional OEM controller is suitable for integrators, OEM partners and users who want to create their own custom design.

Teach Pendant

	ERP400	ERP400S
Size	301mm x 232mm x 54mm	301mm x 232mm x 105mm
Screen size	12.1"	
Resolution	1280 x 800 pixels	
IP rating	IP54	
Weight	1.7 kg	1.6 kg
Cable length	5.5 m	
Temperature range	0~50°C	
Relative humidity	5%~95% (non-condensing)	
Material	Aluminum, plastic, rubber	
Input method	Capacitive full touch-screen	Capacitive full touch-screen, 3-mode enable key, jogging-keys, function keys



The CS teach pendant contains Elite Robots proprietary software. The optional ERP400S version integrates jogging and function keys and a 3-mode enable key for enhanced safety.



18 kg



954 mm



±0.05mm

CS618

CS SERIES

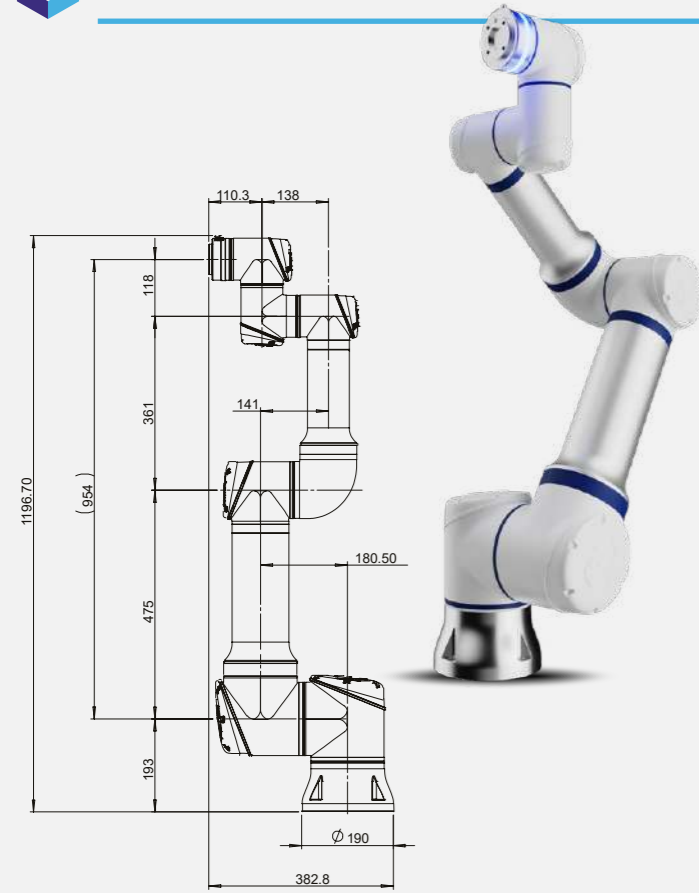

1196.70

(954)

118

361

141

180.50

475

193

Ø 190

382.8

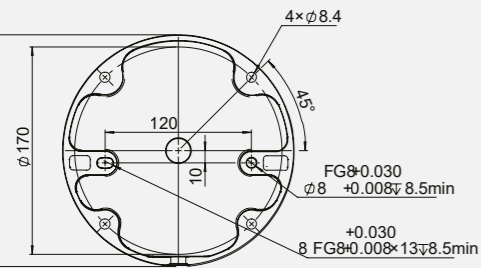
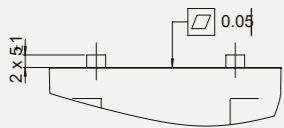

Lumberg RKMW 8-354 connector

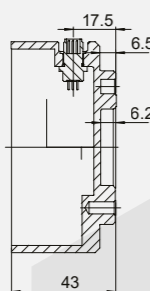
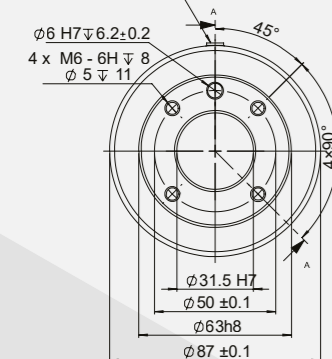

Robotic Arm

Payload	18kg	
Radius	954mm	
Accuracy	±0.05mm	
Axis	6	
Joints rotation	J1-J6	±360°
	J1-J2	120°/s
	J3	150°/s
Joints speed	J4-J6	180°/s
Typical TCP Speed	1.5 m/s	
IP rating	IP65 (optional IP68)	
Temperature range	-10~50°C	
Relative humidity	<90% (non-condensing)	
Noise reduction	<70db	
Typical power usage	435w	
Mounting	Any angle	
Tool I/O connector	M8, 8pin	
Tool I/O ports	4 config. DI / DO; 1 AI, 1 AO	
Tool I/O power supply	0 / 12V / 24V; 3A / 2A / 1A	
Tool I/O communication	RS485, Modbus RTU	
Footprint	Ø 190 mm	
Weight	33 kg	
Material	Aluminum, steel, plastic, rubber	
Cable length	5.5m*	
Certifications	ISO 13849, ISO 10218, ISO/TS 15066, ISO 14644 cleanroom class 5, RoHS; SEMI-S2; UL, CE, KCs	
Programming	Python-script, graphical proprietary user interface, free-drag/offline programming	

* Optional cable lengths of 1.5m, 3m and 10m and additional extensions up to 10m are available.



Standard controller

Type	AC
I/O ports	24 DI, 24 DO (8 safety config. DI/DO); 2 AI, 2 AO; 4 High-Speed DI
I/O power supply	24V/3A (internal), 6A (external)
Communication	RS485, Ethernet TCP/IP, Modbus TCP/RTU, Ethernet/IP slave, Profinet slave
Size	505mm x 257mm 462mm
IP Rating	IP44
Weight	14kg
Power source	100~240 VAC, 50~60 Hz
Temperature range	0~50°C
Relative humidity	5%~95% (non-condensing)
Material	Aluminum, Steel



The standard controller integrates a holder to optionally attach the TP

OEM controller

Type	DC / AC
I/O ports	24 DI, 24 DO (8 safety config. DI/DO); 2 AI, 2 AO; 4 High-Speed DI
I/O power supply	24V/3A (internal), 6A (external)
Communication	RS485, Ethernet TCP/IP, Modbus TCP/RTU, Ethernet/IP slave, Profinet slave
Size	495mm x 200mm x 227mm
IP Rating	IP40
Weight	5kg
Power source	19~72VDC / 100~240VAC, 50~60Hz
Temperature range	0~50°C
Relative humidity	5%~95% (non-condensing)
Material	Aluminum, Steel



The optional OEM controller is suitable for integrators, OEM partners and users who want to create their own custom design.

Teach Pendant

	ERP400	ERP400S
Size	301mm x 232mm x 54mm	301mm x 232mm x 105mm
Screen size	12.1"	
Resolution	1280 x 800 pixels	
IP rating	IP54	
Weight	1.7 kg	1.6 kg
Cable length	5.5 m	
Temperature range	0~50°C	
Relative humidity	5%~95% (non-condensing)	
Material	Aluminum, plastic, rubber	
Input method	Capacitive full touch-screen	Capacitive full touch-screen, 3-mode enable key, jogging-keys, function keys

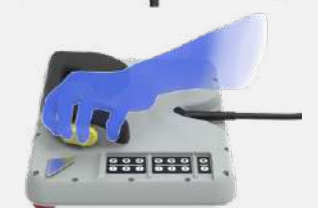

The CS teach pendant contains Elite Robots proprietary software. The optional ERP400S version integrates jogging and function keys and a 3-mode enable key for enhanced safety.

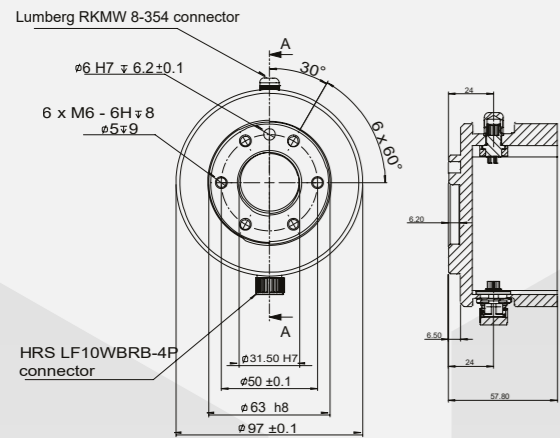
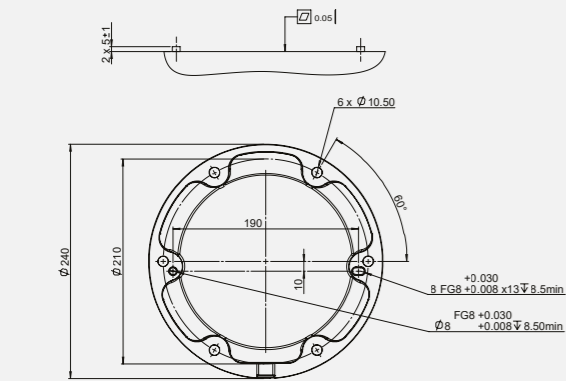
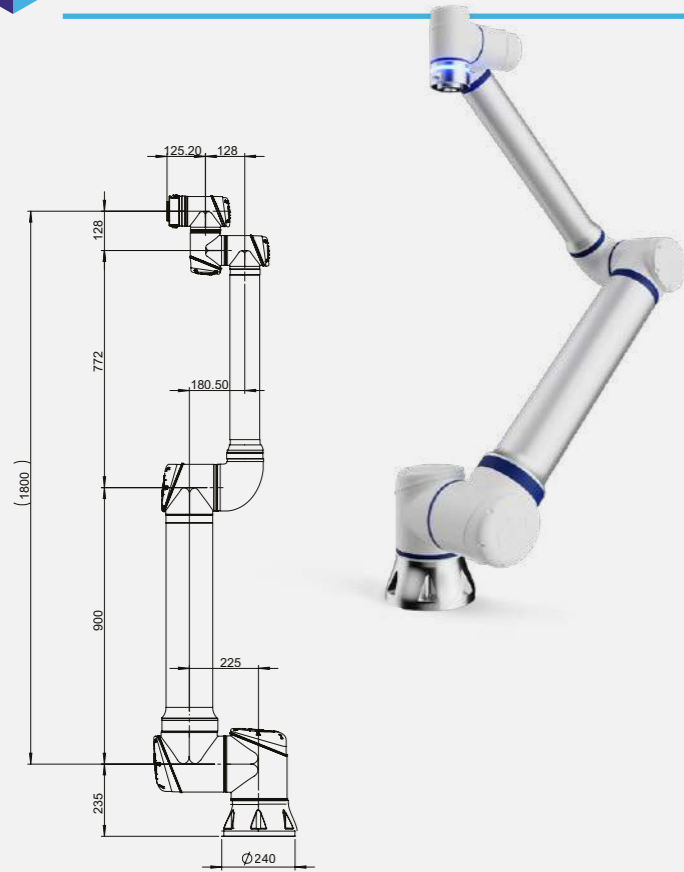

Robotic Arm

Payload	20kg	
Radius	1800mm	
Accuracy	±0.1mm	
Axis	6	
Joints rotation	J1-J6	±360°
	J1-J2	125°/s
	J3	150°/s
Joints speed	J4-J6	210°/s
Typical TCP Speed	2.0 m/s	
IP rating	IP65 (optional IP68)	
Temperature range	-10~50°C	
Relative humidity	<90% (non-condensing)	
Noise reduction	<70db	
Typical power usage	625w	
Mounting	Any angle	
Tool I/O connector	T1: M8, 8pin T2: Ø 12.8mm, 4pin	
Tool I/O ports	4 config. DI / DO; 1 AI, 1 AO	
Tool I/O power supply	T1: 0 / 12V / 24V; 3A / 2A / 1A T2: 24 V; 5A	
Tool I/O communication	RS485, Modbus RTU	
Footprint	Ø 240 mm	
Weight	60 kg	
Material	Aluminum, steel, plastic, rubber	
Cable length	5.5m*	
Certifications	ISO 13849, ISO 10218, ISO/TS 15066, ISO 14644 cleanroom class 5, RoHS; SEMI-S2; UL, CE, KCs	
Programming	Python-script, graphical proprietary user interface, free-drag/offline programming	

* Optional cable lengths of 1.5m, 3m and 10m and additional extensions up to 10m are available.



Equipped with a dual 3A/5A tool connector for enhanced power, CS620 features a 20 kg payload and the longest reach of all CS cobots, and can effectively perform palletizing, welding and other demanding tasks, and handle multiple devices simultaneously.

Standard controller

Type	AC
I/O ports	24 DI, 24 DO (8 safety config. DI/DO); 2 AI, 2 AO; 4 High-Speed DI
I/O power supply	24V/3A (internal), 6A (external)
Communication	RS485, Ethernet TCP/IP, Modbus TCP/RTU, Ethernet/IP slave, Profinet slave
Size	505mm x 257mm 462mm
IP Rating	IP44
Weight	16kg
Power source	100~240 VAC, 50~60 Hz
Temperature range	0~50°C
Relative humidity	5%~95% (non-condensing)
Material	Aluminum, Steel



The standard controller integrates a holder to optionally attach the TP

OEM controller

Type	DC / AC
I/O ports	24 DI, 24 DO (8 safety config. DI/DO); 2 AI, 2 AO; 4 High-Speed DI
I/O power supply	24V/3A (internal), 6A (external)
Communication	RS485, Ethernet TCP/IP, Modbus TCP/RTU, Ethernet/IP slave, Profinet slave
Size	495mm x 200mm x 227mm
IP Rating	IP40
Weight	7 kg
Power source	19~72VDC / 100~240VAC, 50~60Hz
Temperature range	0~50°C
Relative humidity	5%~95% (non-condensing)
Material	Aluminum, Steel



The optional OEM controller is suitable for integrators, OEM partners and users who want to create their own custom design.

Teach Pendant

	ERP400	ERP400S
Size	301mm x 232mm x 54mm	301mm x 232mm x 105mm
Screen size	12.1"	
Resolution	1280 x 800 pixels	
IP rating	IP54	
Weight	1.7 kg	1.6 kg
Cable length	5.5 m	
Temperature range	0~50°C	
Relative humidity	5%~95% (non-condensing)	
Material	Aluminum, plastic, rubber	
Input method	Capacitive full touch-screen	Capacitive full touch-screen, 3-mode enable key, jogging-keys, function keys



The CS teach pendant contains Elite Robots proprietary software. The optional ERP400S version integrates jogging and function keys and a 3-mode enable key for enhanced safety.

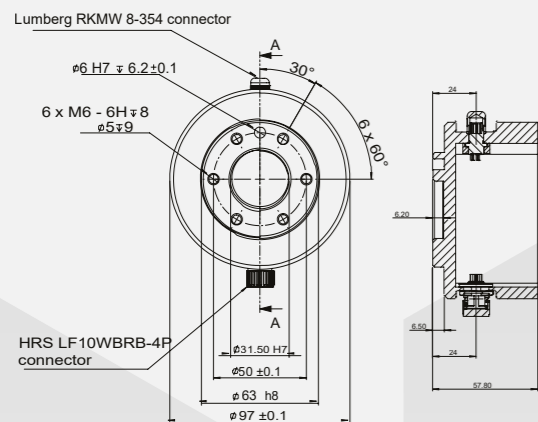
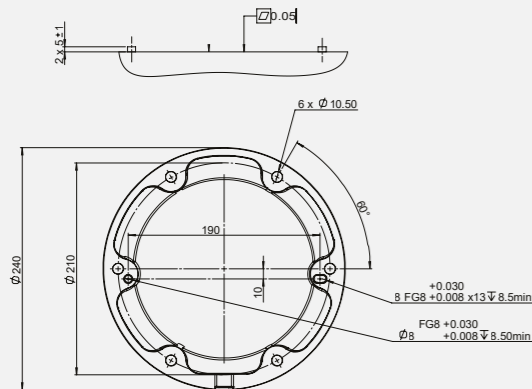
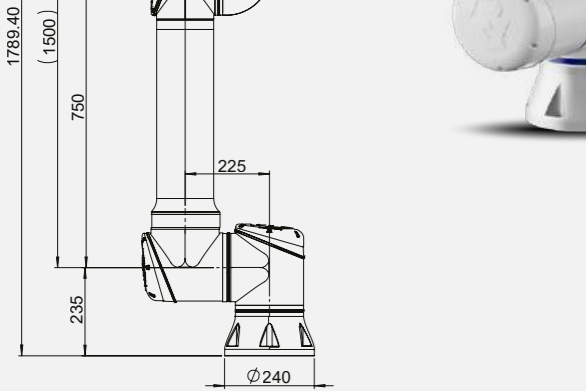
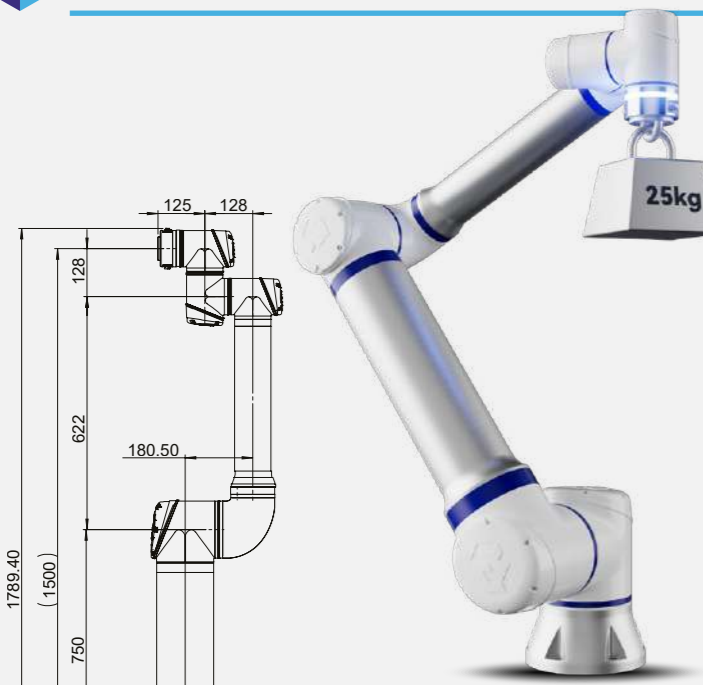

Robotic Arm

Payload	25kg	
Radius	1500mm	
Accuracy	±0.08mm	
Axis	6	
Joints rotation	J1-J6	±360°
	J1-J2	125°/s
	J3	150°/s
Joints speed	J4-J6	210°/s
Typical TCP Speed	2.0 m/s	
IP rating	IP65 (optional IP68)	
Temperature range	-10~50°C	
Relative humidity	<90% (non-condensing)	
Noise reduction	<70db	
Typical power usage	625w	
Mounting	Any angle	
Tool I/O connector	T1: M8, 8pin T2: Ø 12.8mm, 4pin	
Tool I/O ports	4 config. DI / DO; 1 AI, 1 AO	
Tool I/O power supply	T1: 0 / 12V / 24V; 3A / 2A / 1A T2: 24 V; 5A	
Tool I/O communication	RS485, Modbus RTU	
Footprint	Ø 240 mm	
Weight	58 kg	
Material	Aluminum, steel, plastic, rubber	
Cable length	5.5m*	
Certifications	ISO 13849, ISO 10218, ISO/TS 15066, ISO 14644 cleanroom class 5, RoHS; SEMI-S2; UL, CE, KCs	
Programming	Python-script, graphical proprietary user interface, free-drag/offline programming	

* Optional cable lengths of 1.5m, 3m and 10m and additional extensions up to 10m are available.



Featuring the same architecture as CS620, the CS625 is the cobot with the highest payload of the entire CS series. Yet, with a weight of only 58kg and an ultra-compact 240mm footprint (the same as CS620), this collaborative robot ensures broad versatility on any work floor.

Standard controller

Type	AC
I/O ports	24 DI, 24 DO (8 safety config. DI/DO); 2 AI, 2 AO; 4 High-Speed DI
I/O power supply	24V/3A (internal), 6A (external)
Communication	RS485, Ethernet TCP/IP, Modbus TCP/RTU, Ethernet/IP slave, Profinet slave
Size	505mm x 257mm 462mm
IP Rating	IP44
Weight	16kg
Power source	100~240 VAC, 50~60 Hz
Temperature range	0~50°C
Relative humidity	5%~95% (non-condensing)
Material	Aluminum, Steel



The standard controller integrates a holder to optionally attach the TP

OEM controller

Type	DC / AC
I/O ports	24 DI, 24 DO (8 safety config. DI/DO); 2 AI, 2 AO; 4 High-Speed DI
I/O power supply	24V/3A (internal), 6A (external)
Communication	RS485, Ethernet TCP/IP, Modbus TCP/RTU, Ethernet/IP slave, Profinet slave
Size	495mm x 200mm x 227mm
IP Rating	IP40
Weight	7 kg
Power source	19~72VDC / 100~240VAC, 50~60Hz
Temperature range	0~50°C
Relative humidity	5%~95% (non-condensing)
Material	Aluminum, Steel



The optional OEM controller is suitable for integrators, OEM partners and users who want to create their own custom design.

Teach Pendant

	ERP400	ERP400S
Size	301mm x 232mm x 54mm	301mm x 232mm x 105mm
Screen size	12.1"	
Resolution	1280 x 800 pixels	
IP rating	IP54	
Weight	1.7 kg	1.6 kg
Cable length	5.5 m	
Temperature range	0~50°C	
Relative humidity	5%~95% (non-condensing)	
Material	Aluminum, plastic, rubber	
Input method	Capacitive full touch-screen	Capacitive full touch-screen, 3-mode enable key, jogging-keys, function keys



The CS teach pendant contains Elite Robots proprietary software. The optional ERP400S version integrates jogging and function keys and a 3-mode enable key for enhanced safety.



- **HEADQUARTERS**

Xuelin Road 36, Bldg. 18
201210, Shanghai (China)
Ph: +86 400 1899358

- **NORTH & SOUTH AMERICA OPERATIONS CENTER**

10521 Research Dr., Ste 104
37932, Knoxville, TN (USA)
Ph: +1 865 392 1215

- **EUROPE OPERATIONS CENTER**

Münchener Str. 53
85290, Geisenfeld, Bavaria (Germany)
Ph: +49 8452 7330091

- **JAPAN OPERATIONS CENTER**

TOSHIN Hirokoji Honmachi Bldg., 1F, 2-4-3
Nagoya, 460-0008 (Japan)
Ph: +81 52 291442

- **GLOBAL PRODUCTION FACILITY**

Changyang Road 259, Bldg. 4
215123, Suzhou (China)
Ph: +86 0512 83951898

- **NORTHERN CHINA OPERATIONS CENTER**

South Ronghua Road 2, Bldg. 6, Rm. 1102
Beijing, 100176 (China)
Ph: +86 400 1899358

- **SOUTHERN CHINA OPERATIONS CENTER**

Wutong Island, Hangkong road, Bldg. 1A, Ste. 202
Shenzhen, 518100 (China)
Ph: +86 400 1899358

www.eliterobots.com

 Elite Robots

 @EliteRobotsOfficial / @EliteRobotsTech