



Tag us in your pictures on Instagram

@6_sided_lights

www.6sidedlights.co.uk

Email: info@6sidedlights.co.uk

Install Instructions



Please read these instructions before assembling this product, & keep for subsequent reference

Design Sketch:

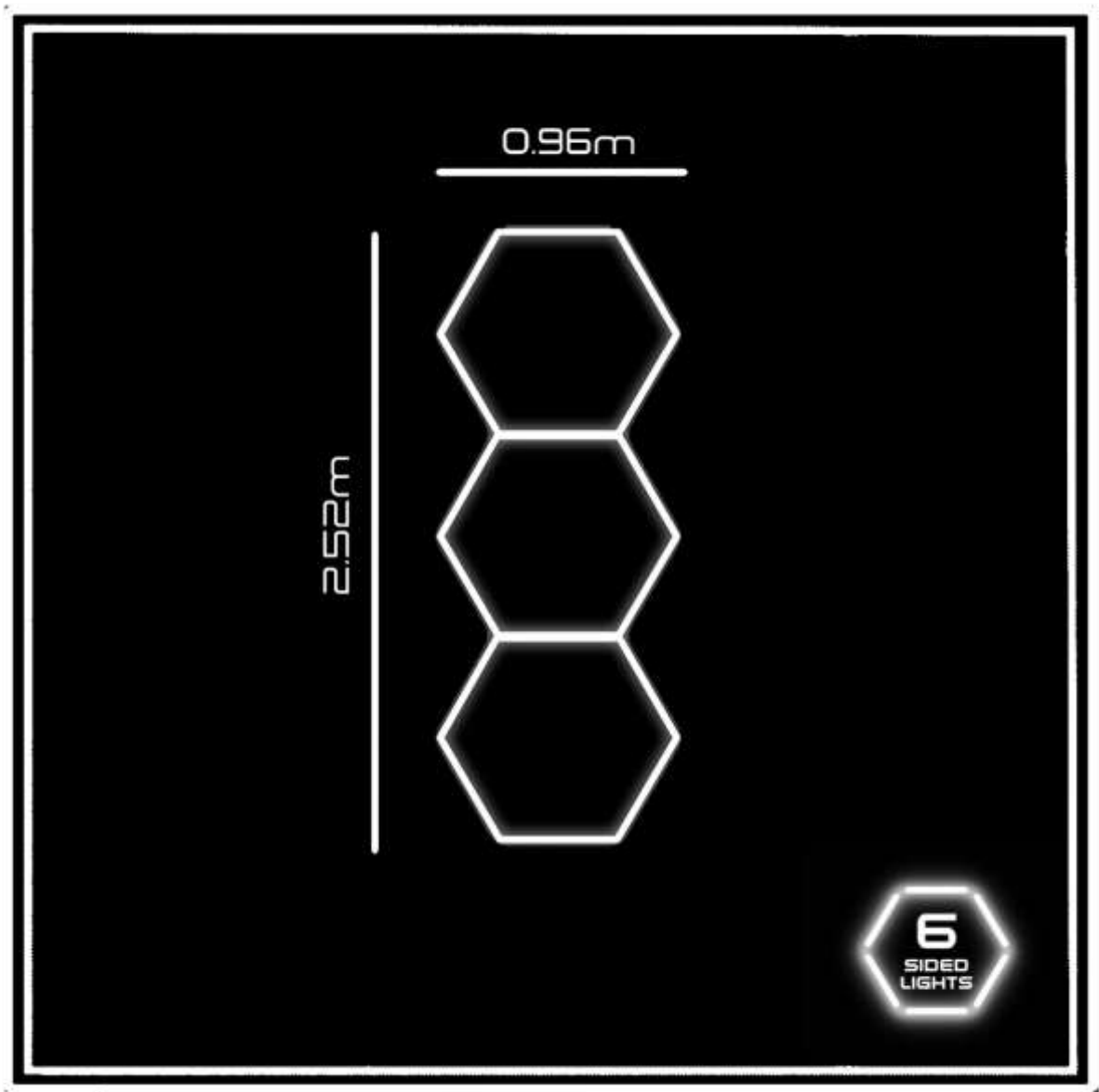

Series	Name	Specification	QTY	Unit
1	Tubes	L:440*20mm Power 6W	16	Pieces
2	Connectors	120º 2-Way	9	Pieces
3	Connectors	120º Y Connector	5	Pieces
4	Cable	1-End	1	Pieces
5	Manual	-	1	Pieces

Connect the tubes in series as follows:

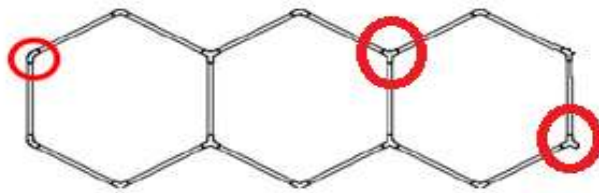

1. The 3  connect as follow picture

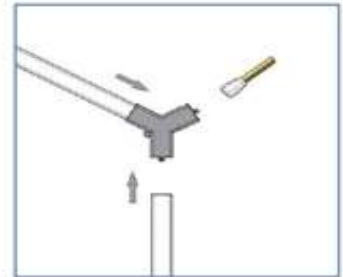

2. Other 3-end connection connect as follow picture

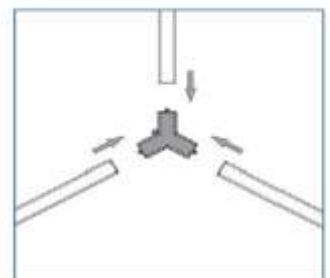

3. Other 2-end connection connect as follow picture

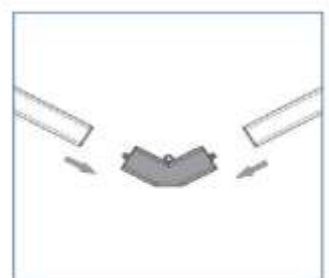

Caution!!

Please be careful while connecting tubes. Connectors are copper and could be damaged if careless. Do not force them together. If they wont connect, try a different tube/connector.

Connection should be made via provided cable wired into lighting circuit. A professional electrician is recommended.

RED = L

BLUE = N

YELLOW = E

Depending on your circuit breaker you may experience the power being cut. This is due to the inrush of current to the LED's. A different circuit breaker might be required to deal with the initial surge of current. Please refer to a professional electrician.

How to install to ceiling:

Grid roof:



Tie it with ribbons

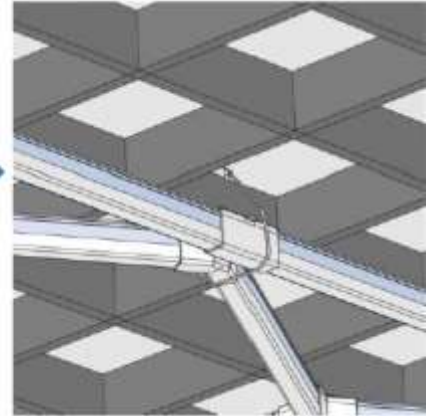

Flat Roof:



Use hole on connectors to screw into flat ceiling/wall to secure.

Technical Data:

Power: AC230V/96W

Current:5A

Width:20mm

Luminous Flux 110-120lm/w

CRI: >90

CCT: 6500K (White)

Material: Aluminium & PVC Diffuser