

***NAOMI JEANETTE ROBINSON LOGISTICS GROUP
PROPERTY SURVEY***



The Robinson's Estate Sub-Division

Custom Homes Building on Stilts Design

3047 Bass Landing Road

Edenton, NC 27932

Property Length - 1,080'

Property Width - 1,120'

30.31 Acres Lot

Cell: (252)903-3751

tariq.robinson1969@gmail.com

<https://njrtruckingllc.com/pro-sales-specialist>

***Residential Custom Home
Design Draft***

<i>STAKE / GRADE STATION# PROPERTY SURVEYING FOR 15,000 SQ. FT. STILTS (From Center Stake)</i>	<i>NORTH</i>	<i>EAST</i>	<i>SOUTH</i>	<i>WEST</i>	<i>HUB LOCATION</i>	<i>HUB GRADE (Stilts)</i>	<i>TRANSIT ELEVATION</i>
<i>Center Stake Stilts Grade</i>	<i>580'</i>	<i>630'</i>	<i>550'</i>	<i>1,020'</i>	<i>120° Degrees Southwest</i>	<i>Fill - 24'</i>	<i>4.25' Above Hub Bass Landing Road</i>
<i>Driveway Entrance (40' Width)</i>	<i>80° - 670' Northeast</i>	<i>N/a</i>	<i>N/a</i>	<i>N/a</i>	<i>80° Northeast</i>	<i>Cut - 12"</i>	<i>4.25' Above Center Stake Hub</i>
<i>Driveway Ramp on Stilts Entrance (40' Width)</i>	<i>N/a</i>	<i>N/a</i>	<i>110° - 400' Southeast</i>	<i>N/a</i>	<i>110° Southeast</i>	<i>Fill- 4'</i>	<i>4.25' Above Center Stake Hub</i>
<i>Parking Garage on Stilts Destination (40' Width)</i>	<i>N/a</i>	<i>N/a</i>	<i>120° - 50' Southeast</i>	<i>N/a</i>	<i>120° Southeast</i>	<i>Fill 21.39'</i>	<i>4.25' Above Center Stake Hub</i>
<i>Beginning of Underground Parking (900'L x 50'W x 14'H)</i>	<i>N/a</i>	<i>N/a</i>	<i>100° - 60' Southeast</i>	<i>N/a</i>	<i>100° Southeast</i>	<i>Fill - 21.47'</i>	<i>4.25' Above Center Stake Hub</i>

<i>STAKE / GRADE STATION# PROPERTY SURVEYING FOR 15,000 SQ. FT. STILTS (From Center Stake)</i>	<i>NORTH</i>	<i>EAST</i>	<i>SOUTH</i>	<i>WEST</i>	<i>HUB LOCATION</i>	<i>HUB GRADE (Stilts)</i>	<i>TRANSIT ELEVATION</i>
--	--------------	-------------	--------------	-------------	-------------------------	-----------------------------------	------------------------------

Residential Custom Home Design Leveling Chart for House

<i>STAKE / GRADE STATION# PROPERTY SURVEYING FOR 15,000 SQ. FT. STILTS (From Center Stake)</i>	<i>NORTH</i>	<i>EAST</i>	<i>SOUTH</i>	<i>WEST</i>	<i>HUB LOCATION</i>	<i>HUB GRADE (Stilts)</i>	<i>TRANSIT ELEVATION</i>
--	--------------	-------------	--------------	-------------	-------------------------	-----------------------------------	------------------------------

<i>America Home Place (The Southampton Model - Daughters Home 74' x 55' / 5 Beds / 3.5 Baths On Stilts</i>	<i>17° - 420' Northeast</i>	<i>N/a EAST</i>	<i>N/a SOUTH</i>	<i>N/a WEST</i>	<i>17° Northeast</i>	<i>+24.47'</i>	<i>4.25' Above Center Stake Hub</i>
--	---------------------------------	---------------------	----------------------	---------------------	--------------------------	----------------	---

<i>America Home Place (The Southampton Model - Son's Home 74' x 55' / 5 Beds / 3.5 Baths On Stilts</i>	<i>320° - 515' Northwest</i>	<i>N/a</i>	<i>N/a</i>	<i>N/a</i>	<i>320° Northwest</i>	<i>+25.23'</i>	<i>4.25' Above Center Stake Hub</i>
--	----------------------------------	------------	------------	------------	---------------------------	----------------	---

<i>Main House Front Right Corner (House 150' x 100' x 48') On Stilts</i>	<i>300° - 77' Northeast</i>	<i>N/a</i>	<i>N/a</i>	<i>N/a</i>	<i>300° Northeast</i>	<i>+24'</i>	<i>4.25' Above Center Stake Hub</i>
--	---------------------------------	------------	------------	------------	---------------------------	-------------	---

<i>Main House Front Left Corner (House 150' x 100' x 48') On Stilts</i>	<i>N/a</i>	<i>N/a</i>	<i>219°-70' Southwest</i>	<i>N/a</i>	<i>219° Southwest</i>	<i>+24'</i>	<i>4.25' Above Center Stake Hub</i>
---	------------	------------	-------------------------------	------------	---------------------------	-------------	---

<i>Main House Rear Right Corner (House 150' x 100' x 48') On Stilts</i>	<i>N/a</i>	<i>N/a</i>	<i>343° - 125' Southwest</i>	<i>N/a</i>	<i>343° Southwest</i>	<i>+26.67'</i>	<i>4.25' Above Center Stake Hub</i>
---	------------	------------	----------------------------------	------------	---------------------------	----------------	---

<i>Main House Rear Left Corner (House</i>	<i>N/a</i>	<i>N/a</i>	<i>268° - 120' Southwest</i>	<i>N/a</i>	<i>268° Southwest</i>	<i>+18.93'</i>	<i>4.25' Above Center Stake Hub</i>
---	------------	------------	----------------------------------	------------	---------------------------	----------------	---

150' x 100' x 48')
On Stilts

Home Office Truck Garage (50' x 100' x 25') Front Right Corner On Stilts	80° - 360' Northeast	N/a	N/a	N/a	80° Northeast	+12.46'	4.25' Above Center Stake Hub
Home Office Truck Garage (50' x 100' x 25') Front Left Corner On Stilts	74° - 320' Northeast	N/a	N/a	N/a	74° Northeast	+14.49'	4.25' Above Center Stake Hub
Home Office Truck Garage (50' x 100' x 25') Rear Right Corner On Stilts	N/a	N/a	100° - 300' Southeast	N/a	100° Southeast	+11.77'	4.25' Above Center Stake Hub
Home Office Truck Garage (50' x 100' x 25') Rear Left Corner On Stilts	N/a	90° - 250' East	N/a	N/a	90° East	+14.12'	4.25' Above Center Stake Hub
Greenhouse (100' x 25' x 12') Level Building Pad On Stilts	1° - 240' Northeast	N/a	N/a	N/a	1° Northeast	+20.63'	4.25' Above Center Stake Hub
Daughter's Garage (55' x 35' x 15') Level Building Pad On Stilts	7° - 350' Northeast	N/a	N/a	N/a	7° Northeast	+20.99'	4.25' Above Center Stake Hub
Son's Garage (55' x 35' x 15') Level Building Pad On Stilts	344° - 470' Northwest	N/a	N/a	N/a	344° Northwest	+21.59'	4.25' Above Center Stake Hub

Garden (100' x 100') Level Ground	330° - 380' Northwest	N/a	N/a	N/a	330° Northwest	+2.7'	4.25' Above Center Stake Hub
-----------------------------------	-----------------------	-----	-----	-----	----------------	-------	------------------------------

STAKE / GRADE STATION# PROPERTY SURVEYING FOR 15,000 SQ. FT. STILTS (From Center Stake)	NORTH	EAST	SOUTH	WEST	HUB LOCATION	HUB GRADE (Dirt)	TRANSIT ELEVATION
--	--------------	-------------	--------------	-------------	---------------------	-------------------------	--------------------------

Residential Custom Home Design Leveling Chart for Boardwalk & Bridge

STAKE / GRADE STATION# PROPERTY SURVEYING FOR 15,000 SQ. FT. STILTS (From Center Stake)	NORTH	EAST	SOUTH	WEST	HUB LOCATION	HUB GRADE (Dirt)	TRANSIT ELEVATION
--	--------------	-------------	--------------	-------------	---------------------	-------------------------	--------------------------

Boat Ramp (Decline Starting Point - 100' Length)	316° -610' Northwest	N/a	N/a	N/a	316° Northwest	+25.31'	4.25' Above Center Stake Hub
Boat Ramp (Decline Ending Point - 100' Length w/41.41' Decline to Riverbed Floor)	336° -590' Northwest	N/a	N/a	N/a	336° Northwest	Cut - 18.30'	4.25' Above Center Stake Hub
Outside Kitchen on Boardwalk (50' x 50' x 12') Level Boardwalk	333° -790' Northwest	N/a	N/a	N/a	333° Northwest	+26'	4.25' Above Center Stake Hub
Walking Bridge Starting Point (200' x 25' / 9' Above Land / 35' Above River Low Tide)	333° -500' Northwest	N/a	N/a	N/a	333° Northwest	+28.58'	4.25' Above Center Stake Hub

<i>Walking Bridge Ending Point (200' x 25' / 9' Above Land / 35' Above River Low Tide)</i>	<i>333° -700' Northwest</i>	<i>N/a</i>	<i>N/a</i>	<i>N/a</i>	<i>333° Northwest</i>	<i>+33.00'</i>	<i>4.25' Above Center Stake Hub</i>
<i>Boat Dock (45'L x 15'W x 50"H [low tide])</i>	<i>333° -890' Northwest</i>	<i>N/a</i>	<i>N/a</i>	<i>N/a</i>	<i>333° Northwest</i>	<i>+4.17'</i>	<i>4.25' Above Center Stake Hub</i>
<i>Pool (75'L x 50'W [On Stilts])</i>	<i>293° -330' Northwest</i>	<i>N/a</i>	<i>N/a</i>	<i>N/a</i>	<i>293° Northwest</i>	<i>+20.43'</i>	<i>4.25' Above Center Stake Hub</i>
<i>Hobby Warehouse (100'L x 100'W [On Stilts])</i>	<i>280° -570' Northwest</i>	<i>N/a</i>	<i>N/a</i>	<i>N/a</i>	<i>280° Northwest</i>	<i>+25.42'</i>	<i>4.25' Above Center Stake Hub</i>
<i>Outdoors Home Theater (100' x 25' [On Stilts])</i>	<i>N/a</i>	<i>N/a</i>	<i>260° -480' Southwest</i>	<i>N/a</i>	<i>260° Southwest</i>	<i>+20.38'</i>	<i>4.25' Above Center Stake Hub</i>
<i>Basketball / Volleyball Court (100' x 50' [On Stilts])</i>	<i>N/a</i>	<i>N/a</i>	<i>234° -340' Southwest</i>	<i>N/a</i>	<i>234° Southwest</i>	<i>+13.75'</i>	<i>4.25' Above Center Stake Hub</i>
<i>Wind Turbine, Generator / Solar Panel Farm (100' x 100' [Level Ground for Excavation])</i>	<i>N/a</i>	<i>N/a</i>	<i>265° -650' Southwest</i>	<i>N/a</i>	<i>265° Southwest</i>	<i>+25.69'</i>	<i>4.25' Above Center Stake Hub</i>
<i>Bowling Lanes (100' x 50' x 15' [On Stilts])</i>	<i>N/a</i>	<i>N/a</i>	<i>230° -460' Southwest</i>	<i>N/a</i>	<i>230° Southwest</i>	<i>+18.95'</i>	<i>4.25' Above Center Stake Hub</i>
<i>Helicopter Pad (50' x 50') On Stilts</i>	<i>N/a</i>	<i>N/a</i>	<i>191° -510' Southwest</i>	<i>N/a</i>	<i>191° Southwest</i>	<i>+9.10'</i>	<i>4.25' Above Center Stake Hub</i>

STAKE / GRADE STATION# PROPERTY SURVEYING FOR 15,000 SQ. FT. STILTS (From Center Stake)

NORTH EAST SOUTH WEST HUB LOCATION HUB GRADE (Dirt) TRANSIT ELEVATION

Residential Custom Home Design for Entertainment

Custom Property Designed and Built by N.J.R. Logistics Group

Hobby Warehouse (Entertainment) - 10,000 sq. feet on Stilts

- ◆ *Hobby Works RC Construction - 100'L x 25'W x 30'H*
 - *Sand Box - 2,500 Sq. Feet with 24" Sand*
 - *Tower Cranes*
 - *Building a Sky Scrapper Setting*
 - *Crawler Cranes*
 - *Building a Parking Garage Setting*
 - *All-Terrain Cranes*
 - *Building a Distribution Center Setting*
 - *Earth Moving Equipment*
 - *Building on Airport on Swamp Land Setting*
 - *Semi Trucks*
 - *Driving in a Congested City with Specialized Shipment Setting*
 - *Hobby Works Lionel Train Layout Warehouse - 2,500 Sq. Feet*
 - *Concrete Cable Stayed Bridges*
 - *Concrete Suspension Bridges*
 - *8" Concrete Tubes Tunnels*
 - *1,000' of Tracks*
 - ◆ *Intermodal Facility*
 - ◆ *Railyard*
 - ◆ *Bridges and Mountains Setting*
 - *Hobby Works Digital Slot Cars Warehouse - 2,500 Sq. Feet*
 - *Road Course*
 - *Oval Track*
- ◆ *Hobby Lobby Outside RC Nitro Cars Drag Strip & Course Track*
 - *1/8 - Mile Drag Strip*
 - *1/4 - Mile Oval Track*
 - *1/2 - Mile Road Course*
- ◆ *Hobby Works RC Aircraft Facility*
 - *8 - 1,000' Runways*
 - *Newark International Airport Construction Design in Concrete*
 - *New York City Skyline*
 - *Newark City Skyline*
 - *Tri State Bridges in Concrete*
- ◆ *Residential Bridge (Prevent Landscaping Destruction)*
 - *200'L x 10'W x 25' Height*
- ◆ *Boardwalk*
 - *500'L x 10'W x 10' Height Boardwalk*
 - *Underground Parking & Tunnels (Privacy and Security)*
 - *Walking Tunnel from Car Garage Leading to House*
 - *Parking Tunnel to and From Garage*
 - *Underground Parking with a 3-Car Parking Lift for All Members of the family on Family Events*
 - *Floating Sidewalks (Prevent Dirt into Vehicles and House)*

STAKE / GRADE STATION# PROPERTY SURVEYING FOR 15,000 SQ. FT. STILTS (From Property Line Left [Bass Landing Road])	ELEVATION (North)	ELEVATION (East)	ELEVATION (South)	ELEVATION (West)	ABOVE SEA LEVEL (2.3' County)
Center Stake (From East Points (90°, 180°, 270°, 360° to center stake)	460' +1' Incline	26.67' + 1' Incline	22.5' + 1' Incline	525' + 1' Incline	26.3' Above Sea Level
Driveway Entrance (40' Width) (From Left Side of Property Line)	1.34' - 1' Decline to Property Line (Northeast)	N/a	N/a	N/a	1.3' Above Sea Level
Driveway Ramp on Stilts Entrance (40' Width) (From Left Side of property Line)	N/a	N/a	3.58' - 1' Decline to Property Line (Southeast)	N/a	6.3' Above Sea Level
Driveway on Stilts Destination (40' Width) (From Left Side Property Line)	N/a	N/a	21.44' - 1' Decline to Property Line (Southeast)	N/a	25.3' Above Sea Level

STAKE / GRADE STATION# PROPERTY SURVEYING FOR 15,000 SQ. FT. STILTS (From Property Line Left [Bass Landing Road])	ELEVATION (North)	ELEVATION (East)	ELEVATION (South)	ELEVATION (West)	ABOVE SEA LEVEL (2.3' County)
--	------------------------------	-----------------------------	------------------------------	-----------------------------	--

Residential Custom Home Design Center Stake Chart

STAKE / GRADE STATION# PROPERTY SURVEYING FOR 15,000 SQ. FT. STILTS (From Property Line Left [Bass Landing Road])	ELEVATION (North)	ELEVATION (East)	ELEVATION (South)	ELEVATION (West)	ABOVE SEA LEVEL (2.3' County)
<i>Beginning of Stilts Parking (900'L x 50'W x 14'H) (From Left Side Property Line)</i>	<i>N/a</i>	<i>N/a</i>	<i>21.44' - 1' Decline to property Line (Southeast)</i>	<i>N/a</i>	<i>23.77' Above Sea Level</i>
<i>America Home Place (The Southampton Model - Daughters Home 74' x 55' / 5 Beds / 3.5 Baths) (From Left side Property Line)</i>	<i>20.32' - 1' Decline to Property Line (Northeast)</i>	<i>N/a</i>	<i>N/a</i>	<i>N/a</i>	<i>26.77' Above Sea Level</i>
<i>America Home Place (The Southampton Model - Sons Home 74' x 55' / 5 Beds / 3.5 Baths)</i>	<i>N/a</i>	<i>N/a</i>	<i>20.85' - 1' Decline to Property Line (Southwest)</i>	<i>N/a</i>	<i>27.53' Above Sea Level</i>
<i>Main House Front Right Corner (House 150' x 100' x 48')</i>	<i>20.42' - 1' Decline to property line (Northeast)</i>	<i>N/a</i>	<i>N/a</i>	<i>N/a</i>	<i>26.30' Above Sea Level</i>
<i>Main House Front Left Corner (House 150' x 100' x 48')</i>	<i>N/a</i>	<i>N/a</i>	<i>17.92' - 1' Decline to property line (Southwest)</i>	<i>N/a</i>	<i>26.30' Above Sea Level</i>

Main House Rear Right Corner (House 150' x 100' x 48')	N/a	N/a	19.67' - 1' Decline to property line (Southwest)	N/a	27.22' Above Sea Level
Main House Rear Left Corner (House 150' x 100' x 48')	N/a	N/a	22.09' - 1' Decline to property line (Southwest)	N/a	21.23' Above Sea Level
Home Office Truck Garage (50' x 100' x 25') Front Right Corner	10.42' - 1' Decline to property line (Northeast)	N/a	N/a	N/a	14.75' Above Sea Level
Home Office Truck Garage (50' x 100' x 25') Front Left Corner	24' - 1' Decline to property line (Northeast)		N/a	N/a	16.79' Above Sea Level
Home Office Truck Garage (50' x 100' x 25') Rear Right Corner	N/a		11.77' - 1' Decline to property line (Southeast)	N/a	14.07' Above Sea level
Home Office Truck Garage (50' x 100' x 25') Rear Left Corner	N/a	14.59' - 1' Decline to Property line (East)	N/a	N/a	16.89' Above Sea Level

**STAKE / GRADE
STATION#
PROPERTY
SURVEYING FOR
15,000 SQ. FT. STILTS
(From Property Line
Left [Bass Landing
Road])**

**ELEVATION
(North)**

**ELEVATION
(East)**

**ELEVATION
(South)**

**ELEVATION
(West)**

**ABOVE SEA
LEVEL (2.3'
County)**

**Residential Custom Multi-Home for Daughter & Sons Home Design
Center Stake Chart**

STAKE / GRADE STATION# PROPERTY SURVEYING FOR 15,000 SQ. FT. STILTS (From Property Line Left [Bass Landing Road])	ELEVATION (North)	ELEVATION (East)	ELEVATION (South)	ELEVATION (West)	ABOVE SEA LEVEL (2.3' County)
<i>Greenhouse (100' x 25' x 12') Level Building Pad</i>	<i>31.51' - 1' Decline to property Line (Northeast)</i>	<i>N/a</i>	<i>N/a</i>	<i>N/a</i>	<i>22.93' Above Sea Level</i>
<i>Daughter's Garage (55' x 35' x 15') Level Building Pad</i>	<i>32.88' - 1' Decline to property line (Northeast)</i>	<i>N/a</i>	<i>N/a</i>	<i>N/a</i>	<i>23.29' Above Sea Level</i>
<i>Son's Garage (55' x 35' x 15') Level Building Pad</i>	<i>40.76' - 1' Decline to property line (Northwest)</i>	<i>N/a</i>	<i>N/a</i>	<i>N/a</i>	<i>23.89' Above Sea level</i>

<i>Garden (100' x 100') Level Ground</i>	<i>40.39' - 1' Decline to property line (Northwest)</i>	<i>N/a</i>	<i>N/a</i>	<i>N/a</i>	<i>5' Above Sea Level</i>
<i>Boat Ramp (Decline Starting Point - 100' Length)</i>	<i>43.07' - 1' Decline to property line (Northwest)</i>	<i>N/a</i>	<i>N/a</i>	<i>N/a</i>	<i>5' Above Sea Level</i>
<i>Boat Ramp (Decline Ending Point - 100' Length w/41.41' Decline to Riverbed Floor)</i>	<i>57.93' - 1' Incline to property Line (Northwest)</i>	<i>N/a</i>	<i>N/a</i>	<i>N/a</i>	<i>18.30' Below Sea Level</i>
<i>Outside Kitchen on Boardwalk (50' x 50' x 12') Level Boardwalk</i>	<i>48.08' - 1' Incline to property line (Northwest)</i>	<i>N/a</i>	<i>N/a</i>	<i>N/a</i>	<i>28.30' Above Sea Level</i>
<i>Walking Bridge Starting Point (200' x 25' / 9' Above Land / 35' Above River Low Tide)</i>	<i>33.59' - 1' Decline to property line (Northwest)</i>	<i>N/a</i>	<i>N/a</i>	<i>N/a</i>	<i>30.88' Above Sea Level</i>
<i>Boat Dock (45'L x 15'W x 50"H [Low Tide])</i>	<i>328.54' - 1' Decline to property line (Northwest)</i>	<i>N/a</i>	<i>N/a</i>	<i>N/a</i>	<i>4.17' Above Sea Level</i>
<i>Pool (75' x 50' [On Stilts])</i>	<i>20.17' - 1' Decline to property line (Northwest)</i>	<i>N/a</i>	<i>N/a</i>	<i>N/a</i>	<i>22.47' Above Sea Level</i>
<i>Hobby Warehouse (100' x 100' [On Stilts])</i>	<i>34.62' - 1' Decline to property line</i>	<i>N/a</i>	<i>N/a</i>	<i>N/a</i>	<i>27.72' Above Sea Level</i>

(Northwest)

<i>Outdoors Home Theater (100' x 25'</i>	<i>N/a</i>	<i>N/a</i>	<i>33.86' - 1' Decline to</i>	<i>N/a</i>	<i>22.68' Above Sea Level</i>
[Level Ground for Tower Crane Purposes]			property line (Southwest)		
<i>Basketball / Volleyball Court (100' x 50' [Level Ground for Tower Crane Purposes])</i>	<i>N/a</i>	<i>N/a</i>	<i>34.19' - 1' Decline to property line (Southwest)</i>	<i>N/a</i>	<i>16.05' Above Sea Level</i>
<i>Generator / Solar Panel Farm (100' x 100' [Level Ground for Tower Crane Purposes])</i>	<i>N/a</i>	<i>N/a</i>	<i>32.31' - 1' Decline to property line (Southwest)</i>	<i>N/a</i>	<i>27.99' Above Sea Level</i>
<i>Bowling Lanes (100' x 50' x 15' [Level Ground for Tower Crane Purposes])</i>	<i>N/a</i>	<i>N/a</i>	<i>23.22' - 1' Decline to property line (Southwest)</i>	<i>N/a</i>	<i>21.25' Above Sea level</i>
<i>Helicopter Pad (50' x 50') Level Ground for Tower Crane Purposes</i>	<i>N/a</i>	<i>N/a</i>	<i>12.09' - 1' Decline to property line (Southwest)</i>	<i>N/a</i>	<i>11.40' Above Sea Level</i>

STAKE / GRADE STATION# PROPERTY SURVEYING FOR 15,000 SQ. FT. STILTS (From Property Line Left [Bass Landing Road])	ELEVATION (North)	ELEVATION (East)	ELEVATION (South)	ELEVATION (West)	ABOVE SEA LEVEL (2.3' County)
--	--------------------------	-------------------------	--------------------------	-------------------------	--------------------------------------



Bass Landing Road Surveying Results

- *Beginning of Property to End of Property Line (Chowan River) 1,110'*
- *Beginning of property to End of Property Line (Bottom Neighbors) -1,110'*
 - *Grade Hub @ Bass Landing Road Starting or Introduction to Property +17.42'*
- *Grade Hub w/Instrument Height*
 - *Grade Hub @ Bass Landing Road at Chico River (Property Ending) +12.92'*
 - *The Property is 3,725' Away From the Equator with 53' Decline to the Equator*
- *Neighbor in Front Top of Property Grade Hub +17.42' (Instrument Elevation)*
- *Neighbor in Front Bottom of Property Grade Hub -8.84'*

<i>GRADE STATION #</i>	<i>HUB GRADE</i>	<i>LENGTH FROM CENTER STAKE</i>	<i>SPACING OF 10 DEGREES FROM PRIOR DEGREES</i>	<i>BACKSIDE READING (Center Stake + Instrument Height)</i>	<i>FORESIGHT READING (Property Line)</i>
-------------------------------	-------------------------	--	--	---	---

10 Degrees	1	+14.50' HUB GRADE	530' Distance to Property Line	72.8' Spacing from 360 Degrees Mark	17.42' Bass landing Road @ 530' From Right Side Property Line	+18.92' Bass Landing Road@ 530' From Center Stake
20 Degrees	2	+12.19' HUB GRADE	490' Distance to Property Line	95' Spacing from 10 Degree Mark	17.42' Bass landing Road @ 530' From Right Side Property Line	+16.61' Bass Landing Road @ 490' From Center Stake
30 degrees	3	+10.17 HUB GRADE	400' Distance to Property Line	70' Spacing from 20 Degrees Mark	17.42' Bass landing Road @ 530' From Right Side Property Line	+14.59' Bass Landing Road @ 400' From Center Stake
40 degrees	4	+8.44' HUB GRADE	480' Distance to Property Line	80' Spacing from 30 Degrees Mark	17.42' Bass landing Road 530' From Right Side Property Line	+12.86' @ Bass Landing Road @ 480' From Center Stake
50 degrees	5	+7.03' HUB GRADE	390' Distance to Property Line	80' Spacing from 40 Degrees Mark	17.42' Bass landing Road 530' From Right Side Property Line	+11.45' @ Bass Landing Road @ 490' From Center Stake
60 Degrees	6	+6.02' HUB GRADE	280' Distance to Property Line	110' Spacing from 50 Degrees Mark	17.42' Bass landing Road @ 530' From Right Side Property Line	+10.42' Bass Landing Road @ 530' From Center Stake
70 Degrees	7	+5.33' HUB GRADE	190' Distance to Property line	90' Spacing from 60 Degrees Mark	17.42' Bass landing Road @ 530' From Right Side Property Line	+9.75' Bass Landing Road @ 570' From Center Stake

80 Degrees	8	-0.15' HUB GRADE	10' Distance to Top Property Line (Bass Landing Road)	190' Spacing from 70 Degrees Mark	17.42' Bass landing Road @ 530' From Right Side Property Line	-4.57' Bass Landing Road @ 700' From Center Stake
90 Degrees	9	-1.43' HUB GRADE	100' Distance to Top Property Line	110' Spacing from 80 Degrees Mark	17.42' Bass landing Road @ 530' From Right Side Property Line	-5.85' Bass Landing Road @ 530' From Center Stake
100 Degrees	10	-3.42' HUB GRADE	240' Distance to Top Property Line	115' Spacing from 90 Degrees Mark	17.42' Bass landing Road 530' From Right Side Property Line	-7.84' Bass Landing Road @ 580' From Center Stake
110 Degrees	11	-5.20' HUB GRADE	365' Distance to Property Line	130' Spacing from 100 Degrees Mark	17.42' Bass landing Road 530' From Right Side Property Line	-9.62' Bass Landing Road @ 510' From Center Stake
120 Degrees	12	-6.12' HUB GRADE	430' Distance to Property Line	65' Spacing from 110 Degrees Mark	17.42' Bass landing Road 530' From Right Side Property Line	-10.54' Bass Landing Road @ 480' From Center Stake
130 Degrees	13	-7.55' HUB GRADE	530' Distance to Property Line	70' Spacing from 120 Degrees Mark	17.42' Bass landing Road 530' From Right Side Property Line	-11.97' Bass Landing Road @ 440' From Center Stake

140 Degrees	14	-8.54' HUB GRADE	600' Distance to Property Line	75' Spacing from 130 Degrees Mark	17.42' Bass landing Road @ 530' From Right Side Property Line	-12.96' Bass Landing Road @ 430' From Center Stake
150 Degrees	15	-9.61' HUB GRADE	675' Distance to Property Line	75' Spacing from 140 Degrees Mark	17.42' Bass landing Road @ 530' From Right Side Property Line	-14.03' Bass Landing Road @ 440' From Center Stake
160 Degrees	16	-10.46' HUB GRADE	735' Distance to Property Line	60' Spacing from 150 Degrees Mark	17.42' Bass landing Road @ 530' From Right Side Property Line	-14.88' Bass Landing Road @ 460' From Center Stake
170 Degrees	17	-12.03' HUB GRADE	845' Distance to Property Line	105' Spacing from 160 Degrees Mark	17.42' Bass landing Road @ 530' From Right Side Property Line	-16.25' Bass Landing Road @ 490' From Center Stake
180 Degrees	18	-13.24' HUB GRADE	930' Distance to Property Line	90' Spacing from 170 degrees Mark	17.42' Bass landing Road @ 530' From Right Side Property Line	-17.66' Bass Landing Road @ 440' From Center Stake
190 Degrees	19	-12.44' HUB GRADE	30' Distance to Property Line Bottom (Right Side)	180' Spacing from 180 Degrees Mark	17.42' Bass landing Road @ 530' From Right Side Property Line	-16.86' Bass Landing Road @ 530' From Center Stake
200 Degrees	20	-13.02' HUB GRADE	160' Distance to Property Line Bottom	130' Spacing from 190 Degrees Mark	17.42' Bass landing Road @ 530' From Right Side Property Line	-17.44' Bass Landing Road @ 610' From Center Stake

210 Degrees	21	-13.85' HUB GRADE	230' Distance to Property Line Bottom	75' Spacing from 200 Degrees Mark	17.42' Bass landing Road @ 530' From Right Side Property Line	-18.27' Bass Landing Road @ 510' From Center Stake
220 Degrees	22	-14.51' HUB GRADE	320' Distance to Property Line Bottom	85' Spacing from 210 Degrees Mark	17.42' Bass landing Road @ 530' From Right Side Property Line	-18.93' Bass Landing Road @ 600' From Center Stake
230 Degrees	23	-16.05' HUB GRADE	425' Distance to Property Line Bottom	105' Spacing from 220 Degrees	17.42' Bass landing Road @ 530' From Right Side Property Line	-20.47' Bass Landing Road @ 610' From Center Stake
240 Degrees	24	-18.00' HUB GRADE	540' Distance to Property Line Bottom	120' Spacing from 230 Degrees Mark	17.42' Bass landing Road @ 530' From Right Side Property Line	-22.42' Bass Landing Road @ 650' From Center Stake
250 Degrees	25	-20.49' HUB GRADE	690' Distance to Property Line Bottom	145' Spacing from 240 Degrees Mark	17.42' Bass landing Road @ 530' From Right Side Property Line	-24.91' Bass Landing Road @ 740' From Center Stake
260 Degrees	26	-23.67' HUB GRADE	880' Distance to Property Line Bottom	190' Spacing from 250 Degrees Mark	17.42' Bass landing Road @ 530' From Right Side Property Line	-28.09' Bass Landing Road @ 865' From Center Stake

270 Degrees	27	-27.75' HUB GRADE	1,130' Distance to Property Line	250' Spacing from 260 Degrees Mark	17.42' Bass landing Road @ 530' From Right Side Property Line	-32.17' Bass Landing Road @ 1,060' From Center Stake
280 Degrees	28	-23.76' HUB GRADE	280' Distance to Property Line Bottom Left (River Side)	200' Spacing from 270 Degrees Mark	17.42' Bass landing Road @ 530' From Right Side Property Line	-28.18' Bass Landing Road @ 950' From Center Stake
290 Degrees	29	17.78' HUB GRADE	420' Distance to Property Line Bottom Right	140' Spacing from 280 Degrees Mark	17.42' Bass landing Road @ 530' From Right Side Property Line	-22.20' Bass Landing Road @ 880' From Center Stake
300 Degree	30	-9.95' HUB GRADE	550' Distance to Property Line Bottom Right	125' Spacing from 290 Degrees Mark	17.42' Bass landing Road @ 530' From Right Side Property Line	-14.37' Bass Landing Road @ 850' From Center Stake
310 Degrees	31	-0.41' HUB GRADE	670' Distance to Property Line	120' Spacing from 300 Degrees Mark	17.42' Bass landing Road @ 530' From Right Side Property Line	-4.83' Bass Landing Road @ 855' From Center Stake

**Bottom
Right**

320 Degrees	32	+10.98' HUB GRADE	800' Distance to Property Line Bottom Right	125' Spacing From 310 Degrees Mark	17.42' Bass landing Road @ 530' From Right Side Property Line	+15.40' Bass Landing Road @ 890' From Center Stake
330 Degrees	33	+25.21' HUB GRADE	1,000' Distance to Property Line Bottom Right	200' Spacing from 320 Degrees Mark	17.42' Bass landing Road @ 530' From Right Side Property Line	+29.63' Bass Landing Road @ 980' From Center Stake
340 Degrees	34	+40.01' HUB GRADE	1,040' Distance to Property Line Bottom Right	140' Spacing from 330 Degrees Mark	17.42' Bass landing Road @ 530' From Right Side Property Line	+44.43' Bass Landing Road @ 910' From Center Stake
350 Degrees	35	11.04' HUB GRADE	960' Distance to Property Line Top (Left Side)	190' Spacing from 340' Degrees Mark	17.42' Bass landing Road @ 530' From Right Side Property Line	+15.46' Bass Landing Road @ 650' From Center Stake
360 Degrees	36	14.11' HUB GRADE	850' Distance to Property Line Top Right	110' Spacing from 350 Degrees Mark	17.42' Bass landing Road @ 530' From Right Side Property Line	+18.53' Bass Landing Road @ 570' From Center Stake

GRADE STATION #	HUB GRADE	LENGTH FROM CENTER STAKE	SPACING OF 10 DEGREES FROM PRIOR DEGREES	BACKSIDE READING (Center Stake + Instrument Height)	FORESIGHT READING (Property Line)
----------------------------	----------------------	---	---	--	--

Residential Custom Home Design Surveying The Property From Center Stake

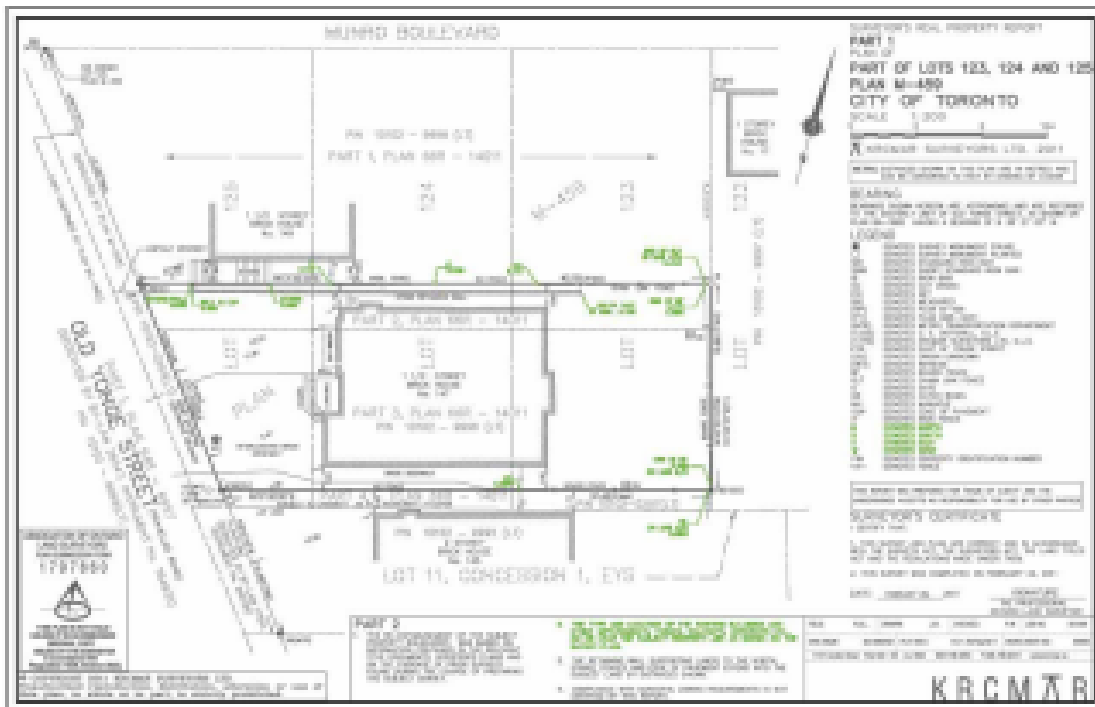

Top Left Corner - 330° Northwest **Top Right Corner** - 80° Northeast Hub Grade +25.21'
 Hub Grade -0.15' Center Stake Distance Away 980' Center Stake Distance Away 700'

Northwest to Southwest 1,760' Northeast to West 1,510' Average Fill of +12.76'
 Average Cuts of -13.70' Ratio (Length to Rise) 137.94' to 1' Ratio (Length to Fall)
110.22' to 1' Center Stake 555' From Bass Road Center Stake 480' From Bass Road
 Center Stake 550' From Right Line Center Stake 530' From Right Line Center Grade
 Stake +19.38 Center Stake Grade -19.90'

Bottom Left Corner - 270° West **Bottom Right Corner** - 190° Southwest Hub Grade
-27.27' Hub Grade -12.44' Center Stake Distance Away 1,060' Center Stake Distance
 Away 530'

	STARTING LEFT SIDE (Grade w/Location When Required)	STARTING RIGHT SIDE (Grade w/Location When Required)	ENDING LEFT SIDE (Grade w/Location When Required)	ENDING RIGHT SIDE (Grade w/Location When Required)
Boardwalk (From Bass Landing Road down to Outdoors Kitchen)	334° 1,310' from Top Right Corner	336° 1,285' from Top Right Corner	272° 1,070' from Bottom Right Corner	271° 1,040' from Bottom Right Corner
Boardwalk (From Outdoors Kitchen Down to Property Line)	306° 1,220' from Right Property Line	305° 1,160' From Right Property line	304° 1,210' from right property line	304° 950' from right property line

	<i>Line</i>			
<i>Boardwalk (Electric Pipe Laying Trench or under boardwalk [Cat 374 has a 48" Bucket])</i>	40° 70' From Ground Floor Entrance Stake	40° 70' from Ground Floor Entrance Stake	305° 760' from Ground Floor Entrance Stake	305° 760' from Ground Floor Entrance Stake
<i>Boat Dock/ House ("U" Shape for Boat Lift)</i>	305° 910' From Ground Floor Entrance Stake	305° 860' from Ground Floor Entrance Stake	303° 910' From Ground Floor Entrance Stake	303° 860' from Ground Floor Entrance Stake
<i>Boat Dock (Boardwalk from Outdoors Kitchen)</i>	304° 810' From Ground Floor Entrance Stake	303° 865' from Ground Floor Entrance Stake	303° 810' from Ground Floor Entrance Stake	304° 865' from Ground Floor Entrance Stake
<i>Boat Dock (Electric Pipe Laying Trench or Under Boardwalk [Cat 374 has a 48" Bucket])</i>	305° 860' from Ground Floor Entrance Stake	305° 860' from Ground Floor Entrance Stake	305° 755' from Ground Floor Entrance Stake	305° 755' from ground Floor Entrance Stake
<i>Walking Bridge Wooden Sidewalk to House</i>	305° 485' from Ground Floor Entrance Stake	303° 485' from Ground Floor Entrance Stake	316° 100' from Ground Floor Entrance Stake	306° 100' from Ground Floor Entrance Stake

<i>Walking Bridge</i>	<i>304° 690' from Ground Floor Entrance Stake</i>	<i>305° 490' from Ground Floor Entrance Stake</i>	<i>303° 690' from Ground Floor Entrance Stake</i>	<i>302° 490' from Ground Floor Entrance Stake</i>
<i>Walking Bridge Wooden Sidewalk to Boardwalk</i>	<i>304° 750' from Ground Floor Entrance Stake</i>	<i>306° 690' from Ground Floor Entrance Stake</i>	<i>304° 750' from Ground Floor Entrance Stake</i>	<i>303° 690' from Ground Floor Entrance Stake</i>
<i>Walking Bridge (Electric Pipe Laying Trench or Under Bridge)</i>	<i>304° 690' from Ground Floor Entrance Stake</i>	<i>305° 490' from Ground Floor Entrance Stake</i>	<i>303° 690' from Ground Floor Entrance Stake</i>	<i>302° 490' from Ground Floor Entrance Stake</i>
<i>Walking Bridge Sewer Pipe Laying Trench or Under Bridge</i>	<i>304° 690' from Ground Floor Entrance Stake</i>	<i>305° 490' from Ground Floor Entrance Stake</i>	<i>303° 690' from Ground Floor Entrance Stake</i>	<i>302° 490' from Ground Floor Entrance Stake</i>
<i>Car Garage</i>	<i>340° 200' from Ground Floor Entrance Stake</i>	<i>55° 135' from Ground Floor Entrance Stake</i>	<i>263° 200' from Ground Floor Entrance Stake</i>	<i>186° 125' from Ground Floor Entrance Stake</i>
<i>Car Garage Driveway</i>	<i>76° 650' from Ground Floor Entrance Stake</i>	<i>82° 710' from Ground Floor Entrance Stake</i>	<i>90° 60' from Ground Floor Entrance Stake</i>	<i>135° 60' from Ground Floor Entrance Stake</i>
<i>Car Garage Electric Pipe Laying Trench</i>	<i>Have to Figure out Sewer</i>	<i>Have to Figure out</i>	<i>Have to Figure out Sewer Pipe</i>	<i>Have to Figure out Sewer Pipe</i>

	<i>Pipe whereabouts and the depth of the well if not City Supplied</i>	<i>Sewer Pipe whereabouts and the depth of the well if not City Supplied</i>	<i>whereabouts and the depth of the well if not City Supplied</i>	<i>whereabouts and the depth of the well if not City Supplied</i>
<i>Car Garage Water Pipe Laying Trench</i>	<i>Have to Figure out Sewer Pipe whereabouts and the depth of the well if not City Supplied</i>	<i>Have to Figure out Sewer Pipe whereabouts and the depth of the well if not City Supplied</i>	<i>Have to Figure out Sewer Pipe whereabouts and the depth of the well if not City Supplied</i>	<i>Have to Figure out Sewer Pipe whereabouts and the depth of the well if not City Supplied</i>
<i>Car Garage Sewer Pipe Laying Trench</i>	<i>Have to Figure out Sewer Pipe whereabouts and the depth of the well if not City Supplied</i>	<i>Have to Figure out Sewer Pipe whereabouts and the depth of the well if not City Supplied</i>	<i>Have to Figure out Sewer Pipe whereabouts and the depth of the well if not City Supplied</i>	<i>Have to Figure out Sewer Pipe whereabouts and the depth of the well if not City Supplied</i>
<i>Car Garage Sanitary Pipe Laying Trench (Bathroom)</i>	<i>Have to Figure out Sewer Pipe whereabouts and the depth of the well if not City Supplied</i>	<i>Have to Figure out Sewer Pipe whereabouts and the depth of the well if not City Supplied</i>	<i>Have to Figure out Sewer Pipe whereabouts and the depth of the well if not City Supplied</i>	<i>Have to Figure out Sewer Pipe whereabouts and the depth of the well if not City Supplied</i>
<i>Helicopter Pad</i>	<i>194°</i>	<i>188°</i>	<i>198°</i>	<i>192°</i>

***STARTING
LEFT SIDE
(Grade
w/Location
When
Required)***

***STARTING
RIGHT
SIDE
(Grade
w/Location
When
Required)***

***ENDING
LEFT SIDE
(Grade
w/Location
When
Required)***

***ENDING RIGHT
SIDE (Grade
w/Location
When Required)***