

3074 Bass Landing Road  
Edenton, NC

*Robinson's Family Property  
3074 Bass Landing Road  
Edenton, NC*

*30.31 Acres of Land Survey and Designed by N.J.R. Logistics Group*

***Naomi Jeanette Robinson Logistics Group***

## Custom Property & Home Building Design

2650 Arlington Street

Rocky Mount, NC 27801

### 48,440 Square Feet Facility

### 4.8 Acres Lot

*Cell: (252)903-3751*

[tariq.robinson1969@gmail.com](mailto:tariq.robinson1969@gmail.com)

<https://njrtruckingllc.com/pro-sales-specialist>

# Residential Custom Home Design Draft



# ***Residential Custom Home Design Leveling Chart for Vehicles***

<i><b>STAKE / GRADE STATION# PROPERTY SURVEYING FOR 15,000 SQ. FT. HOME (From Center Stake)</b></i>	<i><b>NORTH</b></i>	<i><b>EAST</b></i>	<i><b>SOUTH</b></i>	<i><b>WEST</b></i>	<i><b>HUB LOCATION</b></i>	<i><b>HUB GRADE (Dirt)</b></i>	<i><b>TRANSIT ELEVATION</b></i>
<i>Center Stake</i>	<i>580'</i>	<i>630'</i>	<i>550'</i>	<i>1,020'</i>	<i>120 Degrees Southwest</i>	<i>Fill - 24'</i>	<i>4.25' Above Hub Bass Landing Road</i>
<i>Driveway Entrance (40' Width)</i>	<i>80° - 670' Northeast</i>	<i>N/a</i>	<i>N/a</i>	<i>N/a</i>	<i>80° Northeast</i>	<i>Cut - 12"</i>	<i>4.25' Above Center Stake Hub</i>
<i>Tunnel Entrance (40' Width)</i>	<i>N/a</i>	<i>N/a</i>	<i>110° - 400' Southeast</i>	<i>N/a</i>	<i>110° Southeast</i>	<i>Fill- 4'</i>	<i>4.25' Above Center Stake Hub</i>
<i>Tunnel Destination (40' Width)</i>	<i>N/a</i>	<i>N/a</i>	<i>120° - 50' Southeast</i>	<i>N/a</i>	<i>120° Southeast</i>	<i>Cut - 21.39'</i>	<i>4.25' Above Center Stake Hub</i>
<i>Beginning of Underground Parking (900'L x 50'W x 14'H)</i>	<i>N/a</i>	<i>N/a</i>	<i>100° - 60' Southeast</i>	<i>N/a</i>	<i>100° Southeast</i>	<i>Cut - 21.47'</i>	<i>4.25' Above Center Stake Hub</i>
<i><b>STAKE / GRADE STATION# PROPERTY SURVEYING FOR 15,000 SQ. FT. HOME (From Center Stake)</b></i>	<i><b>NORTH</b></i>	<i><b>EAST</b></i>	<i><b>SOUTH</b></i>	<i><b>WEST</b></i>	<i><b>HUB LOCATION</b></i>	<i><b>HUB GRADE (Dirt)</b></i>	<i><b>TRANSIT ELEVATION</b></i>

# ***Residential Custom Home Design Leveling Chart for House***

<i><b>STAKE / GRADE STATION# PROPERTY SURVEYING FOR 15,000 SQ. FT. HOME (From Center Stake)</b></i>	<i><b>NORTH</b></i>	<i><b>EAST</b></i>	<i><b>SOUTH</b></i>	<i><b>WEST</b></i>	<i><b>HUB LOCATION</b></i>	<i><b>HUB GRADE (Dirt)</b></i>	<i><b>TRANSIT ELEVATION</b></i>
<i>America Home Place (The Southampton Model - Daughters Home 74' x 55' / 5 Beds / 3.5 Baths</i>	<i>17° - 420' Northeast</i>	<i>N/a</i>	<i>N/a</i>	<i>N/a</i>	<i>17° Northeast</i>	<i>Fill - 24.47'</i>	<i>4.25' Above Center Stake Hub</i>
<i>America Home Place (The Southampton Model - Son's Home 74' x 55' / 5 Beds / 3.5 Baths</i>	<i>320° - 515' Northwest</i>	<i>N/a</i>	<i>N/a</i>	<i>N/a</i>	<i>320° Northwest</i>	<i>Fill - 25.23'</i>	<i>4.25' Above Center Stake Hub</i>
<i>Main House Front Right Corner (House 150' x 100' x 48')</i>	<i>300° - 77' Northeast</i>	<i>N/a</i>	<i>N/a</i>	<i>N/a</i>	<i>300° Northeast</i>	<i>Fill - 24'</i>	<i>4.25' Above Center Stake Hub</i>
<i>Main House Front Left Corner (House 150' x 100' x 48')</i>	<i>N/a</i>	<i>N/a</i>	<i>219°-70' Southwest</i>	<i>N/a</i>	<i>219° Southwest</i>	<i>Fill - 24'</i>	<i>4.25' Above Center Stake Hub</i>
<i>Main House Rear Right Corner (House 150' x 100' x 48')</i>	<i>N/a</i>	<i>N/a</i>	<i>343° - 125' Southwest</i>	<i>N/a</i>	<i>343° Southwest</i>	<i>Fill - 26.67'</i>	<i>4.25' Above Center Stake Hub</i>
<i>Main House Rear Left Corner (House</i>	<i>N/a</i>	<i>N/a</i>	<i>268° - 120' Southwest</i>	<i>N/a</i>	<i>268° Southwest</i>	<i>Fill - 18.93'</i>	<i>4.25' Above Center Stake Hub</i>

150' x 100' x 48')

Home Office Truck Garage (50' x 100' x 25') Front Right Corner	80° - 360' Northeast	N/a	N/a	N/a	80° Northeast	Fill - 12.46'	4.25' Above Center Stake Hub
Home Office Truck Garage (50' x 100' x 25') Front Left Corner	74° - 320' Northeast	N/a	N/a	N/a	74° Northeast	Fill - 14.49'	4.25' Above Center Stake Hub
Home Office Truck Garage (50' x 100' x 25') Rear Right Corner	N/a	N/a	100° - 300' Southeast	N/a	100° Southeast	Fill - 11.77'	4.25' Above Center Stake Hub
Home Office Truck Garage (50' x 100' x 25') Rear Left Corner	N/a	90° - 250' East	N/a	N/a	90° East	Fill - 14.12'	4.25' Above Center Stake Hub
Greenhouse (100' x 25' x 12') Level Building Pad	1° - 240' Northeast	N/a	N/a	N/a	1° Northeast	Fill - 20.63'	4.25' Above Center Stake Hub
Daughter's Garage (55' x 35' x 15') Level Building Pad	7° - 350' Northeast	N/a	N/a	N/a	7° Northeast	Fill - 20.99'	4.25' Above Center Stake Hub
Son's Garage (55' x 35' x 15') Level Building Pad	344° - 470' Northwest	N/a	N/a	N/a	344° Northwest	Fill - 21.59'	4.25' Above Center Stake Hub
Garden (100' x 100') Level Ground	330° - 380' Northwest	N/a	N/a	N/a	330° Northwest	Fill - 21.30'	4.25' Above Center Stake Hub

<i>STAKE / GRADE STATION# PROPERTY SURVEYING FOR 15,000 SQ. FT. HOME (From Center Stake)</i>	<i>NORTH</i>	<i>EAST</i>	<i>SOUTH</i>	<i>WEST</i>	<i>HUB LOCATION</i>	<i>HUB GRADE (Dirt)</i>	<i>TRANSIT ELEVATION</i>
--	--------------	-------------	--------------	-------------	-------------------------	---------------------------------	------------------------------

*Residential Custom Home Design Leveling Chart for  
Boardwalk & Bridge*

<i>STAKE / GRADE STATION# PROPERTY SURVEYING FOR 15,000 SQ. FT. HOME (From Center Stake)</i>	<i>NORTH</i>	<i>EAST</i>	<i>SOUTH</i>	<i>WEST</i>	<i>HUB LOCATION</i>	<i>HUB GRADE (Dirt)</i>	<i>TRANSIT ELEVATION</i>
--	--------------	-------------	--------------	-------------	-------------------------	---------------------------------	------------------------------

<i>Boat Ramp (Decline Starting Point - 100' Length)</i>	<i>316° -610' Northwest</i>	<i>N/a</i>	<i>N/a</i>	<i>N/a</i>	<i>316° Northwest</i>	<i>Fill - 25.31'</i>	<i>4.25' Above Center Stake Hub</i>
<i>Boat Ramp (Decline Ending Point - 100' Length w/41.41' Decline to Riverbed Floor)</i>	<i>336° -590' Northwest</i>	<i>N/a</i>	<i>N/a</i>	<i>N/a</i>	<i>336° Northwest</i>	<i>Cut - 18.30'</i>	<i>4.25' Above Center Stake Hub</i>
<i>Outside Kitchen on Boardwalk (50' x 50' x 12') Level Boardwalk</i>	<i>333° -790' Northwest</i>	<i>N/a</i>	<i>N/a</i>	<i>N/a</i>	<i>333° Northwest</i>	<i>Fill - 26'</i>	<i>4.25' Above Center Stake Hub</i>
<i>Walking Bridge Starting Point (200' x 25' / 9' Above Land / 35' Above River Low Tide)</i>	<i>333° -500' Northwest</i>	<i>N/a</i>	<i>N/a</i>	<i>N/a</i>	<i>333° Northwest</i>	<i>Fill - 28.58'</i>	<i>4.25' Above Center Stake Hub</i>
<i>Walking Bridge Ending Point (200' x 25' / 9' Above Land / 35' Above River Low Tide)</i>	<i>333° -700' Northwest</i>	<i>N/a</i>	<i>N/a</i>	<i>N/a</i>	<i>333° Northwest</i>	<i>Fill - 33.00'</i>	<i>4.25' Above Center Stake Hub</i>
<i>Boat Dock (45'L x 15'W x 50"H [low tide])</i>	<i>333° -890' Northwest</i>	<i>N/a</i>	<i>N/a</i>	<i>N/a</i>	<i>333° Northwest</i>	<i>Fill - 4.17'</i>	<i>4.25' Above Center Stake Hub</i>

<i>Pool (75'L x 50'W [Level Ground])</i>	<i>293° -330' Northwest</i>	<i>N/a</i>	<i>N/a</i>	<i>N/a</i>	<i>293° Northwest</i>	<i>Fill - 20.43'</i>	<i>4.25' Above Center Stake Hub</i>
<i>Hobby Warehouse (100'L x 100'W [Level Ground for Excavation])</i>	<i>280° -570' Northwest</i>	<i>N/a</i>	<i>N/a</i>	<i>N/a</i>	<i>280° Northwest</i>	<i>Fill - 25.42'</i>	<i>4.25' Above Center Stake Hub</i>
<i>Outdoors Home Theater (100' x 25' [Level Ground for Excavation])</i>	<i>N/a</i>	<i>N/a</i>	<i>260° -480' Southwest</i>	<i>N/a</i>	<i>260° Southwest</i>	<i>Fill - 20.38'</i>	<i>4.25' Above Center Stake Hub</i>
<i>Basketball / Volleyball Court (100' x 50' [Level Ground for Excavation])</i>	<i>N/a</i>	<i>N/a</i>	<i>234° -340' Southwest</i>	<i>N/a</i>	<i>234° Southwest</i>	<i>Fill - 13.75'</i>	<i>4.25' Above Center Stake Hub</i>
<i>Generator / Solar Panel Farm (100' x 100' [Level Ground for Excavation])</i>	<i>N/a</i>	<i>N/a</i>	<i>265° -650' Southwest</i>	<i>N/a</i>	<i>265° Southwest</i>	<i>Fill - 25.69'</i>	<i>4.25' Above Center Stake Hub</i>
<i>Bowling Lanes (100' x 50' x 15' [Level Ground for Excavating Purposes])</i>	<i>N/a</i>	<i>N/a</i>	<i>230° -460' Southwest</i>	<i>N/a</i>	<i>230° Southwest</i>	<i>Fill - 18.95'</i>	<i>4.25' Above Center Stake Hub</i>
<i>Helicopter Pad (50' x 50') level Ground for Excavation purposes</i>	<i>N/a</i>	<i>N/a</i>	<i>191° -510' Southwest</i>	<i>N/a</i>	<i>191° Southwest</i>	<i>Fill - 9.10'</i>	<i>4.25' Above Center Stake Hub</i>

<b><i>STAKE / GRADE STATION# PROPERTY SURVEYING FOR 15,000 SQ. FT. HOME (From Center Stake)</i></b>	<b><i>NORTH</i></b>	<b><i>EAST</i></b>	<b><i>SOUTH</i></b>	<b><i>WEST</i></b>	<b><i>HUB LOCATION</i></b>	<b><i>HUB GRADE (Dirt)</i></b>	<b><i>TRANSIT ELEVATION</i></b>
---	---------------------	--------------------	---------------------	--------------------	----------------------------	--------------------------------	---------------------------------

### ***Residential Custom Home Design for Entertainment***

*Custom Property Designed and Built by N.J.R. Logistics Group*

*Hobby Warehouse (Entertainment) - 10,000 sq. feet,*

◆ *Hobby Works RC Construction - 100'L x 25'W x 30'H*

- *Sand Box - 2,500 Sq. Feet with 24" Sand*
- *Tower Cranes*
  - *Building a Sky Scraper Setting*
- *Crawler Cranes*
  - *Building a Parking Garage Setting*

- *All-Terrain Cranes*
  - *Building a Distribution Center Setting*
- *Earth Moving Equipment*
  - *Building on Airport on Swamp Land Setting*
- *Semi Trucks*
  - *Driving in a Congested City with Specialized Shipment Setting*
- *Hobby Works Lionel Train Layout Warehouse - 2,500 Sq. Feet*
  - *Concrete Cable Stayed Bridges*
  - *Concrete Suspension Bridges*
  - *8" Concrete Tubes Tunnels*
  - *1,000' of Tracks*
    - ◆ *Intermodal Facility*
    - ◆ *Railyard*
    - ◆ *Bridges and Mountains Setting*
- *Hobby Works Digital Slot Cars Warehouse - 2,500 Sq. Feet*
  - *Road Course*
  - *Oval Track*
- ◆ *Hobby Lobby Outside RC Nitro Cars Drag Strip & Course Track*
  - *1/8 - Mile Drag Strip*
  - *1/4 - Mile Oval Track*
  - *1/2 - Mile Road Course*
- ◆ *Hobby Works RC Aircraft Facility*
  - *8 - 1,000' Runways*
  - *Newark International Airport Construction Design in Concrete*
  - *New York City Skyline*
  - *Newark City Skyline*
  - *Tri State Bridges in Concrete*
- ◆ *Residential Bridge (Prevent Landscaping Destruction)*
  - *200'L x 10'W x 25' Height*
- ◆ *Boardwalk*
  - *500'L x 10'W x 10' Height Boardwalk*
  - *Underground Parking & Tunnels (Privacy and Security)*
    - *Walking Tunnel from Car Garage Leading to House*
    - *Parking Tunnel to and From Garage*
    - *Underground Parking with a 3-Car Parking Lift for All Members of the family on Family Events*
  - *Floating Sidewalks (Prevent Dirt into Vehicles and House)*
    - *Woodsidewalk for Golf Cart 12" above Grade Elevation*
  - *Cylesdale & Arabian Horse Residence*
    - *Cylesdale Horse Heavy Pulling Plow Setting (Exercise)*
    - *Arabian Horse Hurdle Jumping Setting (Exercise)*
  - *Cane Corso Dogs Playground*
    - *Storage Shed Feeding House and Lounge Setting*
    - *Bathroom Box (12" of Sand and Fire Hydrants Setting)*
    - *Storage Shed Guard House w/ 80" TV with Camera Surveillance of the property.*
    - *Oval Track with Motorized Rabbit (Exercise)*



- [illegible]

### ***Residential Custom Home Design Center Stake Chart***

STAKE / GRADE STATION# PROPERTY SURVEYING FOR 15,000 SQ. FT. HOME (From Property Line Left [Bass Landing Road])	ELEVATION (North)	ELEVATION (East)	ELEVATION (South)	ELEVATION (West)	ABOVE SEA LEVEL (2.3' County)
Center Stake (From East Points (90°, 180°, 270°, 360° to center stake)	460' + 1' Incline	26.67' + 1' Incline	22.5' + 1' Incline	525' + 1' Incline	26.3' Above Sea Level

<i>Driveway Entrance (40' Width) (From Left Side of Property Line)</i>	<i>1.34' - 1' Decline to Property Line (Northeast)</i>	<i>N/a</i>	<i>N/a</i>	<i>N/a</i>	<i>1.3' Above Sea Level</i>
<i>Tunnel Entrance (40' Width) (From Left Side of property Line)</i>	<i>N/a</i>	<i>N/a</i>	<i>3.58' - 1' Decline to Property Line (Southeast)</i>	<i>N/a</i>	<i>6.3' Above Sea Level</i>
<i>Tunnel Destination (40' Width) (From Left Side Property Line)</i>	<i>N/a</i>	<i>N/a</i>	<i>21.44' - 1' Decline to Property Line (Southeast)</i>	<i>N/a</i>	<i>4.91' Above Sea Level</i>

<b><i>STAKE / GRADE STATION# PROPERTY SURVEYING FOR 15,000 SQ. FT. HOME (From Property Line Left [Bass Landing Road])</i></b>	<b><i>ELEVATION (North)</i></b>	<b><i>ELEVATION (East)</i></b>	<b><i>ELEVATION (South)</i></b>	<b><i>ELEVATION (West)</i></b>	<b><i>ABOVE SEA LEVEL (2.3' County)</i></b>
---	-------------------------------------	------------------------------------	-------------------------------------	------------------------------------	---

***Residential Custom Home Design Center Stake Chart***

<b><i>STAKE / GRADE STATION# PROPERTY SURVEYING FOR 15,000 SQ. FT. HOME (From Property Line Left [Bass Landing Road])</i></b>	<b><i>ELEVATION (North)</i></b>	<b><i>ELEVATION (East)</i></b>	<b><i>ELEVATION (South)</i></b>	<b><i>ELEVATION (West)</i></b>	<b><i>ABOVE SEA LEVEL (2.3' County)</i></b>
---	-------------------------------------	------------------------------------	-------------------------------------	------------------------------------	---

<i>Beginning of Underground Parking (900'L x 50'W x 14'H) (From Left Side Property Line)</i>	<i>N/a</i>	<i>N/a</i>	<i>21.44' - 1' Decline to property Line (Southeast)</i>	<i>N/a</i>	<i>23.77' Above Sea Level</i>
--	------------	------------	---	------------	-------------------------------

<i>America Home Place (The Southhampton Model - Daughters Home 74' x 55' / 5 Beds / 3.5 Baths) (From Left side Property Line)</i>	<i>20.32' - 1' Decline to Property Line (Northeast)</i>	<i>N/a</i>	<i>N/a</i>	<i>N/a</i>	<i>26.77' Above Sea Level</i>
<i>America Home Place (The Southhampton Model - Sons Home 74' x 55' / 5 Beds / 3.5 Baths)</i>	<i>N/a</i>	<i>N/a</i>	<i>20.85' - 1' Decline to Property Line (Southwest)</i>	<i>N/a</i>	<i>27.53' Above Sea Level</i>
<i>Main House Front Right Corner (House 150' x 100' x 48')</i>	<i>20.42' - 1' Decline to property line (Northeast)</i>	<i>N/a</i>	<i>N/a</i>	<i>N/a</i>	<i>26.30' Above Sea Level</i>
<i>Main House Front Left Corner (House 150' x 100' x 48')</i>	<i>N/a</i>	<i>N/a</i>	<i>17.92' - 1' Decline to property line (Southwest )</i>	<i>N/a</i>	<i>26.30' Above Sea Level</i>
<i>Main House Rear Right Corner (House 150' x 100' x 48')</i>	<i>N/a</i>	<i>N/a</i>	<i>19.67' - 1' Decline to property line (Southwest )</i>	<i>N/a</i>	<i>27.22' Above Sea Level</i>
<i>Main House Rear Left Corner (House 150' x 100' x 48')</i>	<i>N/a</i>	<i>N/a</i>	<i>22.09' - 1' Decline to property line (Southwest )</i>	<i>N/a</i>	<i>21.23' Above Sea Level</i>
<i>Home Office Truck Garage (50' x 100' x 25') Front Right Corner</i>	<i>10.42' - 1' Decline to property line</i>	<i>N/a</i>	<i>N/a</i>	<i>N/a</i>	<i>14.75' Above Sea Level</i>

	(Northeast)				
Home Office Truck Garage (50' x 100' x 25') Front Left Corner	24' - 1' Decline to property line (Northeast)		N/a	N/a	16.79' Above Sea Level
Home Office Truck Garage (50' x 100' x 25') Rear Right Corner	N/a		11.77' - 1' Decline to property line (Southeast)	N/a	14.07' Above Sea level
Home Office Truck Garage (50' x 100' x 25') Rear Left Corner	N/a	14.59' - 1' Decline to Property line (East)	N/a	N/a	16.89' Above Sea Level

<b>STAKE / GRADE STATION# PROPERTY SURVEYING FOR 15,000 SQ. FT. HOME (From Property Line Left [Bass Landing Road])</b>	<b>ELEVATION (North)</b>	<b>ELEVATION (East)</b>	<b>ELEVATION (South)</b>	<b>ELEVATION (West)</b>	<b>ABOVE SEA LEVEL (2.3' County)</b>
--	------------------------------	-----------------------------	------------------------------	-----------------------------	--

**Residential Custom Multi-Home for Daughter & Sons Home Design  
Center Stake Chart**

<i><b>STAKE / GRADE STATION# PROPERTY SURVEYING FOR 15,000 SQ. FT. HOME (From Property Line Left [Bass Landing Road])</b></i>	<i><b>ELEVATION (North)</b></i>	<i><b>ELEVATION (East)</b></i>	<i><b>ELEVATION (South)</b></i>	<i><b>ELEVATION (West)</b></i>	<i><b>ABOVE SEA LEVEL (2.3' County)</b></i>
---	-------------------------------------	------------------------------------	-------------------------------------	------------------------------------	---

<i>Greenhouse (100' x 25' x 12') Level Building Pad</i>	<i>31.51' - 1' Decline to property Line (Northeast)</i>	<i>N/a</i>	<i>N/a</i>	<i>N/a</i>	<i>22.93' Above Sea Level</i>
<i>Daughter's Garage (55' x 35' x 15') Level Building Pad</i>	<i>32.88' - 1' Decline to property line (Northeast)</i>	<i>N/a</i>	<i>N/a</i>	<i>N/a</i>	<i>23.29' Above Sea Level</i>
<i>Son's Garage (55' x 35' x 15') Level Building Pad</i>	<i>40.76' - 1' Decline to property line (Northwest)</i>	<i>N/a</i>	<i>N/a</i>	<i>N/a</i>	<i>23.89' Above Sea level</i>
<i>Garden (100' x 100') Level Ground</i>	<i>40.39' - 1' Decline to property line (Northwest)</i>	<i>N/a</i>	<i>N/a</i>	<i>N/a</i>	<i>23.60' Above Sea Level</i>
<i>Boat Ramp (Decline Starting Point - 100' Length)</i>	<i>43.07' - 1' Decline to property line (Northwest)</i>	<i>N/a</i>	<i>N/a</i>	<i>N/a</i>	<i>27.61' Above Sea Level</i>
<i>Boat Ramp (Decline Ending Point - 100' Length w/41.41' Decline to Riverbed Floor)</i>	<i>57.93' - 1' Incline to property Line (Northwest)</i>	<i>N/a</i>	<i>N/a</i>	<i>N/a</i>	<i>18.30' Below Sea Level</i>

Outside Kitchen on Boardwalk (50' x 50' x 12') Level Boardwalk	48.08' - 1' Incline to property line (Northwest)	N/a	N/a	N/a	28.30' Above Sea Level
Walking Bridge Starting Point (200' x 25' / 9' Above Land / 35' Above River Low Tide)	33.59' - 1' Decline to property line (Northwest)	N/a	N/a	N/a	30.88' Above Sea Level
Boat Dock (45'L x 15'W x 50"H [Low Tide])	328.54' - 1' Decline to property line (Northwest)	N/a	N/a	N/a	4.17' Above Sea Level
Pool (75' x 50' [Level Ground])	20.17' - 1' Decline to property line (Northwest)	N/a	N/a	N/a	22.47' Above Sea Level
Hobby Warehouse (100' x 100' [Level Ground for Excavation])	34.62' - 1' Decline to property line (Northwest)	N/a	N/a	N/a	27.72' Above Sea Level
Outdoors Home Theater (100' x 25' [Level Ground for Excavation Purposes])	N/a	N/a	33.86' - 1' Decline to property line (Southwest)	N/a	22.68' Above Sea Level
Basketball / Volleyball Court (100' x 50' [Level Ground for Excavation Purposes])	N/a	N/a	34.19' - 1' Decline to property line (Southwest)	N/a	16.05' Above Sea Level

<i>Generator / Solar Panel Farm (100' x 100' [Level Ground for Excavation Purposes])</i>	<i>N/a</i>	<i>N/a</i>	<i>32.31' - 1' Decline to property line (Southwest)</i>	<i>N/a</i>	<i>27.99' Above Sea Level</i>
<i>Bowling Lanes (100' x 50' x 15' [Level Ground for Excavation Purposes])</i>	<i>N/a</i>	<i>N/a</i>	<i>23.22' - 1' Decline to property line (Southwest)</i>	<i>N/a</i>	<i>21.25' Above Sea level</i>
<i>Helicopter Pad (50' x 50') Level Ground for Excavation Purposes</i>	<i>N/a</i>	<i>N/a</i>	<i>12.09' - 1' Decline to property line (Southwest)</i>	<i>N/a</i>	<i>11.40' Above Sea Level</i>

<b><i>STAKE / GRADE STATION# PROPERTY SURVEYING FOR 15,000 SQ. FT. HOME (From Property Line Left [Bass Landing Road])</i></b>	<b><i>ELEVATION (North)</i></b>	<b><i>ELEVATION (East)</i></b>	<b><i>ELEVATION (South)</i></b>	<b><i>ELEVATION (West)</i></b>	<b><i>ABOVE SEA LEVEL (2.3' County)</i></b>
---	-------------------------------------	------------------------------------	-------------------------------------	------------------------------------	---



### ***Bass Landing Road Surveying Results***

- Beginning of Property to End of Property Line (Chowan River) 1.110'
- Beginning of property to End of Property Line (Bottom Neighbors) – 1.110'
  - Grade Hub @ Bass Landing Road Starting or Introduction to Property +17.42'
- Grade Hub w/Instrument Height
  - Grade Hub @ Bass Landing Road at Chico River (Property Ending) +12.92'
  - The Property is 3,725' Away From the Equator with 53' Decline to the Equator
- Neighbor in Front Top of Property Grade Hub +17.42' (Instrument Elevation)
- Neighbor in Front Bottom of Property Grade Hub -8.84'

<b><i>GRADE STATION #</i></b>	<b><i>HUB GRADE</i></b>	<b><i>LENGTH FROM CENTER STAKE</i></b>	<b><i>SPACING OF 10 DEGREES FROM PRIOR DEGREES</i></b>	<b><i>BACKSIDE READING (Center Stake + Instrument Height)</i></b>	<b><i>FORESIGHT READING (Property Line)</i></b>
-----------------------------------	-----------------------------	--	--	---	---



10 Degrees	1	+14.50' <b>HUB GRADE</b>	530' Distance to Property Line	72.8' Spacing from 360 Degrees Mark	17.42' Bass landing Road @ 530' From Right Side Property Line	+18.92' Bass Landing Road@ 530' From Center Stake
20 Degrees	2	+12.19' <b>HUB GRADE</b>	490' Distance to Property Line	95' Spacing from 10 Degree Mark	17.42' Bass landing Road @ 530' From Right Side Property Line	+16.61' Bass Landing Road @ 490' From Center Stake
30 degrees	3	+10.17 <b>HUB GRADE</b>	400' Distance to Property Line	70' Spacing from 20 Degrees Mark	17.42' Bass landing Road @ 530' From Right Side Property Line	+14.59' Bass Landing Road @ 400' From Center Stake
40 degrees	4	+8.44' <b>HUB GRADE</b>	480' Distance to Property Line	80' Spacing from 30 Degrees Mark	17.42' Bass landing Road 530' From Right Side Property Line	+12.86' @ Bass Landing Road @ 480' From Center Stake
50 degrees	5	+7.03' <b>HUB GRADE</b>	390' Distance to Property Line	80' Spacing from 40 Degrees Mark	17.42' Bass landing Road 530' From Right Side Property Line	+11.45' @ Bass Landing Road @ 490' From Center Stake
60 Degrees	6	+6.02' <b>HUB GRADE</b>	280' Distance to Property Line	110' Spacing from 50 Degrees Mark	17.42' Bass landing Road @ 530' From Right Side Property Line	+10.42' Bass Landing Road @ 530' From Center Stake
70 Degrees	7	+5.33' <b>HUB GRADE</b>	190' Distance to Property line	90' Spacing from 60 Degrees Mark	17.42' Bass landing Road @ 530' From Right Side Property Line	+9.75' Bass Landing Road @ 570' From Center Stake

80 Degrees	8	-0.15' <b>HUB GRADE</b>	10' Distance to Top Property Line (Bass Landing Road)	190' Spacing from 70 Degrees Mark	17.42' Bass landing Road @ 530' From Right Side Property Line	-4.57' Bass Landing Road @ 700' From Center Stake
90 Degrees	9	-1.43' <b>HUB GRADE</b>	100' Distance to Top Property Line	110' Spacing from 80 Degrees Mark	17.42' Bass landing Road @ 530' From Right Side Property Line	-5.85' Bass Landing Road @ 530' From Center Stake
100 Degrees	10	-3.42' <b>HUB GRADE</b>	240' Distance to Top Property Line	115' Spacing from 90 Degrees Mark	17.42' Bass landing Road 530' From Right Side Property Line	-7.84' Bass Landing Road @ 580' From Center Stake
110 Degrees	11	-5.20' <b>HUB GRADE</b>	365' Distance to Property Line	130' Spacing from 100 Degrees Mark	17.42' Bass landing Road 530' From Right Side Property Line	-9.62' Bass Landing Road @ 510' From Center Stake
120 Degrees	12	-6.12' <b>HUB GRADE</b>	430' Distance to Property Line	65' Spacing from 110 Degrees Mark	17.42' Bass landing Road 530' From Right Side Property Line	-10.54' Bass Landing Road @ 480' From Center Stake
130 Degrees	13	-7.55' <b>HUB GRADE</b>	530' Distance to Property Line	70' Spacing from 120 Degrees Mark	17.42' Bass landing Road 530' From Right Side Property Line	-11.97' Bass Landing Road @ 440' From Center Stake

140 Degrees	14	-8.54' <b>HUB GRADE</b>	600' Distance to Property Line	75' Spacing from 130 Degrees Mark	17.42' Bass landing Road @ 530' From Right Side Property Line	-12.96' Bass Landing Road @ 430' From Center Stake
150 Degrees	15	-9.61' <b>HUB GRADE</b>	675' Distance to Property Line	75' Spacing from 140 Degrees Mark	17.42' Bass landing Road @ 530' From Right Side Property Line	-14.03' Bass Landing Road @ 440' From Center Stake
160 Degrees	16	-10.46' <b>HUB GRADE</b>	735' Distance to Property Line	60' Spacing from 150 Degrees Mark	17.42' Bass landing Road @ 530' From Right Side Property Line	-14.88' Bass Landing Road @ 460' From Center Stake
170 Degrees	17	-12.03' <b>HUB GRADE</b>	845' Distance to Property Line	105' Spacing from 160 Degrees Mark	17.42' Bass landing Road @ 530' From Right Side Property Line	-16.25' Bass Landing Road @ 490' From Center Stake
180 Degrees	18	-13.24' <b>HUB GRADE</b>	930' Distance to Property Line	90' Spacing from 170 degrees Mark	17.42' Bass landing Road @ 530' From Right Side Property Line	-17.66' Bass Landing Road @ 440' From Center Stake
190 Degrees	19	-12.44' <b>HUB GRADE</b>	30' Distance to Property Line Bottom ( <b>Right Side</b> )	180' Spacing from 180 Degrees Mark	17.42' Bass landing Road @ 530' From Right Side Property Line	-16.86' Bass Landing Road @ 530' From Center Stake
200 Degrees	20	-13.02' <b>HUB GRADE</b>	160' Distance to Property Line Bottom	130' Spacing from 190 Degrees Mark	17.42' Bass landing Road @ 530' From Right Side Property Line	-17.44' Bass Landing Road @ 610' From Center Stake

210 Degrees	21	-13.85' <b>HUB GRADE</b>	230' Distance to Property Line Bottom	75' Spacing from 200 Degrees Mark	17.42' Bass landing Road @ 530' From Right Side Property Line	-18.27' Bass Landing Road @ 510' From Center Stake
220 Degrees	22	-14.51' <b>HUB GRADE</b>	320' Distance to Property Line Bottom	85' Spacing from 210 Degrees Mark	17.42' Bass landing Road @ 530' From Right Side Property Line	-18.93' Bass Landing Road @ 600' From Center Stake
230 Degrees	23	-16.05' <b>HUB GRADE</b>	425' Distance to Property Line Bottom	105' Spacing from 220 Degrees	17.42' Bass landing Road @ 530' From Right Side Property Line	-20.47' Bass Landing Road @ 610' From Center Stake
240 Degrees	24	-18.00' <b>HUB GRADE</b>	540' Distance to Property Line Bottom	120' Spacing from 230 Degrees Mark	17.42' Bass landing Road @ 530' From Right Side Property Line	-22.42' Bass Landing Road @ 650' From Center Stake
250 Degrees	25	-20.49' <b>HUB GRADE</b>	690' Distance to Property Line Bottom	145' Spacing from 240 Degrees Mark	17.42' Bass landing Road @ 530' From Right Side Property Line	-24.91' Bass Landing Road @ 740' From Center Stake
260 Degrees	26	-23.67' <b>HUB GRADE</b>	880' Distance to Property Line Bottom	190' Spacing from 250 Degrees Mark	17.42' Bass landing Road @ 530' From Right Side Property Line	-28.09' Bass Landing Road @ 865' From Center Stake

270 Degrees	27	-27.75' <b>HUB GRADE</b>	1,130' Distance to Property Line	250' Spacing from 260 Degrees Mark	17.42' Bass landing Road @ 530' From Right Side Property Line	-32.17' Bass Landing Road @ 1,060' From Center Stake
280 Degrees	28	-23.76' <b>HUB GRADE</b>	280' Distance to Property Line Bottom Left ( <b>River Side</b> )	200' Spacing from 270 Degrees Mark	17.42' Bass landing Road @ 530' From Right Side Property Line	-28.18' Bass Landing Road @ 950' From Center Stake
290 Degrees	29	17.78' <b>HUB GRADE</b>	420' Distance to Property Line Bottom Right	140' Spacing from 280 Degrees Mark	17.42' Bass landing Road @ 530' From Right Side Property Line	-22.20' Bass Landing Road @ 880' From Center Stake
300 Degree	30	-9.95' <b>HUB GRADE</b>	550' Distance to Property Line Bottom Right	125' Spacing from 290 Degrees Mark	17.42' Bass landing Road @ 530' From Right Side Property Line	-14.37' Bass Landing Road @ 850' From Center Stake
310 Degrees	31	-0.41' <b>HUB GRADE</b>	670' Distance to Property Line  Bottom Right	120' Spacing from 300 Degrees Mark	17.42' Bass landing Road @ 530' From Right Side Property Line	-4.83' Bass Landing Road @ 855' From Center Stake

320 Degrees	32	+10.98' <b>HUB GRADE</b>	800' Distance to Property Line Bottom Right	125' Spacing From 310 Degrees Mark	17.42' Bass landing Road @ 530' From Right Side Property Line	+15.40' Bass Landing Road @ 890' From Center Stake
330 Degrees	33	+25.21' <b>HUB GRADE</b>	1,000' Distance to Property Line Bottom Right	200' Spacing from 320 Degrees Mark	17.42' Bass landing Road @ 530' From Right Side Property Line	+29.63' Bass Landing Road @ 980' From Center Stake
340 Degrees	34	+40.01' <b>HUB GRADE</b>	1,040' Distance to Property Line Bottom Right	140' Spacing from 330 Degrees Mark	17.42' Bass landing Road @ 530' From Right Side Property Line	+44.43' Bass Landing Road @ 910' From Center Stake
350 Degrees	35	11.04' <b>HUB GRADE</b>	960' Distance to Property Line Top ( <b>Left Side</b> )	190' Spacing from 340' Degrees Mark	17.42' Bass landing Road @ 530' From Right Side Property Line	+15.46' Bass Landing Road @ 650' From Center Stake
360 Degrees	36	14.11' <b>HUB GRADE</b>	850' Distance to Property Line Top Right	110' Spacing from 350 Degrees Mark	17.42' Bass landing Road @ 530' From Right Side Property Line	+18.53' Bass Landing Road @ 570' From Center Stake

**GRADE  
STATION #**

**HUB  
GRADE**

**LENGTH  
FROM  
CENTER  
STAKE**

**SPACING OF  
10 DEGREES  
FROM PRIOR  
DEGREES**

**BACKSIDE  
READING  
(Center Stake  
+ Instrument  
Height)**

**FORESIGHT  
READING  
(Property Line)**

## ***Residential Custom Home Design Surveying The Property From Center Stake***

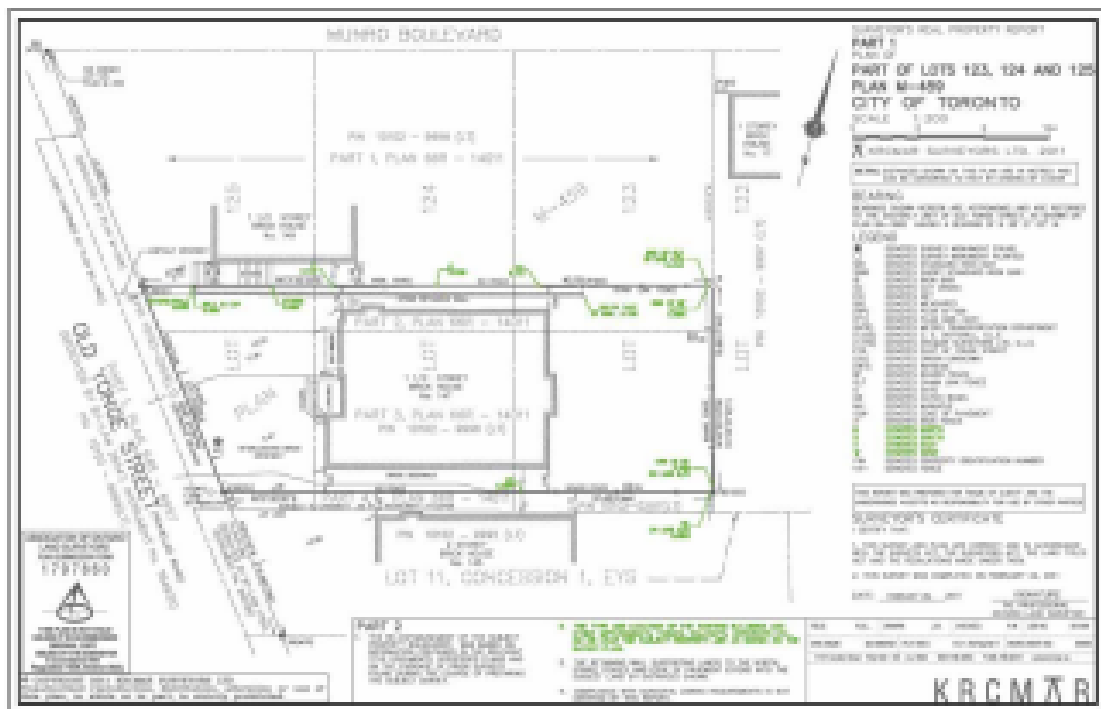

**Top Left Corner** – 330° Northwest **Top Right Corner** - 80° Northeast Hub Grade +25.21'

Hub Grade -0.15' Center Stake Distance Away 980' Center Stake Distance Away 700'

Northwest to Southwest 1,760' Northeast to West 1,510' Average Fill of +12.76'

Average Cuts of -13.70' Ratio (Length to Rise) 137.94' to 1' Ratio (Length to Fall)

110.22' to 1' Center Stake 555' From Bass Road Center Stake 480' From Bass Road

Center Stake 550' From Right Line Center Stake 530' From Right Line Center Grade

Stake +19.38 Center Stake Grade -19.90'

**Bottom Left Corner** - 270° West **Bottom Right Corner** - 190° Southwest Hub Grade

-27.27' Hub Grade -12.44' Center Stake Distance Away 1,060' Center Stake Distance

Away 530'

	<b>STARTING LEFT SIDE (Grade w/Location When Required)</b>	<b>STARTING RIGHT SIDE (Grade w/Location When Required)</b>	<b>ENDING LEFT SIDE (Grade w/Location When Required)</b>	<b>ENDING RIGHT SIDE (Grade w/Location When Required)</b>
Boardwalk (From Bass Landing Road down to Outdoors Kitchen)	334° 1,310' from Top Right Corner	336° 1,285' from Top Right Corner	272° 1,070' from Bottom Right Corner	271° 1,040' from Bottom Right Corner
Boardwalk (From Outdoors Kitchen Down to Property Line)	306° 1,220' from Right Property Line	305° 1,160' From Right Property	304° 1,210' from right property line	304° 950' from right property line



	<i>Line</i>			
<i>Boardwalk (Electric Pipe Laying Trench or under boardwalk [Cat 374 has a 48" Bucket])</i>	40° 70' From Ground Floor Entrance Stake	40° 70' from Ground Floor Entrance Stake	305° 760' from Ground Floor Entrance Stake	305° 760' from Ground Floor Entrance Stake
<i>Boat Dock/ House ("U" Shape for Boat Lift)</i>	305° 910' From Ground Floor Entrance Stake	305° 860' from Ground Floor Entrance Stake	303° 910' From Ground Floor Entrance Stake	303° 860' from Ground Floor Entrance Stake
<i>Boat Dock (Boardwalk from Outdoors Kitchen)</i>	304° 810' From Ground Floor Entrance Stake	303° 865' from Ground Floor Entrance Stake	303° 810' from Ground Floor Entrance Stake	304° 865' from Ground Floor Entrance Stake
<i>Boat Dock (Electric Pipe Laying Trench or Under Boardwalk [Cat 374 has a 48" Bucket])</i>	305° 860' from Ground Floor Entrance Stake	305° 860' from Ground Floor Entrance Stake	305° 755' from Ground Floor Entrance Stake	305° 755' from ground Floor Entrance Stake
<i>Walking Bridge Wooden Sidewalk to House</i>	305° 485' from Ground Floor	303° 485' from Ground Floor	316° 100' from Ground Floor	306° 100' from Ground Floor Entrance Stake
	<i>Entrance Stake</i>	<i>Entrance Stake</i>	<i>Entrance Stake</i>	

<i>Walking Bridge</i>	304° 690' from Ground Floor Entrance Stake	305° 490' from Ground Floor Entrance Stake	303° 690' from Ground Floor Entrance Stake	302° 490' from Ground Floor Entrance Stake
<i>Walking Bridge Wooden Sidewalk to Boardwalk</i>	304° 750' from Ground Floor Entrance Stake	306° 690' from Ground Floor Entrance Stake	304° 750' from Ground Floor Entrance Stake	303° 690' from Ground Floor Entrance Stake
<i>Walking Bridge (Electric Pipe Laying Trench or Under Bridge)</i>	304° 690' from Ground Floor Entrance Stake	305° 490' from Ground Floor Entrance Stake	303° 690' from Ground Floor Entrance Stake	302° 490' from Ground Floor Entrance Stake
<i>Walking Bridge Sewer Pipe Laying Trench or Under Bridge</i>	304° 690' from Ground Floor Entrance Stake	305° 490' from Ground Floor Entrance Stake	303° 690' from Ground Floor Entrance Stake	302° 490' from Ground Floor Entrance Stake
<i>Car Garage</i>	340° 200' from Ground Floor Entrance Stake	55° 135' from Ground Floor Entrance Stake	263° 200' from Ground Floor Entrance Stake	186° 125' from Ground Floor Entrance Stake
<i>Car Garage Driveway</i>	76° 650' from Ground Floor Entrance Stake	82° 710' from Ground Floor Entrance Stake	90° 60' from Ground Floor Entrance Stake	135° 60' from Ground Floor Entrance Stake
<i>Car Garage Electric Pipe Laying Trench</i>	<i>Have to Figure out Sewer</i>	<i>Have to Figure out</i>	<i>Have to Figure out Sewer Pipe</i>	<i>Have to Figure out Sewer Pipe</i>

	<i>Pipe whereabouts and the depth of the well if not City Supplied</i>	<i>Sewer Pipe whereabouts and the depth of the well if not City Supplied</i>	<i>whereabouts and the depth of the well if not City Supplied</i>	<i>whereabouts and the depth of the well if not City Supplied</i>
<i>Car Garage Water Pipe Laying Trench</i>	<i>Have to Figure out Sewer Pipe whereabouts and the depth of the well if not City Supplied</i>	<i>Have to Figure out Sewer Pipe whereabouts and the depth of the well if not City Supplied</i>	<i>Have to Figure out Sewer Pipe whereabouts and the depth of the well if not City Supplied</i>	<i>Have to Figure out Sewer Pipe whereabouts and the depth of the well if not City Supplied</i>
<i>Car Garage Sewer Pipe Laying Trench</i>	<i>Have to Figure out Sewer Pipe whereabouts and the depth of the well if not City Supplied</i>	<i>Have to Figure out Sewer Pipe whereabouts and the depth of the well if not City Supplied</i>	<i>Have to Figure out Sewer Pipe whereabouts and the depth of the well if not City Supplied</i>	<i>Have to Figure out Sewer Pipe whereabouts and the depth of the well if not City Supplied</i>
<i>Car Garage Sanitary Pipe Laying Trench (Bathroom)</i>	<i>Have to Figure out Sewer Pipe whereabouts and the depth of the well if not City Supplied</i>	<i>Have to Figure out Sewer Pipe whereabouts and the depth of the well if not City Supplied</i>	<i>Have to Figure out Sewer Pipe whereabouts and the depth of the well if not City Supplied</i>	<i>Have to Figure out Sewer Pipe whereabouts and the depth of the well if not City Supplied</i>
<i>Helicopter Pad</i>	<i>194°</i>	<i>188°</i>	<i>198°</i>	<i>192°</i>

<i><b>STARTING LEFT SIDE (Grade w/Location When Required)</b></i>	<i><b>STARTING RIGHT SIDE (Grade w/Location When Required)</b></i>	<i><b>ENDING LEFT SIDE (Grade w/Location When Required)</b></i>	<i><b>ENDING RIGHT SIDE (Grade w/Location When Required)</b></i>
---	--	---	--

## ***Residential Custom Home Design Surveying Property from Ground Floor***

	<i>475' from Ground Floor Entrance Stake</i>	<i>485' from Ground Floor Entrance Stake</i>	<i>520' from Ground Floor Entrance Stake</i>	<i>540' from Ground Floor Entrance Stake</i>
<i>Helicopter Pad Wooden Sidewalk</i>	<i>270° 275' from Ground Floor Entrance Stake</i>	<i>240° 240' from Ground Floor Entrance Stake</i>	<i>187° 490' from Ground Floor Entrance Stake</i>	<i>190° 480' from Ground Floor Entrance Stake</i>
<i>Helicopter Pad Electric Pipe Laying Trench</i>	<i>Have to Figure out Sewer Pipe whereabouts and the depth of the well if not City Supplied</i>	<i>Have to Figure out Sewer Pipe whereabouts and the depth of the well if not City Supplied</i>	<i>Have to Figure out Sewer Pipe whereabouts and the depth of the well if not City Supplied</i>	<i>Have to Figure out Sewer Pipe whereabouts and the depth of the well if not City Supplied</i>
<i>Helicopter Pad Sewer Pipe Laying Trench</i>	<i>Have to Figure</i>	<i>Have to</i>	<i>Have to Figure</i>	<i>Have to Figure out</i>

	out Sewer Pipe whereabouts and the depth of the well if not City Supplied	Figure out Sewer Pipe whereabouts and the depth of the well if not City Supplied	out Sewer Pipe whereabouts and the depth of the well if not City Supplied	Sewer Pipe whereabouts and the depth of the well if not City Supplied
Helicopter Pad Sanitary Pipe Laying Trench (For Pilots Full Bathroom)	Have to Figure out Sewer Pipe whereabouts and the depth of the well if not City Supplied	Have to Figure out Sewer Pipe whereabouts and the depth of the well if not City Supplied	Have to Figure out Sewer Pipe whereabouts and the depth of the well if not City Supplied	Have to Figure out Sewer Pipe whereabouts and the depth of the well if not City Supplied
Helicopter Pad Water Pipe Laying Trench (For Pilots Full Bathroom)	Have to Figure out Sewer Pipe whereabouts and the depth of the well if not City Supplied	Have to Figure out Sewer Pipe whereabouts and the depth of the well if not City Supplied	Have to Figure out Sewer Pipe whereabouts and the depth of the well if not City Supplied	Have to Figure out Sewer Pipe whereabouts and the depth of the well if not City Supplied
Infinity Pool	295° 350' from Ground Floor Entrance Stake	298° 280' from Ground Floor Entrance Stake	290° 370' from Ground Floor Entrance Stake	288° 280' from Ground Floor Entrance Stake
Infinity Pool Wooden Sidewalk	Have to Figure out Sewer Pipe whereabouts	Have to Figure out Sewer Pipe whereabouts	Have to Figure out Sewer Pipe whereabouts and the depth	Have to Figure out Sewer Pipe whereabouts and the depth of the

<i>and the depth of the well if not City Supplied</i>	<i>and the depth of the well if not City Supplied</i>	<i>of the well if not City Supplied</i>	<i>well if not City Supplied</i>
---	---	---	--------------------------------------

*Infinity Pool Electric Pipe  
Laying Trench*

<i>Have to Figure out Sewer Pipe whereabouts and the depth of the well if not City Supplied</i>	<i>Have to Figure out Sewer Pipe whereabouts and the depth of the well if not City Supplied</i>	<i>Have to Figure out Sewer Pipe whereabouts and the depth of the well if not City Supplied</i>	<i>Have to Figure out Sewer Pipe whereabouts and the depth of the well if not City Supplied</i>
---	---	---	---

*Infinity Pool Water Pipe Laying  
Trench for Bathroom*

<i>Have to Figure out Sewer Pipe whereabouts and the depth of the well if not City Supplied</i>	<i>Have to Figure out Sewer Pipe whereabouts and the depth of the well if not City Supplied</i>	<i>Have to Figure out Sewer Pipe whereabouts and the depth of the well if not City Supplied</i>	<i>Have to Figure out Sewer Pipe whereabouts and the depth of the well if not City Supplied</i>
---	---	---	---

*Infinity Pool Sanitary Pipe Laying  
for Bathroom*

<i>Have to Figure out Sewer Pipe whereabouts and the depth of the well if not City Supplied</i>	<i>Have to Figure out Sewer Pipe whereabouts and the depth of the well if not City Supplied</i>	<i>Have to Figure out Sewer Pipe whereabouts and the depth of the well if not City Supplied</i>	<i>Have to Figure out Sewer Pipe whereabouts and the depth of the well if not City Supplied</i>
---	---	---	---

<i>Hobby Warehouse</i>	<i>285° 600' from Ground Floor Entrance Stake</i>	<i>280° 500' from Ground Floor Entrance Stake</i>	<i>275° 630' from Ground Floor Entrance Stake</i>	<i>271° 545' from Ground Floor Entrance Stake</i>
<i>Hobby Warehouse Wooden Sidewalk</i>	<i>278° 510' from Ground Floor Entrance Stake</i>	<i>260° 310' from Ground Floor Entrance Stake</i>	<i>275° 525' from Ground Floor Entrance Stake</i>	<i>256° 540' from Ground Floor Entrance Stake</i>
<i>Hobby Warehouse Electric Pipe Laying Trench</i>	<i>Have to Figure out Sewer Pipe whereabouts and the depth of the well if not City Supplied</i>	<i>Have to Figure out Sewer Pipe whereabouts and the depth of the well if not City Supplied</i>	<i>Have to Figure out Sewer Pipe whereabouts and the depth of the well if not City Supplied</i>	<i>Have to Figure out Sewer Pipe whereabouts and the depth of the well if not City Supplied</i>
<i>Hobby Warehouse Water Pipe Laying Trench</i>	<i>Have to Figure out Sewer Pipe whereabouts and the depth of the well if not City Supplied</i>	<i>Have to Figure out Sewer Pipe whereabouts and the depth of the well if not City Supplied</i>	<i>Have to Figure out Sewer Pipe whereabouts and the depth of the well if not City Supplied</i>	<i>Have to Figure out Sewer Pipe whereabouts and the depth of the well if not City Supplied</i>
<i>Hobby Warehouse Sanitary Pipe Laying Trench</i>	<i>Have to Figure out Sewer Pipe whereabouts</i>	<i>Have to Figure out Sewer Pipe whereabouts</i>	<i>Have to Figure out Sewer Pipe whereabouts and the depth</i>	<i>Have to Figure out Sewer Pipe whereabouts and the depth of the</i>

	<i>and the depth of the well if not City Supplied</i>	<i>and the depth of the well if not City Supplied</i>	<i>of the well if not City Supplied</i>	<i>well if not City Supplied</i>
<i>Bowling Lanes</i>	<i>235° 420' from Ground Floor Entrance Stake</i>	<i>230° 400' from Ground Floor Entrance Stake</i>	<i>231° 515' from Ground Floor Entrance Stake</i>	<i>226° 500' from Ground Floor Entrance Stake</i>
<i>Bowling Lanes Wooden Sidewalk</i>	<i>240° 455' from Ground Floor Entrance Stake</i>	<i>234° 450' from Ground Floor Entrance Stake</i>	<i>238° 490' from Ground Floor Entrance Stake</i>	<i>232° 470' from Ground Floor Entrance Stake</i>
<i>Bowling Lanes Electric Pipe Laying Trench</i>	<i>Have to Figure out Sewer Pipe whereabouts and the depth of the well if not City Supplied</i>	<i>Have to Figure out Sewer Pipe whereabouts and the depth of the well if not City Supplied</i>	<i>Have to Figure out Sewer Pipe whereabouts and the depth of the well if not City Supplied</i>	<i>Have to Figure out Sewer Pipe whereabouts and the depth of the well if not City Supplied</i>
<i>Bowling Lanes Water Pipe Laying Trench</i>	<i>Have to Figure out Sewer Pipe whereabouts and the depth of the well if not City Supplied</i>	<i>Have to Figure out Sewer Pipe whereabouts and the depth of the well if not City Supplied</i>	<i>Have to Figure out Sewer Pipe whereabouts and the depth of the well if not City Supplied</i>	<i>Have to Figure out Sewer Pipe whereabouts and the depth of the well if not City Supplied</i>
<i>Bowling Lanes Sanitary Pipe</i>	<i>Have to Figure</i>	<i>Have to</i>	<i>Have to Figure</i>	<i>Have to Figure out</i>



<i>Laying Trench</i>	<i>out Sewer Pipe whereabouts and the depth of the well if not City Supplied</i>	<i>Figure out Sewer Pipe whereabouts and the depth of the well if not City Supplied</i>	<i>out Sewer Pipe whereabouts and the depth of the well if not City Supplied</i>	<i>Sewer Pipe whereabouts and the depth of the well if not City Supplied</i>
<i>Basketball &amp; Volleyball Court</i>	<i>241° 330' from Ground Floor Entrance Stake</i>	<i>224° 350' from Ground Floor Entrance Stake</i>	<i>238° 380' from Ground Floor Entrance Stake</i>	<i>223° 350' from Ground Floor Entrance Stake</i>
<i>Basketball &amp; Volleyball Court Wooden Sidewalk</i>	<i>243° 270' from Ground Floor Entrance Stake</i>	<i>240° 260' from Ground Floor Entrance Stake</i>	<i>240° 350' from Ground Floor Entrance Stake</i>	<i>234° 310' from Ground Floor Entrance Stake</i>
<i>Basketball &amp; Volleyball Court Electric Pipe Laying Trench</i>	<i>Have to Figure out Sewer Pipe whereabouts and the depth of the well if not City Supplied</i>	<i>Have to Figure out Sewer Pipe whereabouts and the depth of the well if not City Supplied</i>	<i>Have to Figure out Sewer Pipe whereabouts and the depth of the well if not City Supplied</i>	<i>Have to Figure out Sewer Pipe whereabouts and the depth of the well if not City Supplied</i>
<i>Basketball &amp; Volleyball Court Water Pipe Laying Trench (Washing Court)</i>	<i>Have to Figure out Sewer Pipe whereabouts and the depth of the well if not City Supplied</i>	<i>Have to Figure out Sewer Pipe whereabouts and the depth of the well if not City Supplied</i>	<i>Have to Figure out Sewer Pipe whereabouts and the depth of the well if not City Supplied</i>	<i>Have to Figure out Sewer Pipe whereabouts and the depth of the well if not City Supplied</i>

*Greenhouse*

*Supplied*

*351°  
270' from  
Ground  
Floor  
Entrance  
Stake*

*15°  
210' from  
Ground  
Floor*

*349°  
245' from  
Ground  
Floor  
Entrance  
Stake*

*13°  
190' from  
Ground Floor  
Entrance  
Stake*

*475' from  
Ground  
Floor  
Entrance  
Stake*

*485' from  
Ground  
Floor  
Entrance  
Stake*

*520' from  
Ground  
Floor  
Entrance  
Stake*

*540' from  
Ground Floor  
Entrance  
Stake*

## ***Residential Custom Home Design Pipe Laying & Boardwalk Chart***

*Entrance Stake*

*Entrance  
Stake*

*Entrance Stake*

*Entrance Stake*

<i>Greenhouse Wooden Sidewalk</i>	<i>347° 300' from Ground Floor Entrance Stake</i>	<i>352° 280' from Ground Floor Entrance Stake</i>	<i>343° 285' from Ground Floor Entrance Stake</i>	<i>349° 260' from Ground Floor Entrance Stake</i>
<i>Greenhouse Electric Pipe Laying Trench</i>	<i>Have to Figure out Sewer Pipe whereabouts and the depth of the well if not City Supplied</i>	<i>Have to Figure out Sewer Pipe whereabouts and the depth of the well if not City Supplied</i>	<i>Have to Figure out Sewer Pipe whereabouts and the depth of the well if not City Supplied</i>	<i>Have to Figure out Sewer Pipe whereabouts and the depth of the well if not City Supplied</i>
<i>Greenhouse Water Pipe Laying Trench</i>	<i>Have to Figure out Sewer Pipe whereabouts and the depth of the well if not City Supplied</i>	<i>Have to Figure out Sewer Pipe whereabouts and the depth of the well if not City Supplied</i>	<i>Have to Figure out Sewer Pipe whereabouts and the depth of the well if not City Supplied</i>	<i>Have to Figure out Sewer Pipe whereabouts and the depth of the well if not City Supplied</i>
<i>Greenhouse Sewer Pipe Laying Trench</i>	<i>Have to Figure out Sewer Pipe whereabouts and the depth of the well if not City Supplied</i>	<i>Have to Figure out Sewer Pipe whereabouts and the depth of the well if not City Supplied</i>	<i>Have to Figure out Sewer Pipe whereabouts and the depth of the well if not City Supplied</i>	<i>Have to Figure out Sewer Pipe whereabouts and the depth of the well if not City Supplied</i>

<i>Garden</i>	<i>344° 440' from Ground Floor Entrance Stake</i>	<i>342° 360' from Ground Floor Entrance Stake</i>	<i>322° 390' from Ground Floor Entrance Stake</i>	<i>327° 300' from Ground Floor Entrance Stake</i>
<i>Garden Wooden Sidewalk</i>	<i>338° 340' from Ground Floor Entrance Stake</i>	<i>342° 336' from Ground Floor Entrance Stake</i>	<i>336° 320' from Ground Floor Entrance Stake</i>	<i>339° 300' from Ground Floor Entrance Stake</i>
<i>Garden Water Pipe Laying Trench</i>	<i>Have to Figure out Sewer Pipe whereabouts and the depth of the well if not City Supplied</i>	<i>Have to Figure out Sewer Pipe whereabouts and the depth of the well if not City Supplied</i>	<i>Have to Figure out Sewer Pipe whereabouts and the depth of the well if not City Supplied</i>	<i>Have to Figure out Sewer Pipe whereabouts and the depth of the well if not City Supplied</i>
<i>Main House</i>	<i>340° 125' from Ground Floor Entrance Stake</i>	<i>33° 75' from Ground Floor Entrance Stake</i>	<i>265° 125' from Ground Floor Entrance Stake</i>	<i>222° 75' from Ground Floor Entrance Stake</i>
<i>Main House Wooden Sidewalk</i>	<i>306° 490' from Ground Floor Entrance Stake</i>	<i>313° 100' from Ground Floor Entrance Stake</i>	<i>304° 500' from Ground Floor Entrance Stake</i>	<i>300° 100' from Ground Floor Entrance Stake</i>
<i>Main House Electric Pipe Laying Trench</i>	<i>Have to Figure out Sewer Pipe whereabouts and the depth</i>	<i>Have to Figure out Sewer Pipe whereabouts and the</i>	<i>Have to Figure out Sewer Pipe whereabouts and the depth of the well if</i>	<i>Have to Figure out Sewer Pipe whereabouts and the depth of the well if not City</i>

	<i>of the well if not City Supplied</i>	<i>depth of the well if not City Supplied</i>	<i>not City Supplied</i>	<i>Supplied</i>
<i>Main House Water Pipe Laying Trench</i>	<i>Have to Figure out Sewer Pipe whereabouts and the depth of the well if not City Supplied</i>	<i>Have to Figure out Sewer Pipe whereabouts and the depth of the well if not City Supplied</i>	<i>Have to Figure out Sewer Pipe whereabouts and the depth of the well if not City Supplied</i>	<i>Have to Figure out Sewer Pipe whereabouts and the depth of the well if not City Supplied</i>
<i>Main House Sanitary Pipe Laying Trench</i>	<i>Have to Figure out Sewer Pipe whereabouts and the depth of the well if not City Supplied</i>	<i>Have to Figure out Sewer Pipe whereabouts and the depth of the well if not City Supplied</i>	<i>Have to Figure out Sewer Pipe whereabouts and the depth of the well if not City Supplied</i>	<i>Have to Figure out Sewer Pipe whereabouts and the depth of the well if not City Supplied</i>
<i>Main House Entrance Way Radius (Left Side to Center of Entrance)</i>	<i>78° 650' from Ground Floor</i>	<i>80° 700' from Ground</i>	<i>83° 650' from Ground Floor</i>	<i>84°</i>

*Entrance Stake*

*Entrance  
Stake*

*Entrance Stake*

*Entrance Stake*

## ***Residential Custom Home Design for Crane***

## ***Lifting Radius Over Daughter's House***

	<i>Entrance Stake</i>	<i>Floor Entrance Stake</i>	<i>Entrance Stake</i>	<i>670' from Ground Floor Entrance Stake</i>
<i>Main House Entrance Way Radius (Right Side to Center of Entrance)</i>	<i>82° 700' from Ground Floor Entrance Stake</i>	<i>86° 770' from Ground Floor Entrance Stake</i>	<i>83° 670' from Ground Floor Entrance Stake</i>	<i>85° 690' from Ground Floor Entrance Stake</i>
<i>Main House Driveway (From Radius to Tunnel Decline Entranceway)</i>	<i>85° 640' from Ground Floor Entrance Stake</i>	<i>84° 695' from Ground Floor Entrance Stake</i>	<i>116° 410' from Ground Floor Entrance Stake</i>	<i>122° 430' from Ground Floor Entrance Stake</i>
<i>Main House Tunnel Entrance (From Point of Downgrade to Tunnel Entrance)</i>	<i>116° 410' from Ground Floor Entrance Stake</i>	<i>122° 430' from Ground Floor Entrance Stake</i>	<i>110° 50' from Ground Floor Entrance Stake</i>	<i>140° 60' from Ground Floor Entrance Stake</i>
<i>Main House Tunnel</i>	<i>63° 20' from Ground Floor Entrance Stake</i>	<i>104° 50' from Ground Floor Entrance Stake</i>	<i>205° 20' from Ground Floor Entrance Stake</i>	<i>145° 60' from Ground Floor Entrance Stake</i>
<i>Main House Underground Parking Starting (One Way Traffic Around House to the right)</i>	<i>63° 20' from Ground Floor Entrance Stake</i>	<i>104° 50' from Ground Floor Entrance Stake</i>	<i>32° 60' from Ground Floor Entrance Stake</i>	<i>73° 90' from Ground Floor Entrance Stake</i>

<i>Main House Underground Parking Front Right Corner (One Way Traffic Around House to the right)</i>	56° 135' from Ground Floor Entrance Stake	65° 95' from Ground Floor Entrance Stake	340° 190' from Ground Floor Entrance Stake	329° 165' from Ground Floor Entrance Stake
<i>Main House Underground Parking Rear Right Corner (One Way Traffic Around House to the Right)</i>	327° 160' from Ground Floor Entrance Stake	336° 120' from Ground Floor Entrance Stake	276° 170' from Ground Floor Entrance Stake	265° 120' from Ground Floor Entrance Stake
<i>Main House Underground Parking Rear Left Corner (One Way Traffic Around House to the Right)</i>	263° 200' from Ground Floor Entrance Stake	277° 170' from Ground Floor Entrance Stake	212° 80' from Ground Floor Entrance Stake	212° 125' from Ground Floor Entrance Stake
<i>Main House Underground Parking Front Left Corner (One Way Traffic Around House to the Right)</i>	212° 125' from Ground Floor Entrance Stake	190° 150' from Ground Floor Entrance Stake	200° 20' from Ground Floor Entrance Stake	142° 60' from Ground Floor Entrance Stake
<i>Main House Underground Parking Ending and Starting the Tunnel (One Way Traffic Around House to the Right)</i>	203° 30' from Ground Floor Entrance Stake	152° 60' from Ground Floor Entrance Stake	101° 10' from Ground Floor Entrance Stake	110° 50' from Ground Floor Entrance Stake
<i>Main House Bottom Floor</i>	<i>Access From Ground Floor Entrance Hub</i>	<i>Access From Ground Floor Entrance Hub</i>	<i>Access From Ground Floor Entrance Hub</i>	<i>Access From Ground Floor Entrance Hub</i>
<i>Main House 2nd Level Floor</i>	<i>Access From Ground Floor Entrance Hub</i>	<i>Access From Ground Floor Entrance Hub</i>	<i>Access From Ground Floor Entrance Hub</i>	<i>Access From Ground Floor Entrance Hub</i>

<i>Main House Ground Floor Level</i>	<i>Access From Ground Floor Entrance Hub</i>	<i>Access From Ground Floor Entrance Hub</i>	<i>Access From Ground Floor Entrance Hub</i>	<i>Access From Ground Floor Entrance Hub</i>
<i>Main House Top Level</i>	<i>Access From Ground Floor Entrance Hub</i>	<i>Access From Ground Floor Entrance Hub</i>	<i>Access From Ground Floor Entrance Hub</i>	<i>Access From Ground Floor Entrance Hub</i>
<i>Main House Roof / Stairs Observation Deck &amp; Telescope / Roof</i>		<i>Access From Ground Floor Entrance Hub</i>	<i>Access From Ground Floor Entrance Hub</i>	<i>Access From Ground Floor Entrance Hub</i>
<i>Daughter's House</i>	<i>7° 445' from Ground Floor Entrance Stake</i>	<i>17° 400' from Ground Floor Entrance Stake</i>	<i>4° 380' from Ground Floor Entrance Stake</i>	<i>15° 350' from Ground Floor Entrance Stake</i>
<i>Daughter's House Wooden Sidewalk</i>	<i>Access From Ground Floor Entrance Hub</i>	<i>Access From Ground Floor Entrance Hub</i>	<i>Access From Ground Floor Entrance Hub</i>	<i>Access From Ground Floor Entrance Hub</i>
<i>Daughter's House Electric Pole</i>	<i>Access From Ground Floor Entrance Hub</i>	<i>Access From Ground Floor Entrance Hub</i>	<i>Access From Ground Floor Entrance Hub</i>	<i>Access From Ground Floor Entrance Hub</i>
<i>Daughter's House Water Pipe Laying Trench</i>	<i>Access From Ground Floor Entrance Hub</i>	<i>Access From Ground Floor Entrance Hub</i>	<i>Access From Ground Floor Entrance Hub</i>	<i>Access From Ground Floor Entrance Hub</i>
<i>Daughter's House Sanitary Pipe Laying Trench</i>	<i>Access From Ground Floor Entrance Hub</i>	<i>Access From Ground Floor Entrance Hub</i>	<i>Access From Ground Floor Entrance Hub</i>	<i>Access From Ground Floor Entrance Hub</i>
<i>Daughter's House Basement</i>	<i>Access From Ground Floor Entrance Hub</i>	<i>Access From Ground Floor Entrance Hub</i>	<i>Access From Ground Floor Entrance Hub</i>	<i>Access From Ground Floor Entrance Hub</i>
<i>Daughter's House Ground Floor</i>	<i>Access From Ground Floor</i>	<i>Access From Ground Floor</i>	<i>Access From Ground Floor</i>	<i>Access From Ground Floor</i>





<i>Son's House Wooden Sidewalk</i>	<i>Access From Ground Floor Entrance Hub</i>	<i>Access From Ground Floor Entrance Hub</i>	<i>Access From Ground Floor Entrance Hub</i>	<i>Access From Ground Floor Entrance Hub</i>
<i>Son's House Electric Pole</i>	<i>Access From Ground Floor Entrance Hub</i>	<i>Access From Ground Floor Entrance Hub</i>	<i>Access From Ground Floor Entrance Hub</i>	<i>Access From Ground Floor Entrance Hub</i>
<i>Son's House Water Pipe Laying Trench</i>	<i>Access From Ground Floor Entrance Hub</i>	<i>Access From Ground Floor Entrance Hub</i>	<i>Access From Ground Floor Entrance Hub</i>	<i>Access From Ground Floor Entrance Hub</i>
<i>Son's House Sanitary Pipe Laying Trench</i>	<i>Access From Ground Floor Entrance Hub</i>	<i>Access From Ground Floor Entrance Hub</i>	<i>Access From Ground Floor Entrance Hub</i>	<i>Access From Ground Floor Entrance Hub</i>
<i>Son's House Basement</i>	<i>Access From Ground Floor Entrance Hub</i>	<i>Access From Ground Floor Entrance Hub</i>	<i>Access From Ground Floor Entrance Hub</i>	<i>Access From Ground Floor Entrance Hub</i>
<i>Son's House Ground Floor</i>	<i>Access From Ground Floor Entrance Hub</i>	<i>Access From Ground Floor Entrance Hub</i>	<i>Access From Ground Floor Entrance Hub</i>	<i>Access From Ground Floor Entrance Hub</i>
<i>Son's House 2nd Level</i>	<i>Access From Ground Floor Entrance Hub</i>	<i>Access From Ground Floor Entrance Hub</i>	<i>Access From Ground Floor Entrance Hub</i>	<i>Access From Ground Floor Entrance Hub</i>
<i>Son's House Roof</i>	<i>Access From Ground Floor Entrance Hub</i>	<i>Access From Ground Floor Entrance Hub</i>	<i>Access From Ground Floor Entrance Hub</i>	<i>Access From Ground Floor Entrance Hub</i>
<i>Daughters and Sons Entranceway Radius (Right Side to Center of Road)</i>	<i>6° 540' from Ground Floor Entrance Stake</i>	<i>13° 510' from Ground Floor Entrance Stake</i>	<i>1° 480 from Ground Floor Entrance Stake</i>	<i>4° 465' from Ground Floor Entrance Stake</i>

<i>Daughters and Sons Entranceway Radius (Left Side to Center of Road)</i>	357° 590' from Ground Floor Entrance Stake	5° 540' from Ground Floor Entrance Stake	1° 520' from Ground Floor Entrance Stake	3° 500' from Ground Floor Entrance Stake
<i>Daughters and Sons Driveway (From Radius to "T" For Sons's Driveway Right and Daughters Left)</i>	360° 510' from Ground Floor Entrance Stake	5° 490' from Ground Floor Entrance Stake	355° 440' from Ground Floor Entrance Stake	360° 410' from Ground Floor Entrance Stake
<i>Daughter Driveway From Center of "T" to Daughters Garage</i>	355° 425' from Ground Floor Entrance Stake	2° 385' from Ground Floor Entrance Stake	6° 355' from Ground Floor Entrance Stake	5° 335' from Ground Floor Entrance Stake
<i>Sons Driveway From Center of "T" to Son's Garage</i>	347° 450' from Ground Floor Entrance Stake	345° 435' from Ground Floor Entrance Stake	356° 425' from Ground Floor Entrance Stake	352° 385' from Ground Floor Entrance Stake
<i>Daughter's Garage</i>	6° 365' from Ground Floor	10° 355' from Ground	2° 320' from Ground Floor	8°

*Entrance  
Stake*

*Entrance  
Stake*

*Entrance  
Stake*

*Entrance Stake*

## ***Residential Custom Home Design Radius Lift over Tunnel and Garage***

	<i>Entrance Stake</i>	<i>Floor Entrance Stake</i>	<i>Entrance Stake</i>	<i>305' from Ground Floor Entrance Stake</i>
<i>Sons Garage</i>	<i>345° 480' from Ground Floor Entrance Stake</i>	<i>349° 460' from Ground Floor Entrance Stake</i>	<i>340° 450' from Ground Floor Entrance Stake</i>	<i>343° 425' from Ground Floor Entrance Stake</i>
<i>Home Office &amp; Garage</i>	<i>75° 320' from Ground Floor Entrance Stake</i>	<i>81° 360' from Ground Floor Entrance Stake</i>	<i>90° 255' from Ground Floor Entrance Stake</i>	<i>95° 300' from Ground Floor Entrance Stake</i>
<i>Home Office &amp; Garage Wooden Sidewalk</i>	<i>Access From Ground Floor Entrance Hub</i>	<i>Access From Ground Floor Entrance Hub</i>	<i>Access From Ground Floor Entrance Hub</i>	<i>Access From Ground Floor Entrance Hub</i>
<i>Home Office &amp; Garage Electric Pipe Laying Trench</i>	<i>Access From Ground Floor Entrance Hub</i>	<i>Access From Ground Floor Entrance Hub</i>	<i>Access From Ground Floor Entrance Hub</i>	<i>Access From Ground Floor Entrance Hub</i>
<i>Home Office &amp; Garage Water Pipe Laying Trench</i>	<i>Access From Ground Floor Entrance Hub</i>	<i>Access From Ground Floor Entrance Hub</i>	<i>Access From Ground Floor Entrance Hub</i>	<i>Access From Ground Floor Entrance Hub</i>
<i>Home Office &amp; Garage Sewer Pipe Laying Trench</i>	<i>Access From Ground Floor Entrance Hub</i>	<i>Access From Ground Floor Entrance Hub</i>	<i>Access From Ground Floor Entrance Hub</i>	<i>Access From Ground Floor Entrance Hub</i>
<i>Home Office &amp; Garage Sanitary Pipe Laying Trench</i>	<i>Access From Ground Floor Entrance Hub</i>	<i>Access From Ground Floor Entrance Hub</i>	<i>Access From Ground Floor Entrance Hub</i>	<i>Access From Ground Floor Entrance Hub</i>
<i>Home Office &amp; Garage (Office Suite 1st Floor)</i>	<i>Access From Ground Floor Entrance Hub</i>	<i>Access From Ground Floor Entrance Hub</i>	<i>Access From Ground Floor Entrance Hub</i>	<i>Access From Ground Floor Entrance Hub</i>

<i>Home Office &amp; Garage (Storage 2nd Floor)</i>	<i>Access From Ground Floor Entrance Hub</i>	<i>Access From Ground Floor Entrance Hub</i>	<i>Access From Ground Floor Entrance Hub</i>	<i>Access From Ground Floor Entrance Hub</i>
<i>Home Office &amp; Garage (1st Bay)</i>	<i>Access From Ground Floor Entrance Hub</i>	<i>Access From Ground Floor Entrance Hub</i>	<i>Access From Ground Floor Entrance Hub</i>	<i>Access From Ground Floor Entrance Hub</i>
<i>Home Office &amp; Garage (2nd Bay)</i>	<i>Access From Ground Floor Entrance Hub</i>	<i>Access From Ground Floor Entrance Hub</i>	<i>Access From Ground Floor Entrance Hub</i>	<i>Access From Ground Floor Entrance Hub</i>
<i>Home Office &amp; Garage (3rd Bay)</i>	<i>Access From Ground Floor Entrance Hub</i>	<i>Access From Ground Floor Entrance Hub</i>	<i>Access From Ground Floor Entrance Hub</i>	<i>Access From Ground Floor Entrance Hub</i>
<i>Home Office &amp; Garage Entranceway Radius (Right Side to Center of Road)</i>	<i>60° 535' from Ground Floor Entrance Stake</i>	<i>66° 560' from Ground Floor Entrance Stake</i>	<i>63° 490' from Ground Floor Entrance Stake</i>	<i>65° 500' from Ground Floor Entrance Stake</i>
<i>Home Office &amp; Garage Entranceway Radius (Left Side to Center of Road)</i>	<i>54° 500' from Ground Floor Entrance Stake</i>	<i>61° 540' from Ground Floor Entrance Stake</i>	<i>61° 490' from Ground Floor Entrance Stake</i>	<i>63° 495' from Ground Floor Entrance Stake</i>
<i>Home Office &amp; Garage Driveway to Garage</i>	<i>61° 490' from Ground Floor Entrance Stake</i>	<i>64° 510' from Ground Floor Entrance Stake</i>	<i>70° 385' from Ground Floor Entrance Stake</i>	<i>73° 410' from Ground Floor Entrance Stake</i>

<i>Home Office &amp; Garage Pull Off Parking for Backing into Bays</i>	<i>71° 350' from Ground Floor Entrance Stake</i>	<i>90° 500' from Ground Floor Entrance Stake</i>	<i>75° 320' from Ground Floor Entrance Stake</i>	<i>94° 470' from Ground Floor Entrance Stake</i>
<i>Generator &amp; Solar Panel Farm</i>	<i>271° 660' from Ground Floor Entrance Stake</i>	<i>265° 580' from Ground Floor Entrance Stake</i>	<i>264° 710' from Ground Floor Entrance Stake</i>	<i>259° 640' from Ground Floor Entrance Stake</i>
<i>Generator &amp; Solar Panel Farm Wooden Sidewalk</i>	<i>261° 610' from Ground Floor Entrance Stake</i>	<i>242° 470' from Ground Floor Entrance Stake</i>	<i>260° 640' from Ground Floor Entrance Stake</i>	<i>240° 500' from Ground Floor Entrance Stake</i>
<i>Generator &amp; Solar Panel Farm Electric Pipe Laying Trench</i>				
<i>Outdoors Kitchen</i>	<i>304° 810' from Ground Floor Entrance Stake</i>	<i>305° 750' from Ground Floor Entrance Stake</i>	<i>302° 810' from Ground Floor Entrance Stake</i>	<i>302° 750' from Ground Floor Entrance Stake</i>
<i>Outdoors Kitchen Electric Pipe Laying Trench or Under Boardwalk</i>	<i>Have to Figure out Sewer Pipe whereabouts and the depth of the well if not City Supplied</i>	<i>Have to Figure out Sewer Pipe whereabouts and the depth of the well if not City Supplied</i>	<i>Have to Figure out Sewer Pipe whereabouts and the depth of the well if not City Supplied</i>	<i>Have to Figure out Sewer Pipe whereabouts and the depth of the well if not City Supplied</i>
<i>Outdoors Kitchen Water Pipe Laying Trench or Under Boardwalk</i>	<i>Have to Figure out Sewer</i>	<i>Have to Figure out</i>	<i>Have to Figure out Sewer Pipe</i>	<i>Have to Figure out Sewer Pipe</i>

<i>Pipe whereabouts and the depth of the well if not City Supplied</i>	<i>Sewer Pipe whereabouts and the depth of the well if not City Supplied</i>	<i>whereabouts and the depth of the well if not City Supplied</i>	<i>whereabouts and the depth of the well if not City Supplied</i>
--	--	---	---

<i>Outdoors Kitchen Sanitary Pipe Laying Trench or Under Boardwalk</i>	<i>Have to Figure out Sewer Pipe whereabouts and the depth of the well if not City Supplied</i>	<i>Have to Figure out Sewer Pipe whereabouts and the depth of the well if not City Supplied</i>	<i>Have to Figure out Sewer Pipe whereabouts and the depth of the well if not City Supplied</i>	<i>Have to Figure out Sewer Pipe whereabouts and the depth of the well if not City Supplied</i>
--	---	---	---	---

<i>Outdoors Theater</i>	<i>266° 435' from Ground Floor Entrance Stake</i>	<i>263° 415' from Ground Floor Entrance Stake</i>	<i>257° 500' from Ground Floor Entrance Stake</i>	<i>254° 490' from Ground Floor Entrance Stake</i>
-------------------------	---	---	---	---

<i>Outdoors Theater Wooden Sidewalk</i>	<i>Have to Figure out Sewer Pipe whereabouts and the depth of the well if not City Supplied</i>	<i>Have to Figure out Sewer Pipe whereabouts and the depth of the well if not City Supplied</i>	<i>Have to Figure out Sewer Pipe whereabouts and the depth of the well if not City Supplied</i>	<i>Have to Figure out Sewer Pipe whereabouts and the depth of the well if not City Supplied</i>
---	---	---	---	---

<i>Entrance Stake</i>	<i>Floor Entrance Stake</i>	<i>Entrance Stake</i>	<i>305' from Ground Floor Entrance Stake</i>
-----------------------	-----------------------------	-----------------------	--

<i>Outdoors Theater Electric Pipe Laying Trench</i>	<i>Have to Figure out Sewer Pipe whereabouts and the depth of the well if not City Supplied</i>	<i>Have to Figure out Sewer Pipe whereabouts and the depth of the well if not City Supplied</i>	<i>Have to Figure out Sewer Pipe whereabouts and the depth of the well if not City Supplied</i>	<i>Have to Figure out Sewer Pipe whereabouts and the depth of the well if not City Supplied</i>
<i>Outdoors Theater Water Pipe Laying Trench</i>	<i>Have to Figure out Sewer Pipe whereabouts and the depth of the well if not City Supplied</i>	<i>Have to Figure out Sewer Pipe whereabouts and the depth of the well if not City Supplied</i>	<i>Have to Figure out Sewer Pipe whereabouts and the depth of the well if not City Supplied</i>	<i>Have to Figure out Sewer Pipe whereabouts and the depth of the well if not City Supplied</i>
<i>Outdoors Theater Sanitary Pipe Laying Trench</i>	<i>Have to Figure out Sewer Pipe whereabouts and the depth of the well if not City Supplied</i>	<i>Have to Figure out Sewer Pipe whereabouts and the depth of the well if not City Supplied</i>	<i>Have to Figure out Sewer Pipe whereabouts and the depth of the well if not City Supplied</i>	<i>Have to Figure out Sewer Pipe whereabouts and the depth of the well if not City Supplied</i>

*Entrance  
Stake*

*Floor  
Entrance  
Stake*

*Entrance  
Stake*

*305' from  
Ground Floor  
Entrance  
Stake*