



GREENSEA



OPENSEA Edge

INTRODUCING OPENSEA Edge

Bringing true autonomy and
edge computing to the seafloor

Open Architecture

Vehicle Agnostic

Vehicle Perception

Tetherless

Autonomy

Over-the-horizon
Command & Control

Let us show you how OPENSEA Edge can deliver
this capability to your vehicle.

Call 802.434.6080 or visit: Greensea.com/opensea-edge

OPENSEA Edge

OPENSEA Edge is a hardware and software technology framework that provides the computing resources needed to power perception systems and manipulators, and enables advanced autonomous behaviors, allowing for trusted human-on-the-loop autonomy and tetherless command and control over any subsea marine robotic platform.

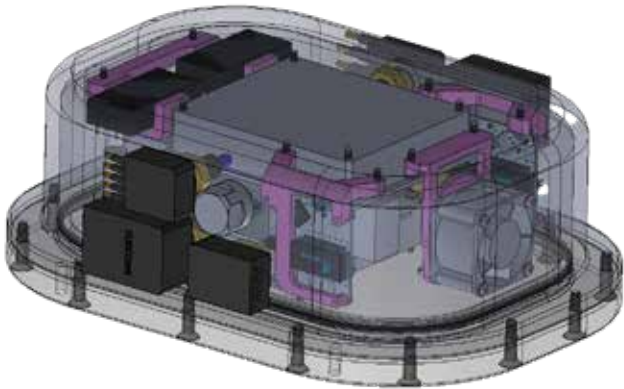

Features

- Platform Agnostic
- Depth Rated 300m
- Dual NVIDIA Xavier AGX Processors
- Gigabit Ethernet backbone
- Load Balancing between processors
- Redundancy – Hardware and software
- Room for other commercial off-the-shelf AI and ML engines.

The OPENSEA Edge system is based on two NVIDIA edge processors and a Gigabit Ethernet network architecture while providing subsea connector interfaces for the robot, video sensors, sonar sensors, navigation sensors, and acoustic communications.

Software Included

*subject to change.

- OPENSEA Platform
- EOD Workspace
- Safe C2

Hardware Specifications

*subject to change.

- Bulkheads Connections qty x 7
- 1x Vacuum/Purge Port
- 1x 9-Pin Low Profile Bulkhead
- Comms & Power to Platform
- 1x 5-Pin Low Profile Bulkhead
- Dedicated Power Connector

Payload Expansion

- 3x 13-Pin Low Profile Bulkhead
- Gigabit Ethernet, Serial, Power
- 2x 9-Pin Low Profile Bulkhead
- 100BaseT Eth, Serial, Power



OPENSEA Edge