

ANIL SAYDAM | INTERIOR DESIGN

E-Mail: asinteriorarchitect@gmail.com

Contact: +90 533 860 70 70

Website: www.anilsaydam.com

Instagram: [saydamdesign](https://www.instagram.com/saydamdesign)

Instagram: [bauformatcyprus](https://www.instagram.com/bauformatcyprus)

BAUFORMAT SHOWROOM

ENTRANCE

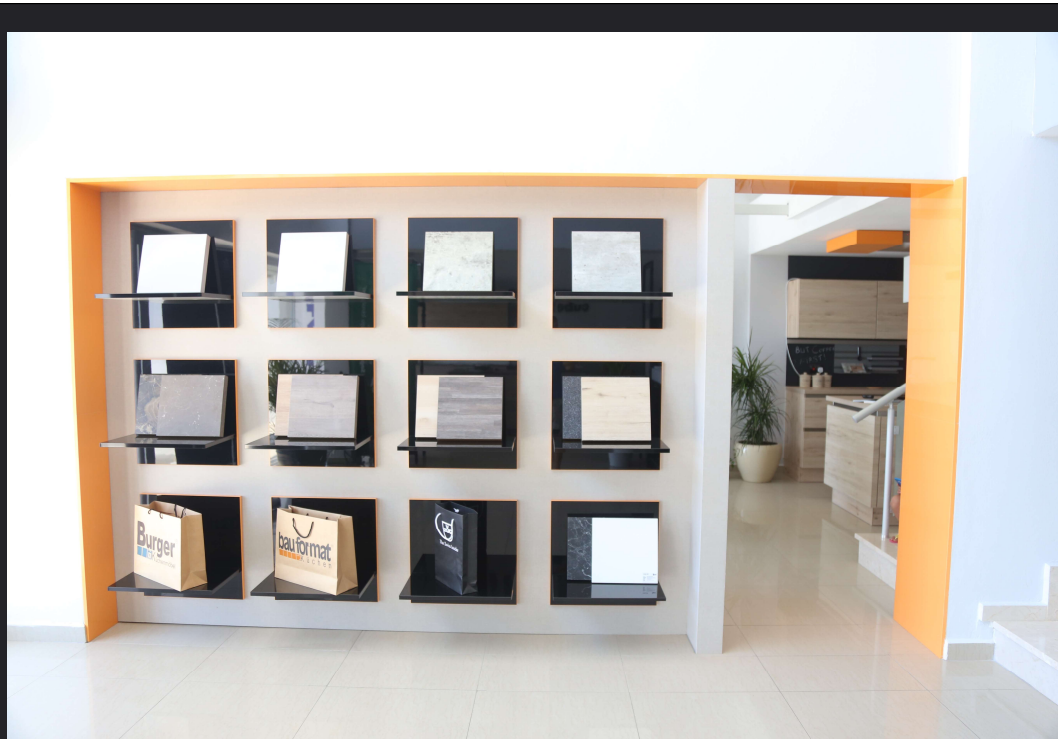

At the entrance; there are symmetrically exhibited shelves on the left wall of the entrance. These shelves contain kitchen cabinet doors and suited countertop materials.



“Cube Fashion” being the self concept of Bauformat is seen in the lightening elements which are also cube-shaped in order to emphasize the concept itself.



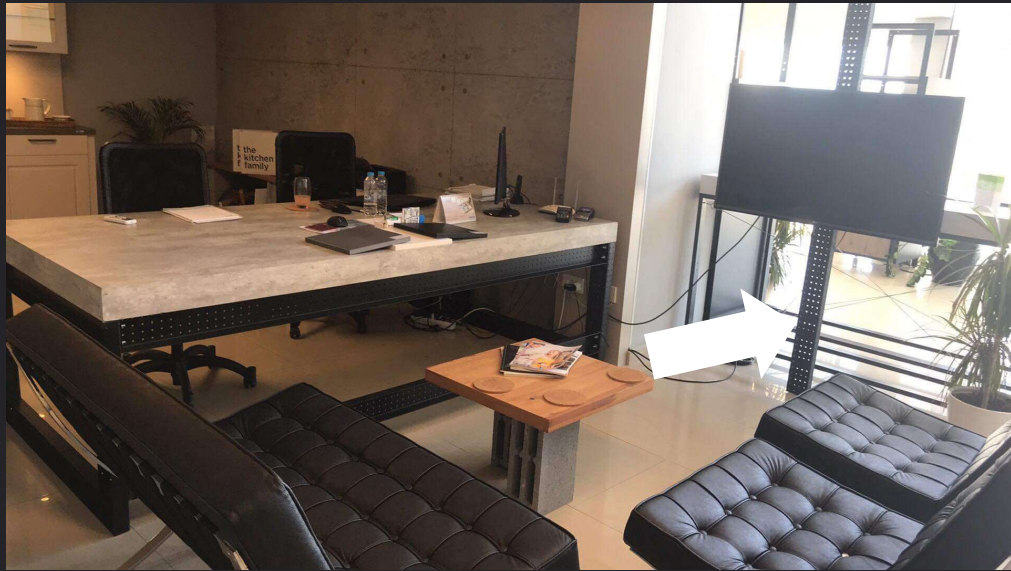

BAUFORMAT SHOWROOM

OPEN OFFICE

With the intention of being included in industrial concept, the legs of the desk, 360-degree rotating television carrier system and lightening suspenders consist of steel lintels. Concept integrity is achieved with the exposed concrete wall as well as exposed concrete-looking laminate countertop.





BAUFORMAT SHOWROOM

KITCHEN 1

Showroom kitchens are designed to appear aesthetically flamboyant from exterior. There are five different kitchens offered to the visitors in the showroom with innovative alternatives which are designed with the concept of uniting industrial and modern lines.

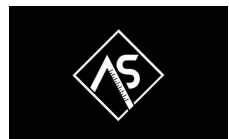
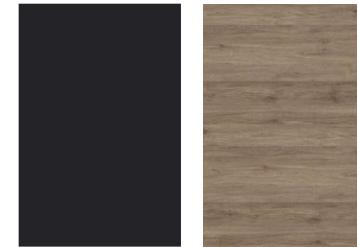
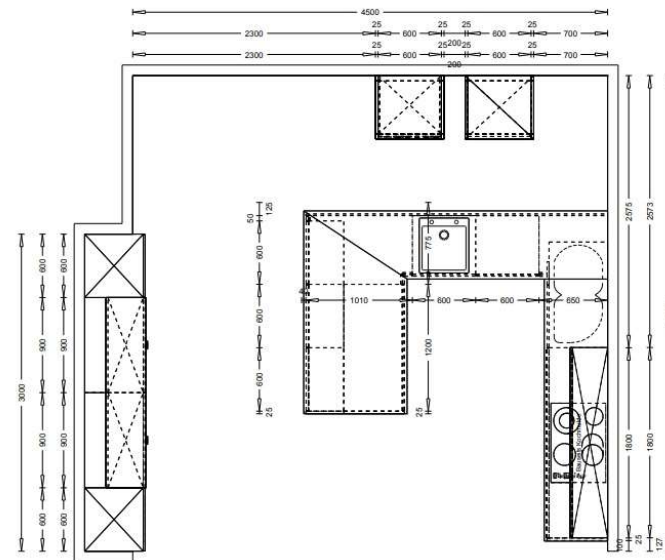



BAUFORMAT SHOWROOM

KITCHEN 2



2780 240

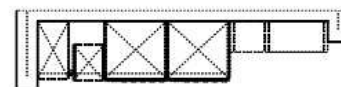

2520 2520

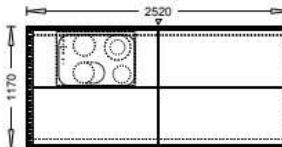

2500

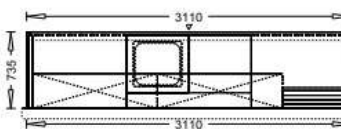

3110 3110 3200

Worktop

Base, Wall And
Tall Units





BAUFORMAT SHOWROOM

KITCHEN 3

This Island type kitchen was designed with Oak materials mostly. Black wall claddings can be used as a blackboard. The island has a breakfast table with Ceramic look material.

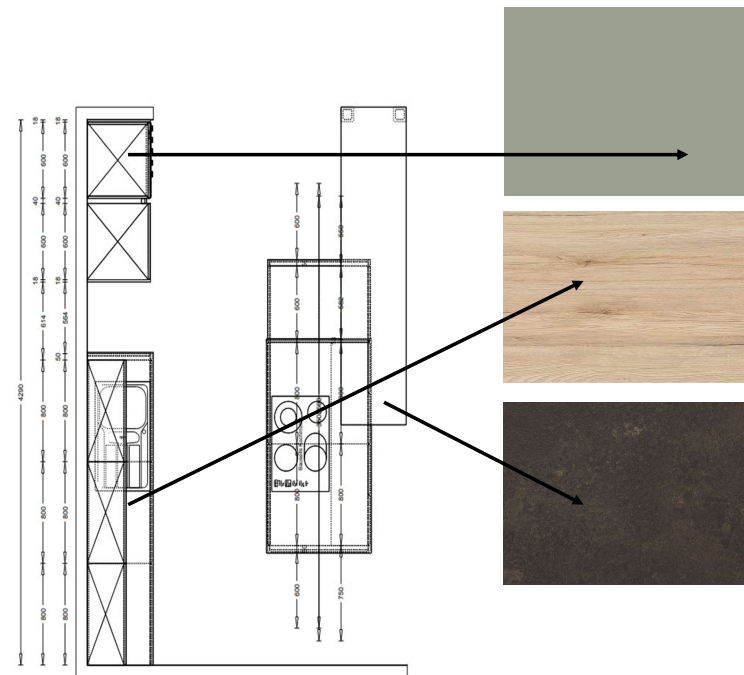



BAUFORMAT SHOWROOM

KITCHEN 4

This country style kitchen was designed with the combination of modern and traditional lines. Fronts are lacquered sand beige and the worktop is Neolith Omega Stone.

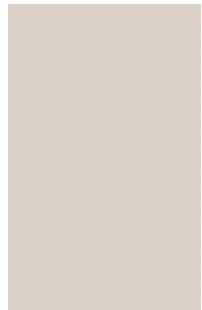
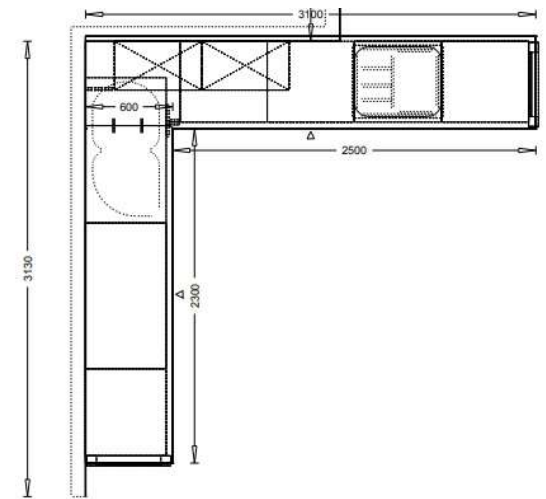



BAUFORMAT SHOWROOM

KITCHEN 5



Neolith Aspen Grey

Base And
Tall Units

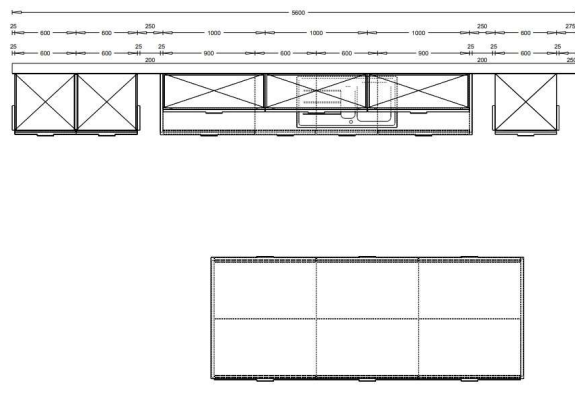

BURGER KÜCHEN

Villa/Famagusta 2018

In this open-plan kitchen, matt anthracite and oak materials were used to harmonize a sense of balance. The wooden material used in the open shelves continued in the wall cabinets ensuring integrity.

The kitchen cabinets were designed as peninsula to work both in the kitchen and dining room sides.

Wide working spaces were provided with the Neolith worktops. For integrity purpose, Neolith material continued on the wall claddings.



Continues...

BURGER KÜCHEN

Villa/Famagusta 2018



Open Shelves
And Wall Units



Base Units
And Tall Units



Worktop

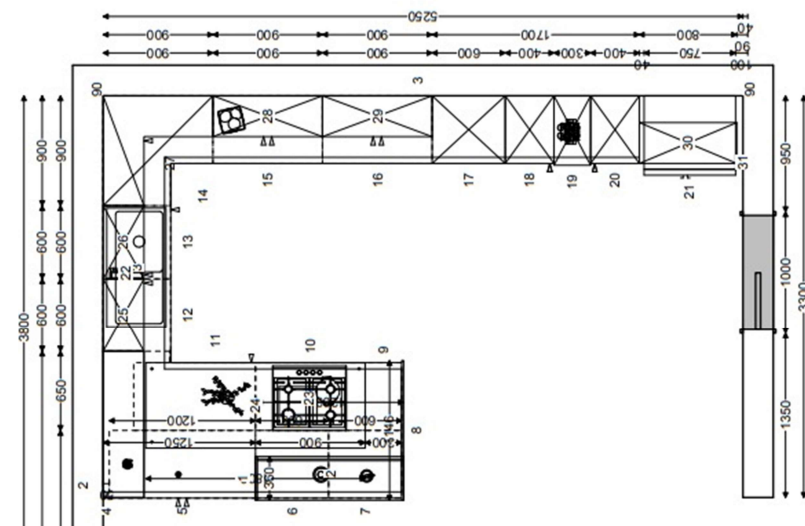

BAUFORMAT KÜCHEN

Loch Manor/Çatalköy Kyrenia 2017

Loch Manor

In the kitchen section of this masonry building, which was built in 1939 by British Architecture, materials were chosen by bearing in mind industrial concept approach. Thus, this modest and elegant kitchen was designed with touch-open doors and capacious worktop.

Kitchen cabinets were completely manufactured by Bauformat Kuchen company in Germany and the installation was completed by the trained team in Cyprus.

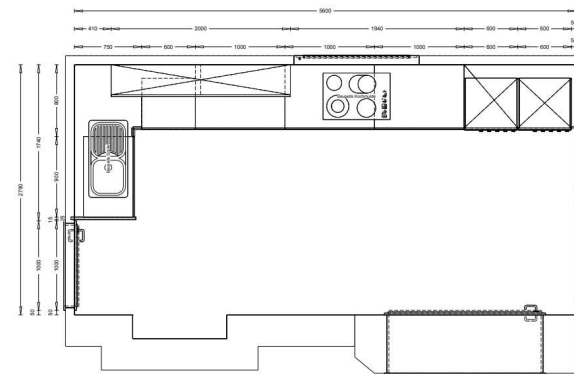

Continues...

BAUFORMAT KÜCHEN

Loch Manor/Çatalköy Kyrenia 2017

WALL UNIT

CONCRETE



BASE AND TALL
UNITS

CHICAGO
FACTORY



WORKTOP

NEOLITH IRON
COPPER



BEFORE



AFTER



BURGER KÜCHEN

Villa/Iskele 2018

In this project, we encountered the problem of insufficiency in storage and worktops. Yet, as the kitchen was an open plan and retained a visual correlation with the living room, further aesthetic and expedient kitchen design was inevitably demanded.

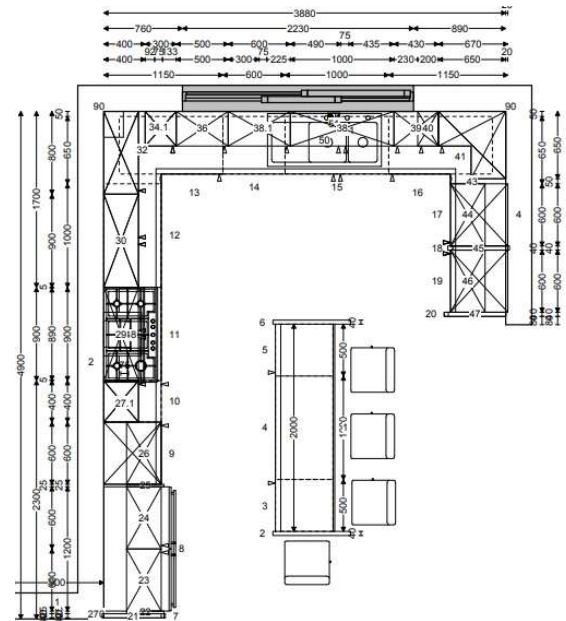

Wall Units

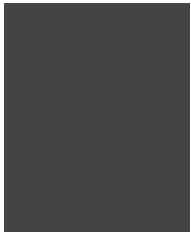

Base And Tall Units



Continues...



BURGER KÜCHEN

Villa/Iskele 2018

Since the kitchen was an open plan concept, wooden materials were preferred as a means of correlating it with the living room, hence cozy and natural atmosphere was supplemented by complementing it with ardent of LED lightings.

While planning the modules depending on the demand, sufficient storage space and vigorous operation of all other functions were taken into consideration. For this reason, while the cabinets were designed to reach the ceiling, an island was added to the center of the kitchen to gain countertops and additional drawer space.





BURGER KÜCHEN

Villa/Famagusta 2019

This open-plan kitchen project was designed simplicity and functionality in mind. The front part of the island works as storage whereas the rear was designed for seating. This kitchen, which was manufactured from Germany in handle-less design, intended to provide untamedness and convenience to the user with its large drawers and wide countertops. Kitchen cabinets materials are High-Gloss Silk and the worktop is quartz stone.

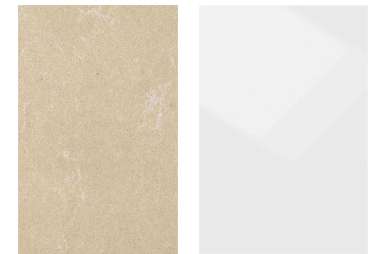
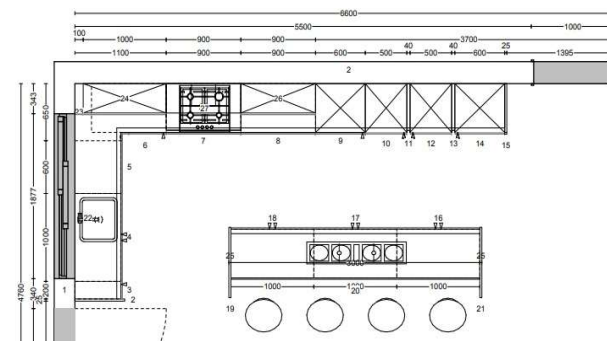



BAUFORMAT KÜCHEN

Levent Homes/20-Villas/Kyrenia 2017

This project was 20 Villas in total. This open-plan kitchen was designed using wooden and matte anthracite materials by considering its natural-look, modernity and convenience. Especially manufactured in Germany, this kitchen proposes functional and aesthetic capacity with the provided spacious drawers and countertops.





BURGER KÜCHEN

DRN Construction 104 Residences/Nicosia 2018

In this 104-residence project, handle-less, White matte lacquered and sage green fronts were used in the kitchens which were designed in peninsula shape. Functional usage areas were created with corner drawers, corner cabinets and wide drawers. The kitchen was completely manufactured in Germany and installed by a professional team in Cyprus.

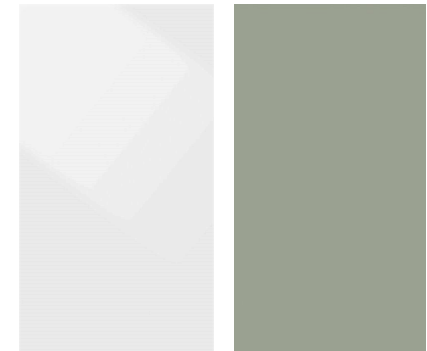
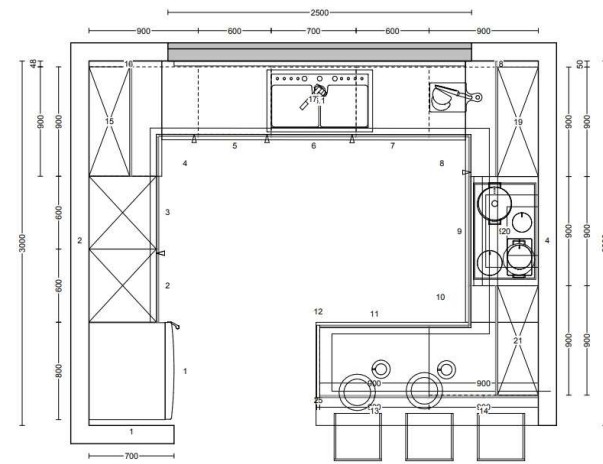

And many more projects...

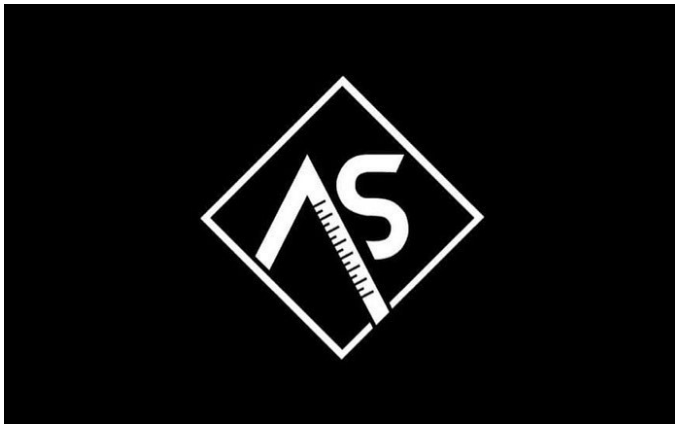

www.anilsaydam.com

ANIL SAYDAM | INTERIOR DESIGN

Anıl Saydam, an interior architect, who focuses on specializing in interior residential projects, aims to provide quality, aesthetic and functional spaces to the user.

It will be an honour to collaborate for the involvement and contribution of such projects.