



**WACKER
NEUSON**
all it takes!



ST27

Track Loader

Small But Fierce

The ST27 offers a compact design, outstanding visibility and operator comfort features that make it a perfect fit for any job. The trim package, low weight and ability to lift heavier loads, compared to similar machines in this class, make it especially productive for smaller job sites. The ST27 is powered by a Kohler turbocharged engine offering high horsepower, superior torque and large fuel capacity to operate longer and get more done. The vertical lift arms allow excellent lift and dump height for maximum efficiency and flexibility on the job site.

Highlights

- Controls for Every Operator
- Maintenance and Filter Free After-treatment
- Expansive Maintenance Access

Technical Data

■ Hydraulic

Flow rate	73.0 l/min
Flow rate max.	109.0 l/min
Auxiliary relief pressure	240.0 bar

■ Mechanical - Output Details

Ground Pressure (standard track)	0.3 bar
Break Out Force Bucket	24,039.0 N
Break Out Force Lift Arm	21,277.0 N
Tractive Effort max. at 100% effective force	33,259.0 N
Bucket Roll Back	2.1 s
Bucket Roll Out	2.2 s
Lift Arm Raise	3.3 s
Lift arm lower	2.8 s
Travel speed stage 1	10.3 km/h
Travel speed stage 2	14.7 km/h

■ Mechanical Details

Overall Length without bucket	2,604.0 mm
Overall Length with Bucket	3,364.0 mm
Overall width without bucket	1,524.0 mm
Overall height to top of ROPS	2,028.0 mm
Bucket Hinge Pin Height	3,046.0 mm
Bucket roll back at ground	30.0 °
Bucket roll back at maximum height	95.0 °

Angle of departure	29.0 °
Bucket dump height at maximum height	3,944.0 mm
Bucket dump angle at maximum height	37.0 °
Operating weight	3,334.0 kg
Track width	320.0 mm
Ground clearance	215.0 mm
Length of Track on Ground	1,350.0 mm
Dump reach at maximum height	994.0 mm

■ Engine

Cooling	Water-cooling
Cylinder	4.0
Oil filling max.	9.5 l
Power rating max.	55.2 KW
Operating Engine speed	2,600.0 1/min
Starter battery Voltage	12.0 V
Manufacturer	Kohler
Engine designation	KDI2504TCR

■ Operating Fluids

Cooling fluid volume	13.0 l
Hydraulic fluid volume	29.0 l
Fuel Tank capacity	103.0 l

■ Chassis

Tip Load	2,540.0 kg
----------	------------

The illustrations, equipment and data shown may deviate from the current delivery program of your country. Optional equipment subject to additional charge may be shown. Subject to changes.

Rated Operating Capacity at 35% Tip 857.0 kg

Load

Dimensions

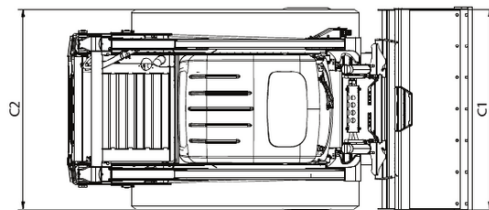
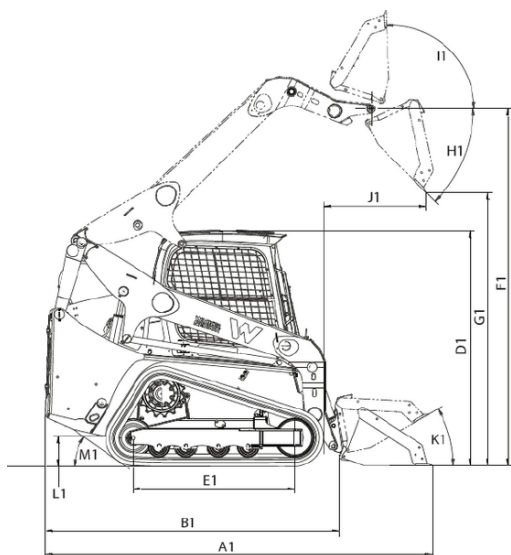

A1	Overall length with bucket	3,364 mm
B1	Overall length without bucket	2,605 mm
C1	Overall width with bucket	1,612.9 mm
C2	Overall width without bucket	1,524 mm
D1	Overall height	2,028 mm
E1	Length of track on ground	1,351 mm
F1	Hinge pin height	3,046.9 mm
G1	Dump height max.	2,395 mm
H1	Dump angle	37 °
I1	Bucket rollback at max. stroke height	95.5 °
J1	Dump reach	994.9 mm
K1	Bucket rollback at ground level	30 °
L1	Ground clearance	216 mm
M1	Angle of departure	29.9 °