



**WACKER
NEUSON**
all it takes!

ST45

Compact Track Loader

Lift Higher, Load More

The ST45 is a large versatile machine. The vertical lift arm makes it perfect for unloading pallets of pavers or stone from trucks and distributing them around the jobsite. The 74hp regeneration-free engine provides easy maintenance and no interruptions to the workday, meaning more up time and greater productivity.

Highlights

- Controls for Every Operator
- Maintenance and Filter Free After-treatment
- Expansive Maintenance Access

Technical Data

Hydraulic

Flow rate	21.9 gal/mi
Flow rate max.	31.7 gal/mi
Auxiliary relief pressure	3,494.5 psi

Mechanical - Output Details

Break Out Force Bucket	6,941.0 lbf
Break Out Force Lift Arm	8,199.9 lbf
Tractive Effort max. at 100% effective force	11,078.6 lbf
Travel speed stage 1	6.4 m/H
Travel speed stage 2	9.6 m/H

Mechanical Details

Overall Length without bucket	117.5 "
Overall Length with Bucket	145.4 "
Overall width without bucket	78.0 "
Overall height to top of ROPS	83.2 "
Bucket Hinge Pin Height	134.8 "
Angle of departure	27.0 °
Bucket dump height at maximum height	107.8 "

Bucket dump angle at maximum height	44.0 °
Operating weight	10,266.9 lb
Ground clearance	8.9 "

Engine

Cooling	Water-cooling
Motor type	Diesel engine
Cylinder	4.0
Cylinder capacity	205.0 Inch3
Operating power	73.8 hp
Operating Engine speed	2,500.0 1/min
Battery capacity (nom. value)	950.0 Ah
Manufacturer	Kohler

Operating Fluids

Fuel Tank capacity	39.9 gal US
--------------------	-------------

Chassis

Tip Load	8,999.3 lb
Rated Operating Capacity at 50% Tip Load	4,499.6 lb
Rated Operating Capacity at 35% Tip Load	3,150.4 lb

Dimensions

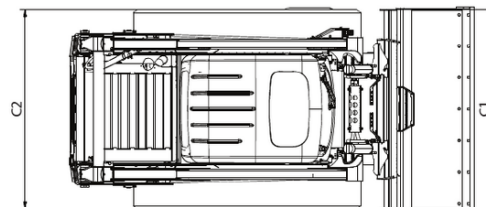
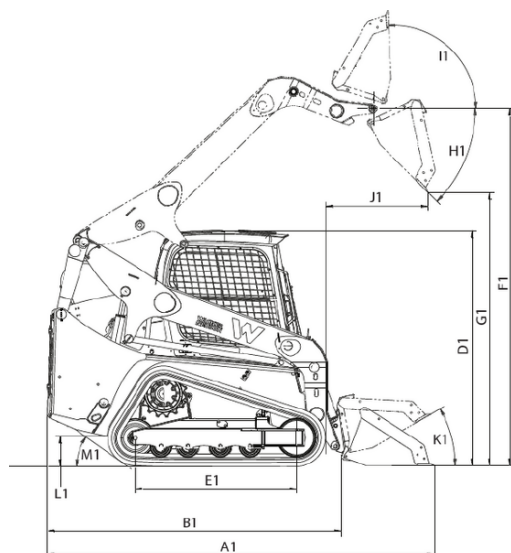

A1	Overall length with bucket	143.9 in
B1	Overall length without bucket	115.8 in
C1	Overall width with bucket	78 in
C2	Overall width without bucket	76 in
D1	Overall height	81.9 in
E1	Wheelbase	63 in
F1	Hinge pin height	135.4 in
G1	Dump height max.	107.1 in
H1	Dump angle	38 °
I1	Bucket rollback at max. stroke height	45.5 °
J1	Dump reach	34.3 in
K1	Bucket rollback at ground level	30.5 °
L1	Ground clearance	9.4 in
M1	Angle of departure	30 °