



EZ50

Tracked Zero Tail Excavator

The compact and powerful zero-tail excavator

Full speed ahead: The EZ50 mini-excavator offers excellent lifting and digging power as well as quick work cycles. Using the newest technologies, the emissions of the mini-excavator were reduced and, at the same time, the efficiency increased. For example, the powerful engine in the EZ50 meets the stage 5 exhaust emission standards. In terms of operator-friendliness, the excavator is impressive. The intuitive operating concept and excellent view of the work area contribute to the easy and comfortable operation of the machine. The EZ50 is also a zero-tail excavator and is well suited for working in narrow spaces.

Highlights

- Flexible cylinder rod protection
- 3-point kinematics
- Active Working Signal (AWS)
- Load Sensing Flow Sharing
- Zero Tail

Technical Data

Hydraulic

| | |
|--------------------|-------------------|
| Operating pressure | 3,552.5 psi |
| hydraulikpump | Axial piston pump |
| Flow rate | 33.3 gal/mi |
| Flow rate max. | 33.3 gal/mi |

Mechanical - Output Details

| | |
|--------------|---------|
| Travel speed | 2.7 m/H |
|--------------|---------|

Mechanical Details

| | |
|------------------------------|------------------------|
| Length | 238.2 " |
| Width | 77.2 " |
| Height | 105.0 " |
| Weight | 10,178.75 lb |
| Operating weight (min.-max.) | 10,685.8 - 12,908.1 lb |
| Digging depth (max.) | 144.4 " |

Engine

| | |
|---------|---------------|
| Cooling | Water-cooling |
|---------|---------------|

| | |
|-------------------------------|---------------|
| Motor type | Diesel engine |
| Cylinder | 3.0 |
| Cylinder capacity | 101.4 Inch3 |
| Inclined position max. | 30.0 ° |
| Fuel type | Diesel EN 590 |
| Effective power | 43.6 hp |
| Nominal Engine speed | 2,000.0 1/min |
| Exhaust-gas limit | EU Stage V |
| Battery capacity (nom. value) | 77.0 Ah |
| Manufacturer | Perkins |
| Engine designation | 403J-E17T |

Environment Data

| | |
|-----------------------------|------------|
| Sound power LWA, guaranteed | 97.0 dB(A) |
|-----------------------------|------------|

Shipping and Storage

| | |
|-----------------|-------------|
| Shipping weight | 10,178.8 lb |
|-----------------|-------------|

Dimensions

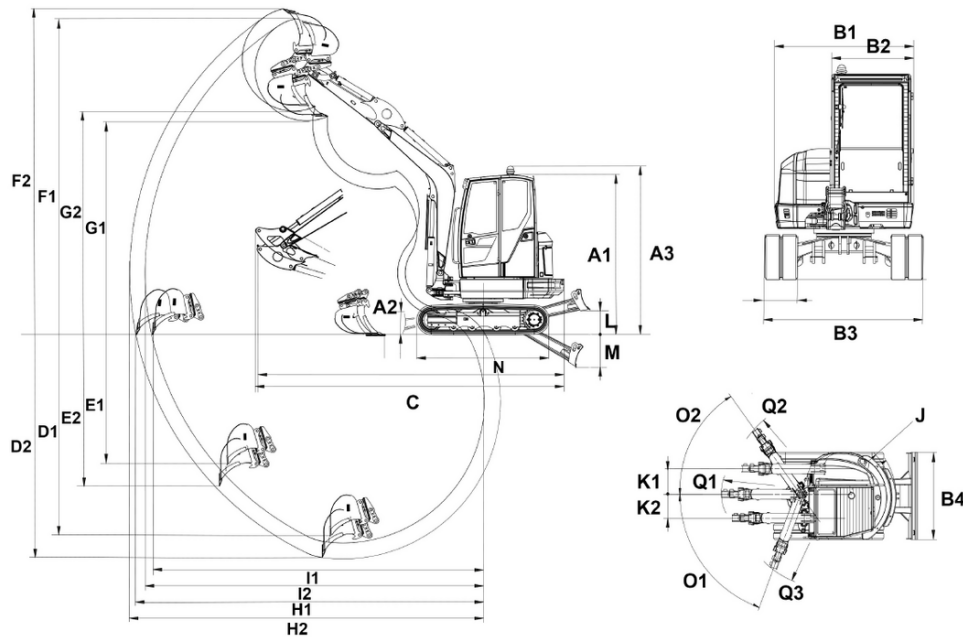

| | | |
|----|---|-----------|
| A1 | Height with cab | 100.67 in |
| A3 | Total height with rotating beacon | 105.08 in |
| B1 | Width of upper carriage | 67.93 in |
| B2 | Width of cab | 38.61 in |
| B3 | Width travel gear | 77.22 in |
| B4 | Width of dozer blade | 77.22 in |
| C | Transport length short shovel arm | 215.4 in |
| | Transport length long shovel arm | 215.99 in |
| D1 | Digging depth max., short shovel arm | 136.6 in |
| D2 | Digging depth max., long shovel arm | 144.48 in |
| E1 | Piercing depth max., short shovel arm | 82.15 in |
| E2 | Piercing depth max., long shovel arm | 89.12 in |
| F1 | Piercing height max., short shovel arm | 215.52 in |
| F2 | Piercing height max., long shovel arm | 220.6 in |
| G1 | Dumping height max., short shovel arm | 144.01 in |
| G2 | Dumping height max., long shovel arm | 149.09 in |
| H1 | Digging radius max., short shovel arm | 233.09 in |
| H2 | Digging radius max., long shovel arm | 242.31 in |
| I1 | Max. reach at ground level (short shovel arm) | 228.28 in |
| I2 | Max. reach at ground level (long shovel arm) | 235.93 in |
| J | Tail swing radius | 41.25 in |
| | Tail swing radius with tail weight | 45.39 in |
| K1 | Boom offset max. (to center of bucket right side) | 30.1 in |
| K2 | Boom offset max. (to center of bucket left side) | 30.34 in |
| L | Stacking height max. (dozer blade above surface) | 16.15 in |
| M | Digging depth max. (dozer blade below surface) | 17.45 in |
| N | Length travel drive | 98.82 in |
| O1 | Max. swivel angle (arm system to the left) | 70 ° |
| O2 | Max. swivel angle (arm system to the right) | 55 ° |
| Q1 | Boom swing radius center | 98.7 in |
| Q2 | Boom swing radius right | 91.76 in |
| Q3 | Boom swing radius left | 81.32 in |
| | Distance bucket dozer blade, short shovel arm | 16.9 in |
| | Distance bucket dozer blade, long shovel arm | 13.12 in |