



Ron Garcia Jr.
(510)862-2445



PRODUCT GUIDE

BUILT STRONG **BACKED BY SERVICE**



U.S. Company Since 1998



DEDICATION TO SERVICE

- MAGNA's experienced and knowledgeable team aims to respond to requests within minutes
- Offering same day shipping on orders received by 2 pm local time
- Long and custom length hoists ship the same or next day as ordered

PREMIUM QUALITY AND DESIGN

- All hoist products load tested to 150% of rated capacity
- Designed for quick and inexpensive repairs
- 18% more robust design than the major competitors
- Lifetime warranty from manufacturer defects

ABOUT MAGNA

MAGNA Lifting Products is a U.S. company that has been successfully providing the North American market with premium level lifting products for over 20 years.

MAGNA's lever, hand chain, and trolley products are manufactured in South Korea with all Korean steel and parts, which allows us to provide our customers with a durable, reliable product at an economical price.

EST.
1998



CONTENTS



02

LEVER HOISTS

CAPACITIES UP TO 15 TON

Heavy duty rated design for vertical or horizontal lifting applications.

02



04

HAND CHAIN HOISTS

CAPACITIES UP TO 50 TON

Heavy duty rated design for vertical lifting applications.

04

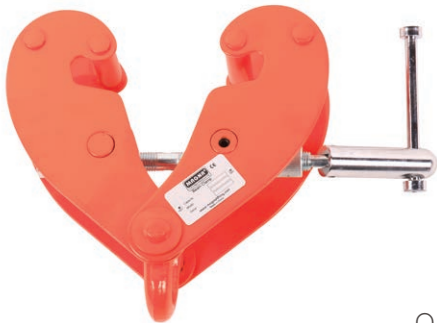

08

BEAM CLAMPS

CAPACITIES UP TO 20 TON

Options for above or below the hook.

08



10

TROLLEYS

CAPACITIES UP TO 20 TON

Heavy duty rated design available in geared and non-geared versions for operation on a wide range of beam sizes.

10



11

WIRE ROPE PULLERS

CAPACITIES UP TO 3 TON

Compact and light weight design for use with any length wire rope.

11

LEVER HOISTS

PRODUCT DETAILS

- Manufactured in South Korea
- Completely repairable with easy access design
- Load tested to 150% of rated capacity
- Meets all applicable ANSI/ASME standards
- Single-hand control of free-chain function
- Weston Style Load Break
- Low temperature grease functions to -45°C (-49°F)

STANDARD LENGTHS:

5', 10', 15', 20' Long length and custom lengths available

MODEL	LH025	LH050	LH075	LH100	LH150	LH150C	LH200	LH300	LH600	LH750	LH900	LH1200	LH1500
SIZE (TONS)†	1/4	1/2	3/4	1	1 1/2	1 1/2	2	3	6	7 1/2	9	12	15
CAPACITY (LBS)	550	1,100	1,650	2,200	3,300	3,300	4,400	6,600	13,200	16,500	19,800	26,400	33,000
LOAD CHAIN (MM)	4.0 x 12.0	5.0 x 15.0	6.3 x 19.1	6.3 x 19.1	7.1 x 21.0	7.1 x 21.0	7.1 x 21.0*	9.0 x 27.0*	9.0 x 27.0*	9.0 x 27.0*	9.0 x 27.0*	9.0 x 27.0*	9.0 x 27.0*
NET WEIGHT (LBS)**	4.5	7.9	15.6	16.3	22.0	21.0	23.0	36.1	60.6	92.5	106.0	119.0	283.0
MINIMUM LOAD (LBS)	66	66	66	66	99	99	99	198	396	496	595	794	990
PULL TO LIFT CAPACITY (LBS)	55	93	59	59	63	84	63	81	83	85	88	93	93
SIDE WIDTH A (IN)	3.90	4.17	6.18	6.18	6.89	6.89	6.89	7.80	7.80	7.80	7.80	7.80	7.80
WIDTH B (IN)	2.36	3.54	5.98	5.98	5.70	5.70	5.70	7.48	7.80	7.80	7.80	12.60	22.00
HEADROOM C (IN)	9.65	11.40	11.02	11.02	13.00	13.00	13.00	17.72	21.65	25.98	27.17	27.17	31.50
HANDLE LENGTH D (IN)	5.90	8.86	11.02	11.02	15.35	11.02	15.35	15.35	15.35	15.35	15.35	15.35	15.40
HOOK OPENING G (IN)	0.63	0.86	1.06	1.06	1.30	1.30	1.30	1.53	1.81	1.81	2.20	2.20	3.10

*Grade 100 Chain **With 5ft Lift †Metric ton rated
Note: "C" in part number stands for compact version

1/4 TON // LH025



1/2 TON // LH050*



3/4 TON // LH075*



1 TON // LH100*



1 1/2 TON // LH150*



1 1/2 TON COMPACT // LH150C*



2 TON // LH200*



3 TON // LH300*



6 TON // LH600*



7 1/2 TON // LH750*

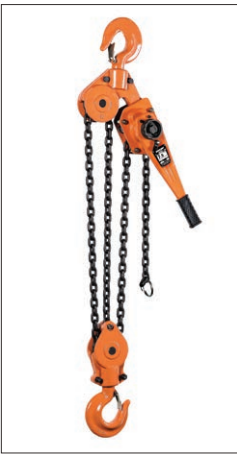

9 TON // LH900*



12 TON // LH1200*



UP TO 3 TONS

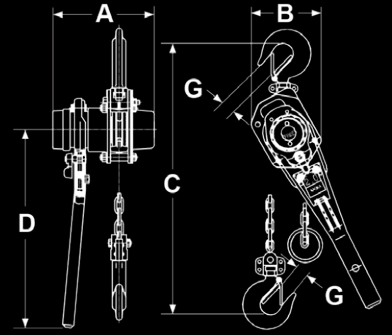

6 TONS

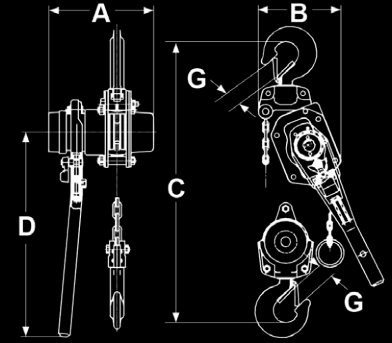

7.5 TONS AND ABOVE

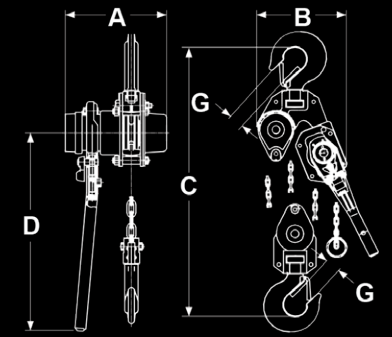

ACCESSORIES

OVERLOAD INDICATOR HANDLE

Handle will bend and show a red indicator when overloaded. Designed to be bent back to the original position and reused.

SHIPYARD HOOK

Flat tipped hook to mitigate tip or point loading.

SELF-LOCKING HOOK

Positive locking latch designed not to open during load.

ELECTRO GALVANIZED CHAIN

Suitable to withstand corrosive environments.

CHAIN

Available with U.S.A. manufactured grade 100 load chain.

HAND CHAIN HOISTS

PRODUCT DETAILS

- Manufactured in South Korea
- Completely repairable with easy access design
- Load tested to 150% of rated capacity
- Meets all applicable ANSI/ASME standards
- Low temperature grease functions to -45°C (-49°F)

STANDARD LENGTHS:

10', 15', 20' *Long length and custom lengths available*

MODEL	CH050	CH100	CH150	CH200	CH300	CH300SF	CH500	CH750	CH1000	CH1500	CH2000
SIZE (TONS)†	1/2	1	1 1/2	2	3	3	5	7 1/2	10	15	20
CAPACITY (LBS)	1,100	2,200	3,300	4,400	6,600	6,600	11,000	16,500	22,000	33,000	44,000
LOAD CHAIN (MM)	6.3 x 19.1	6.3 x 19.1	7.1 x 21.0	7.9 x 23.0	7.1 x 21.0	9.0 x 27.0	9.0 x 27.0	9.0 x 27.0	9.0 x 27.0	9.0 x 27.0	9.0 x 27.0
HAND CHAIN (MM)	5.0 x 22.5	5.0 x 22.5	5.0 x 22.5	5.0 x 23.4	5.0 x 22.5	5.0 x 23.4	5.0 x 23.4	5.0 x 23.4	5.0 x 23.4	5.0 x 23.4	5.0 x 23.4
NET WEIGHT (LBS)*	25.0	26.0	31.0	43.0	49.0	57.0	86.0	119.0	152.0	317.0	403.0
NUMBER OF FALLS	1	1	1	1	2	1	2	3	4	6	8
HAND CHAIN OVERHAUL FOR 1 FT LIFT (FT)	40.3	40.3	54.4	84.3	108.8	93.5	187.0	285.4	374.0	285.4	374.0
PULL TO LIFT CAPACITY (LBS)	53	73	75	75	77	79	86	90	90	90x2**	90x2**
SIDE WIDTH A (IN)	5.79	5.79	5.79	7.05	5.79	7.05	7.05	7.05	7.05	8.15	8.15
WIDTH B (IN)	6.06	6.06	6.85	8.03	8.11	10.35	10.35	14.17	14.45	29.68	34.37
HEADROOM C (IN)	12.40	12.40	13.39	16.54	18.70	25.00	25.00	27.56	29.92	33.46	34.25
HOOK OPENING D (IN)	1.06	1.18	1.34	1.46	1.69	1.69	1.81	1.81	2.36	3.11	3.54

*With 10 ft lift **2 Hand Chain Falls †Metric ton rated

1/2 TON // CH050*



1 TON // CH100*

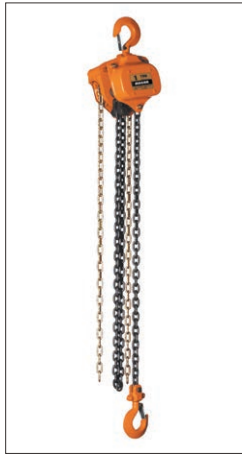

1 1/2 TON // CH150*



2 TON // CH200



3 TON // CH300*



3 TON SINGLE FALL // CH300SF*



5 TON // CH500*



7 1/2 TON // CH750*



10 TON // CH1000*



15 TON // CH1500*



20 TON // CH2000*



*AVAILABLE WITH U.S.A. MANUFACTURED GRADE 100 LOAD CHAIN



UP TO 2 TONS AND 3 TON SF

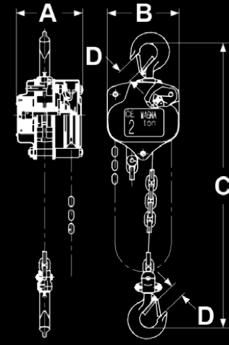

3 AND 5 TONS

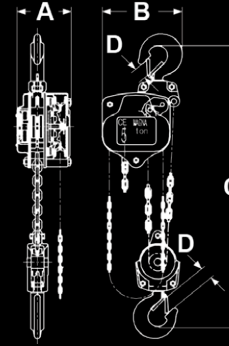

7.5 TONS AND ABOVE

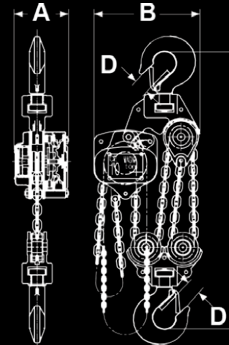

ACCESSORIES

OVERLOAD SLIP CLUTCH

Prevents the hoist from being used to lift loads beyond the rated capacity.

SELF-LOCKING HOOK

Positive locking latch designed not to open under load.

LUG MOUNT FOR LOW HEADROOM

Lug mounting to tuck the hoist up to the anchoring device and reduce total headroom.

ELECTRO GALVANIZED CHAIN

Suitable to withstand corrosive environments.

CHAIN BAG

Contains loose chain to protect equipment and increase safety.

LEVER HOIST HIGHLIGHTS

Steel grip ring for **increased durability**

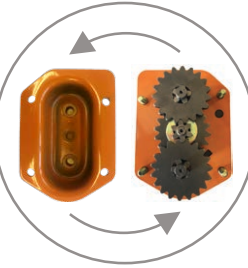

Central bushing that fixes the axis of rotation of the pinion shaft to create a **smoother and stronger overall operation**



Machined and case hardened ratchet gear with deep-cut teeth for **increased strength and durability**



Single-hand control of free-chain function for **easy and quick operation**

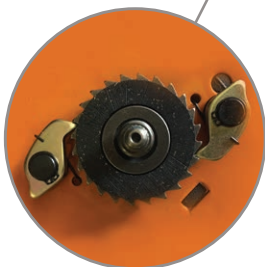

Two pawl gear engagement for **increased safety and power**



Long length rubber grip with stamped ribs to accommodate **diverse sizes** of hands and application environments



Robust, drop forged alloy steel hooks with wide throat openings for **durability and versatility**

SIMPLICITY

Minimal number of parts to allow for simple and inexpensive repairs.

LOAD TESTING

Load tested to 150% of rated capacity.

CHAIN HOIST HIGHLIGHTS



Stamped steel casing for **reduced weight** and with high-strength hardware for **increased durability**



Considerably large brake surface area for **increased performance**

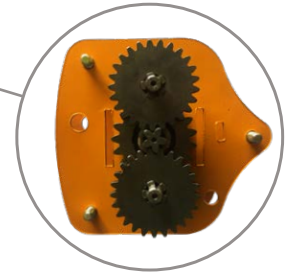

Machined and case hardened gears with deep-cut teeth for **increased strength and durability**



Spring and anchor system designed to facilitate easy hoist repairs and modifications



Robust, drop forged alloy steel hooks with wide throat openings for **durability and versatility**

SIMPLICITY

Minimal number of parts to allow for simple and inexpensive repairs.

LOAD TESTING

Load tested to 150% of rated capacity.

BEAM CLAMPS

PRODUCT DETAILS

- Designed for use above the hook as an anchor point
- Load tested to 125% of rated capacity
- Meets all applicable ANSI/ASME standards
- Easy installation and adjustable design
- Threaded screw locks in place for additional safety

ROUND EYE

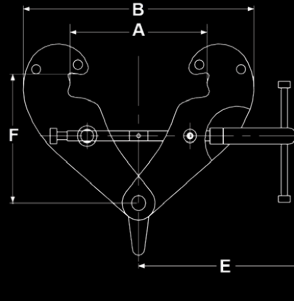

PIN TYPE

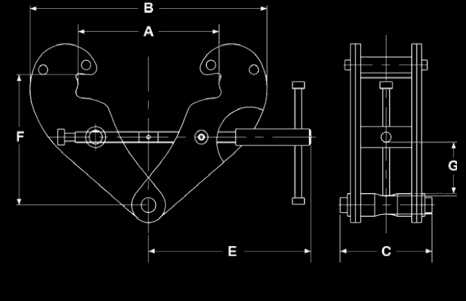

MODEL	PIN TYPE	BC100P	BC200P	BC300P	BC500P	BC1000P	
	ROUND EYE TYPE	BC100RE	BC200RE	BC300RE	BC500RE	BC1000RE	
SIZE (TONS)†		1	2	3	5	10	
RATED CAPACITY (LBS)		2,200	4,400	6,600	11,000	22,000	
I-BEAM WIDTH RANGE (IN)		3.1-9.7	3.1-9.7	3.5-13.0	3.5-13.0	3.5-13.4	
INCHES	B	A max	10.6	10.6	14.0	14.0	14.3
		min	7.2	7.2	9.6	9.6	10.6
		max	14.6	14.6	19.7	19.7	20.5
	C		3.7	3.7	5.2	5.6	7.1
	E	Pin Type	7.8	7.8	10.4	10.4	11.2
		Round Eye Type	8.6	8.6	10.9	10.9	11.9
	F	min	3.9	3.9	5.8	5.8	6.5
		max	6.1	6.1	8.6	8.3	9.4
	G	Pin Type	1.0	1.0	2.0	1.9	2.0
		Round Eye Type	1.7	1.7	2.4	2.4	3.6
NET WEIGHT (LBS)	Pin Type	8	8	21	24	35	
	Round Eye Type	9	11	22	26	37	

PIN TYPE

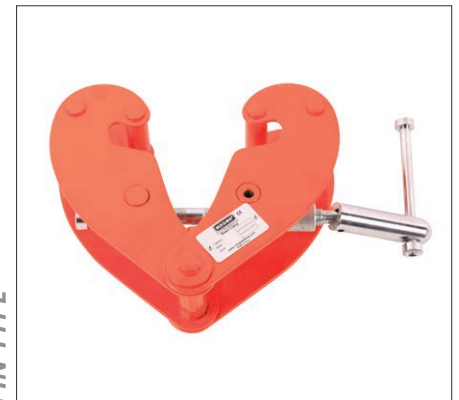

ROUND EYE TYPE

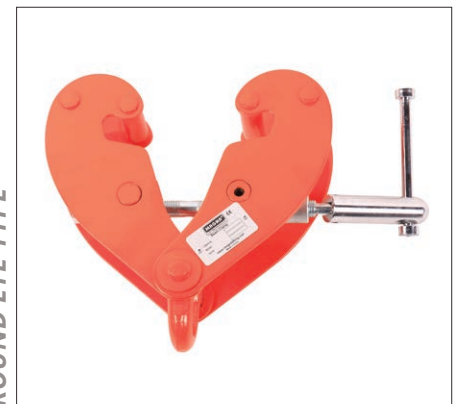

UNIVERSAL LIFTING BEAM CLAMPS

PRODUCT DETAILS

- Designed for use below or above the hook
- Load tested to 150% of rated capacity
- Meets all applicable ANSI/ASME standards
- Easy installation with adjustability

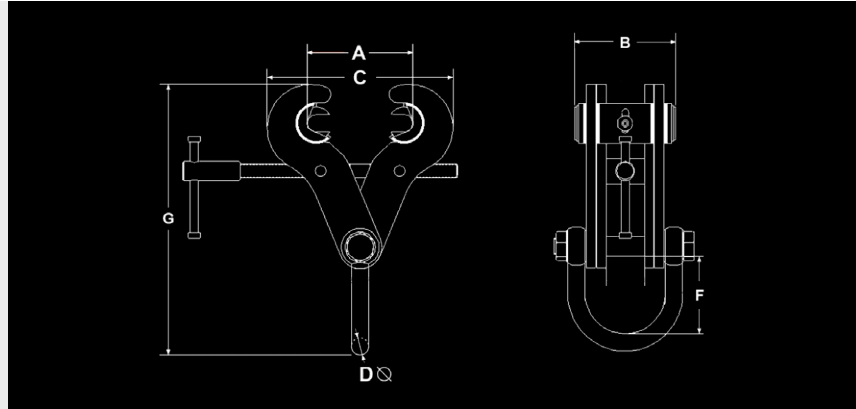

SWIVEL JAW

MODEL		ULBC300S	ULBC500S	ULBC1000S
CAPACITY (LBS)		6,600	11,000	22,000
SIZE (TONS)		3	5	10
FLANGE WIDTH RANGE (IN)	A	3.5-12.0	3.5-12.0	3.5-12.0
NET WEIGHT (LBS)		22.0	34.1	48.4
DIMENSIONS (IN)	B	5.7	5.7	5.7
	C (MAX)	16.5	16.5	16.8
	D	0.8	1.0	1.3
	F	3.9	4.5	4.2
	G (MIN)	12.7	13.6	14.0

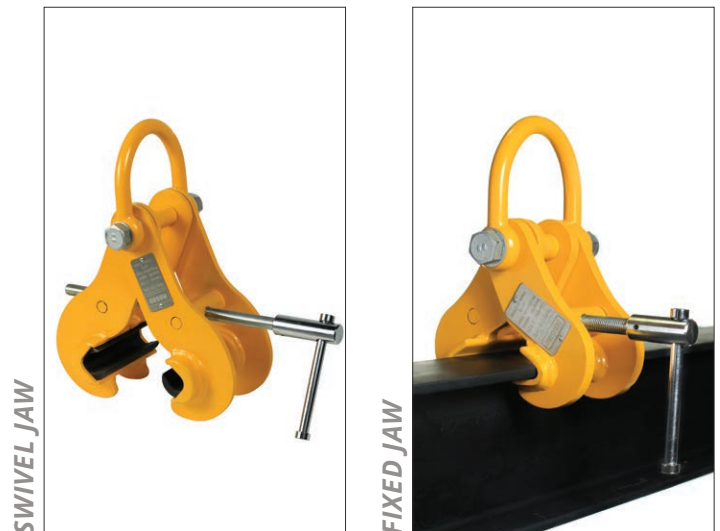

FIXED JAW

MODEL		ULBC300F	ULBC300FW	ULBC500F	ULBC500FW	ULBC1000F	ULBC1500F	ULBC1500FW	ULBC2000FW
CAPACITY (LBS)		6,600	6,600	11,000	11,000	22,000	33,000	33,000	44,000
SIZE (TONS)		3	3	5	5	10	15	15	20
FLANGE WIDTH RANGE (IN)	A	3.0-7.5	5.0-13.75	3.0-7.5	6.0-12.0	8.0-18.0	8.0-18.0	16.0-24.0	16.0-24.0
NET WEIGHT (LBS)		17.6	25.3	22.0	33.0	61.6	103.4	116.2	209.0
DIMENSIONS (IN)	B	5.1	5.1	5.1	5.5	5.5	6.9	6.9	13.8
	C (MAX)	10.7	17.1	13.4	17.7	23.6	26.8	32.9	25.2
	D	0.8	0.8	1.0	1.0	1.3	1.6	1.6	2.2
	F	3.3	3.3	3.9	3.9	3.9	7.3	7.3	5.3
	G (MIN)	10.0	11.7	13.0	12.6	16.5	21.9	25.0	24.0

W=extra wide model

TROLLEYS

PRODUCT DETAILS

- Manufactured in South Korea
- Load tested to 150% of rated capacity
- Meets all applicable ANSI/ASME standards
- Anti-drop lugs included
- Sealed ball-bearing wheels

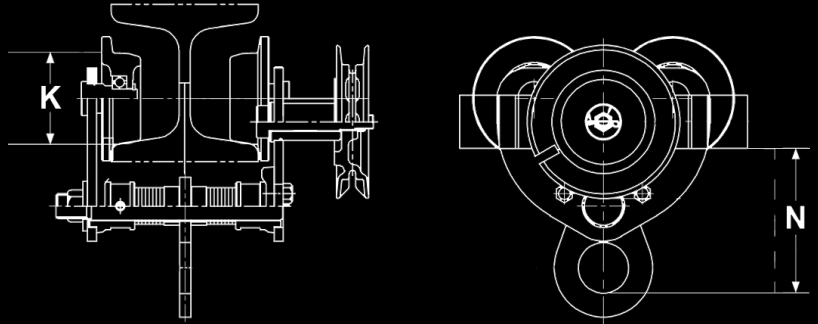

PLAIN TROLLEY

MODEL	PTR050	PTR100	PTR200	PTR300	PTR500	PTR750*	PTR1000*	PTR1500*	PTR2000*
SIZE (TONS)†	1/2	1	2	3	5	7 1/2	10	15	20
CAPACITY (LBS)	1,100	2,200	4,400	6,600	11,000	16,500	22,000	33,000	44,000
FITS FLANGE WIDTH (IN)**	3-8	3-8	4-8	4-8	5-8	5-8	5-8	6 - 12	6 - 12
MIN RADIUS CURVE (IN)	48	56	67	83	114	122	122	141	157
HEADROOM N (IN)	5.1	5.3	6.9	7.8	9.2	11.3	11.3	14.8	18.1
NET WEIGHT (LBS)	17	26	44	68	106	150	161	331	593

GEARED TROLLEY

MODEL	GTR100	GTR200	GTR300	GTR500	GTR750*	GTR1000*	GTR1500*	GTR2000*
SIZE (TONS)†	1	2	3	5	7.5	10	15	20
CAPACITY (LBS)	2,200	4,400	6,600	11,000	16,500	22,000	33,000	44,000
FITS FLANGE WIDTH (IN)**	3-8	4-8	4-8	5-8	5-8	5-8	6 - 12	6 - 12
MIN RADIUS CURVE (IN)	56	67	83	114	122	122	141	157
HEADROOM N (IN)	5.3	6.9	7.8	9.2	11.3	11.3	14.8	18.1
NET WEIGHT (LBS)	37	56	79	117	161	172	353	617

Standard hand chain drop length of 10'

*Two pin design **Wider flange versions available
†Metric ton rated

PLAIN TROLLEY



GEARED TROLLEY



LUG MOUNTING



Lug hoist mount for hand chain hoists to minimize total headroom

WIRE ROPE PULLERS

PRODUCT DETAILS

- Load tested to 125% of rated capacity
- Meets all applicable ANSI/ASME standards
- Can be operated in any position or direction

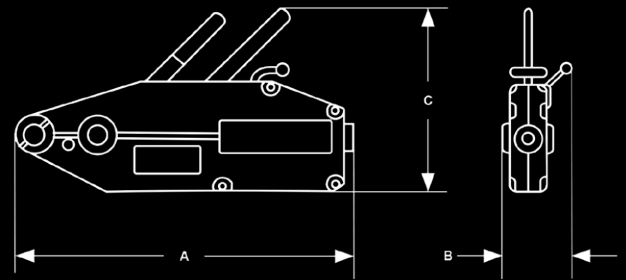

ACCESSORIES

WIRE ROPE: Standard lengths of 33' and 65' (custom lengths available)

MODEL	WRP075C	WRP150C	WRP300C
SIZE (TONS)†	3/4	1 1/2	3
LIFTING CAPACITY (LBS)	1,760	3,525	7,050
ROPE ADVANCE PER FULL STROKE (IN)	2.0	2.2	1.1
ROPE DIAMETER (IN)	5/16	7/16	5/8
STANDARD WIRE ROPE LENGTH (FT)	33 & 65	33 & 65	33 & 65
NET WEIGHT (LBS) (W/HANDLE)	17	34	59
HANDLE LENGTH (IN)	31.5	47.5	47.5
PULLING EFFORT AT RATED CAPACITY (LBS)	77	99	99
A (IN)	20.5	25.5	31.0
B (IN)	2.5	2.8	3.6
C (IN)	9.3	10.8	12.8

†Metric ton rated



3/4 TON // WCP075C



WIRE ROPE*

* Wire rope not included standard, available per request

ENTERTAINMENT INDUSTRY PRODUCTS

Black Powder Coated Finish

BEAM CLAMPS

- 1 ton capacity
- Round eye or pin style



CHAIN FALLS

- 1 ton capacity
- Black colored load & hand chains
- Chain bag optional



CUSTOM HOISTS

12 TON // LH1200

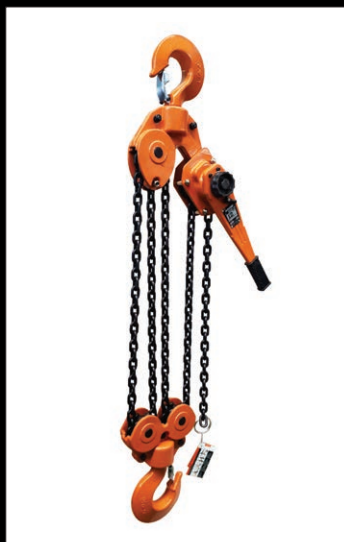

20 TON // CH2000

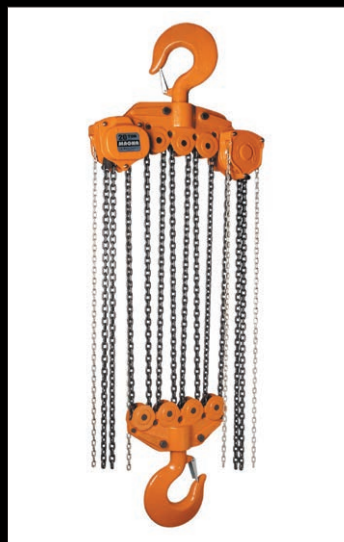

Full range of high-capacity lever and chain hoists. *Hand chain hoists available up to 50 ton and lever hoists available up to 15 ton.*

Custom length hoists, made per foot, readily available. *Includes load chain and hand chain.*

Long lift length hoists readily available. *No maximum length.*

OPTIONS & ACCESSORIES



SHIPYARD HOOK

Flat tipped hook to mitigate tip or point loading

Available for lever hoists of 1 1/2 and 3 ton capacity



SELF-LOCKING HOOK

Positive locking latch designed not to open under load

Available for lever hoist capacities of 3/4, 1, 1 1/2, and 3 ton and for hand chain hoist capacities of 1 1/2 ton



OVERLOAD SLIP CLUTCH

Available for hand chain hoists to prevent the hoist from being used to lift loads beyond the rated capacity



CHAIN BAG

Nylon chain bags to organize chain and provide a cleaner look.

Available for hand chain hoists up to 5 ton capacity.



OVERLOAD INDICATOR HANDLE

For lever hoists to indicate an overloading beyond the rated capacity

Handle is designed to be snapped back into standard operating position and reused after load is reduced to below rated capacity



U.S.A. LOAD CHAIN

U.S.A. manufactured, grade 100 load chain available for a majority of hoist models

REPAIR PARTS

Repair/Replacement parts available quickly and affordably.

ELECTRO GALVANIZED LOAD CHAIN

For applications which require a more corrosive resistant chain

HIGH CAPACITY HOISTS AND TROLLEYS

Lever hoists, chain hoists, and trolleys available at capacities up to 50 ton

www.magnalifting.com

1140 Yew Ave.
Blaine, WA 98230

Tel: 360.392.0432

Toll Free: 1.888.48.MAGNA

Fax: 360.464.2544

Email: sales@magnalifting.com

V2. Rev. 02

