



# Residential Air-Conditioning (RAC)

Prepared by Training and Activation Division

Speaker:

# Overview

- Introduction to Air Conditioner
- Product Features
- Unique Selling Points (USP)
- Pricing & CareShip
- Specification
- Products Comparison







How do you  
choose the right  
air conditioner for  
your home?



No of People



Size of Room



Energy Efficiency



Capacity



The Number and Size of Windows



## Key Features

DUAL Inverter Compressor™

Plasmaster™ Ionizer++

Allergy Filter

LG ThinQ



- Product Features: DUAL Inverter Compressor™



# 5 Benefits of DUAL Inverter Compressor™

- Energy Efficiency
- Faster Cooling and Heating
- Quiet Operation
- Improved Durability
- Reduced Vibration

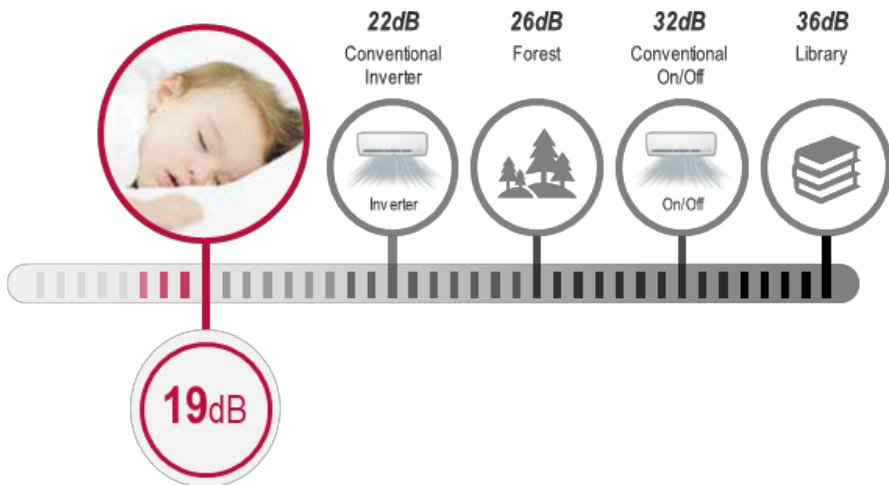

## Dual Inverter Compressor™

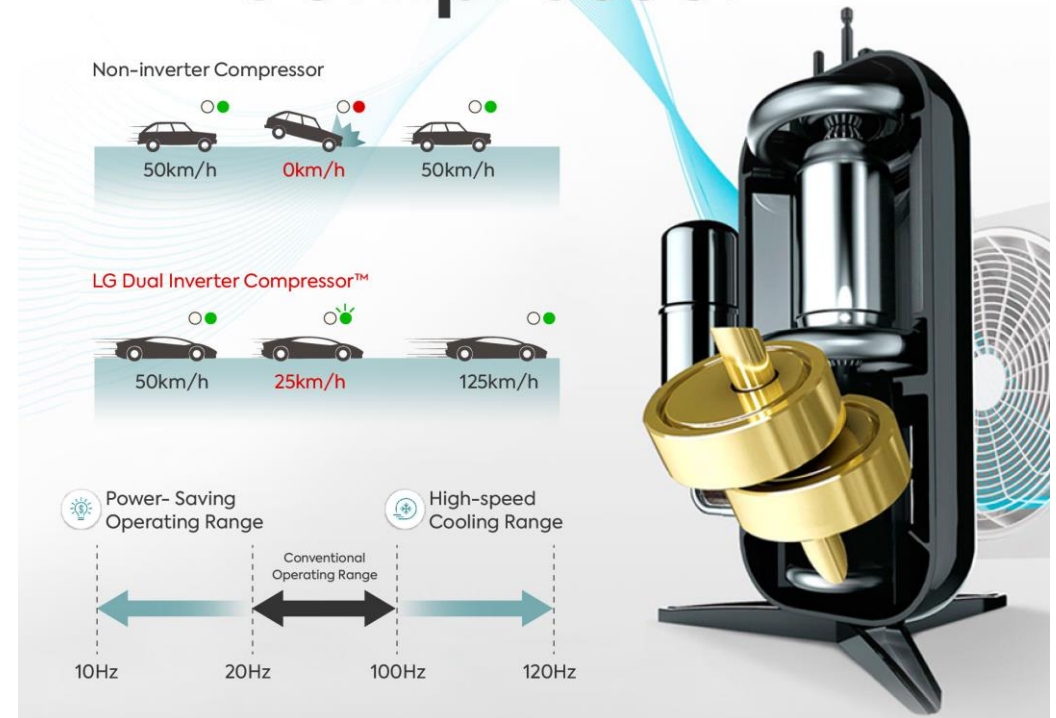

LG inverter air conditioners saves up to 70% more energy and 40% more faster cooling than LG non-inverter air conditioners.

■ Product Features: DUAL Inverter Compressor™



Active Energy Control

The active energy control allows you to adjust the energy consumption depending on the situation.

Limit of Power Consumption				
Step of AEC	1HP (S3-Q09JAPPA)	1.5HP (S3-Q12JAPPA)	2HP (S3-Q18KLPPA)	2.5HP (S3-Q24K2PPA)
Normal (100%)	770 W	1,030 W	1,540 W	1,850 W
Step 1 (80%)	620 W	830 W	1,240 W	1,480 W
Step 2 (60%)	470 W	620 W	930 W	1,110 W
Step 3 (40%)	310 W	420 W	620 W	740 W

Customers can select the “Energy Control” Step appropriate for the situation for saving unnecessary energy.



LG DUALCOOL ThinQ™

- Product Features: Plasmaster™ Ionizer++

LG PuriCare™



## Sterilizes Up to 99.9% Bacteria & Deodorizes

The powerful Plasmaster™ Ionizer++ protects you from bad odors and harmful and contagious particles in the air with over 8 million ions to sterilize not only the air passing through the air conditioner, but also surrounding surfaces for a safer, and cleaner environment.

## ■ Product Features: Filters



### Reduce Allergens for Healthier Air

Remove allergy-causing substances, such as house dust mites, floating in the air.

- \*Replacement every 6 months
- \*Allergy & HAF (Fine Dust) Filters



- Product Features: LG ThinQ

LG PuriCare™

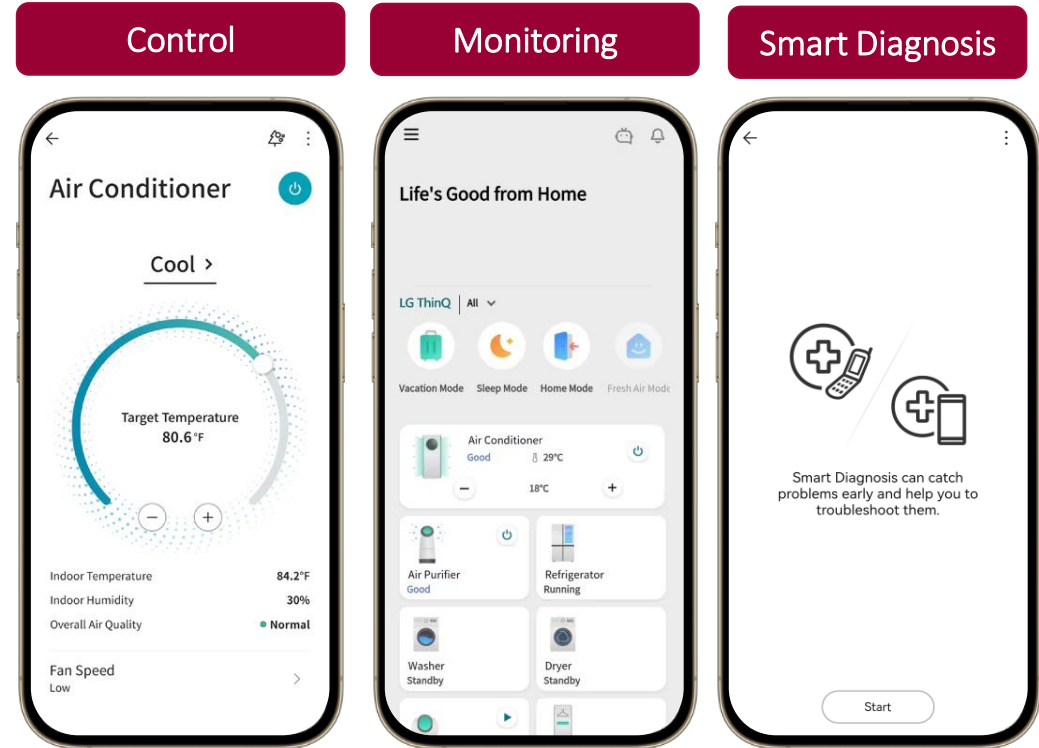

## Smart Control at Your Fingertips

Access your air conditioner anytime and from anywhere with a Wi-Fi equipped device and LG's exclusive control app, LG ThinQ™.

## LG Dual Inverter Premium Air Conditioner

### More Features



Auto Cleaning



AirCare Complete System



Design



Sleep Mode



R32

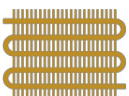

Gold Fin Compressor



4 Way Air Flow



- Unique Selling Points (USP)



DUAL Inverter  
Compressor™

Allergy Filter



Plasmaster™  
Ionizer++

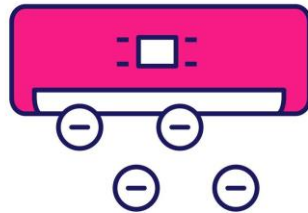

LG ThinQ



## ■ Pricing & CareShip



**Step 1**

### Checking

- Function Check by SDS (Smart Diagnosis by App)
- Leakage and Noise Check



**Step 2**

### Dis Assemble

- Disassemble the unit



**Step 3 (A)**



**Step 3 (B)**

### Wash / Hygiene

- Wash: High pressure with detergent
- Hygiene: UV, Steamer & Dryer (

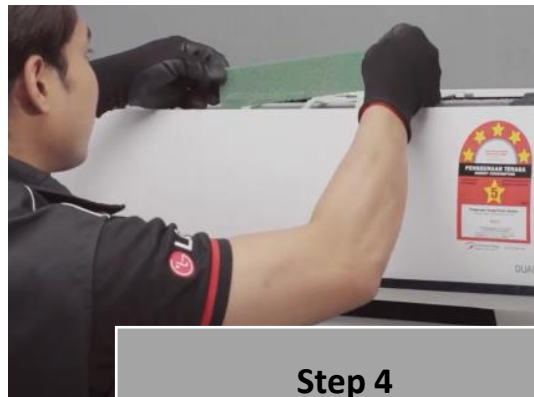

**Step 4**

### Filter Change

- Changing Functional Filter by Customer Needs (Deodorization, Allergy or HAF (Fine Dust))



**Step 5**

### Cleaning

- Outdoor unit cleaning



**Step 6**

### Finished

- Diagnosis by App



Features	Details
Cooling Capacity Rated (Min - Max) Btu/h	1HP 9,200 (1,800 - 11,900) 1.5HP 12,000(2000 - 13,500) 2HP 18,000 (3,400 - 20,000) 2.5HP 21,500 (3,800 - 23,800)
Power Source Rated (Min - Max) W	1HP 770 (150 - 1,000) 1.5HP 1,030 (200 - 1,290) 2HP 1,540 (250 - 2,000) 2.5HP 1,850 (320 - 2,600)
Star Rating	5 Stars
Dimension Indoor (W × H × D MM)	1HP 837 x 308 x 189 1.5HP 837 x 308 x 189 2HP 998 x 345 x 210 2.5HP 998 x 345 x 210
Key Features	Plasmaster™ Ionizer++   Faster Cooling Energy Saving   Less Noise DUAL Inverter Compressor™
Wi-Fi	Yes (LG ThinQ)
Filter	Pre Filter & Allergy Filter



# Thank You

Prepared by Training and Activation Division