

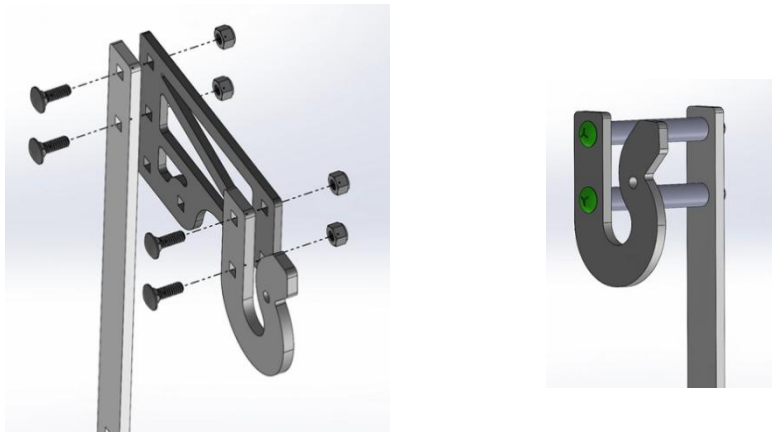

Hanger Offset Kit - Single

Thank you for your purchase of the MPS Premium Target System! Here you will find a set of brief assembly instructions. For more detailed information, please visit our website for downloadable pdfs, as well as in-depth assembly videos that walk you through setup and use. We've taken great lengths to produce the most reliable match-grade target system on the market. If assembled correctly, and placed on a solid footing, you should experience zero target failures for many matches to come. We hope you enjoy your new target package, and we hope your next match is a success!

To install Single Hanger Offset Kit onto your existing target stands, first remove the hook assembly as shown below. Next, install the spacer tubes and hook using the provided **4" carriage bolts**. Tighten the nuts to 1/16 turn past snug. Do not over-torque.



T-post Hangers can also be adapted to the Hanger Offsets. Install per the images below. Tighten nuts to 1/16 turn past snug. Note: Shown on the left is the optional removal of the extension bracket. These are not needed when using offsets.

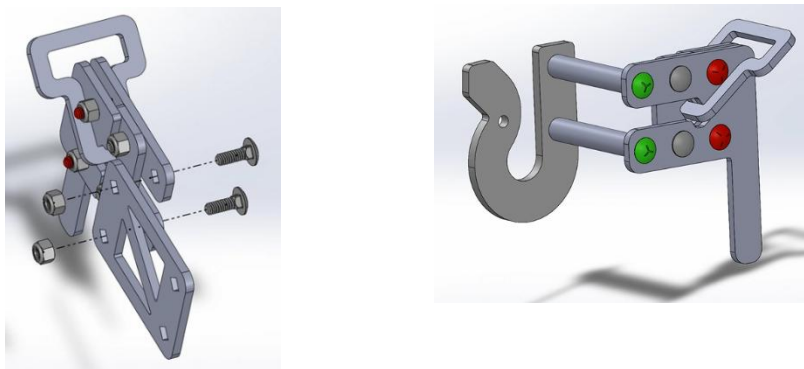

Single Hanger Offset Replacement hardware - If replacement hardware is needed for your Single Hanger Offset Kit, see the following list of parts to source:

- 1/4-20 Carriage Bolt, Grade 5 or 8, **4" Length** (qty 2)
- 1/4-20 Nylon Lock Nut, Grade 5 or 8 (qty 2)



Hanger Offset Kit – Double

To install Double Hanger Offset Kit onto your existing target stands, first remove the hook assembly as shown below. Next, install the spacer tubes and hooks using the provided **7.5" carriage bolts**. Tighten the nuts to 1/16 turn past snug. Do not over-torque.

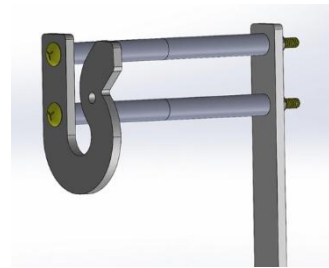
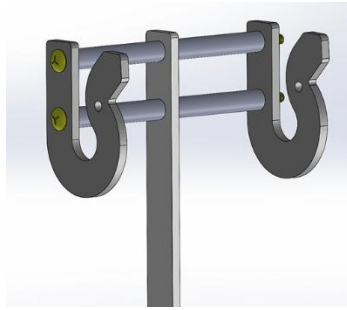
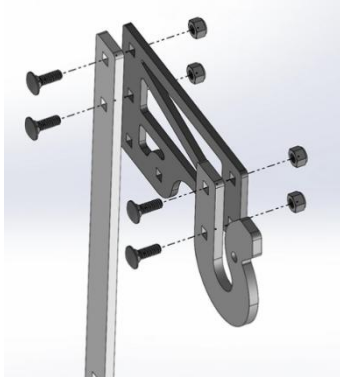

You have the option to use the Double Hanger Offset Kit in one of two ways, either use 2 hooks (one on each side of the upright) or use a single hook, but spaced twice as far from the upright. This option is great for larger target sizes.

T-post Hangers can also be adapted to the Double Hanger Offset Kit. Install per the images below. Tighten nuts to 1/16 turn past snug. Note: Shown on the left is the optional removal of the extension bracket. These are not needed when using offsets.

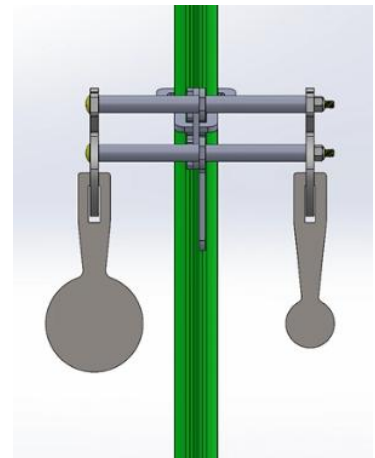
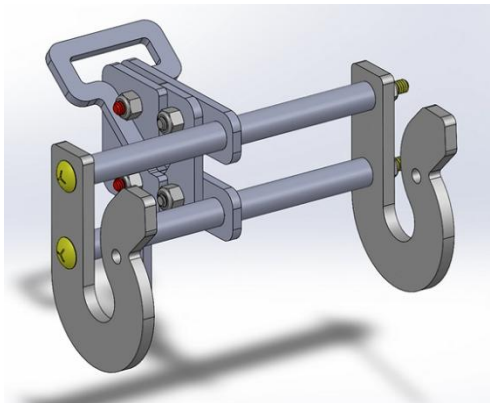
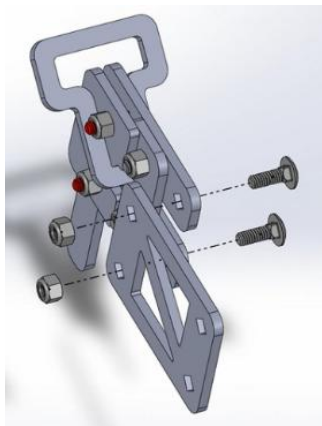

Replacement hardware - If replacement hardware is needed for your Hanger Offset Kit, see the following list of parts to source:

- 1/4-20 Carriage Bolt, Grade 5 or 8, **7.5" Length** (qty 2)
- 1/4-20 Nylon Lock Nut, Grade 5 or 8 (qty 2)
- 1/2" DOM or Schedule 40 tubing, cut to 3.1" (qty 4)