

- The schematic shows how the starter interrupt is integrated into the original OEM wiring harness.
- The wire coming from the ignition switch to the body control module is “interrupted” by adding the module/relay, dust cap, connectors, and wiring to the starter system.
- The blue highlighted area with the two additional connectors summarizes the complete Landi Technologies starter interrupt system.

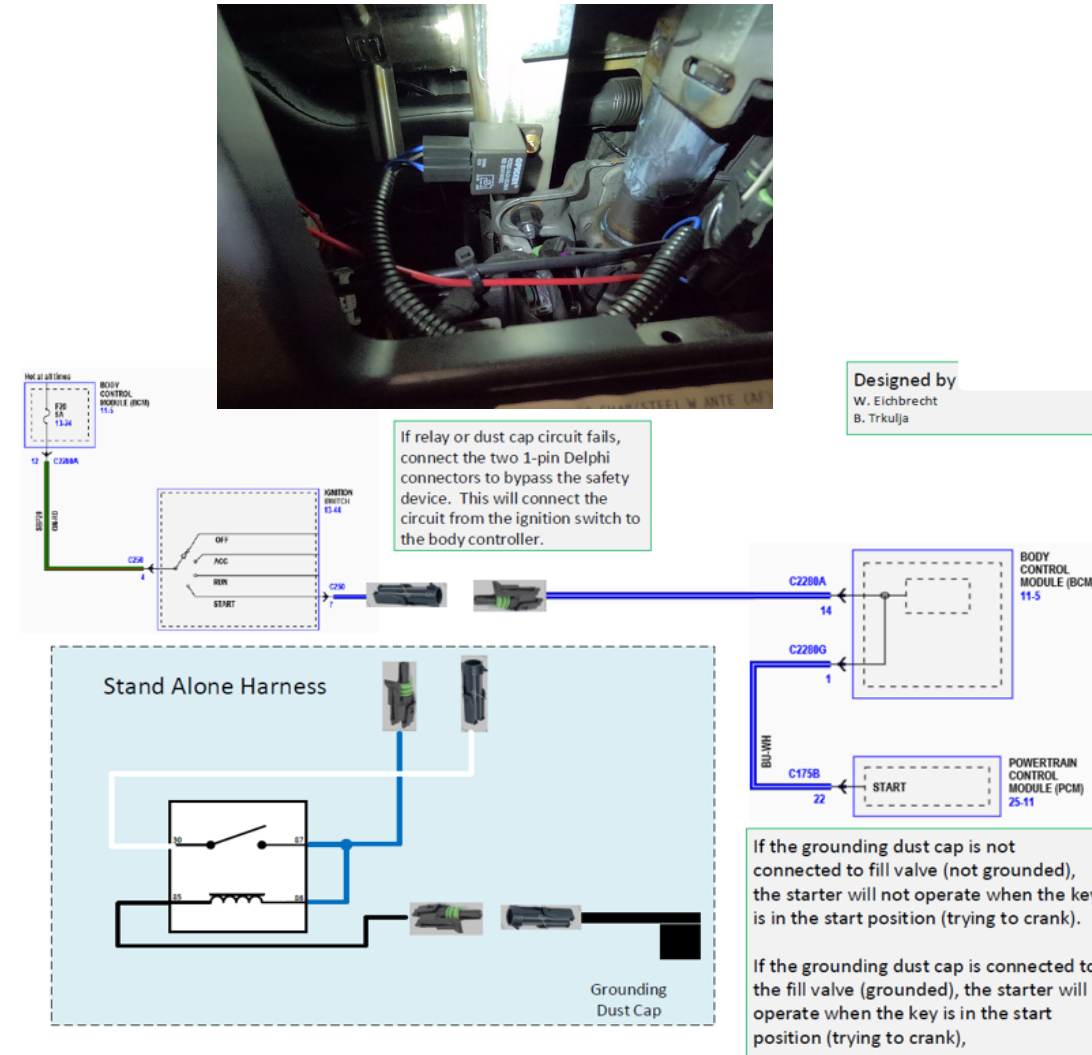

Located behind the plastic trim near the driver's knee

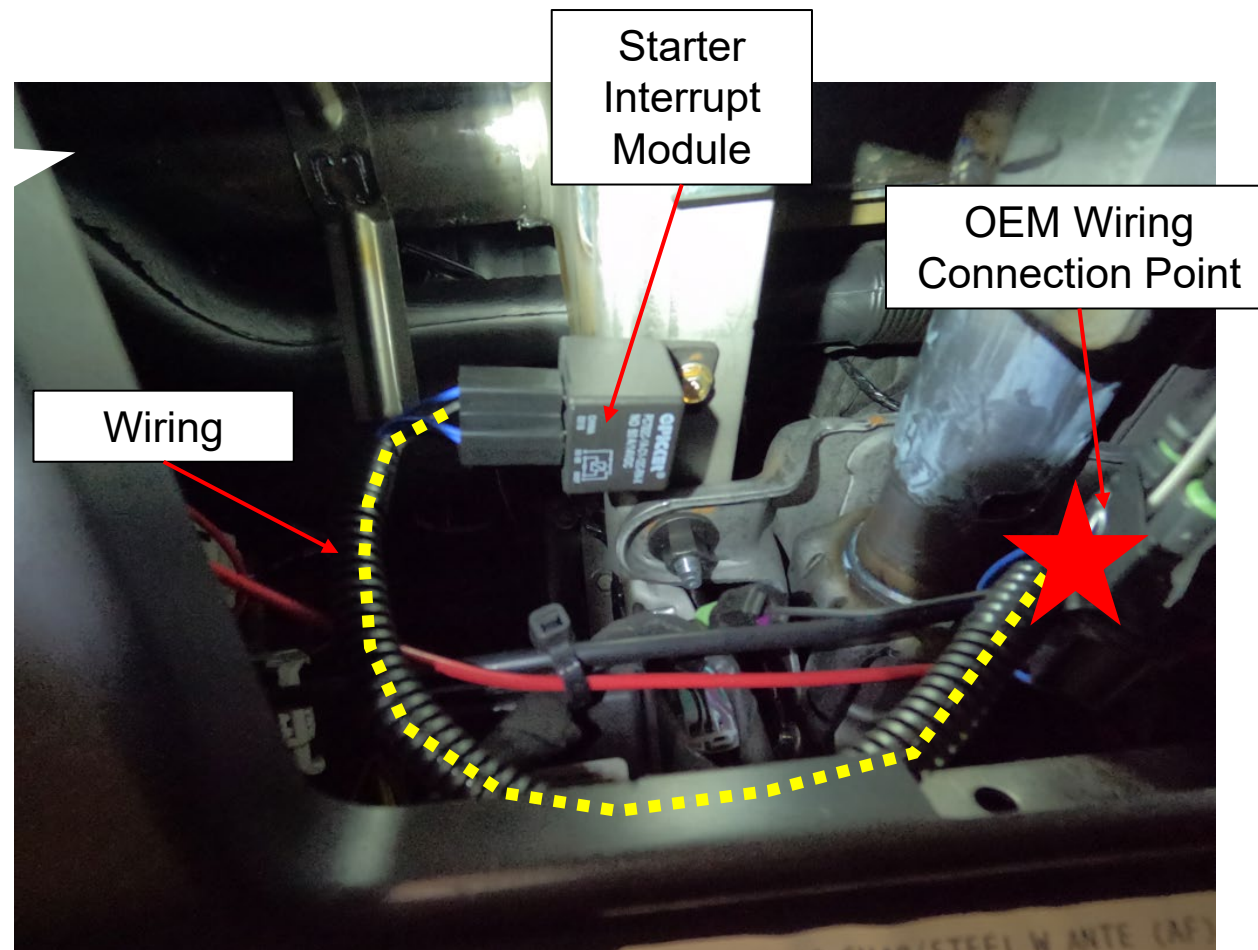

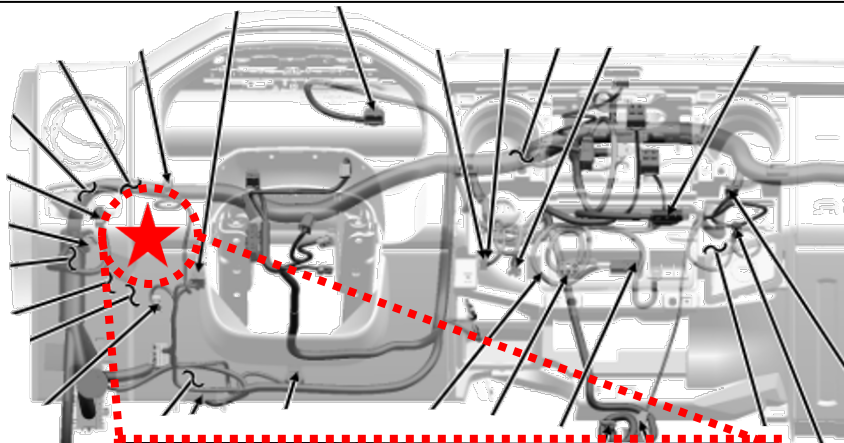

- If the dust cap on the fueling receptacle is damaged, please perform the following steps to bypass starter interrupt
- Locate starter interrupt module/relay wiring connection to OEM wiring harness
- Disconnect (2 X) module/relay connectors
- Connect two connectors on OEM wiring harness together
- Starter Interrupt is now bypassed.

