



Ford F-59 CNG  
UPS Service Parts Catalog  
2019 P100 - Job #19-81  
2019 P120 - Job #19-80



F59NG.SM.0002  
April 14, 2020

# Table of Contents

	Page
Abbreviations Used	3
Fuel System Schematic	4
Engine Mounted Components	5
LP Fuel Lines and Coolant Hoses	6
HP Fuel Lines	8
HP Fuel Line Locations	9
PRD Vent Lines - fittings, brackets & clips	10
PRD Vent Lines - fitting, bracket & clips	11
PRD Vent Lines - chassis & body	12
PRD Vent Lines - chassis & body locations	13
PRDs and PRD Vent Lines - cylinder mounted	14
Cylinder & Shield Components	15
Cylinder Mounting Components	16
Flow & Filtration Components	17
Fuel Fill Panel Components - front	18
Fuel Fill Panel Components - back	19
Electrical Components	20
Decals	21
Contact Information	22

# Abbreviations Used

Item	Description
ASM	Assembly
CNG	Compressed natural gas
DS	Driver side
HP	High pressure
LP	Low pressure
POA	Part of assembly
PRD	Pressure relief device
PS	Passenger side
T-PRD	Thermal PRD
WB	Wheelbase

# Fuel System Schematic

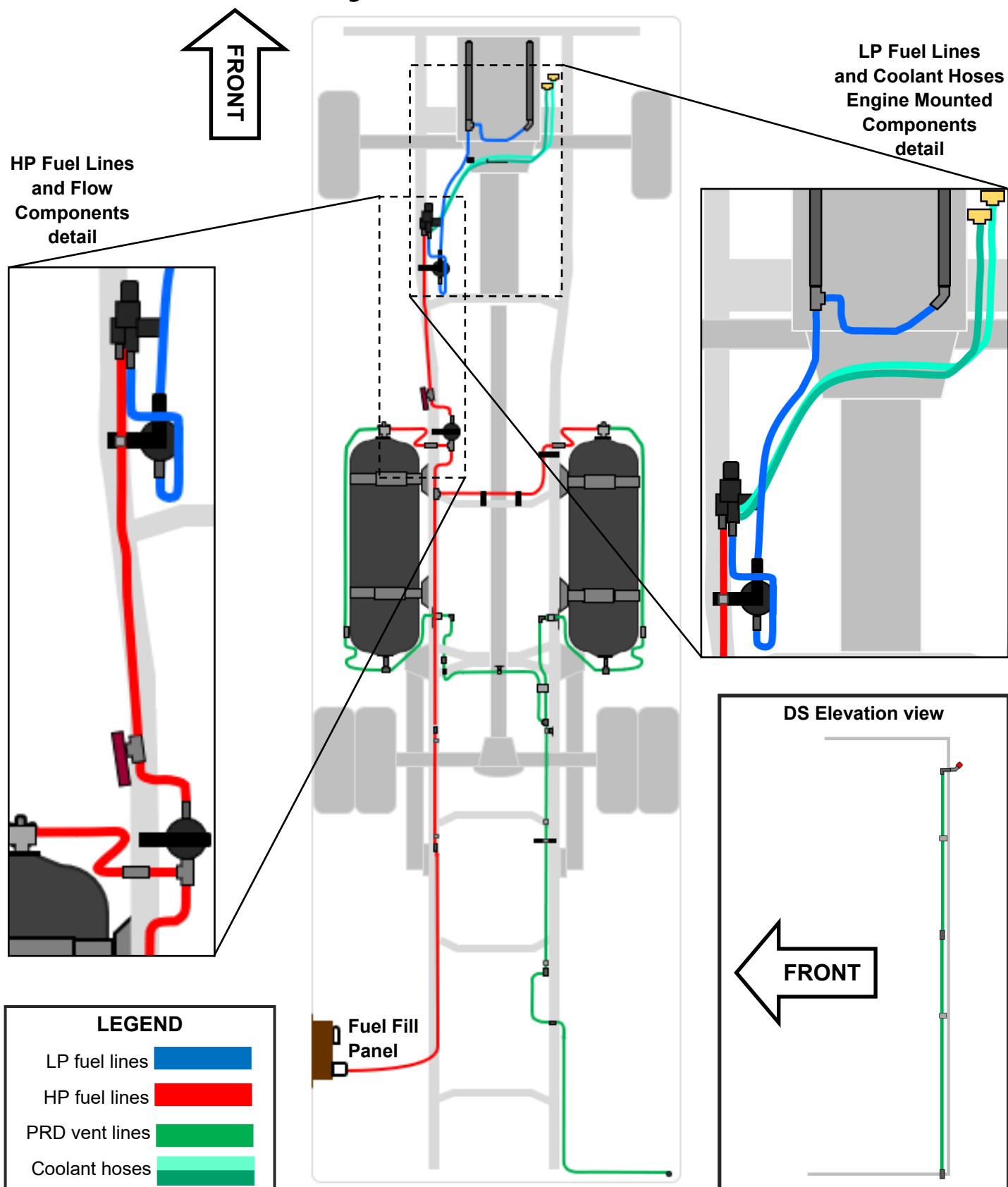

# Engine Mounted Parts

Item	UPS p/n	Service p/n	Description	Job #	Chassis QTY
1		63100000	ASM, fuel rail, DS, 6.8L, CNG - includes 2, 5, 6, 7, (3) 8, (5) 9, (5) 11	19-80 19-81	1
2		10200226	Fitting, tee, fuel rail, driver side, 6.8L, CNG	19-80 19-81	1
3		63100001	ASM, fuel rail, PS, 6.8L, CNG - includes 4, 5, 6, 7, (3) 8, (5) 9, (5) 11	19-80 19-81	1
4		10200201	Fitting, 45-degree elbow, fuel rail, passenger side, 6.8L, CNG	19-80 19-81	1
5		61010013	Fuel rail, 6.8L, CNG (bare)	19-80 19-81	2
6		61180083	Fitting, straight plug, fuel rail, 6.8L, CNG	19-80 19-81	2
7**		62080038	Bracket, single piece, fuel rail, 6.8L, CNG	19-80 19-81	2
8		69000419	Screw, fuel rail bracket to fuel rail mounting, 6.8L CNG – SET OF 6	19-80 19-81	6
9		61020015	Fuel injector, 6.8L, CNG	19-80 19-81	10
10		69000420	O-ring, fuel injector, upper, black, 6.8L, CNG (POA 9) – SET OF 5	19-80 19-81	10
11		69000517	O-ring, fuel injector, lower, 6.8L, CNG (POA 9) – SET OF 5	19-80 19-81	10
12		61180042	Spacer, fuel injector, 6.8L, CNG	19-80 19-81	10
13*		69000421	O-ring, fuel injector spacer, 6.8L, CNG (POA 11) - SET OF 5	19-80 19-81	10
14*		61090096	Cap, vacuum	19-80 19-81	1
15		63060016	ASM, LP fuel tube, fuel rail crossover	19-80 19-81	1
16*		61090113	Bolt, fuel rail bracket to intake manifold mounting	19-80 19-81	6

\*Not shown

\*\*Replaces multiple brackets on early units.

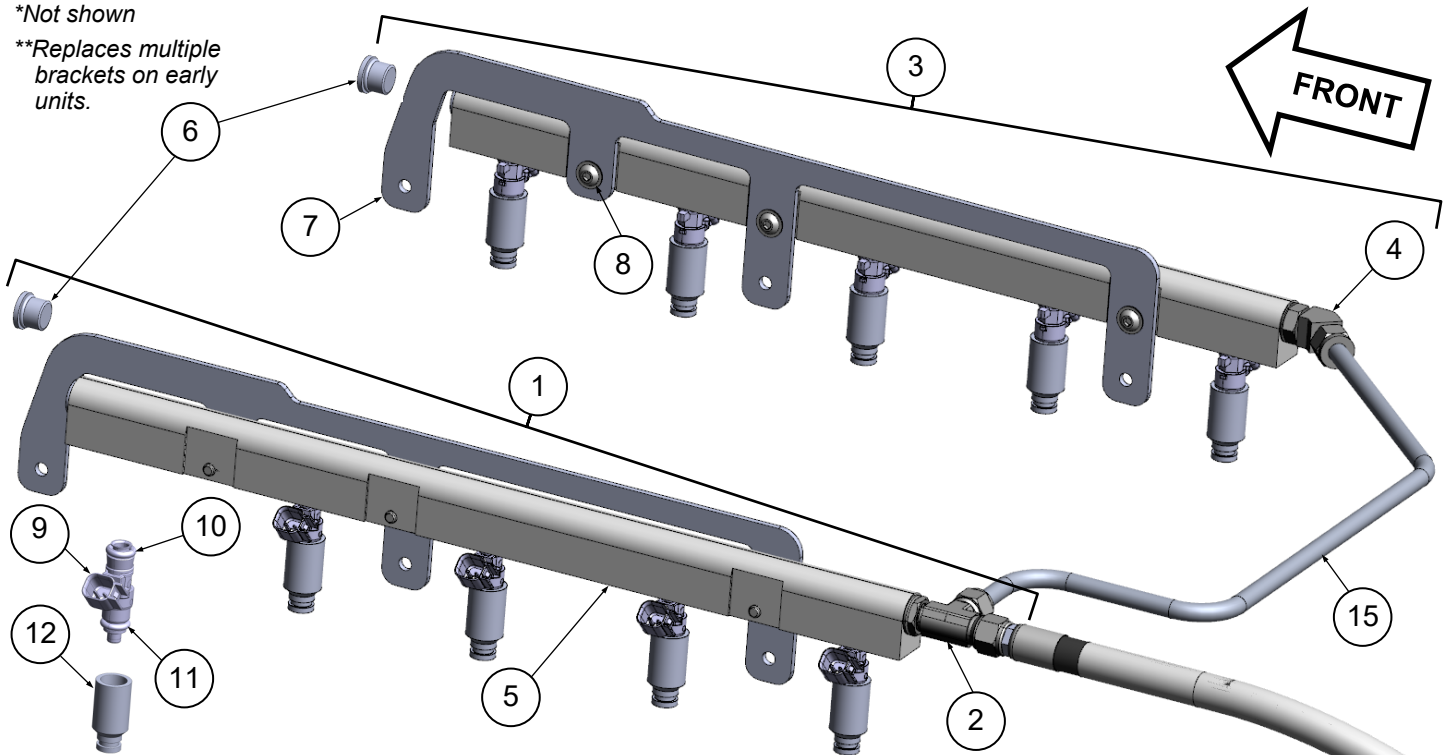

# LP Fuel Lines & Coolant Hoses

Item	UPS p/n	Service p/n	Description	Job #	Chassis QTY
1		63060009	Hose, LP fuel, flexible - includes fittings and heat sleeve	19-80 19-81	1
2		61270000	Heat sleeve, LP fuel hose	19-80 19-81	1
3		63060007	ASM, LP fuel tube, regulator to LP filter	19-80 19-81	1
4		69000504	ASM, bracket, coolant hose routing, with hardware	19-80 19-81	1
5		69000422	Clip, dual tie strap - SET OF 13	19-80 19-81	13
6*		69000423	Clip, single tie strap - SET OF 2	19-80 19-81	2
7		69000505	ASM, bracket, fuel and coolant hose, with hardware	19-80 19-81	1
8		61170039	Hose, pressure regulator coolant, supply	19-80 19-81	1
9		61170038	Hose, pressure regulator coolant, return	19-80 19-81	1
10*		61270001	Heat sleeve, pressure regulator coolant hose	19-80 19-81	2
11		61180044	Clamp, coolant hose, 3/4-in.	19-80 19-81	4
12		61180045	Clamp, coolant hose, 15/16-in.	19-80 19-81	4
13		61180033	Fitting, tee, coolant hose	19-80 19-81	2
14		61180046	Fitting, elbow, pressure regulator coolant port	19-80 19-81	2

\*Not illustrated

# LP Fuel Lines & Coolant Hoses

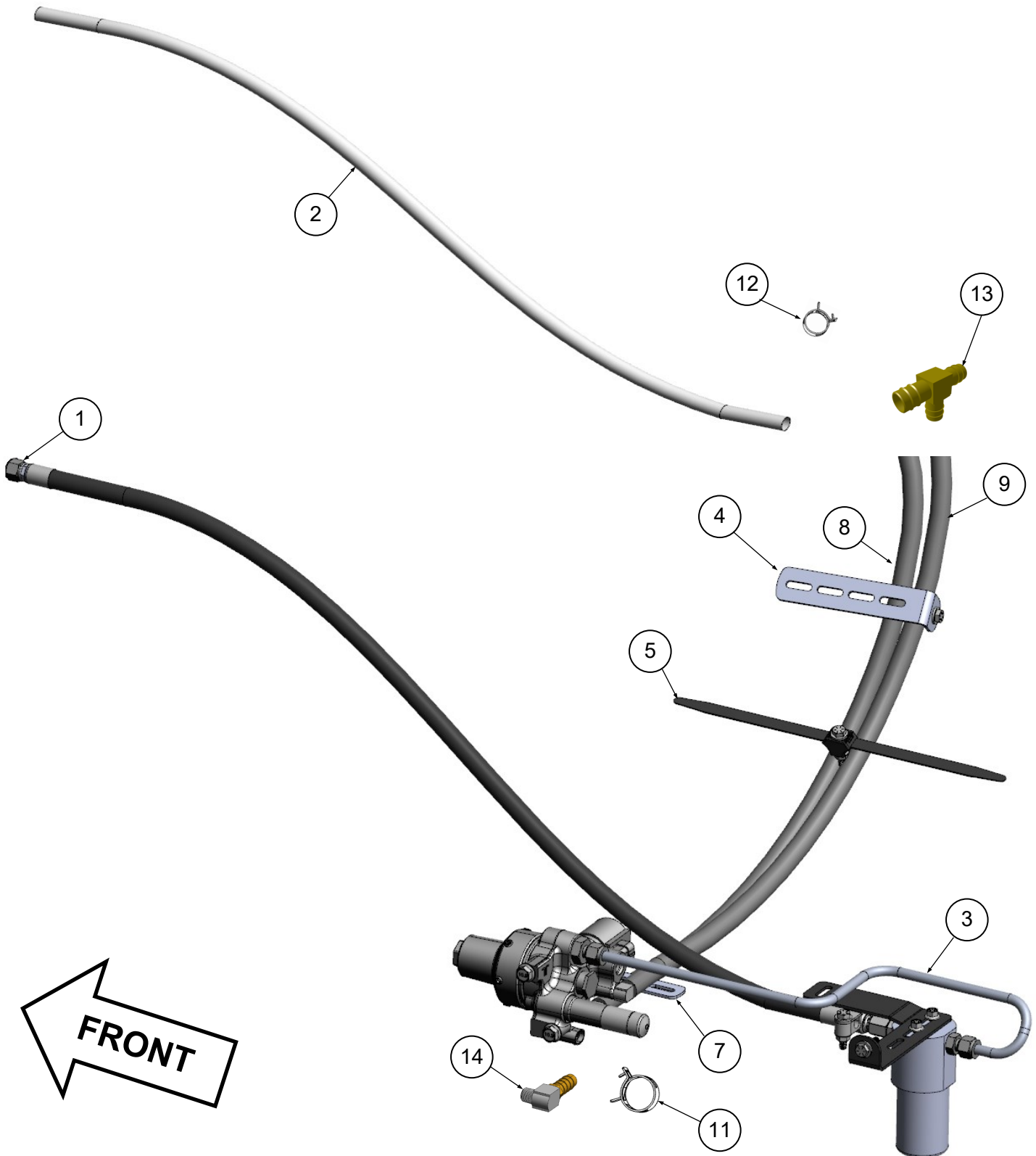

# HP Fuel Lines

Item	UPS p/n	Service p/n	Description	Job #	Chassis QTY
1		10300327	Hose, HP flexible fuel	19-80 19-81	1
2		69000491	ASM, HP fuel tube, hose to union, 178-in. WB	19-81	1
2		69000492	ASM, HP fuel tube, hose to union, 208-in. WB	19-80	1
3		10200002	Fitting, union	19-80 19-81	2
4		10200207	Fitting, tee	19-80 19-81	1
5		69000493	ASM, HP fuel tube, union to tee, 178-in. WB	19-81	1
5		69000494	ASM, HP fuel tube, union to tee, 208-in. WB	19-80	1
6		69000495	ASM, HP fuel tube, tee to tee, 178-in. WB	19-81	1
6		69000496	ASM, HP fuel tube, tee to tee, 208-in. WB	19-80	1
7		69000499	ASM, HP fuel tube, tank to tank crossover, 178-in. WB	19-81	1
7		69000497	ASM, HP fuel tube, tank to tank crossover, 208-in. WB	19-80	1
8		63060006	ASM, HP fuel tube, HP filter to bulkhead	19-80 19-81	1
9		69000498	ASM, HP fuel tube, bulkhead to shut off	19-80 19-81	2
10		63060004	ASM, HP fuel tube, HP filter to quarter turn valve	19-80 19-81	1
11		63060005	ASM, HP fuel tube, quarter turn valve to regulator	19-80 19-81	1
12	4820721	10300158	Valve, 1/4-turn manual shut off, includes (17)	19-80 19-81	1
13		10200023	Fitting, 3/8-in., straight, bulkhead	19-80 19-81	2
14*		69000424	Washer, bulkhead, flat, hardened steel - SET OF 5	19-80 19-81	8
15		69000510	ASM, bracket, 4-slot, with hardware	19-80 19-81	4
16		69000427	Clamp, tube, 3/8-in - SET OF 4	19-80 19-81	4
17	4823484	10300160	Valve handle, red	19-80 19-81	1

\*Not shown

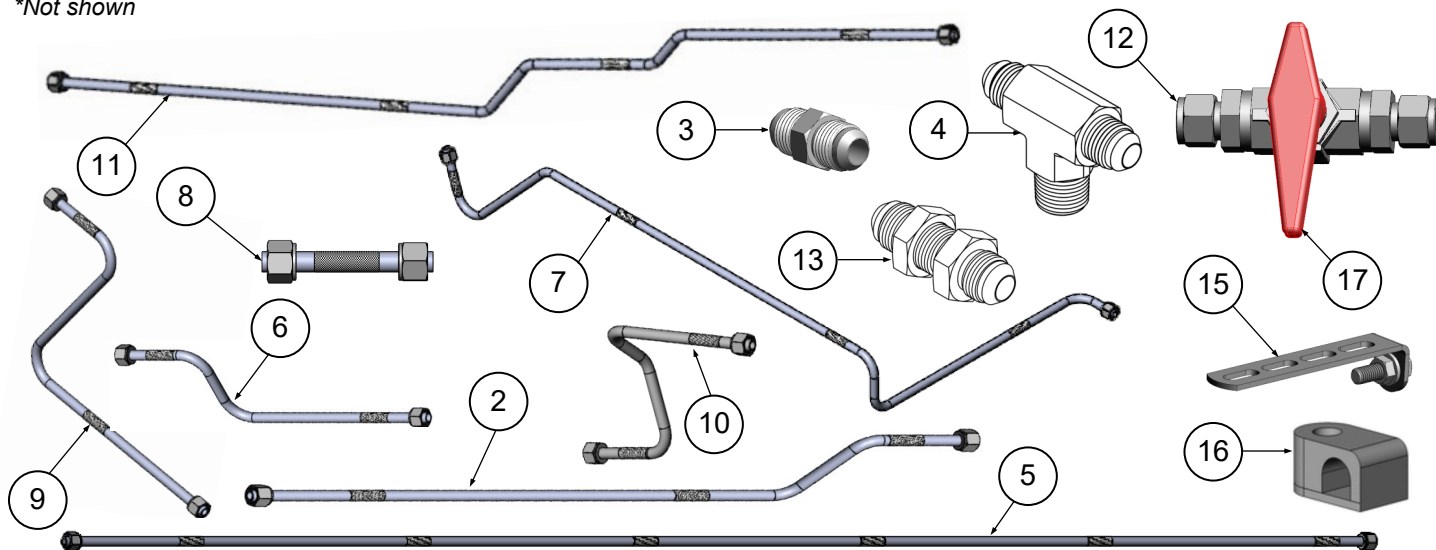



# HP Fuel Line Locations

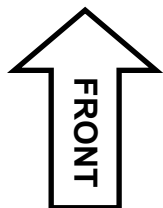

HP Fuel Lines - fittings  
and brackets detail

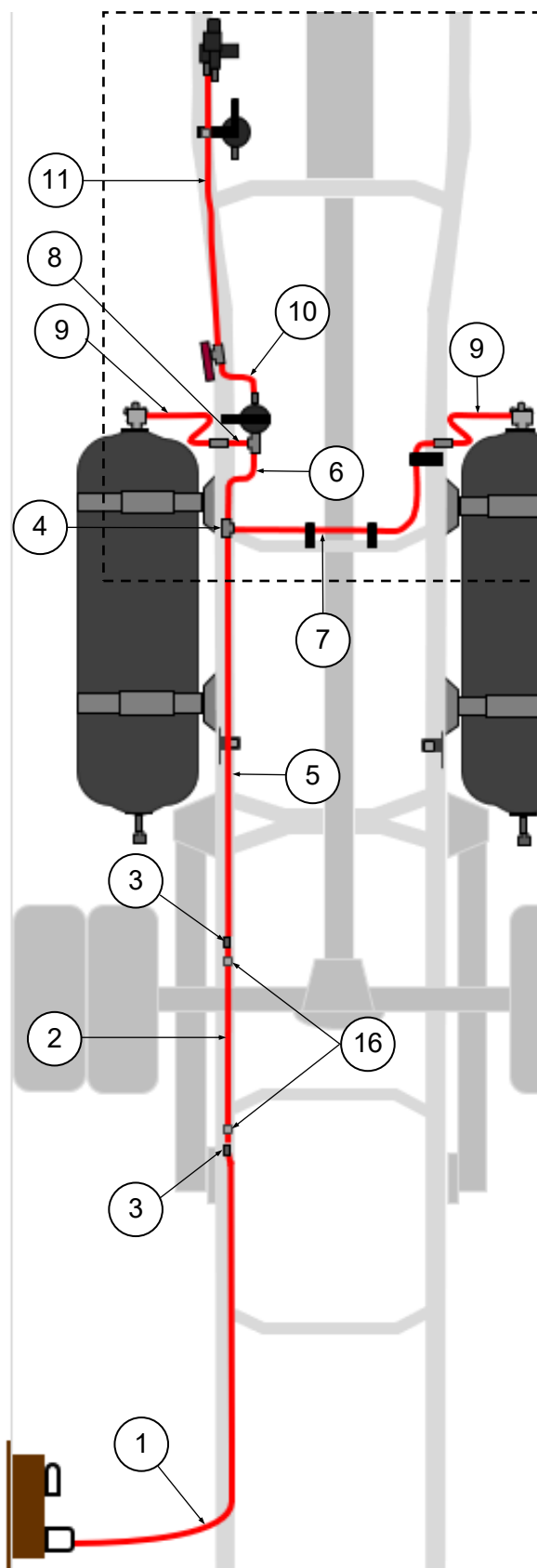
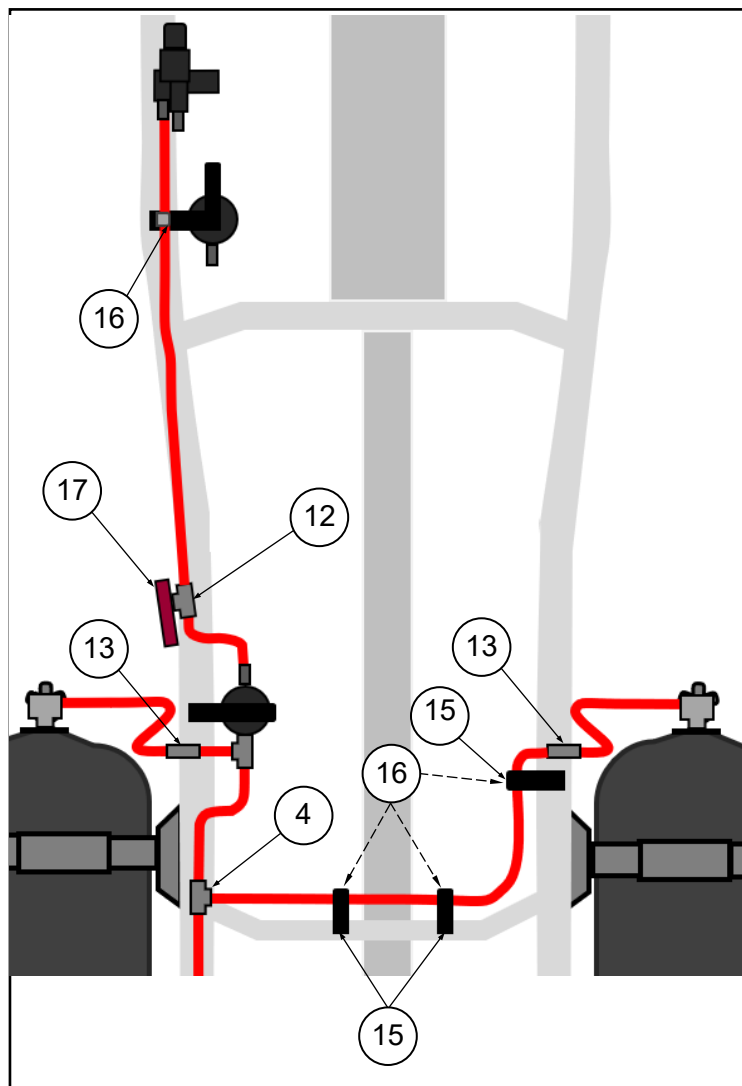

# PRD Vent Lines - fittings, brackets & clips

Item	UPS p/n	Service p/n	Description	Job #	Chassis QTY
1		63120000	ASM, 45-degree elbow, PRD vent outlet with heat shrink cap (6)	19-80 19-81	1
2		10210066	Fitting, JIC, 90-degree elbow	19-80 19-81	2
3		10200023	Fitting, 3/8-in., straight, bulkhead	19-80 19-81	2
4		61180048	Fitting, bulkhead, PRD vent tube, 90-degree elbow	19-80 19-81	2
5		10200285	Fitting, 3/8-in., tee	19-80 19-81	1
6		10712488	Cap, heat shrink, PRD vent outlet	19-80 19-81	1
7		69000425	Clamp, tube, 1/2-in. - SET OF 5	19-80 19-81	5
8		69000427	Clamp, tube, 3/8-in, single hole. - SET OF 4	19-80 19-81	4
13*		69000424	Washer, bulkhead, flat, hardened steel - SET OF FIVE	19-80 19-81	5
14		10200542	Fitting, 1/2-in., union, straight	19-80 19-81	3
15		69000510	ASM, bracket, 4-slot, with hardware	19-80 19-81	1
22		61180049	Fitting, 1/2-in., 90-degree elbow	19-80	1
23		10200024	Fitting, 1/2-in., straight, bulkhead	19-80 19-81	1
24		61090095	Flange clip, zip tie mount <i>[NOTE: Used with (7) and (8)]</i>	19-80 19-81	2

\*Not shown

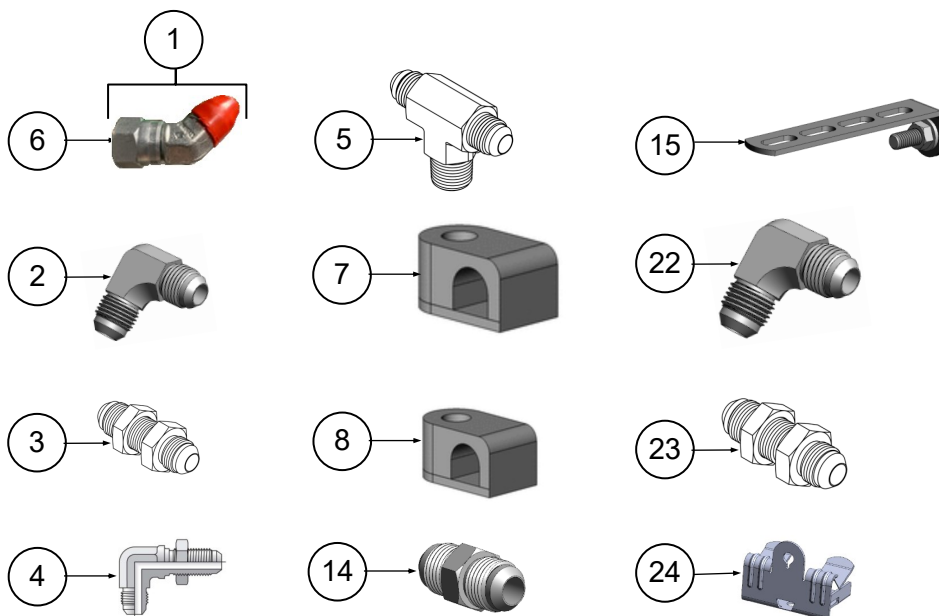

# PRD Vent Lines - fitting, bracket & clip locations

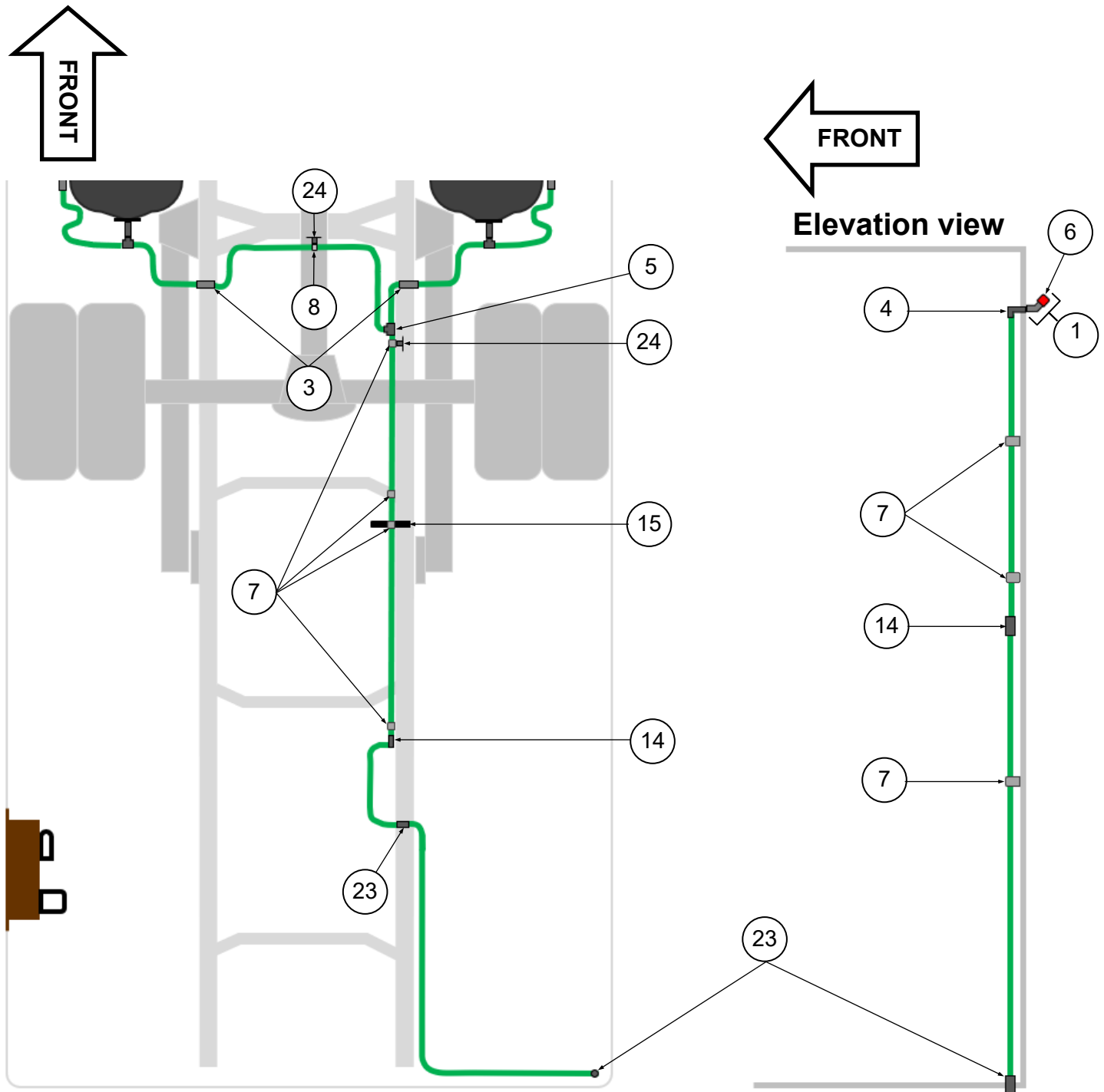

# PRD Vent Lines - chassis & body

Item	UPS p/n	Service p/n	Description	Job #	Chassis QTY
9		62170037	ASM, tube, PRD vent, body, 1/2-in., union to bulkhead	19-80 19-81	1
10		69000513	ASM, tube, PRD vent, body, 1/2-in., bulkhead to bulkhead	19-80 19-81	1
11		63060021	ASM, tube, PRD vent, body, 1/2-in., bulkhead to union	19-80 19-81	1
12		63060020	ASM, tube, PRD vent, body, 1/2-in., union to bulkhead	19-80 19-81	1
16		69000514	ASM, tube, PRD vent, chassis, 3/8-in., PRD to bulkhead (DS), 178-in. WB	19-81	1
16		62170055	ASM, tube, PRD vent, chassis, 3/8-in., PRD to bulkhead (DS), 208-in. WB	19-80	1
17		69000515	ASM, tube, PRD vent, chassis, 3/8-in., PRD to bulkhead (PS), 178-in. WB	19-81	1
17		62170057	ASM, tube, PRD vent, chassis, 3/8-in., PRD to bulkhead (PS), 208-in. WB	19-80	1
18		69000500	ASM, tube, PRD vent, chassis, 3/8-in., tee to bulkhead (PS), 178-in WB	19-81	1
18		69000501	ASM, tube, PRD vent, chassis, 3/8-in., bulkhead to tee (PS), 208-in WB	19-80	1
19		69000502	ASM, tube, PRD vent, chassis, 3/8-in., tank to tank crossover, 178-in. WB	19-81	1
19		69000503	ASM, tube, PRD vent, chassis, 3/8-in., tank to tank crossover, 208-in. WB	19-80	1
20		69000516	ASM, tube, PRD vent, chassis, 1/2-in., tee to union, 178-in WB	19-81	1
20		62170066	ASM, tube, PRD vent, chassis, 1/2-in., tee to union, 208-in WB	19-80	1
21*		62170067	ASM, tube, PRD vent, chassis, 1/2-in., union to elbow, 208-in WB	19-80	1

\*Not shown

# PRD Vent Lines - chassis & body locations

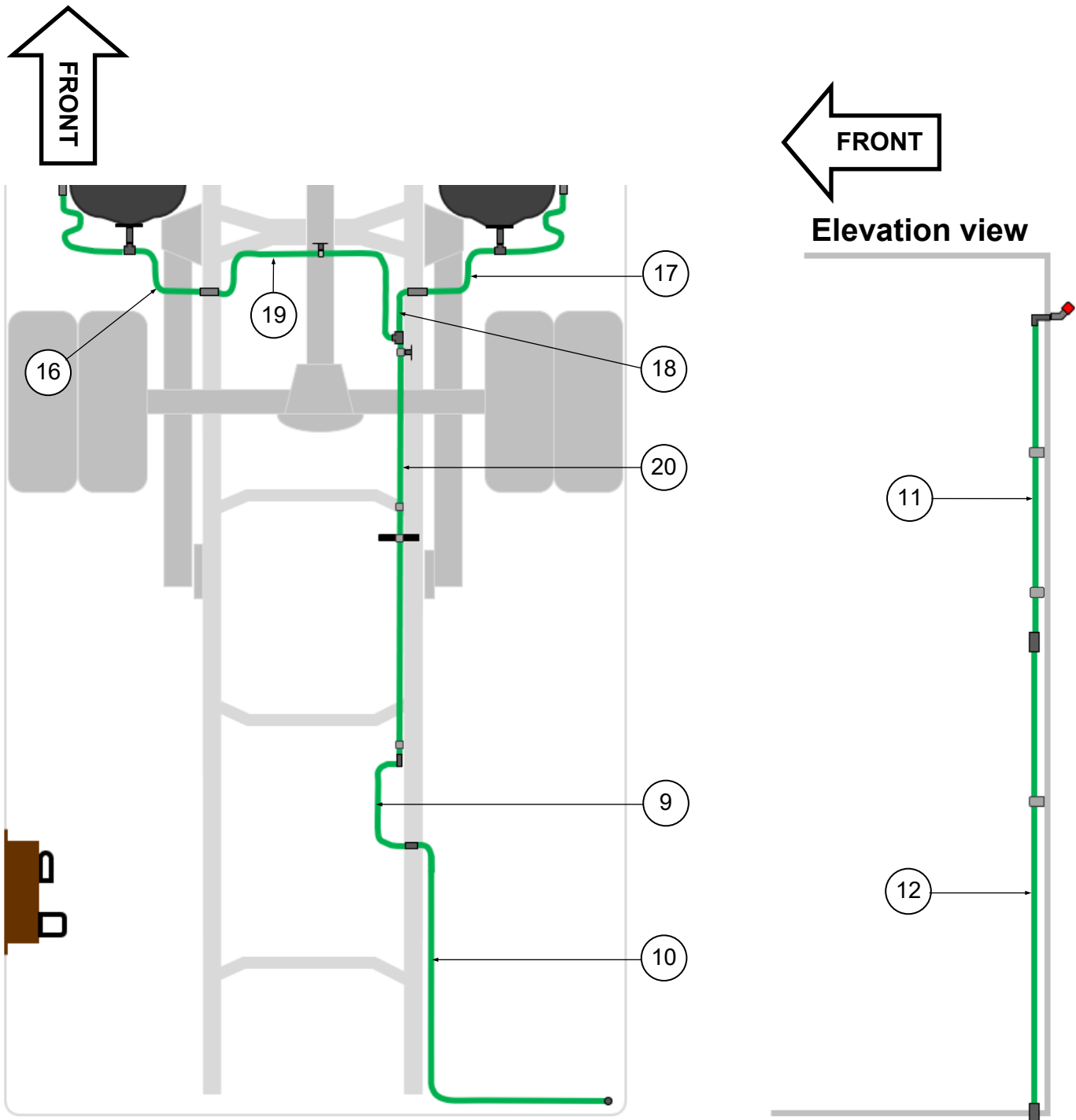

# PRDs & PRD Vent Lines - cylinder mounted

Item	UPS p/n	Service p/n	Description	Job #	Chassis QTY
22		21617007	ASM, PRD vent tube, 3/8-in., valve to union, DS	19-80 19-81	1
23		21617009	ASM, PRD vent tube, 3/8-in., union to PRD, DS	19-80 19-81	1
24*		21617006	ASM, PRD vent tube, 3/8-in., valve to union, PS	19-80 19-81	1
25*		21617008	ASM, PRD vent tube, 3/8-in., union to PRD, PS	19-80 19-81	1
26	4819419	10300077	T-PRD plug	19-80 19-81	2
27		16065-97	PRD plug	19-80 19-81	2
28		10240068	Fitting, union, male to male	19-80 19-81	2
29		10240697	Fitting, tee, male, male, female	19-80 19-81	2
30		10240004	Fitting, union, 1/2-20 Male SAE ORB to -6 Male JIC	19-80 19-81	2
31		69000428	Bushing, tube - SET OF 3	19-81	3
32		69000507	Bracket, tube clamp, (black), with hardware	19-80 19-81	8
33		69000506	Tube clamp, 3/8 in., cylinder PRD vent tube, with hardware - SET OF 4	19-80 19-81	8

\*Not illustrated; similar to DS.

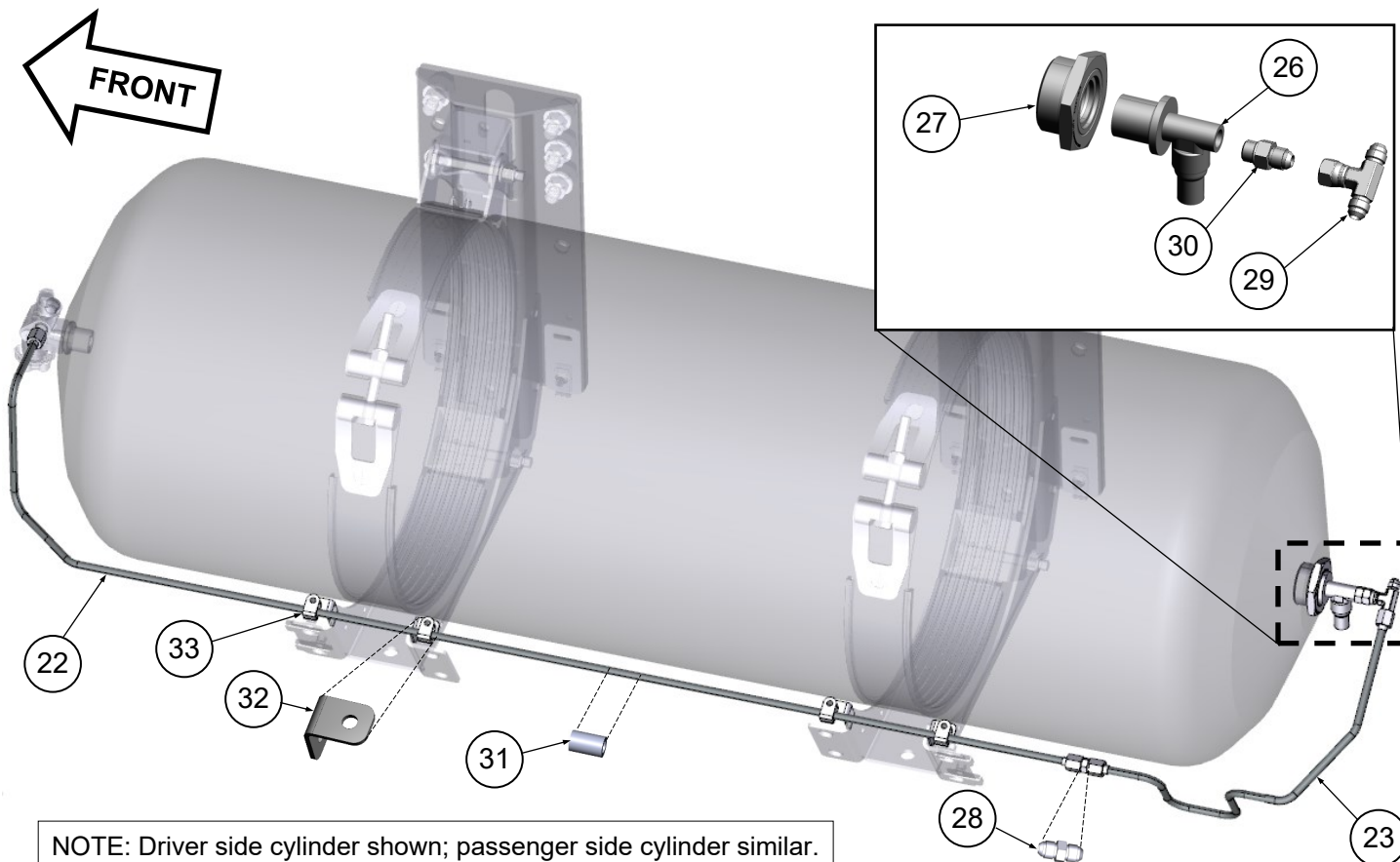

# Cylinder & Shield Components\*\*

Item	UPS p/n	Service p/n	Description	Job #	Chassis QTY
1		240093-063A	Cylinder, CNG, 16-in. x 71-in., 15 GGE, 20 year life - 2019 P100 & P120	19-80 19-81	2
2		10200283	Plug, manual shut off valve	19-80 19-81	4
3	4820709	10300102	Manual shut off valve, cylinder	19-80 19-81	2
4	4820658	10200062	Fitting, SAE, connector	19-80 19-81	2
5*		61090105	Washer, flat, cylinder shield mounting	19-80 19-81	32
6*		10761507	Lock washer, cylinder shield mounting	19-80 19-81	32
7*		10760202-175	Hex cap screw, cylinder shield mounting, inside	19-80 19-81	16
8*		10760202-125	Hex cap screw, cylinder shield mounting, outside	19-80 19-81	8
9		69000508	Nut clip, cylinder shield mounting - SET OF 4	19-80 19-81	8

\*Not illustrated

\*\*Refer to PRDS & PRD Vent Lines - cylinder mounted (above) for other cylinder components.

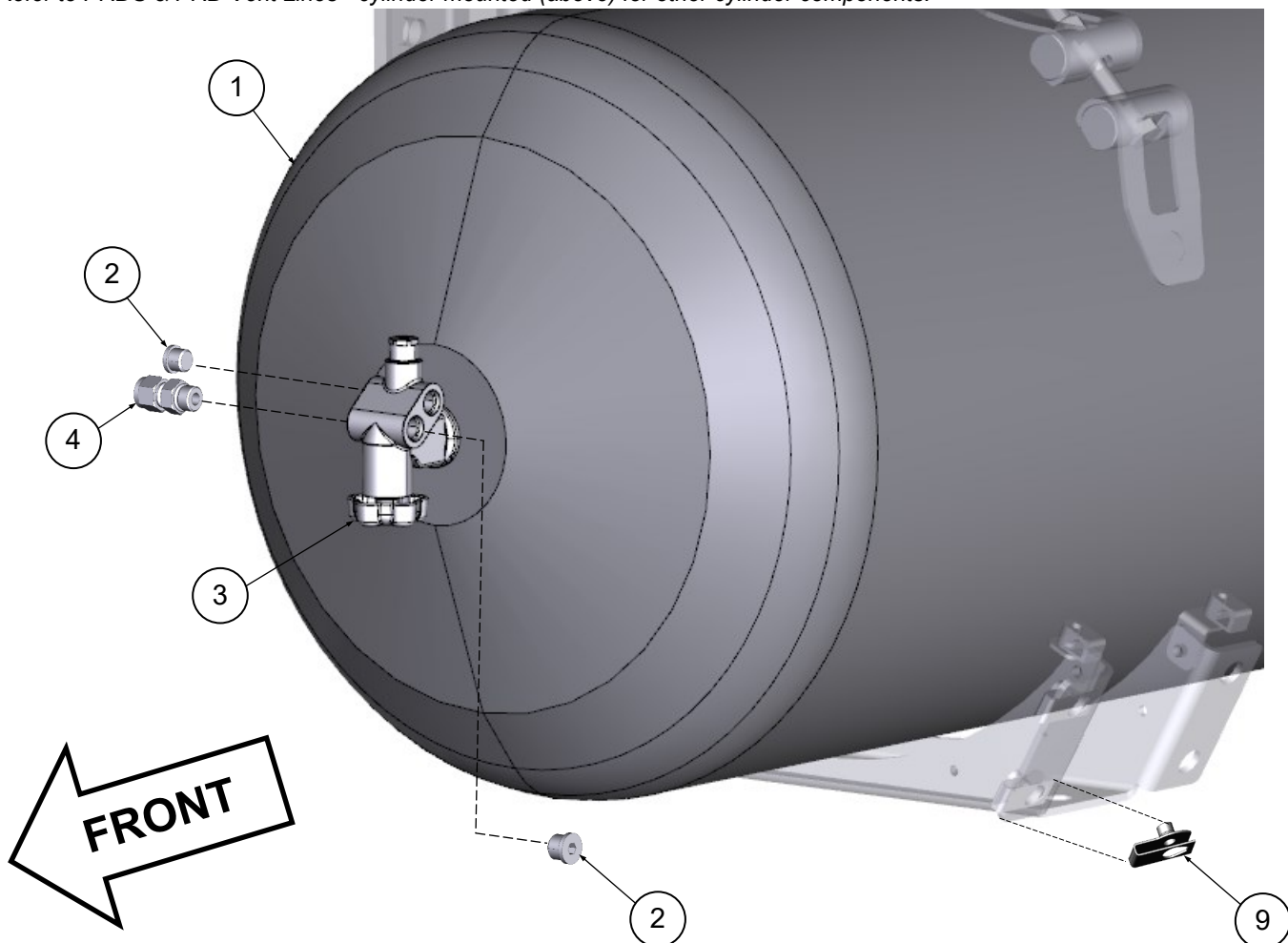

NOTE: Driver side cylinder shown; passenger side cylinder similar.

# Cylinder Mounting Components

Item	UPS p/n	Service p/n	Description	Job #	Chassis QTY
1		21617102	Plate, stiffener, cylinder bracket mount	19-80 19-81	4
2		69000488	ASM, bracket, cylinder mounting	19-80 19-81	4
3		21617103	Plate, nut clip (black)	19-80 19-81	8
4		21615100	Subassembly, welded adaptor bracket	19-80 19-81	4
5		69000489	ASM, strap, cylinder mounting	19-80 19-81	4
6		69000490	Kit, isolator, cylinder mounting - SET OF 2	19-80 19-81	4
7		10760206-2	Hex cap screw, cylinder bracket mounting	19-80 19-81	16
8		10761660	Lock nut, cylinder bracket mounting	19-80 19-81	16
9		10710005	Flat washer, cylinder bracket mounting	19-80 19-81	32
10*		61090109	Flanged hex cap screw, M12-1.75 X 60MM	19-80 19-81	2

\*Not illustrated

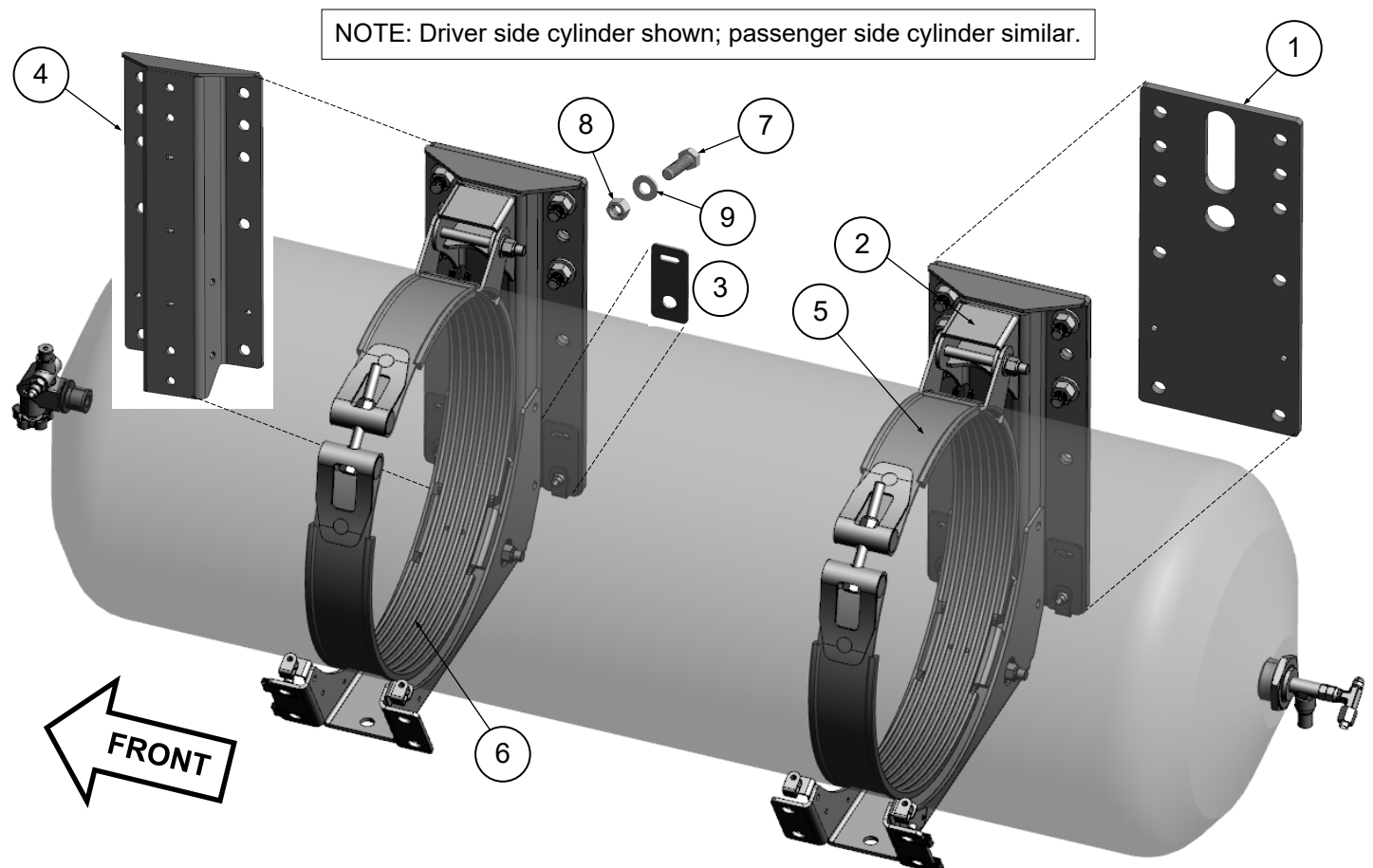



# Flow & Filtration Components

Item	UPS p/n	Service p/n	Description	Job #	Chassis QTY
1		63110000	ASM, HP fuel filter - includes fittings, element and O-rings	19-80 19-81	1
2		69000433	Kit, Service, HP fuel filter mounting - includes bracket and hardware	19-80 19-81	1
3		63110001	ASM, LP fuel filter - includes fittings, element and O-rings	19-80 19-81	1
4		69000434	Kit, Service, LP fuel filter mounting - includes bracket and hardware	19-80 19-81	1
5	NS	NS	Filter head - (POA 1 and 3)	19-80 19-81	2
6		61190003	Filter element, CNG, F-59	19-80 19-81	2
7	NS	NS	O-ring, filter bowl (POA 1 and 3) <i>[Note: also included in (11).]</i>	19-80 19-81	2
8	NS	NS	Filter bowl (POA 1 and 3)	19-80 19-81	2
9		69000430	Filter bowl plug - includes 10	19-80 19-81	2
10	NS	NS	O-ring, filter plug (POA 9) <i>[Note: also included in (11).]</i>	19-80 19-81	2
11*		69000481	Kit, Service, filter element - includes (6), (7), (10) and O-ring lube	19-80 19-81	2
12		63110002	ASM, pressure regulator - includes compression fittings <i>(not shown)</i> and cap (13)	19-80 19-81	1
13		61090107	Cap, pressure regulator PRD cover	19-80 19-81	1
14		69000429	Bolt, pressure regulator mounting - SET OF 2	19-80 19-81	2
15	4820721	10300158	Valve, 1/4-turn manual shut off - includes (16)	19-80 19-81	1
16	4823484	10300160	Valve handle, red	19-80 19-81	1

\*Not illustrated

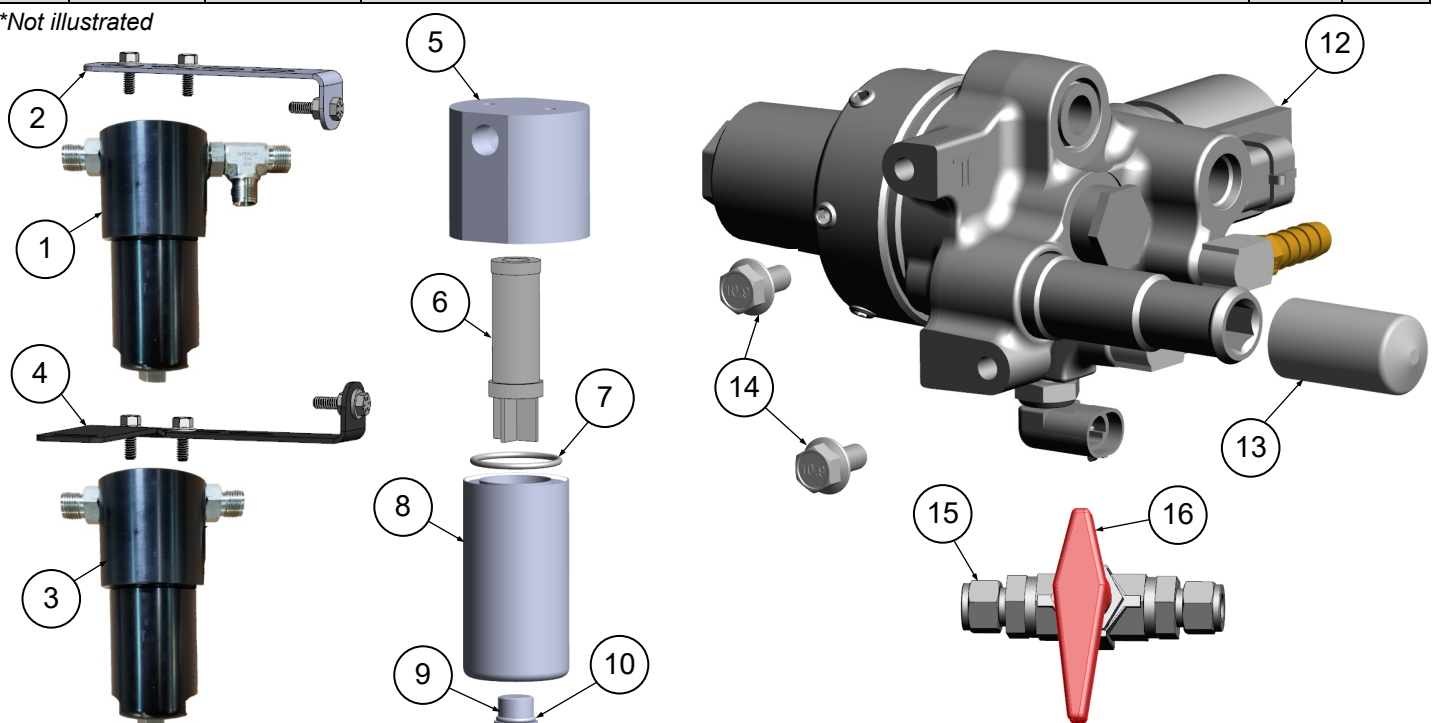

# Fuel Fill Panel Components - front

Item	UPS p/n	Service p/n	Description	Job #	Chassis QTY
1	4819374	10302000	Gauge, HP fuel	19-80 19-81	1
2	4820721	10300158	Defuel valve, includes red handle	19-80 19-81	1
3		20100123	Spacer, defuel valve	19-80 19-81	1
4		10300172	Bleed valve	19-80 19-81	1
5	4819410	10300712	Receptacle, fuel fill	19-80 19-81	1
6	4820736	10300212	Receptacle, defuel	19-80 19-81	1
7*	NS	NS	O-ring, fuel fill receptacle - POA 17	19-80 19-81	1
8	4819371	10404006	Kill cap, Drive Away Protection (DAP)	19-80 19-81	1
9		10300213	Dust cap, defuel receptacle	19-80 19-81	1
10*	NS	NS	O-ring, defuel receptacle - POA 17	19-80 19-81	1
11		20003301	Panel, fuel fill panel block off	19-80 19-81	1
12*		69000431	Bolt, fuel fill panel block off panel - SET OF 2	19-80 19-81	2
13		20003300	Cover, fuel fill panel, mounting face	19-80 19-81	1
14*		69500006*	U-nut spring clip - SET OF 5	19-80 19-81	3
15		10702936	Grommet, fuel fill panel	19-80 19-81	1
16*		20003006	ASM, fuel fill panel, complete	19-80 19-81	1
17*	4822716	10500059	Kit, service, O-ring assortment	19-80 19-81	n/a

\*Not illustrated

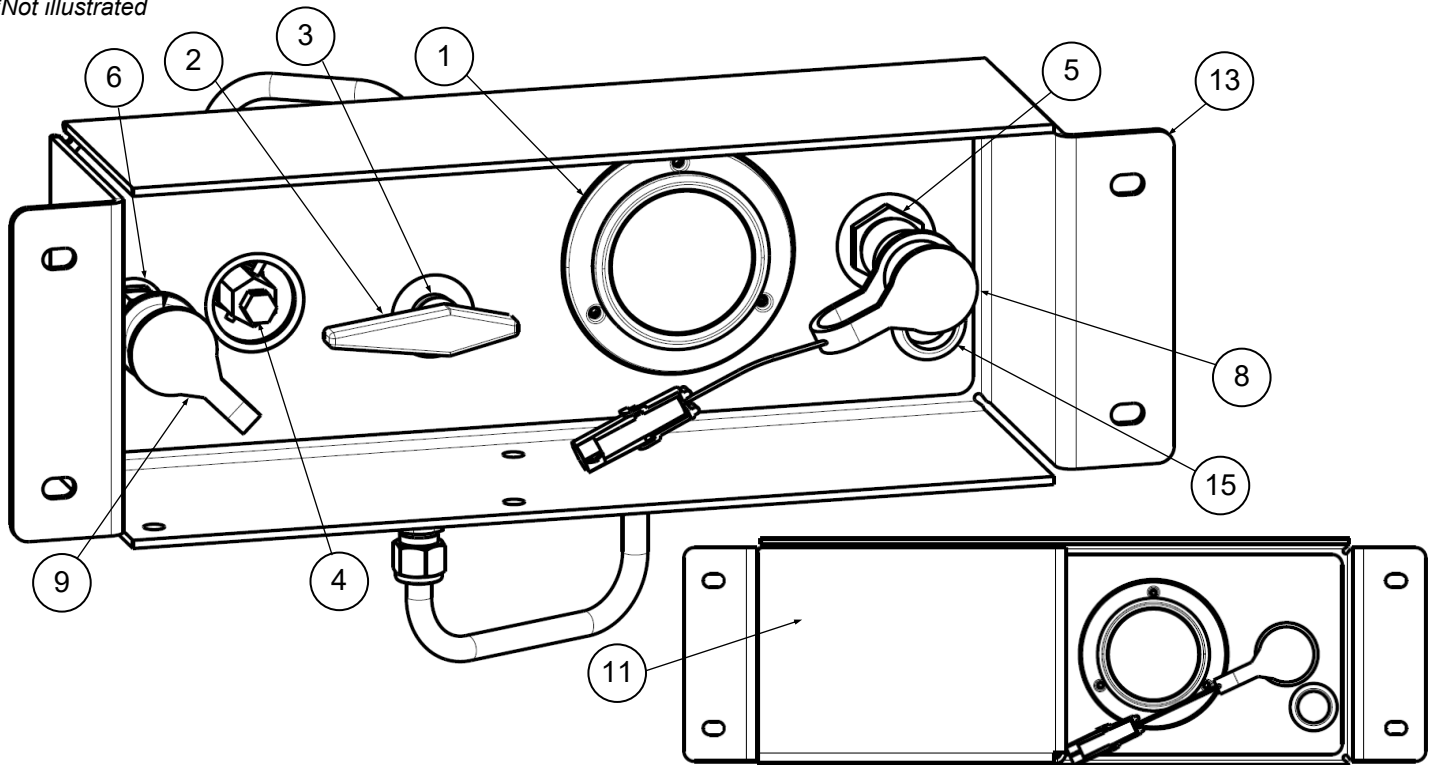

# Fuel Fill Panel Components - rear

Item	UPS p/n	Service p/n	Description	Job #	Chassis QTY
18		69000482	ASM, HP fuel tube, fill panel, check valve to tee	19-80 19-81	1
19		69000483	ASM, HP fuel tube, fill panel, tee to valve	19-80 19-81	1
20		69000484	ASM, HP fuel tube, fill panel, tee to tee	19-80 19-81	1
21		69000485	ASM, HP fuel tube, fill panel, tee to defuel valve	19-80 19-81	1
22		10300323	Check valve, 3/8-in.	19-80 19-81	1
23		10200050	Fitting, bulkhead, straight. 3/8-in.	19-80 19-81	1
24*		10200142	Fitting, port connector	19-80 19-81	1
25		10200207	Fitting, tee, 3/8-in. to 3/8-in	19-80 19-81	1
26	4820682	10200236	Fitting, adapter, male	19-80 19-81	1
27		10200264	Fitting, tee, 3/8-in. to 1/4-in.	19-80 19-81	1
28		10200270	Fitting, tee, 3/8-in. to 1/4-in. female	19-80 19-81	1
29		10240403	Fitting, adapter, straight	19-80 19-81	1
30		20104137	Bracket, grounding wire	19-80 19-81	1

\*Not illustrated

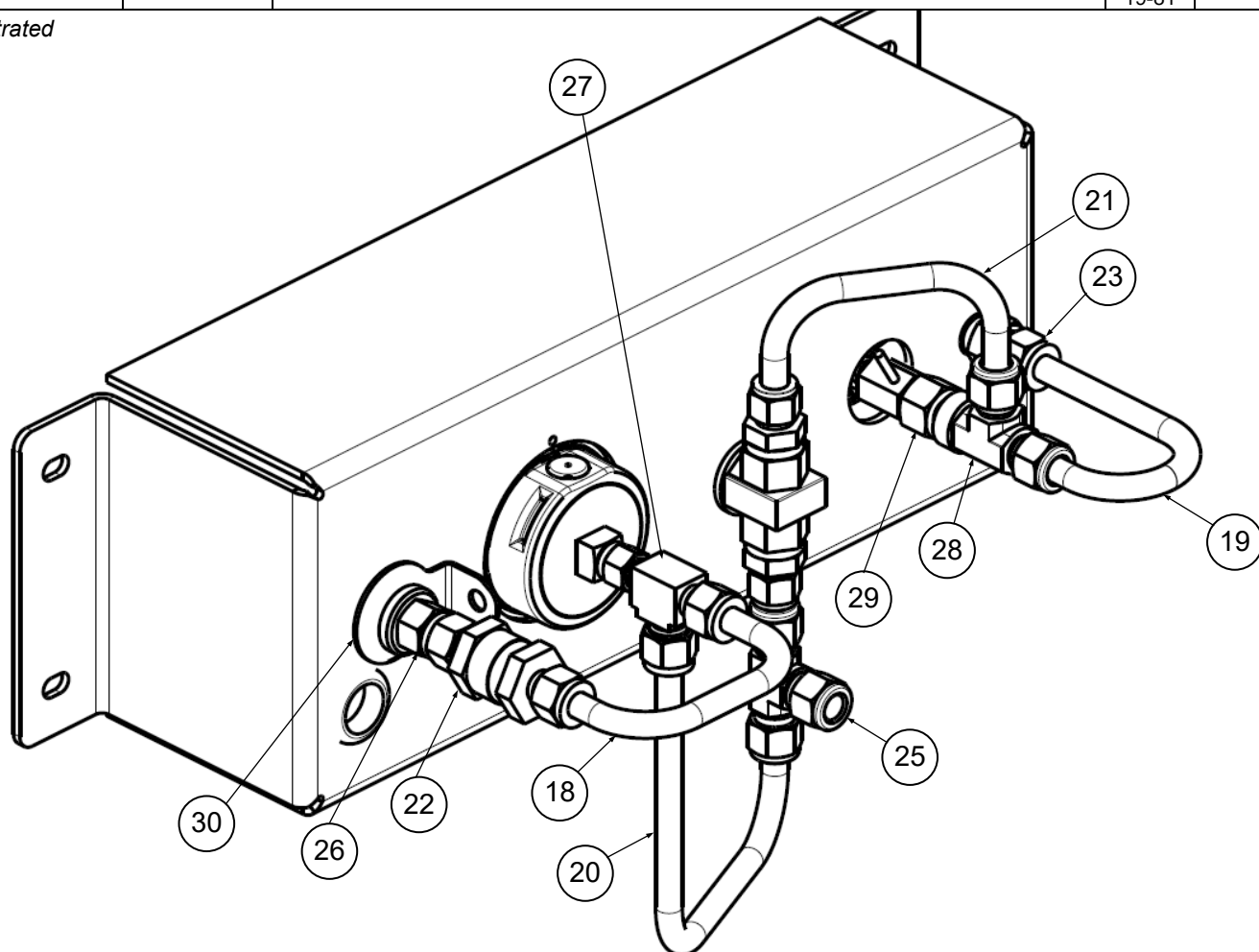

# Electrical Components

Item	UPS p/n	Service p/n	Description	Job #	Chassis QTY
1		20102905	ECU, Ford CNG, PTS_FORD_03.GAU, FW 5.0	19-80 19-81	1
2*		69000487	Kit, ECU mounting hardware	19-80 19-81	1
3		69000486	Kit, Service, Ford F-59 ECU bracket mounting - includes bracket and hardware	19-80 19-81	1
4		69000422	Clip, dual tie strap - SET OF 13	19-80 19-81	13
5		61090095	Flange clip, zip tie mount	19-80 19-81	2
6		62160001	Gasket, engine compartment bulkhead harness connector	19-80 19-81	1
7*		61040012	Harness, chassis, Ford F-59	19-80 19-81	1
8*		61040013	Harness, cabin, Ford F-59	19-80 19-81	1
9		61090110	Mount, 5/8-in. stud, 4-way tie down	19-80 19-81	2

\*Not shown

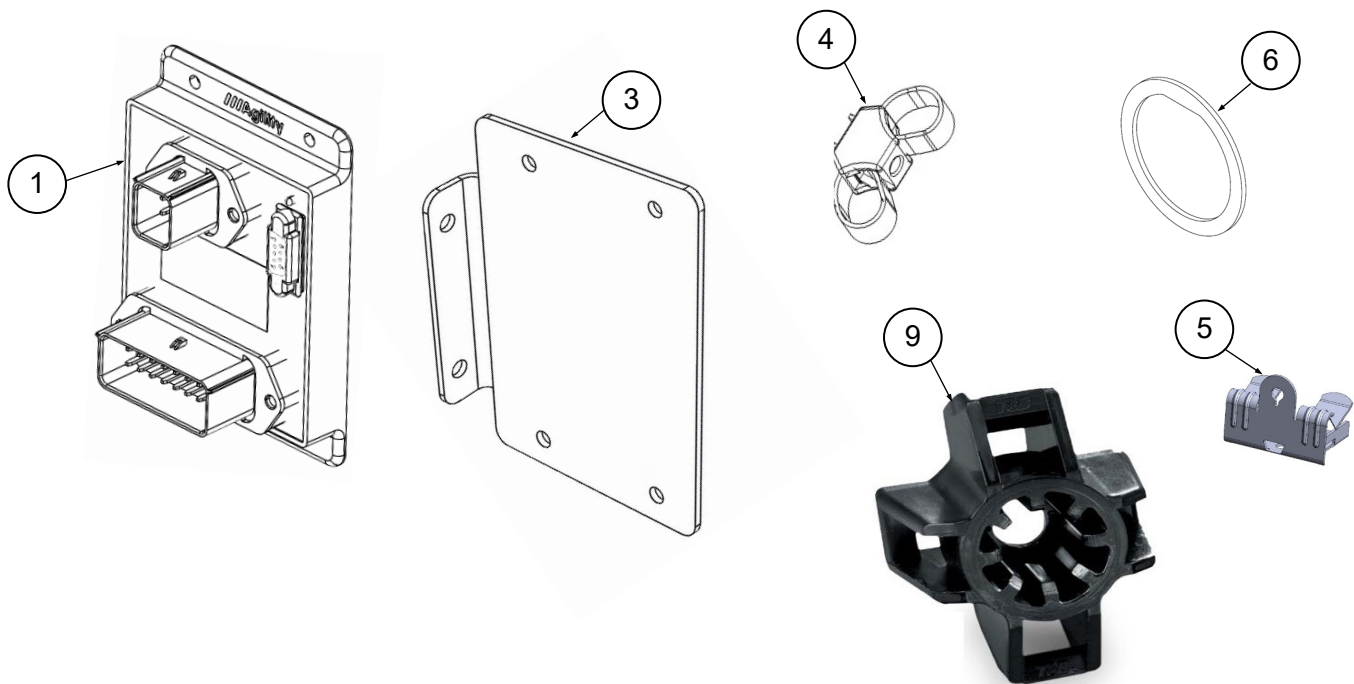

# Decals & Labels

Item	UPS p/n	Service p/n	Description	Job #	Chassis QTY	Location
1	4824783	10602484	Decal, WARNING Pressurized CNG Fuel Line	19-80 19-81	†	Fuel lines
2		10602442	Decal, PRD Vent Line, CAUTION	19-80 19-81	†	PRD vent lines
3		10602310	Decal, Manual Shut Off Valve	19-80 19-81	1	DS chassis rail
4	3467644	10602105	Decal, CNG blue diamond	19-80 19-81	3	Body sides and rear††
5		61210024	Decal, Manual Shut Off Valve, 2.5x2.5	19-80 19-81	1	DS body
6		61210025	Decal, ATTENTION, Master Shut-Off Valve, CNG, 3x3	19-80 19-81	1	Engine compartment firewall
7		61210022	Decal, Reprogram Warning, 2x2	19-80 19-81	1	Engine compartment firewall
8		61210023	Decal, Reprogram Warning, 1x4	19-80 19-81	1	Adjacent to OBD-II port
9		10602610	Decal, WARNING PRD Vent Location	19-80 19-81	1	Body, adjacent to PRD vent tube outlet
10		10602107	Decal, Cylinder Inspection Record	19-80 19-81	2	Cylinders, visible inside shield
11*		10602108	Decal, Fuel fill panel, Danger Vent Pressure	19-80 19-81	1	Fuel fill panel
12*		10602234	Decal, System, WARNING, PRD Inspection	19-80 19-81	1	Fuel fill panel
13*		10602614	Decal, Faceplate, fuel fill panel	19-80 19-81	1	Fuel fill panel

†Decal shall be installed every 18-in. to 24-in.

††Decal cannot be installed on rear bumper per U.S. DOT mandate. Side decals must be installed adjacent to DOT number.

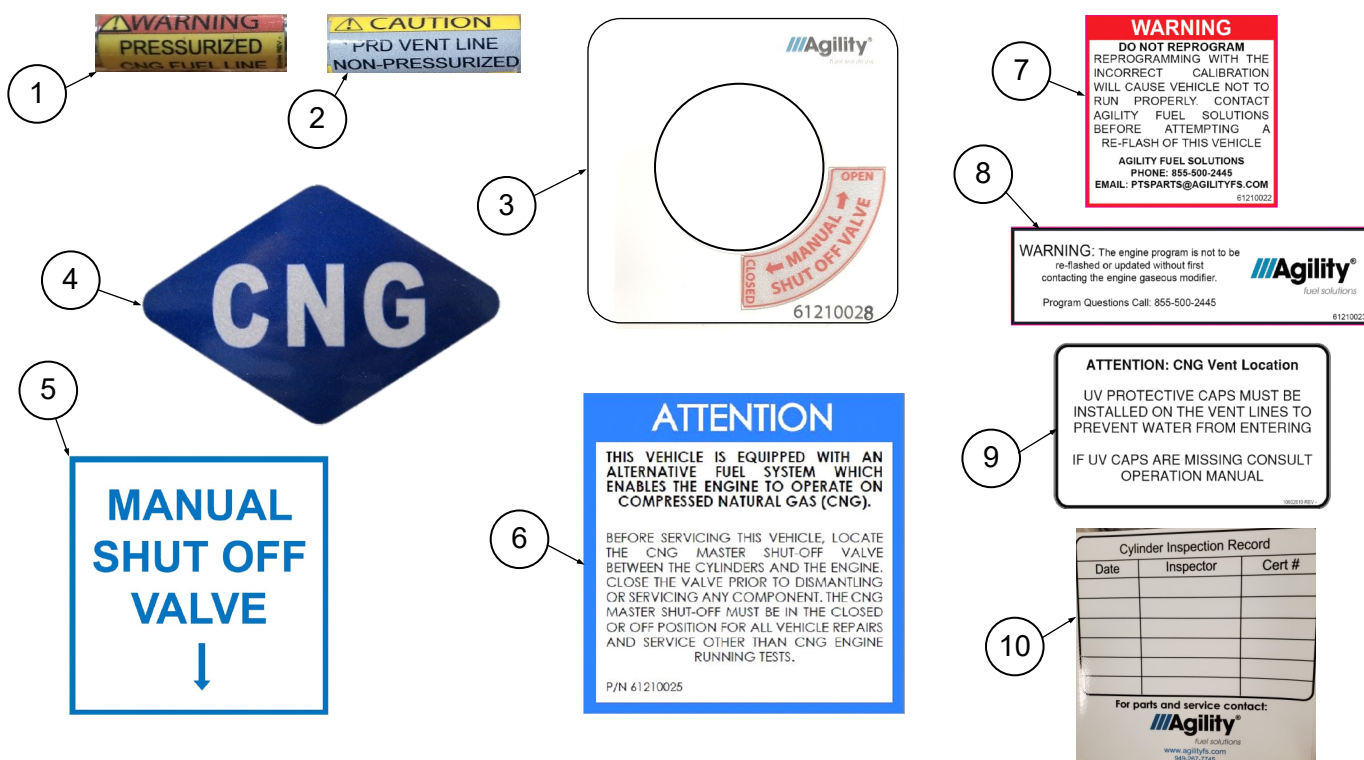



3335 Susan Street  
Suite 100  
Costa Mesa, CA 92626  
[www.agilityfuelsolutions.com](http://www.agilityfuelsolutions.com)



**Customer Care**

**+1 877 234 1722** (toll-free, U.S. and Canada)

UPS Direct Access Prompt: 6



**Parts Orders**

[ptsparts@agilityfs.com](mailto:ptsparts@agilityfs.com)

**F59NG.SM.0002**  
**April 14, 2020**